

Plan View

**QTY. 2**

WHEN DISASSEMBLING ALUMINUM EXTRUSION, TIGHTEN ALL SETSCREWS AND LOCKS TO PREVENT LOSS DURING SHIPPING

# visionary™ IDESIGNS

## Using Your Setup Instructions

The Visionary Designs Setup Instructions are created specifically for your configuration. They are laid out sequentially, including an exploded view of the entire display, and then a logical series of detailed steps to assemble the main structure and components. We encourage you to study the instructions **before** attempting to assemble your exhibit.

Each page reminds you to tighten the setscrews after disassembling your exhibit to prevent loss of the locks and setscrews (see below in RED). This is **VERY IMPORTANT**.

## Cleaning and Packing Your Display

- 1) Use care when cleaning aluminum extrusion or acrylic inserts. Use only non-abrasive cleaners.
- 2) When cleaning laminate inserts or countertops, use mild cleansers and a soft material such as cotton.
- 3) Keep all display components away from extreme heat and long exposure to sunlight to avoid warping and fading.
- 4) Retain all packing material. It will make re-packing much easier and will reduce the likelihood of shipping damage.



**The Tool**

Most Visionary Designs exhibits can be assembled with the supplied Hex Key Tool. Occasionally, a flat head screwdriver may be required.



**Typical Connection**

Most horizontal extrusion connections have a patented expandable lock. This lock inserts into the groove of an opposing extrusion. Tightening the lock with the Hex Key Tool expands the lock and creates a strong positive connection.



**Typical Connection (cont'd)**

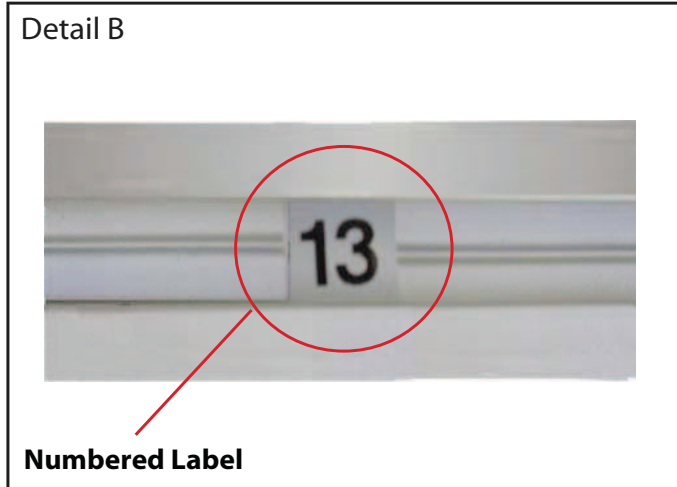

**Detail B**

**Numbered Label**

Each extrusion contains a numbered label which corresponds with setup instructions. The label is located within a groove of the extrusion (when possible). With Visionary Designs the labels contain Black numbers unless otherwise specified.



**Detail C**

**Horizontal Inline Connection** (remove only one setscrew)

Remove only (1) setscrew when disassembling. Replace setscrew in extrusion after assembling it. Before packing, replace setscrew in extrusion to avoid losing it.

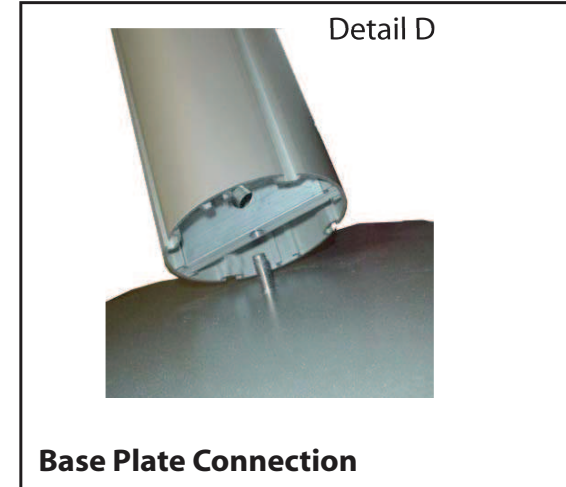

**Detail D**

**Base Plate Connection**

Attach base plate to round or square vertical extrusion using the bolt provided. Be careful not to strip the threads.

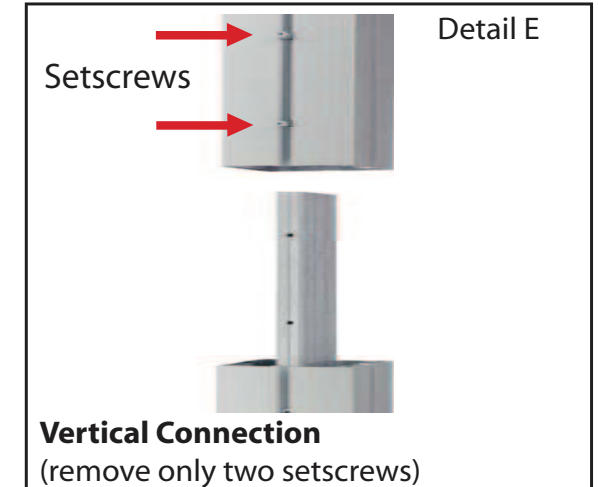

**Detail E**

**Vertical Connection**  
(remove only two setscrews)

When vertical extrusions are packed in portable cases rather than crates or tubs, they must be broken down into smaller sections which then require assembly.

Remove only (2) setscrews when disassembling. Replace setscrews in extrusion after assembling it. Before packing, replace setscrews in extrusion to avoid losing them.

**WHEN DISASSEMBLING ALUMINUM EXTRUSION, TIGHTEN ALL SETSCREWS AND LOCKS TO PREVENT LOSS DURING SHIPPING**

866.652.2100

Item	Qty.	Description
1	2	Oval Base Plate
2	2	Round Base Plate
3	2	88”h Vertical Extrusion
4	2	41”h Vertical Extrusion
5a/5b	1/1	51.4170”w Horizontal Extrusion w/ Sliding Door Track
6	4	17.5”w Horizontal Extrusion
7a/7b	1/1	51.4170”w Horizontal Extrusion
8a/8b	1/1	51.4170”w Horizontal Extrusion w/ Attached Velcro to Front of Extrusion
9a/9b	1/1	51.4170”w Horizontal Extrusion w/ Attached Velcro to Bottom of Extrusion
10	2	37.418” Vertical Extrusion
14	1	Canopy Attachment
15	1	Canopy Attachment

Steps:

- 1) Attach vertical extrusions 3 to base plates 1.  
See detail D on General Information Page.
- 2) Attach canopy attachments 14 and 15 to top of vertical extrusions 3.
- 3) Attach vertical extrusions 4 to base plates 2.
- 4) Attach horizontal extrusions together 5a to 5b, 7a/7b, 8a to 8b, and 9a to 9b.
- 5) Attach lower horizontal extrusions 5a/5b, 6 and 7a/7b between vertical extrusions 4 and 3 as shown.
- 6) Attach vertical extrusions 10 to assembled horizontal extrusions 7a/7b, placing inserts as indicated.
- 7) Attach vertical extrusions 10 to assembled horizontal extrusions 5a/5b.
- 8) Attach middle horizontal extrusions 6 and 8a/8b between vertical extrusions 3 and 4 as shown.
- 9) Attached upper horizontal extrusions 9a/9b between vertical extrusions 3, flush to top of vertical extrusions.
- 10) Apply graphic to assembled backwall as indicated.

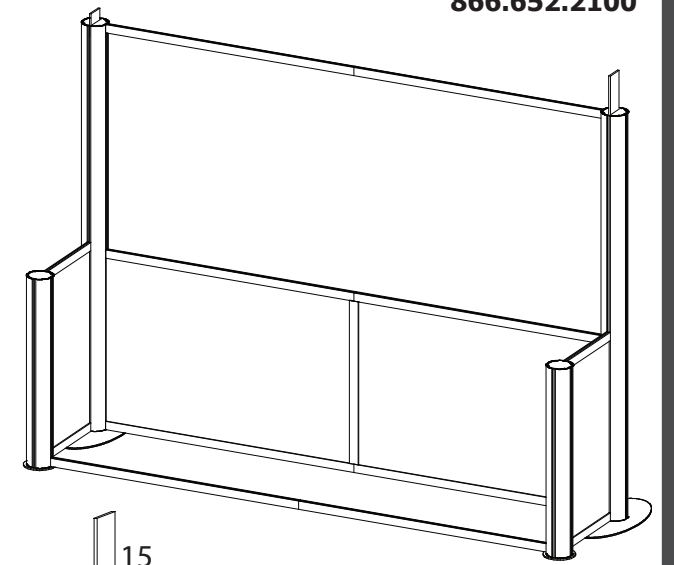

**QTY. 2**

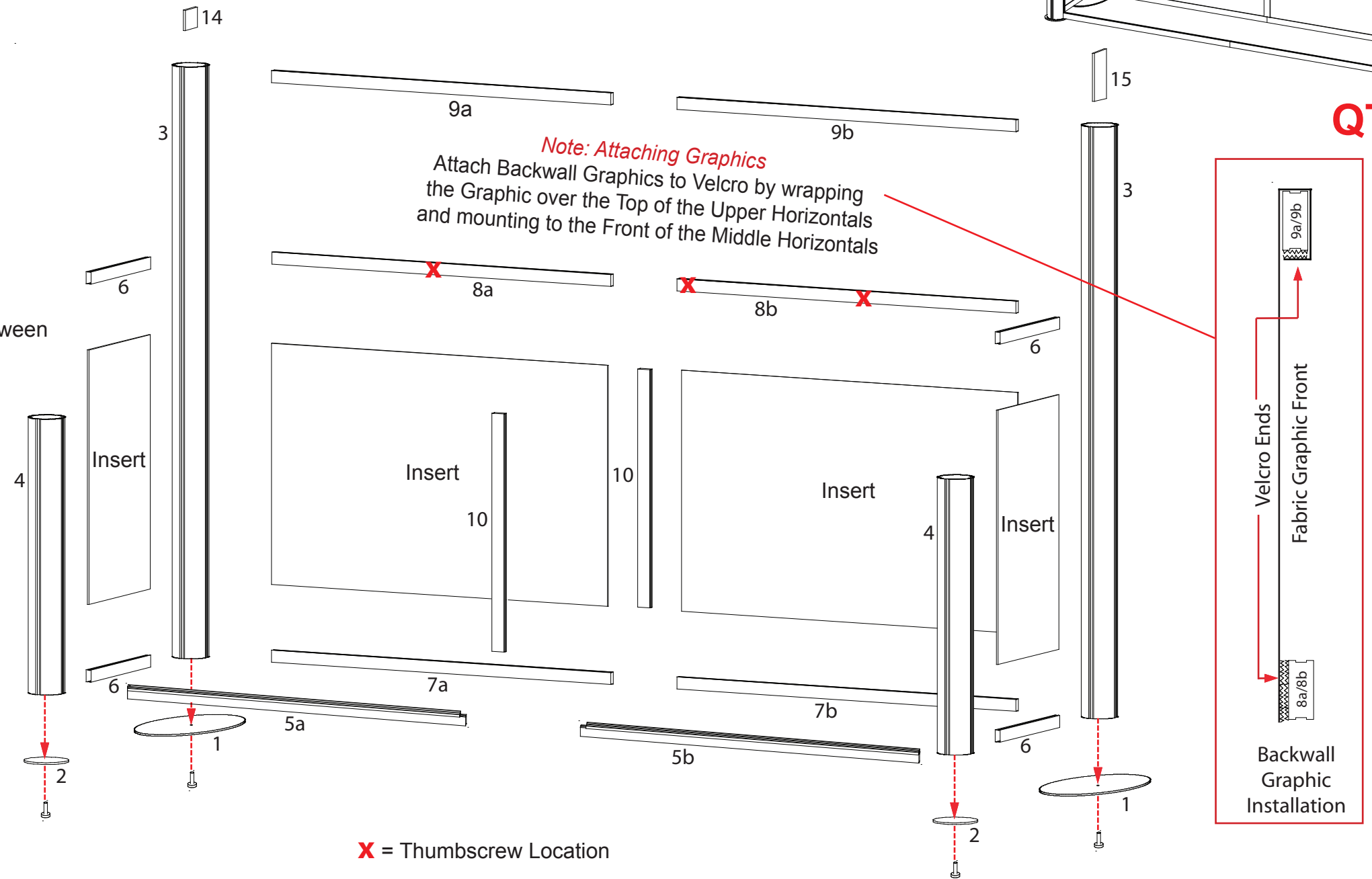

**WHEN DISASSEMBLING ALUMINUM EXTRUSION, TIGHTEN ALL SETSCREWS AND LOCKS TO PREVENT LOSS DURING SHIPPING**

866.652.2100

Item	Qty.	Description
11a/11b	1/1	37.418"w Horizontal Extrusion w/ Sliding Door Track

Steps:

- 1) Attach horizontal extrusions 11a and 11b together.
- 2) Place sliding door inserts into grooves of sliding door tracks.
- 3) Attach assembled extrusions 11a/11b between vertical extrusions 4 as shown.
- 4) Velcro internal shelf supports to inside assembled structure base.
- 5) Place internal shelf atop shelf supports.
- 6) Set counter top on assembled base and secure with supplied thumbscrews.

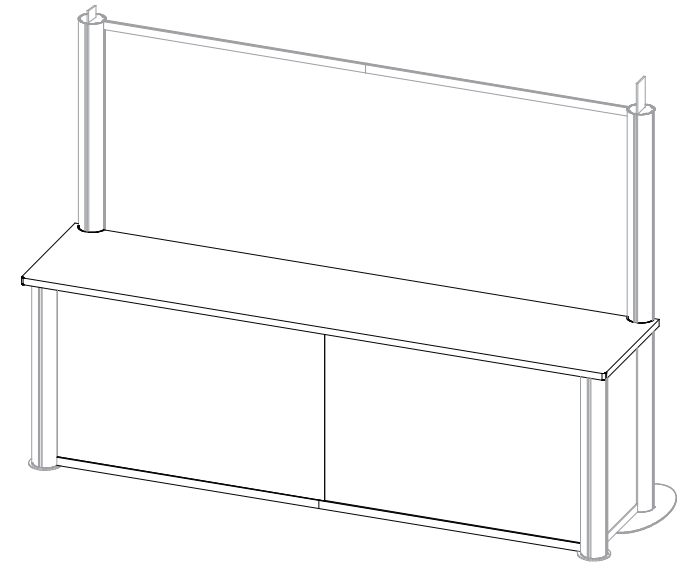

**QTY. 2**

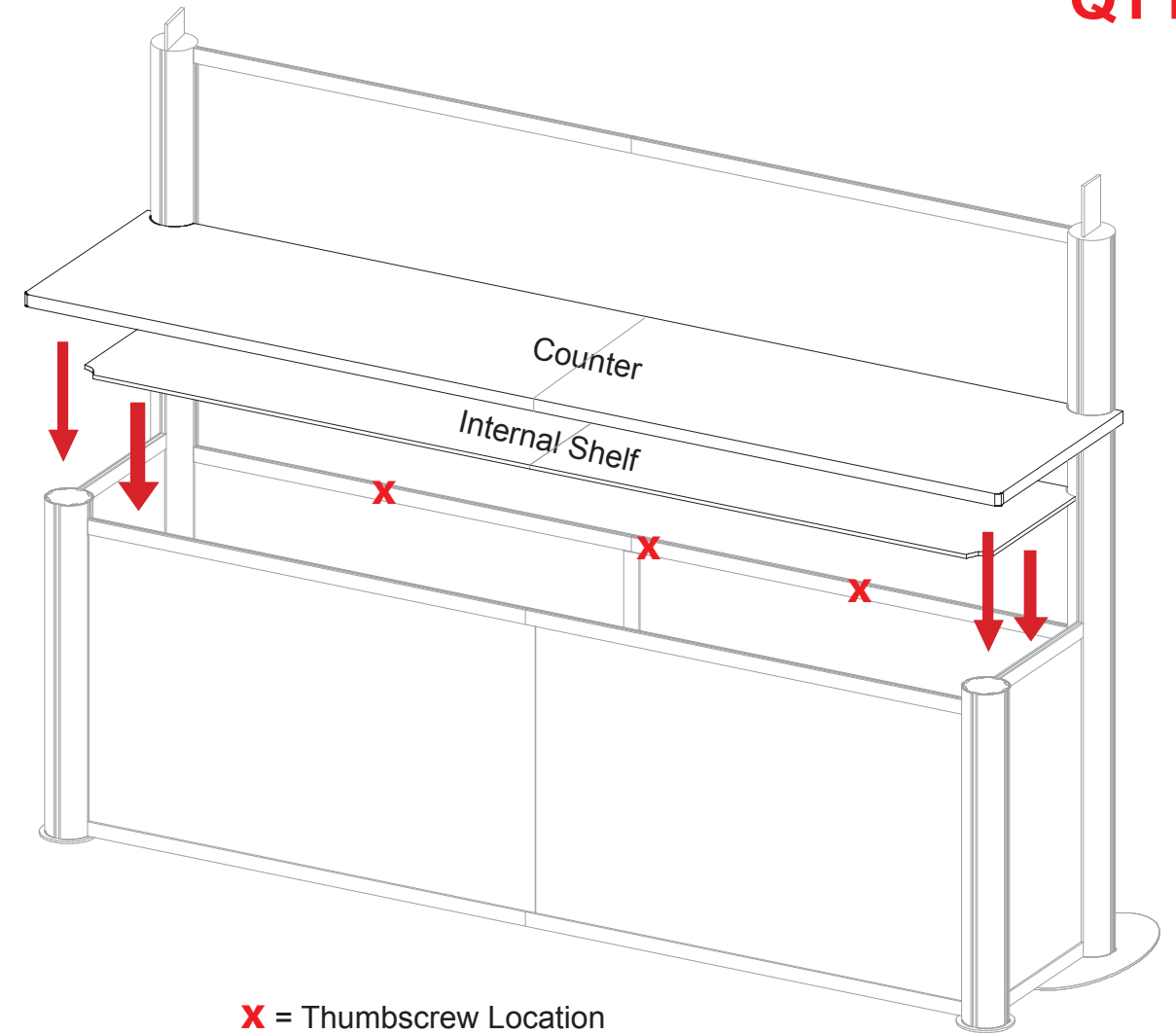
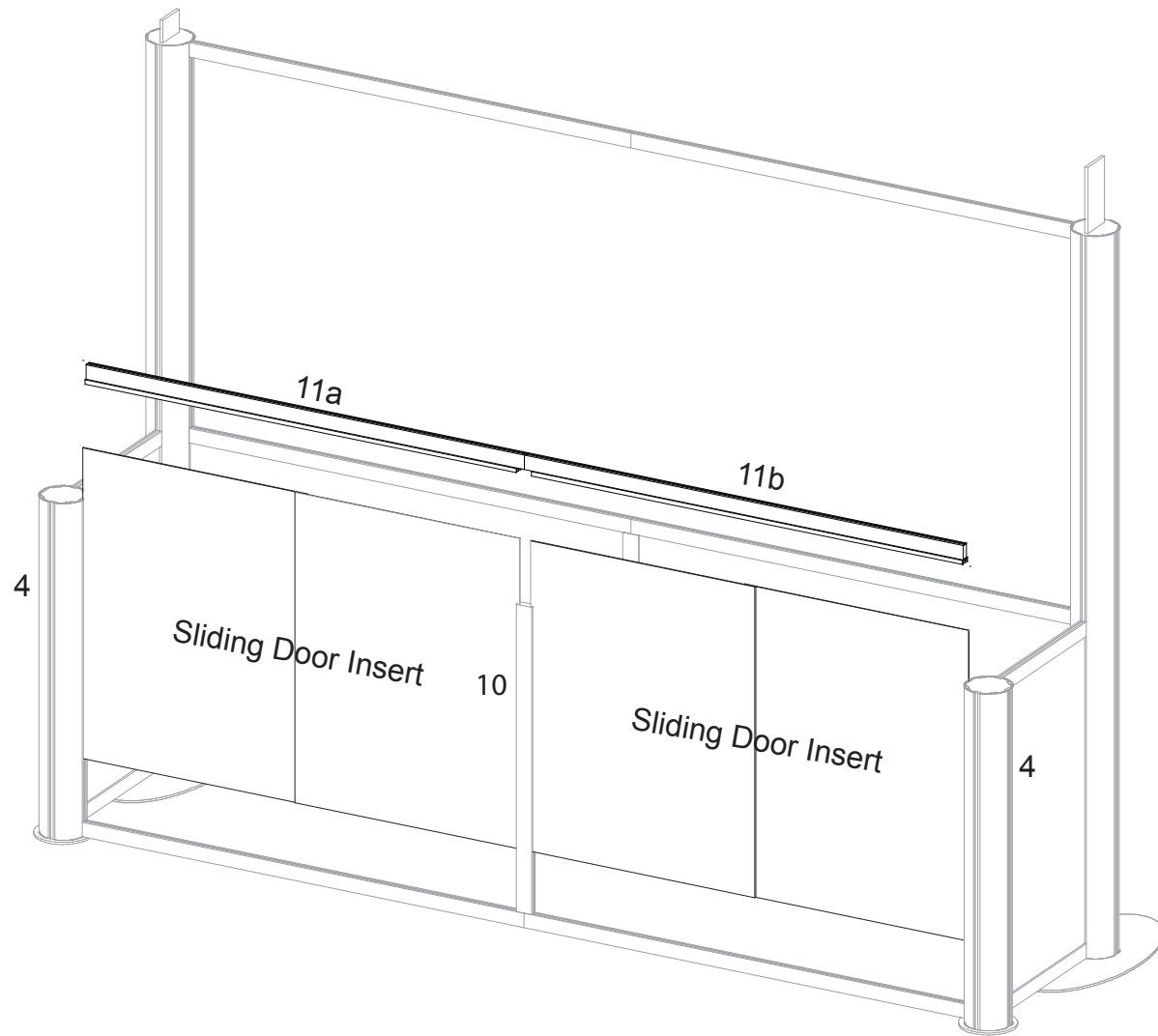

**X** = Thumbscrew Location

**WHEN DISASSEMBLING ALUMINUM EXTRUSION, TIGHTEN ALL SETSCREWS AND LOCKS TO PREVENT LOSS DURING SHIPPING**

866.652.2100

Item	Quantity	Description
A	2	Round Curved Extrusion
B	2	Round Curved Extrusion
C	2	14.773" Round Curved Extrusion made for Connection
D	1	14.773" Round Curved Extrusion

**Steps:**

- 1) Connect [A] extrusion to opposing [A] extrusion.
- 2) Connect [B] extrusion to opposing [B] extrusion.
- 3) Connect [C] extrusions between [A/B].
- 4) Connect [D] extrusion between [A/B].

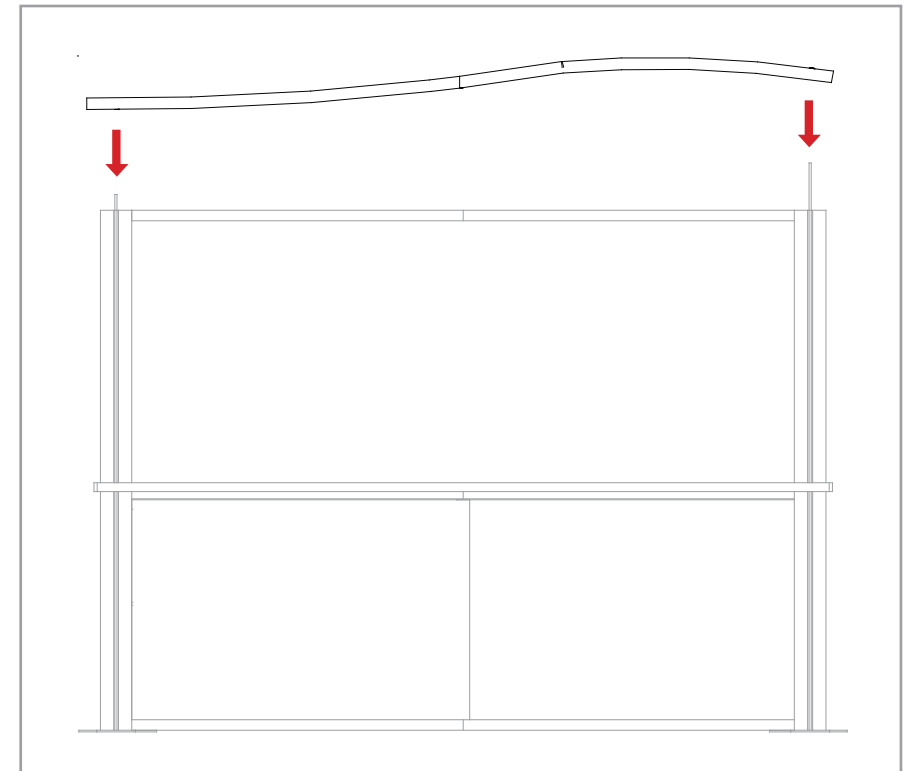
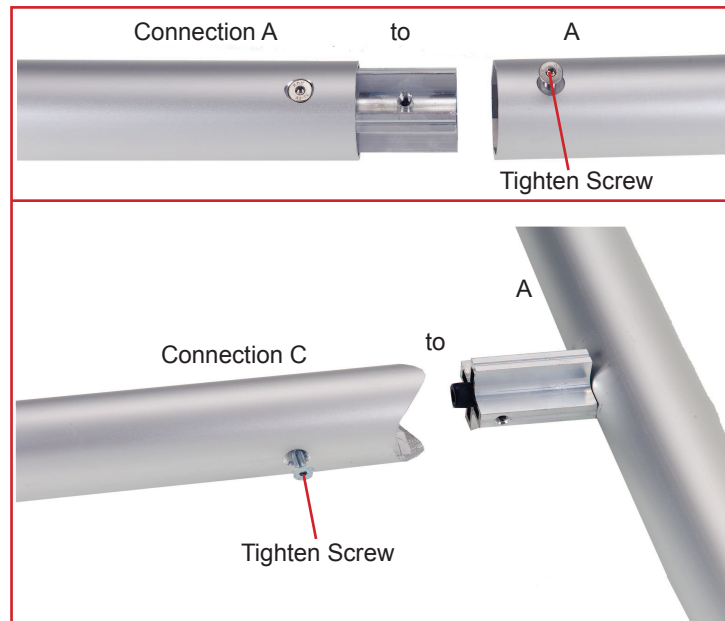
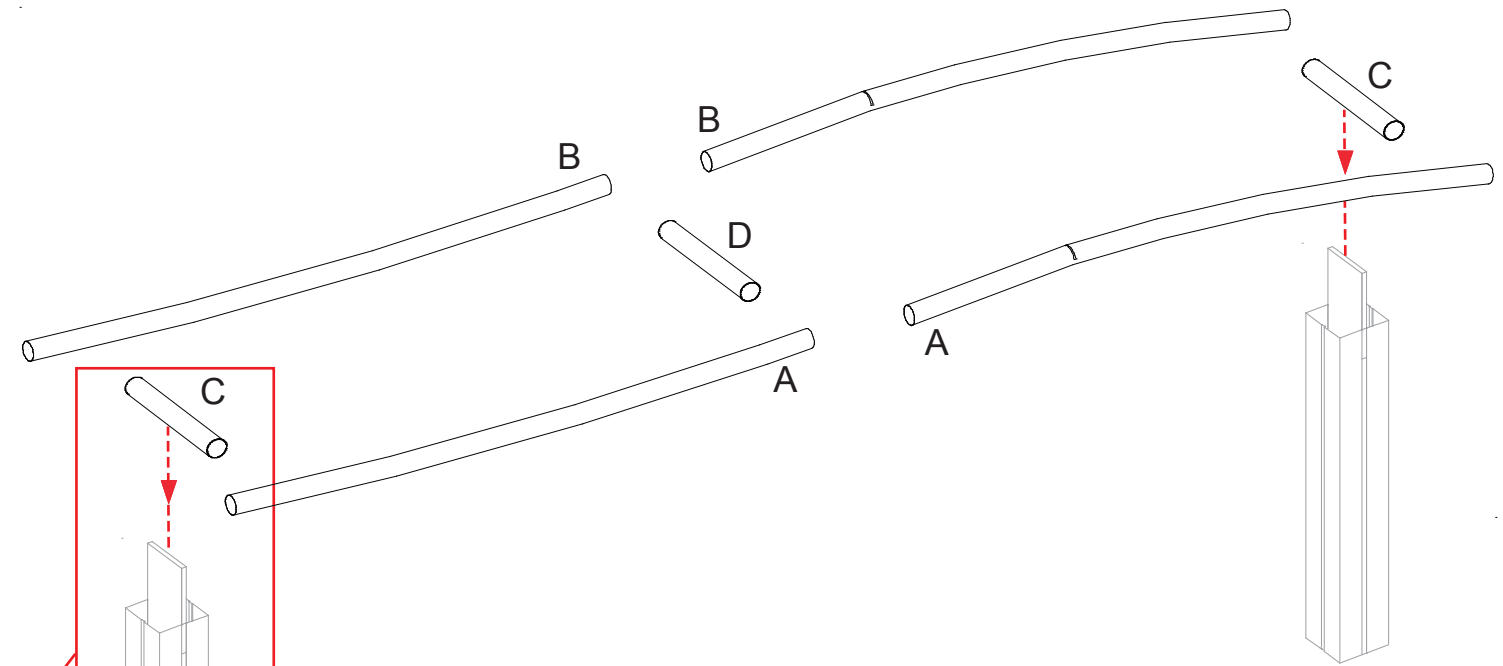

**WHEN DISASSEMBLING ALUMINUM EXTRUSION, TIGHTEN ALL SETSCREWS AND LOCKS TO PREVENT LOSS DURING SHIPPING**

Item	Qty.	Description
12	1	18" Base Plate
13	1	41.25"h Vertical Extrusion

- Steps:
- 1) Attach conference table Leg 13 to base plate 12.  
See detail D on General Information Page.
  - 2) Attach counter to table leg with supplied hardware.

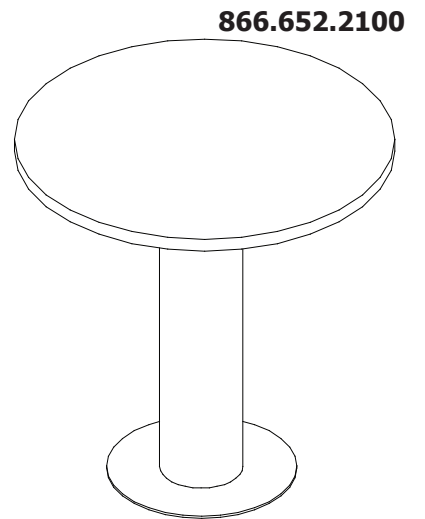
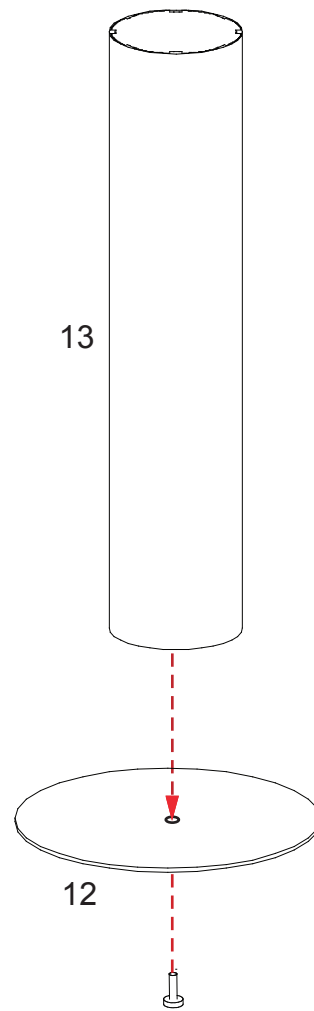
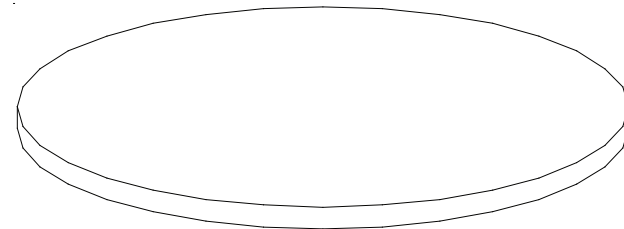

866.652.2100

**QTY. 2**

**WHEN DISASSEMBLING ALUMINUM EXTRUSION, TIGHTEN ALL SETSCREWS AND LOCKS TO PREVENT LOSS DURING SHIPPING**

**NOTE :**

PDF copies of your Setup Instructions are available @ [classicexhibits.com](http://classicexhibits.com)

See the search tool on the lower left hand corner of the Home page.

Enter the 5 digit Order #.

Search for Setup Instructions

WHEN DISASSEMBLING ALUMINUM EXTRUSION, TIGHTEN ALL  
SETSCREWS AND LOCKS TO PREVENT LOSS DURING SHIPPING