

euro It | *HYBRIDS*

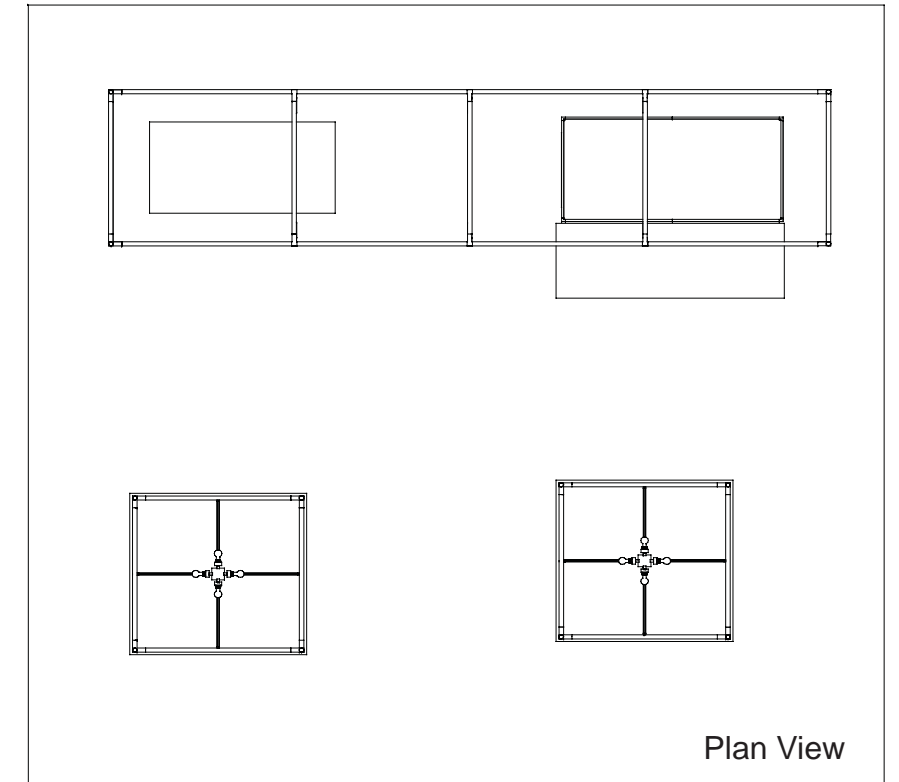
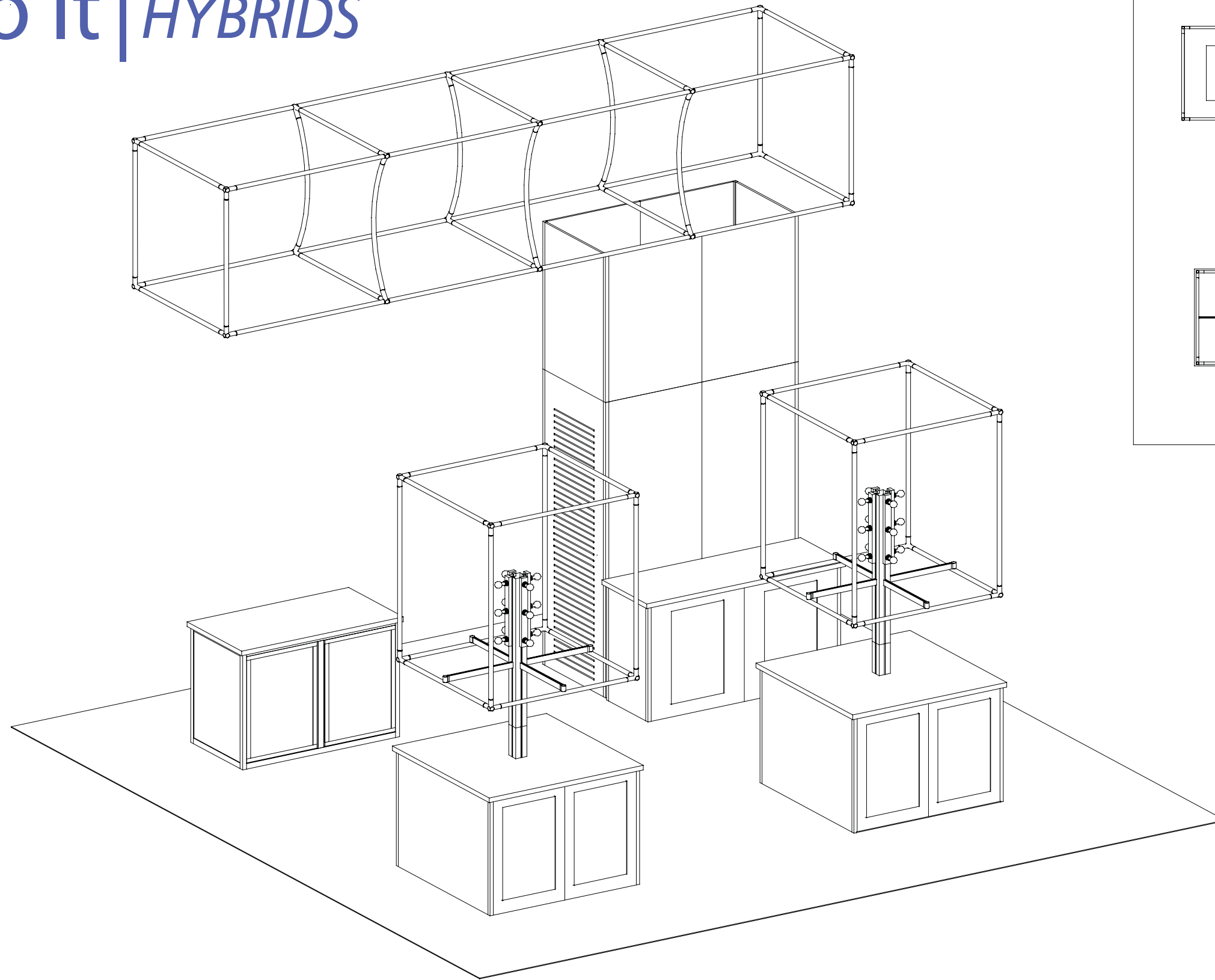

WHEN DISASSEMBLING ALUMINUM EXTRUSION, TIGHTEN ALL SETSCREWS AND LOCKS TO PREVENT LOSS DURING SHIPPING

euro lt | HYBRIDS

Using Your Setup Instructions

The Euro LT Hybrids Setup Instructions are created specifically for your configuration. They are laid out sequentially in levels, including exploded views, and a logical series of detailed steps to assemble the main structure and components. We encourage you to study the instructions **before** attempting to assemble your exhibit.

Each page reminds you to tighten the setscrews after disassembling your exhibit to prevent loss of the locks and setscrews (see below in RED). This is VERY IMPORTANT.

Cleaning and Packing Your Display

- 1) Use care when cleaning aluminum extrusion or acrylic inserts. Use only non-abrasive cleaners.
- 2) When cleaning laminate inserts, countertops, or panels use mild cleansers and a soft material such as cotton.
- 3) Keep all display components away from extreme heat and long exposure to sunlight to avoid warping and fading.
- 4) Retain all packing material. It will make re-packing much easier and will reduce the likelihood of shipping damage.

General Setup Instructions for Extrusion System



Most exhibits can be assembled with the supplied Hex Key Tool. Occasionally, a flat head screwdriver may be required.



Most horizontal extrusion connections have a patented expandable lock. This lock inserts into the groove of an opposing extrusion. Tightening the lock with the Hex Key Tool expands the lock and creates a strong positive connection.

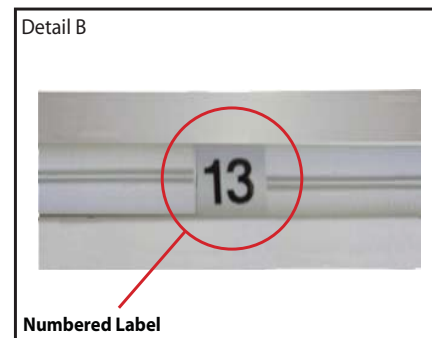

Each extrusion contains a numbered label which corresponds with setup instructions. The label is located within a groove of the extrusion (when possible). With extrusion components the labels contain Black numbers unless otherwise specified.

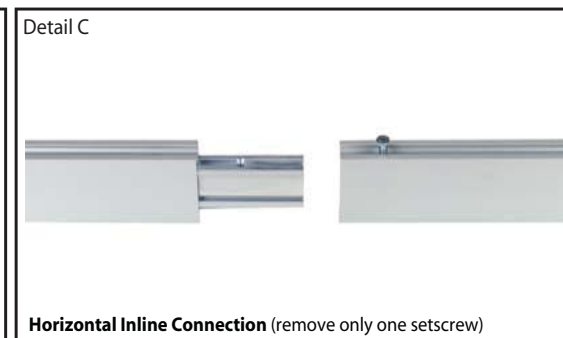

Remove only (1) setscrew when disassembling. Replace setscrew in extrusion after assembling it. Before packing, replace setscrew in extrusion to avoid losing it.

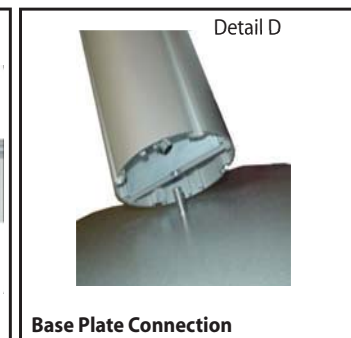

Attach base plate to round or square vertical extrusion using the bolt provided. Be careful not to strip the threads.

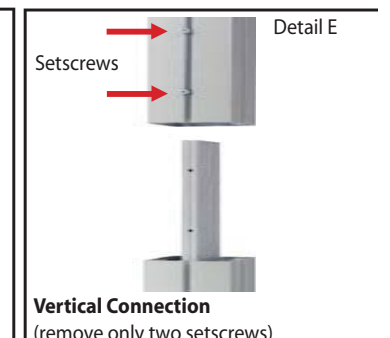

When vertical extrusions are packed in portable cases rather than crates or tubs, they must be broken down into smaller section which then require assembly.

Remove only (2) setscrews when disassembling. Replace setscrews in extrusion after assembling it. Before packing, replace setscrews in extrusion to avoid losing them.

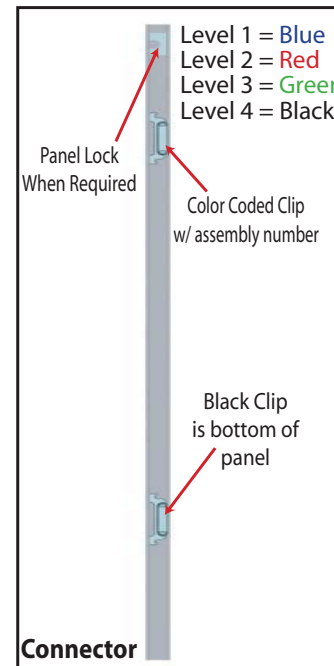

Each component has 2 clips, the lower clip is ALWAYS black. The top clip is color coded to distinguish which level. The color coded clip also contains the numbered label.

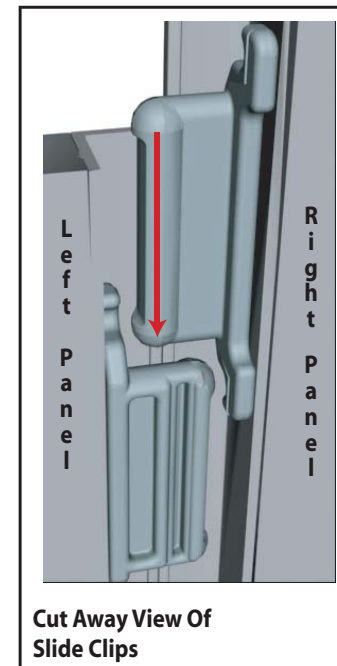

Components connect together by aligning them and sliding downward connecting clips together.

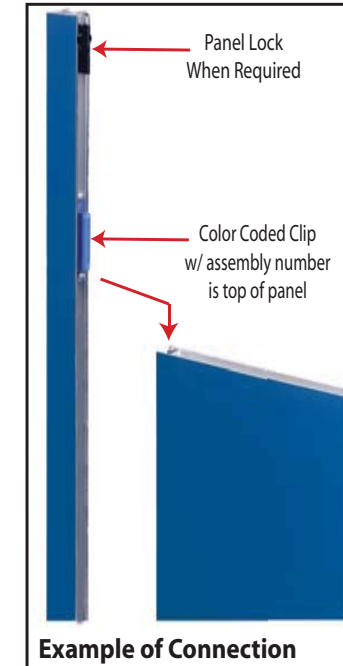

Configurations are assembled from left to right, usually starting with #1 and following the numbered sequence.

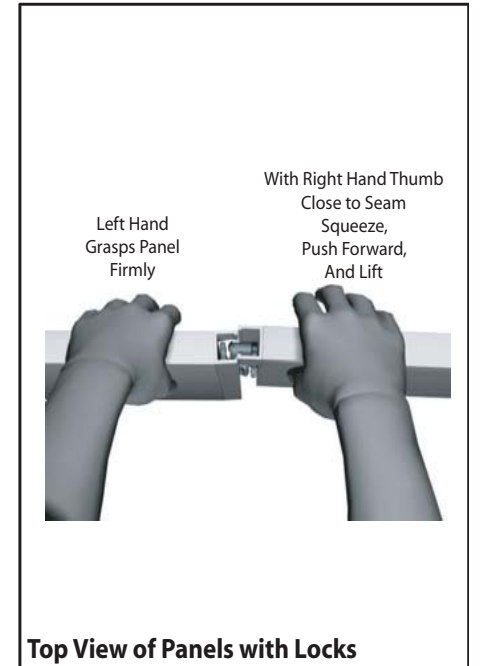

The first level of components contain panel locks that are located at the top of the panel for extra stability and seamless connection. When disassembling panels twist top connection slightly and lift right panel upward.

WHEN DISASSEMBLING ALUMINUM EXTRUSION, TIGHTEN ALL SETSCREWS AND LOCKS TO PREVENT LOSS DURING SHIPPING

Item Number	Description
1	23" w x 38" h Flat Panel w/ Door
2	23" w x 38" h Flat Panel w/ Door
3	38" h 90° Connector
4	46" w x 38" h Flat Panel
5	38" h 90° Connector
6	46" w x 38" h Flat Panel
7	38" h 90° Connector
8	46" w x 38" h Flat Panel
9	38" h 90° Connector
10	23" w x 38" h Flat Panel w/ Door
11	23" w x 38" h Flat Panel w/ Door
12	38" h 90° Connector
13	46" w x 38" h Flat Panel
14	38" h 90° Connector
15	46" w x 38" h Flat Panel
16	38" h 90° Connector
17	46" w x 38" h Flat Panel
18	38" h 90° Connector

Item	Qty.	Description
1	2	48" h Square Vertical Extrusion
2	2	48" h Square Vertical Extrusion
10	4	Counter support

Steps:

- 1) Attach lower vertical extrusion [1] to base plate, see Detail D on General Information Page.
- 2) Assemble workstations in numerical order as shown around base plates.
- 3) Attach counter supports [10] to vertical extrusions [1] as shown.
- 4) Set counter tops on assembled workstations and atop counter supports [10].
- 5) Attach upper vertical extrusion [2] atop lower vertical extrusion [1].
- 6) Hook light bars to top of square vertical extrusions as shown.

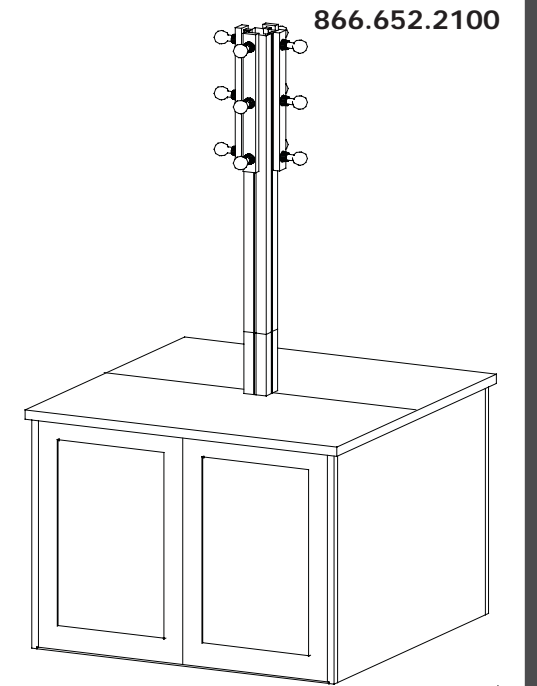

QTY.2

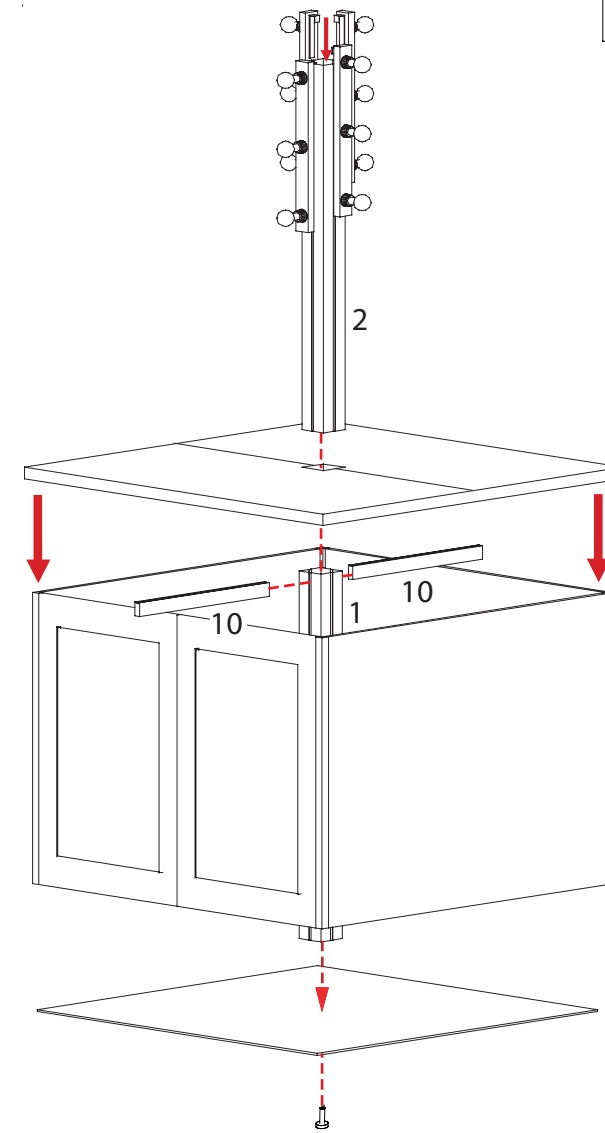
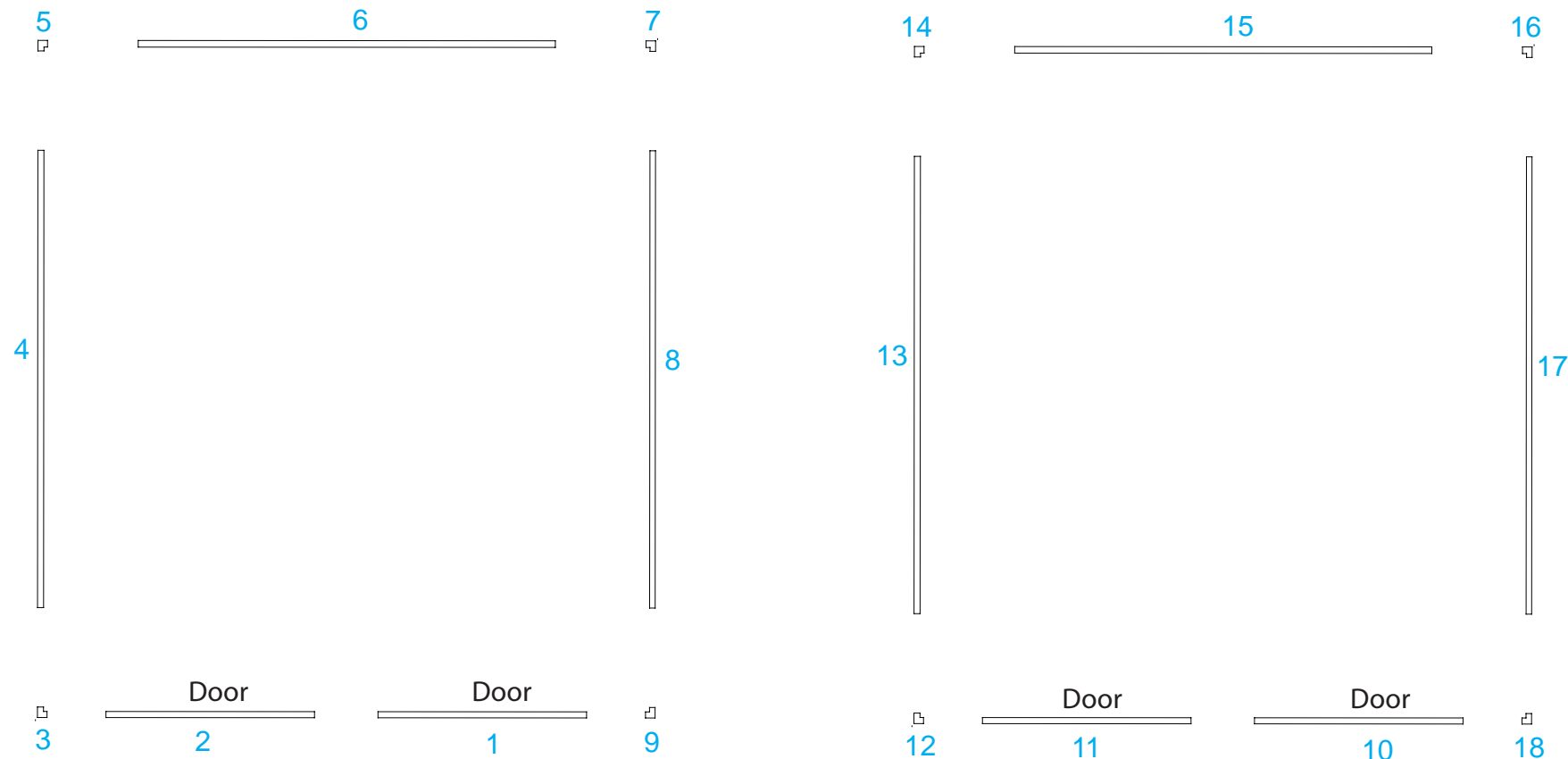

WHEN DISASSEMBLING ALUMINUM EXTRUSION, TIGHTEN ALL SETSCREWS AND LOCKS TO PREVENT LOSS DURING SHIPPING



866.652.2100

Using Your Setup Instructions

The Aero Overhead Sign Setup Instructions are created specifically for your configuration. They include an exploded view of the frame which is sequentially numbered. We encourage you to study the instructions before attempting to assemble your exhibit.

Connections are kept very simple: no tools. Everything assembles with push-button connectors and pre-connected horizontal sections.

Cleaning and Packing Your Display

- 1) Use care when cleaning aluminum extrusion or acrylic inserts. Use only non-abrasive cleaners.
- 2) Retain all packing material. It will make re-packing much easier and will reduce the likelihood of shipping damage.

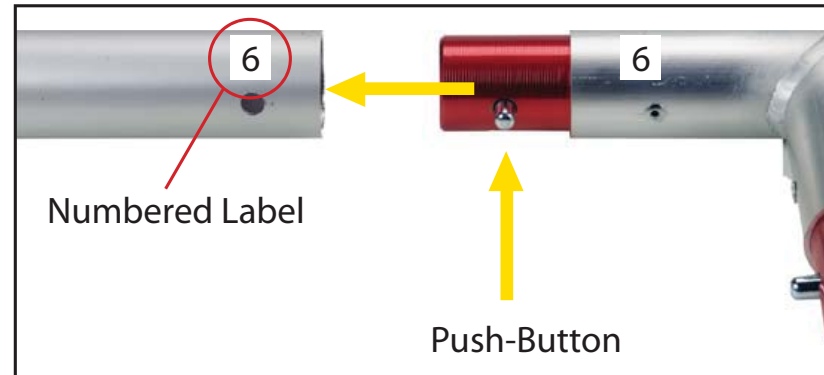
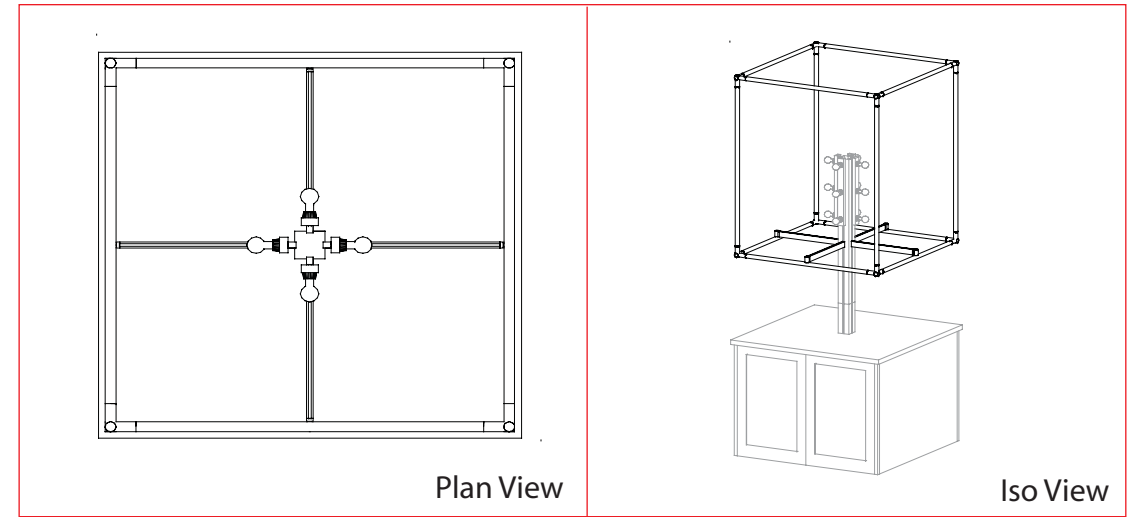

Connections are made by holding the button down and sliding the red tube into opposing tube until the connection is made. To disassemble push button and pull or twist extrusions apart.

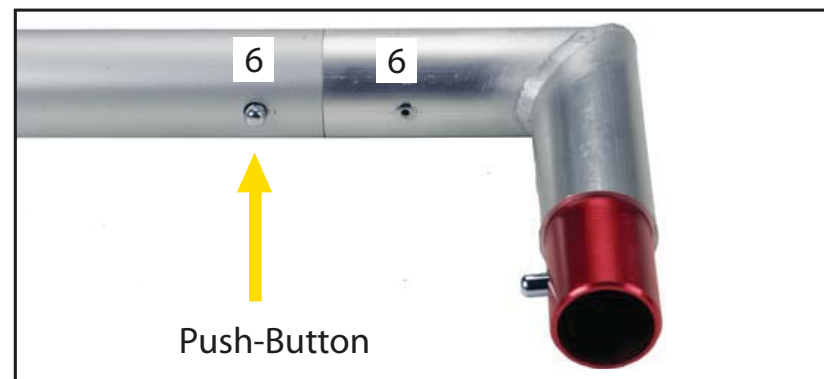

Item	Qty. per Step	Description
25	4	20.5" w Horizontal Extrusion

Steps:

- 1) Connect all pieces together in numerical order.
- 2) Attach horizontal extrusions [25] to connectors located on lower section of aero structure.
- 3) Attach horizontal extrusions [25] to square vertical extrusion.

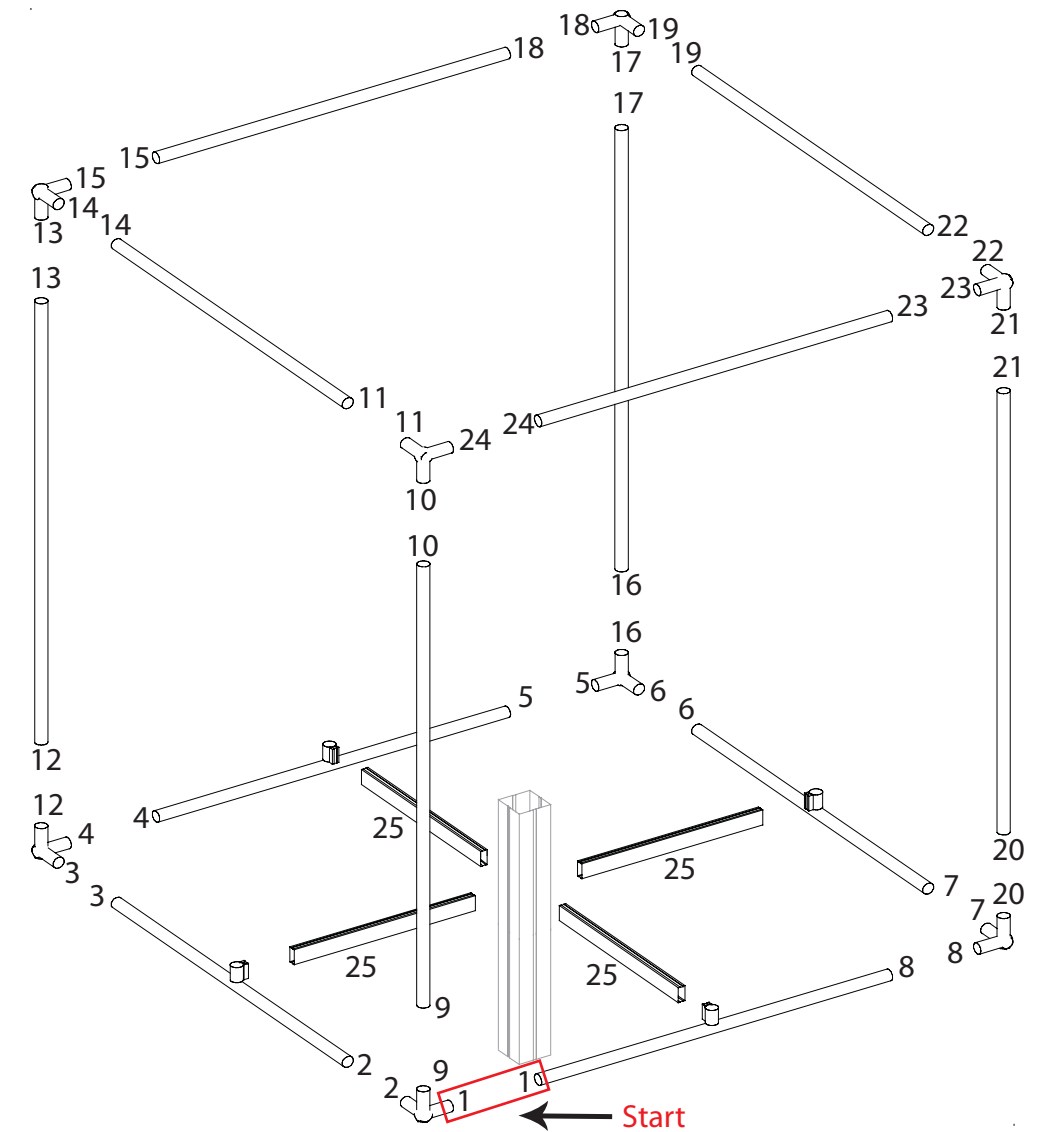

WHEN DISASSEMBLING ALUMINUM EXTRUSION, TIGHTEN ALL SETSCREWS AND LOCKS TO PREVENT LOSS DURING SHIPPING



866.652.2100

Using Your Setup Instructions

The Aero Overhead Sign Setup Instructions are created specifically for your configuration. They include an exploded view of the frame which is sequentially numbered. We encourage you to study the instructions before attempting to assemble your exhibit.

Connections are kept very simple: no tools. Everything assembles with push-button connectors and pre-connected horizontal sections.

Cleaning and Packing Your Display

- 1) Use care when cleaning aluminum extrusion or acrylic inserts. Use only non-abrasive cleaners.
- 2) Retain all packing material. It will make re-packing much easier and will reduce the likelihood of shipping damage.

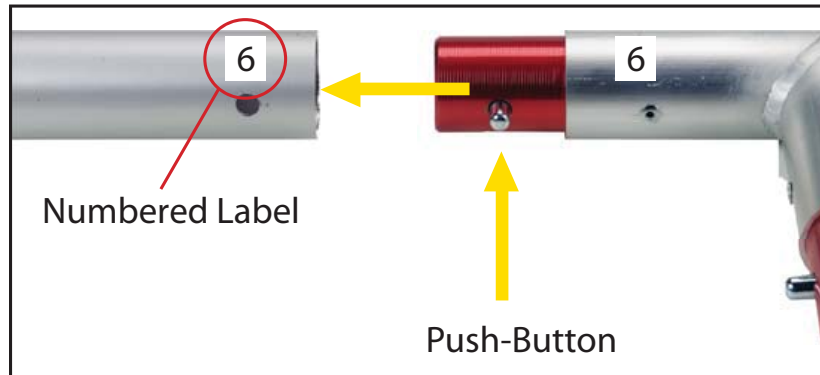
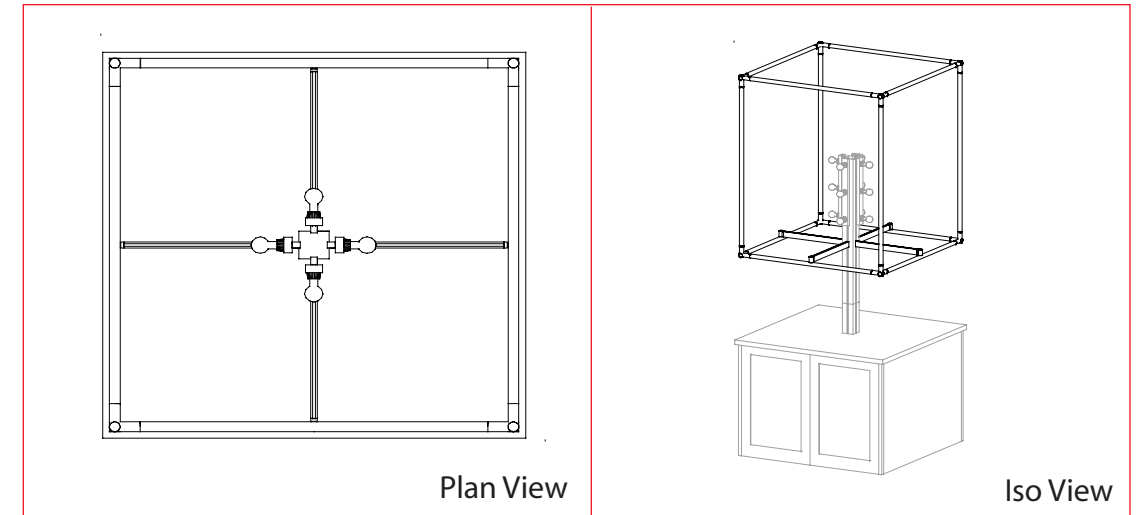

Connections are made by holding the button down and sliding the red tube into opposing tube until the connection is made. To disassemble push button and pull or twist extrusions apart.

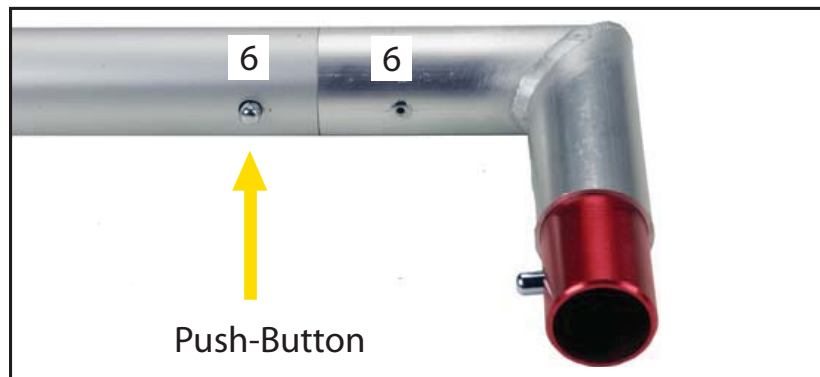

Item	Qty. per Step	Description
25	4	20.5" w Horizontal Extrusion

Steps:

- 1) Connect all pieces together in numerical order.
- 2) Attach horizontal extrusions [25] to connectors located on lower section of aero structure.
- 3) Attach horizontal extrusions [25] to square vertical extrusion.

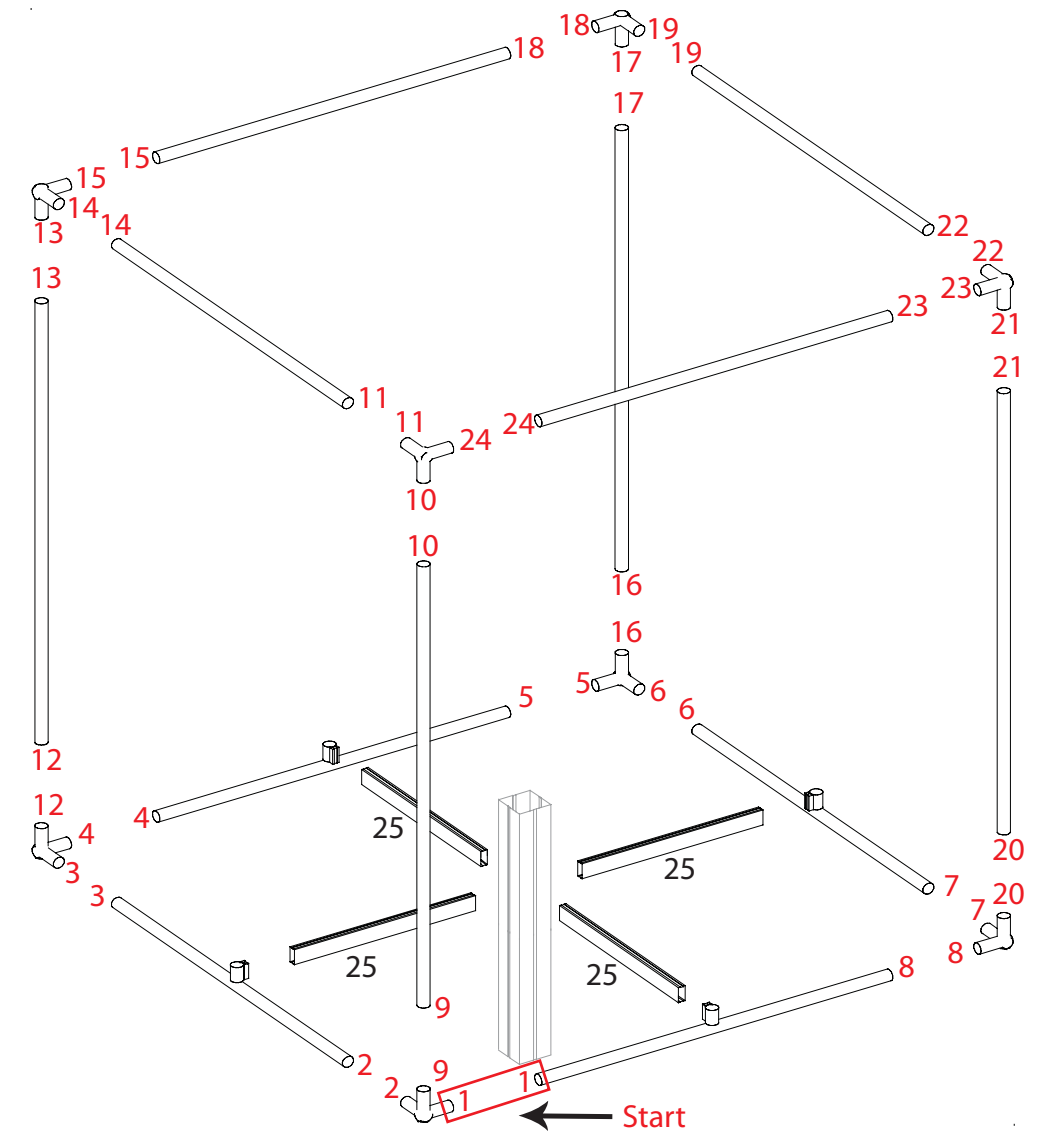

WHEN DISASSEMBLING ALUMINUM EXTRUSION, TIGHTEN ALL SETSCREWS AND LOCKS TO PREVENT LOSS DURING SHIPPING

Item Number	Description
19	30" w x 95" h Flat Panel
20	30" w x 95" h Flat Panel
21	95" h 90° Connector
22	30" w x 95" h Flat Panel w/ Slatwall
23	95" h 90° Connector
24	30" w x 95" h Flat Panel w/ Wood Core
25	30" w x 95" h Flat Panel w/ Wood Core
26	95" h 90° Connector
27	30" w x 95" h Flat Panel w/ Door
28	95" h 90° Connector

Steps:
 1) Connect tower panel [19] to [20] and continue in numerical order.

866.652.2100

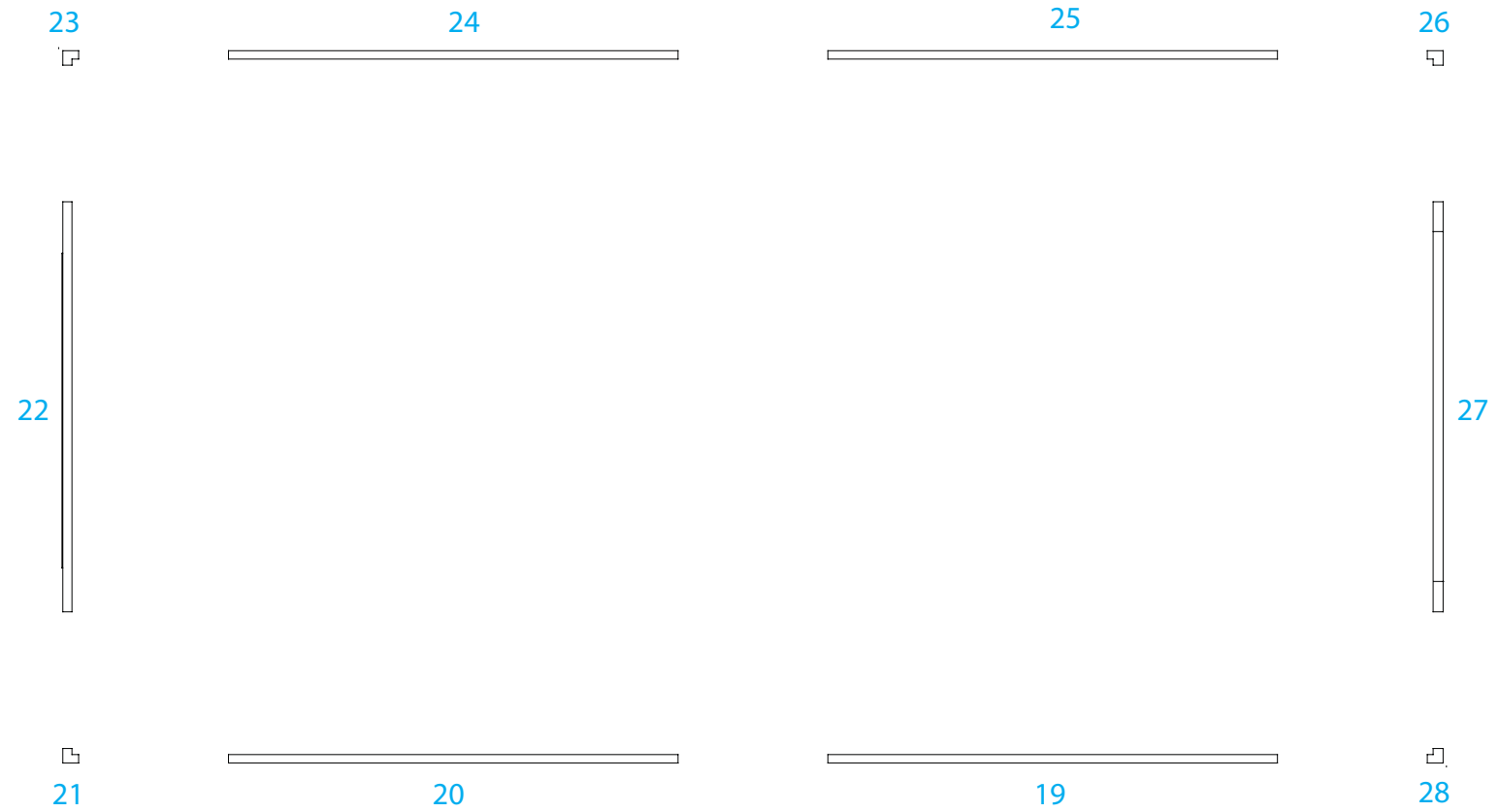
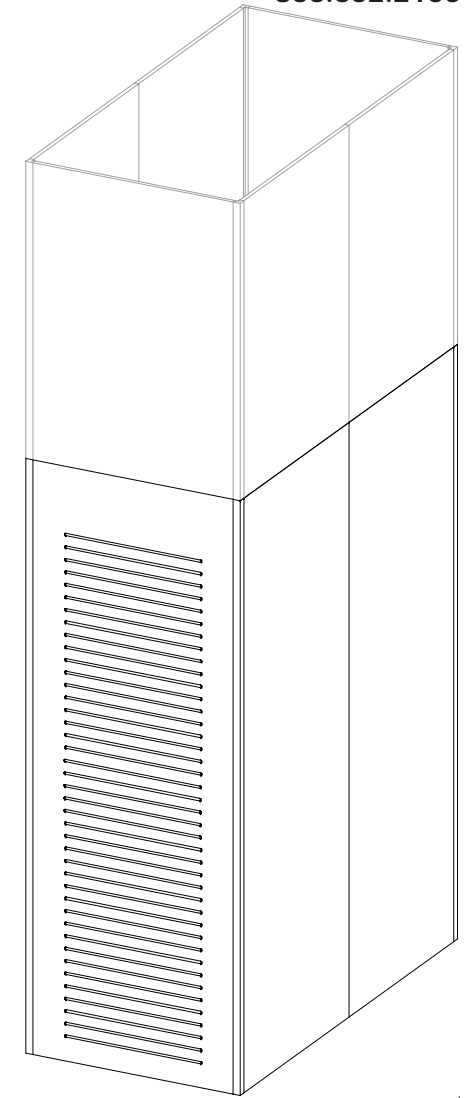

WHEN DISASSEMBLING ALUMINUM EXTRUSION, TIGHTEN ALL SETSCREWS AND LOCKS TO PREVENT LOSS DURING SHIPPING

866.652.2100

Item Number	Description
19	30" w x 47.5" h Flat Panel
20	30" w x 47.5" h Flat Panel
21	47.5" h 90° Connector
22	30" w x 47.5" h Flat Panel
23	47.5" h 90° Connector
24	30" w x 47.5" h Flat Panel
25	30" w x 47.5" h Flat Panel
26	47.5" h 90° Connector
27	30" w x 47.5" h Flat Panel
28	47.5" h 90° Connector

Steps:
 1) Connect panel [19] to [20] and continue in numerical order.

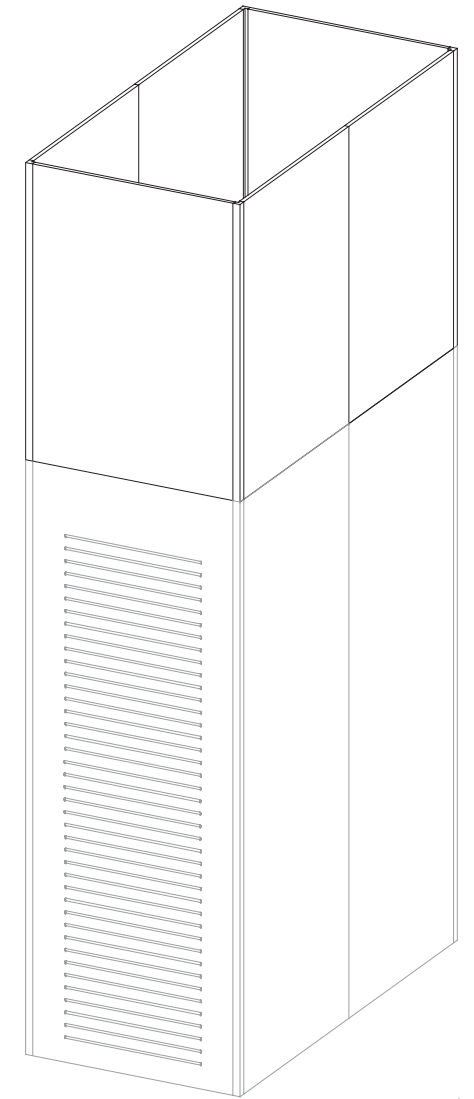
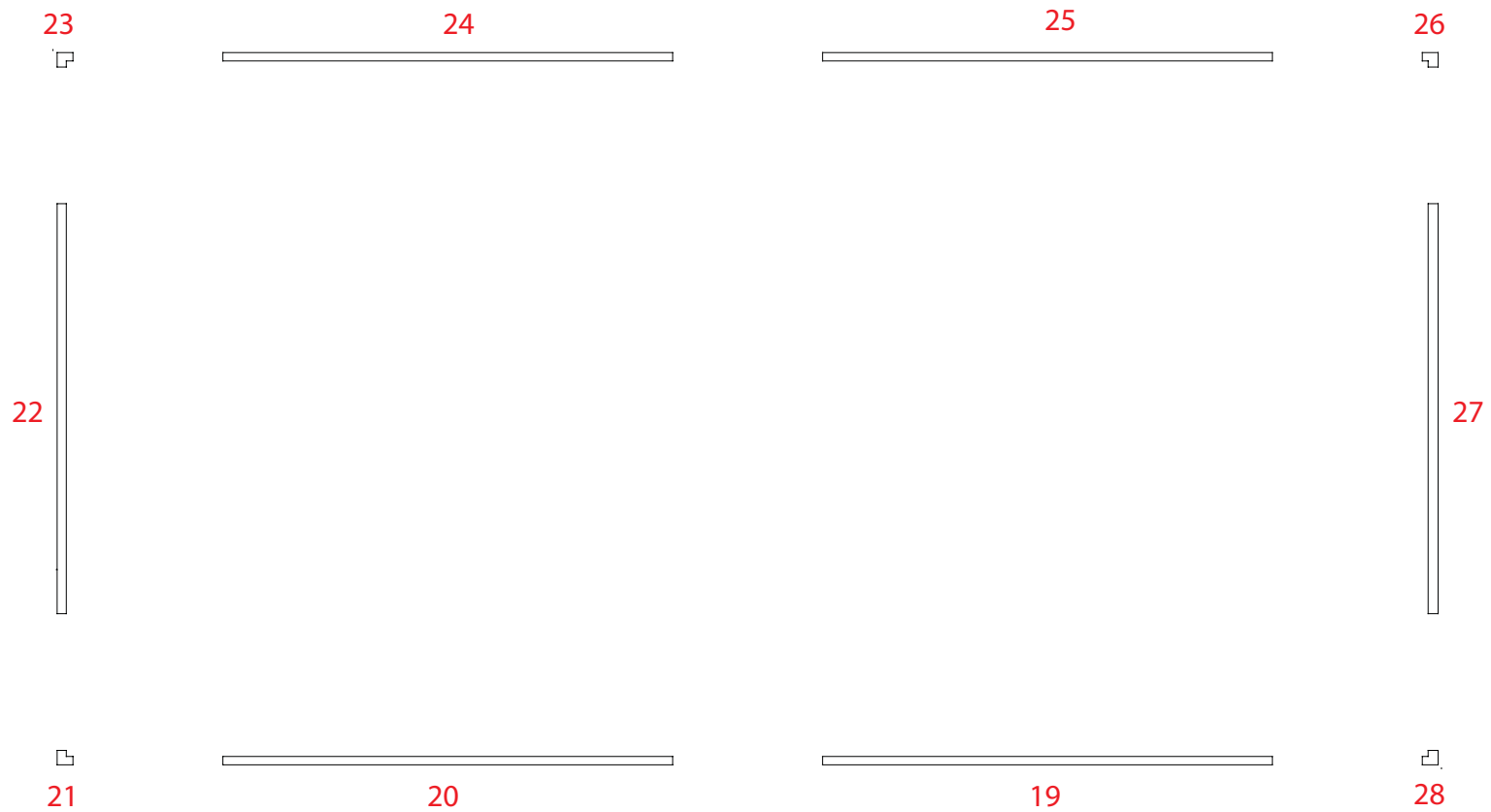

WHEN DISASSEMBLING ALUMINUM EXTRUSION, TIGHTEN ALL SETSCREWS AND LOCKS TO PREVENT LOSS DURING SHIPPING

866.652.2100

Item Number	Description
29	30"w x 38"h Flat Panel w/ Door
30	30"w x 38"h Flat Panel w/ Door
31	38"h 90° Connector
32	19"w x 38"h Flat Panel
33	38"h 90° Connector
34	30"w x 38"h Flat Panel
35	30"w x 38"h Flat Panel
36	38"h 90° Connector
37	19"w x 38"h Flat Panel
38	38"h 90° Connector

- Steps:
- 1) Connect pedestal panel [29] to [30] and continue in numerical order.
 - 2) Place counter top on assembled pedestal.

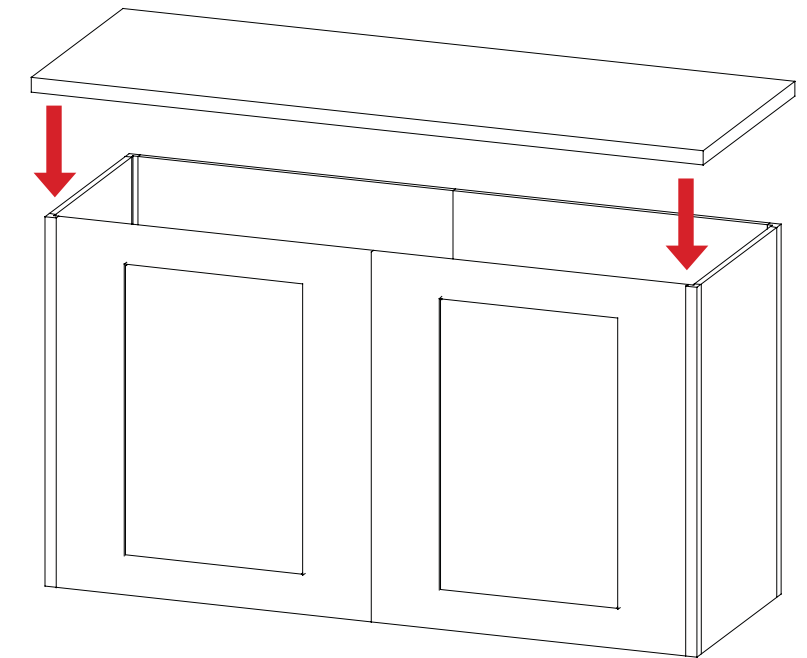
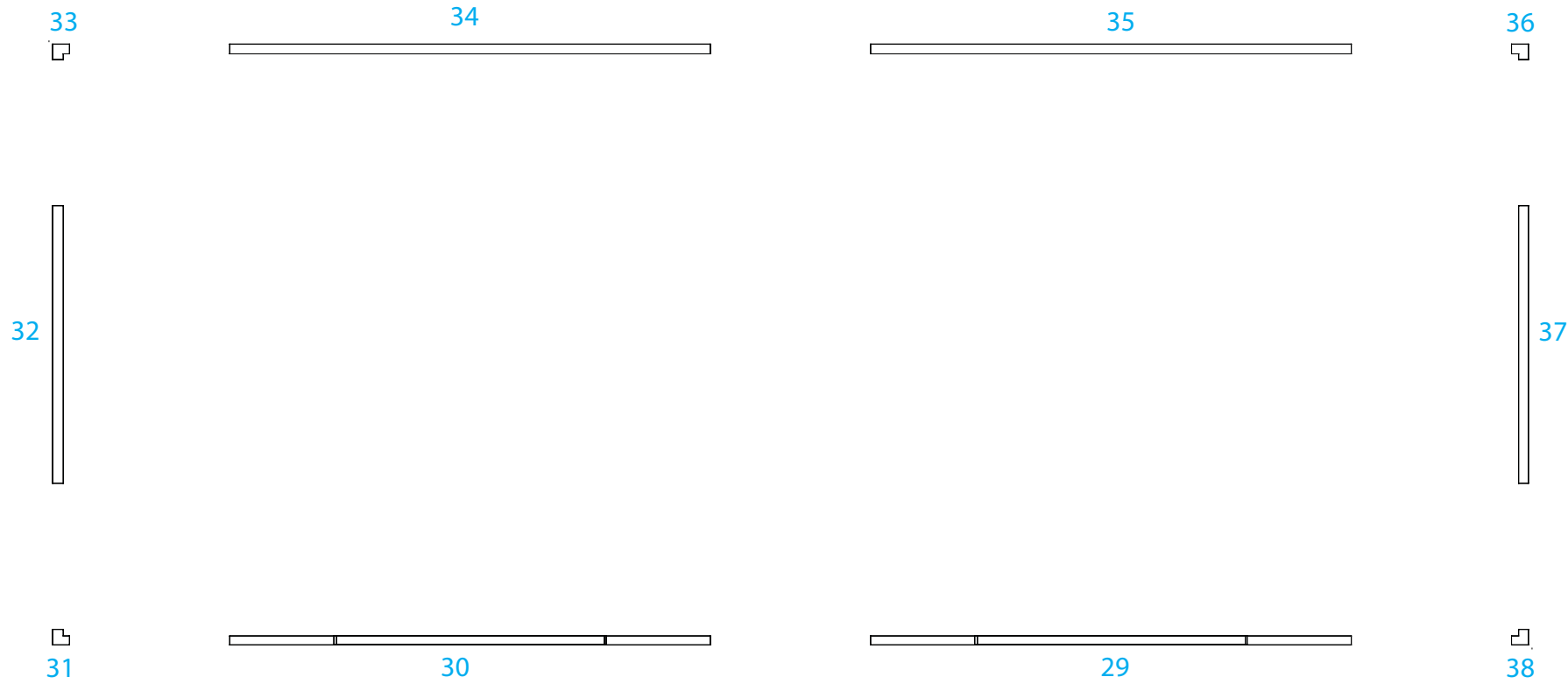
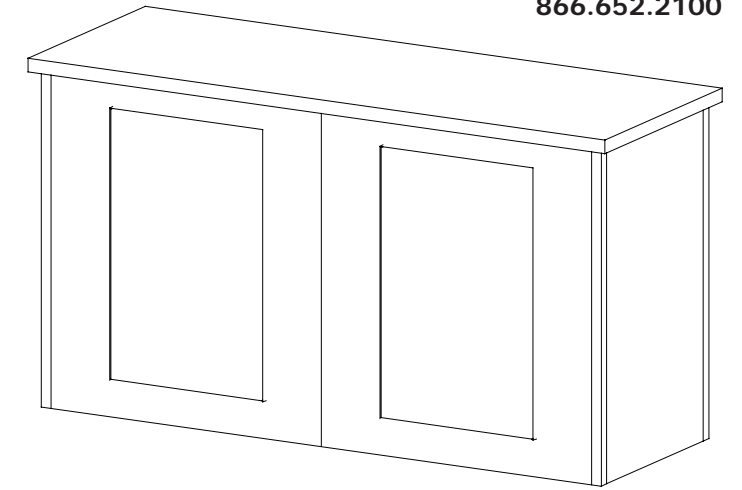

WHEN DISASSEMBLING ALUMINUM EXTRUSION, TIGHTEN ALL SETSCREWS AND LOCKS TO PREVENT LOSS DURING SHIPPING

866.652.2100

Item	Qty.	Description
3	1	38" h Vertical Extrusion w/ Hinges
4	1	38" h Vertical Extrusion
5	1	38" h Vertical Extrusion
6	1	38" h Vertical Extrusion w/ Hinges
7	1	34.418 Vertical Extrusion w/ Door Stopper
8	4	48" w Horizontal Extrusion
9	4	24" w Horizontal Extrusion

Steps:

- 1) Attach horizontal extrusions [8 and 9] between vertical extrusions [3, 4, 5 and 6].
- 2) Attach vertical extrusion [7] to horizontal extrusion [8], leave loose.
- 3) Attach doors as indicated, tightening vertical extrusion [7] in place.
- 4) Place inserts as shown.
- 5) Attach horizontal extrusions [8 and 9] between vertical extrusions [3, 4, 5 and 6] and atop inserts and doors as shown.
- 6) Velcro shelf supports to inside of assembled pedestal.
- 7) Place internal shelf atop shelf supports.
- 8) Set counter top on assembled pedestal.

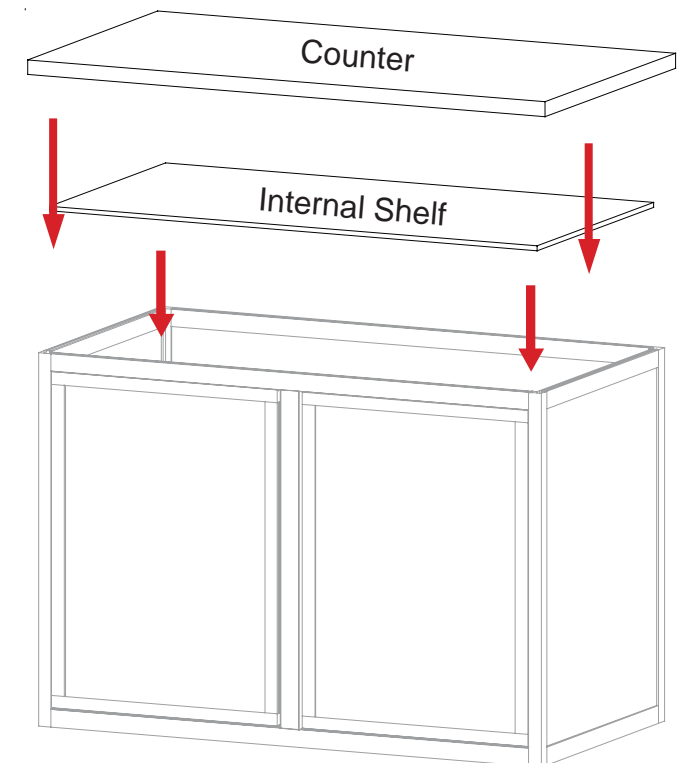
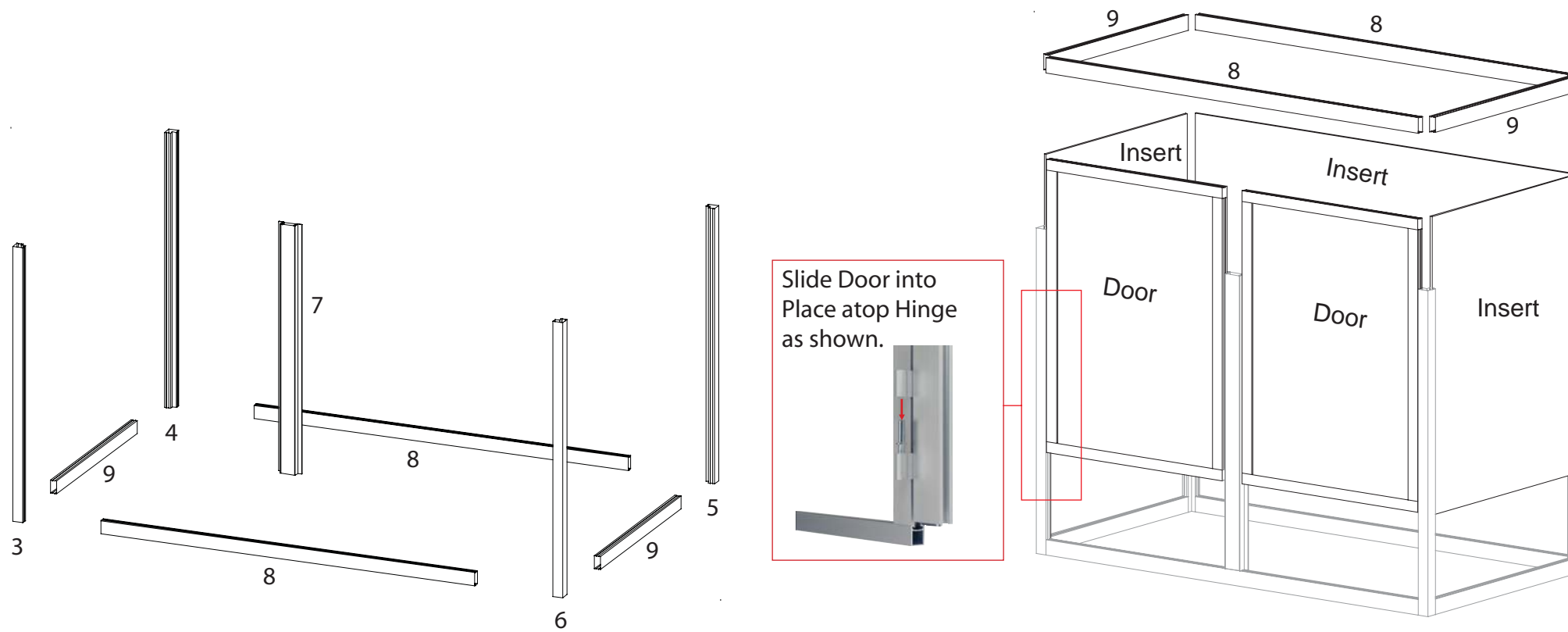
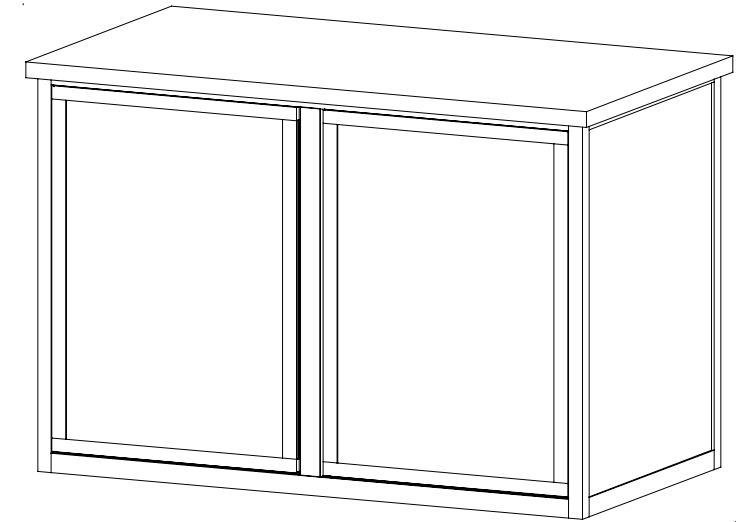

WHEN DISASSEMBLING ALUMINUM EXTRUSION, TIGHTEN ALL SETSCREWS AND LOCKS TO PREVENT LOSS DURING SHIPPING



Using Your Setup Instructions

The Aero Overhead Sign Setup Instructions are created specifically for your configuration. They include an exploded view of the frame which is sequentially numbered. We encourage you to study the instructions before attempting to assemble your exhibit.

Connections are kept very simple: no tools. Everything assembles with push-button connectors and pre-connected horizontal sections.

Cleaning and Packing Your Display

- 1) Use care when cleaning aluminum extrusion or acrylic inserts. Use only non-abrasive cleaners.
- 2) Retain all packing material. It will make re-packing much easier and will reduce the likelihood of shipping damage.

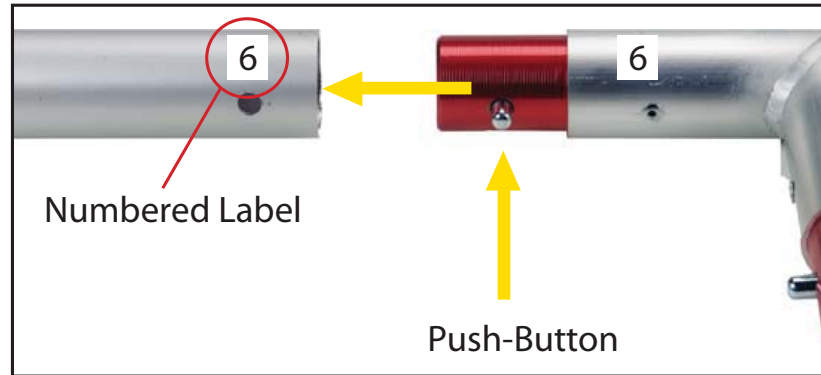
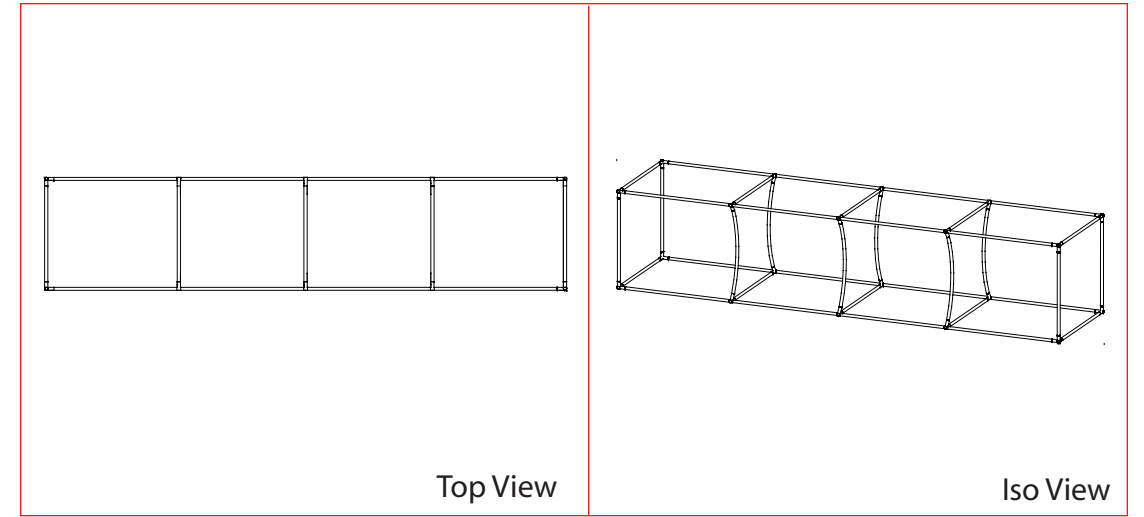

Connections are made by holding the button down and sliding the red tube into opposing tube until the connection is made. To disassemble push button and pull or twist extrusions apart.

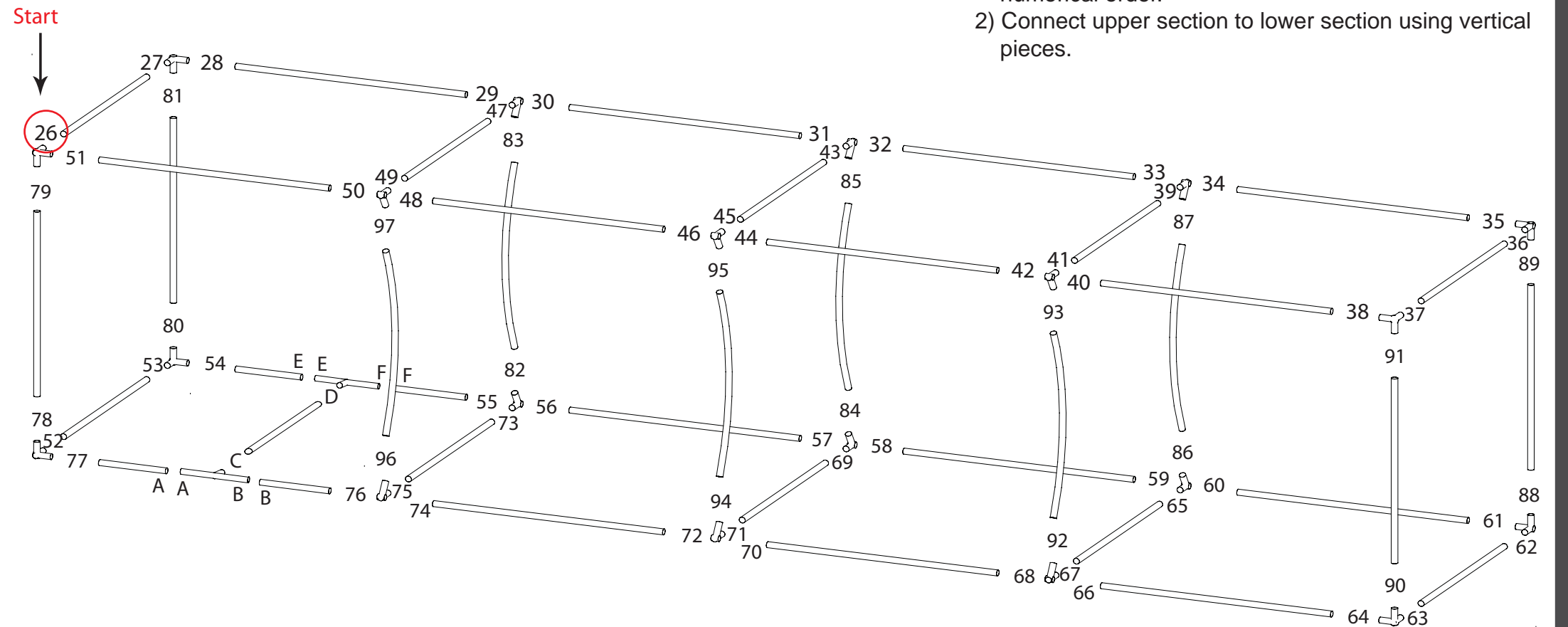
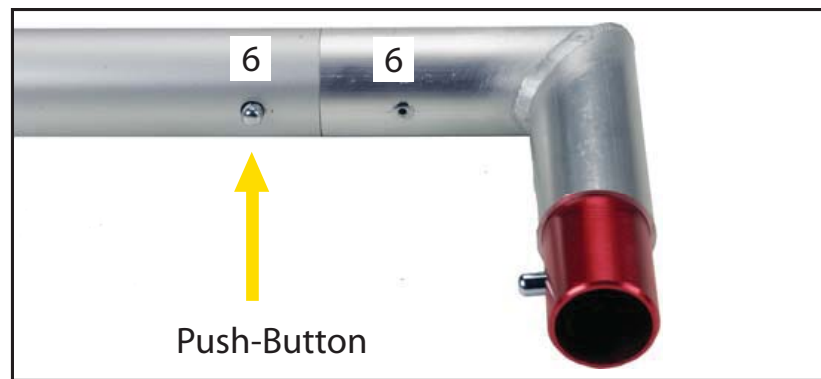

WHEN DISASSEMBLING ALUMINUM EXTRUSION, TIGHTEN ALL SETSCREWS AND LOCKS TO PREVENT LOSS DURING SHIPPING

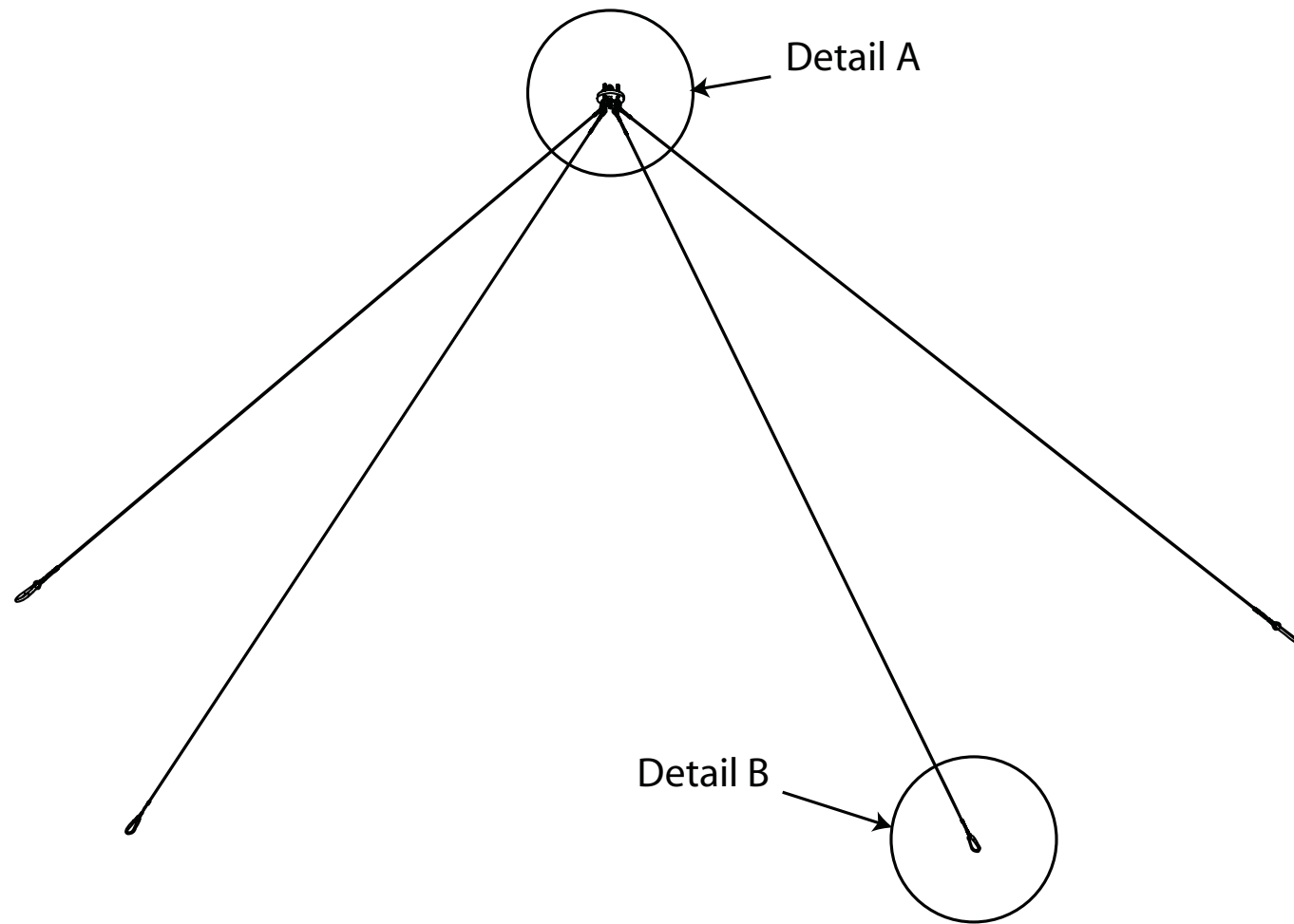

Construction consists of the following materials:

1. 302/304 (1/8") Stainless Steel Cable (Rated at 1760 lbs break strength)
2. Plated Spring-loaded Interlocking Snaps (Rated at 280 lbs working load)
3. Nicoperss Oval Sleeves (Holding strength rated at 900 lbs)
4. 0.25" x 4" Diameter T6061 Aluminum Plate
5. Eye Bolts (Rated 900 lbs on vertical lift and 450 lbs on 45 degree lift)

Harness Strength Calculation

Hanging sign weight is calculated based on weight of the structure and the weight of the fabric:

1. The weight of the structure material is 0.29 lbs per linear feet
2. The weight of the fabric is 0.04 lbs per sq. feet

Based on information above, one string of the harness at a standard 45 degree sling angle will accommodate 163 sq. feet surface measured sign. The vertical string will hold 233 sq. feet surface measured sign.

NOTE: If motor used for rotation, see motor specification.

<p style="text-align: center;">Harness Head Assembly</p>			<p style="text-align: center;">Harness Tail Assembly</p>		
MK	Qty	Desc	MK	Qty	Desc
10e	1	.313 Nylok Hex Nut	10c	2	.125 Copper Stop 520-20040
			10f	1	.313 Kidney Snap 434-24905
					Typical 4 Places

WHEN DISASSEMBLING ALUMINUM EXTRUSION, TIGHTEN ALL SETSCREWS AND LOCKS TO PREVENT LOSS DURING SHIPPING

866.652.2100



1st Level -
Is packed as shown below.



2nd Level -
Contains Shelf that sits atop metal extrusions to support Tension Fabric Frame Boxes.

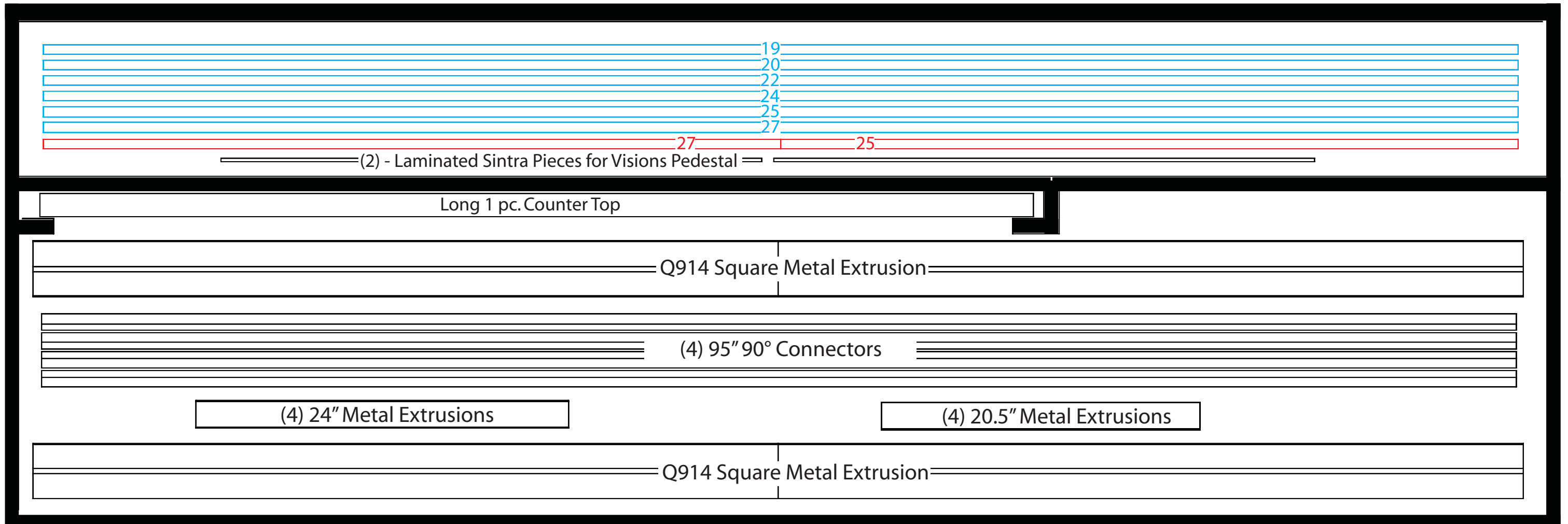

Top Loading Crate (Top View of 1st Level)

WHEN DISASSEMBLING ALUMINUM EXTRUSION, TIGHTEN ALL SETSCREWS AND LOCKS TO PREVENT LOSS DURING SHIPPING

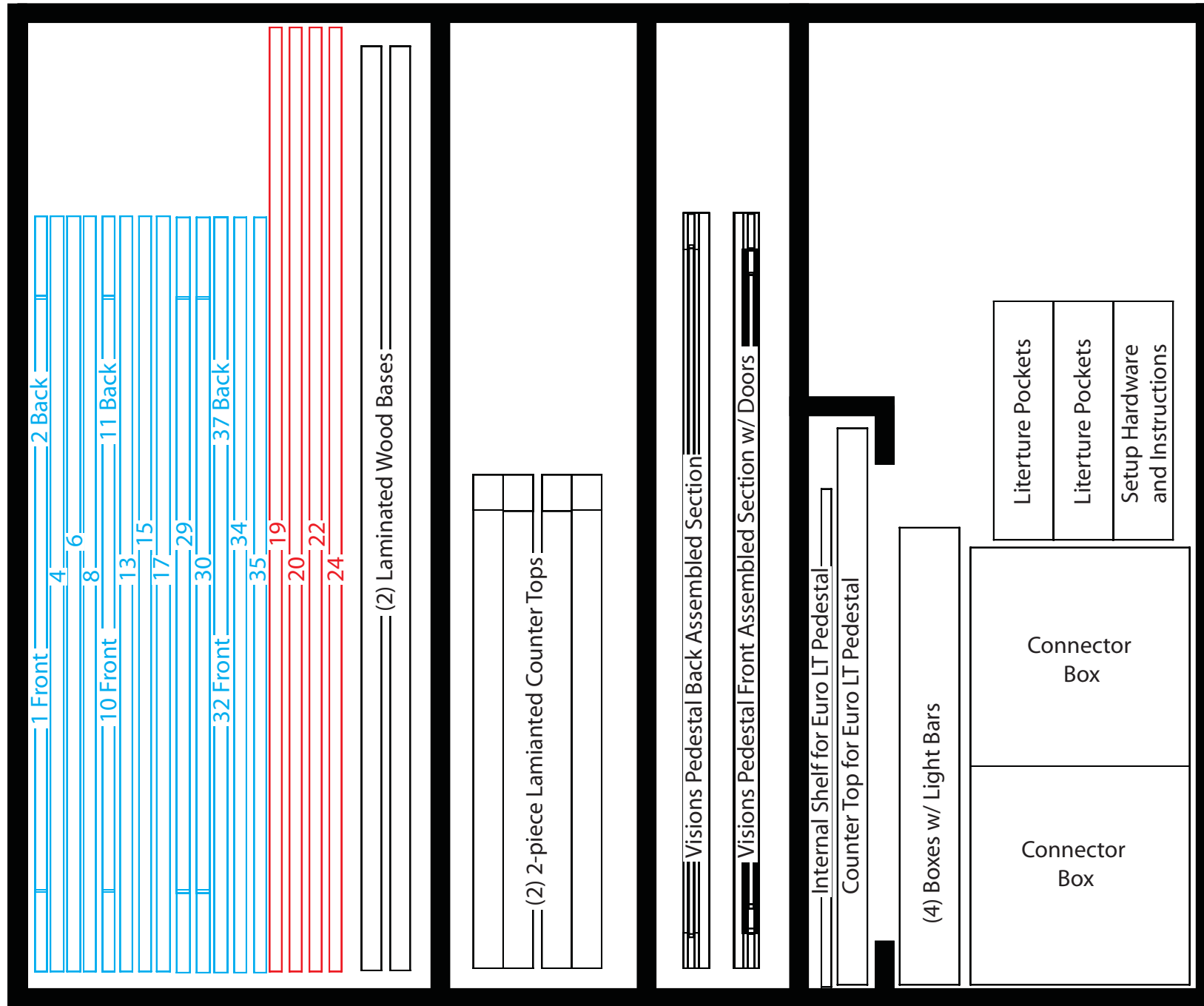

Front Loading Crate (Front View)

Front View



WHEN DISASSEMBLING ALUMINUM EXTRUSION, TIGHTEN ALL SETSCREWS AND LOCKS TO PREVENT LOSS DURING SHIPPING

NOTE :

PDF copies of your Setup Instructions are available @ classicexhibits.com
See the search tool on the lower left hand corner of the Home page.

Enter the 5 digit Order #. Search for Setup Instructions

WHEN DISASSEMBLING ALUMINUM EXTRUSION, TIGHTEN ALL
SETSCREWS AND LOCKS TO PREVENT LOSS DURING SHIPPING