

WHEN DISASSEMBLING ALUMINUM EXTRUSION, TIGHTEN ALL SETSCREWS AND LOCKS TO PREVENT LOSS DURING SHIPPING

visionary™ IDESIGNS

Using Your Setup Instructions

The Visionary Designs Setup Instructions are created specifically for your configuration. They are laid out sequentially, including an exploded view of the entire display, and then a logical series of detailed steps to assemble the main structure and components. We encourage you to study the instructions **before** attempting to assemble your exhibit.

Each page reminds you to tighten the setscrews after disassembling your exhibit to prevent loss of the locks and setscrews (see below in RED). This is **VERY IMPORTANT**.

Cleaning and Packing Your Display

- 1) Use care when cleaning aluminum extrusion or acrylic inserts. Use only non-abrasive cleaners.
- 2) When cleaning laminate inserts or countertops, use mild cleansers and a soft material such as cotton.
- 3) Keep all display components away from extreme heat and long exposure to sunlight to avoid warping and fading.
- 4) Retain all packing material. It will make re-packing much easier and will reduce the likelihood of shipping damage.



The Tool

Most Visionary Designs exhibits can be assembled with the supplied Hex Key Tool. Occasionally, a flat head screwdriver may be required.

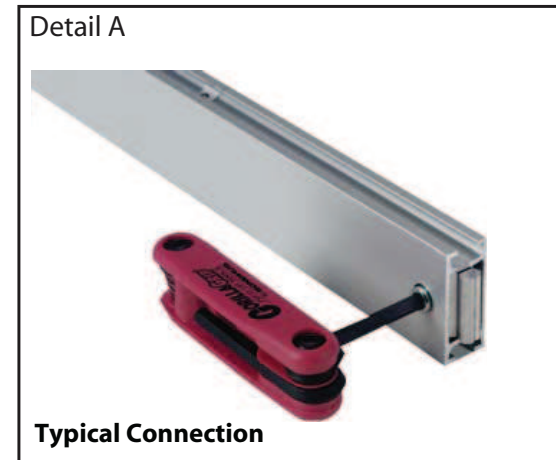

Typical Connection

Most horizontal extrusion connections have a patented expandable lock. This lock inserts into the groove of an opposing extrusion. Tightening the lock with the Hex Key Tool expands the lock and creates a strong positive connection.



Typical Connection (cont'd)

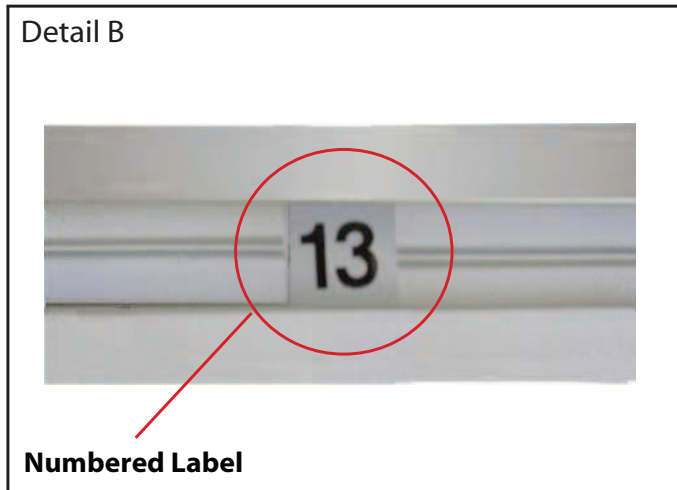

Detail B

Numbered Label

Each extrusion contains a numbered label which corresponds with setup instructions. The label is located within a groove of the extrusion (when possible). With Visionary Designs the labels contain Black numbers unless otherwise specified.



Detail C

Horizontal Inline Connection (remove only one setscrew)

Remove only (1) setscrew when disassembling. Replace setscrew in extrusion after assembling it. Before packing, replace setscrew in extrusion to avoid losing it.

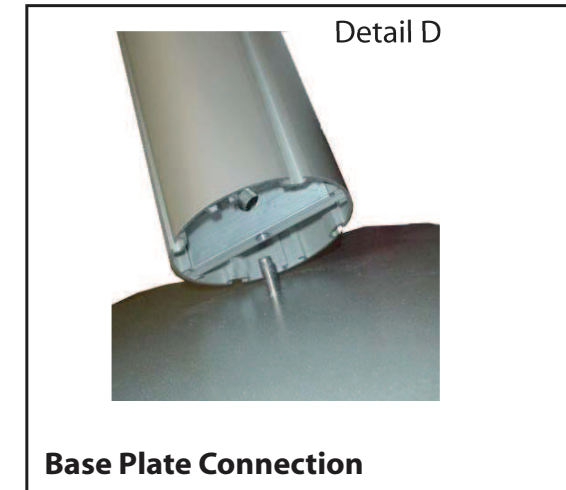

Detail D

Base Plate Connection

Attach base plate to round or square vertical extrusion using the bolt provided. Be careful not to strip the threads.

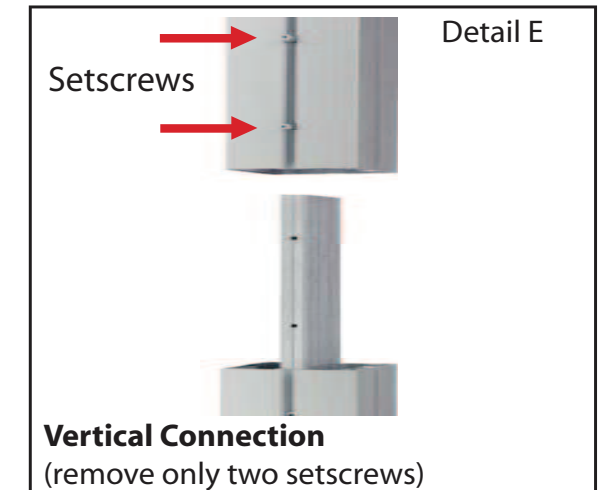

Detail E

Vertical Connection
(remove only two setscrews)

When vertical extrusions are packed in portable cases rather than crates or tubs, they must be broken down into smaller sections which then require assembly.

Remove only (2) setscrews when disassembling. Replace setscrews in extrusion after assembling it. Before packing, replace setscrews in extrusion to avoid losing them.

WHEN DISASSEMBLING ALUMINUM EXTRUSION, TIGHTEN ALL SETSCREWS AND LOCKS TO PREVENT LOSS DURING SHIPPING

866.652.2100

Item	Quantity	Description
1	2	Oval Base Plates
2	2	42" Square Vertical Extrusion
3	2	42" Square Vertical Extrusion
4	1	20.115" Tapered Horizontal Extrusion
5	1	20.115" Tapered Horizontal Extrusion
6	1	7.322" Horizontal Extrusion
7	1	7.322" Horizontal Extrusion
8	1	47.1923" Curved Extrusion w/ Attached Velcro to Back of Extrusion
9	1	47.1923" Curved Extrusion w/ Attached Velcro to Back of Extrusion
10	1	47.1923" Curved Extrusion w/ Attached Velcro to Back of Extrusion
11	1	47.1923" Curved Extrusion w/ Attached Velcro to Back of Extrusion
12	1	47.1923" Curved Extrusion w/ Attached Velcro to Back of Extrusion
13	1	47.1923" Curved Extrusion w/ Attached Velcro to Back of Extrusion
14	1	20.115" Tapered Horizontal Extrusion
15	1	20.115" Tapered Horizontal Extrusion

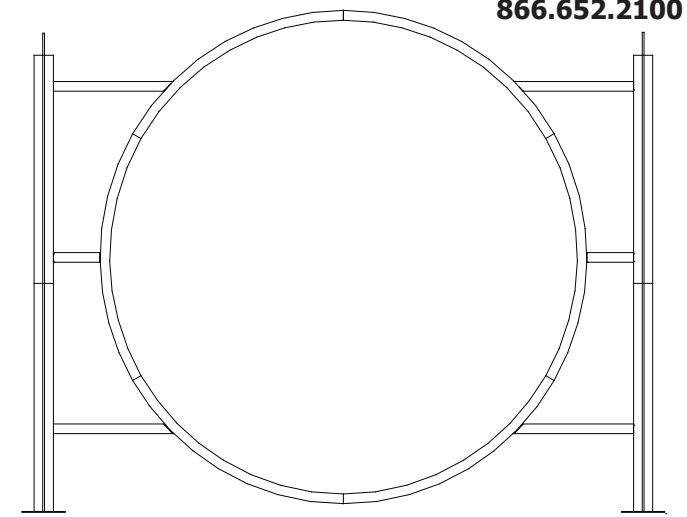
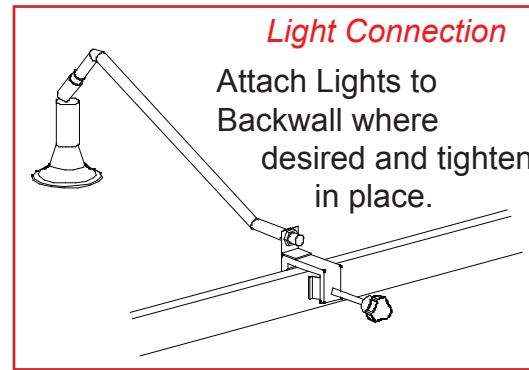

Steps:

- 1) Attach oval base plates [1] to lower vertical extrusions [2].
- 2) Attach upper vertical extrusions [3] atop of vertical extrusions [2].
- 3) Attach tapered horizontal extrusions [4 and 5] to vertical extrusions [2].
- 4) Attach horizontal extrusions [6 and 7] to vertical extrusions [3], placing inserts between horizontal extrusions [4&6 and 5&7].
- 5) Assemble curved extrusion [8 and 9] together.
- 6) Attach each side of assembled curved extrusion to horizontal extrusions [4 and 5].
- 7) Attach curved extrusion [10] to top of curved extrusion [8] and to horizontal extrusion [6].
- 8) Attach curved extrusion [11] to top of curved extrusion [9] and to horizontal extrusion [7].
- 9) Attach curved extrusion [12] to top of curved extrusion [10].
- 10) Attach curved extrusion [13] between curved extrusions [11 and 12].
- 11) Place insert between vertical extrusions [3 and 10], then set tapered horizontal extrusion [14] atop insert and attach between vertical extrusion [3] and curved extrusion [12].
- 12) Place insert between vertical extrusions [3 and 11], then set tapered horizontal extrusion [15] atop insert and attach between vertical extrusion [3] and curved extrusion [11].
- 13) Attach graphic to Velcro on backside.

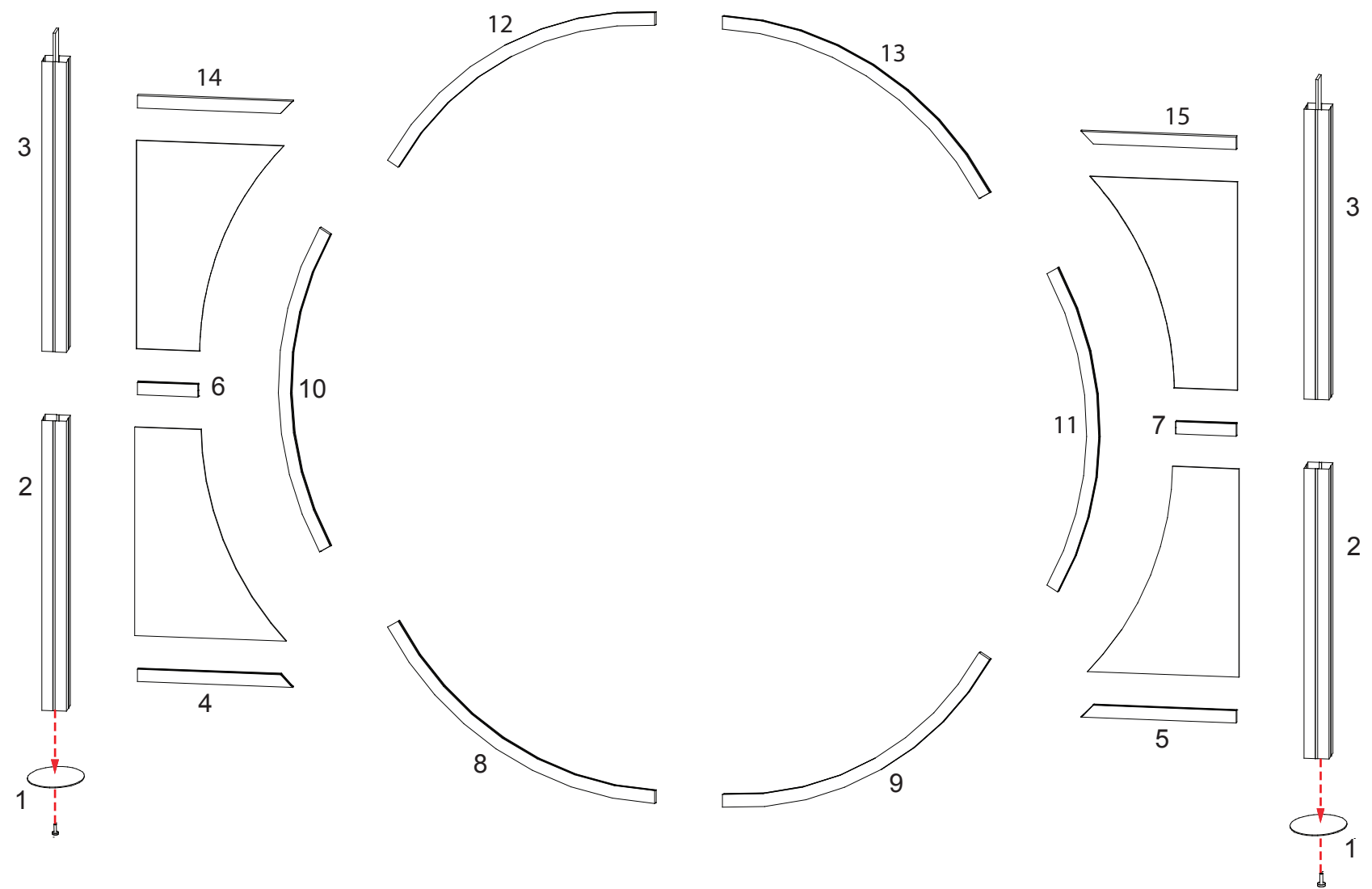

WHEN DISASSEMBLING ALUMINUM EXTRUSION, TIGHTEN ALL SETSCREWS AND LOCKS TO PREVENT LOSS DURING SHIPPING

Item	Quantity	Description
A	1	39" Round formed extrusion
AB	1	39" Round formed extrusion
B	1	39" Round fomred extrusion
C	1	39" Round formed extrusion
CD	1	39" Round formed extrusion
D	1	39" Round formed extrusion
E	2	14" Round extrusion
F	1	14" Round extrusion

Steps:

- 1) Connect 39" (A) round formed extrusion to 39" (A) round formed extrusion.
- 2) Connect 39" (B) round formed extrusion to 39" (B) round formed extrusion.
- 3) Connect 39" (C) round formed extrusion to 39" (C) round formed extrusion.
- 4) Connect 39" (D) round formed extrusion to 39" (D) round formed extrusion.
- 5) Connect (A) round formed extrusion and (D) round formed extrusion to 14" (E) extrusion.
- 6) Connect (B) round formed extrusion and (C) round formed extrusion to 14" (E) extrusion.
- 7) Connect (AB) round formed extrusion and (CD) round formed extrusion to 14" (F) extrusion.
- 8) Attach Canopy Assembly to Vertical extrusions with Canopy attachments.

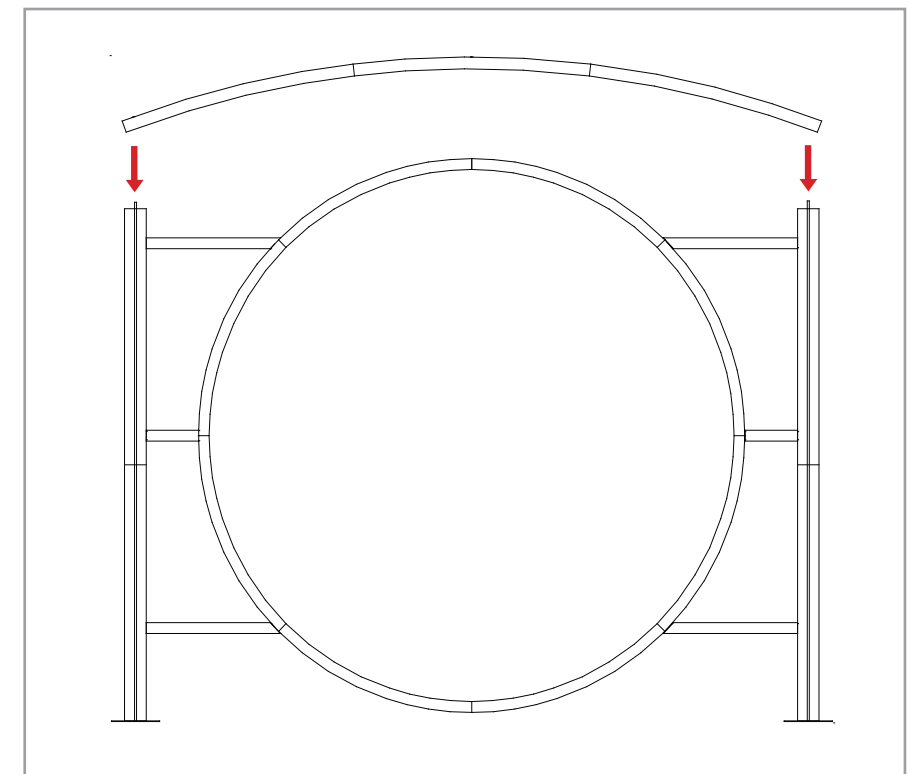
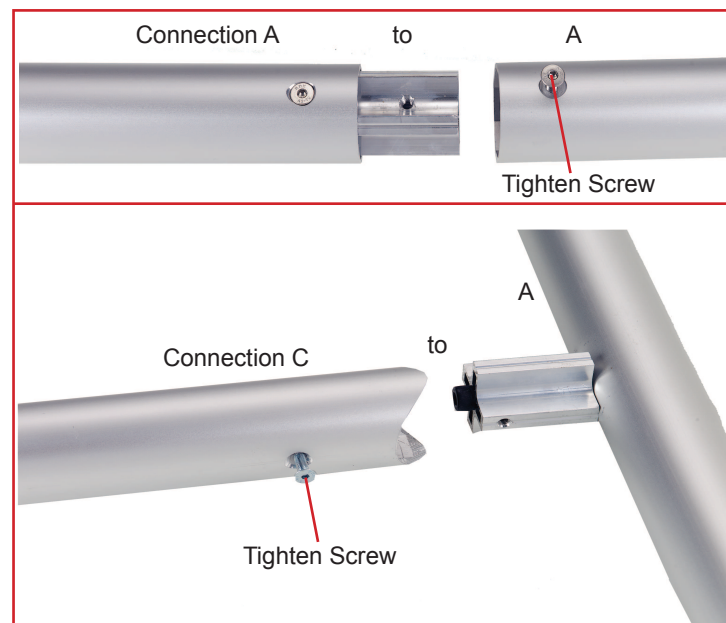
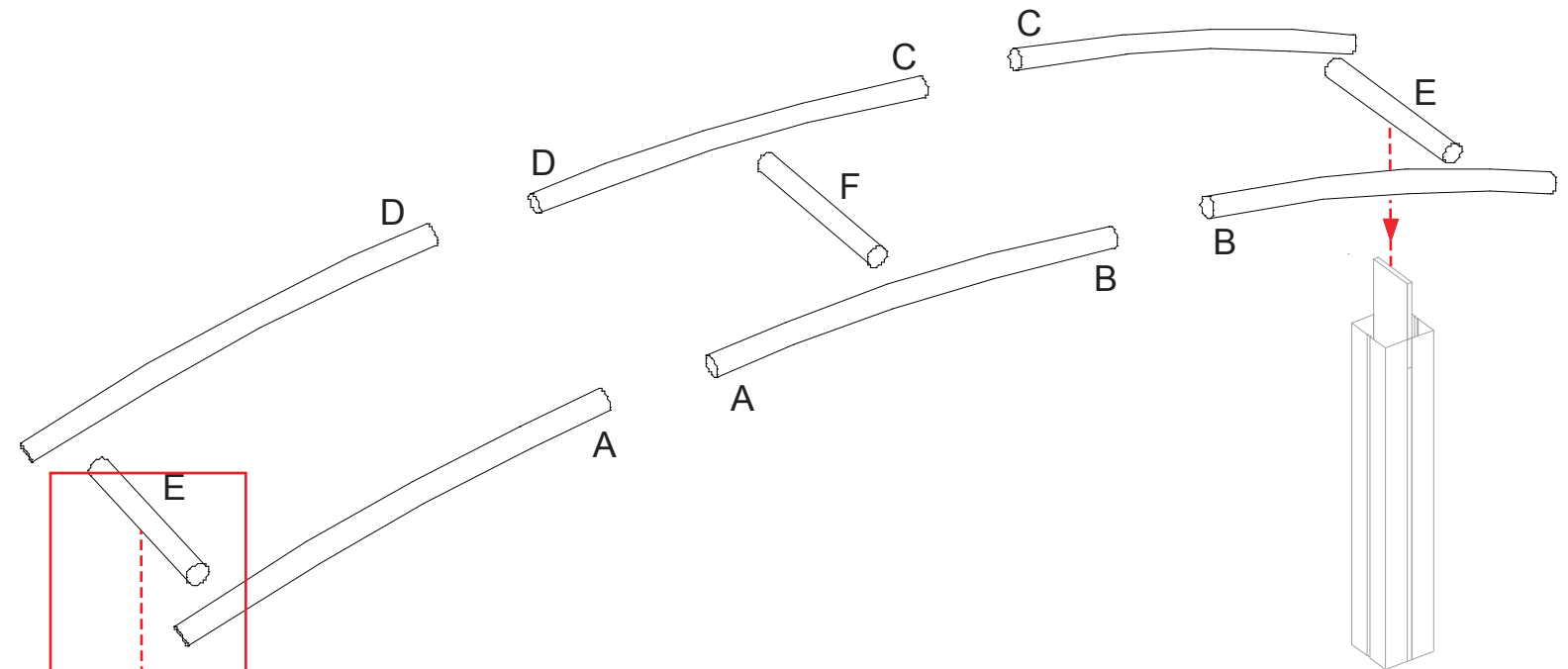

WHEN DISASSEMBLING ALUMINUM EXTRUSION, TIGHTEN ALL SETSCREWS AND LOCKS TO PREVENT LOSS DURING SHIPPING

866.652.2100

Item Number	Description
1	23"w x 38"h Custom Flat Panel
1A	11"w x 38"h Flat Panel
3	11"w x 9.5"h Flat Panel
5	23"w x 38"h Custom Flat Panel
5A	11"w x 38"h Flat Panel w/ Door
6	38"h 90° Corner Connector
7	11"w 38"h Flat Panel
8	38"h 90° Corner Connector
9	Custom Curved Panel

Item Number	Description
10	23"w x 38"h Custom Flat Panel
10A	11"w x 38"h Flat Panel
11	38"h 90° Corner Connector
12	11"w x 38"h Flat Panel
13	38"h 90° Corner Connector
14	23"w x 38"h Custom Flat Panel
14A	11"w 38"h Flat Panel w/ Door
16	11"w x 9.5"h Flat Panel
18	Custom Curved Panel

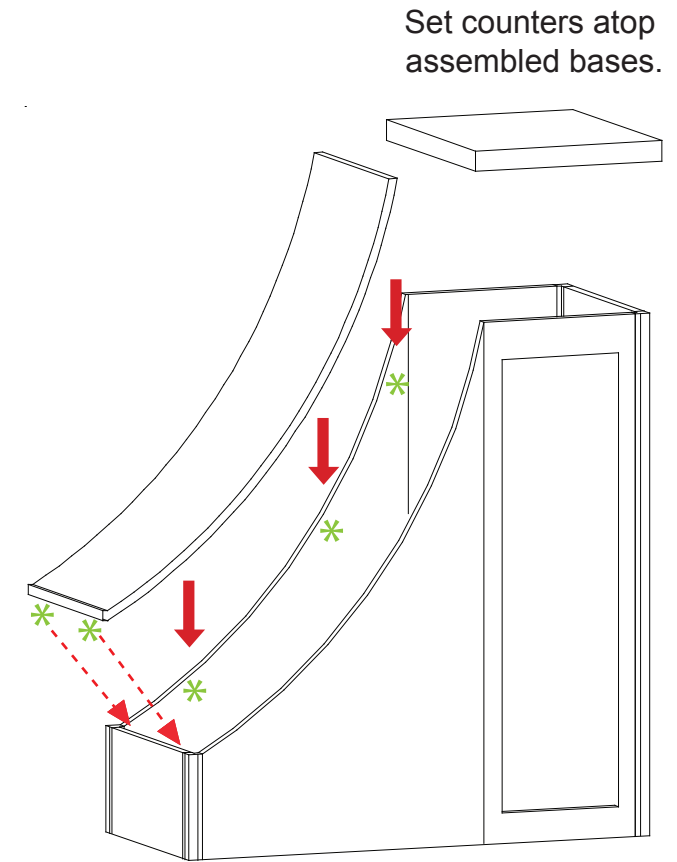
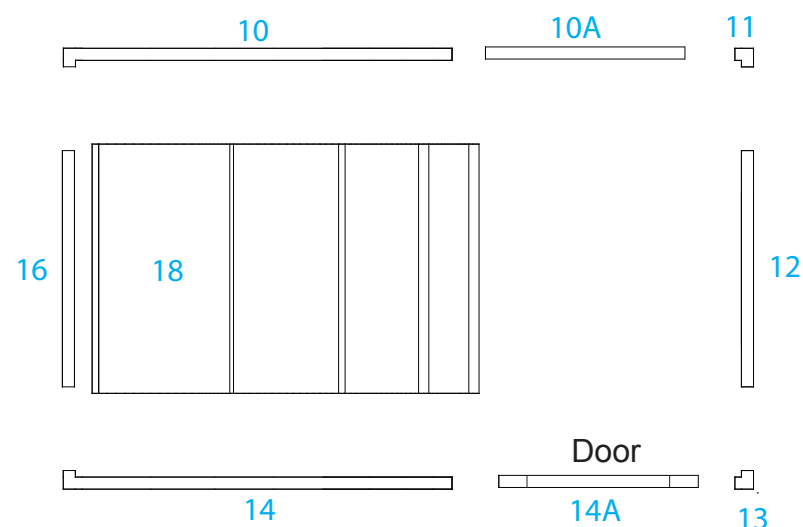
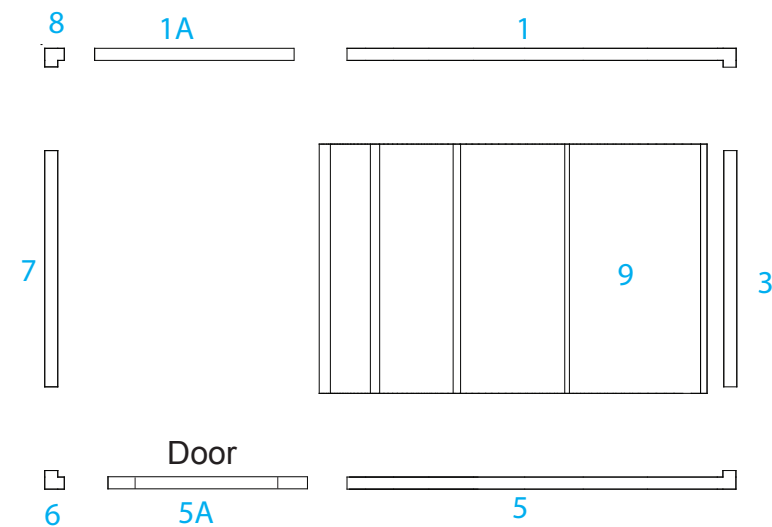
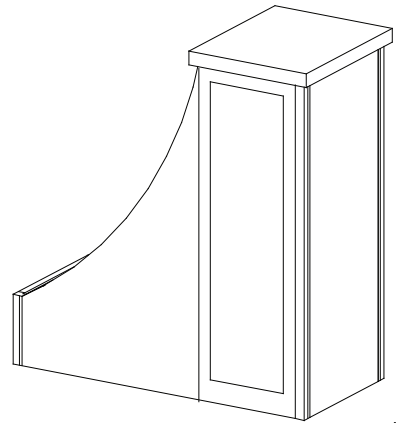
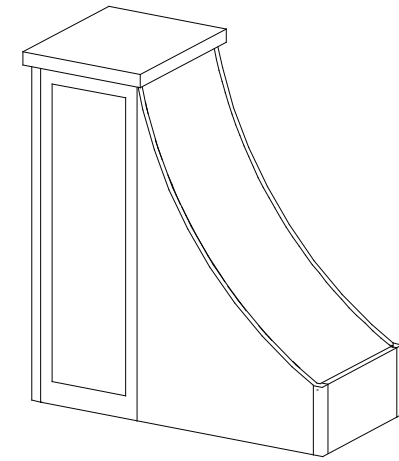

Place pins on lower end of curve panels [9 and 18] into groove of small panel and atop pins located inside panels.

* = Pin Location

WHEN DISASSEMBLING ALUMINUM EXTRUSION, TIGHTEN ALL SETSCREWS AND LOCKS TO PREVENT LOSS DURING SHIPPING

866.652.2100

Item	Qty.	Description
16	1	Base Plate
17	1	35.25"h Curved Vertical Extrusion w/ Attached Pins
18	1	35"h Round Vertical Extrusion

Steps:

- 1) Attach round vertical extrusion [18] to base plate [16], see DetailD on General Information Page.
- 2) Slide large counter on vertical extrusion [18] and slide curved vertical extrusion [17] thru counter hole from bottom and attach to base plate [16].
- 4) Secure large counter to vertical extrusion [18] with thumbscrews.
- 5) Set small counter atop vertical extrusion [17], and secure with thumbscrews to vertical extrusion [18].

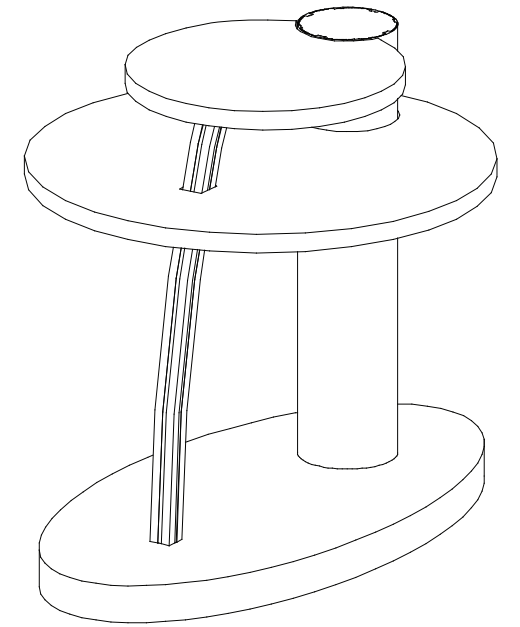
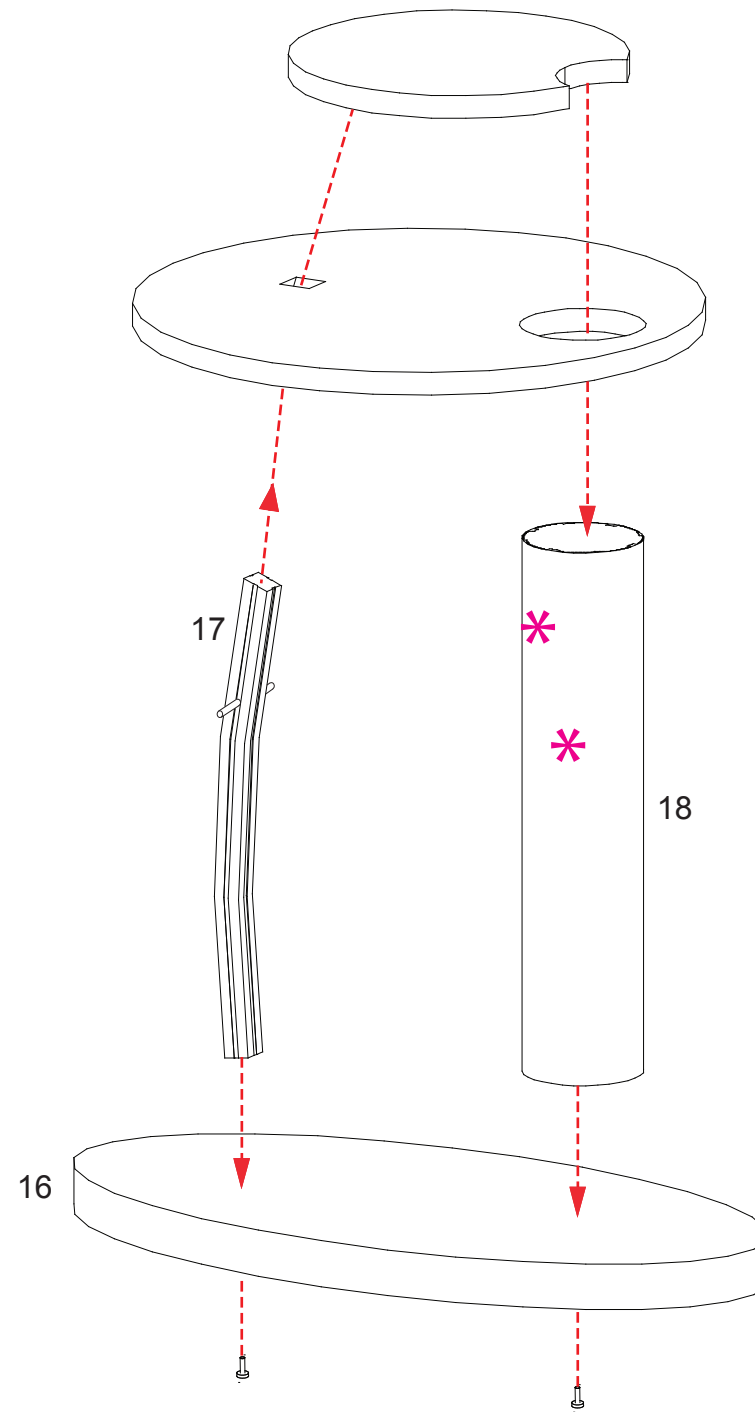

* = Thumbscrew Location

WHEN DISASSEMBLING ALUMINUM EXTRUSION, TIGHTEN ALL SETSCREWS AND LOCKS TO PREVENT LOSS DURING SHIPPING

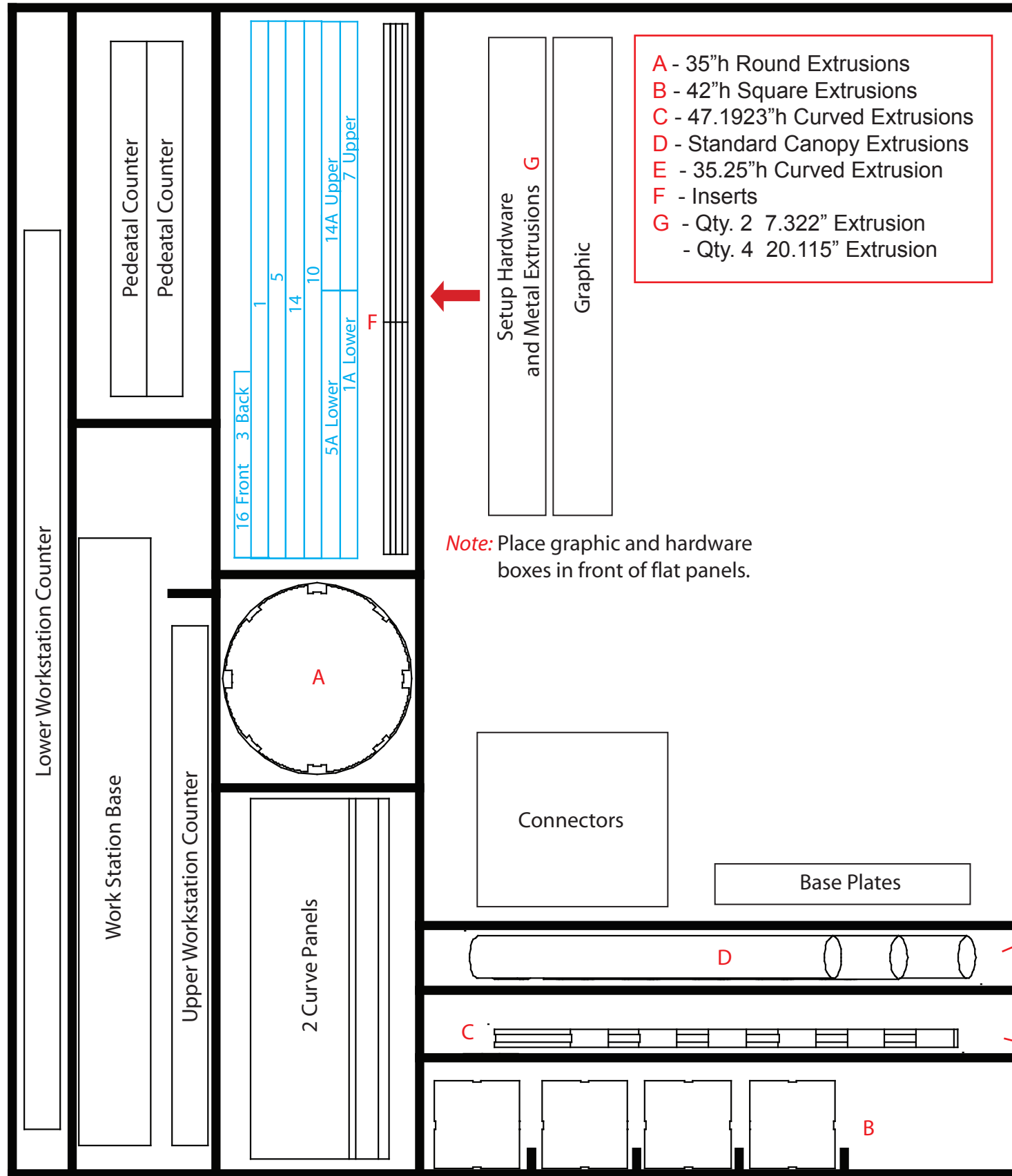

- A - 35" h Round Extrusions
- B - 42" h Square Extrusions
- C - 47.1923" h Curved Extrusions
- D - Standard Canopy Extrusions
- E - 35.25" h Curved Extrusion
- F - Inserts
- G - Qty. 2 7.322" Extrusion
- Qty. 4 20.115" Extrusion

Note: Place graphic and hardware boxes in front of flat panels.



Tub Front View

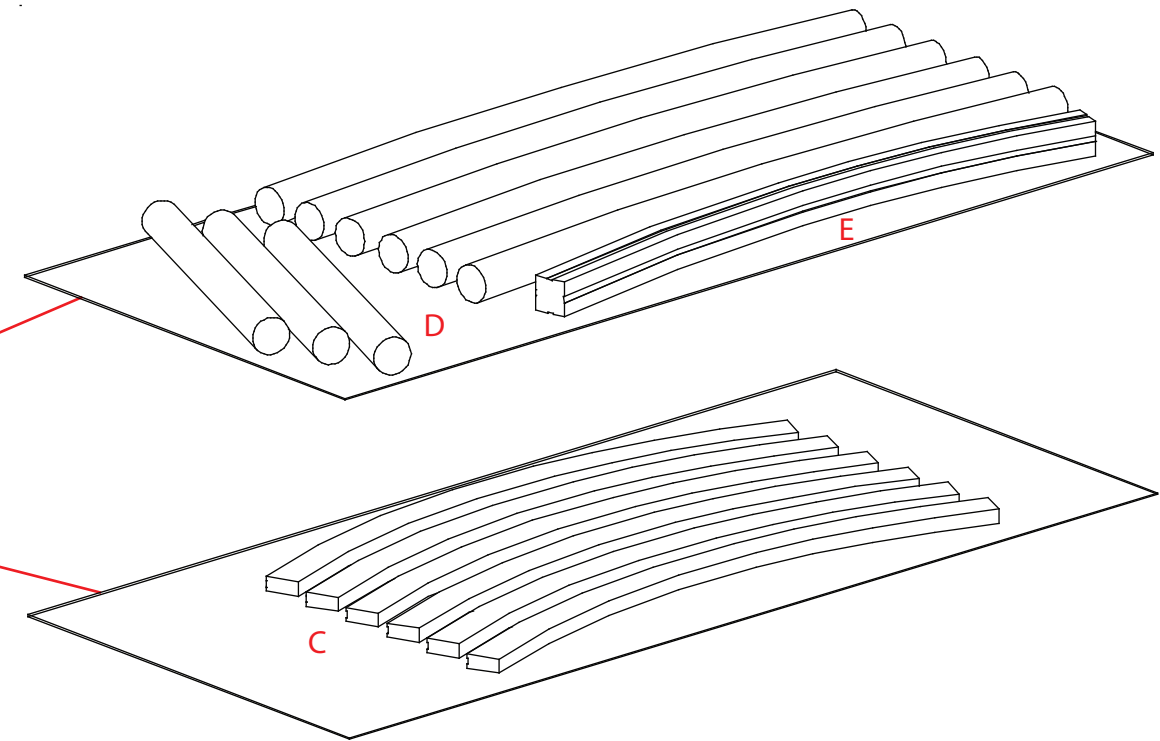

WHEN DISASSEMBLING ALUMINUM EXTRUSION, TIGHTEN ALL SETSCREWS AND LOCKS TO PREVENT LOSS DURING SHIPPING

NOTE :

PDF copies of your Setup Instructions are available @ classicexhibits.com
See the search tool on the lower left hand corner of the Home page.

Enter the 5 digit Order #.

Search for Setup Instructions

WHEN DISASSEMBLING ALUMINUM EXTRUSION, TIGHTEN ALL
SETSCREWS AND LOCKS TO PREVENT LOSS DURING SHIPPING