

WHEN DISASSEMBLING ALUMINUM EXTRUSION, TIGHTEN ALL SETSCREWS AND LOCKS TO PREVENT LOSS DURING SHIPPING

visionary™ IDESIGNS

Using Your Setup Instructions

The Visionary Designs Setup Instructions are created specifically for your configuration. They are laid out sequentially, including an exploded view of the entire display, and then a logical series of detailed steps to assemble the main structure and components. We encourage you to study the instructions **before** attempting to assemble your exhibit.

Each page reminds you to tighten the setscrews after disassembling your exhibit to prevent loss of the locks and setscrews (see below in RED). This is **VERY IMPORTANT**.

Cleaning and Packing Your Display

- 1) Use care when cleaning aluminum extrusion or acrylic inserts. Use only non-abrasive cleaners.
- 2) When cleaning laminate inserts or countertops, use mild cleansers and a soft material such as cotton.
- 3) Keep all display components away from extreme heat and long exposure to sunlight to avoid warping and fading.
- 4) Retain all packing material. It will make re-packing much easier and will reduce the likelihood of shipping damage.



The Tool

Most Visionary Designs exhibits can be assembled with the supplied Hex Key Tool. Occasionally, a flat head screwdriver may be required.



Typical Connection

Most horizontal extrusion connections have a patented expandable lock. This lock inserts into the groove of an opposing extrusion. Tightening the lock with the Hex Key Tool expands the lock and creates a strong positive connection.



Typical Connection (cont'd)

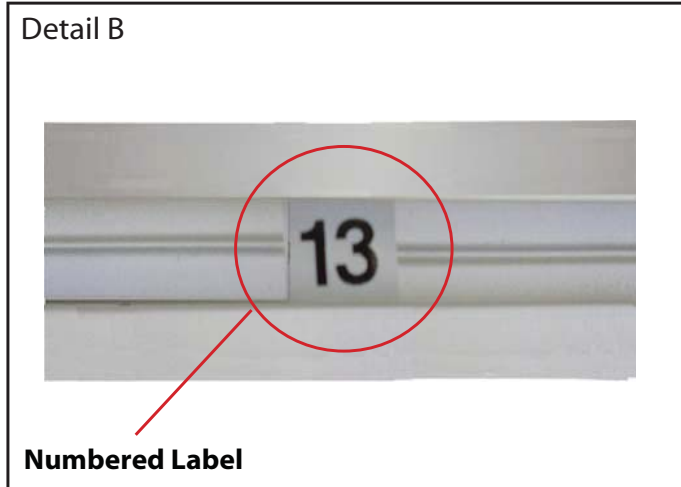

Detail B

Numbered Label

Each extrusion contains a numbered label which corresponds with setup instructions. The label is located within a groove of the extrusion (when possible). With Visionary Designs the labels contain Black numbers unless otherwise specified.



Detail C

Horizontal Inline Connection (remove only one setscrew)

Remove only (1) setscrew when disassembling. Replace setscrew in extrusion after assembling it. Before packing, replace setscrew in extrusion to avoid losing it.

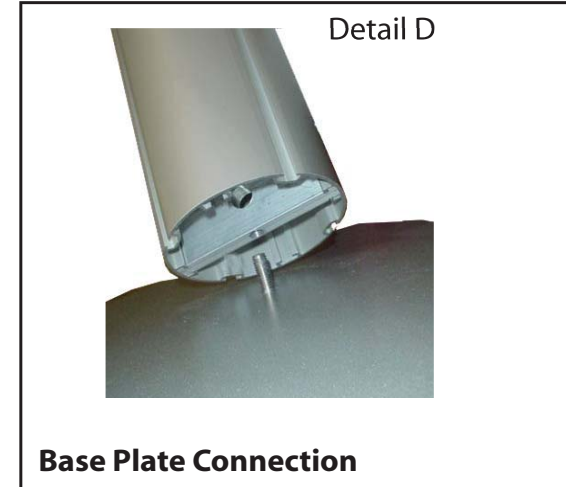

Detail D

Base Plate Connection

Attach base plate to round or square vertical extrusion using the bolt provided. Be careful not to strip the threads.

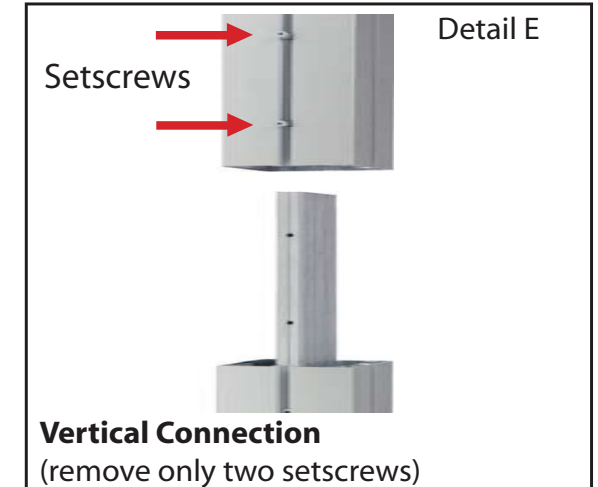

Detail E

Vertical Connection
(remove only two setscrews)

When vertical extrusions are packed in portable cases rather than crates or tubs, they must be broken down into smaller sections which then require assembly.

Remove only (2) setscrews when disassembling. Replace setscrews in extrusion after assembling it. Before packing, replace setscrews in extrusion to avoid losing them.

WHEN DISASSEMBLING ALUMINUM EXTRUSION, TIGHTEN ALL SETSCREWS AND LOCKS TO PREVENT LOSS DURING SHIPPING

Item	Quantity	Description
1	2	96"h Vertical Extrusion
2	1	96"h Vertical Extrusion
2a	1	96"h Vertical Extrusion w/Attached Connector
3	1	96"h Vertical Extrusion
4a	1	55.5146"w Curved Horizontal Extrusion
4b	1	55.5146"w Curved Horizontal Extrusion
5a	1	55.5146"w Curved Horizontal Extrusion
5b	1	55.5146"w Curved Horizontal Extrusion
6	1	15"w Horizontal Extrusion
7	1	15"w Horizontal Extrusion
8a	1	55.5146"w Curved Horizontal Extrusion
8b	1	55.5146"w Curved Horizontal Extrusion
9a	1	55.5146"w Curved Horizontal Extrusion
9b	1	55.5146"w Curved Horizontal Extrusion

- Steps:
- 1) Connect horizontal extrusions [4a to 4b, 5a to 5b, 8a to 8b, and 9a to 9b] together.
 - 2) Attach horizontal assemblies [4a/4b and 5a/5b] between vertical extrusions [1 and 2] as shown below.
NOTE: Vertical extrusion [3] should stay attached to vertical extrusion [2a].
 - 3) Attach horizontal extrusions [6 and 7] between vertical extrusions [3 and 1] placing insert as shown.
 - 4) Attach horizontal assemblies [8a/8b and 9a/9b] between vertical extrusions [1 and 2] as shown below.

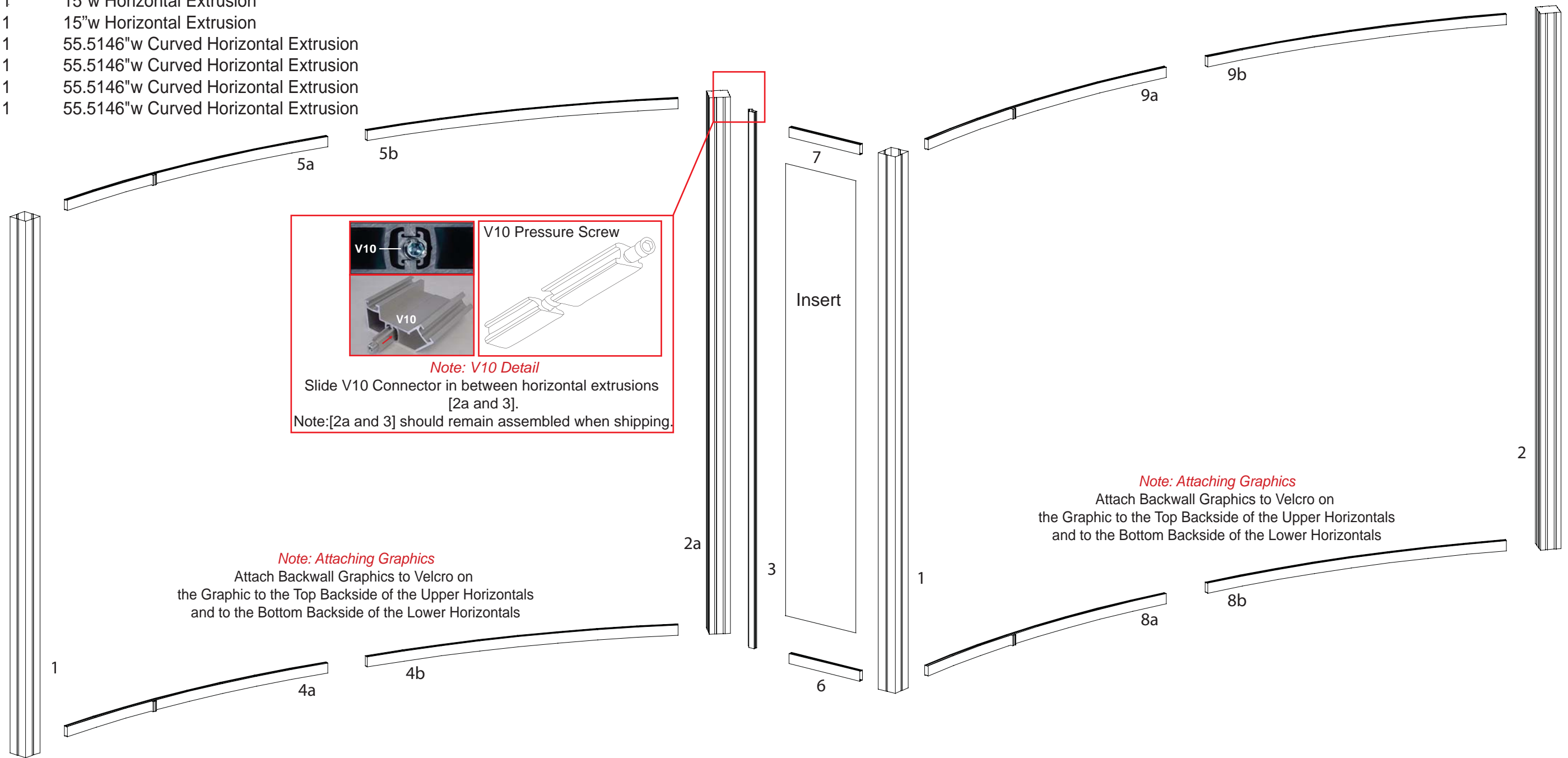

V10 Pressure Screw

Note: V10 Detail
Slide V10 Connector in between horizontal extrusions [2a and 3].
Note:[2a and 3] should remain assembled when shipping.

Note: Attaching Graphics
Attach Backwall Graphics to Velcro on the Graphic to the Top Backside of the Upper Horizontals and to the Bottom Backside of the Lower Horizontals

Note: Attaching Graphics
Attach Backwall Graphics to Velcro on the Graphic to the Top Backside of the Upper Horizontals and to the Bottom Backside of the Lower Horizontals

WHEN DISASSEMBLING ALUMINUM EXTRUSION, TIGHTEN ALL SETSCREWS AND LOCKS TO PREVENT LOSS DURING SHIPPING

866.652.2100

Item	Quantity	Description
1	2	96"h Vertical Extrusion
10a	1	45.1896"h Horizontal Extrusion
10b	1	45.1896"h Horizontal Extrusion
11a	1	45.1896"h Horizontal Extrusion
11b	1	45.1896"h Horizontal Extrusion
12	4	20.794"w Tapered Horizontal Extrusion
13	2	24.592"w Tapered Horizontal Extrusion
14	2	25.988"w Tapered Horizontal Extrusion
15	2	21.058"w Tapered Horizontal Extrusion
16	2	10.802"w Tapered Horizontal Extrusion
17	2	1.791" Connector Extrusion

Steps:

- 1) Connect horizontal extrusions [10a to 10b and 11a to 11b].
- 2) Attach horizontal extrusions [12] between horizontal extrusions from backwall to vertical extrusions [1].
- 3) Attach horizontal assemblies [10a/10b and 11a/11b] to vertical extrusions [1 and end of 17].
NOTE: [17] should stay attached to vertical extrusion [2a] from previous page.
- 4) Attach horizontal extrusions [13 thru 16] to horizontal assemblies from previous page and [10a/10b and 11a/11b] as shown.

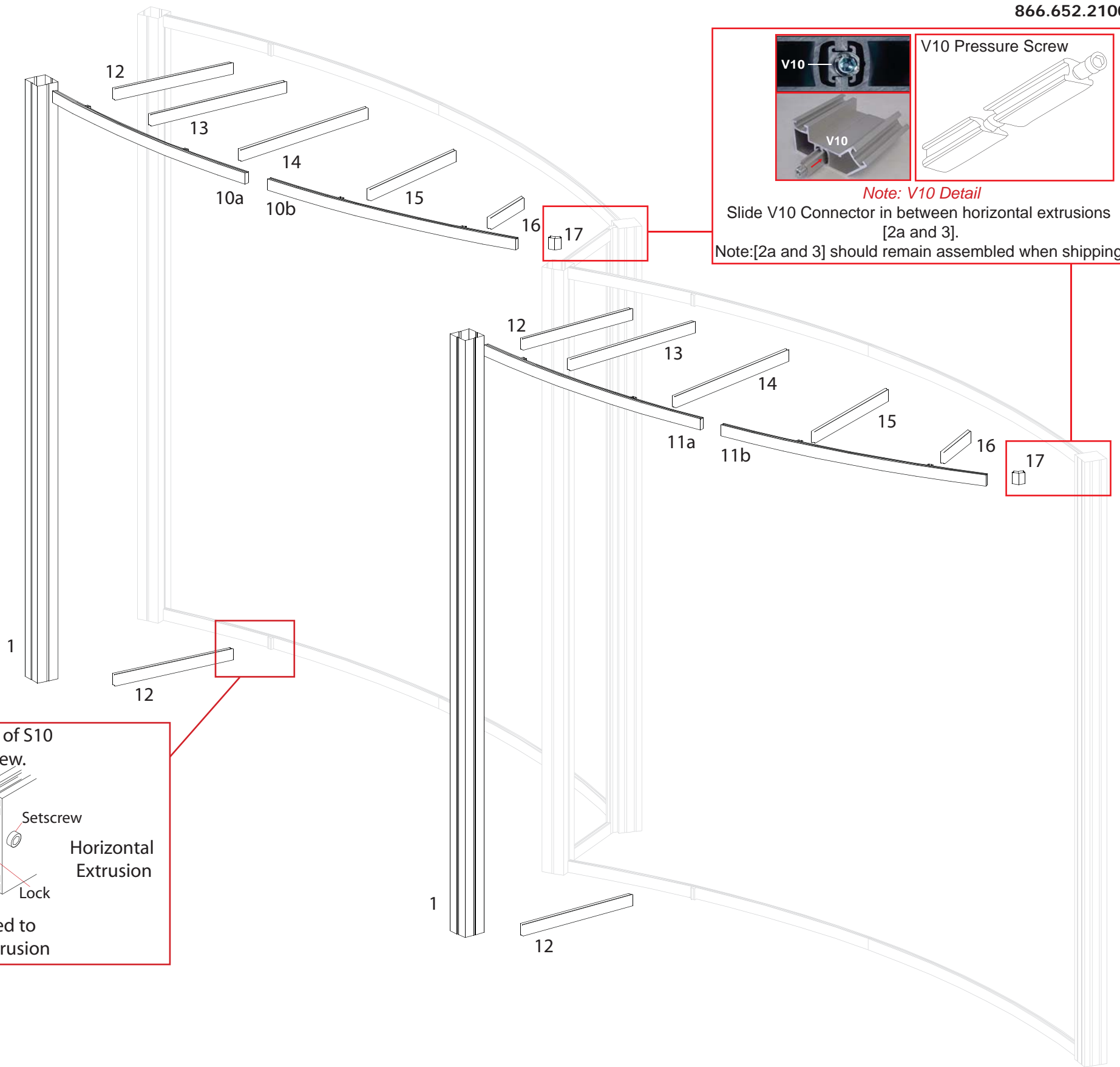

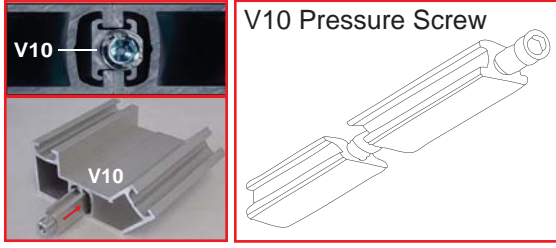

V10 Pressure Screw

Note: V10 Detail

Slide V10 Connector in between horizontal extrusions [2a and 3].

Note:[2a and 3] should remain assembled when shipping.

Place lock into groove of S10 and tighten setscrew.

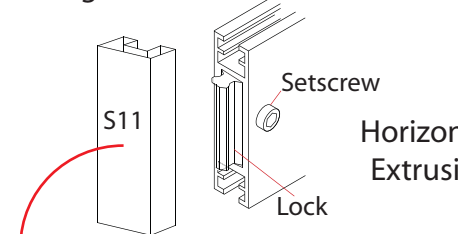

Setscrew

Lock

S11

Horizontal Extrusion

Permanently Attached to Curved Horizontal Extrusion

WHEN DISASSEMBLING ALUMINUM EXTRUSION, TIGHTEN ALL SETSCREWS AND LOCKS TO PREVENT LOSS DURING SHIPPING

866.652.2100

Item	Quantity	Description
18	3	37.75"h Vertical Extrusion
19	3	Square Base Plate
20	2	18"w Horizontal Extrusion
21	2	57.1455"w Curved Horizontal Extrusion
22	1	32"w Horizontal Extrusion w/ Velcro attached to bottom edge
23	1	32"w Horizontal Extrusion w/ Velcro attached to bottom edge
24	1	32"w Horizontal Extrusion w/ Velcro attached to top edge
25	1	32"w Horizontal Extrusion w/ Velcro attached to top edge

Steps:

- 1) Connect vertical extrusions [18] to base plates [19].
- 2) Attach horizontal extrusions [20 to 21, 22 to 23 and 24 to 25] as shown below.
- 3) Attach horizontal assemblies [20/21, 22/23 and 24/25] between vertical extrusions [18] placing insert as shown below.

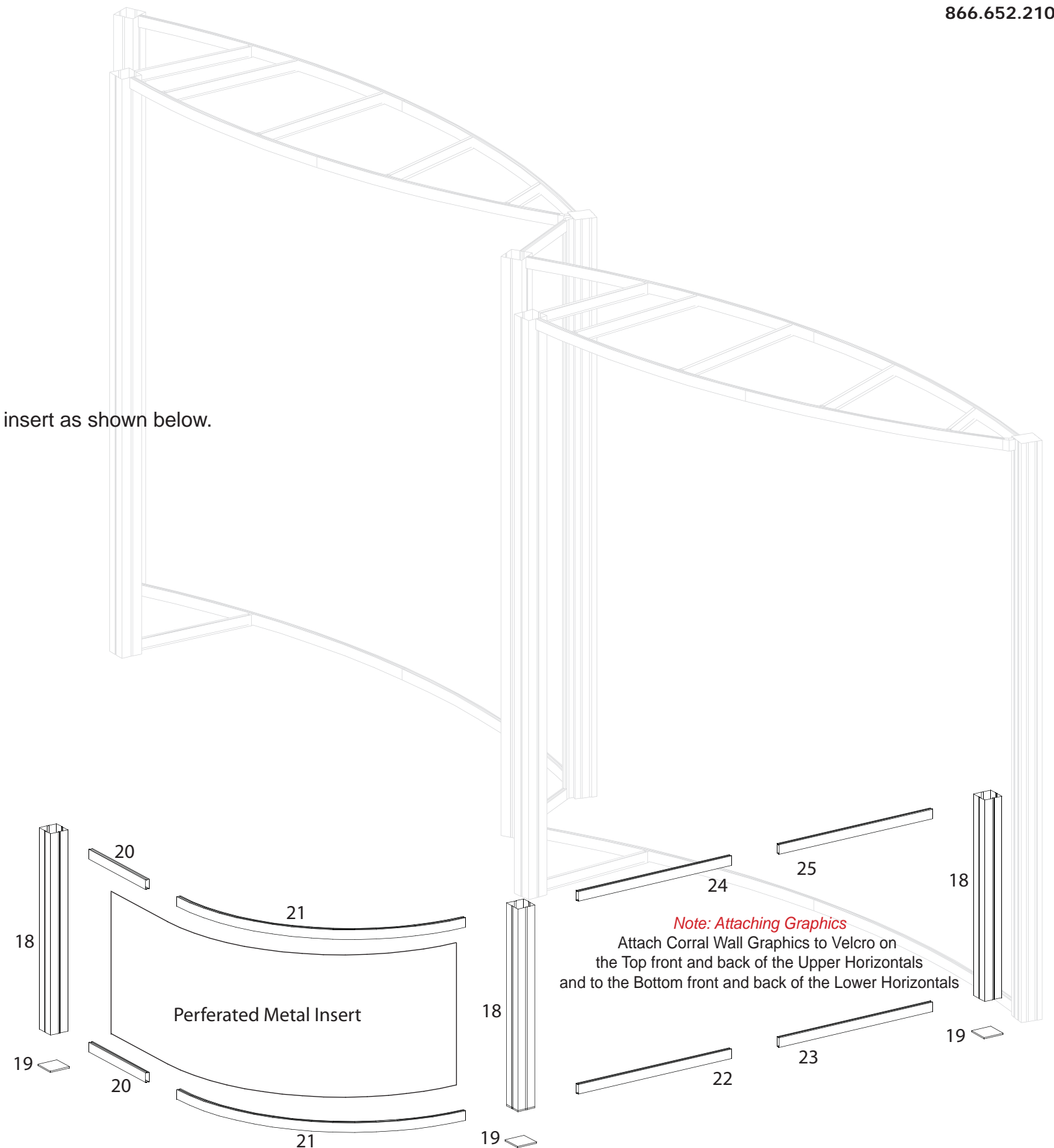

WHEN DISASSEMBLING ALUMINUM EXTRUSION, TIGHTEN ALL SETSCREWS AND LOCKS TO PREVENT LOSS DURING SHIPPING

866.652.2100

Item Number	Description
1	12.3310"w x 38"h Flat Panel
2	38"h Flex Connector
3	38"h Curve Panel
4	38"h Flex Connector
5	12.3310"w x 38"h Flat Panel
6	38"h 90° Connector
7	38"h 180° Connector
8	38"h Curve Panel w/Door
9	38"h Curve Panel
10	38"h Curve Panel w/Door
11	38"h 180° Connector
12	38"h 90° Connector

Steps:

Connect panels together in numerical order as shown in illustrations.

Place internal shelf atop shelf supports.

Set counter atop assembled pedestal.

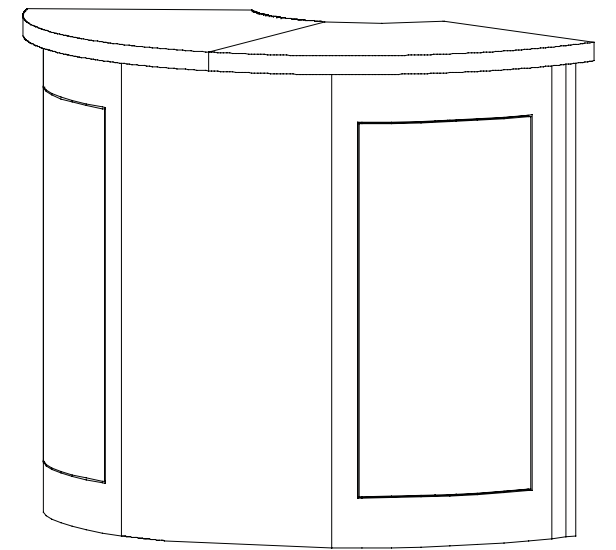
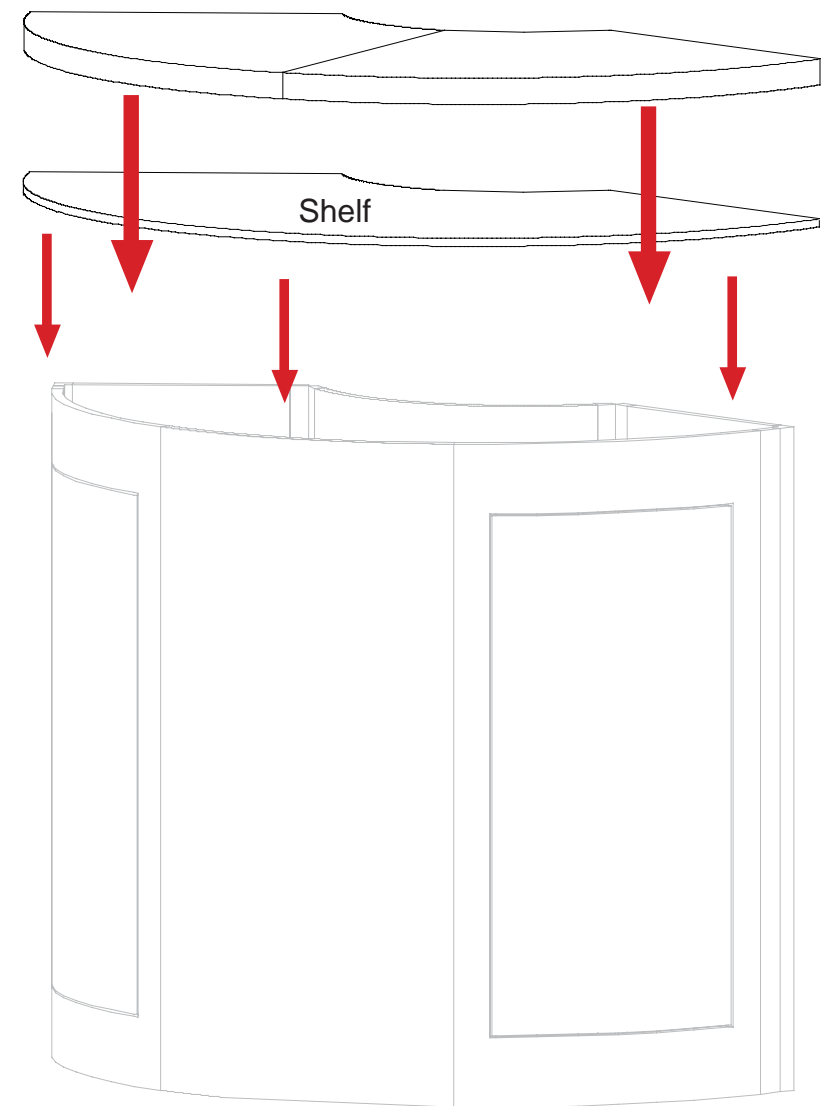
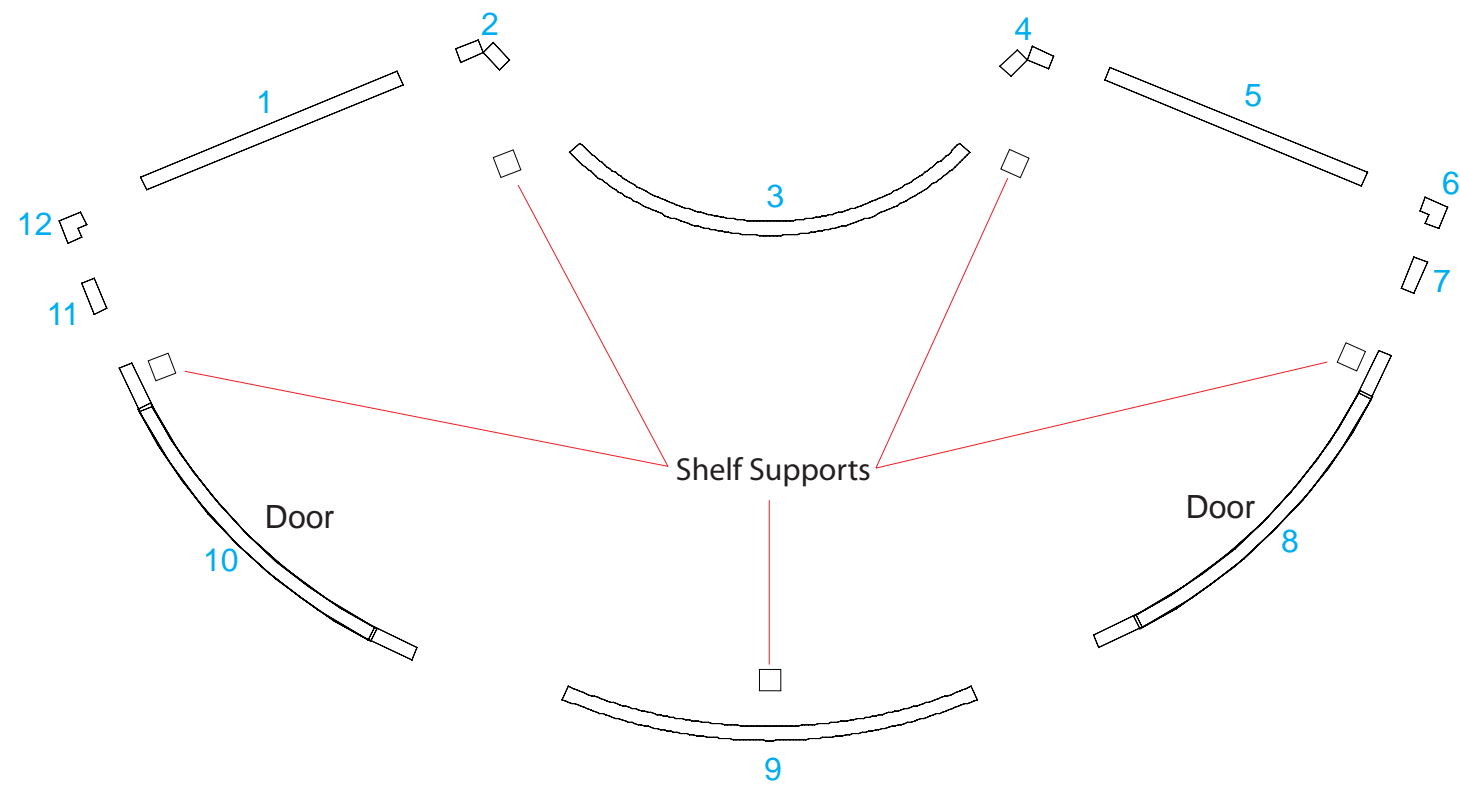

WHEN DISASSEMBLING ALUMINUM EXTRUSION, TIGHTEN ALL SETSCREWS AND LOCKS TO PREVENT LOSS DURING SHIPPING

866.652.2100

Item Number	Description
13	14.125" w x 38" h Flat Panel
14	38" h 135° Connector
15	11.201" w x 38" h Flat Panel
16	38" h 135° Connector
17	14.125" w x 38" h Flat Panel
18	38" h 90° Connector
19	38" h Curve Panel w/Door
20	38" h Curve Panel w/Door
21	38" h 90° Connector

Steps:
Connect panels together in numerical order as shown in illustrations.

Place internal shelf atop shelf supports.

Set counter atop assembled pedestal.

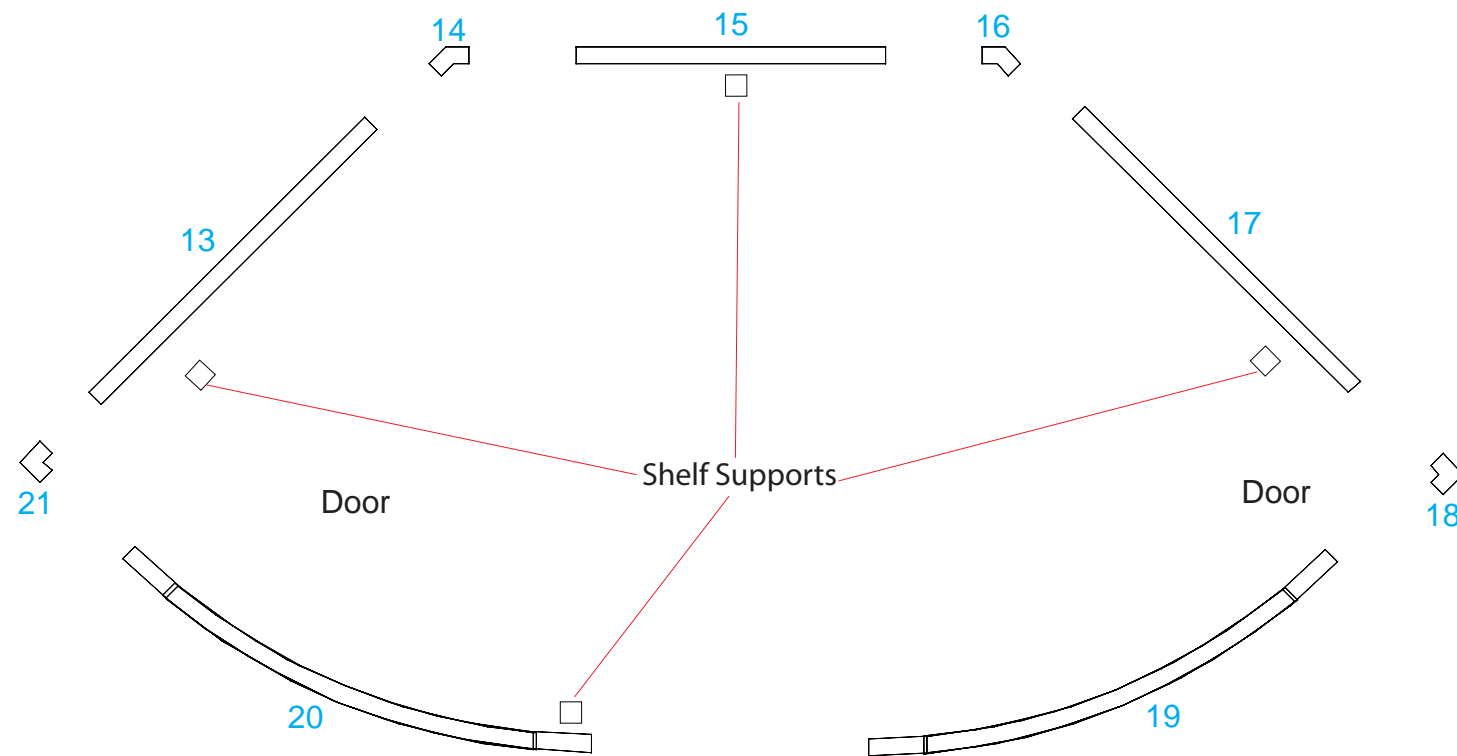
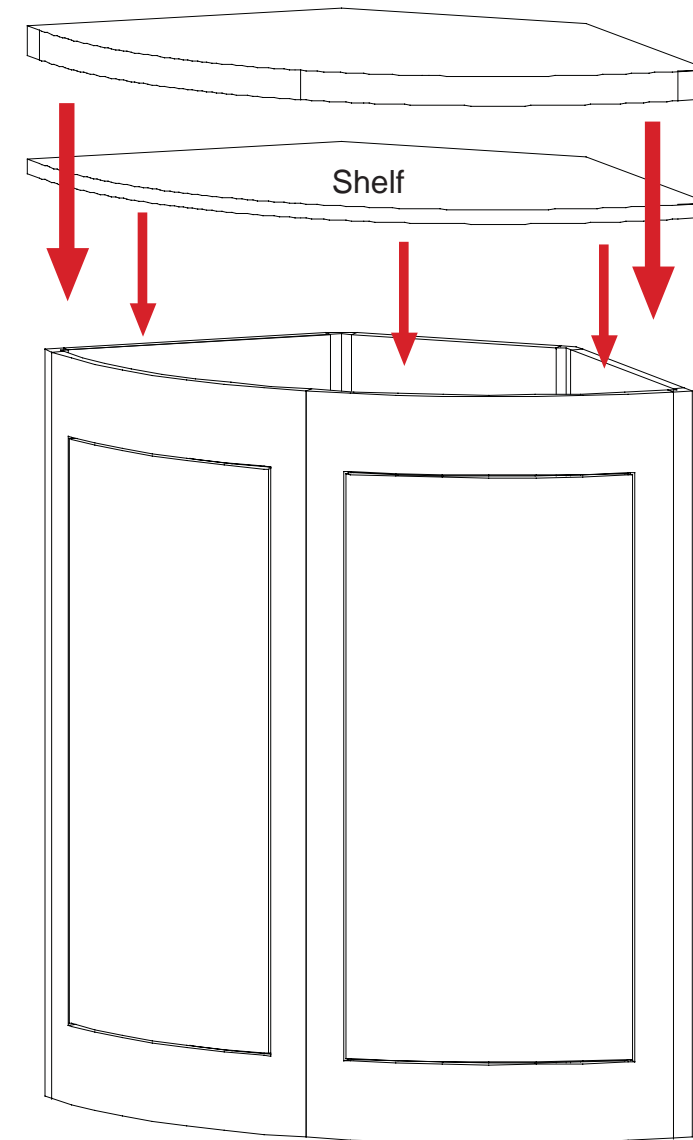
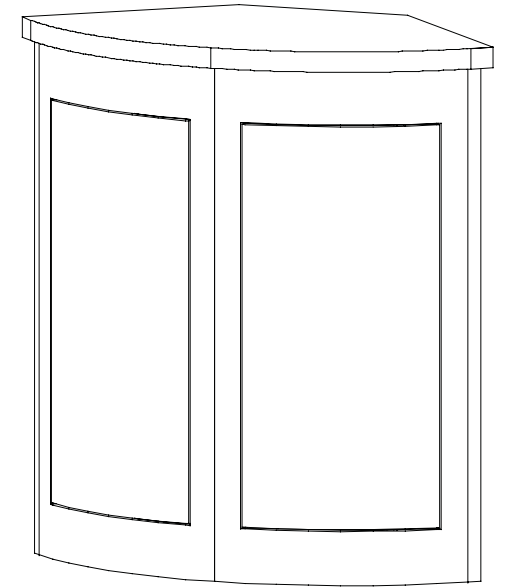

WHEN DISASSEMBLING ALUMINUM EXTRUSION, TIGHTEN ALL SETSCREWS AND LOCKS TO PREVENT LOSS DURING SHIPPING

866.652.2100

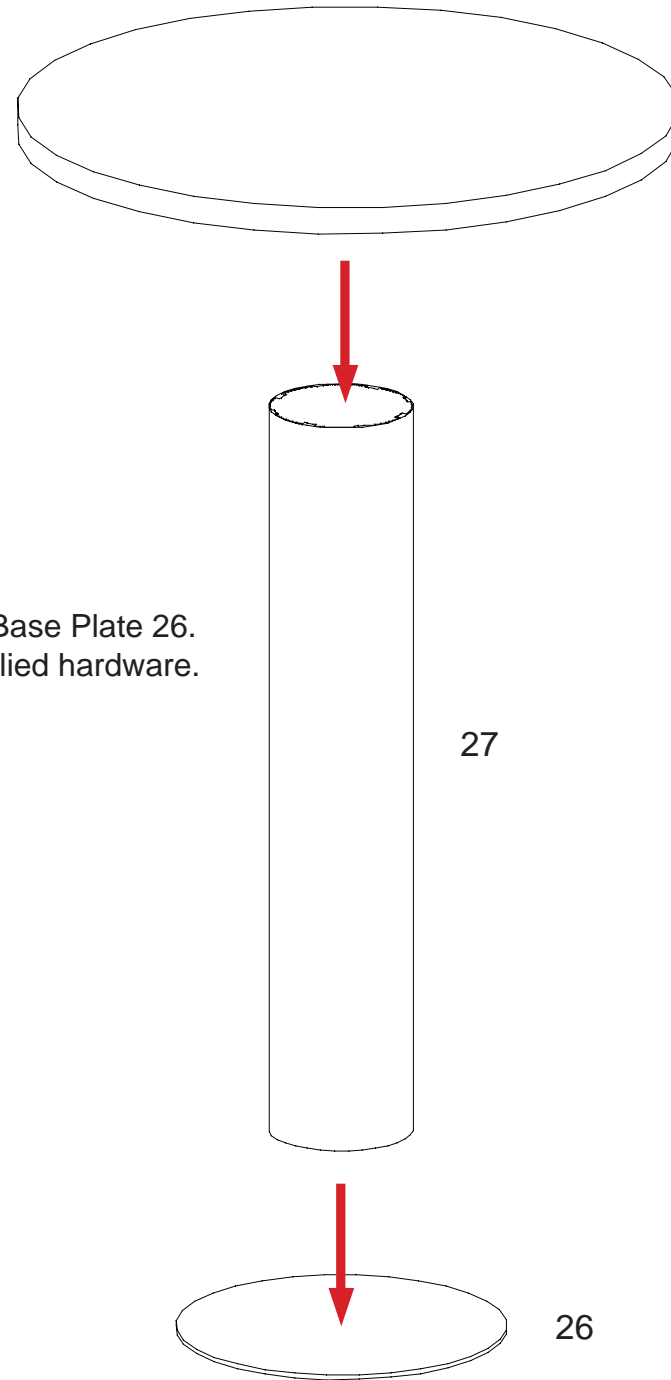
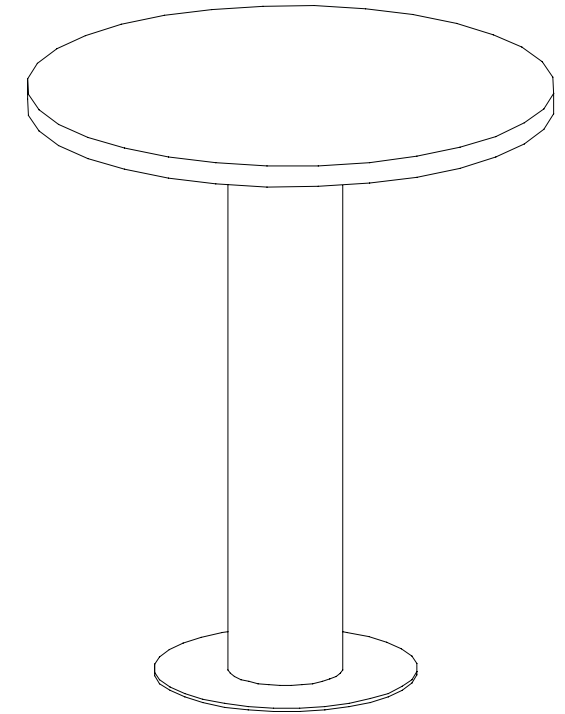

Attach Conference Table Leg 27 to Base Plate 26.
Attach counter to table leg with supplied hardware.

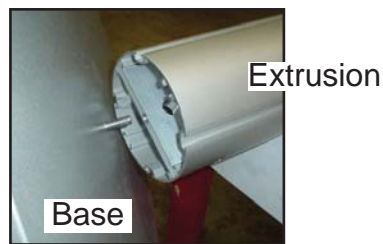

WHEN DISASSEMBLING ALUMINUM EXTRUSION, TIGHTEN ALL SETSCREWS AND LOCKS TO PREVENT LOSS DURING SHIPPING

866.652.2100

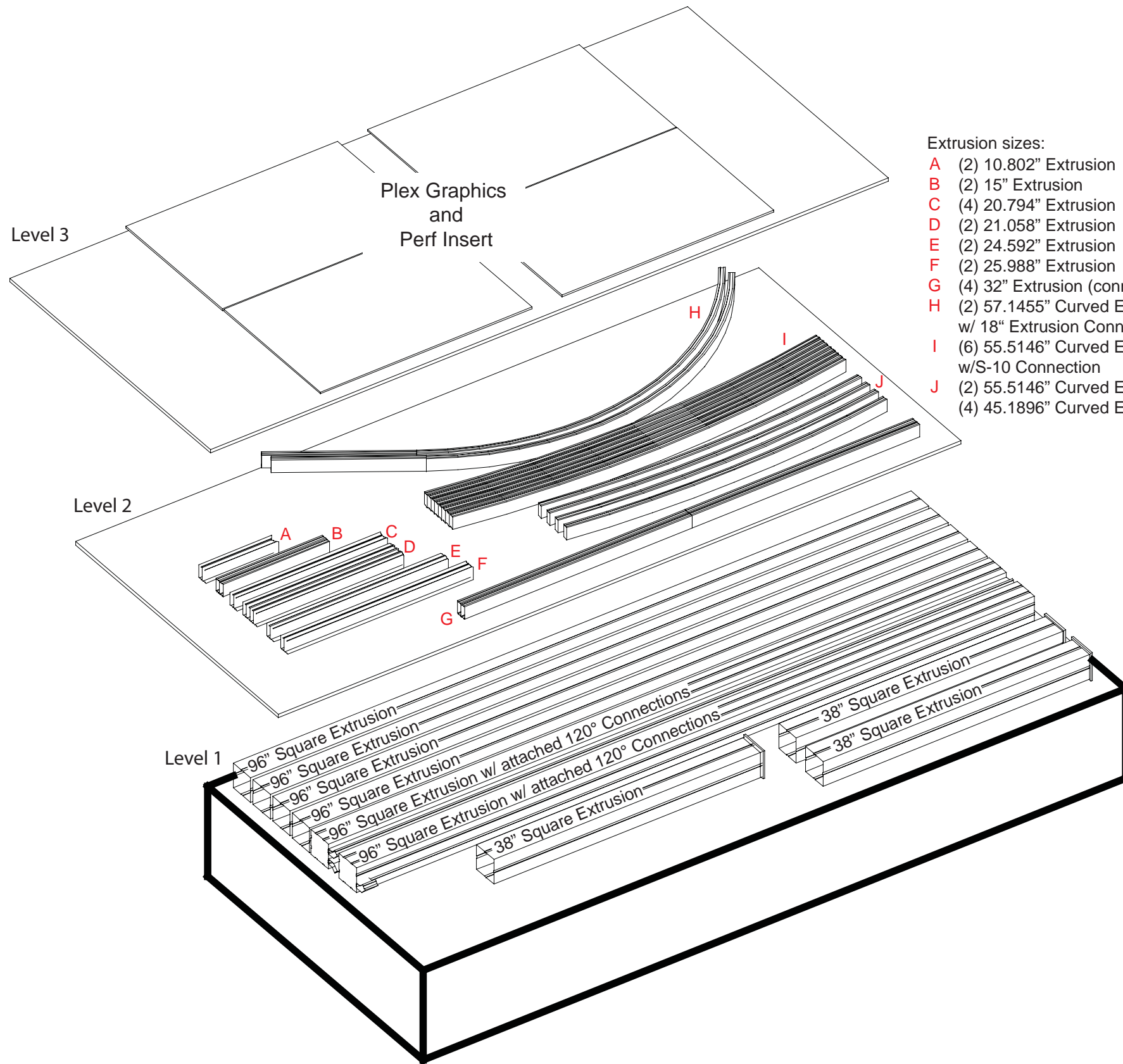

- Extrusion sizes:
- A (2) 10.802" Extrusion
 - B (2) 15" Extrusion
 - C (4) 20.794" Extrusion
 - D (2) 21.058" Extrusion
 - E (2) 24.592" Extrusion
 - F (2) 25.988" Extrusion
 - G (4) 32" Extrusion (connected together)
 - H (2) 57.1455" Curved Extrusion w/ 18" Extrusion Connected
 - I (6) 55.5146" Curved Extrusion w/S-10 Connection
 - J (2) 55.5146" Curved Extrusion
 - (4) 45.1896" Curved Extrusion



Level 3



Level 1



Level 2

WHEN DISASSEMBLING ALUMINUM EXTRUSION, TIGHTEN ALL SETSCREWS AND LOCKS TO PREVENT LOSS DURING SHIPPING

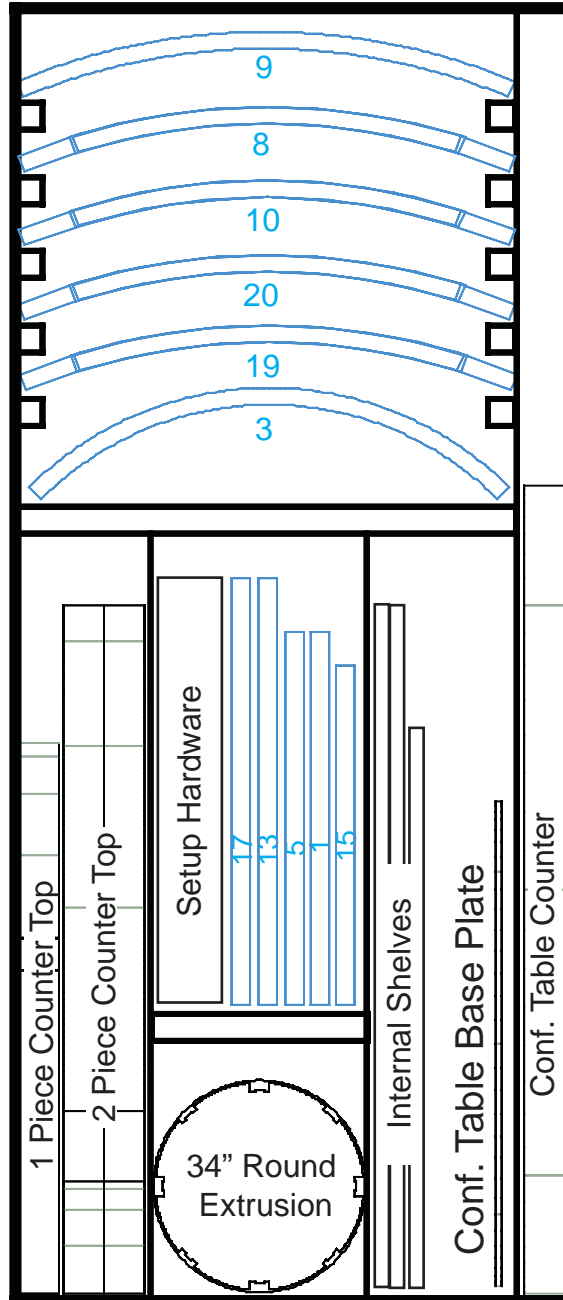

Misc. Product Boxes

Connector Box



WHEN DISASSEMBLING ALUMINUM EXTRUSION, TIGHTEN ALL SETSCREWS AND LOCKS TO PREVENT LOSS DURING SHIPPING

NOTE :

PDF copies of your Setup Instructions are available @ classicexhibits.com

See the search tool on the lower left hand corner of the Home page.

Enter the 5 digit Order #.

Search for Setup Instructions

WHEN DISASSEMBLING ALUMINUM EXTRUSION, TIGHTEN ALL
SETSCREWS AND LOCKS TO PREVENT LOSS DURING SHIPPING