

euro It | HYBRIDS

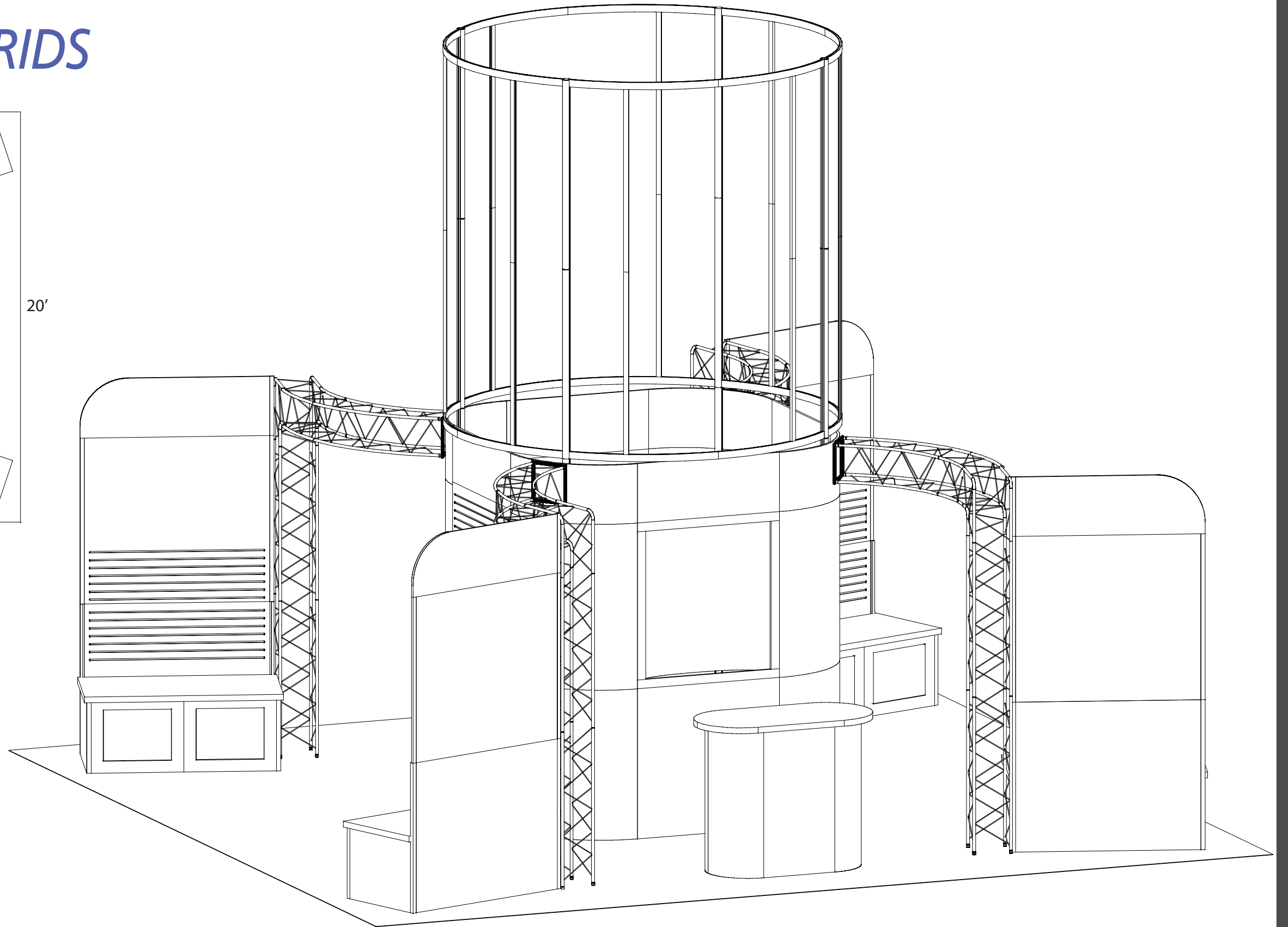
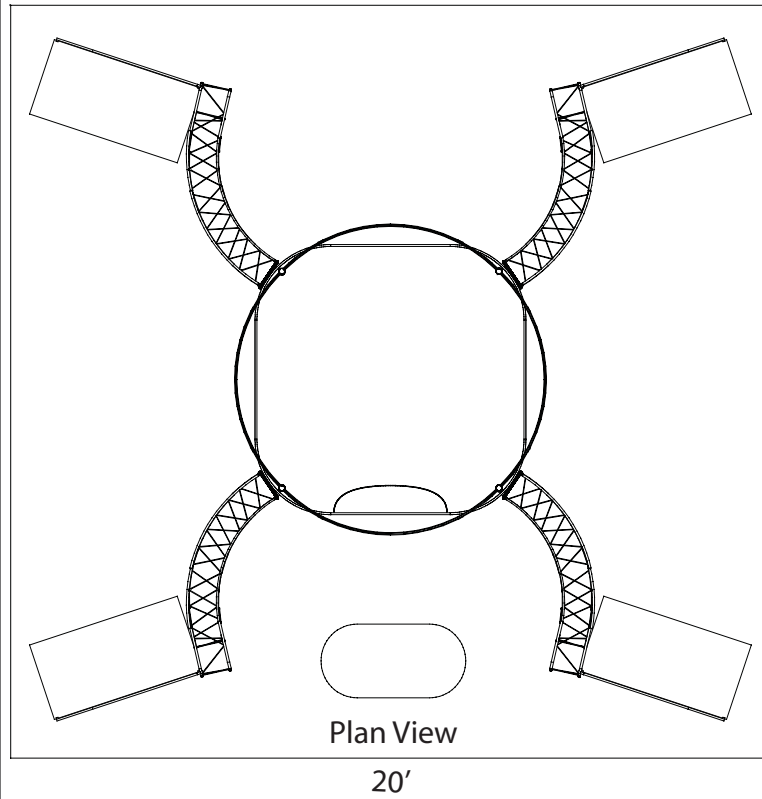

WHEN DISASSEMBLING ALUMINUM EXTRUSION, TIGHTEN ALL SETSCREWS AND LOCKS TO PREVENT LOSS DURING SHIPPING

euro lt | HYBRIDS

Using Your Setup Instructions

The Euro LT Hybrids Setup Instructions are created specifically for your configuration. They are laid out sequentially in levels, including exploded views, and a logical series of detailed steps to assemble the main structure and components. We encourage you to study the instructions **before** attempting to assemble your exhibit.

Each page reminds you to tighten the setscrews after disassembling your exhibit to prevent loss of the locks and setscrews (see below in RED). This is VERY IMPORTANT.

Cleaning and Packing Your Display

- 1) Use care when cleaning aluminum extrusion or acrylic inserts. Use only non-abrasive cleaners.
- 2) When cleaning laminate inserts, countertops, or panels use mild cleansers and a soft material such as cotton.
- 3) Keep all display components away from extreme heat and long exposure to sunlight to avoid warping and fading.
- 4) Retain all packing material. It will make re-packing much easier and will reduce the likelihood of shipping damage.

General Setup Instructions for Extrusion System



Most exhibits can be assembled with the supplied Hex Key Tool. Occasionally, a flat head screwdriver may be required.



Most horizontal extrusion connections have a patented expandable lock. This lock inserts into the groove of an opposing extrusion. Tightening the lock with the Hex Key Tool expands the lock and creates a strong positive connection.

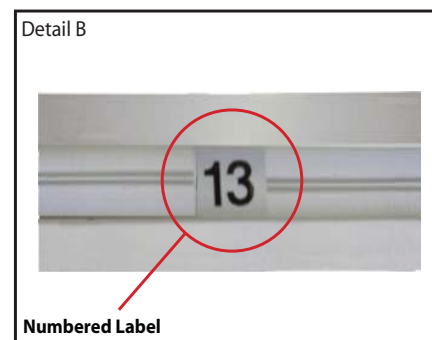

Each extrusion contains a numbered label which corresponds with setup instructions. The label is located within a groove of the extrusion (when possible). With extrusion components the labels contain Black numbers unless otherwise specified.



Remove only (1) setscrew when disassembling. Replace setscrew in extrusion after assembling it. Before packing, replace setscrew in extrusion to avoid losing it.

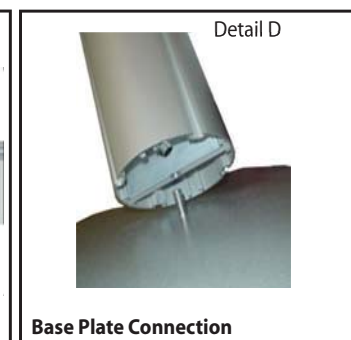

Attach base plate to round or square vertical extrusion using the bolt provided. Be careful not to strip the threads.

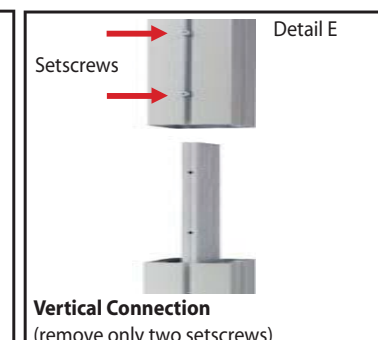

When vertical extrusions are packed in portable cases rather than crates or tubs, they must be broken down into smaller section which then require assembly.

Remove only (2) setscrews when disassembling. Replace setscrews in extrusion after assembling it. Before packing, replace setscrews in extrusion to avoid losing them.

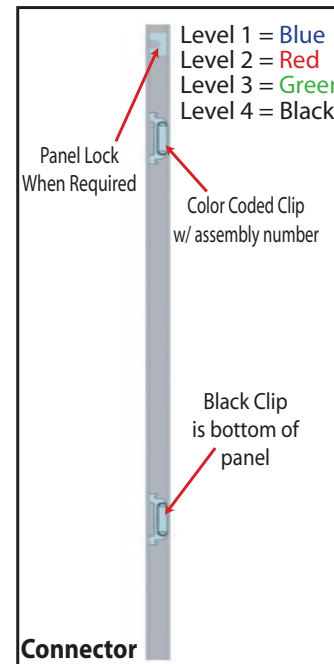

Each component has 2 clips, the lower clip is ALWAYS black. The top clip is color coded to distinguish which level. The color coded clip also contains the numbered label.

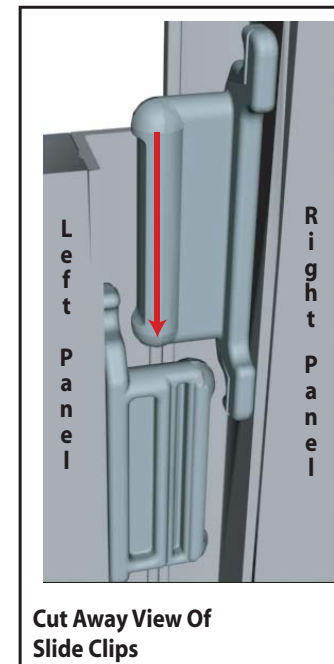

Components connect together by aligning them and sliding downward connecting clips together.

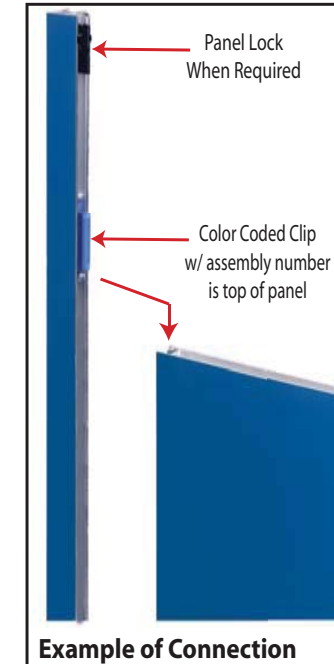

Configurations are assembled from left to right, usually starting with #1 and following the numbered sequence.

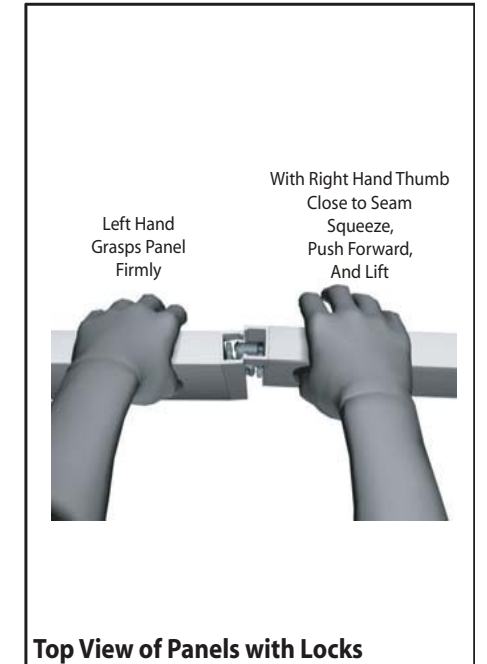

The first level of components contain panel locks that are located at the top of the panel for extra stability and seamless connection. When disassembling panels twist top connection slightly and lift right panel upward.

WHEN DISASSEMBLING ALUMINUM EXTRUSION, TIGHTEN ALL SETSCREWS AND LOCKS TO PREVENT LOSS DURING SHIPPING

866.652.2100

Item Number	Description
1	38" w x 38" h Flat Panel w/ Slatwall
2	23" r x 38" h Curved Panel
3	38" w x 38" h Flat Panel
4	23" r x 38" h Curved Panel
5	38" w x 38" h Flat Panel w/ Slatwall
6	23" r x 38" h Curved Panel
7	38" w x 38" h Lower Conference Door
7A	38" h Lower Conference Door Section
8	23" r x 38" h Curved Panel
9	23" w x 19" h Flat Panel
10	19" h 90° Connector
11	23" w x 19" h Flat Panel w/ Door
12	23" w x 19" h Flat Panel w/ Door
13	19" h 90° Connector
14	23" w x 19" h Flat Panel
15	38" h Custom Milled 90° Connector
16	46" w x 38" h Flat Panel w/ Slatwall
17	38" h Custom Milled 90° Connector
18	23" w x 19" h Flat Panel
19	19" h 90° Connector
20	23" w x 19" h Flat Panel w/ Door
21	23" w x 19" h Flat Panel w/ Door
22	19" h 90° Connector
23	23" w x 19" h Flat Panel
24	38" h Custom Milled 90° Connector
25	46" w x 38" h Flat Panel w/ Slatwall
26	38" h Custom Milled 90° Connector
27	23" w x 19" h Flat Panel
28	19" h 90° Connector
29	23" w x 19" h Flat Panel w/ Door
30	23" w x 19" h Flat Panel w/ Door
31	19" h 90° Connector
32	23" w x 19" h Flat Panel
33	38" h Custom Milled 90° Connector
34	46" w x 38" h Flat Panel w/ Slatwall
35	38" h Custom Milled 90° Connector
36	23" w x 19" h Flat Panel
37	19" h 90° Connector
38	23" w x 19" h Flat Panel w/ Door
39	23" w x 19" h Flat Panel w/ Door
40	19" h 90° Connector
41	23" w x 19" h Flat Panel
42	38" h Custom Milled 90° Connector
43	46" w x 38" h Flat Panel w/ Slatwall
44	38" h Custom Milled 90° Connector
45	23" w x 19" h Flat Panel
46	19" h 90° Connector
47	23" w x 19" h Flat Panel w/ Door
48	23" w x 19" h Flat Panel w/ Door
49	19" h 90° Connector
50	23" w x 19" h Flat Panel

Steps:
Starting with panel # 1 (✳) connect panels together in numerical order as shown in illustrations.

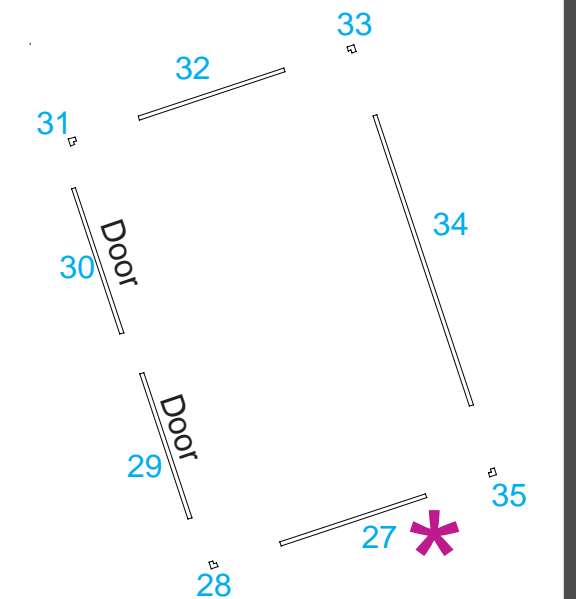
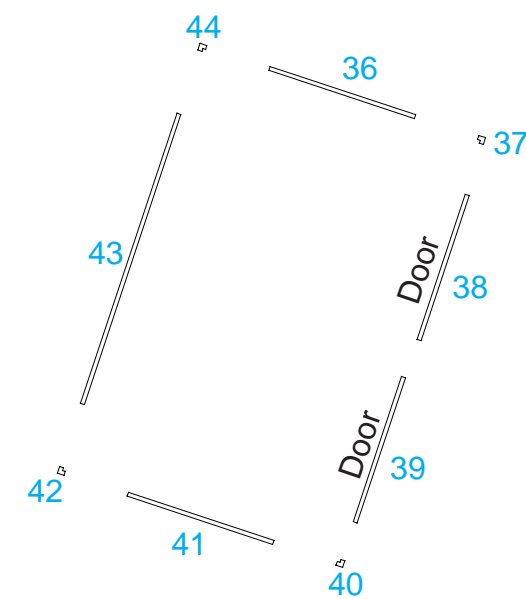
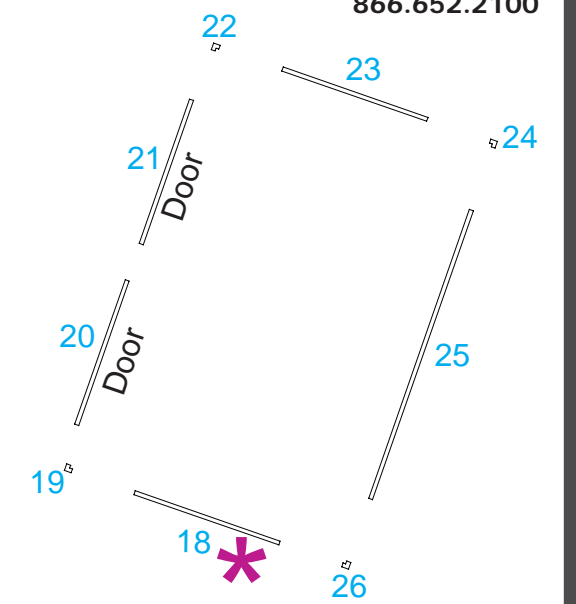
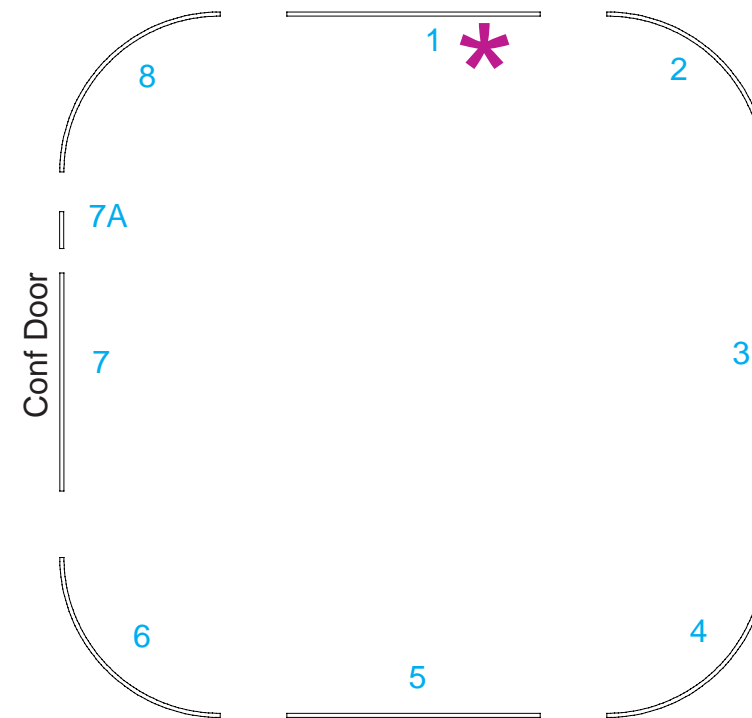
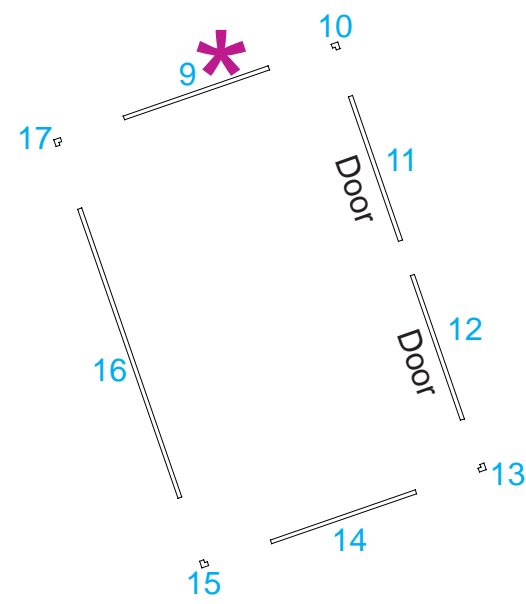

WHEN DISASSEMBLING ALUMINUM EXTRUSION, TIGHTEN ALL SETSCREWS AND LOCKS TO PREVENT LOSS DURING SHIPPING

Item Number	Description
36	23"w x 19"h Flat Panel
37	19"h 90° Connector
38	23"w x 19"h Flat Panel w/ Door
39	23"w x 19"h Flat Panel w/ Door
40	19"h 90° Connector
41	23"w x 19"h Flat Panel
42	38"h Custom Milled 90° Connector
43	46"w x 38"h Flat Panel w/ Slatwall
44	38"h Custom Milled 90° Connector
45	19"w x 38"h Flat Panel w/ Door
46	11.5"r x 38"h Curved Panel
47	11.5"r x 38"h Curved Panel
48	19"w x 38"h Flat Panel
49	11.5"r x 38"h Curved Panel
50	11.5"r x 38"h Curved Panel

Steps:
 Starting with panel # 36 (✳) connect panels together in numerical order as shown in illustrations.

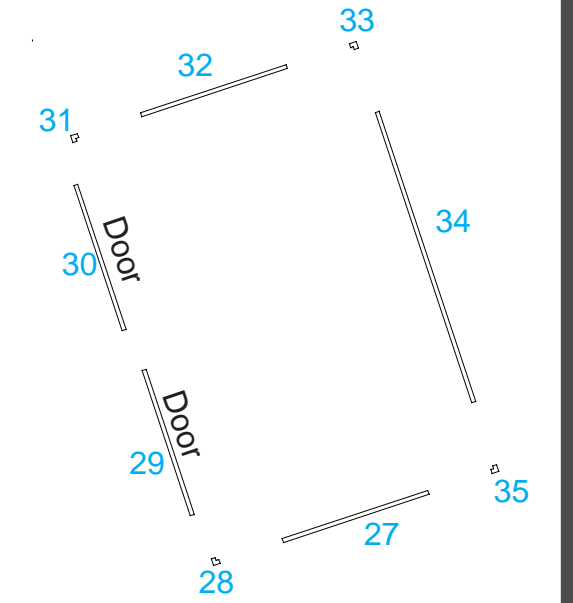
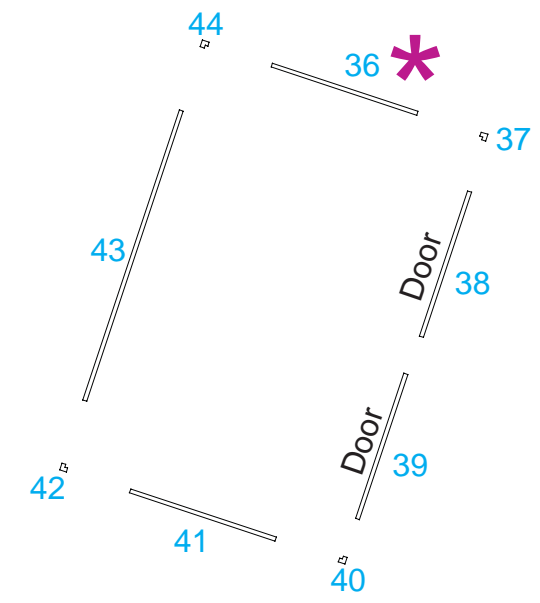
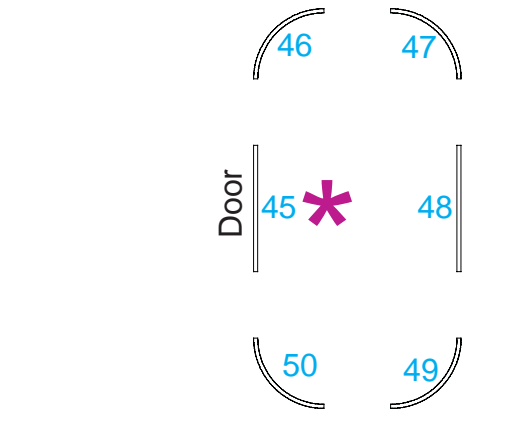
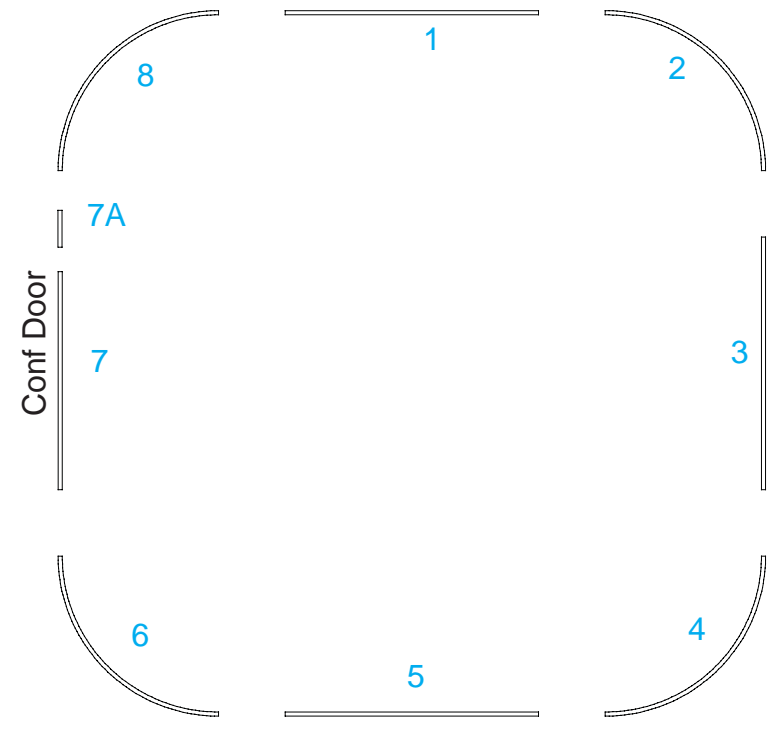
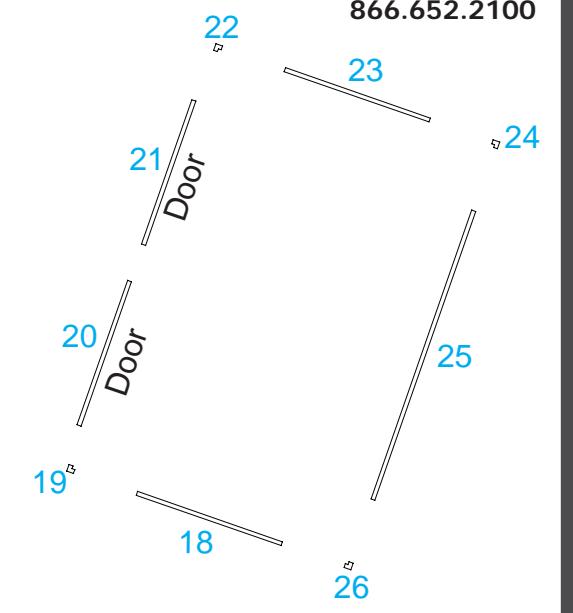
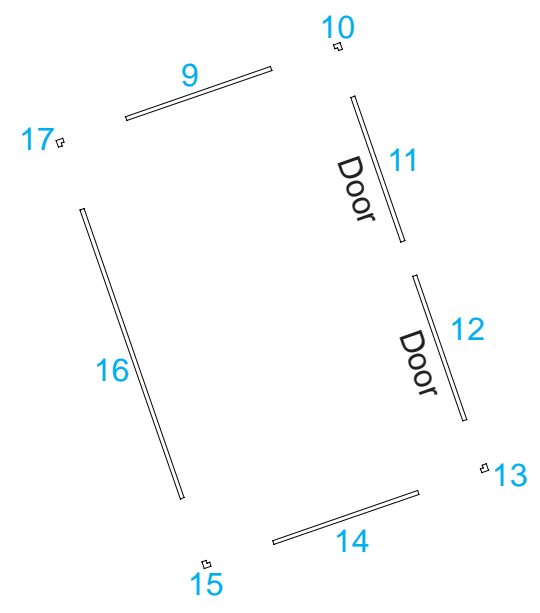

WHEN DISASSEMBLING ALUMINUM EXTRUSION, TIGHTEN ALL SETSCREWS AND LOCKS TO PREVENT LOSS DURING SHIPPING

866.652.2100

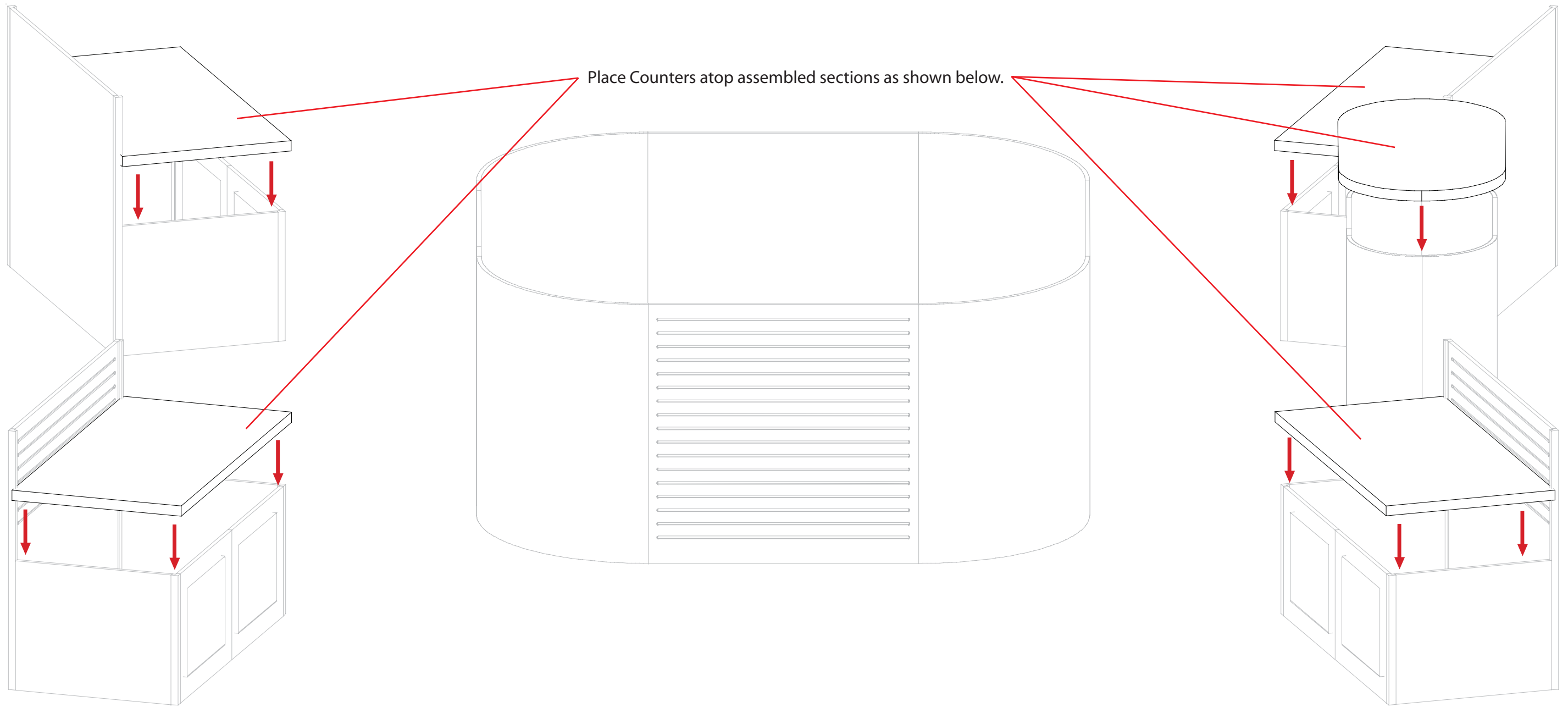

WHEN DISASSEMBLING ALUMINUM EXTRUSION, TIGHTEN ALL SETSCREWS AND LOCKS TO PREVENT LOSS DURING SHIPPING

866.652.2100

Item Number	Description
1	38" w x 42" h Flat Panel w/ Slatwall
2	23" r x 42" h Curved Panel
3	38" w x 42" h Flat Window Panel
4	23" r x 42" h Curved Panel
5	38" w x 42" h Flat Panel w/ Slatwall
6	23" r x 42" h Curved Panel
7	38" w x 42" h Upper Conference Door
8	23" r x 42" h Curved Panel
15	42" h End Cap
16	46" w x 42" h Flat Panel w/ Slatwall
17	42" h End Cap
24	42" h End Cap
25	46" w x 42" h Flat Panel w/ Slatwall
26	42" h End Cap
33	42" h End Cap
34	46" w x 42" h Flat Panel w/ Slatwall
35	42" h End Cap
42	42" h End Cap
43	46" w x 42" h Flat Panel w/ Slatwall
44	42" h End Cap

Steps:
Starting with panel # 1 (✳) connect panels together in numerical order as shown in illustrations.

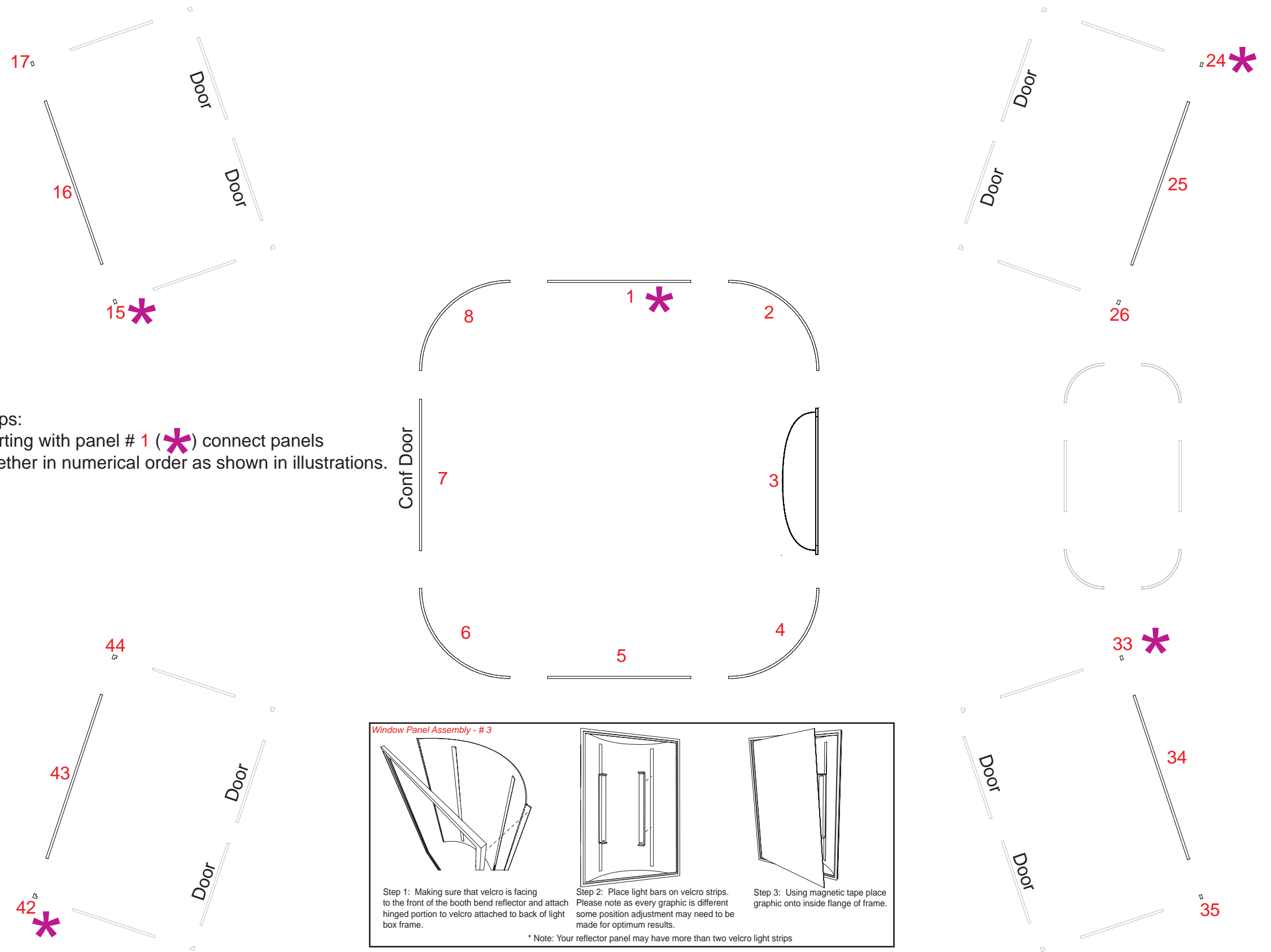

WHEN DISASSEMBLING ALUMINUM EXTRUSION, TIGHTEN ALL SETSCREWS AND LOCKS TO PREVENT LOSS DURING SHIPPING

866.652.2100

Item Number	Description
1	38" w x 15" h Flat Panel
2	23" r x 15" h Curved Panel
3	38" w x 15" h Flat Panel
4	23" r x 15" h Curved Panel
5	38" w x 15" h Flat Panel
6	23" r x 15" h Curved Panel
7	38" w x 15" h Flat Panel
8	23" r x 15" h Curved Panel
15	15" h End Cap
16	46" w x 15" h Flat Panel
25	46" w x 15" h Flat Panel
26	15" h End Cap
33	15" h End Cap
34	46" w x 15" h Flat Panel
43	46" w x 15" h Flat Panel
44	15" h End Cap

Steps:
Starting with panel # 1 (*) connect panels together in numerical order as shown in illustrations.

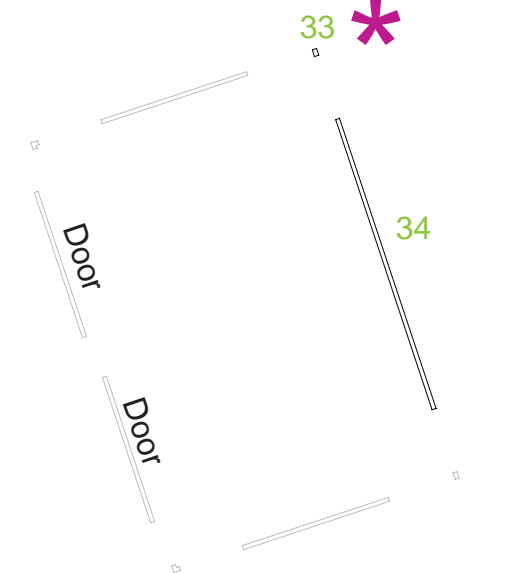
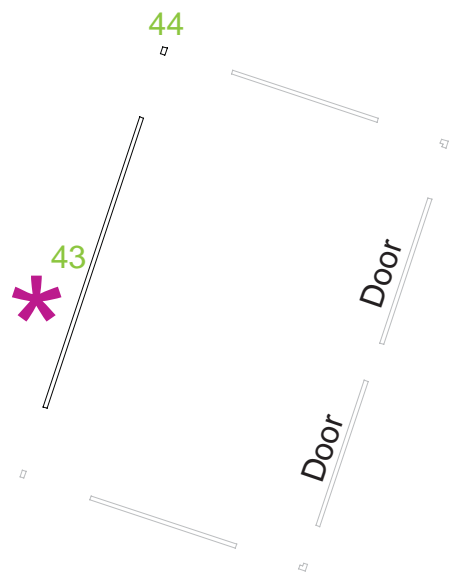
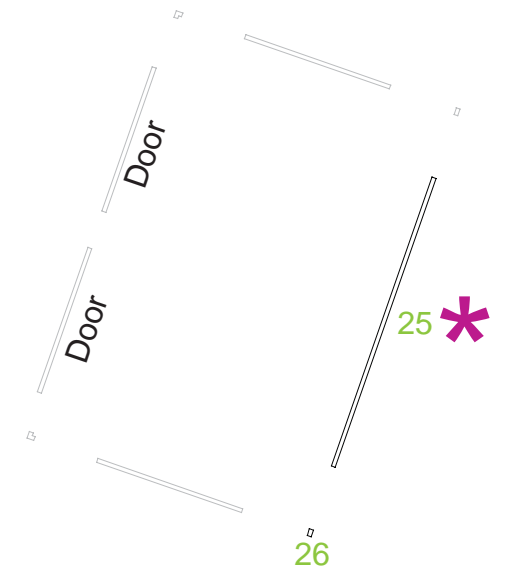
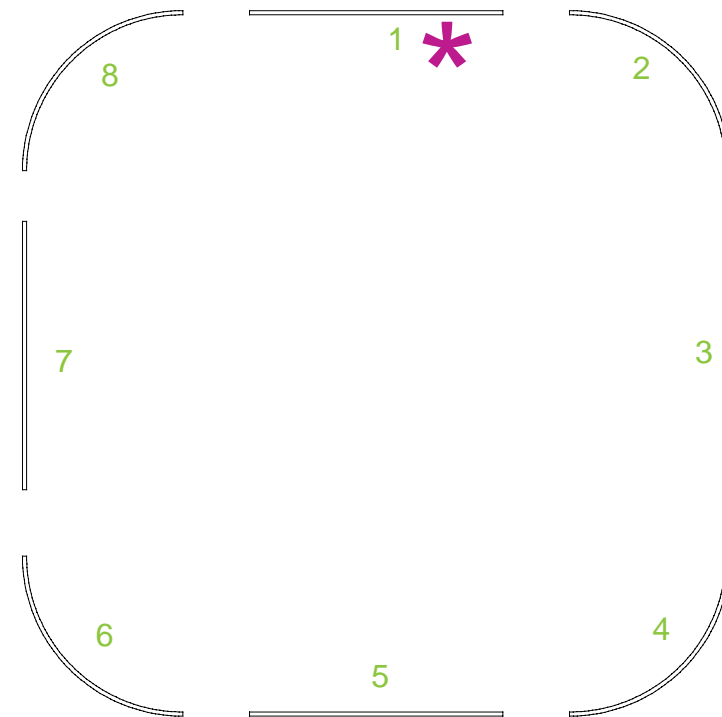
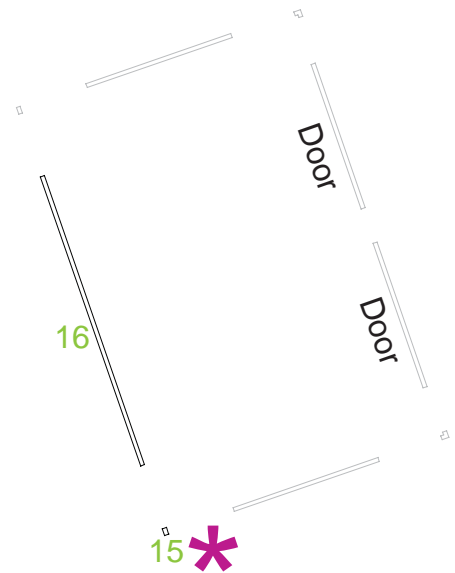

WHEN DISASSEMBLING ALUMINUM EXTRUSION, TIGHTEN ALL SETSCREWS AND LOCKS TO PREVENT LOSS DURING SHIPPING

866.652.2100

Number	Qty	Description
1	4	48" h Lower Vertical Extrusion
2	4	48" h Upper Vertical Extrusion
3	4	48" h Upper Vertical Extrusion
4	4	48" h Upper Vertical Extrusion
5	4	37.9356" Curved Horizontal Extrusion
6	4	37.9356" Curved Horizontal Extrusion
7	8	46.209" h Vertical Extrusion
8	8	46.209" h Vertical Extrusion

Steps

- 1) Assemble vertical extrusions [1 - 4] by connecting together as shown at right.
- 2) Assemble horizontal curved extrusions [5 and 6] by connecting together.
- 3) Starting at the bottom of the groove on extrusion [3] attach horizontal extrusions [5/6] around as shown.
- 4) Assemble vertical extrusions [7 and 8] by connecting together as shown.
- 5) Attach assembled vertical extrusions [7/8] to horizontal extrusions [5/6] as shown at right.

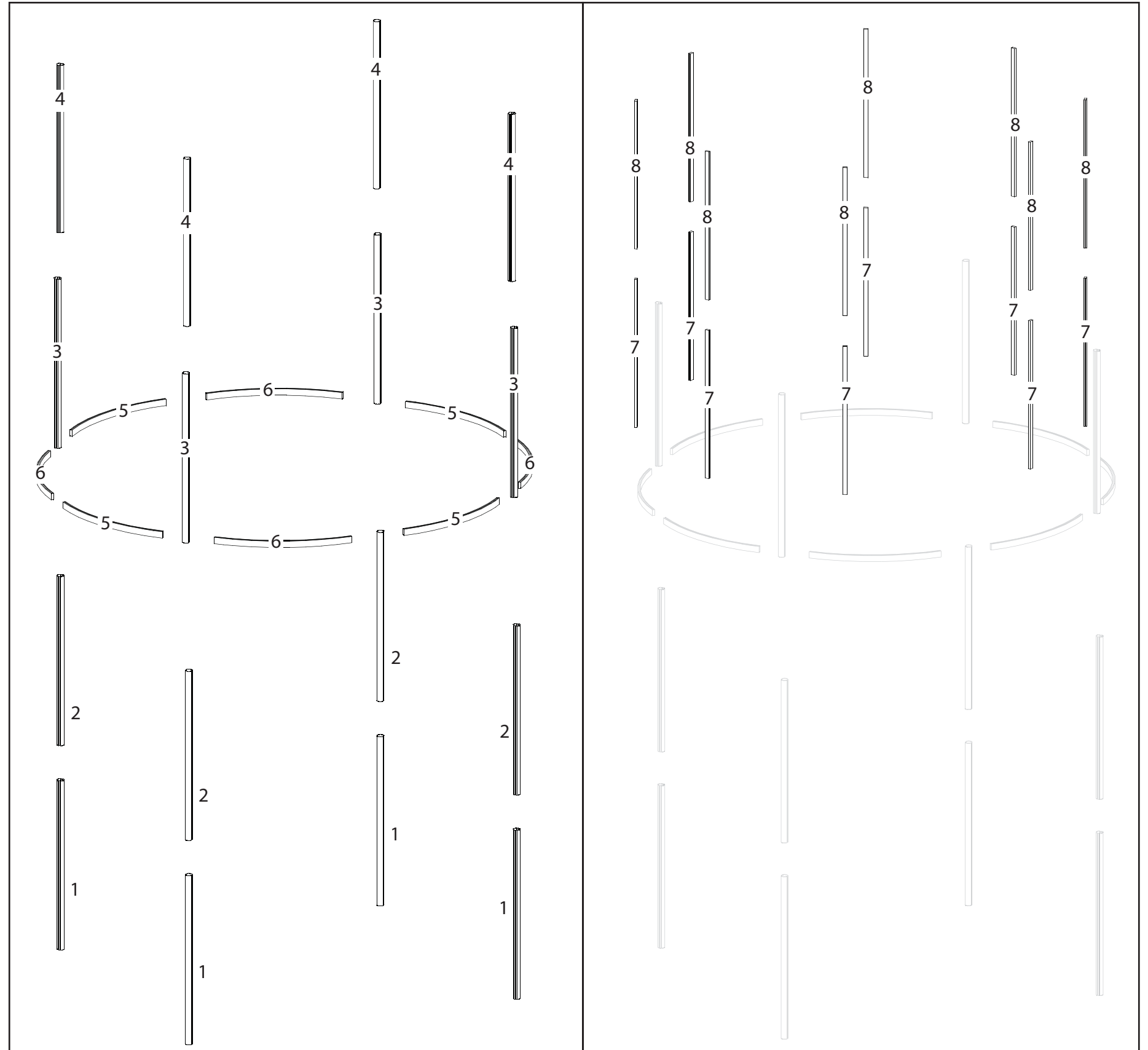

WHEN DISASSEMBLING ALUMINUM EXTRUSION, TIGHTEN ALL SETSCREWS AND LOCKS TO PREVENT LOSS DURING SHIPPING

866.652.2100

Number	Qty	Description
9	4	37.9356" Curved Horizontal Extrusion
10	4	37.9356" Curved Horizontal Extrusion

Steps

- 1) Assemble horizontal curved extrusions [9 and 10] by connecting together.
- 2) Starting at the top of the groove on extrusion [4] attach horizontal extrusions [9/10] around as shown.

Note: Attaching Graphics

Attach Graphics to Velcro placed on the Top of the Upper Horizontals, sides and Bottom of the Lower Horizontals

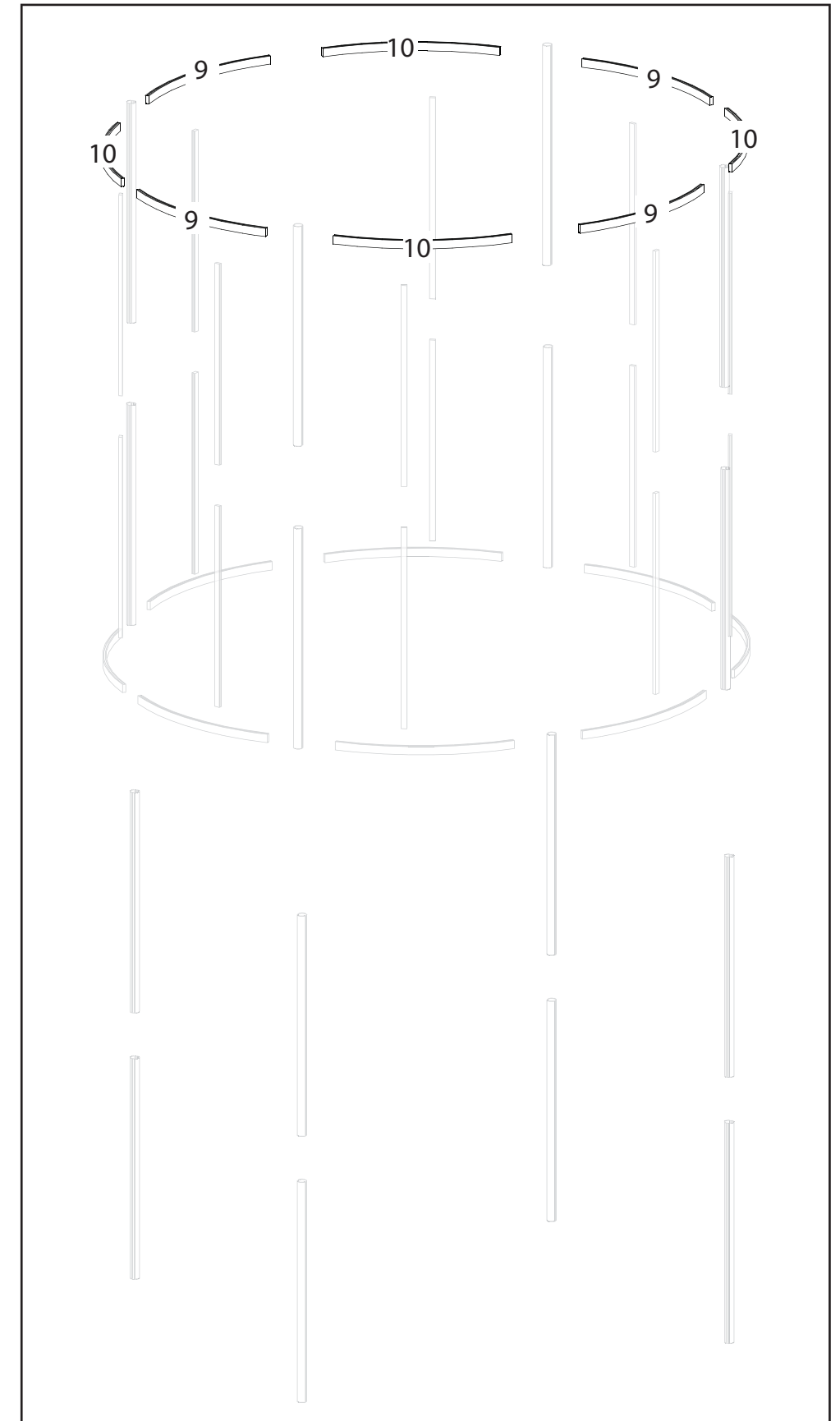

WHEN DISASSEMBLING ALUMINUM EXTRUSION, TIGHTEN ALL SETSCREWS AND LOCKS TO PREVENT LOSS DURING SHIPPING

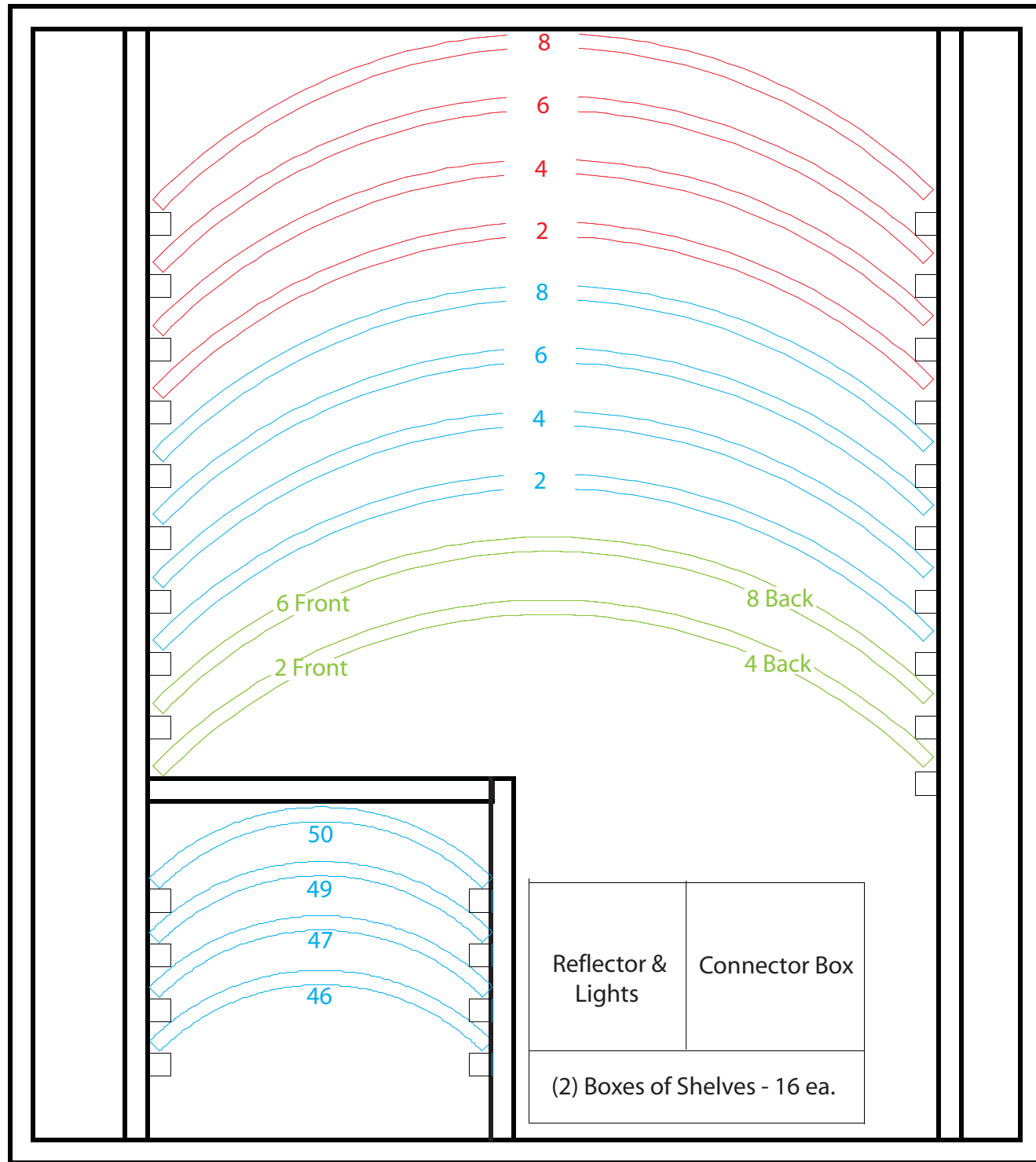

Front View of Case 2

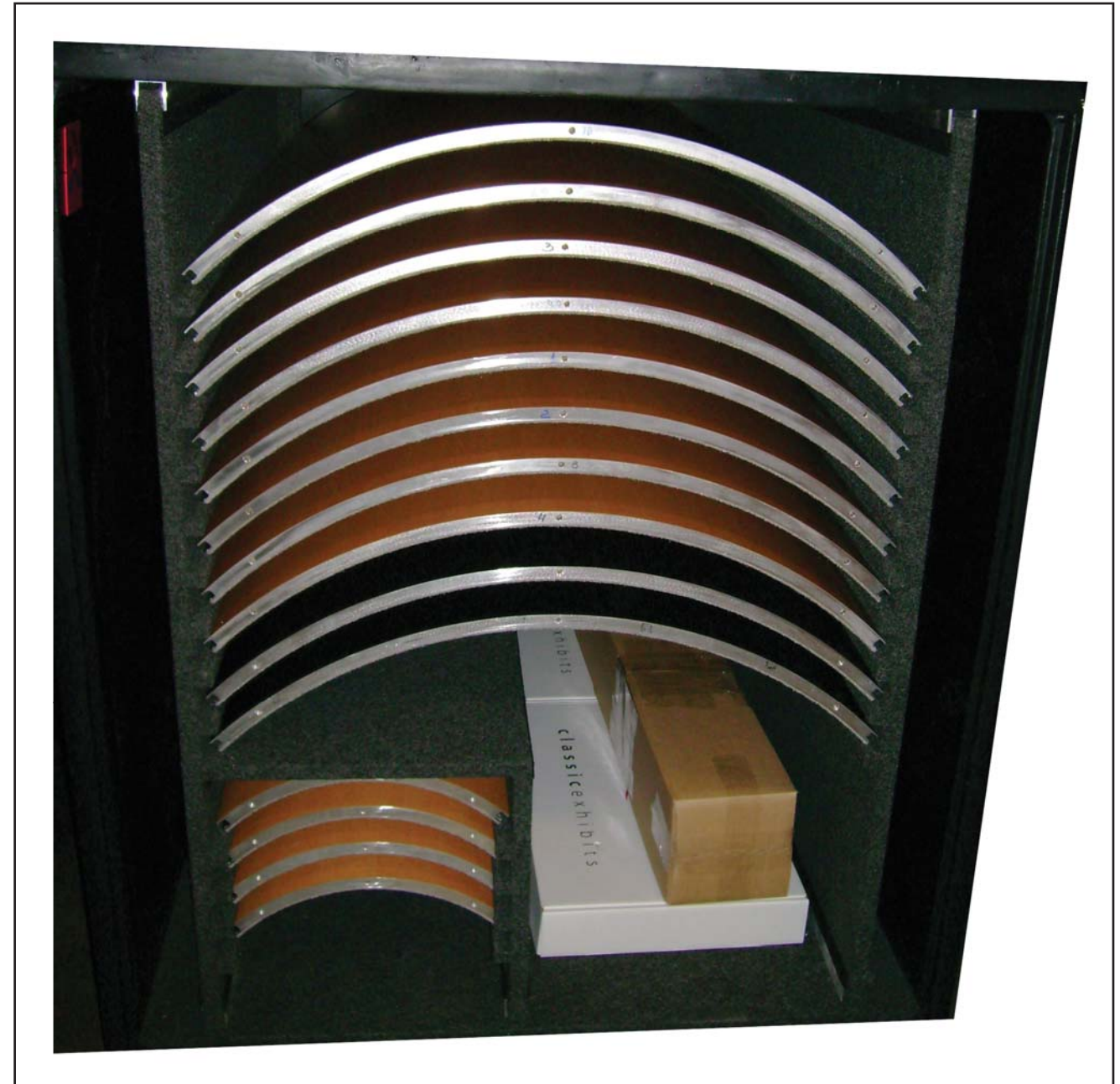

Front View of Case 2

WHEN DISASSEMBLING ALUMINUM EXTRUSION, TIGHTEN ALL SETSCREWS AND LOCKS TO PREVENT LOSS DURING SHIPPING

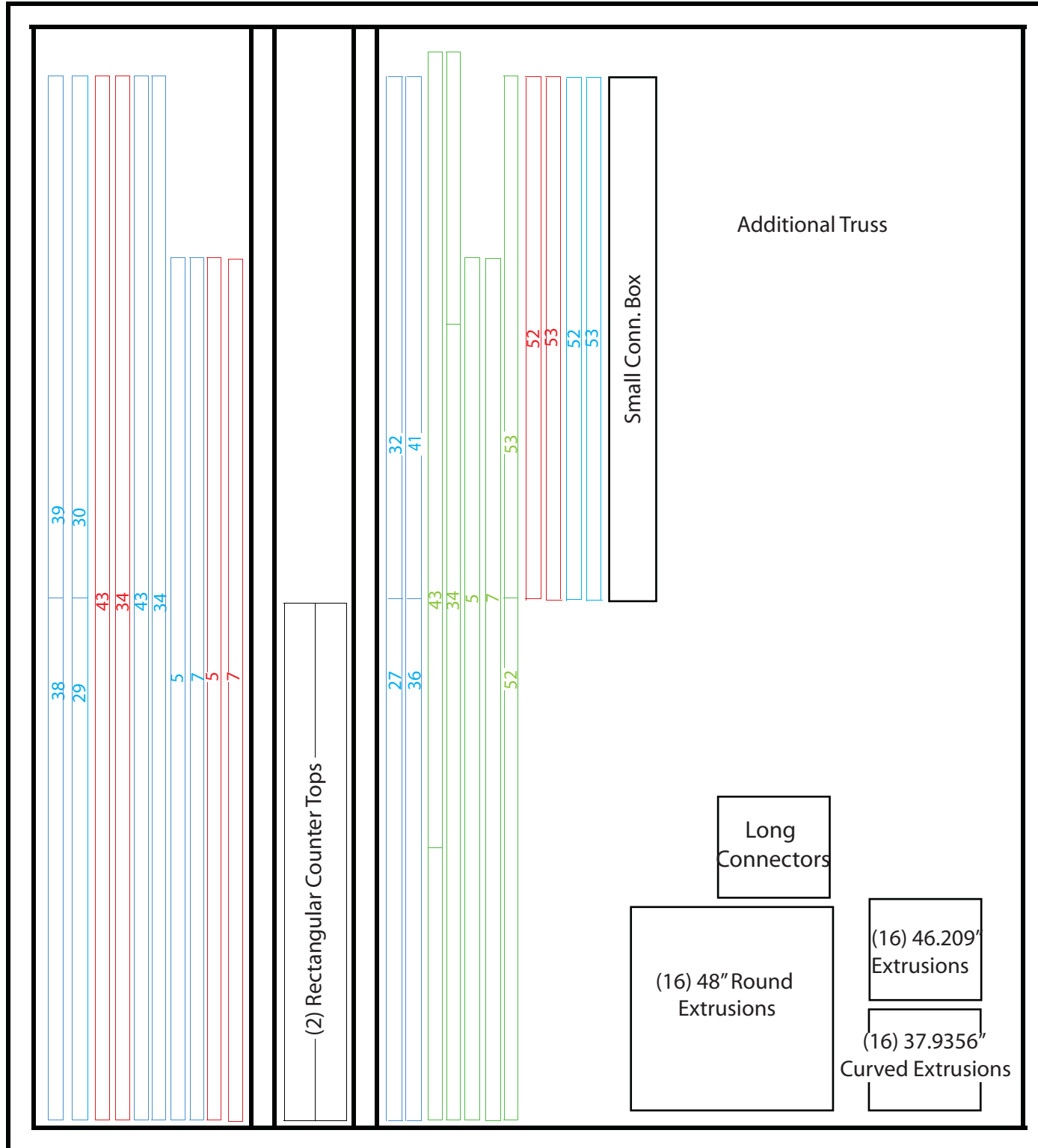

Top View of Case 3

Front View of Case 3

Note :This case also houses the additional components to create the 10 x 10 configuration.



Front View of Case 3

WHEN DISASSEMBLING ALUMINUM EXTRUSION, TIGHTEN ALL SETSCREWS AND LOCKS TO PREVENT LOSS DURING SHIPPING

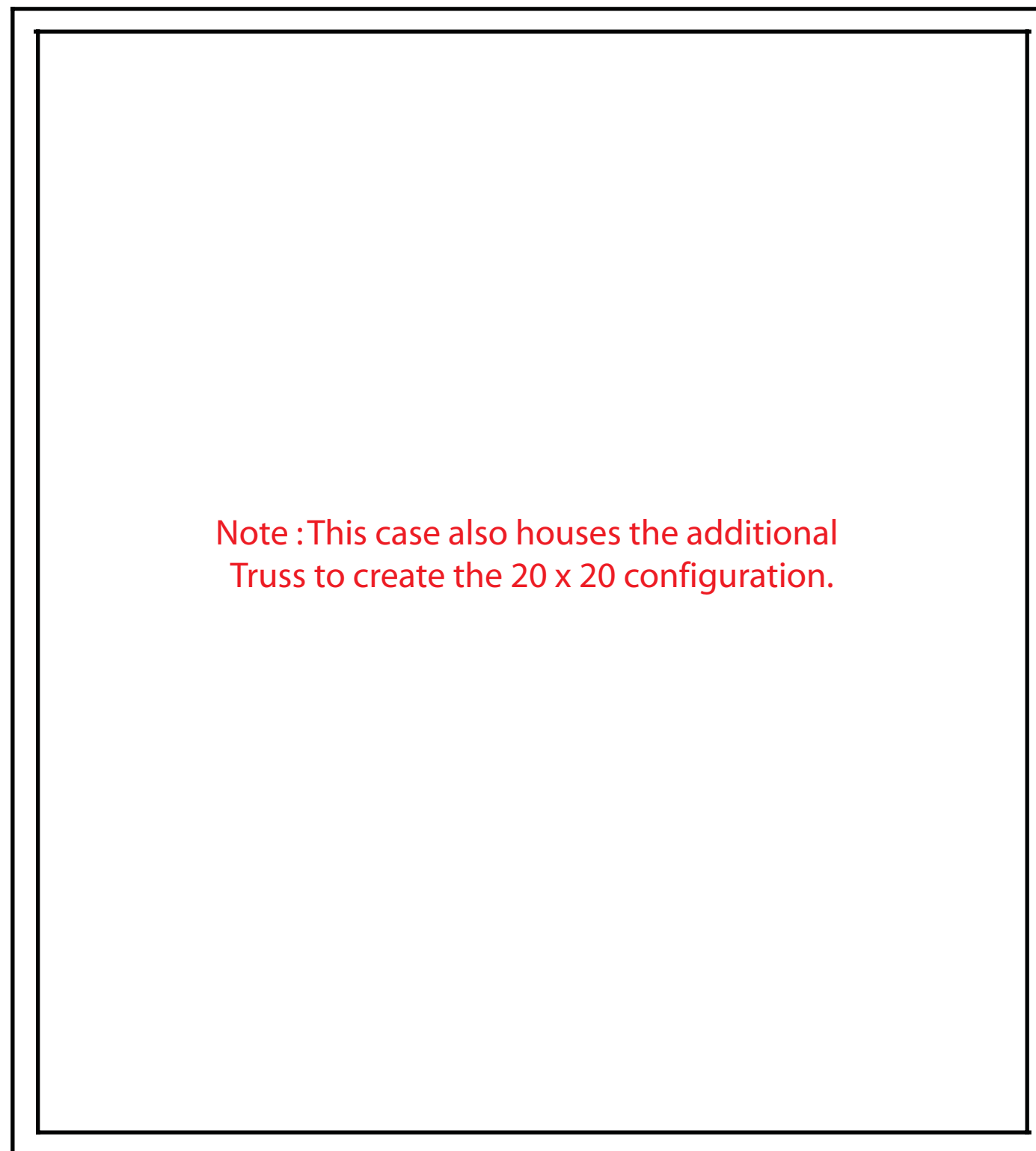

Note : This case also houses the additional Truss to create the 20 x 20 configuration.

Front View of Case 4

WHEN DISASSEMBLING ALUMINUM EXTRUSION, TIGHTEN ALL SETSCREWS AND LOCKS TO PREVENT LOSS DURING SHIPPING

NOTE :

PDF copies of your Setup Instructions are available @ classicexhibits.com
See the search tool on the lower left hand corner of the Home page.

Enter the 5 digit Order #.

Search for Setup Instructions

WHEN DISASSEMBLING ALUMINUM EXTRUSION, TIGHTEN ALL
SETSCREWS AND LOCKS TO PREVENT LOSS DURING SHIPPING

euro It | HYBRIDS

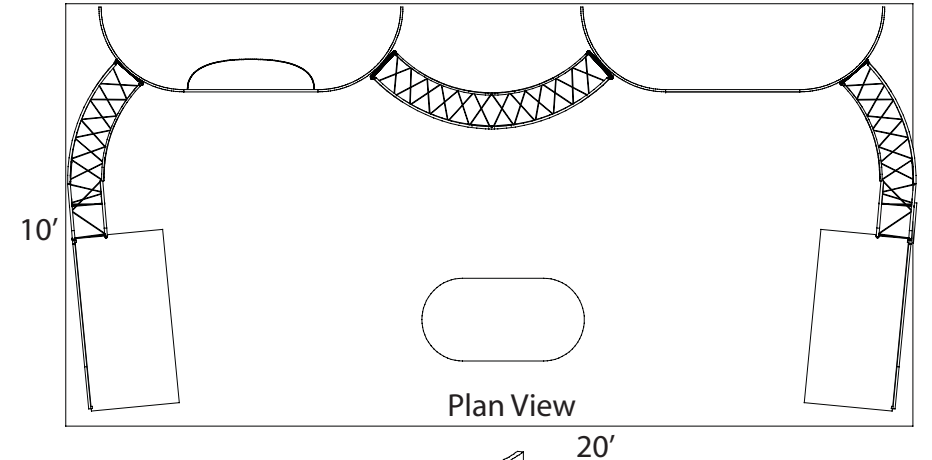
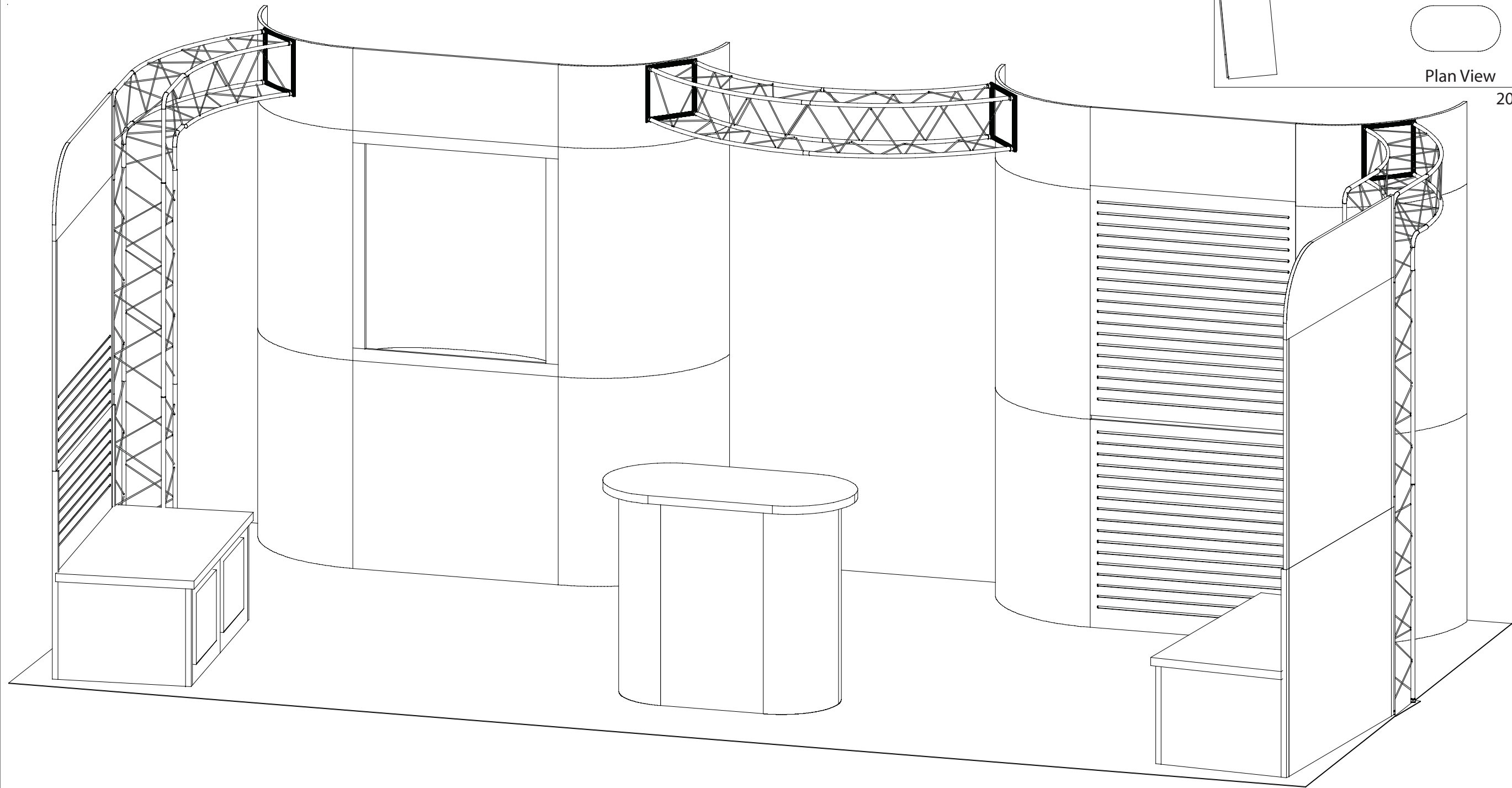

WHEN DISASSEMBLING ALUMINUM EXTRUSION, TIGHTEN ALL SETSCREWS AND LOCKS TO PREVENT LOSS DURING SHIPPING

euro lt | HYBRIDS

Using Your Setup Instructions

The Euro LT Hybrids Setup Instructions are created specifically for your configuration. They are laid out sequentially in levels, including exploded views, and a logical series of detailed steps to assemble the main structure and components. We encourage you to study the instructions **before** attempting to assemble your exhibit.

Each page reminds you to tighten the setscrews after disassembling your exhibit to prevent loss of the locks and setscrews (see below in RED). This is VERY IMPORTANT.

Cleaning and Packing Your Display

- 1) Use care when cleaning aluminum extrusion or acrylic inserts. Use only non-abrasive cleaners.
- 2) When cleaning laminate inserts, countertops, or panels use mild cleansers and a soft material such as cotton.
- 3) Keep all display components away from extreme heat and long exposure to sunlight to avoid warping and fading.
- 4) Retain all packing material. It will make re-packing much easier and will reduce the likelihood of shipping damage.

General Setup Instructions for Extrusion System



The Tool

Most exhibits can be assembled with the supplied Hex Key Tool. Occasionally, a flat head screwdriver may be required.



Typical Connection

Most horizontal extrusion connections have a patented expandable lock. This lock inserts into the groove of an opposing extrusion. Tightening the lock with the Hex Key Tool expands the lock and creates a strong positive connection.



Typical Connection (cont'd)

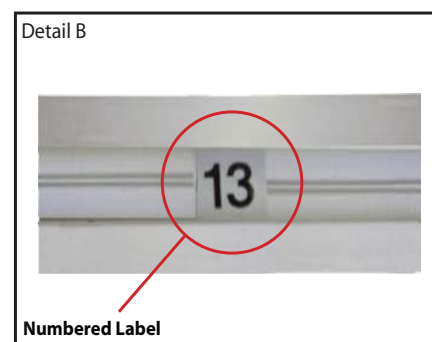

Numbered Label

Each extrusion contains a numbered label which corresponds with setup instructions. The label is located within a groove of the extrusion (when possible). With extrusion components the labels contain Black numbers unless otherwise specified.



Horizontal Inline Connection (remove only one setscrew)

Remove only (1) setscrew when disassembling. Replace setscrew in extrusion after assembling it. Before packing, replace setscrew in extrusion to avoid losing it.

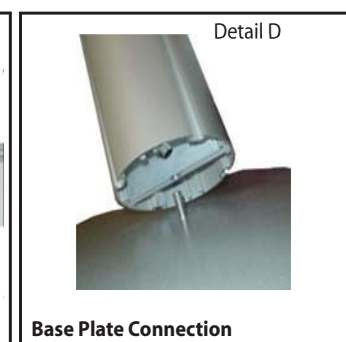

Base Plate Connection

Attach base plate to round or square vertical extrusion using the bolt provided. Be careful not to strip the threads.

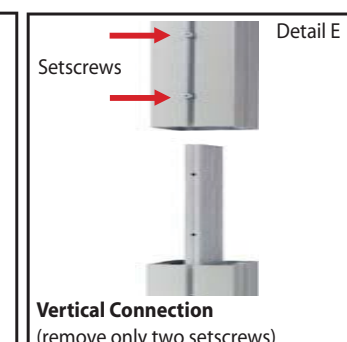

Vertical Connection (remove only two setscrews)

When vertical extrusions are packed in portable cases rather than crates or tubs, they must be broken down into smaller section which then require assembly.

Remove only (2) setscrews when disassembling. Replace setscrews in extrusion after assembling it. Before packing, replace setscrews in extrusion to avoid losing them.

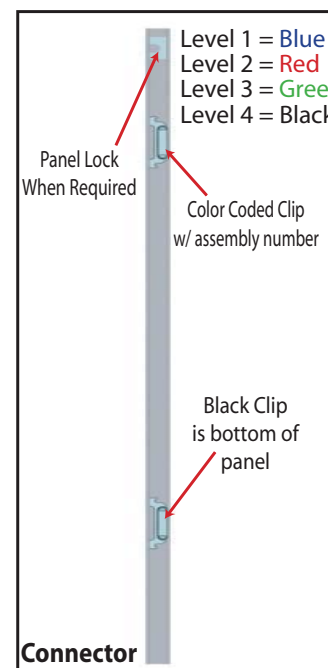

Connector

Each component has 2 clips, the lower clip is ALWAYS black. The top clip is color coded to distinguish which level. The color coded clip also contains the numbered label.

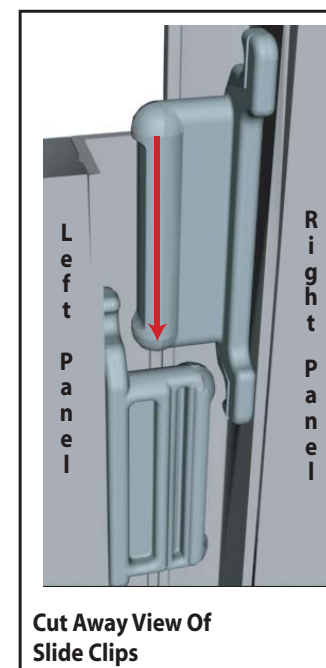

Cut Away View Of Slide Clips

Components connect together by aligning them and sliding downward connecting clips together.

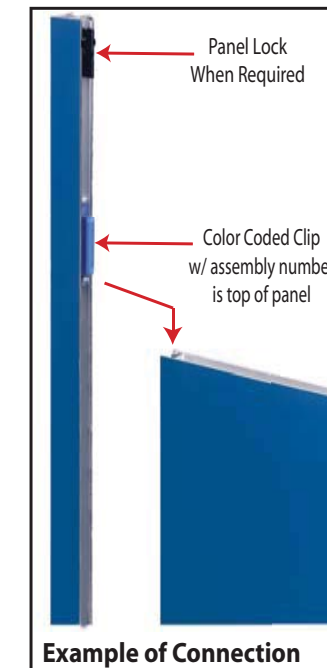

Example of Connection

Configurations are assembled from left to right, usually starting with #1 and following the numbered sequence.

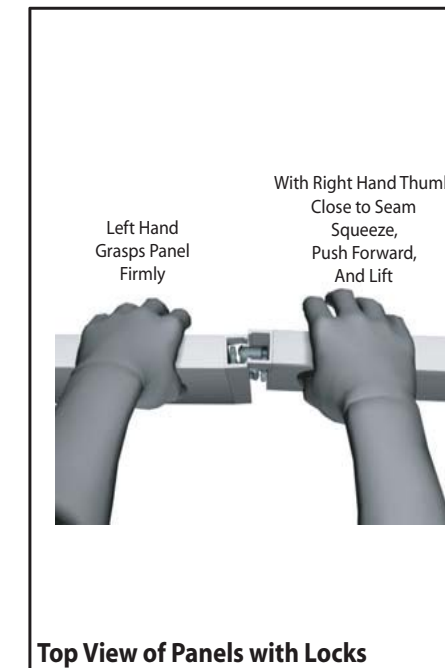

Top View of Panels with Locks

The first level of components contain panel locks that are located at the top of the panel for extra stability and seamless connection. When disassembling panels twist top connection slightly and lift right panel upward.

WHEN DISASSEMBLING ALUMINUM EXTRUSION, TIGHTEN ALL SETSCREWS AND LOCKS TO PREVENT LOSS DURING SHIPPING

Item Number	Description	Item Number	Description	Item Number	Description	Item Number	Description
1	38" w x 38" h Flat Panel w/ Slatwall	9	23" w x 19" h Flat Panel	18	23" w x 19" h Flat Panel	45	19" w x 38" h Flat Panel w/ Door
2	23" r x 38" h Curved Panel	10	19" h 90° Connector	19	19" h 90° Connector	46	11.5" r x 38" h Curved Panel
3	38" w x 38" h Flat Panel	11	23" w x 19" h Flat Panel w/ Door	20	23" w x 19" h Flat Panel w/ Door	47	11.5" r x 38" h Curved Panel
4	23" r x 38" h Curved Panel	12	23" w x 19" h Flat Panel w/ Door	21	23" w x 19" h Flat Panel w/ Door	48	19" w x 38" h Flat Panel
6	23" r x 38" h Curved Panel	13	19" h 90° Connector	22	19" h 90° Connector	49	11.5" r x 38" h Curved Panel
8	23" r x 38" h Curved Panel	14	23" w x 19" h Flat Panel	23	23" w x 19" h Flat Panel	50	11.5" r x 38" h Curved Panel
		15	38" h Custom Milled 90° Connector	24	38" h Custom Milled 90° Connector		
		16	46" w x 38" h Flat Panel w/ Slatwall	25	46" w x 38" h Flat Panel w/ Slatwall		
		17	38" h Custom Milled 90° Connector	26	38" h Custom Milled 90° Connector		



Steps:
Starting with panel # 4 (*) connect panels together in order as shown in illustrations.

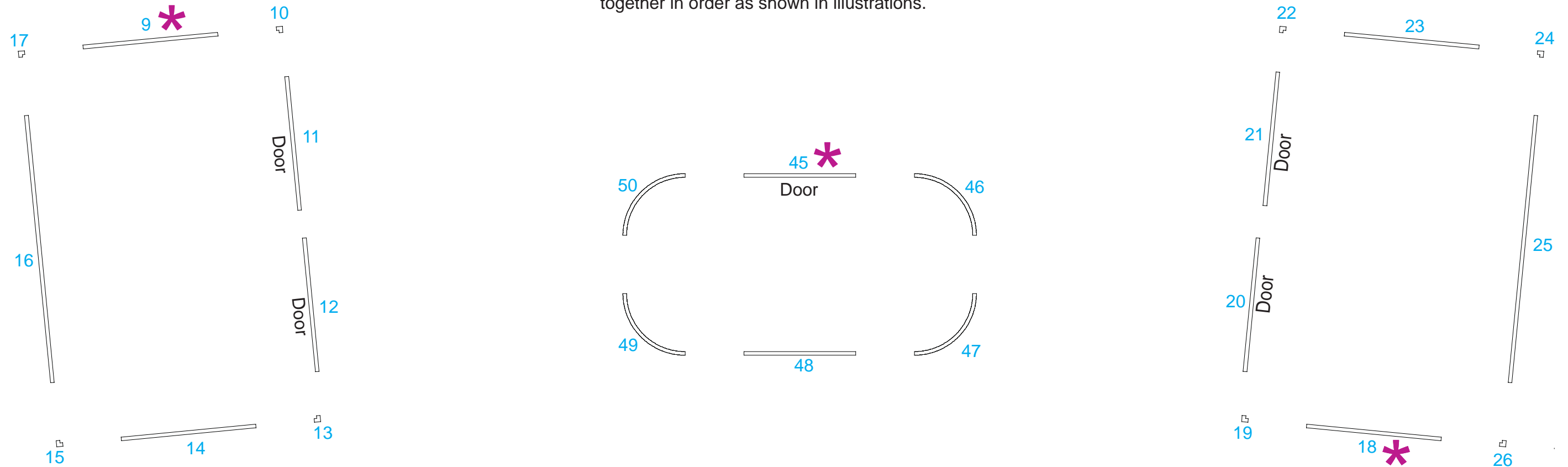

WHEN DISASSEMBLING ALUMINUM EXTRUSION, TIGHTEN ALL SETSCREWS AND LOCKS TO PREVENT LOSS DURING SHIPPING

Place Counters atop assembled sections as shown below.

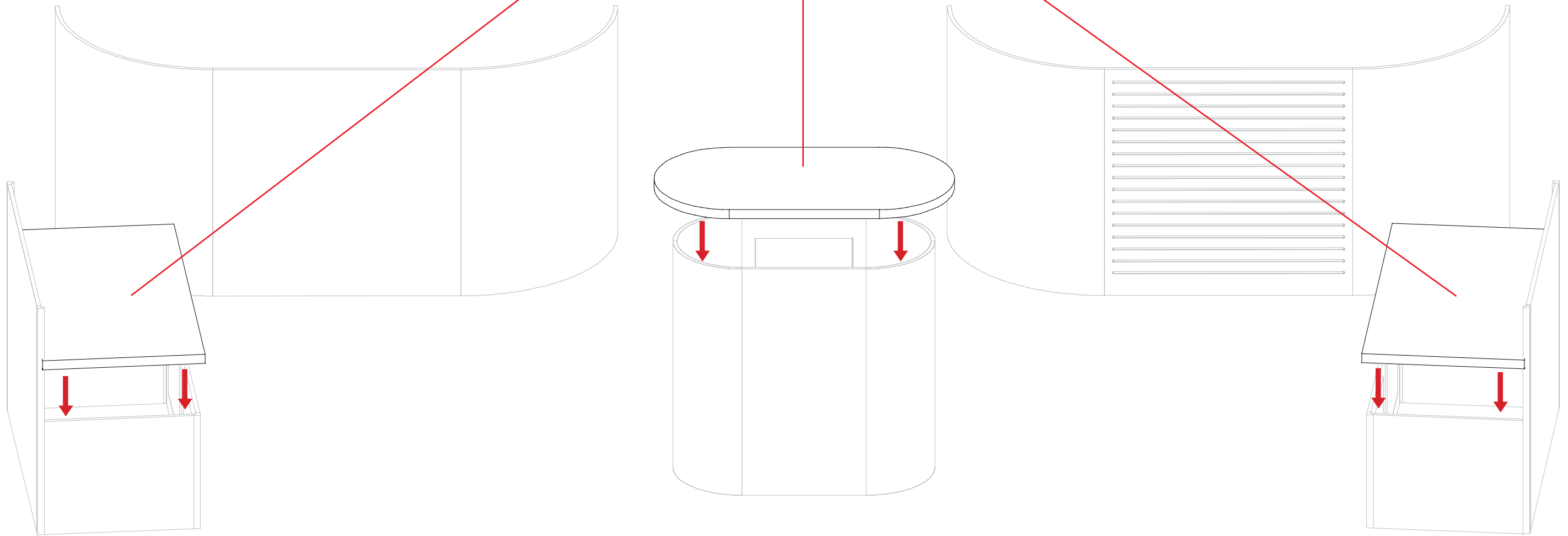

WHEN DISASSEMBLING ALUMINUM EXTRUSION, TIGHTEN ALL SETSCREWS AND LOCKS TO PREVENT LOSS DURING SHIPPING

Item Number	Description	Item Number	Description	Item Number	Description
1	38" w x 42" h Flat Panel w/ Slatwall	15	42" h End Cap	24	42" h End Cap
2	23" r x 42" h Curved Panel	16	46" w x 42" h Flat Panel w/ Slatwall	25	46" w x 42" h Flat Panel w/ Slatwall
3	38" w x 42" h Flat Window Panel	17	42" h End Cap	26	42" h End Cap
4	23" r x 42" h Curved Panel				
6	23" r x 42" h Curved Panel				
8	23" r x 42" h Curved Panel				

866.652.2100

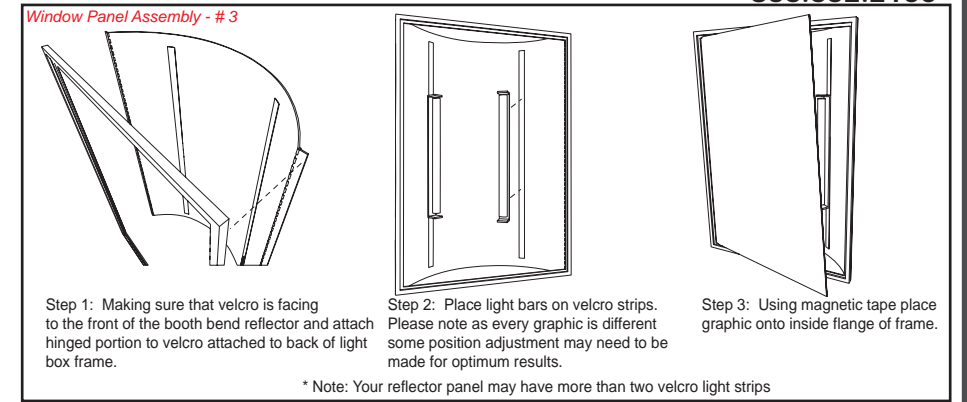

Steps:
Starting with panel # 4 (*) connect panels together in order as shown in illustrations.

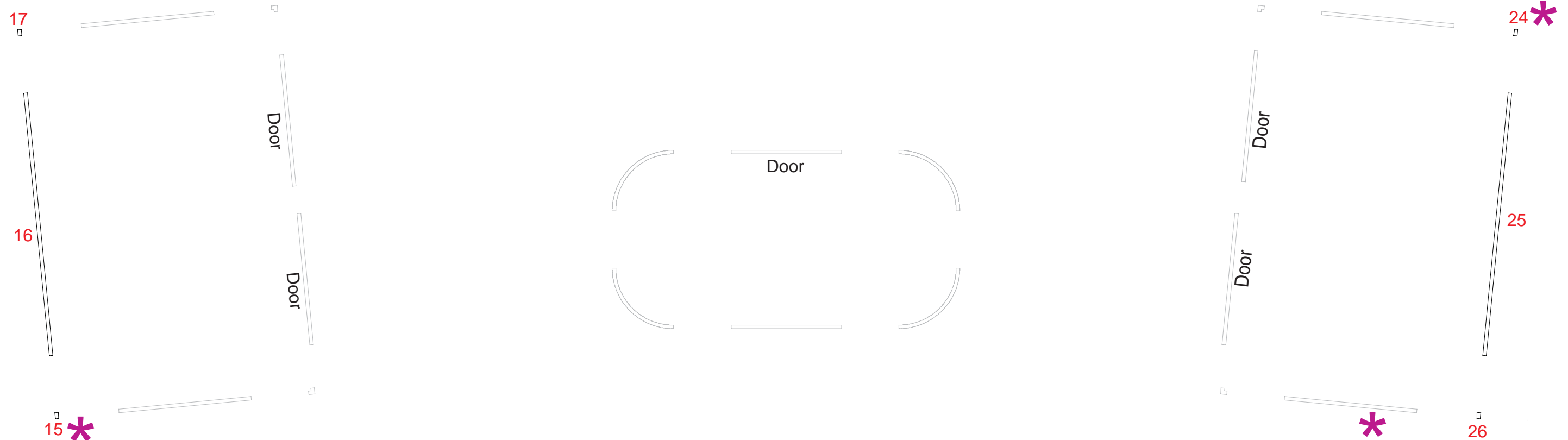

WHEN DISASSEMBLING ALUMINUM EXTRUSION, TIGHTEN ALL SETSCREWS AND LOCKS TO PREVENT LOSS DURING SHIPPING

Item Number	Description	Item Number	Description	Item Number	Description
1	38" w x 15" h Flat Panel w/ Slatwall	15	15" h End Cap	25	46" w x 15" h Flat Panel w/ Slatwall
2	23" r x 15" h Curved Panel	16	46" w x 15" h Flat Panel w/ Slatwall	26	15" h End Cap
3	38" w x 15" h Flat Panel				
4	23" r x 15" h Curved Panel				
6	23" r x 15" h Curved Panel				
8	23" r x 15" h Curved Panel				



Steps:
Starting with panel # 4 (*) connect panels together in order as shown in illustrations.

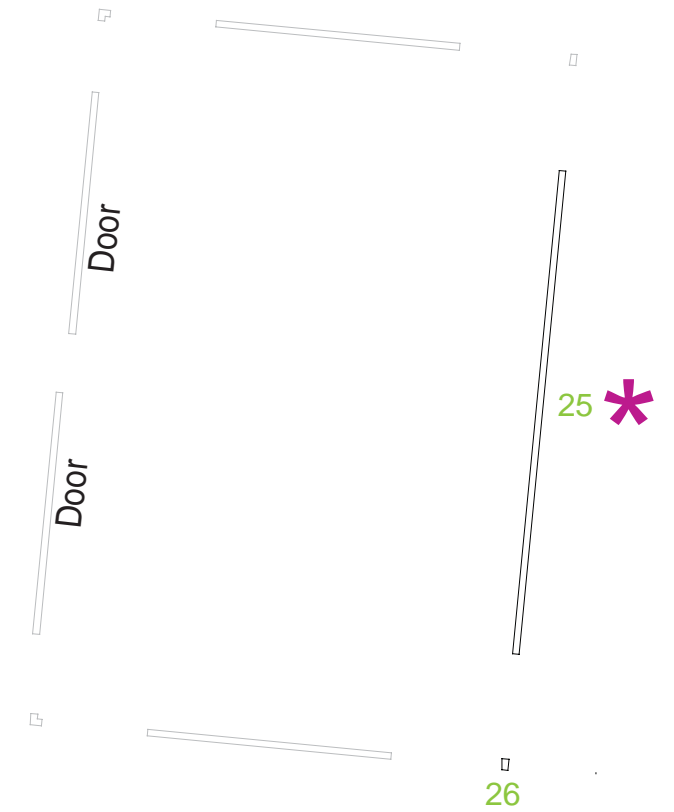
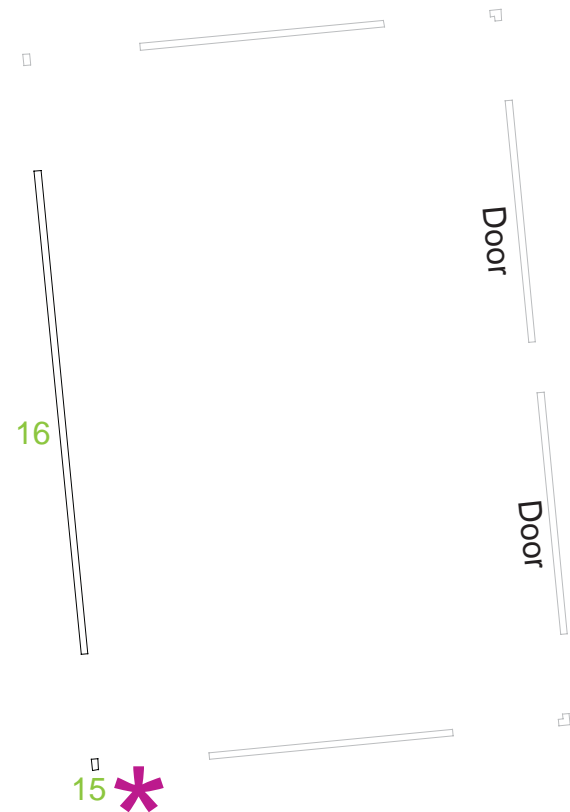

WHEN DISASSEMBLING ALUMINUM EXTRUSION, TIGHTEN ALL SETSCREWS AND LOCKS TO PREVENT LOSS DURING SHIPPING

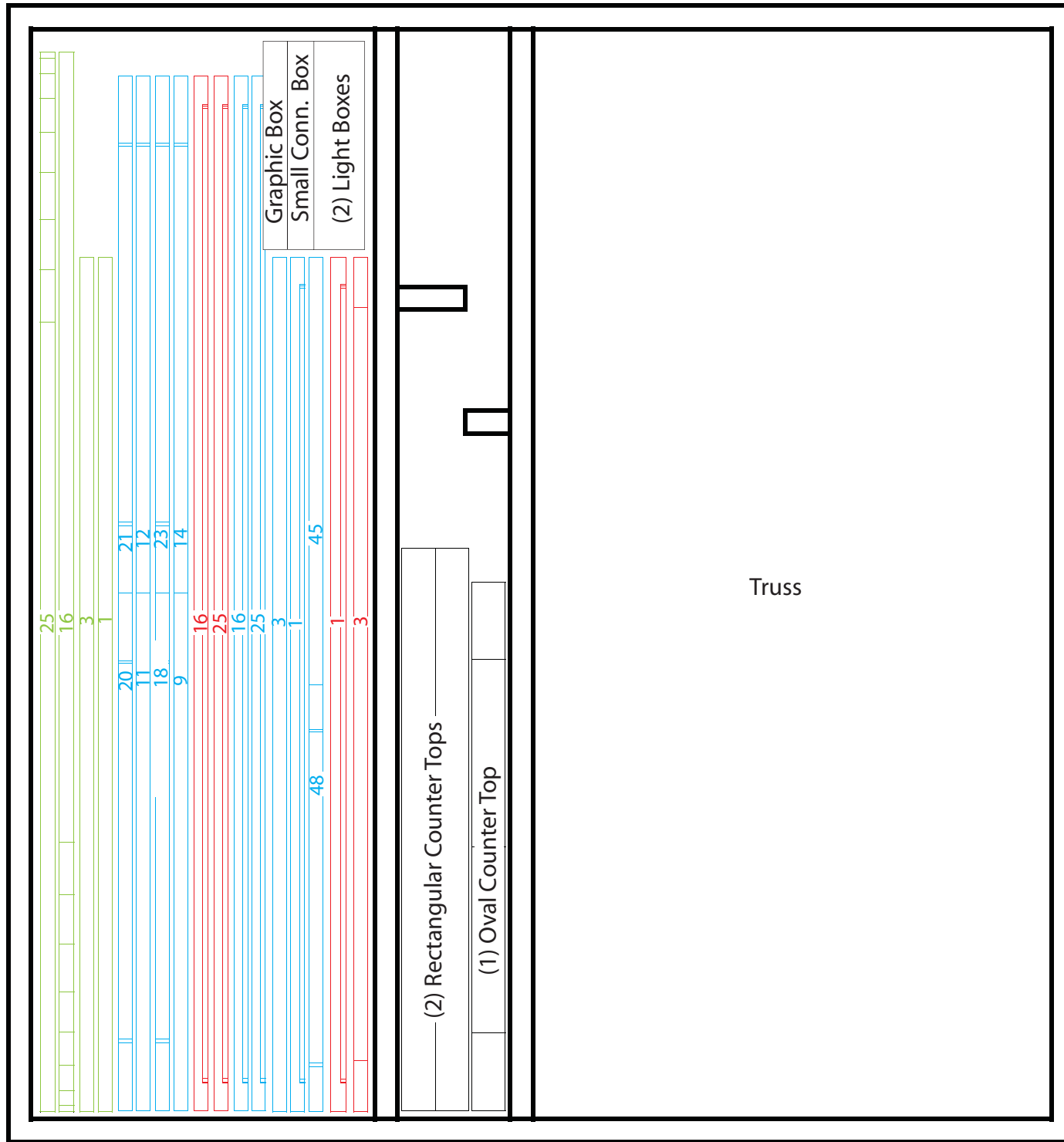

Top View of Case 1

Front View of Case 1



Front View of Case 1

WHEN DISASSEMBLING ALUMINUM EXTRUSION, TIGHTEN ALL SETSCREWS AND LOCKS TO PREVENT LOSS DURING SHIPPING

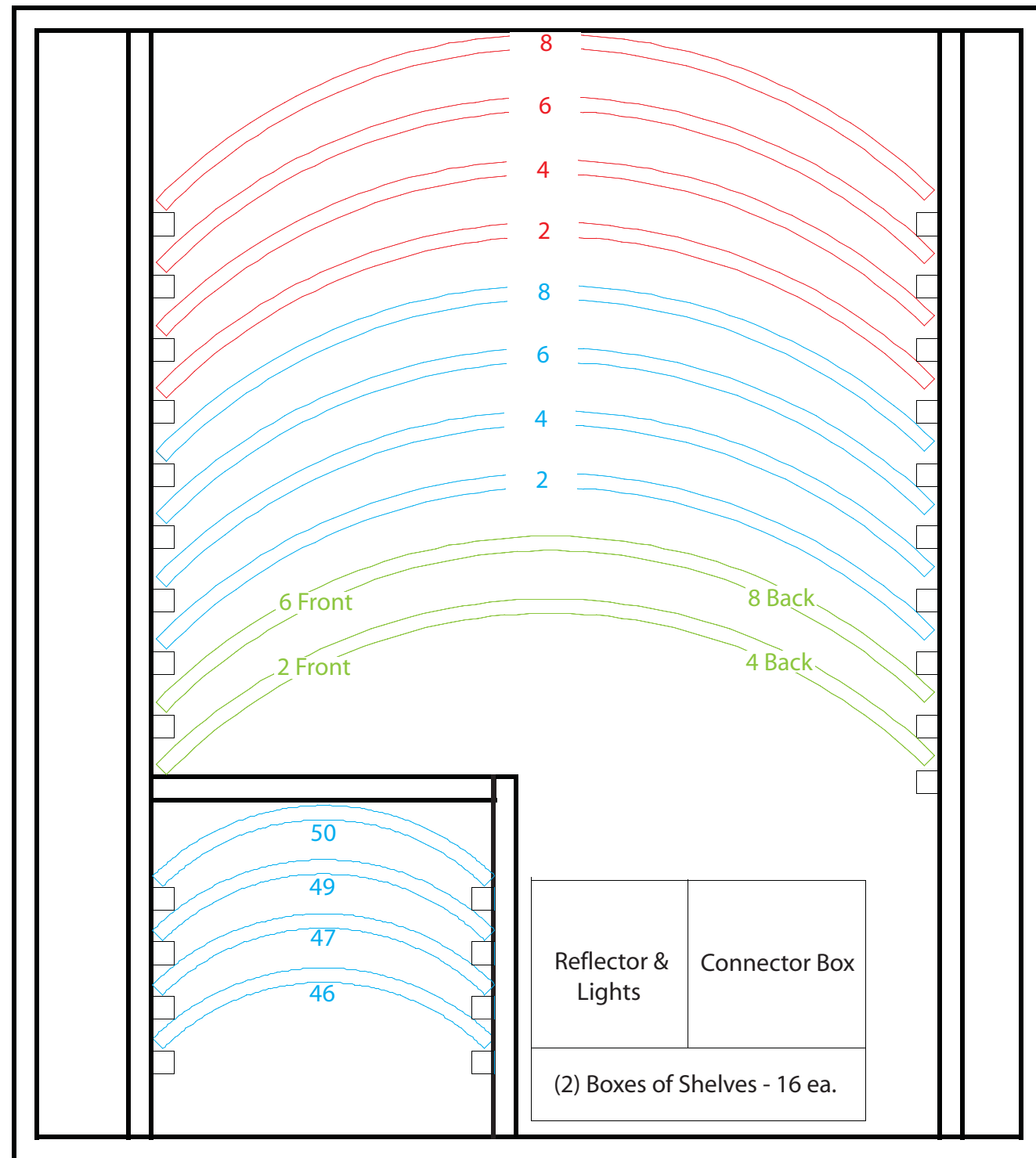

Front View of Case 2



Front View of Case 2

WHEN DISASSEMBLING ALUMINUM EXTRUSION, TIGHTEN ALL SETSCREWS AND LOCKS TO PREVENT LOSS DURING SHIPPING

NOTE :

PDF copies of your Setup Instructions are available @ classicexhibits.com
See the search tool on the lower left hand corner of the Home page.

Enter the 5 digit Order #.

Search for Setup Instructions

WHEN DISASSEMBLING ALUMINUM EXTRUSION, TIGHTEN ALL
SETSCREWS AND LOCKS TO PREVENT LOSS DURING SHIPPING

euro It | *HYBRIDS*

866.652.2100

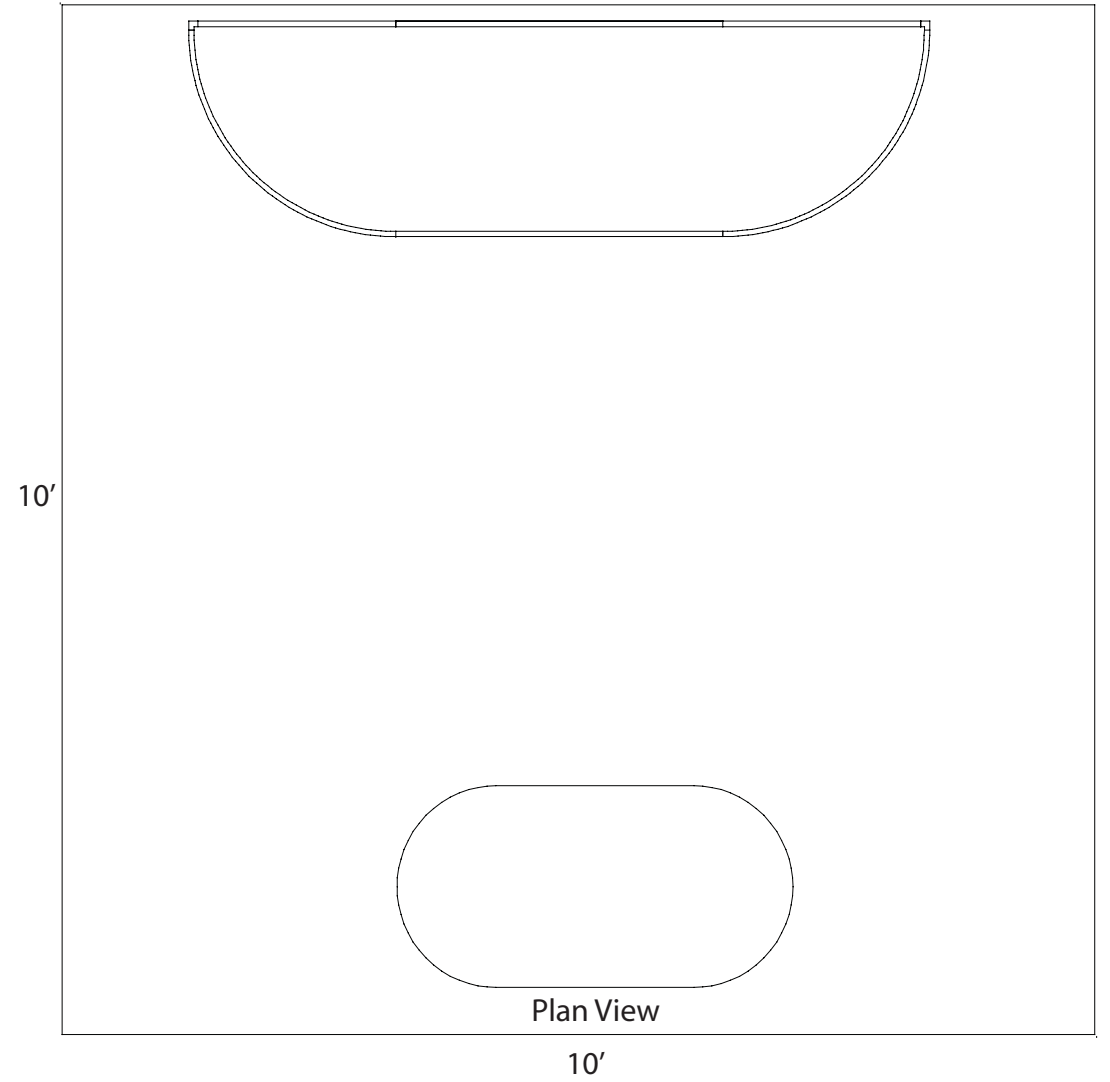
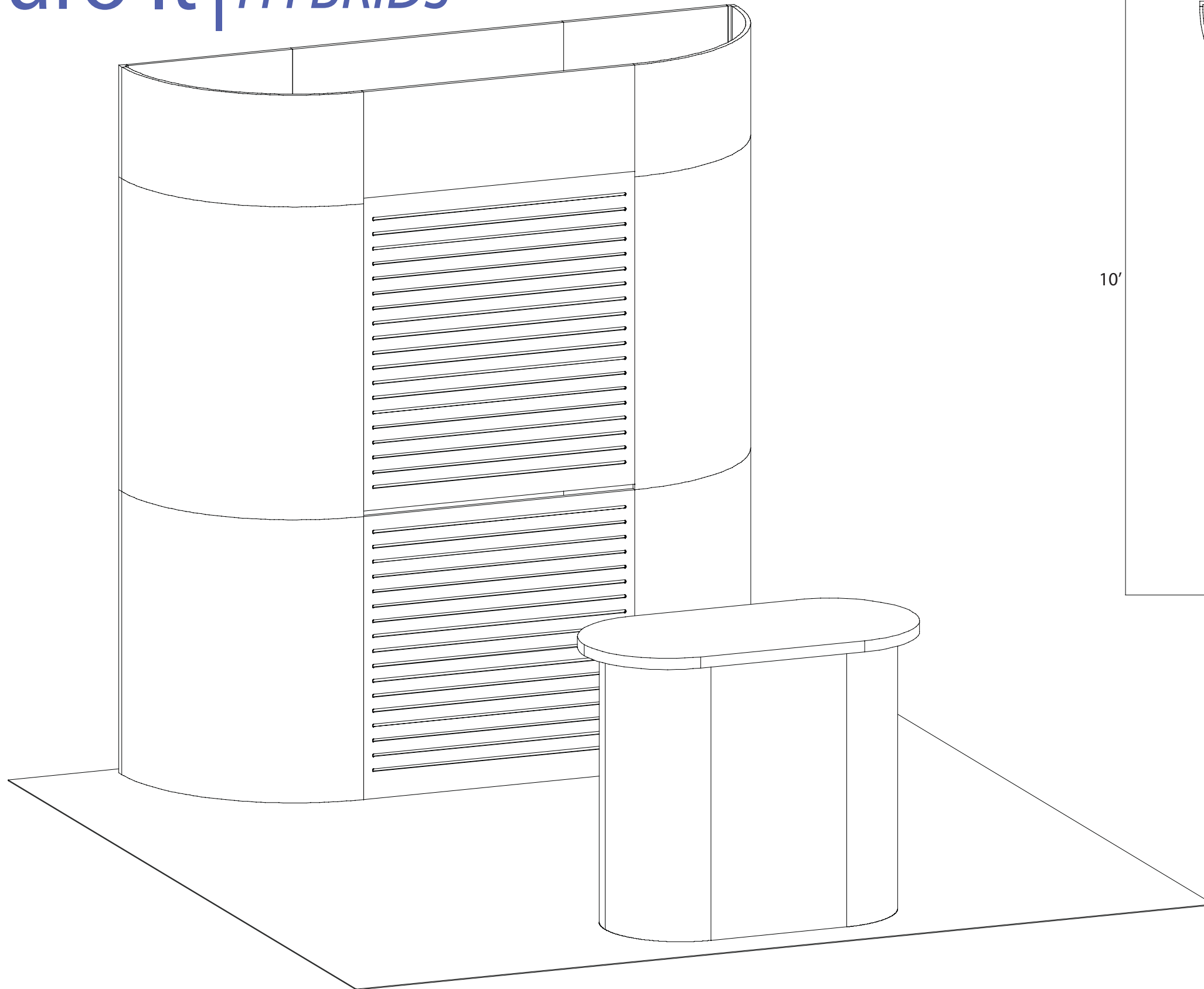

euro lt | HYBRIDS

Using Your Setup Instructions

The Euro LT Hybrids Setup Instructions are created specifically for your configuration. They are laid out sequentially in levels, including exploded views, and a logical series of detailed steps to assemble the main structure and components. We encourage you to study the instructions **before** attempting to assemble your exhibit.

Each page reminds you to tighten the setscrews after disassembling your exhibit to prevent loss of the locks and setscrews (see below in RED). This is VERY IMPORTANT.

Cleaning and Packing Your Display

- 1) Use care when cleaning aluminum extrusion or acrylic inserts. Use only non-abrasive cleaners.
- 2) When cleaning laminate inserts, countertops, or panels use mild cleansers and a soft material such as cotton.
- 3) Keep all display components away from extreme heat and long exposure to sunlight to avoid warping and fading.
- 4) Retain all packing material. It will make re-packing much easier and will reduce the likelihood of shipping damage.

General Setup Instructions for Extrusion System



The Tool

Most exhibits can be assembled with the supplied Hex Key Tool. Occasionally, a flat head screwdriver may be required.



Typical Connection

Most horizontal extrusion connections have a patented expandable lock. This lock inserts into the groove of an opposing extrusion. Tightening the lock with the Hex Key Tool expands the lock and creates a strong positive connection.



Typical Connection (cont'd)

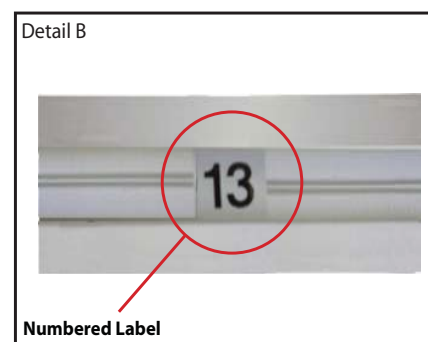

Numbered Label

Each extrusion contains a numbered label which corresponds with setup instructions. The label is located within a groove of the extrusion (when possible). With extrusion components the labels contain Black numbers unless otherwise specified.



Horizontal Inline Connection (remove only one setscrew)

Remove only (1) setscrew when disassembling. Replace setscrew in extrusion after assembling it. Before packing, replace setscrew in extrusion to avoid losing it.

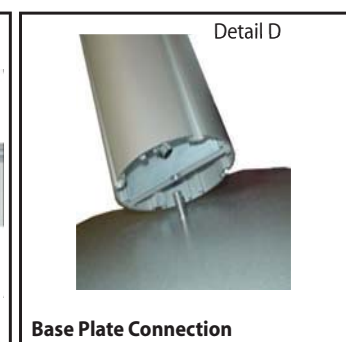

Base Plate Connection

Attach base plate to round or square vertical extrusion using the bolt provided. Be careful not to strip the threads.

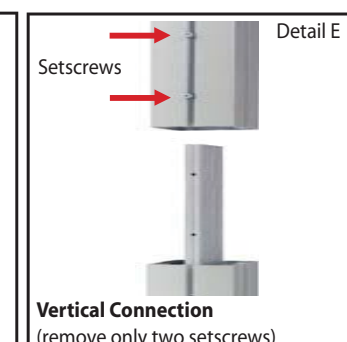

Vertical Connection (remove only two setscrews)

When vertical extrusions are packed in portable cases rather than crates or tubs, they must be broken down into smaller section which then require assembly.

Remove only (2) setscrews when disassembling. Replace setscrews in extrusion after assembling it. Before packing, replace setscrews in extrusion to avoid losing them.

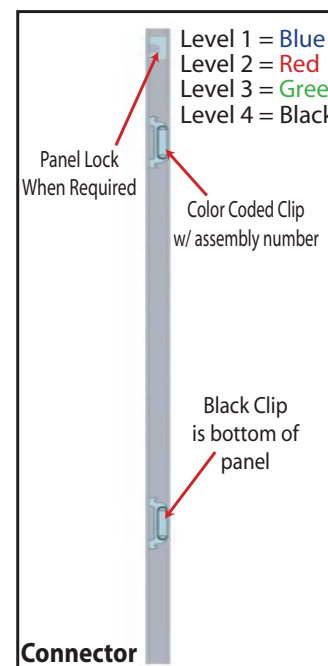

Connector

Each component has 2 clips, the lower clip is ALWAYS black. The top clip is color coded to distinguish which level. The color coded clip also contains the numbered label.

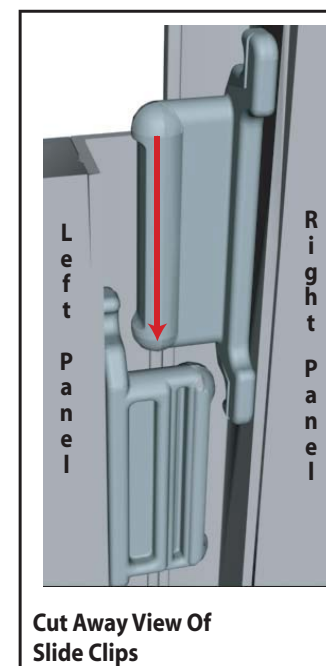

Cut Away View Of Slide Clips

Components connect together by aligning them and sliding downward connecting clips together.

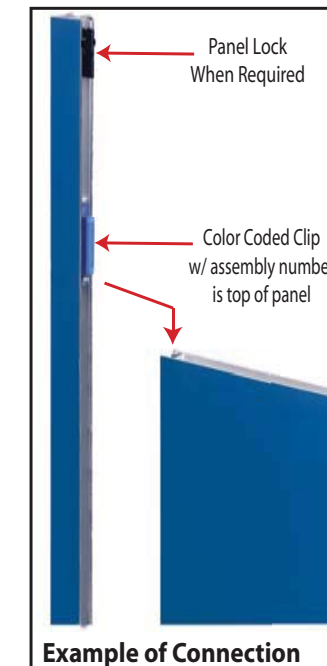

Example of Connection

Configurations are assembled from left to right, usually starting with #1 and following the numbered sequence.

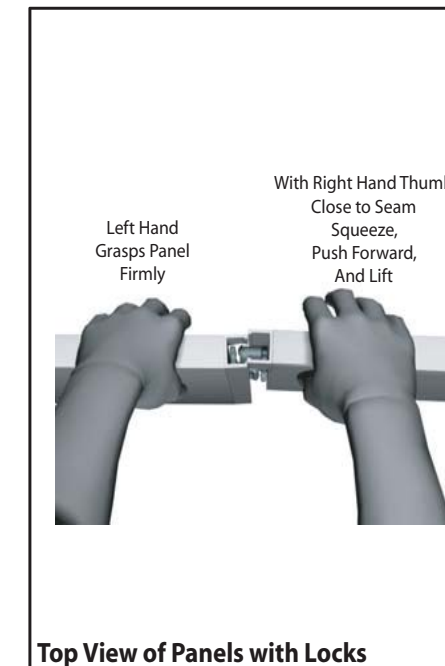

Top View of Panels with Locks

The first level of components contain panel locks that are located at the top of the panel for extra stability and seamless connection. When disassembling panels twist top connection slightly and lift right panel upward.

866.652.2100

Item Number	Description
1	38" w x 38" h Flat Panel w/ Slatwall
2	23" r x 38" h Curved Panel
5	38" w x 38" h Flat Panel w/ Slatwall
8	23" r x 38" h Curved Panel
45	19" w x 38" h Flat Panel w/ Door
46	11.5" r x 38" h Curved Panel
47	11.5" r x 38" h Curved Panel
48	19" w x 38" h Flat Panel
49	11.5" r x 38" h Curved Panel
50	11.5" r x 38" h Curved Panel
51	38" h 90° Connector
52	23" w x 38" h Flat Panel
53	23" w x 38" h Flat Panel
54	38" h 90° Connector

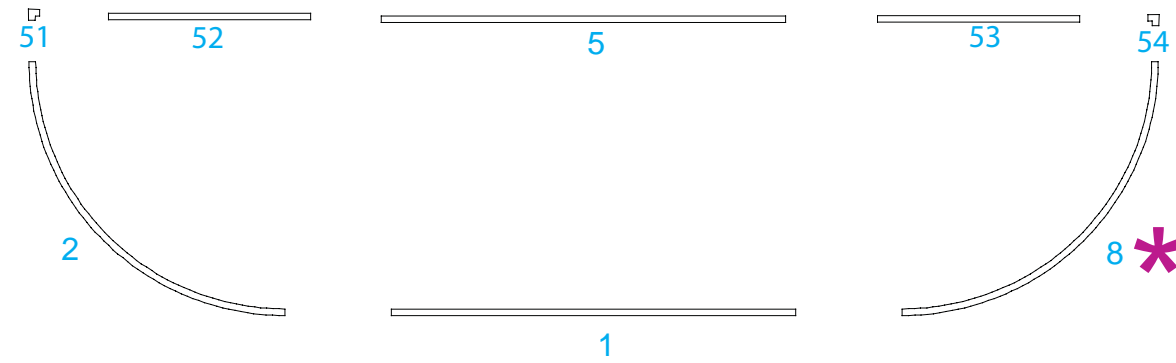

Steps:
Starting with panel # 8 (*) connect panels together in order as shown in illustrations.

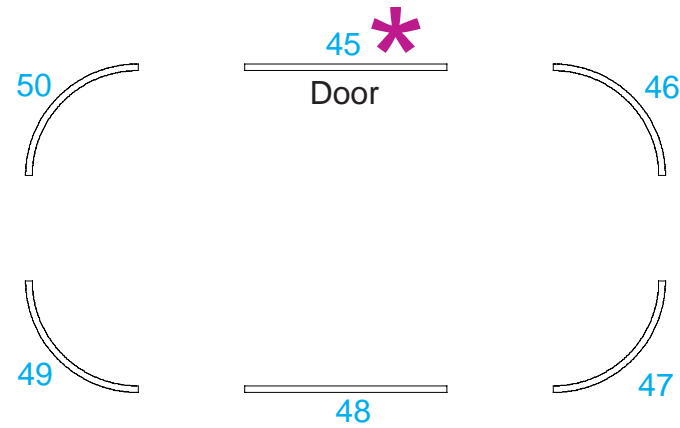

Place Counter atop assembled Pedestal.

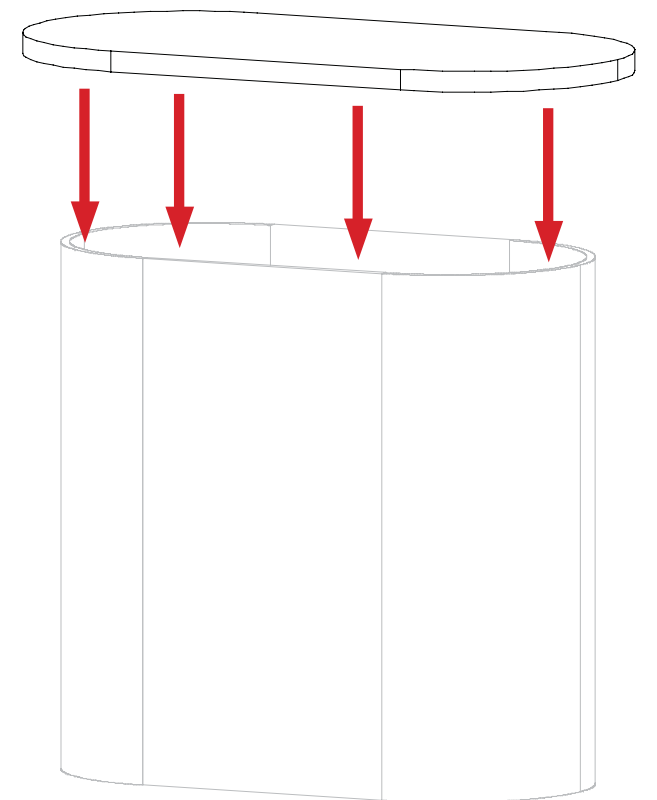

Item Number	Description
1	38" w x 42" h Flat Panel w/ Slatwall
2	23" r x 42" h Curved Panel
5	38" w x 42" h Flat Panel w/ Slatwall
8	23" r x 42" h Curved Panel
51	42" h 90° Connector
52	23" w x 42" h Flat Panel
53	23" w x 42" h Flat Panel
54	42" h 90° Connector

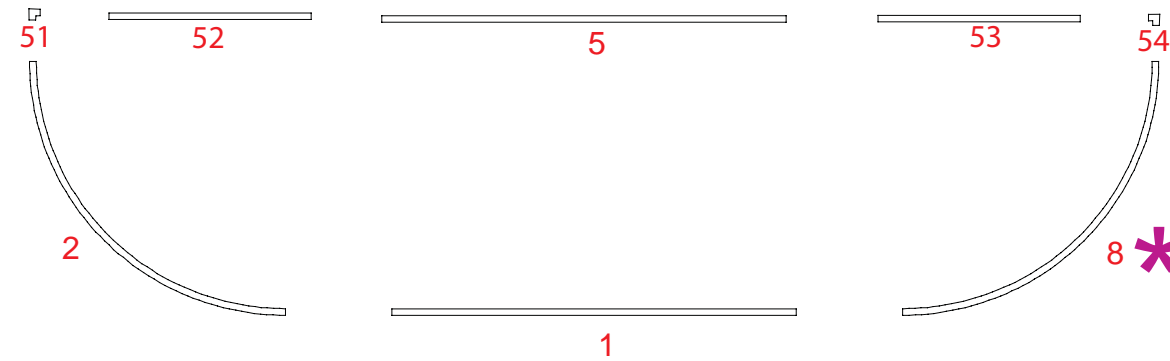

Steps:
 Starting with panel # 8 (✳) connect panels together in order as shown in illustrations.

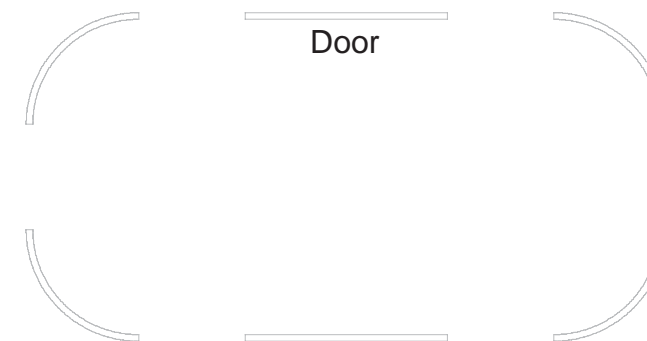

866.652.2100

Item Number	Description
1	38" w x 15" h Flat Panel
2	23" r x 15" h Curved Panel
5	38" w x 15" h Flat Panel
8	23" r x 15" h Curved Panel
51	15" h 90° Connector
52	23" w x 15" h Flat Panel
53	23" w x 15" h Flat Panel
54	15" h 90° Connector

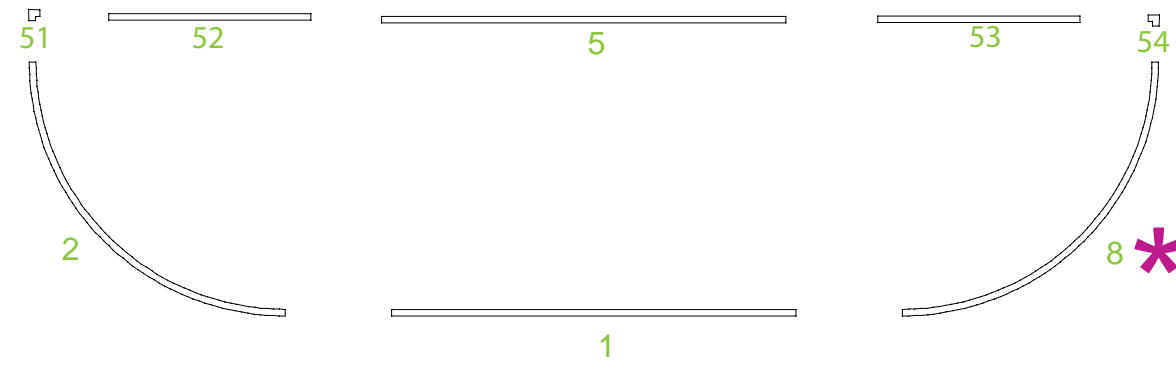

Steps:
 Starting with panel # 8 (*) connect panels together in order as shown in illustrations.

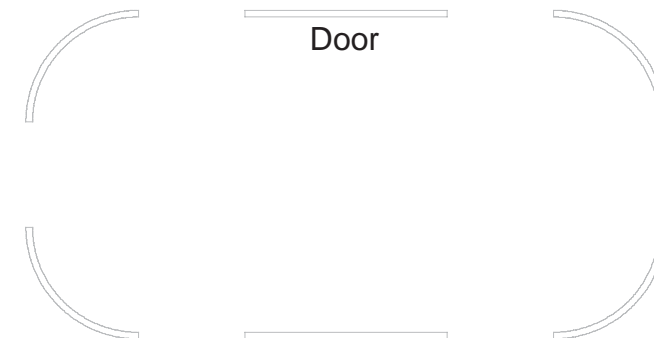

NOTE :

PDF copies of your Setup Instructions are available @ classicexhibits.com
See the search tool on the lower left hand corner of the Home page.

Enter the 5 digit Order #.

Search for Setup Instructions