

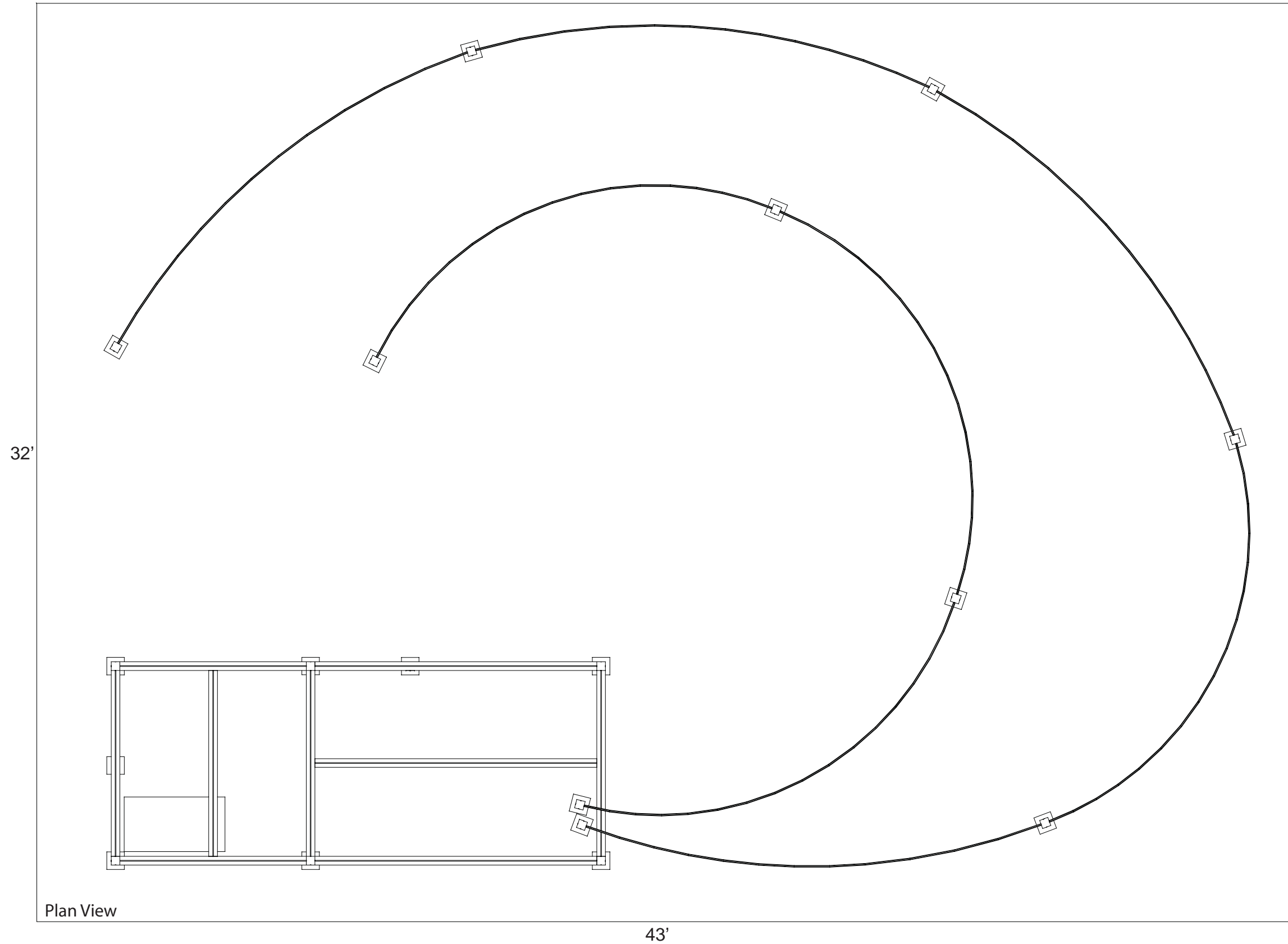

WHEN DISASSEMBLING ALUMINUM EXTRUSION, TIGHTEN ALL SETSCREWS AND LOCKS TO PREVENT LOSS DURING SHIPPING



WHEN DISASSEMBLING ALUMINUM EXTRUSION, TIGHTEN ALL SETSCREWS AND LOCKS TO PREVENT LOSS DURING SHIPPING

visionary™ DESIGNS

Using Your Setup Instructions

The Visionary Designs Setup Instructions are created specifically for your configuration. They are laid out sequentially, including an exploded view of the entire display, and then a logical series of detailed steps to assemble the main structure and components. We encourage you to study the instructions **before** attempting to assemble your exhibit.

Each page reminds you to tighten the setscrews after disassembling your exhibit to prevent loss of the locks and setscrews (see below in RED). This is **VERY IMPORTANT**.

Cleaning and Packing Your Display

- 1) Use care when cleaning aluminum extrusion or acrylic inserts. Use only non-abrasive cleaners.
- 2) When cleaning laminate inserts or countertops, use mild cleansers and a soft material such as cotton.
- 3) Keep all display components away from extreme heat and long exposure to sunlight to avoid warping and fading.
- 4) Retain all packing material. It will make re-packing much easier and will reduce the likelihood of shipping damage.



The Tool

Most Visionary Designs exhibits can be assembled with the supplied Hex Key Tool. Occasionally, a flat head screwdriver may be required.



Typical Connection

Most horizontal extrusion connections have a patented expandable lock. This lock inserts into the groove of an opposing extrusion. Tightening the lock with the Hex Key Tool expands the lock and creates a strong positive connection.



Typical Connection (cont'd)

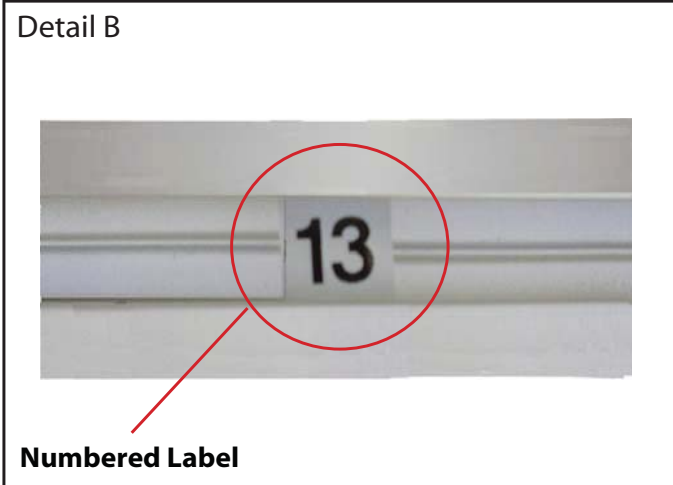

Numbered Label

Each extrusion contains a numbered label which corresponds with setup instructions. The label is located within a groove of the extrusion (when possible). With Visionary Designs the labels contain Black numbers unless otherwise specified.



Horizontal Inline Connection (remove only one setscrew)

Remove only (1) setscrew when disassembling. Replace setscrew in extrusion after assembling it. Before packing, replace setscrew in extrusion to avoid losing it.

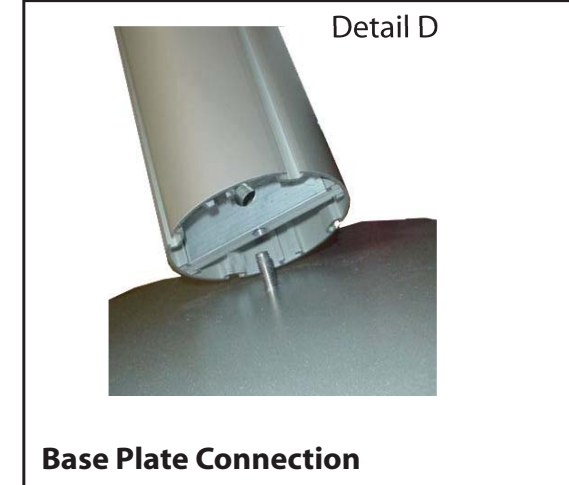

Base Plate Connection

Attach base plate to round or square vertical extrusion using the bolt provided. Be careful not to strip the threads.

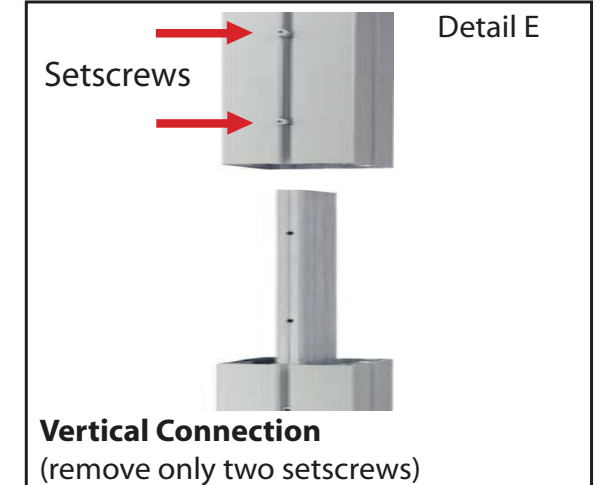

Vertical Connection
(remove only two setscrews)

When vertical extrusions are packed in portable cases rather than crates or tubs, they must be broken down into smaller sections which then require assembly.

Remove only (2) setscrews when disassembling. Replace setscrews in extrusion after assembling it. Before packing, replace setscrews in extrusion to avoid losing them.

WHEN DISASSEMBLING ALUMINUM EXTRUSION, TIGHTEN ALL SETSCREWS AND LOCKS TO PREVENT LOSS DURING SHIPPING

866.652.2100

Part Number	Qty	Description
1	8	Square Base Plates
2/2A	1/1	57.2635" h Vertical extrusion w/Door Hardware
3/3A	1/1	59.055" h Vertical extrusion w/Door Hardware
4/4A	1/1	59.055" h Vertical extrusion w/Door Hardware
5/5A	1/1	57.2635" h Vertical extrusion w/Door Hardware
6/6A	4/4	59.055" h Vertical extrusion
7	1	35.827" w Horizontal extrusion
8	4	76.929" w Horizontal extrusion
9	1	75.197" w Horizontal extrusion
10/10A	1/1	58.1495" w Horizontal extrusion

Steps

- 1) Connect vertical extrusions [2 to 2A, 3 to 3A, 4 to 4A, 5 to 5A, and 6 to 6A] as shown at right.
- 2) Attach vertical assemblies [2/2A, 3/3A, 4/4A, 5/5A, and 6/6A] to the square base plates [1].
- 3) Connect horizontal extrusion [7] between vertical assemblies [6/6A and 2/2A].
- 4) Connect horizontal extrusions [8] between vertical assemblies [3/3A, 4/4A, 5/5A, and 6/6A].
- 5) Connect horizontal extrusion [10 to 10A].
- 6) Connect horizontal extrusions [9 and 10/10A] between vertical assemblies [5/5A and 6/6A].

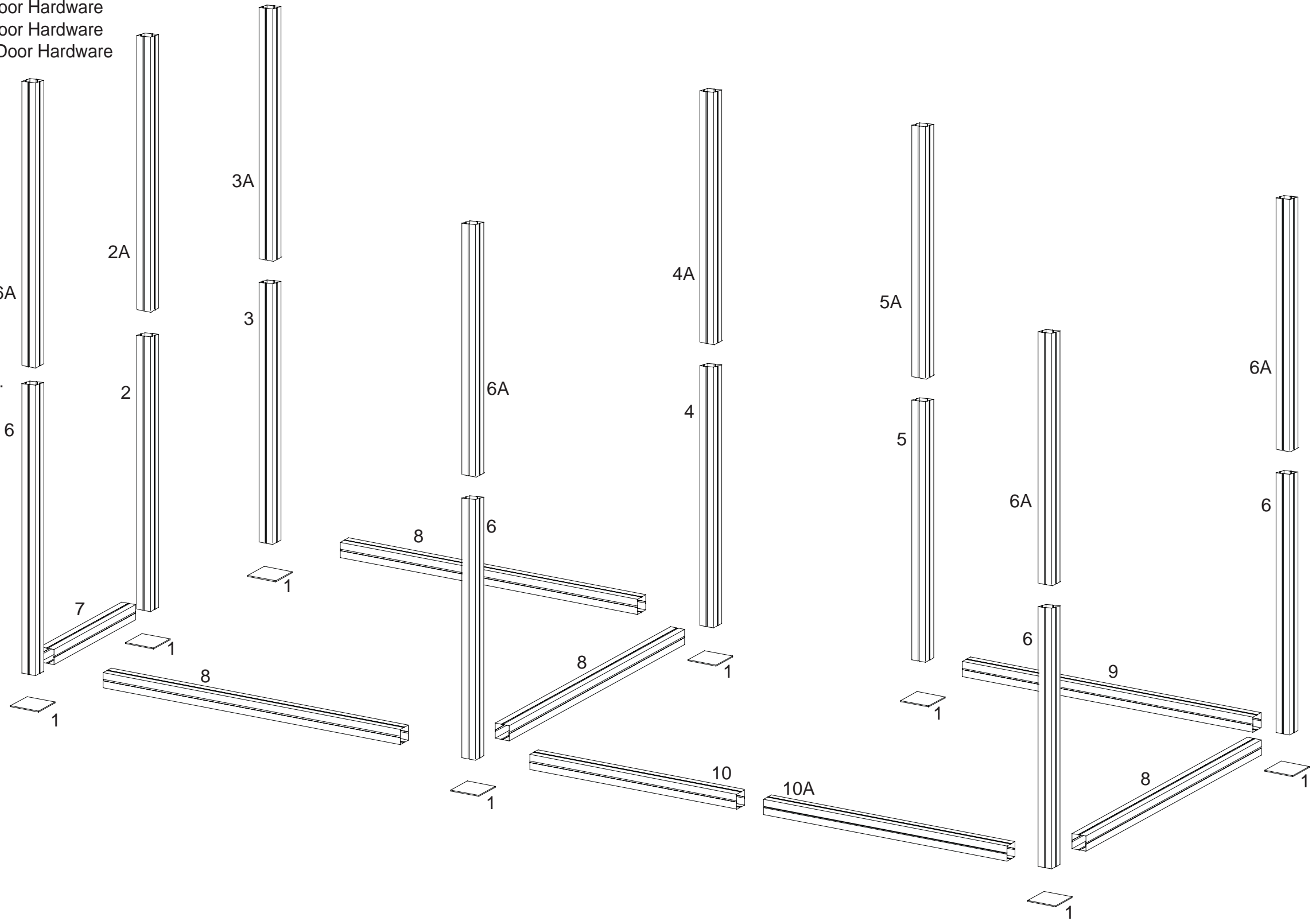

WHEN DISASSEMBLING ALUMINUM EXTRUSION, TIGHTEN ALL SETSCREWS AND LOCKS TO PREVENT LOSS DURING SHIPPING

866.652.2100

Part Number	Qty	Description
8	2	76.929" w Horizontal extrusion
10/10A	1/1	58.1495" w Horizontal extrusion
11	2	35.827" w Horizontal extrusion
12	2	37.52" w Horizontal extrusion
13	2	76.929" w Horizontal extrusion
14	2	75.197" w Horizontal extrusion

Steps

- 1) Connect horizontal extrusions [11 and 12] between vertical assemblies [6/6A, 2/2A and 3/3A from previous page] placing inserts and door as indicated.
- 2) Connect horizontal extrusion [8] between vertical assemblies [6/6A, and 3/3A] and atop vertical assembly [2/2A].
- 3) Connect horizontal extrusions [13] between vertical assemblies [3/3A and 4/4A from previous page] placing inserts as indicated.
- 4) Connect horizontal extrusion [8] between vertical assemblies [3/3A and 4/4A from previous page] placing insert as indicated.
- 5) Connect horizontal extrusion [12] between vertical assemblies [4/4A and 5/5A from previous page] placing insert and door as indicated.
- 6) Connect horizontal extrusions [14] between vertical assemblies [5/5A and 6/6A from previous page] placing inserts as indicated.
- 7) Connect horizontal extrusion [10 to 10A].
- 8) Connect horizontal assembly [10/10A] between vertical assemblies [4/4A and 6/6A] and atop vertical assembly [5/5A].
- 9) Connect horizontal extrusions [13] between vertical assemblies [4/5A and 6/6A from previous page] placing inserts as indicated.

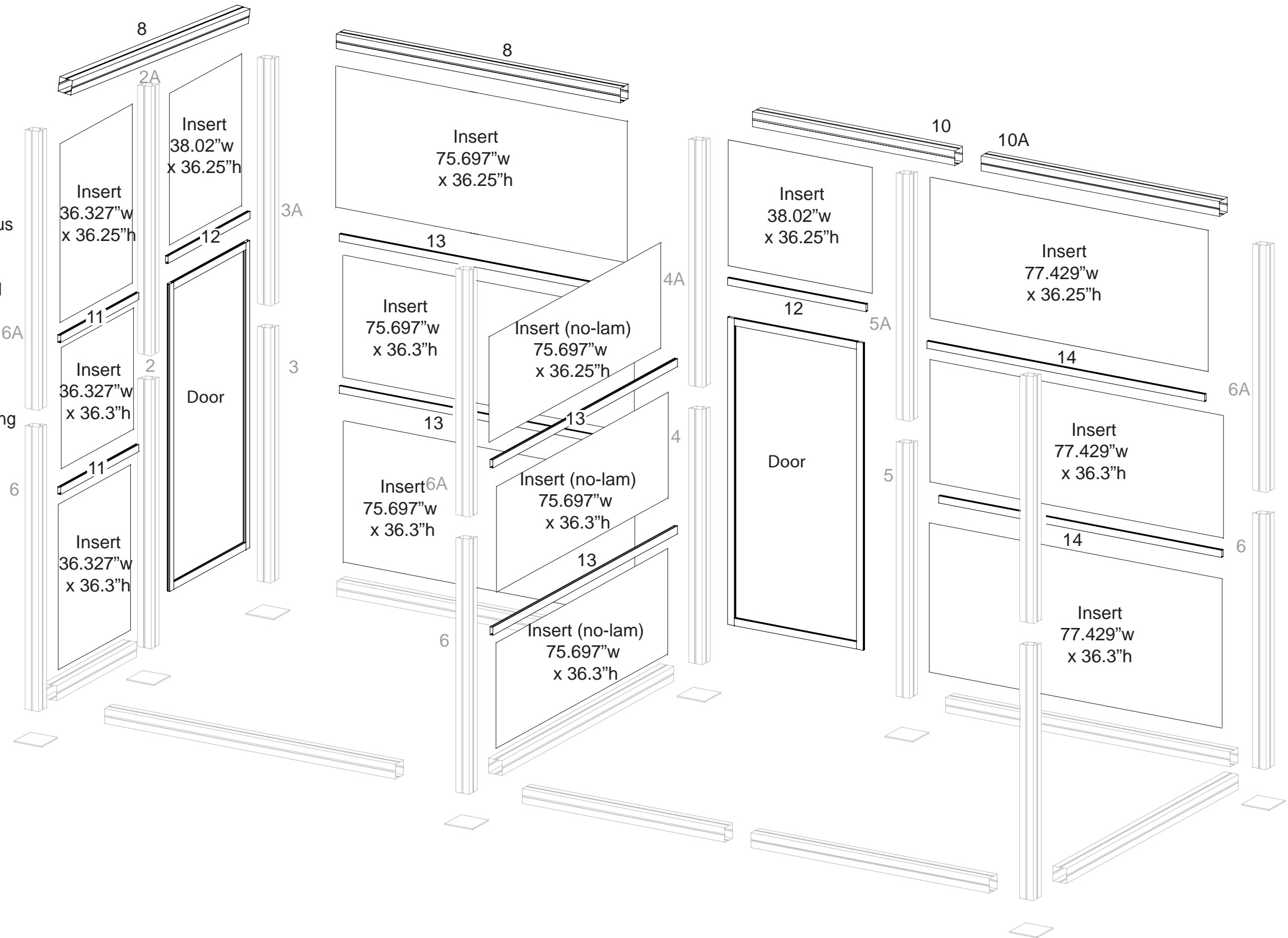

WHEN DISASSEMBLING ALUMINUM EXTRUSION, TIGHTEN ALL SETSCREWS AND LOCKS TO PREVENT LOSS DURING SHIPPING

866.652.2100

Part Number	Qty	Description
8	2	76.929"w Horizontal extrusion
10/10A	1/1	58.1495"w Horizontal extrusion
13	2	76.929"w Horizontal extrusion
15/15A	2/2	58.1495"w Horizontal extrusion

Steps

- 1) Connect horizontal extrusions [13] between vertical assemblies [6/6A from page 1] placing inserts as indicated.
- 2) Connect horizontal extrusion [8] between vertical assemblies [6/6A].
- 3) Connect horizontal extrusion [8] between vertical assemblies [6/6A and 4/4A] and the center horizontal extrusion [8] between the 2 existing horizontal extrusions [8].
- 4) Connect horizontal extrusion [10 to 10A and 15 to 15A].
- 5) Connect horizontal extrusions [13] between vertical assemblies [6/6A from page 1] placing inserts as indicated.
- 6) Connect horizontal extrusion [8] between vertical assemblies [6/6A from page 1].
- 7) Connect horizontal extrusions [15/15A] between vertical assemblies [6/6A from page 1] placing insert as indicated.
- 8) Connect horizontal assembly [10/10A] between vertical assemblies [6/6A from page 1].
- 9) Connect center horizontal assembly [10/10A] between vertical extrusions [8].

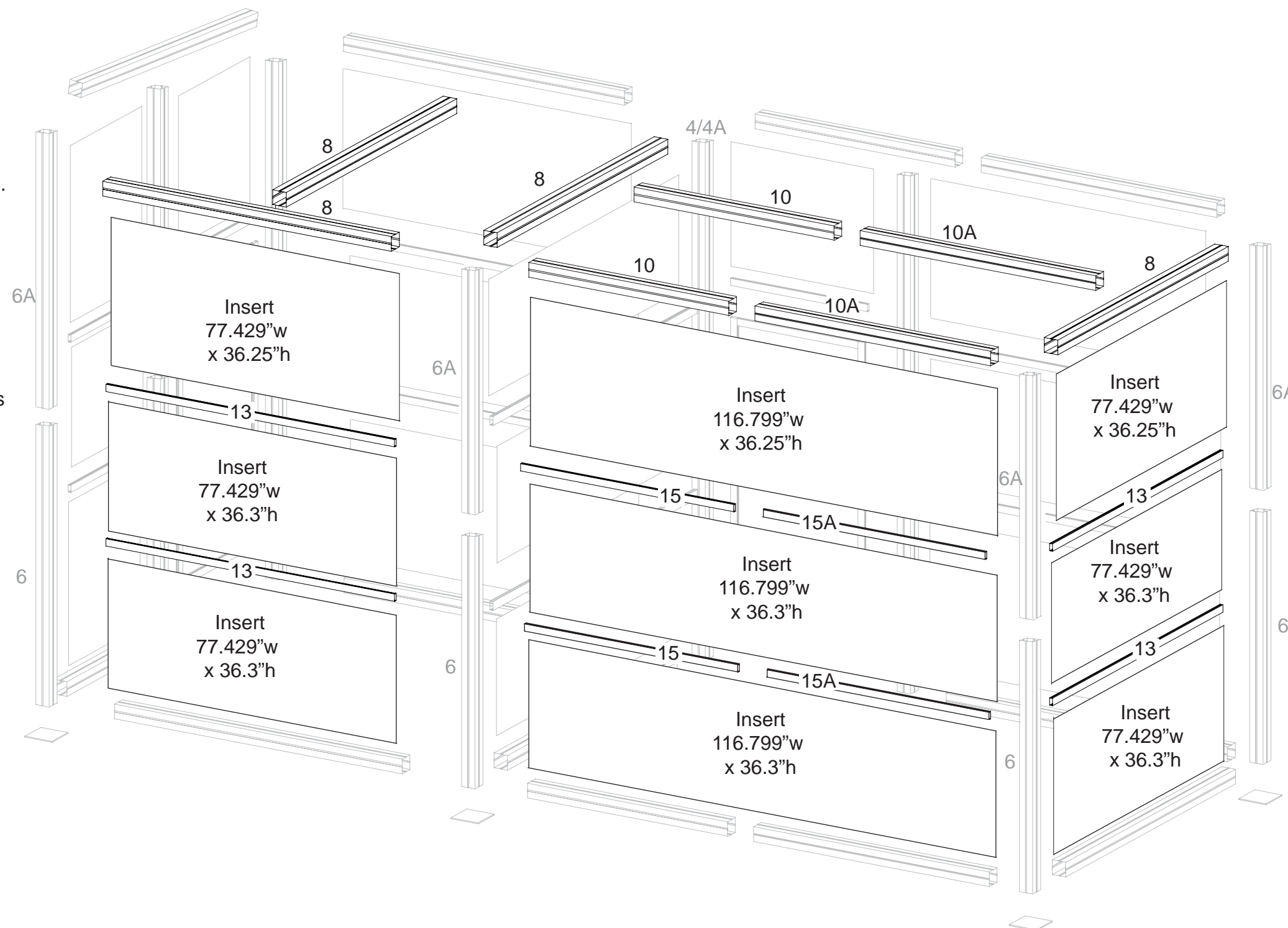

WHEN DISASSEMBLING ALUMINUM EXTRUSION, TIGHTEN ALL SETSCREWS AND LOCKS TO PREVENT LOSS DURING SHIPPING

866.652.2100

Part Number	Qty	Description
1	4	Square Base Plates
27/27A	4/4	86.614" h Vertical extrusion
28/28A	1/1	96.0869" w Curved Horizontal extrusion w/ Velcro both sides, top edge
29/29A	1/1	96.0869" w Curved Horizontal extrusion w/ Velcro both sides, bottom edge
30/30A	1/1	96.0869" w Curved Horizontal extrusion w/ Velcro both sides, top edge
31/31A	1/1	96.0869" w Curved Horizontal extrusion w/ Velcro both sides, bottom edge
32/32A	1/1	96.0869" w Curved Horizontal extrusion w/ Velcro both sides, top edge
33/33A	1/1	96.0869" w Curved Horizontal extrusion w/ Velcro both sides, bottom edge
34	6	27.418" h Vertical extrusion w/ Velcro both sides

Steps

Assembly of rings start inside conference area.

- 1) Connect vertical extrusions [27 to 27A] as shown at right.
- 2) Attach vertical assemblies [27/27A] to base plates [1].
- 3) Connect horizontal curved extrusions [28 to 28A, 29 to 29A, 30 to 30A, 31 to 31A, 32 to 32A, and 33 to 33A].
- 4) Connect horizontal assemblies [28/28A thru 33/33A] between vertical assemblies [27/27A] placing vertical extrusions [34] between as shown.

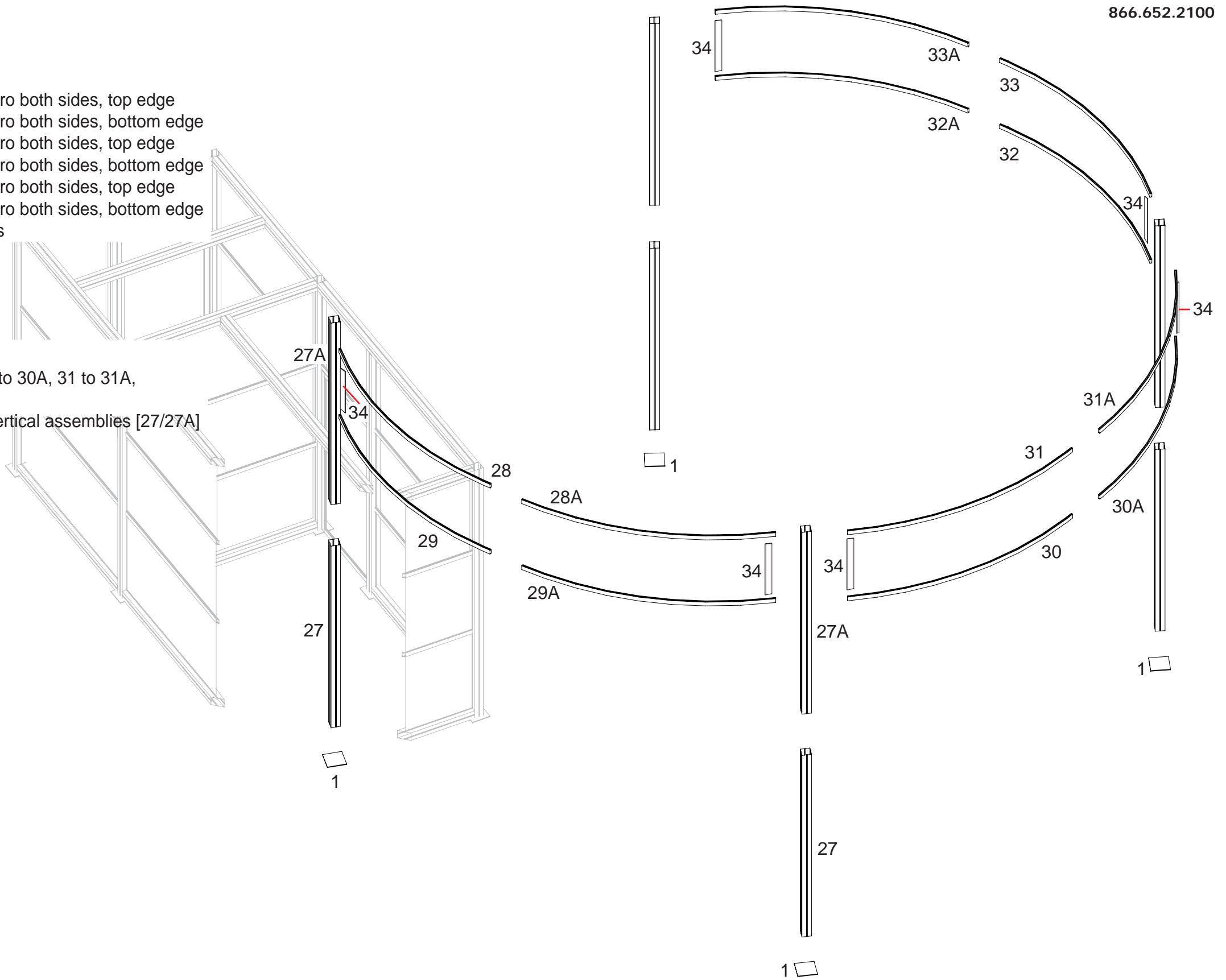

WHEN DISASSEMBLING ALUMINUM EXTRUSION, TIGHTEN ALL SETSCREWS AND LOCKS TO PREVENT LOSS DURING SHIPPING

866.652.2100

Part Number	Qty	Description
1	4	Square Base Plates
16/16A	4/4	94.488"h Vertical extrusion
17/17A	1/1	96.0869"w Curved Horizontal extrusion w/ Velcro both sides, top edge
18/18A	1/1	96.0869"w Curved Horizontal extrusion w/ Velcro both sides, bottom edge
19/19A	1/1	96.2346"w Curved Horizontal extrusion w/ Velcro both sides, top edge
20/20A	1/1	96.2346"w Curved Horizontal extrusion w/ Velcro both sides, bottom edge
21/21A	1/1	96.2346"w Curved Horizontal extrusion w/ Velcro both sides, top edge
22/22A	1/1	96.2346"w Curved Horizontal extrusion w/ Velcro both sides, bottom edge
34	6	27.418"h Vertical extrusion w/ Velcro both sides

Steps

Assembly of rings start inside conference area.

- 1) Connect vertical extrusions [16 to 16A] as shown at right.
- 2) Attach vertical assemblies [16/16A] to base plates [1].
- 3) Connect horizontal curved extrusions [17 to 17A, 18 to 18A, 19 to 19A, 20 to 20A, 21 to 21A, and 22 to 22A].
- 4) Connect horizontal assemblies [17/17A thru 22/22A] between vertical assemblies [16/16A] placing vertical extrusions [34] between as shown.

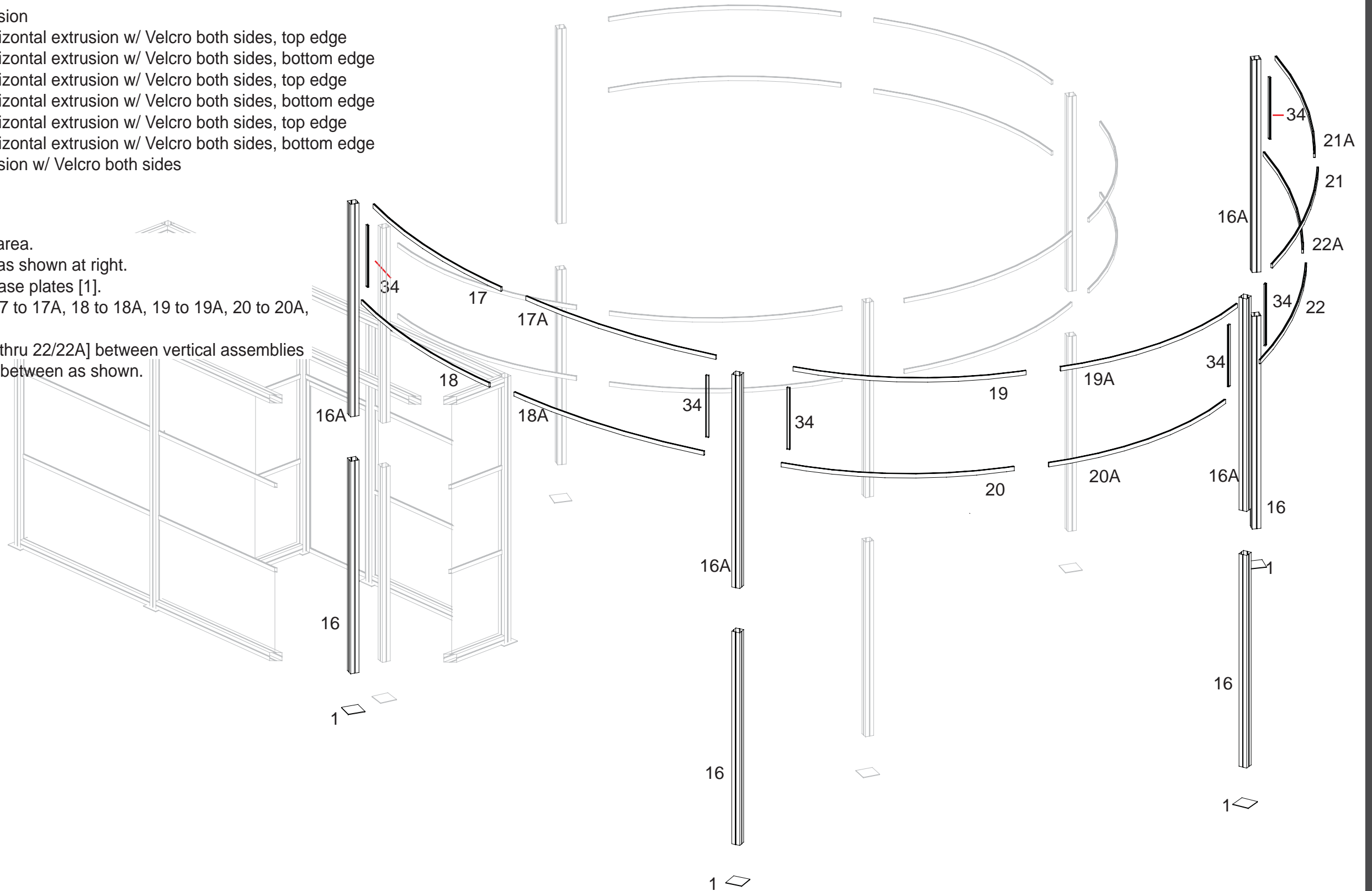

WHEN DISASSEMBLING ALUMINUM EXTRUSION, TIGHTEN ALL SETSCREWS AND LOCKS TO PREVENT LOSS DURING SHIPPING

866.652.2100

Part Number	Qty	Description
1	3	Square Base Plates
16/16A	3/3	94.488"h Vertical extrusion
23/23A	1/1	96.0869"w Curved Horizontal extrusion w/ Velcro both sides, top edge
24/24A	1/1	96.0869"w Curved Horizontal extrusion w/ Velcro both sides, bottom edge
25/25A	1/1	96.2346"w Curved Horizontal extrusion w/ Velcro both sides, top edge
26/26A	1/1	96.2346"w Curved Horizontal extrusion w/ Velcro both sides, bottom edge
34	4	27.418"h Vertical extrusion w/ Velcro both sides

Steps

Continuation of Outer ring.

- 1) Connect vertical extrusions [16 to 16A] as shown at right.
- 2) Attach vertical assemblies [16/16A] to base plates [1].
- 3) Connect horizontal curved extrusions [23 to 23A, 24 to 24A, 25 to 25A, and 26 to 26A].
- 4) Connect horizontal assemblies [23/23A thru 26/26A] between vertical assemblies [16/16A] placing vertical extrusions [34] between as shown.

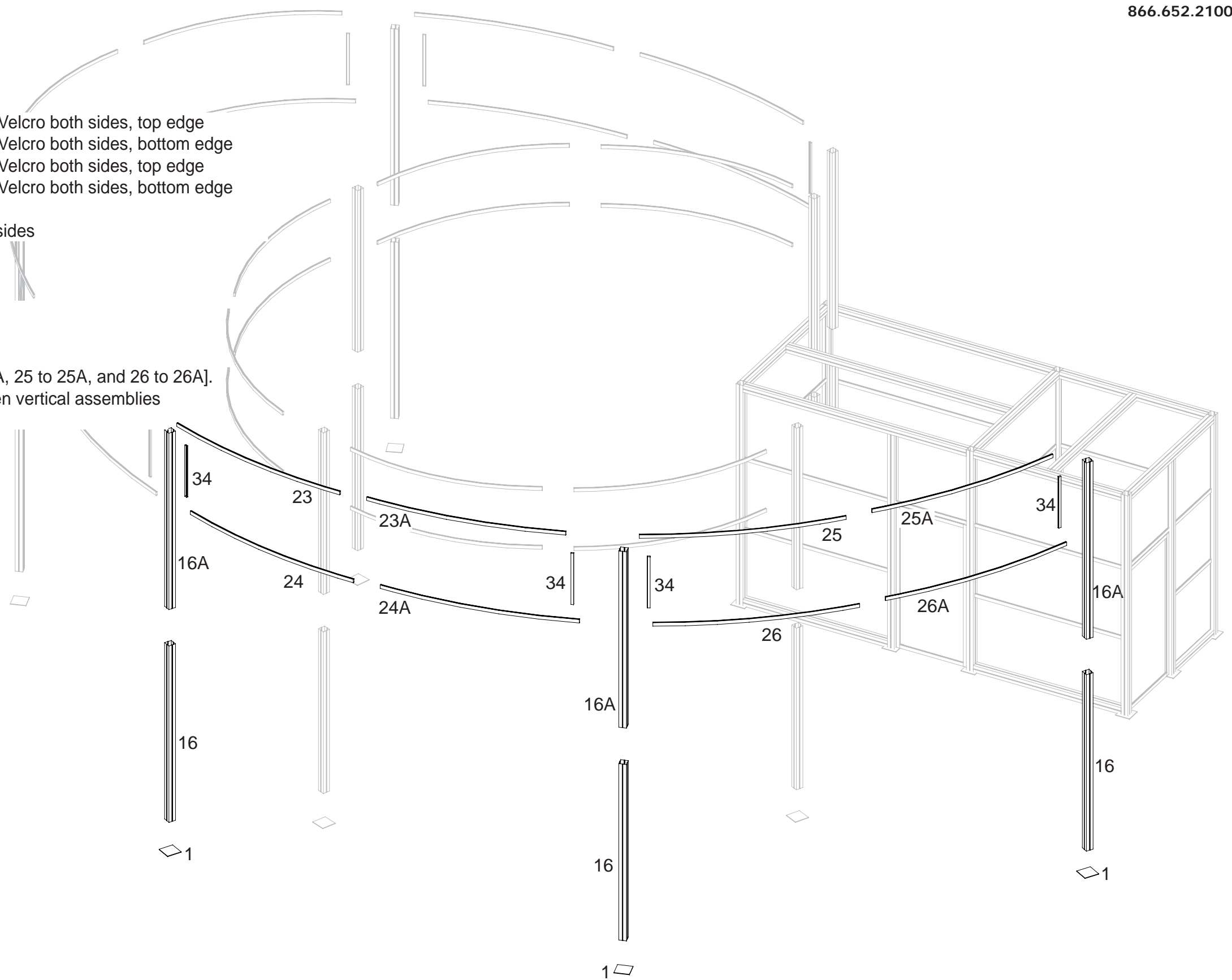

WHEN DISASSEMBLING ALUMINUM EXTRUSION, TIGHTEN ALL SETSCREWS AND LOCKS TO PREVENT LOSS DURING SHIPPING

866.652.2100

Item Number	Description
1	19" w x 38" h Flat Panel
2	19" w x 38" h Flat Panel
3	38" h 90° Connector
4	19" w x 38" h Flat Panel
5	38" h 90° Connector
6	19" w x 38" h Flat Panel w/Door
7	19" w x 38" h Flat Panel w/Door
8	38" h 90° Connector
9	19" w x 38" h Flat Panel
10	38" h 90° Connector

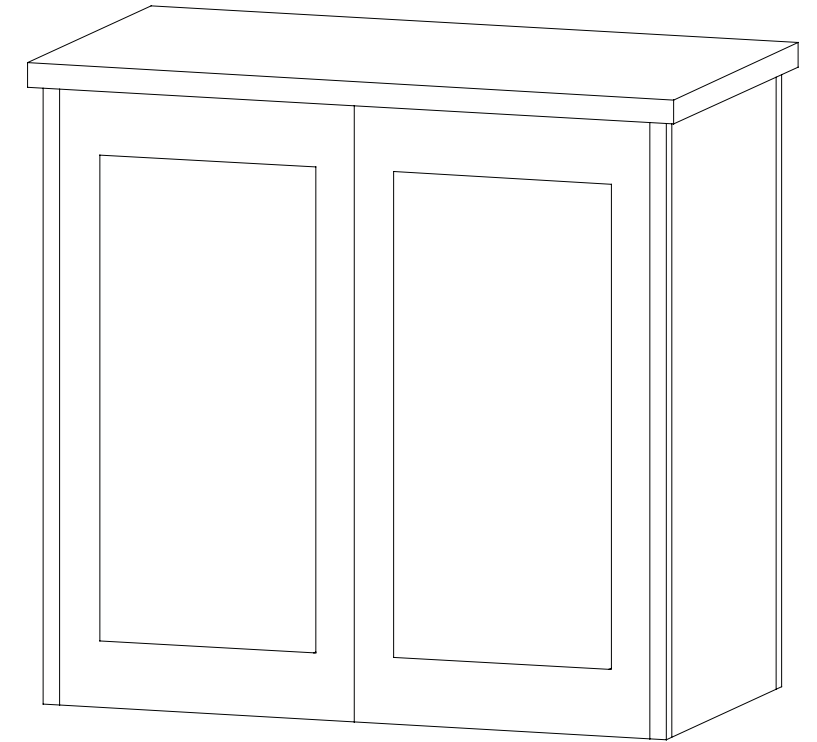
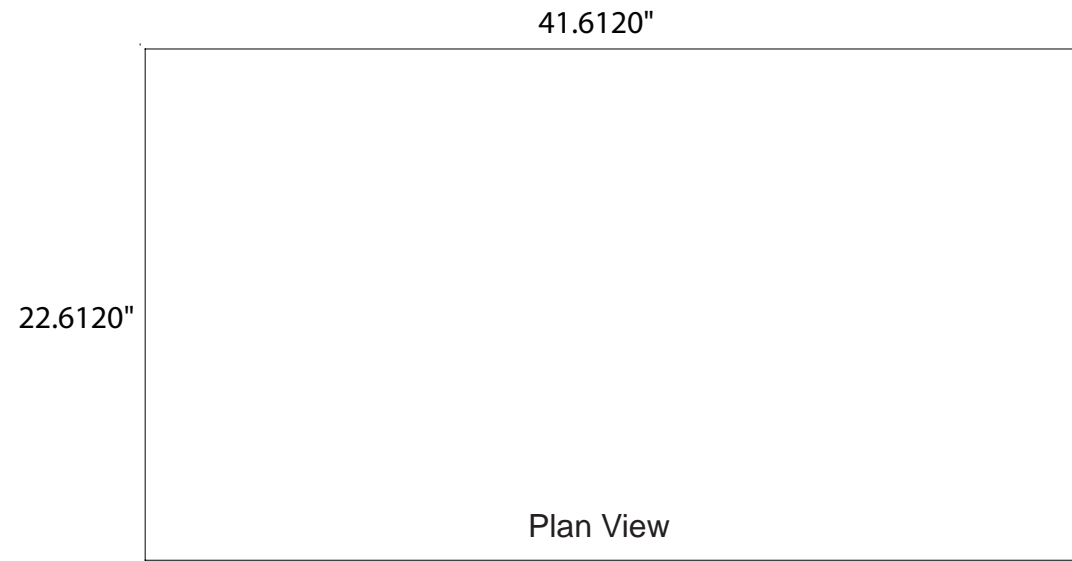

Steps:
Connect panels together in numerical order as shown in illustrations.

Set counter atop assembled pedestal.

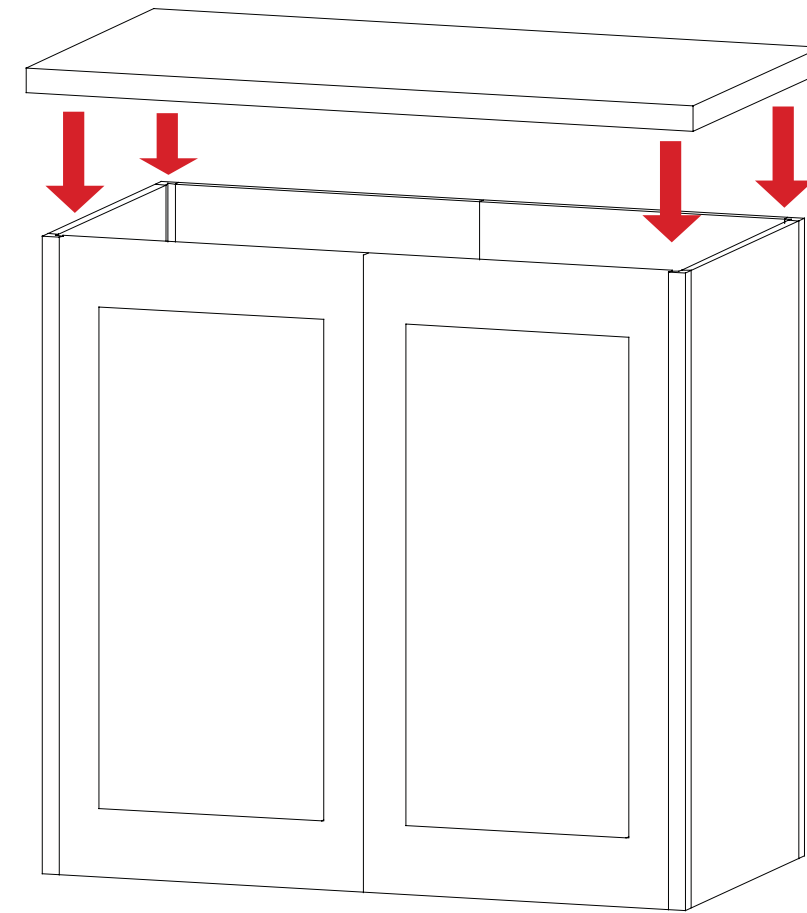
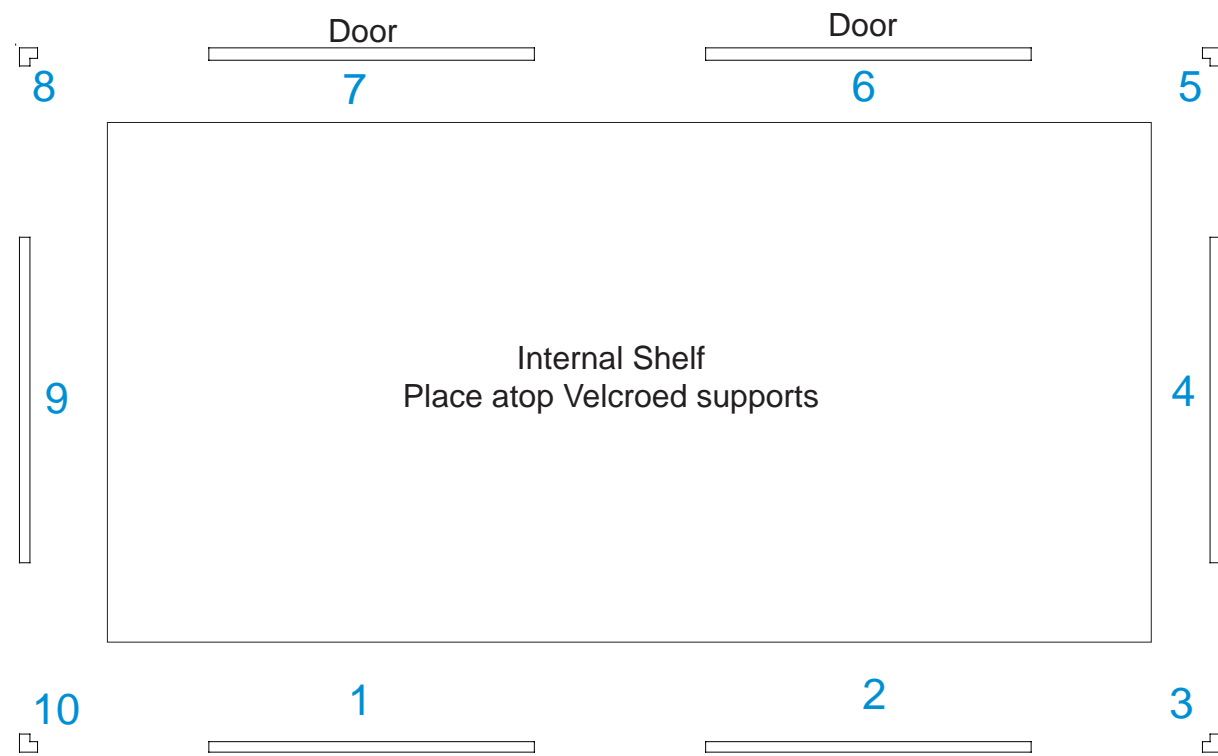

WHEN DISASSEMBLING ALUMINUM EXTRUSION, TIGHTEN ALL SETSCREWS AND LOCKS TO PREVENT LOSS DURING SHIPPING

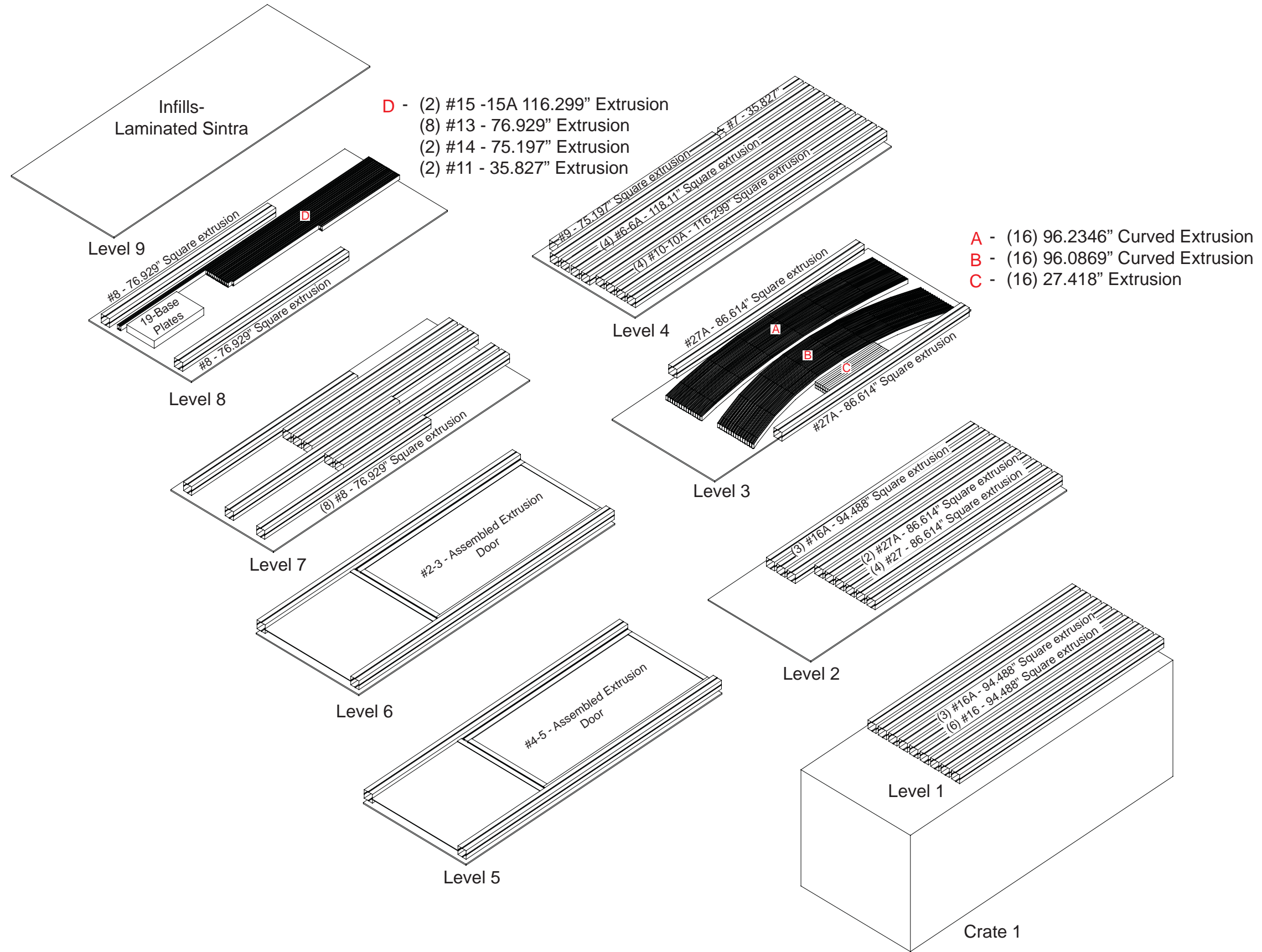

WHEN DISASSEMBLING ALUMINUM EXTRUSION, TIGHTEN ALL SETSCREWS AND LOCKS TO PREVENT LOSS DURING SHIPPING



Level 9



Level 6



Level 3



Level 8



Level 5



Level 2



Level 7



Level 4



Level 1

Physical Photos of Crate 1

WHEN DISASSEMBLING ALUMINUM EXTRUSION, TIGHTEN ALL SETSCREWS AND LOCKS TO PREVENT LOSS DURING SHIPPING



Back Layer of Booth Accessories



Front View of Crate

Front Layer of Booth Accessories

WHEN DISASSEMBLING ALUMINUM EXTRUSION, TIGHTEN ALL SETSCREWS AND LOCKS TO PREVENT LOSS DURING SHIPPING

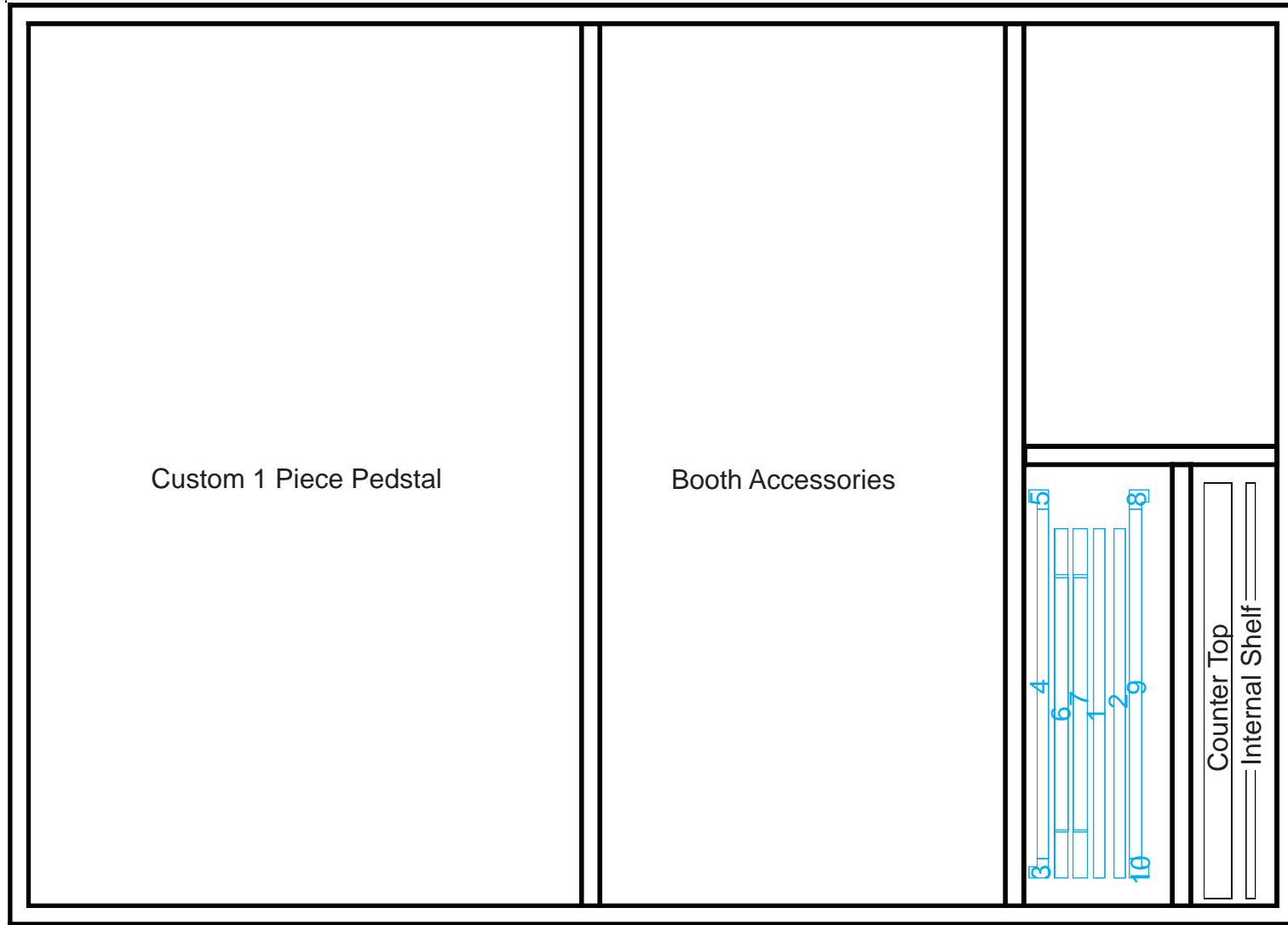

Front View of Crate

WHEN DISASSEMBLING ALUMINUM EXTRUSION, TIGHTEN ALL SETSCREWS AND LOCKS TO PREVENT LOSS DURING SHIPPING