

WHEN DISASSEMBLING ALUMINUM EXTRUSION, TIGHTEN ALL SETSCREWS AND LOCKS TO PREVENT LOSS DURING SHIPPING

visionary™ DESIGNS

Using Your Setup Instructions

The Visionary Designs Setup Instructions are created specifically for your configuration. They are laid out sequentially, including an exploded view of the entire display, and then a logical series of detailed steps to assemble the main structure and components. We encourage you to study the instructions **before** attempting to assemble your exhibit.

Each page reminds you to tighten the setscrews after disassembling your exhibit to prevent loss of the locks and setscrews (see below in RED). This is **VERY IMPORTANT**.

Cleaning and Packing Your Display

- 1) Use care when cleaning aluminum extrusion or acrylic inserts. Use only non-abrasive cleaners.
- 2) When cleaning laminate inserts or countertops, use mild cleansers and a soft material such as cotton.
- 3) Keep all display components away from extreme heat and long exposure to sunlight to avoid warping and fading.
- 4) Retain all packing material. It will make re-packing much easier and will reduce the likelihood of shipping damage.



The Tool

Most Visionary Designs exhibits can be assembled with the supplied Hex Key Tool. Occasionally, a flat head screwdriver may be required.



Typical Connection



Typical Connection (cont'd)

Most horizontal extrusion connections have a patented expandable lock. This lock inserts into the groove of an opposing extrusion. Tightening the lock with the Hex Key Tool expands the lock and creates a strong positive connection.

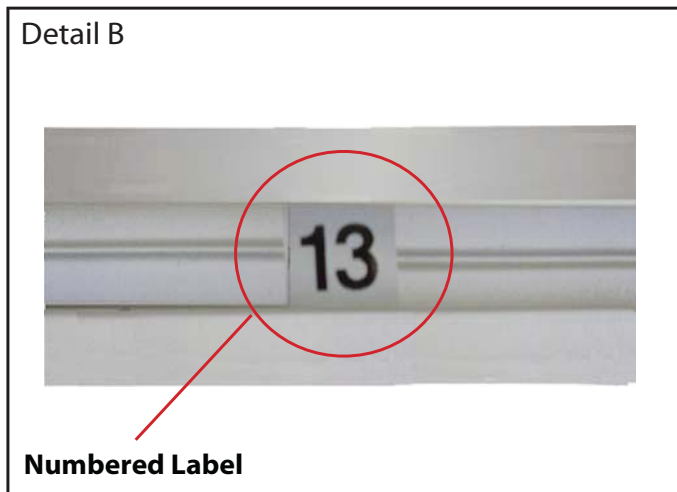

Detail B

Numbered Label

Each extrusion contains a numbered label which corresponds with setup instructions. The label is located within a groove of the extrusion (when possible). With Visionary Designs the labels contain Black numbers unless otherwise specified.



Detail C

Horizontal Inline Connection (remove only one setscrew)

Remove only (1) setscrew when disassembling. Replace setscrew in extrusion after assembling it. Before packing, replace setscrew in extrusion to avoid losing it.

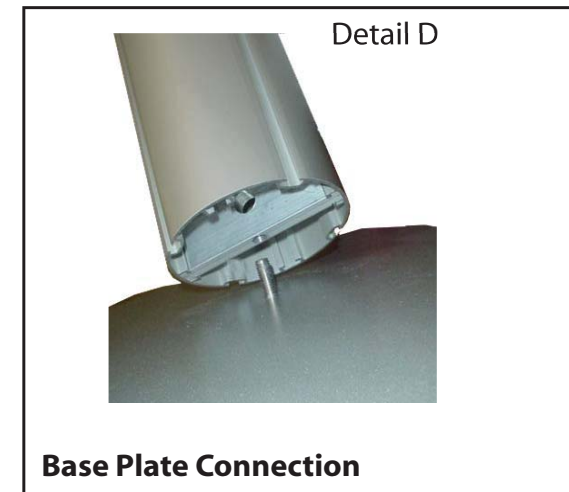

Detail D

Base Plate Connection

Attach base plate to round or square vertical extrusion using the bolt provided. Be careful not to strip the threads.

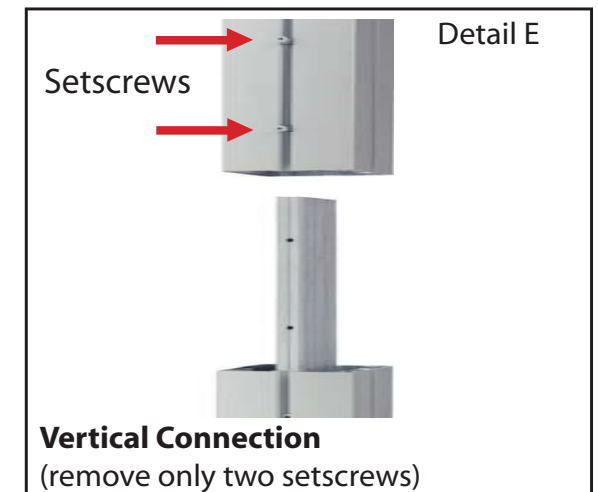

Detail E

Vertical Connection
(remove only two setscrews)

When vertical extrusions are packed in portable cases rather than crates or tubs, they must be broken down into smaller sections which then require assembly.

Remove only (2) setscrews when disassembling. Replace setscrews in extrusion after assembling it. Before packing, replace setscrews in extrusion to avoid losing them.

WHEN DISASSEMBLING ALUMINUM EXTRUSION, TIGHTEN ALL SETSCREWS AND LOCKS TO PREVENT LOSS DURING SHIPPING

Part Number	Qty	Description
1	1	95" h Lower Vertical extrusion
2	1	95" h Middle Vertical extrusion
3	1	47.5" h Upper Vertical extrusion
4	1	95" h Lower Vertical extrusion
4A	1	38" h 90° Connector attached to [4]
5	1	95" h Middle Vertical extrusion
6	1	47.5" h Upper Vertical extrusion
7	1	95" h Lower Vertical extrusion
7A	1	38" h 90° Connector attached to [7]
8	1	95" h Middle Vertical extrusion
9	1	47.5" h Upper Vertical extrusion
10	8	72" w Horizontal extrusion
10A	2	72" w Horizontal extrusion w/ Counter Connections
11	5	72" w Horizontal extrusion
11A	1	72" w Horizontal extrusion w/ connections
12	1	34.418" h Vertical extrusion
13	1	95" h Lower Vertical extrusion
14	1	95" h Middle Vertical extrusion
15	1	47.5" h Upper Vertical extrusion
16	3	72" w Horizontal extrusion

Steps

- 1) Assemble vertical extrusions by connecting together [1 to 2 to 3], [4 to 5 to 6], [7 to 8 to 9], and [13 to 14 to 15].
- 2) Connect lower horizontal extrusions [10 and 11A] between vertical assemblies [1/2/3, 4/5/6, and 7/8/9] horizontal extrusion [11A] will rest atop vertical connections [4A and 7A], connect vertical extrusion [12] to horizontal extrusion [10]. note: leave extrusion [12] loose.
- 3) Place insert and Door as indicated and tighten extrusion [12] in place.
- 4) Continue on connecting extrusions [10 and 11] between vertical assemblies [1/2/3, 4/5/6 and 7/8/9] placing inserts as indicated.
- 5) Connect lower horizontal extrusion [10] between vertical assemblies [7/8/9 and 13/14/15], connect vertical extrusion [12] to horizontal extrusion [10]. note: leave extrusion [12] loose.
- 6) Continue on connecting extrusions [10 and 16] between vertical assemblies [1/2/3, 13/14/15 and 7/8/9].

Note: V10 Detail
 Slide V10 Connector in between vertical connector and vertical square extrusions and tighten to secure together.
 NOTE: Pieces ship assembled.

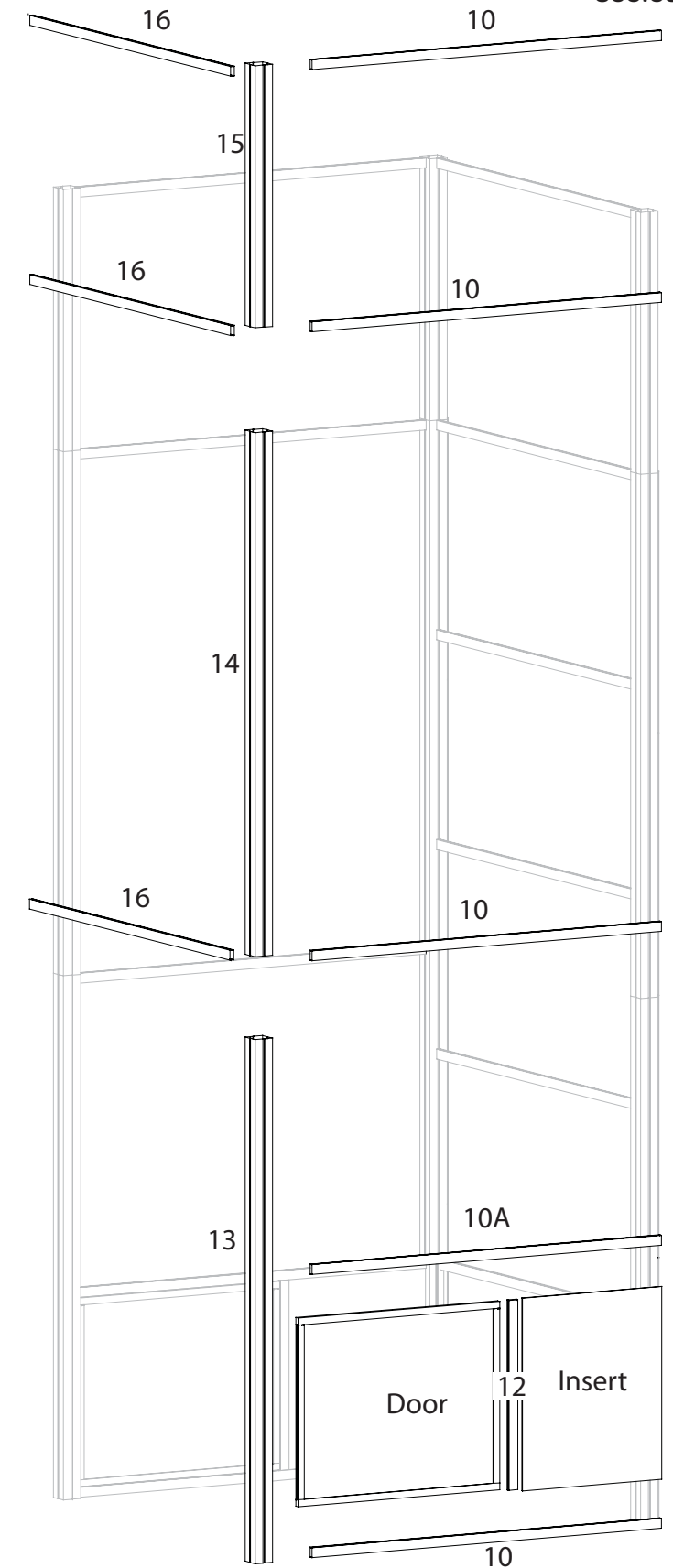
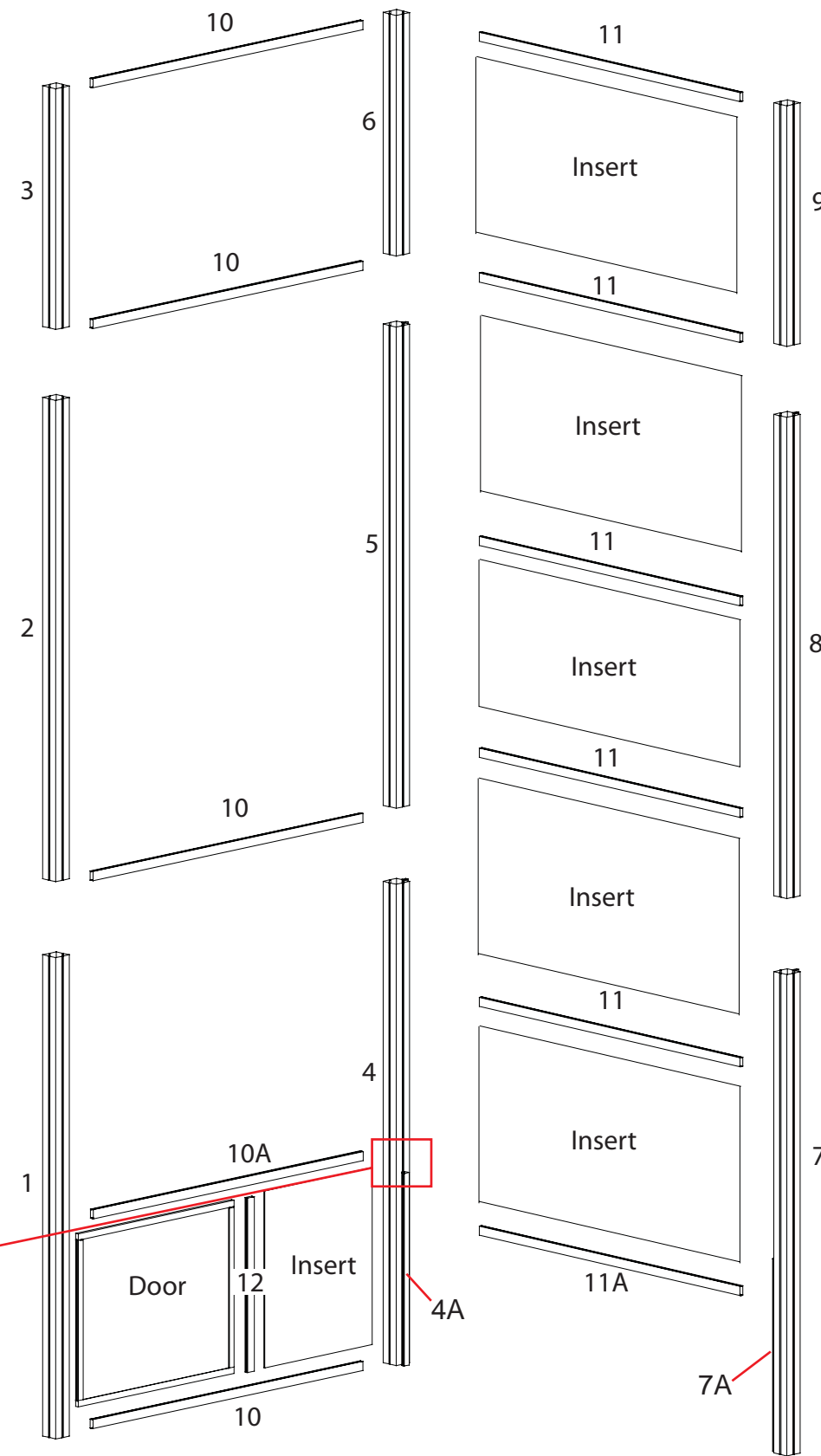
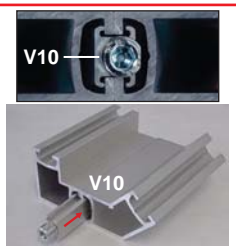

WHEN DISASSEMBLING ALUMINUM EXTRUSION, TIGHTEN ALL SETSCREWS AND LOCKS TO PREVENT LOSS DURING SHIPPING

866.652.2100

Part Number	Qty	Description
17	4	15"w Horizontal extrusion
18	2	38"h Vertical extrusion
19	2	68.417"w Horizontal extrusion
20	1	34.418"h Vertical extrusion

Steps

- 1) Connect horizontal extrusions [17] between vertical extrusions [18] and to connector extrusion [4A and 7A] from previous page.
- 2) Connect lower horizontal extrusion [19] between vertical extrusions [18] as shown below.
- 3) Connect vertical extrusion [20] to center of horizontal extrusion [19]. note: leave extrusion [20] loose.
- 4) Place inserts and doors as indicated and tighten extrusion [20] in place.
- 5) Connect upper horizontal extrusions [17 and 19] between vertical extrusions [18] and to connection on horizontal extrusion [11A] from previous page.

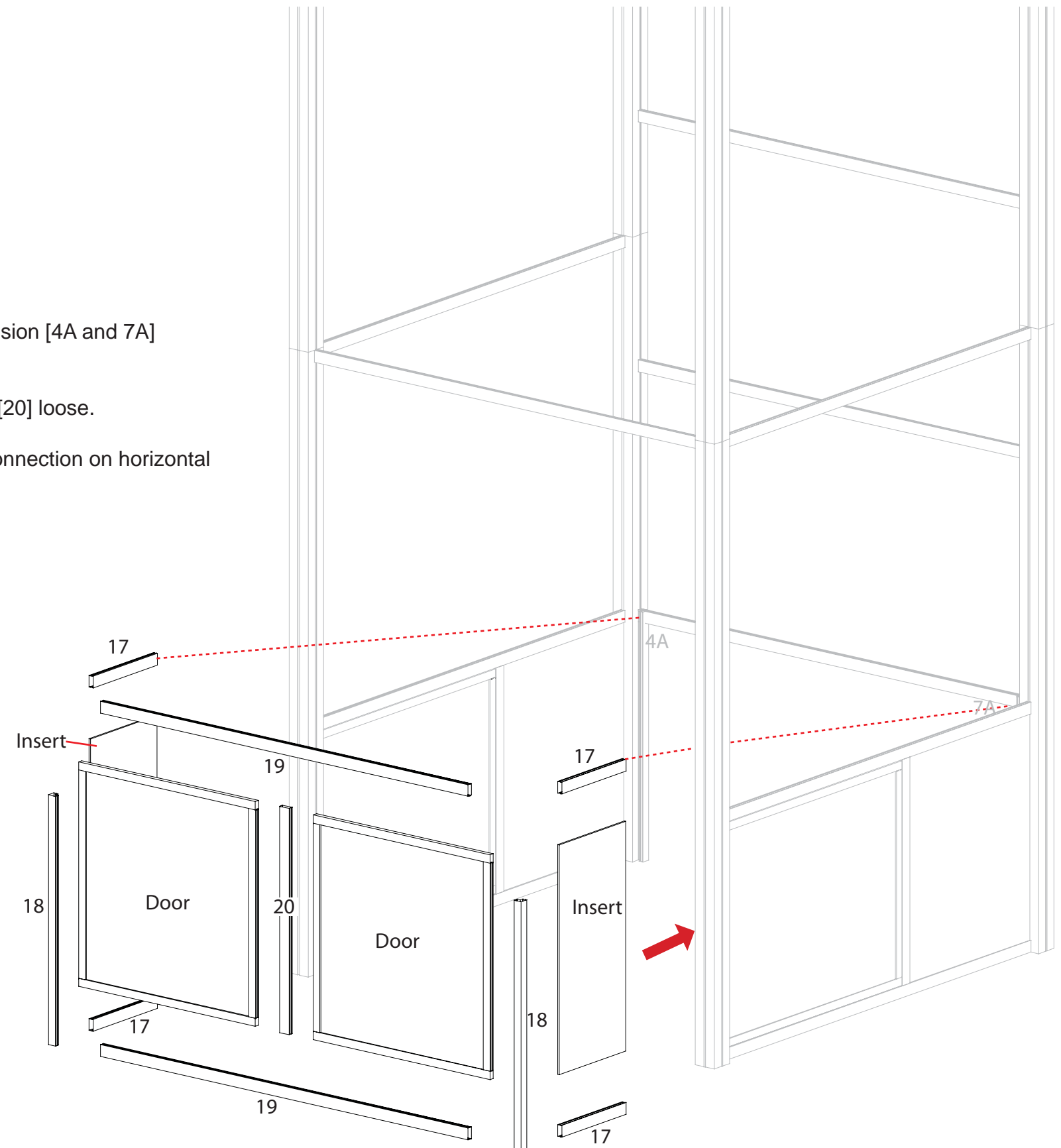

WHEN DISASSEMBLING ALUMINUM EXTRUSION, TIGHTEN ALL SETSCREWS AND LOCKS TO PREVENT LOSS DURING SHIPPING

© 2008

866.652.2100

Part Number	Qty	Description
21	8	15"w Horizontal extrusion
22	4	38"h Vertical extrusion
23	4	73.791"w Horizontal extrusion

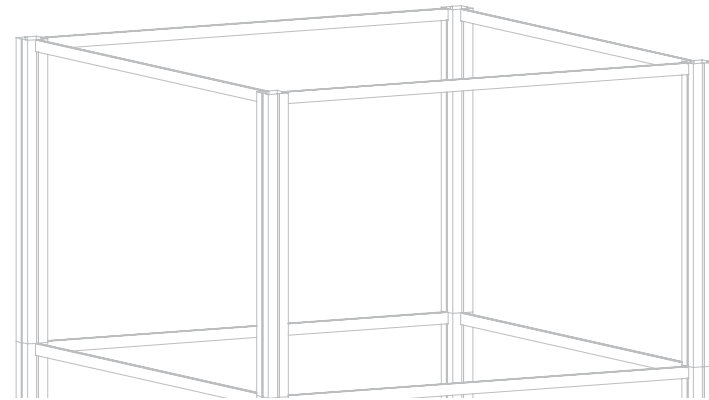

Steps

- 1) Connect lower horizontal extrusions [21] between vertical extrusions [4 and 7 from previous pages] and to 90° connector [22].
- 2) Connect lower horizontal extrusions [23] between vertical extrusions [22] as shown below.
- 3) Place inserts and doors as indicated.
- 4) Connect upper horizontal extrusions [21 and 23] between vertical extrusions [4,7 and 22].

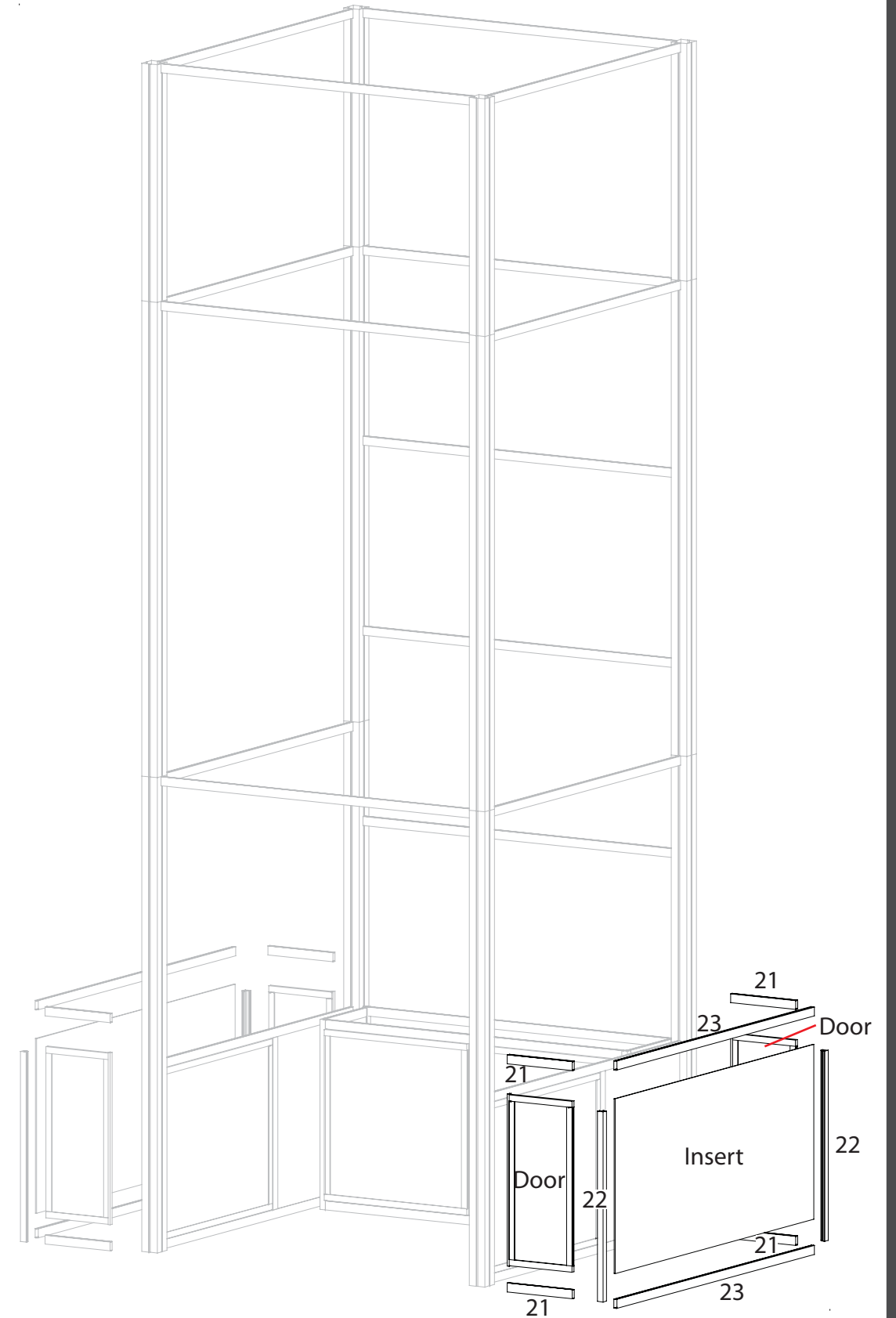
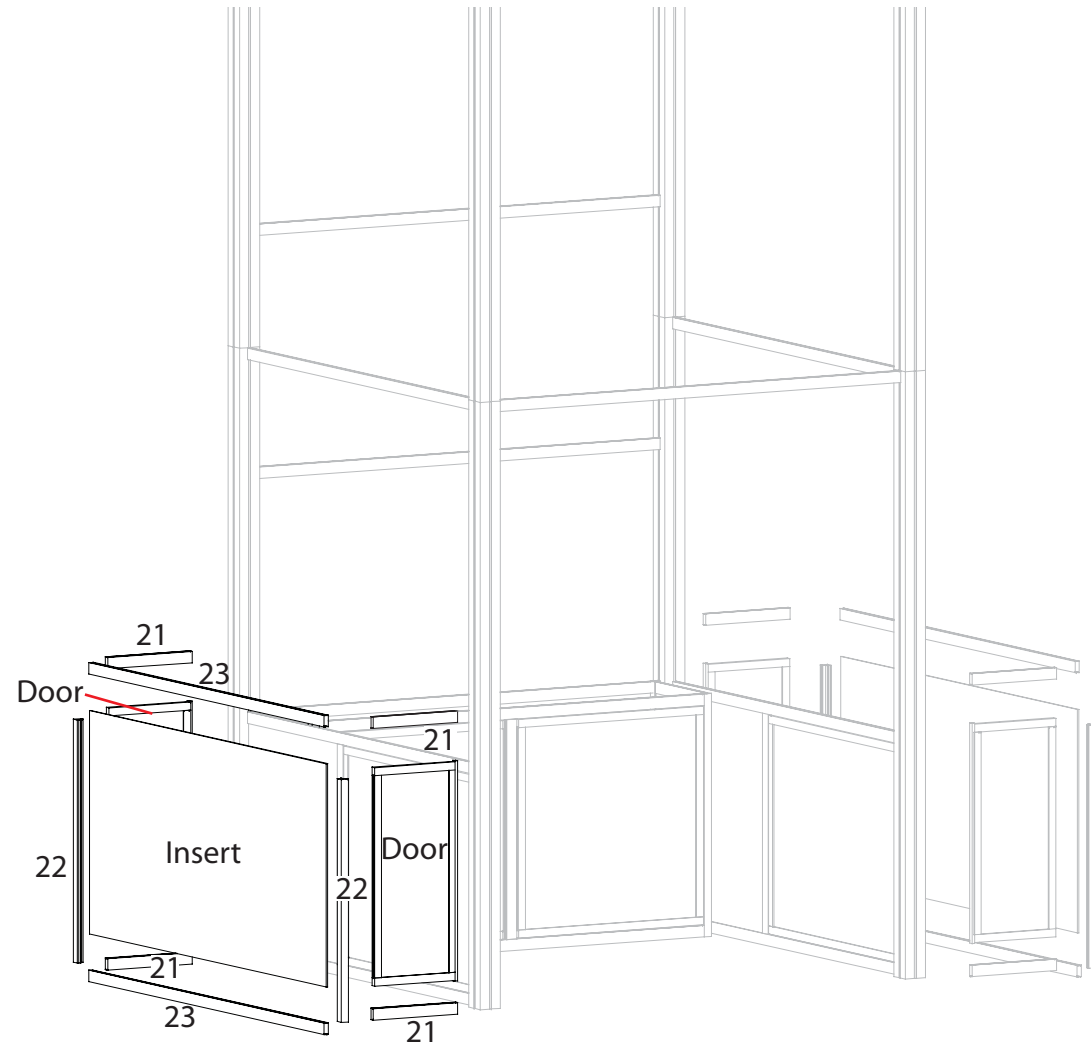

WHEN DISASSEMBLING ALUMINUM EXTRUSION, TIGHTEN ALL SETSCREWS AND LOCKS TO PREVENT LOSS DURING SHIPPING

- 1) Place shelves into assembled workstations atop Velcroed Supports.
- 2) Place Counters atop assembled workstations as shown below.

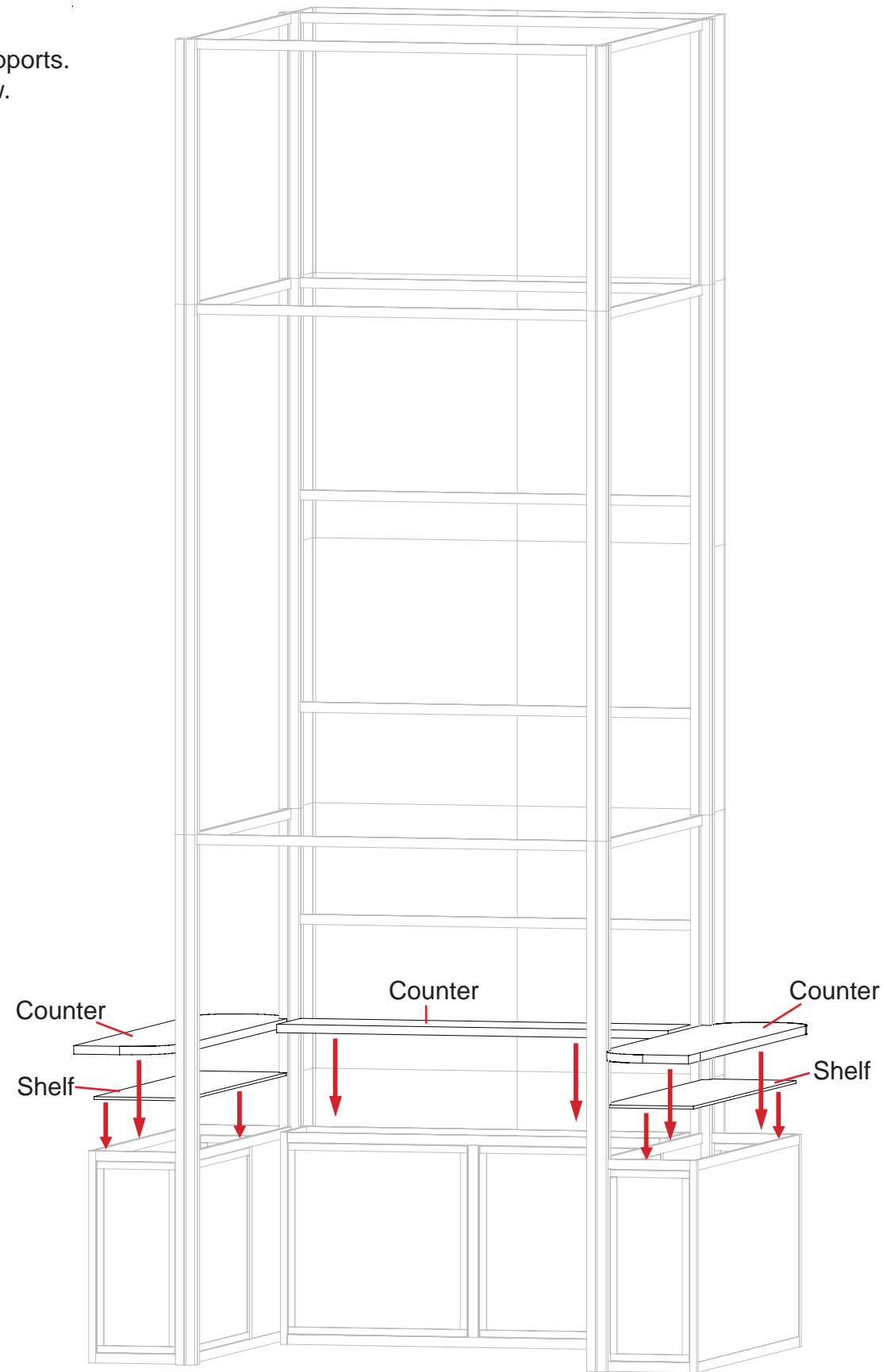

WHEN DISASSEMBLING ALUMINUM EXTRUSION, TIGHTEN ALL SETSCREWS AND LOCKS TO PREVENT LOSS DURING SHIPPING

Item Number	Description
1	11.5"w x 47.5"h Flat Panel
2	47.5"h 90° Connector
3	37.046"w x 47.5"h Flat Panel w/ wood core
4	37.046"w x 47.5"h Flat Panel w/ wood core
5	47.5"h 90° Connector
6	11.5"w x 47.5"h Flat Panel

866.652.2100

Steps:

Connect panels together in numerical order starting with #1 by connecting it to the end cap that is permanently connected to the square extrusion as shown in illustrations.

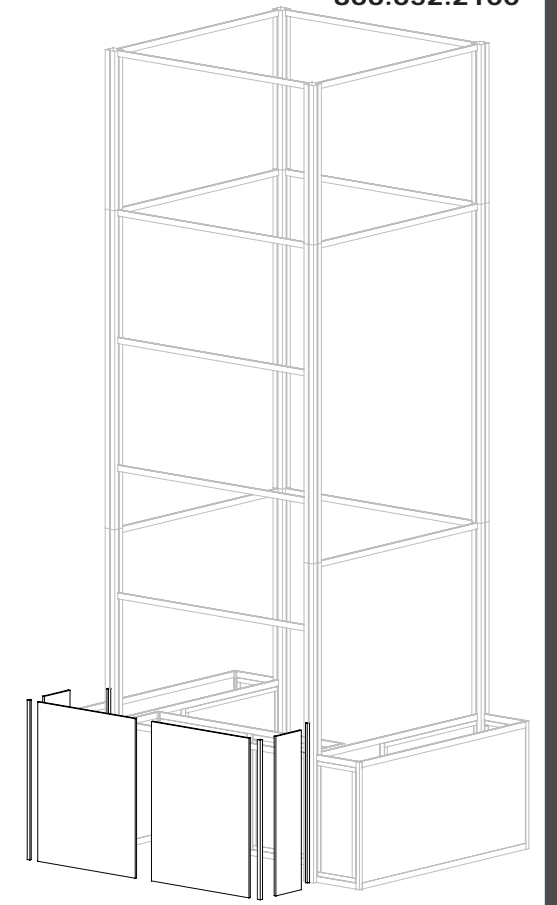
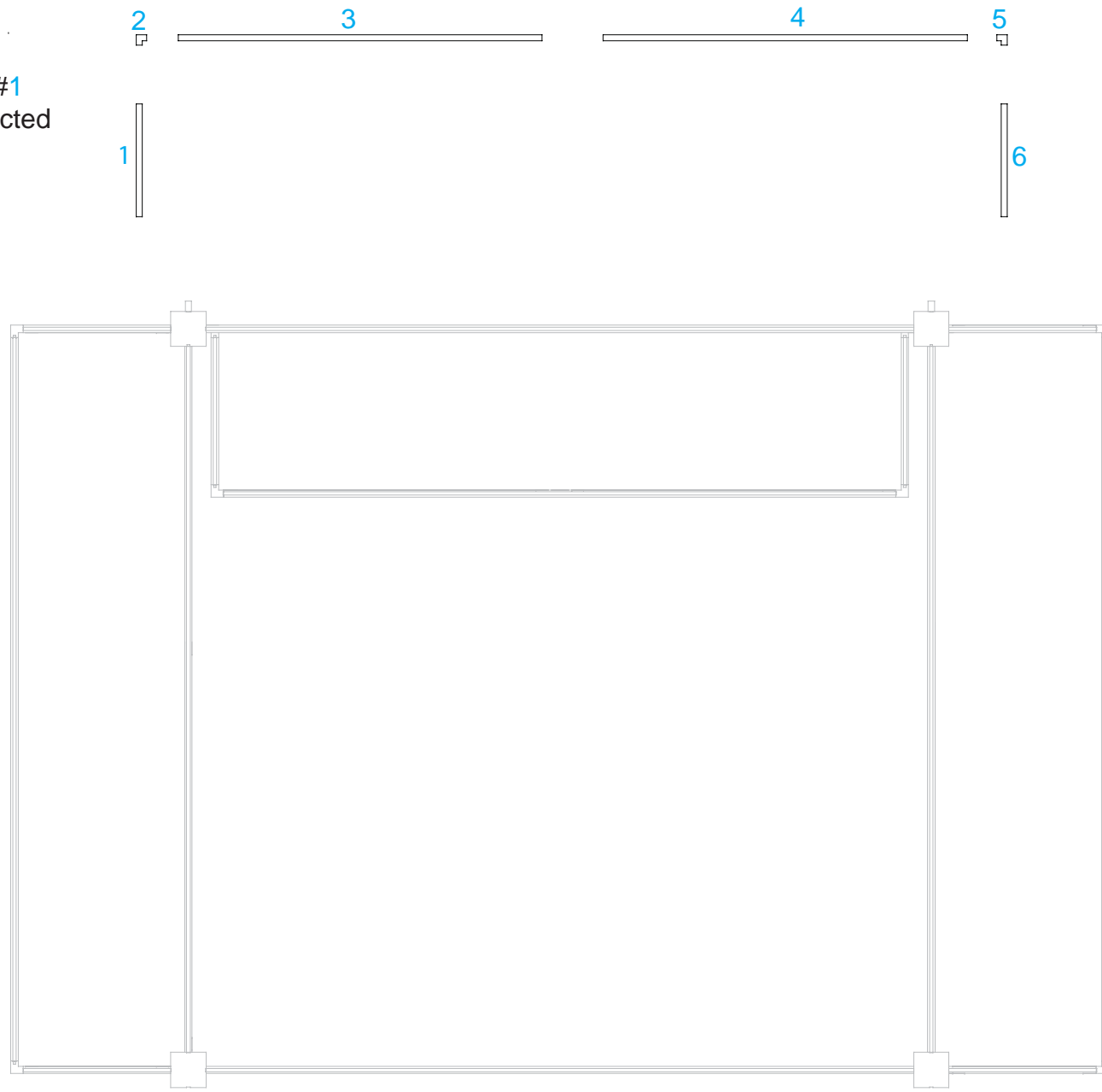

WHEN DISASSEMBLING ALUMINUM EXTRUSION, TIGHTEN ALL SETSCREWS AND LOCKS TO PREVENT LOSS DURING SHIPPING

Item Number	Description
1	11.5" w x 47.5" h Flat Panel
2	47.5" h 90° Connector
3	37.046" w x 47.5" h Flat Panel w/ wood core
4	37.046" w x 47.5" h Flat Panel w/ wood core
5	47.5" h 90° Connector
6	11.5" w x 47.5" h Flat Panel

866.652.2100

Steps:

Connect panels together in numerical order starting with #1 by connecting it to the end cap that is permanently connected to the square extrusion as shown in illustrations.

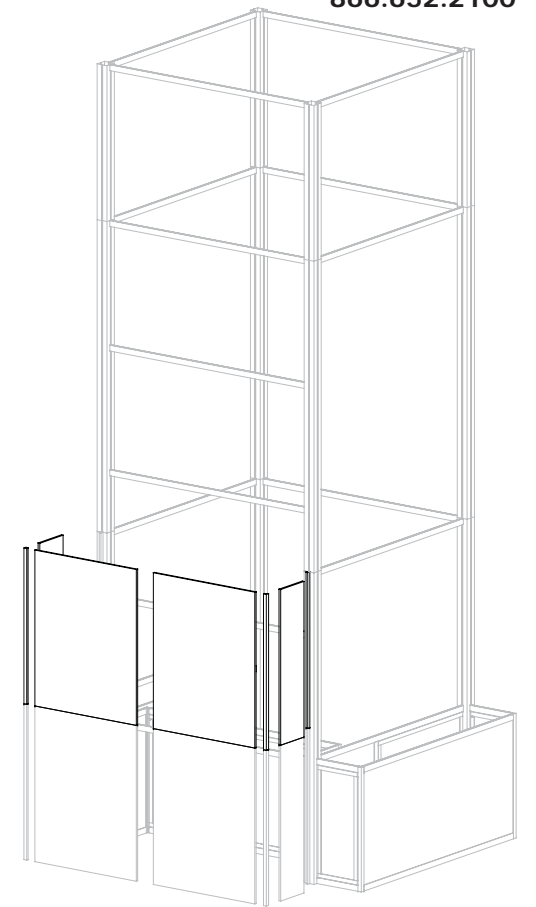
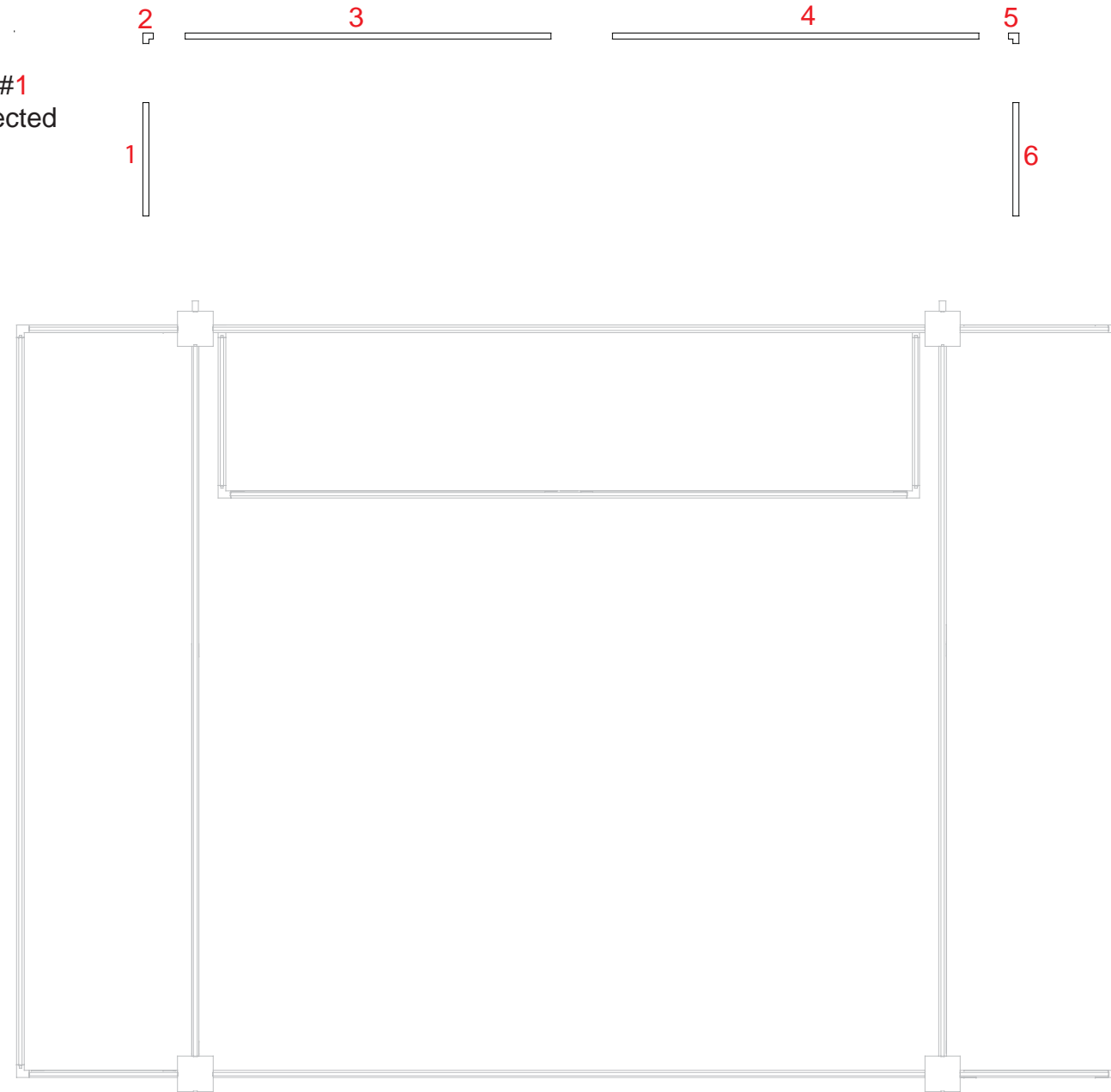

WHEN DISASSEMBLING ALUMINUM EXTRUSION, TIGHTEN ALL SETSCREWS AND LOCKS TO PREVENT LOSS DURING SHIPPING

866.652.2100

Item Number	Description
1	11.5"w x 47.5"h Flat Panel
2	47.5"h 90° Connector
3	37.046"w x 47.5"h Flat Panel w/ wood core
4	37.046"w x 47.5"h Flat Panel w/ wood core
5	47.5"h 90° Connector
6	11.5"w x 47.5"h Flat Panel

Steps:
 Connect panels together in numerical order starting with #1 by connecting it to the end cap that is permanently connected to the square extrusion as shown in illustrations.

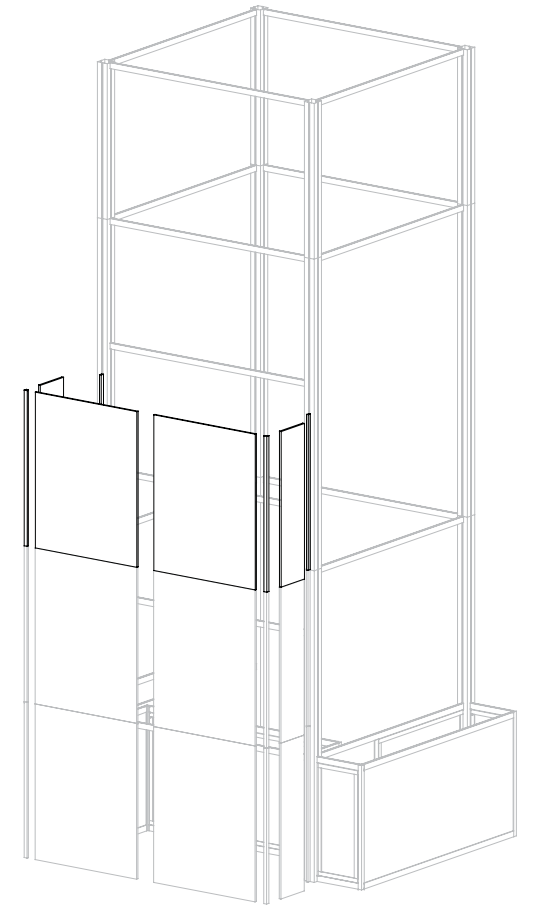
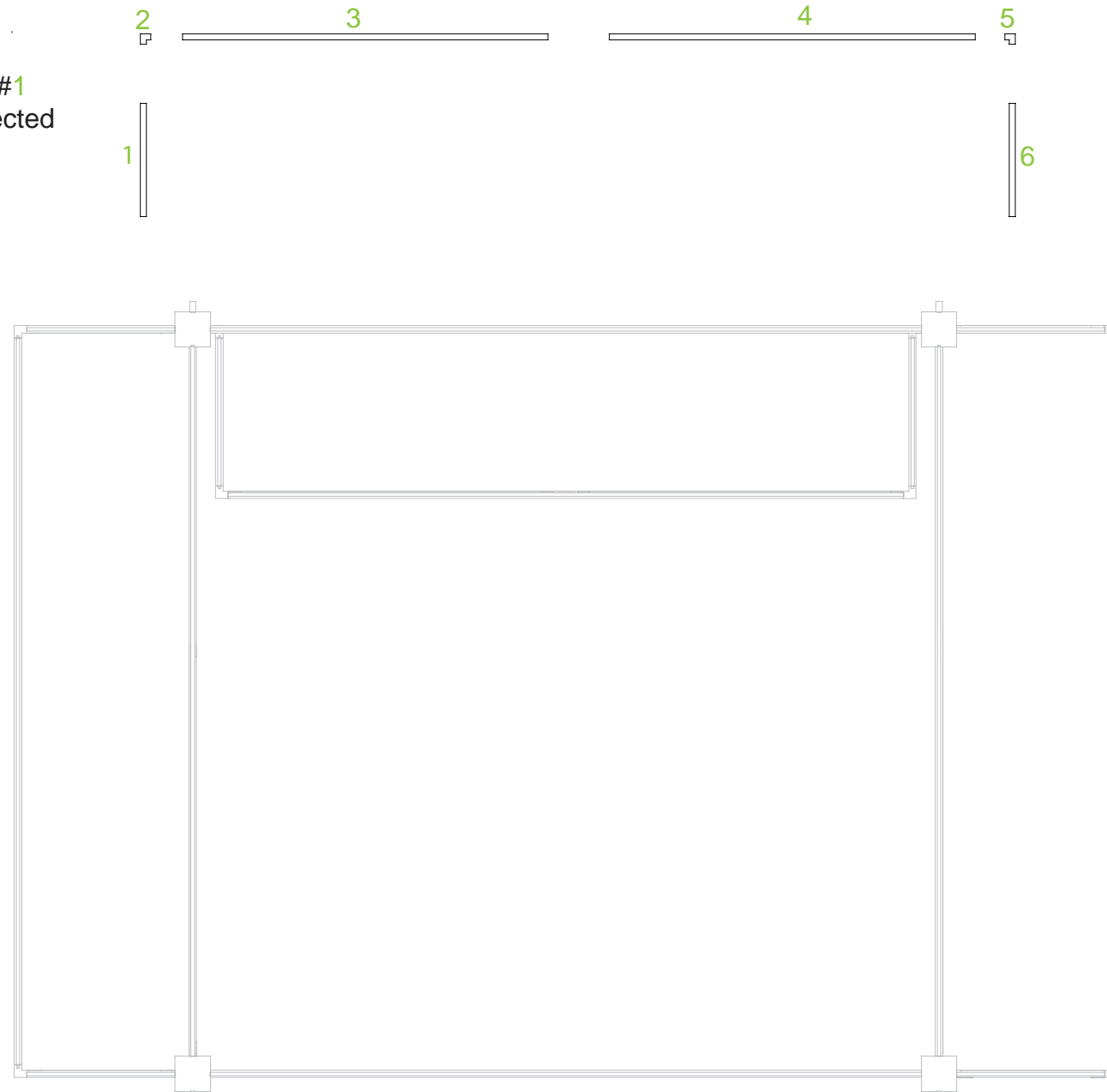

WHEN DISASSEMBLING ALUMINUM EXTRUSION, TIGHTEN ALL SETSCREWS AND LOCKS TO PREVENT LOSS DURING SHIPPING

Item Number	Description
1	11.5"w x 47.5"h Flat Panel
2	47.5"h 90° Connector
3	37.046"w x 47.5"h Flat Panel
4	37.046"w x 47.5"h Flat Panel
5	47.5"h 90° Connector
6	11.5"w x 47.5"h Flat Panel

866.652.2100

Steps:
 Connect panels together in numerical order starting with #1 by connecting it to the end cap that is permanently connected to the square extrusion as shown in illustrations.

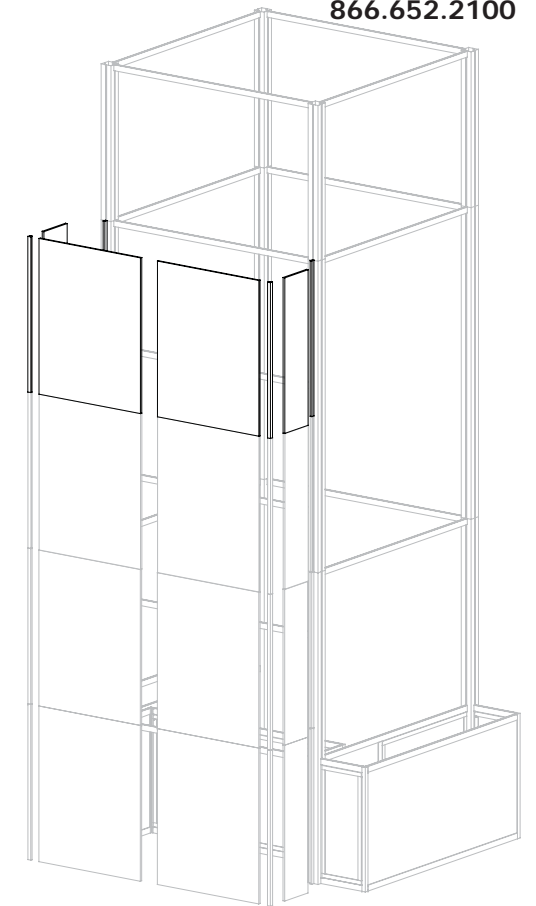
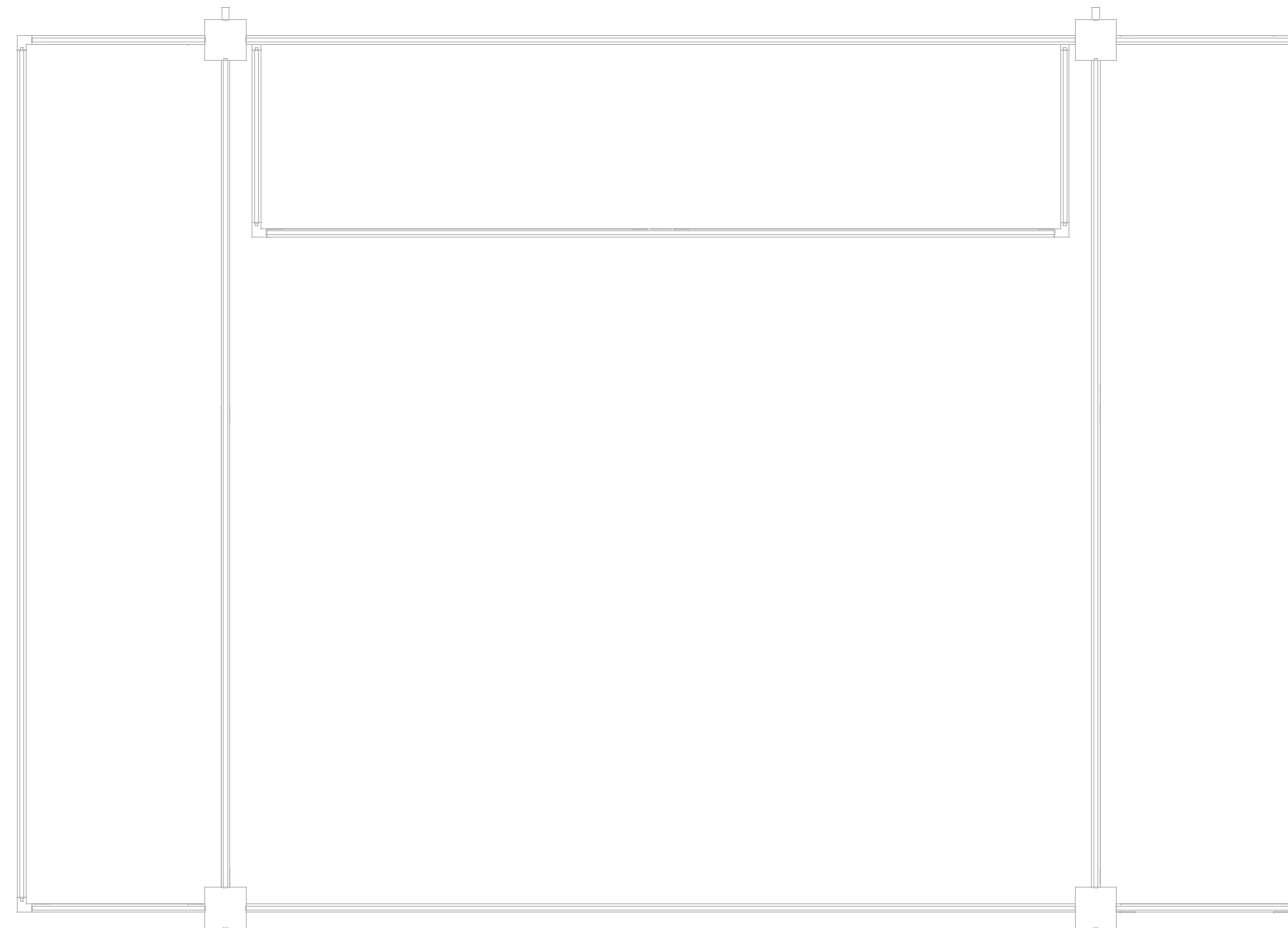
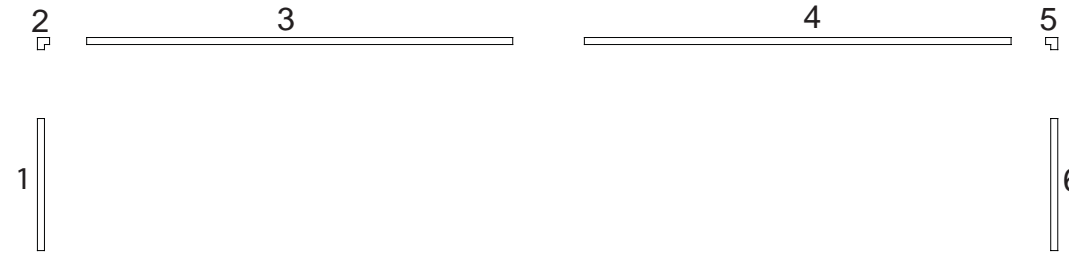

WHEN DISASSEMBLING ALUMINUM EXTRUSION, TIGHTEN ALL SETSCREWS AND LOCKS TO PREVENT LOSS DURING SHIPPING

Item Number	Description
1a	11.5"w x 47.5"h Flat Panel
2a	47.5"h 90° Connector
3a	37.046"w x 47.5"h Flat Panel
4a	37.046"w x 47.5"h Flat Panel
5a	47.5"h 90° Connector
6a	11.5"w x 47.5"h Flat Panel

866.652.2100

Steps:

Connect panels together in numerical order starting with #1a by connecting it to the end cap that is permanently connected to the square extrusion as shown in illustrations.

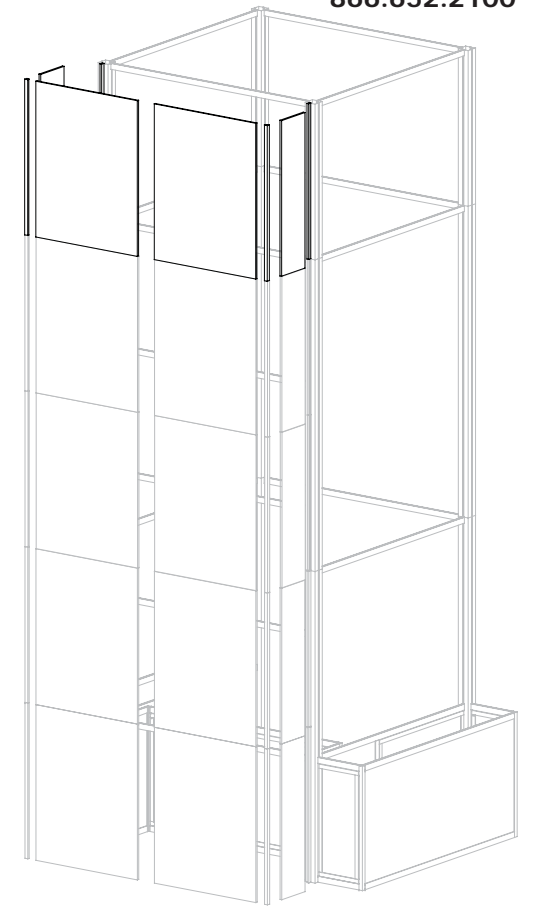
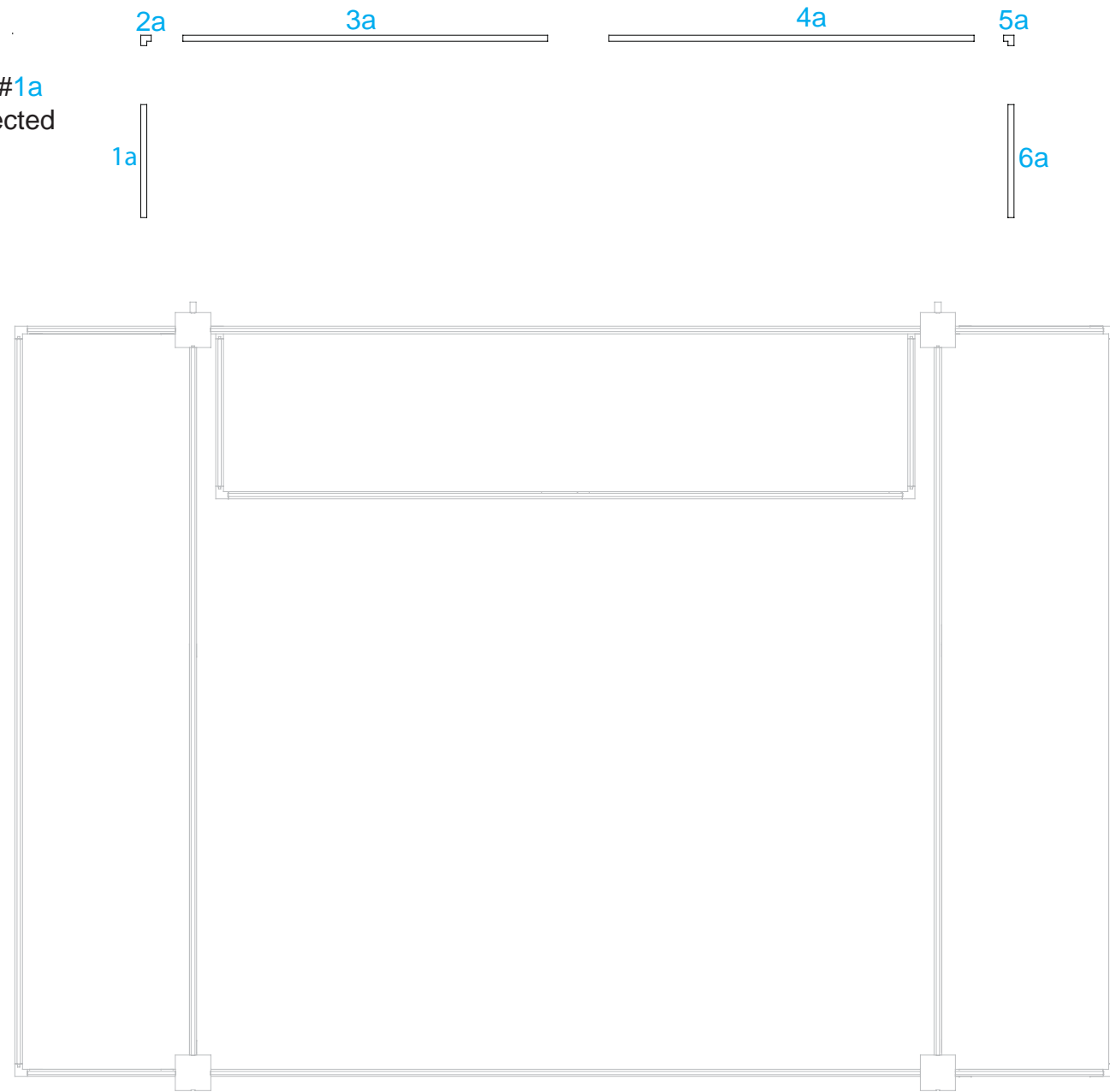

WHEN DISASSEMBLING ALUMINUM EXTRUSION, TIGHTEN ALL SETSCREWS AND LOCKS TO PREVENT LOSS DURING SHIPPING

866.652.2100

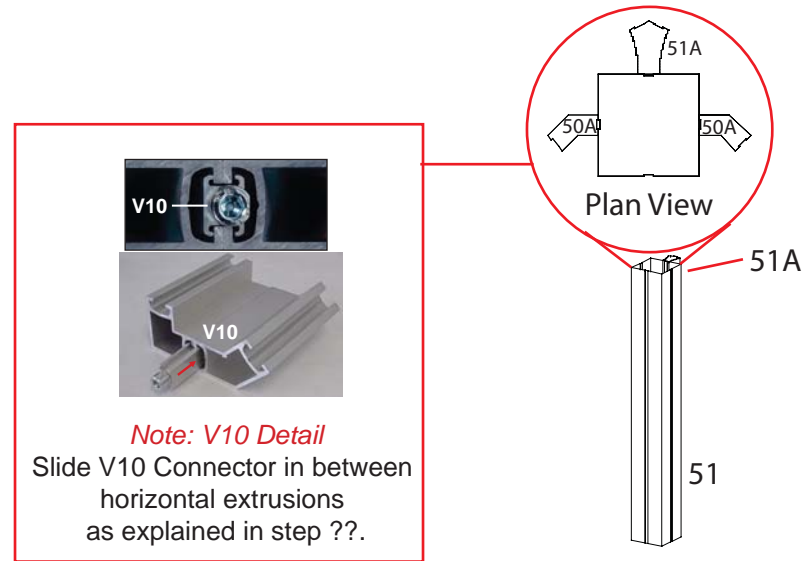

Part Number	Qty	Description
50	1	96" h Lower Vertical extrusion
50A	2	38" h Vertical Connector extrusion
51	1	29" h Upper Vertical extrusion
51A	1	29" h Vertical Connector extrusion
52	4	7.209" w Horizontal extrusion
53	2	38" h Vertical extrusion
54	4	18.0657" w Curved Horizontal extrusion
55	1	38" h Vertical extrusion
56	4	11.09" w Horizontal extrusion
57	1	38" h 90° Vertical Connector extrusion
58	1	38" h Vertical extrusion

- Steps**
- 1) Assemble vertical extrusions by connecting together [50 to 51], [50A and 51A] should stay attached to vertical extrusions [50 and 51] for shipping.
 - 2) Connect lower horizontal extrusions [52 thru 56] between vertical extrusions [50A thru 58] as shown.
 - 3) Place inserts and doors as indicated.
 - 4) Connect upper horizontal extrusions [52 thru 56] between vertical extrusions [50A thru 58] as shown.

Repeat steps for all 4 Pedestals.

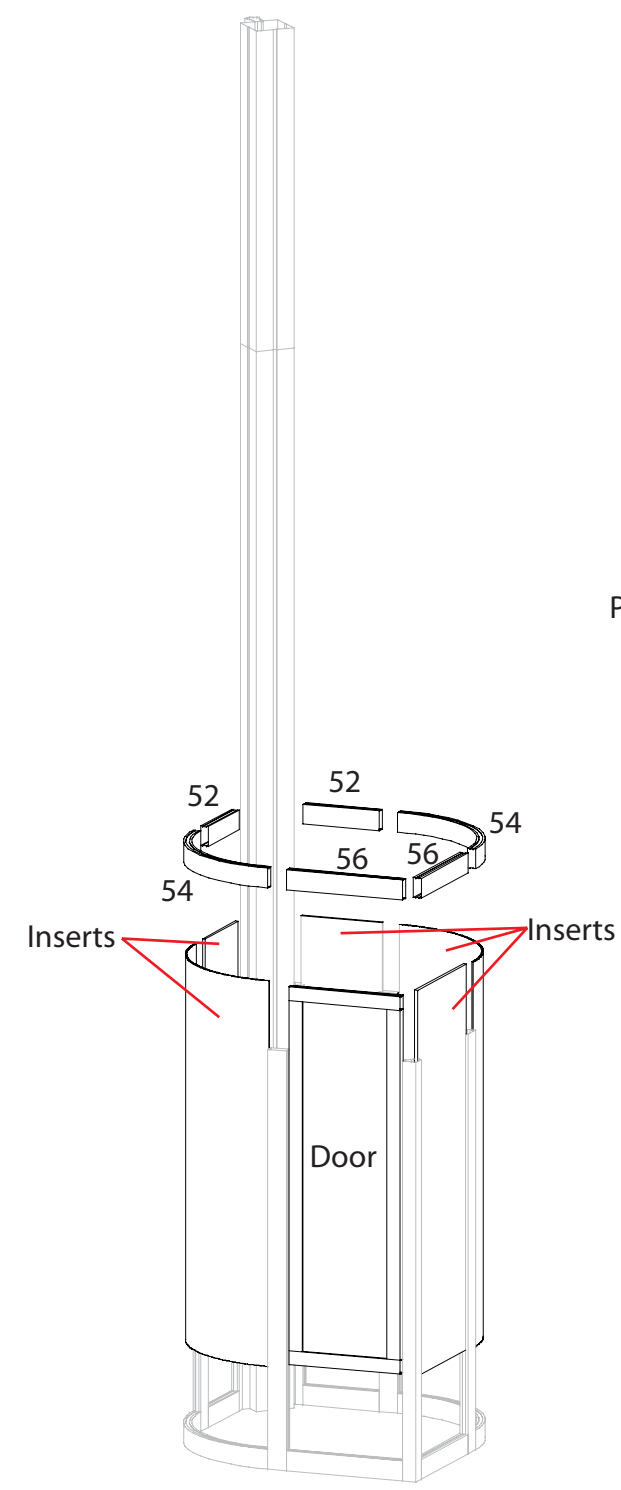
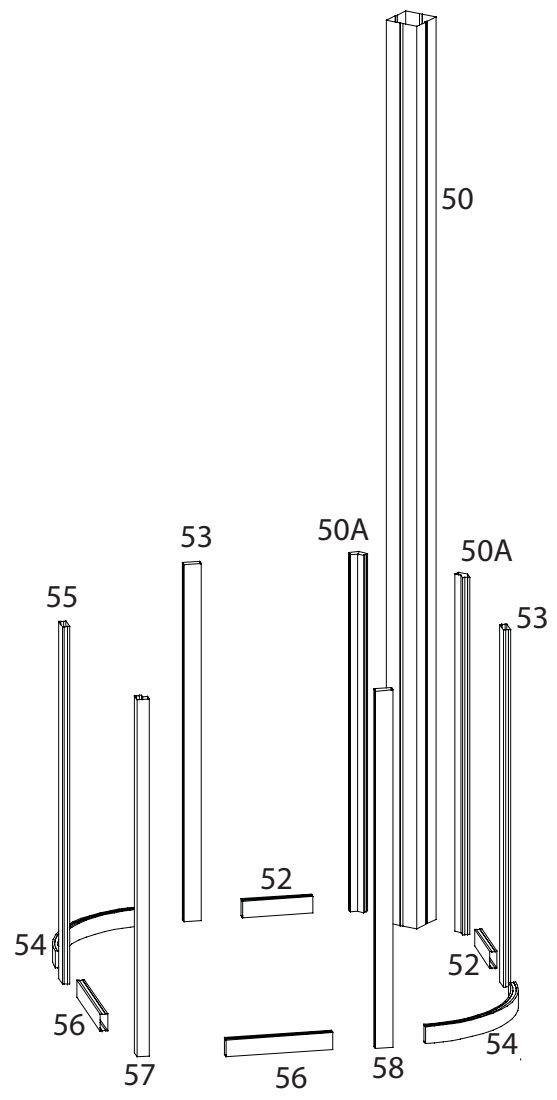

Place internal shelf atop Velcroed supports.

Set Counter atop assembled pedestal.

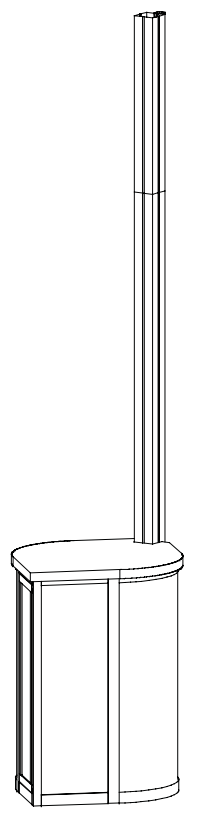
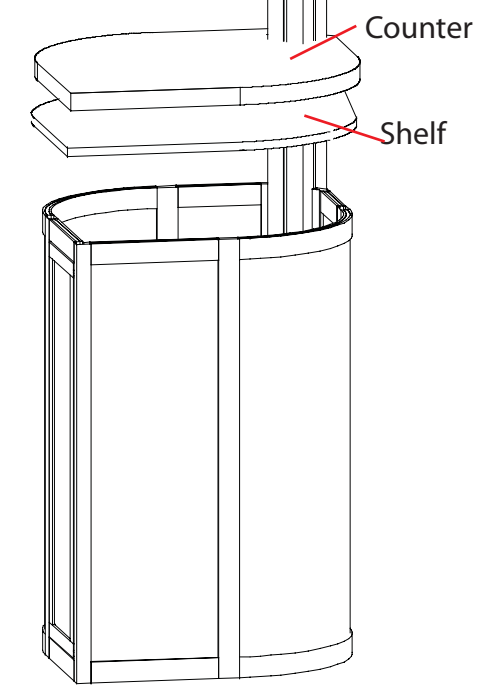

WHEN DISASSEMBLING ALUMINUM EXTRUSION, TIGHTEN ALL SETSCREWS AND LOCKS TO PREVENT LOSS DURING SHIPPING

Part Number	Qty	Description
24	4	XX"w Curved Horizontal extrusion
25	12	XX"w Curved Horizontal extrusion
25A	6	29"h Vertical connector extrusions

Steps

- 1) Connect curved extrusions [24] between vertical connector [51A] which should already be connected to vertical extrusion [51 from previous page] and to custom connection in panels [3 and 4 from Level 3 assembly].
- 2) Connect curved extrusions [25] between vertical connector [51A] which should already be connected to vertical extrusion [51 from previous page] and to vertical extrusions on tower using V10 connection (refer to detail).



Custom Connectors need to be attached to panels 3 and 4 from Level 3 by using screws and tightening from inside with wing nuts.

Then curved horizontal extrusions slide over and tighten into place using set screw.

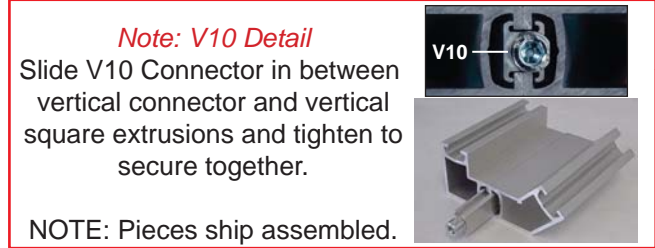

Note: V10 Detail
Slide V10 Connector in between vertical connector and vertical square extrusions and tighten to secure together.

NOTE: Pieces ship assembled.

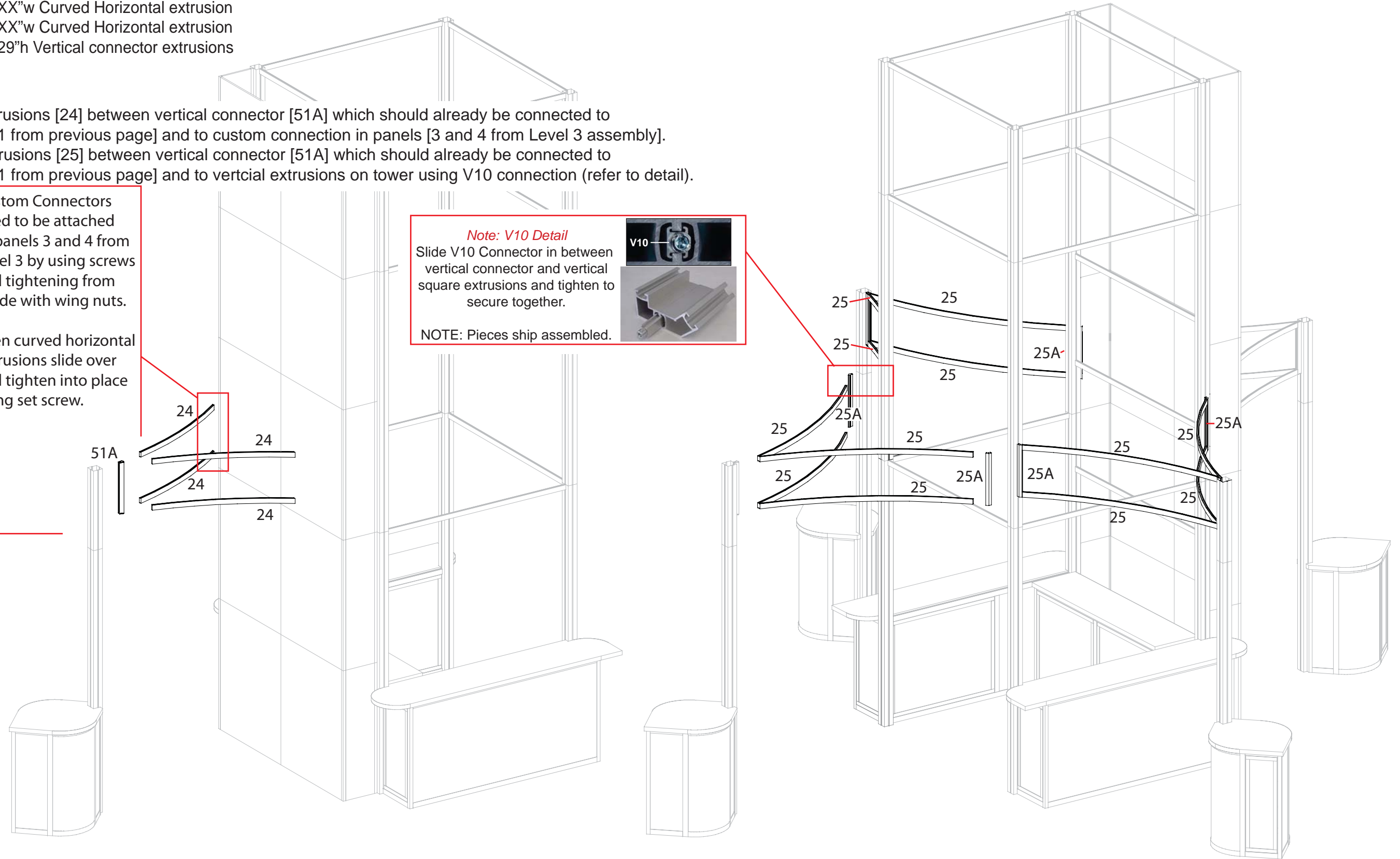

WHEN DISASSEMBLING ALUMINUM EXTRUSION, TIGHTEN ALL SETSCREWS AND LOCKS TO PREVENT LOSS DURING SHIPPING