

Plan View

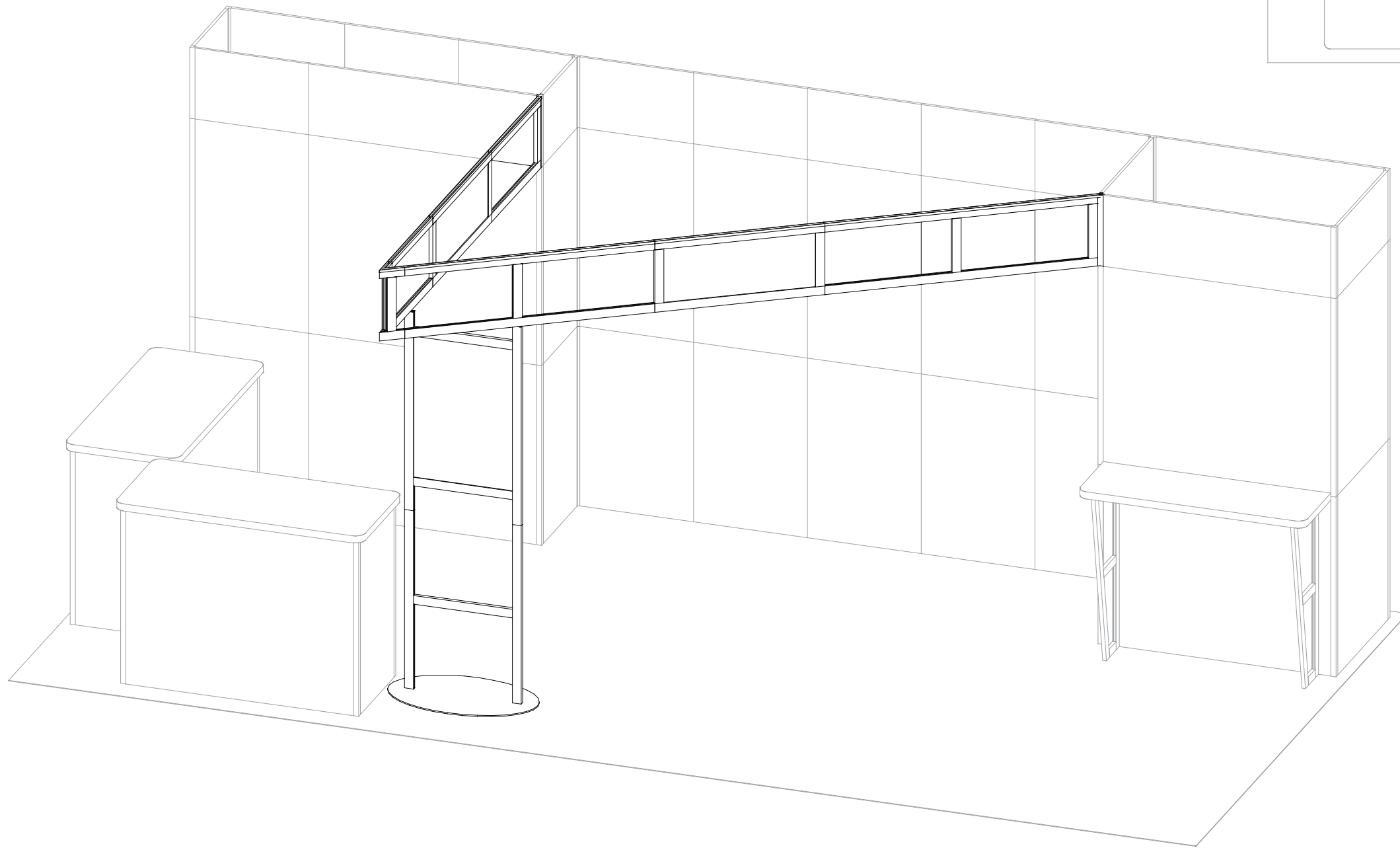

WHEN DISASSEMBLING ALUMINUM EXTRUSION, TIGHTEN ALL SETSCREWS AND LOCKS TO PREVENT LOSS DURING SHIPPING

visionary™ IDESIGNS

Using Your Setup Instructions

The Visionary Designs Setup Instructions are created specifically for your configuration. They are laid out sequentially, including an exploded view of the entire display, and then a logical series of detailed steps to assemble the main structure and components. We encourage you to study the instructions **before** attempting to assemble your exhibit.

Each page reminds you to tighten the setscrews after disassembling your exhibit to prevent loss of the locks and setscrews (see below in RED). This is **VERY IMPORTANT**.

Cleaning and Packing Your Display

- 1) Use care when cleaning aluminum extrusion or acrylic inserts. Use only non-abrasive cleaners.
- 2) When cleaning laminate inserts or countertops, use mild cleansers and a soft material such as cotton.
- 3) Keep all display components away from extreme heat and long exposure to sunlight to avoid warping and fading.
- 4) Retain all packing material. It will make re-packing much easier and will reduce the likelihood of shipping damage.



The Tool

Most Visionary Designs exhibits can be assembled with the supplied Hex Key Tool. Occasionally, a flat head screwdriver may be required.

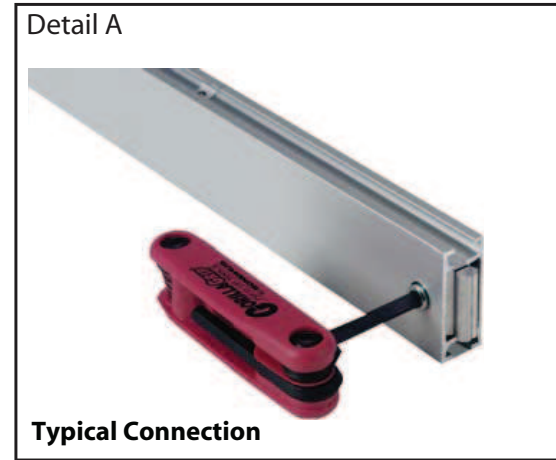

Detail A

Typical Connection



Typical Connection (cont'd)

Most horizontal extrusion connections have a patented expandable lock. This lock inserts into the groove of an opposing extrusion. Tightening the lock with the Hex Key Tool expands the lock and creates a strong positive connection.

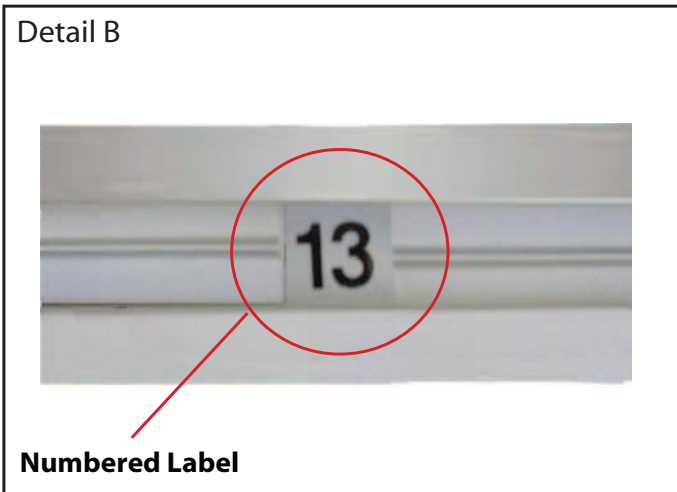

Detail B

Numbered Label

Each extrusion contains a numbered label which corresponds with setup instructions. The label is located within a groove of the extrusion (when possible). With Visionary Designs the labels contain Black numbers unless otherwise specified.



Detail C

Horizontal Inline Connection (remove only one setscrew)

Remove only (1) setscrew when disassembling. Replace setscrew in extrusion after assembling it. Before packing, replace setscrew in extrusion to avoid losing it.

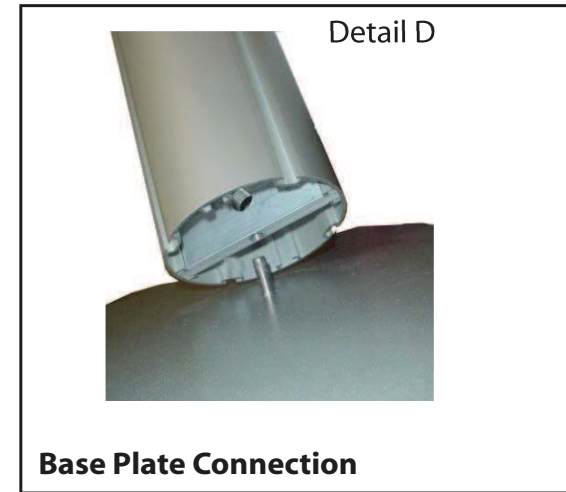

Detail D

Base Plate Connection

Attach base plate to round or square vertical extrusion using the bolt provided. Be careful not to strip the threads.

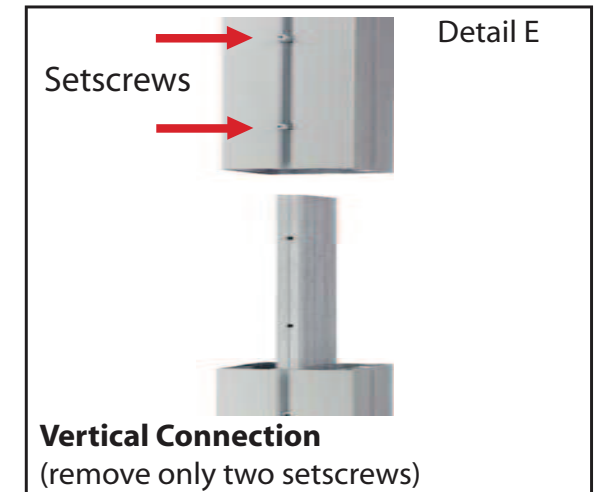

Detail E

Vertical Connection
(remove only two setscrews)

When vertical extrusions are packed in portable cases rather than crates or tubs, they must be broken down into smaller sections which then require assembly.

Remove only (2) setscrews when disassembling. Replace setscrews in extrusion after assembling it. Before packing, replace setscrews in extrusion to avoid losing them.

WHEN DISASSEMBLING ALUMINUM EXTRUSION, TIGHTEN ALL SETSCREWS AND LOCKS TO PREVENT LOSS DURING SHIPPING

866.652.2100

Item	Qty.	Description
1	1	Base Plate
2	2	37.75"h Vertical Extrusion
3	2	42"h Vertical Extrusion
4	3	20"w Horizontal Extrusion

Steps:

- 1) Connect vertical extrusions [2 and 3] together.
- 2) Attach vertical assemblies [2/3] to base plates [1], see detail D on general info page.
- 2) Connect horizontal extrusions [4] between vertical assemblies [2/3], placing insert between upper and middle horizontal extrusions [4] as indicated.

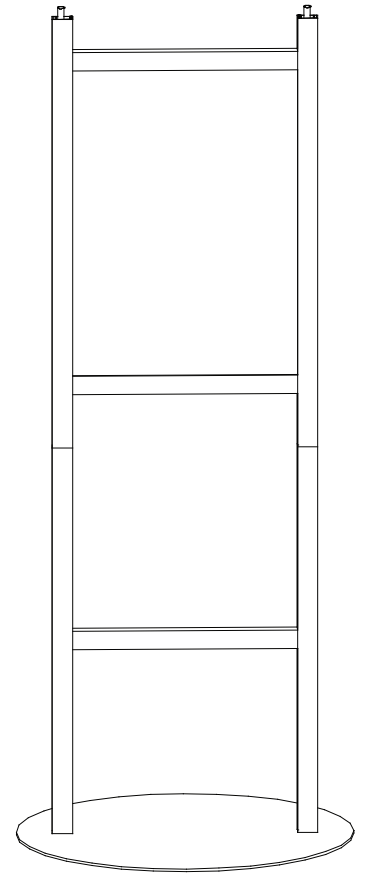
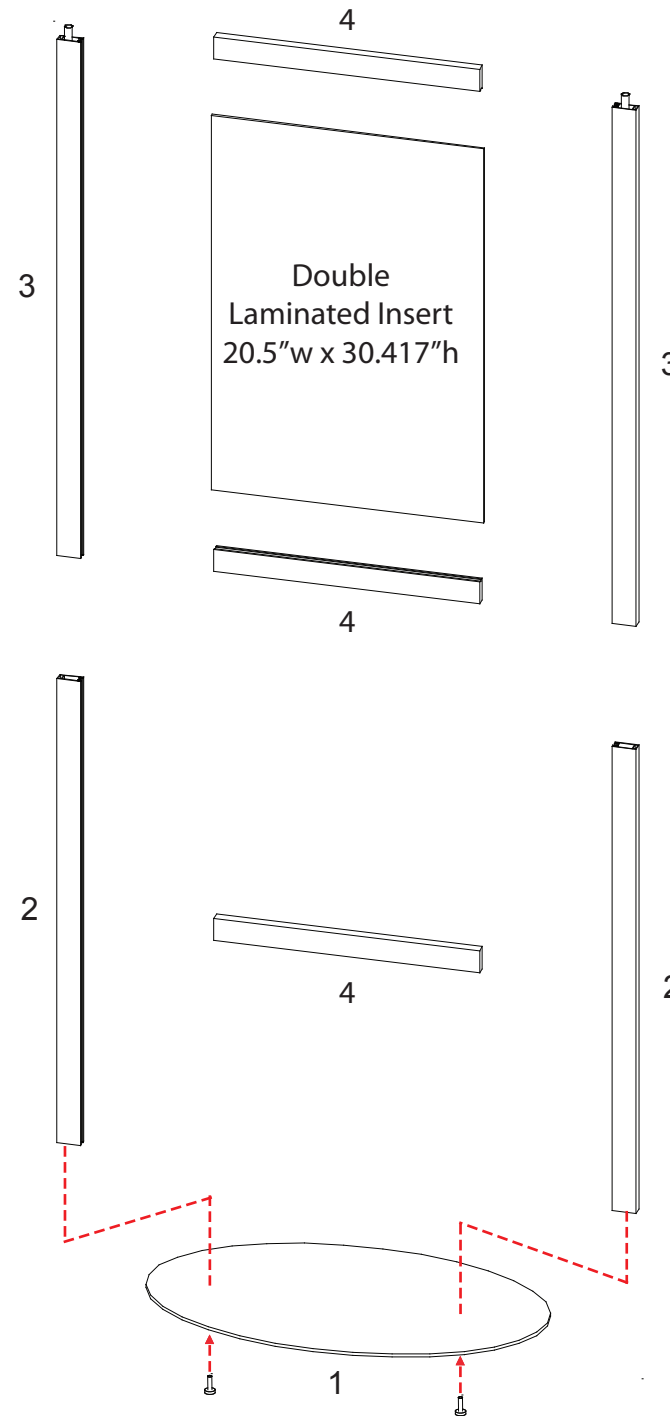

WHEN DISASSEMBLING ALUMINUM EXTRUSION, TIGHTEN ALL SETSCREWS AND LOCKS TO PREVENT LOSS DURING SHIPPING

866.652.2100

Item	Qty.	Description
5	1	Lower Corner Extrusion
6	1	Upper Corner Extrusion
7	1	23.25" w Lower Horizontal Extrusion
8	1	23.25" w Upper Horizontal Extrusion
9	1	33.5" w Lower Horizontal Extrusion
10	1	33.5" w Upper Horizontal Extrusion
11	1	28.25" w Lower Horizontal Extrusion
12	1	28.25" w Upper Horizontal Extrusion
13	1	49.27" w Lower Horizontal Extrusion
14	1	49.27" w Upper Horizontal Extrusion
15	1	33.5" w Lower Horizontal Extrusion
16	1	33.5" w Upper Horizontal Extrusion
17	1	54.259" w Lower Horizontal Extrusion
18	1	54.259" w Upper Horizontal Extrusion
19	10	11.418" w Vertical Extrusion

Steps:

- 1) Connect horizontal pieces and corner pieces together [12 to 10 to 8 to 4 to 14 to 16 to 18, and 11 to 9 to 7 to 5 to 13 to 15 to 17].
- 2) Connect upper and lower assemblies together using vertical extrusions [19], placing inserts as indicated.

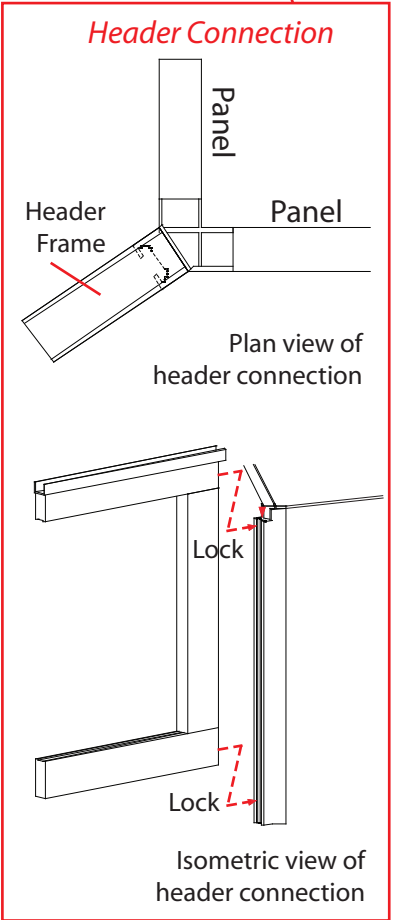
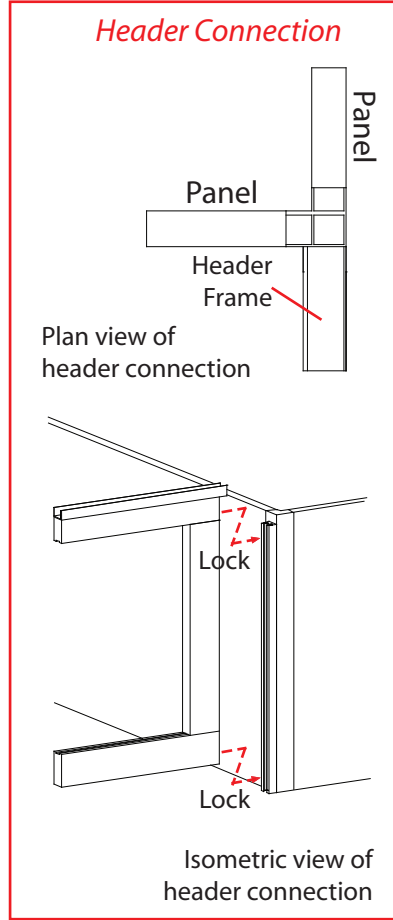
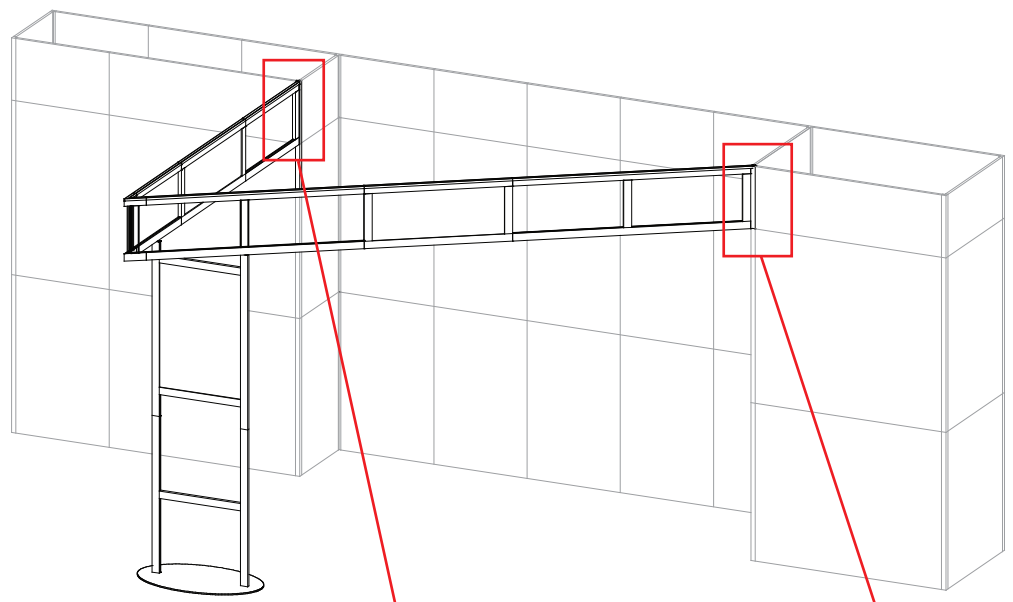
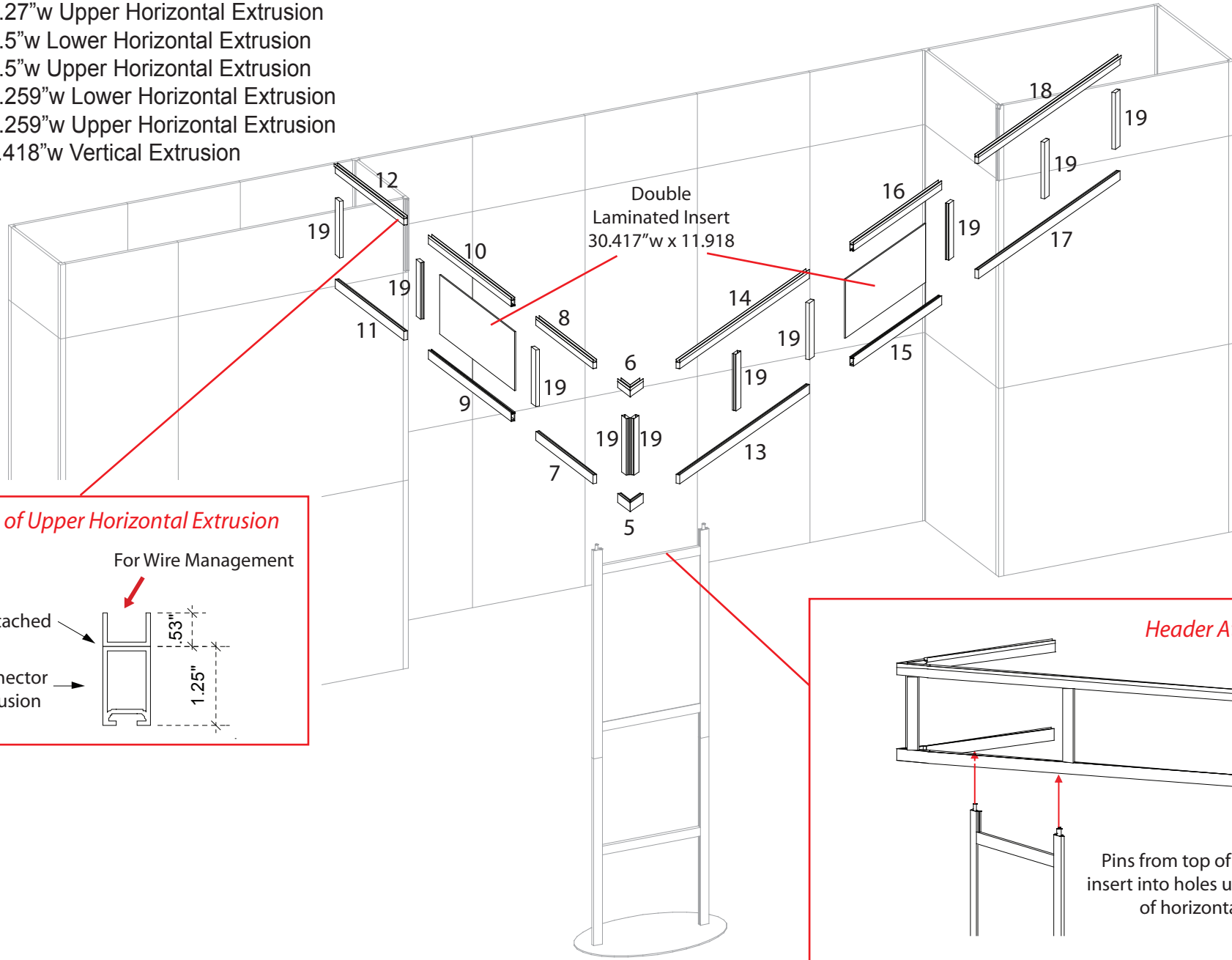

WHEN DISASSEMBLING ALUMINUM EXTRUSION, TIGHTEN ALL SETSCREWS AND LOCKS TO PREVENT LOSS DURING SHIPPING

866.652.2100

Item	Qty.	Description
20	1	25.605"w Horizontal Extrusion
21	1	25.605"w Horizontal Extrusion
22	1	46.5"h Vertical Extrusion
23	1	46.5"h Vertical Extrusion
24	1	46.5"h Vertical Extrusion
25	1	46.5"h Vertical Extrusion

Steps:

- 1) Connect vertical extrusions [22 to 23 and 24 to 25] together.
- 2) Connect vertical assemblies together by attaching horizontal extrusions [20 and 21] between vertical assemblies as shown.

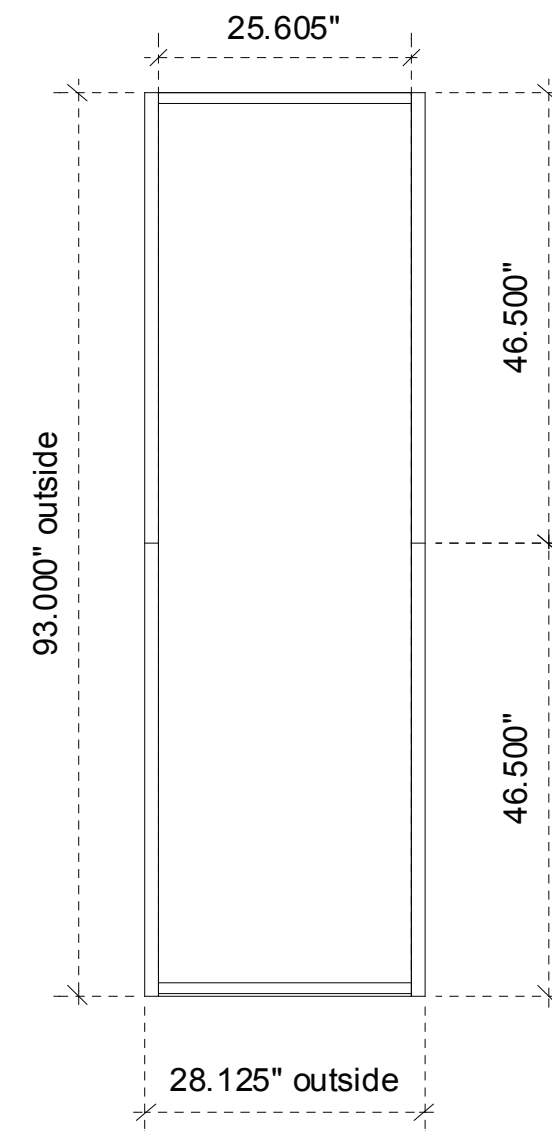
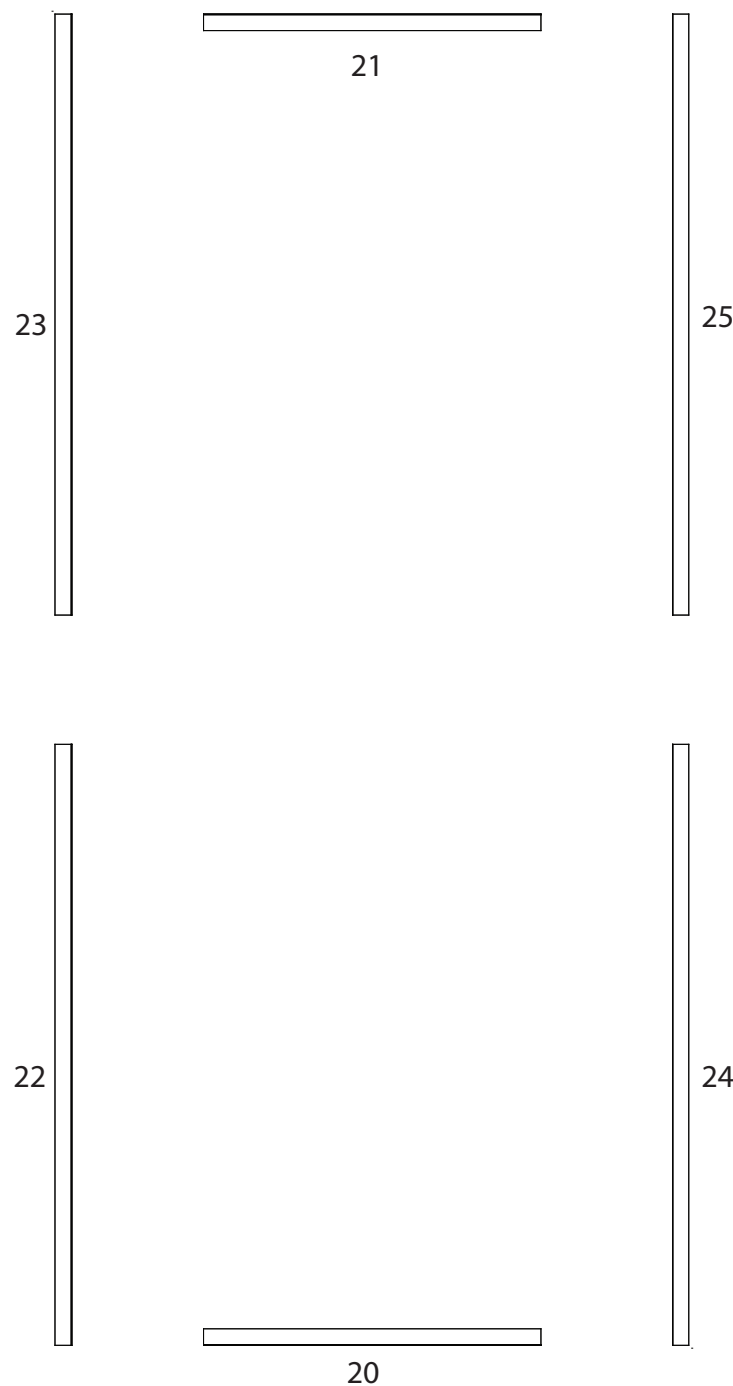

WHEN DISASSEMBLING ALUMINUM EXTRUSION, TIGHTEN ALL SETSCREWS AND LOCKS TO PREVENT LOSS DURING SHIPPING

866.652.2100

Item	Qty.	Description
26	1	17.23"w Horizontal Extrusion
27	1	17.23"w Horizontal Extrusion
28	1	46.5"h Vertical Extrusion
29	1	46.5"h Vertical Extrusion
30	1	46.5"h Vertical Extrusion
31	1	46.5"h Vertical Extrusion

- Steps:
- 1) Connect vertical extrusions [28 to 29 and 30 to 31] together.
 - 2) Connect vertical assemblies together by attaching horizontal extrusions [26 and 27] between vertical assemblies as shown.

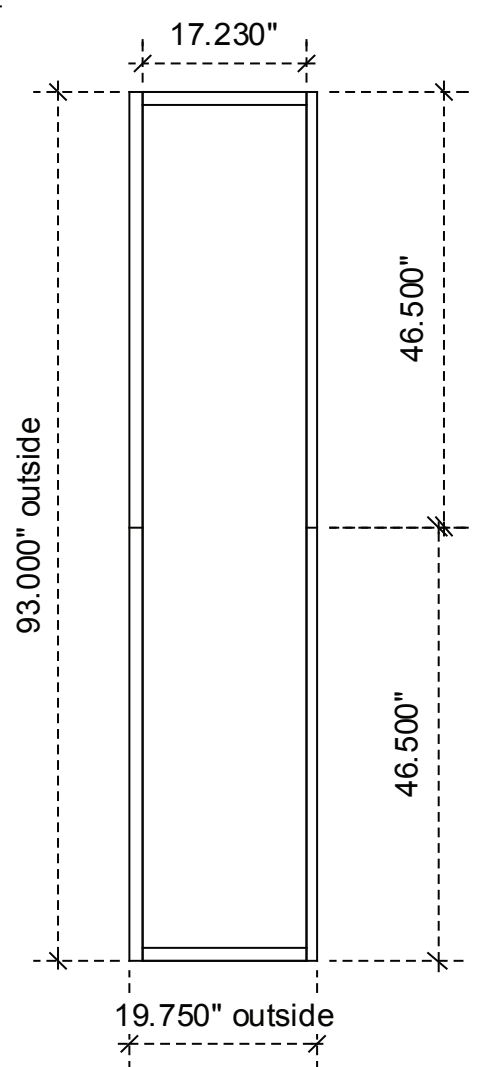
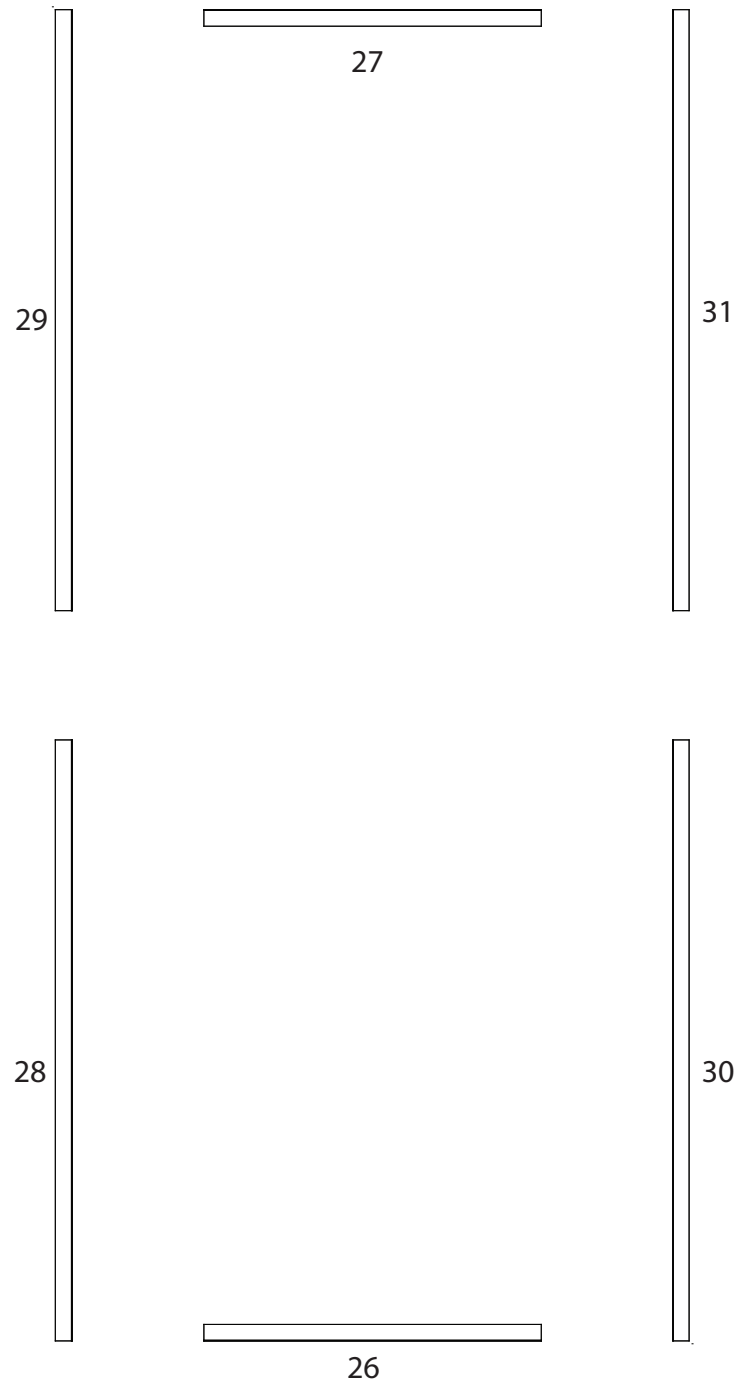

WHEN DISASSEMBLING ALUMINUM EXTRUSION, TIGHTEN ALL SETSCREWS AND LOCKS TO PREVENT LOSS DURING SHIPPING

866.652.2100

Plan View of Assembled Backwall

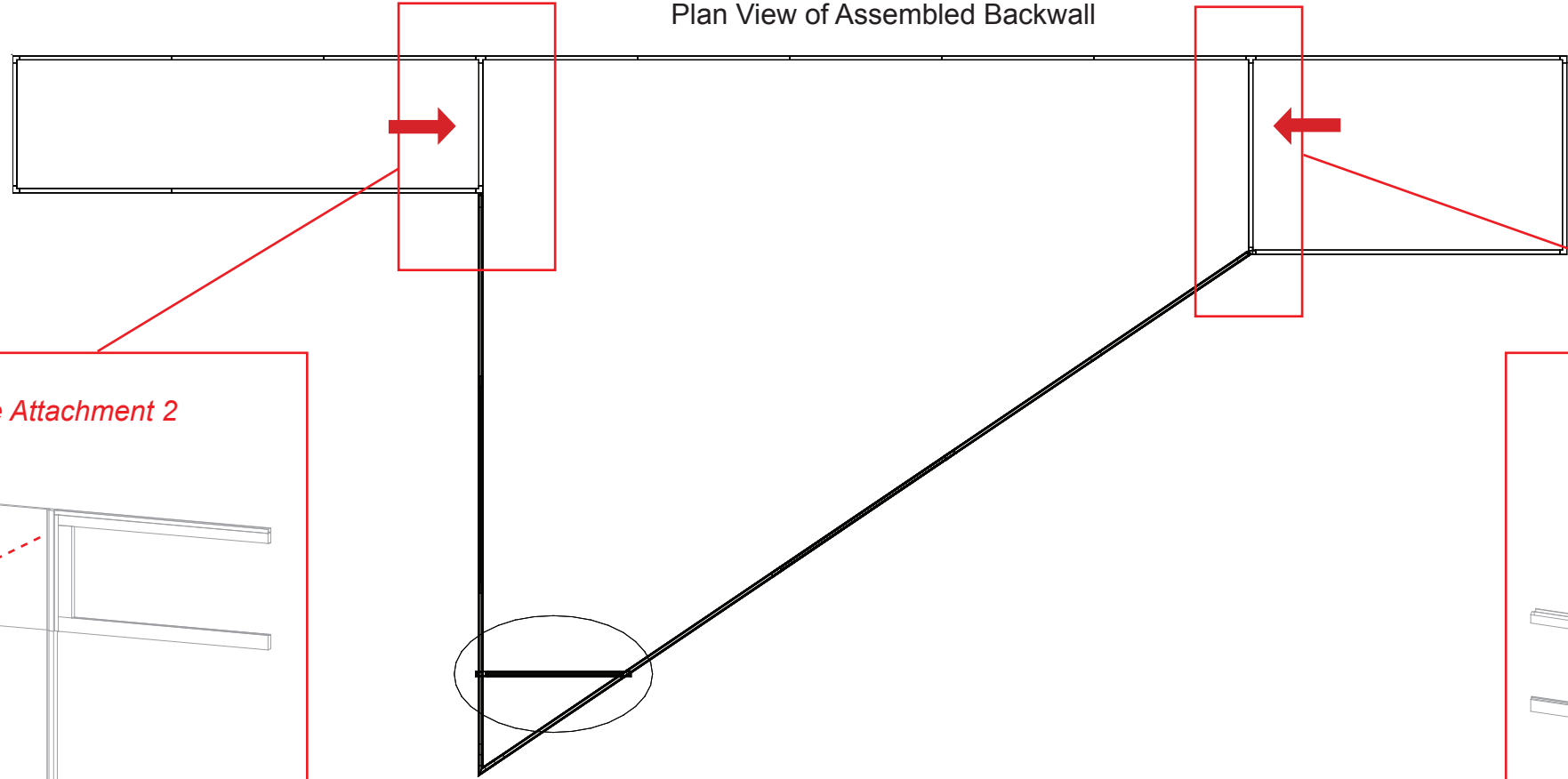

Stabilizing Frame Attachment 2

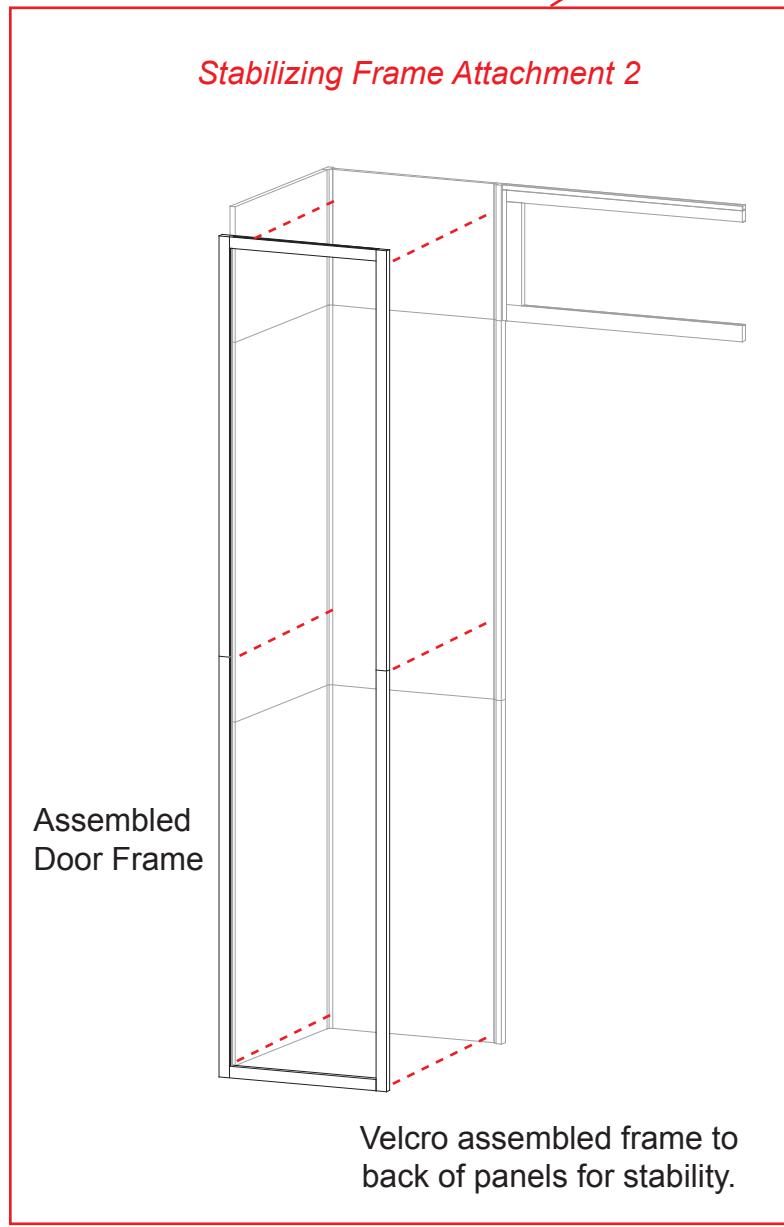

Stabilizing Frame Attachment 1

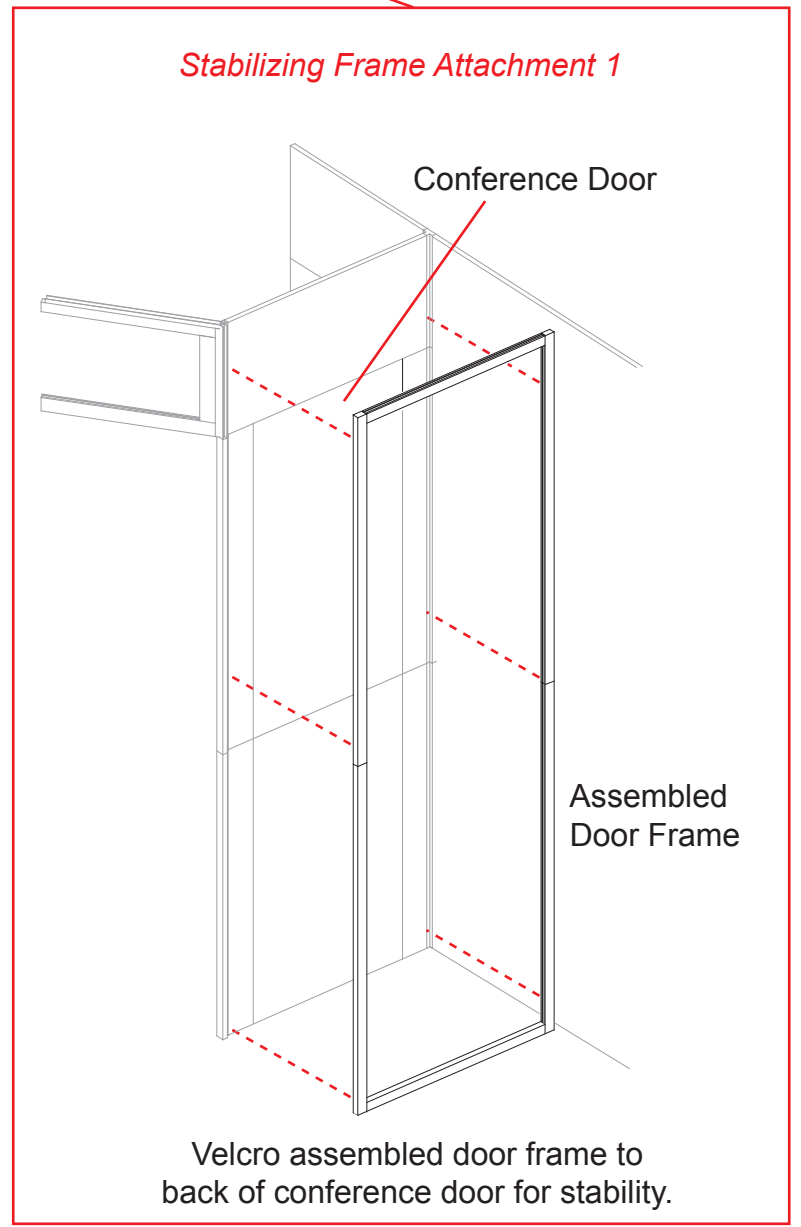

WHEN DISASSEMBLING ALUMINUM EXTRUSION, TIGHTEN ALL SETSCREWS AND LOCKS TO PREVENT LOSS DURING SHIPPING