

WHEN DISASSEMBLING ALUMINUM EXTRUSION, TIGHTEN ALL SETSCREWS AND LOCKS TO PREVENT LOSS DURING SHIPPING

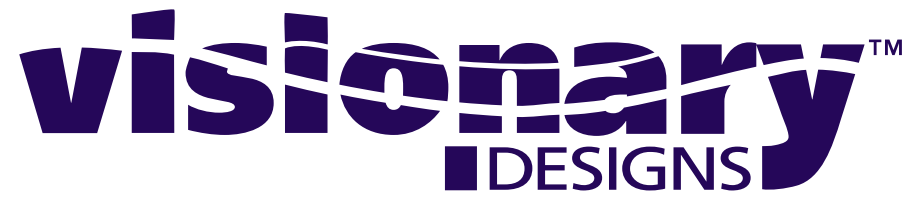

Using Your Setup Instructions

The Euro LT Hybrids Setup Instructions are created specifically for your configuration. They are laid out sequentially in levels, including exploded views, and a logical series of detailed steps to assemble the main structure and components. We encourage you to study the instructions **before** attempting to assemble your exhibit.

Each page reminds you to tighten the setscrews after disassembling your exhibit to prevent loss of the locks and setscrews (see below in RED). This is VERY IMPORTANT.

Cleaning and Packing Your Display

- 1) Use care when cleaning aluminum extrusion or acrylic inserts. Use only non-abrasive cleaners.
- 2) When cleaning laminate inserts, countertops, or panels use mild cleansers and a soft material such as cotton.
- 3) Keep all display components away from extreme heat and long exposure to sunlight to avoid warping and fading.
- 4) Retain all packing material. It will make re-packing much easier and will reduce the likelihood of shipping damage.

General Setup Instructions for Extrusion System



Most exhibits can be assembled with the supplied Hex Key Tool. Occasionally, a flat head screwdriver may be required.



Most horizontal extrusion connections have a patented expandable lock. This lock inserts into the groove of an opposing extrusion. Tightening the lock with the Hex Key Tool expands the lock and creates a strong positive connection.

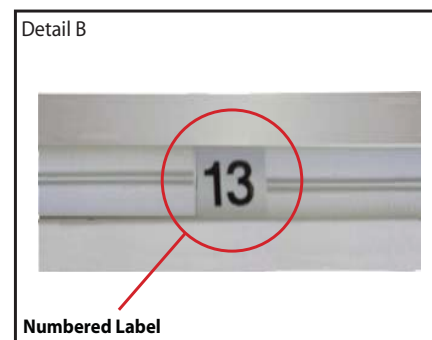

Each extrusion contains a numbered label which corresponds with setup instructions. The label is located within a groove of the extrusion (when possible). With extrusion components the labels contain Black numbers unless otherwise specified.



Remove only (1) setscrew when disassembling. Replace setscrew in extrusion after assembling it. Before packing, replace setscrew in extrusion to avoid losing it.

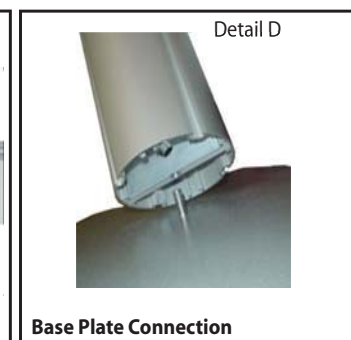

Attach base plate to round or square vertical extrusion using the bolt provided. Be careful not to strip the threads.

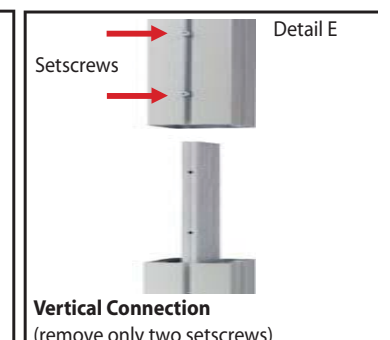

When vertical extrusions are packed in portable cases rather than crates or tubs, they must be broken down into smaller section which then require assembly.

Remove only (2) setscrews when disassembling. Replace setscrews in extrusion after assembling it. Before packing, replace setscrews in extrusion to avoid losing them.

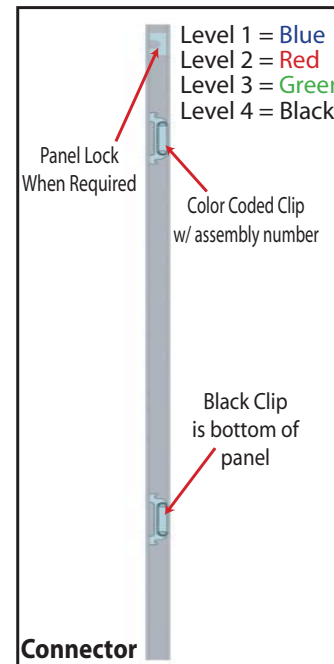

Each component has 2 clips, the lower clip is ALWAYS black. The top clip is color coded to distinguish which level. The color coded clip also contains the numbered label.

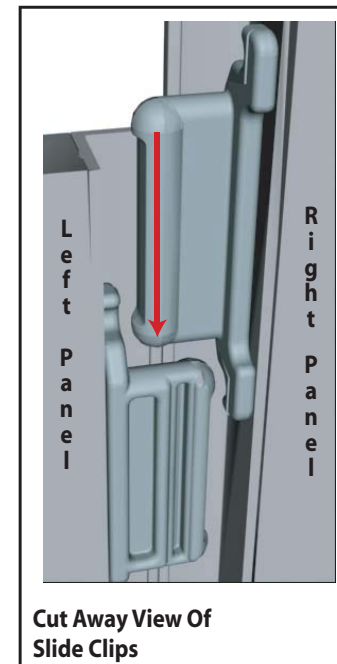

Components connect together by aligning them and sliding downward connecting clips together.

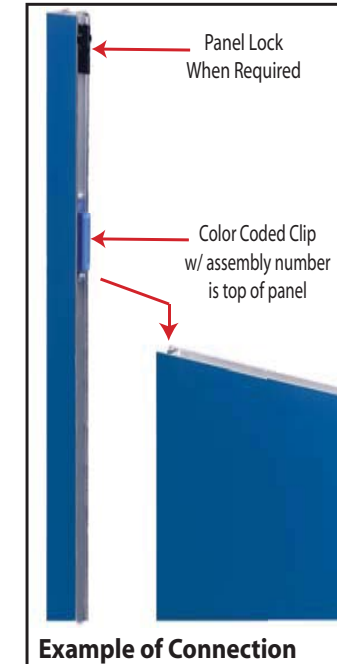

Configurations are assembled from left to right, usually starting with #1 and following the numbered sequence.

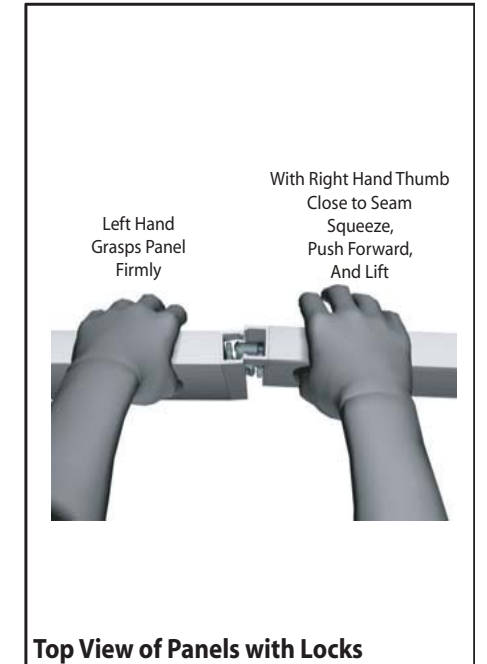

The first level of components contain panel locks that are located at the top of the panel for extra stability and seamless connection. When disassembling panels twist top connection slightly and lift right panel upward.

WHEN DISASSEMBLING ALUMINUM EXTRUSION, TIGHTEN ALL SETSCREWS AND LOCKS TO PREVENT LOSS DURING SHIPPING

866.652.2100

Item	Qty.	Description
1	2	Small Base Plate
1a	1	Large Base Plate
2	1	96"h Vertical Extrusion
3	2	96"h Vertical Extrusion
4	1	95.75"h Vertical Extrusion
5	1	95.75"h Vertical Extrusion
6	1	Vertical Support Extrusion
7	1	Counter Support
7a	1	Lower Horizontal Extrusion
8	1	47.9955"w Curved Extrusion
9	1	47.9955"w Curved Extrusion
10	1	40"w Horizontal Extrusion
11	1	40"w Horizontal Extrusion
12	6	17.868"w Curved Extrusion

- Steps:
- 1) Attach vertical vertical extrusions [2 and 5] to base plates [1] as shown, see detail D on general info page.
 - 2) Attach vertical extrusion [4] and vertical support extrusion [6] to base plate [1a] as shown.
 - 3) Attach curved horizontal extrusions [8 and 9 between vertical extrusions [2 and 3] and horizontal extrusions [10 and 11] between vertical extrusions [3 and 5].
 - 4) Attach curved horizontal extrusions [12] between vertical extrusions [3 and 4], placing inserts [A] as shown.
 - 5) Attach horizontal extrusions [7 and 7a] between vertical extrusions [4 and 6], placing insert [B] in place.
 - 6) Attach counter top atop counter support and secure with thumbscrews to vertical extrusion [4].
 - 7) Apply graphics to assembled backwall

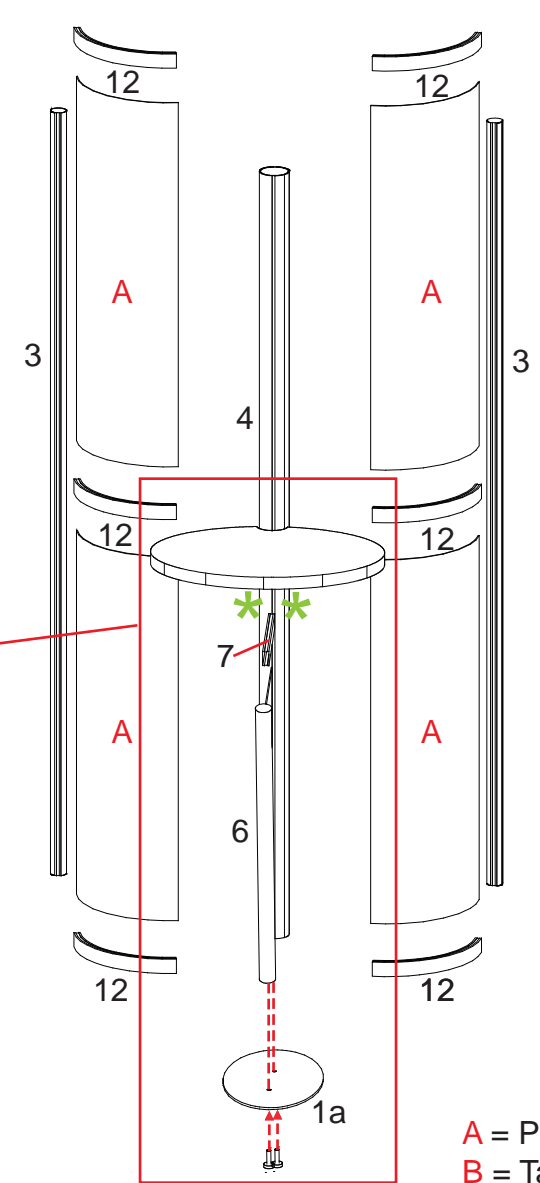
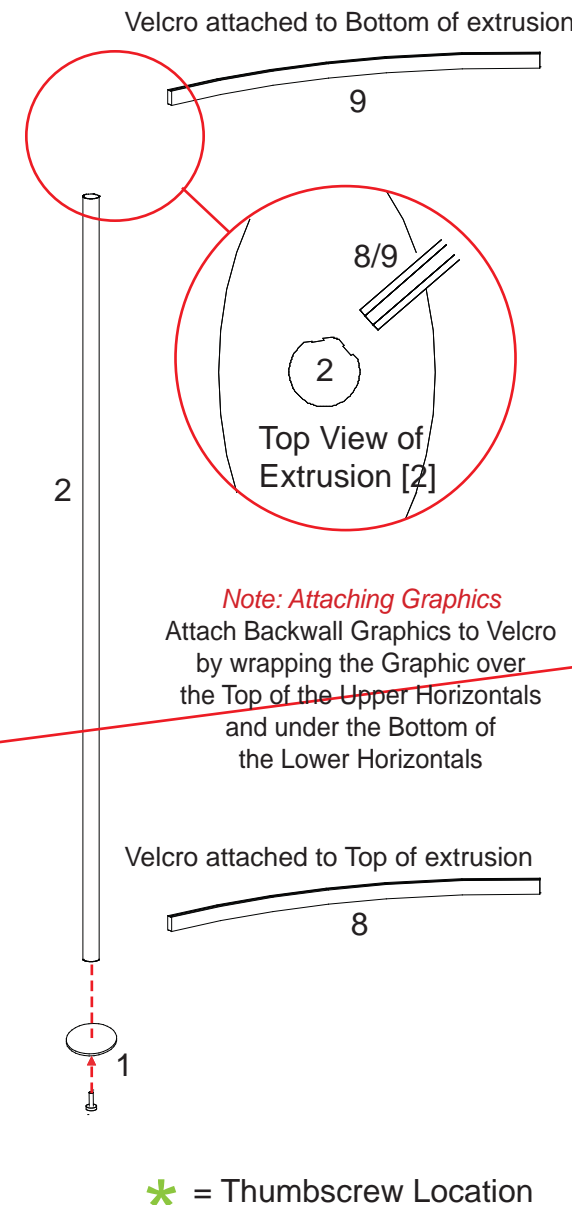
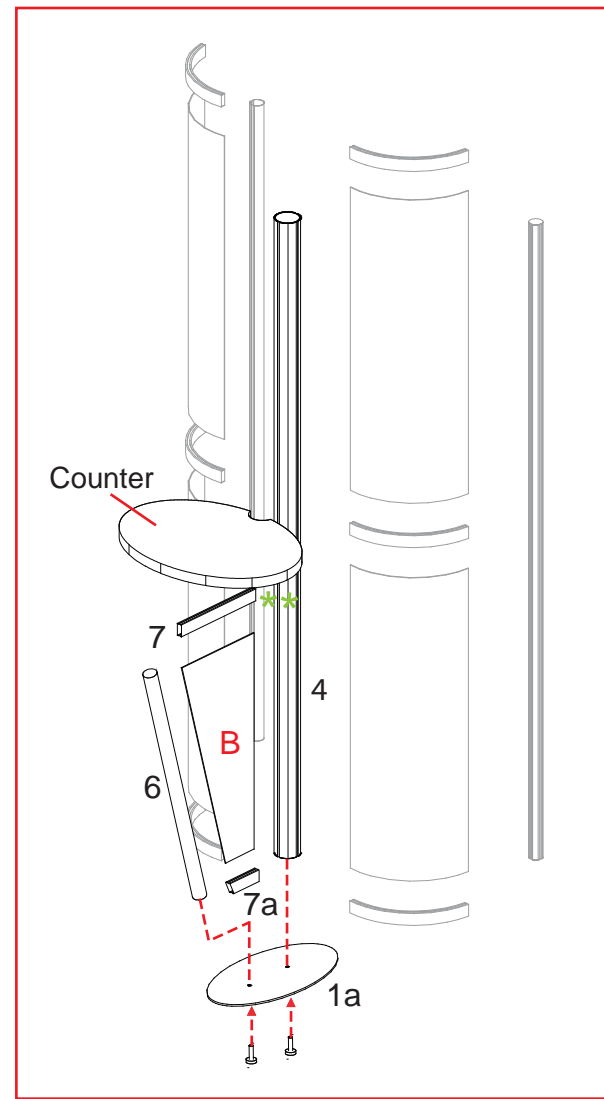
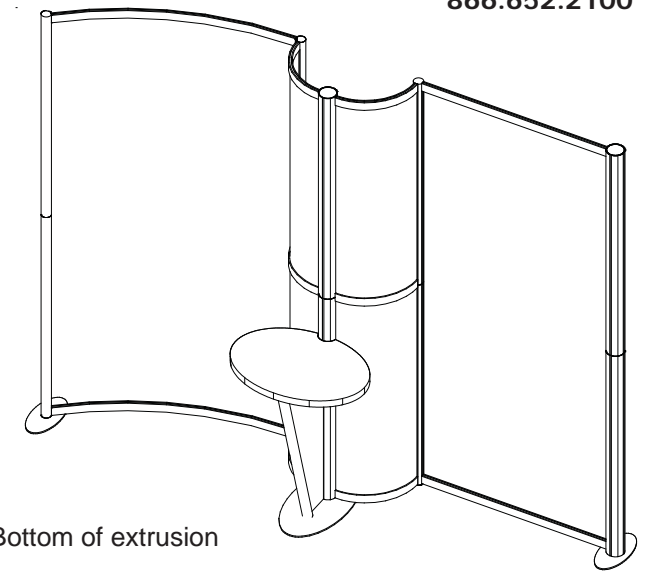

WHEN DISASSEMBLING ALUMINUM EXTRUSION, TIGHTEN ALL SETSCREWS AND LOCKS TO PREVENT LOSS DURING SHIPPING

866.652.2100

Item	Qty.	Description
13	1	57.1897" w Curved Horizontal Extrusion
14	2	11.418" h Vertical Extrusion
15	1	57.1897" w Curved Horizontal Extrusion
16	10	2" w Extrusion
17	5	T Connector
18	5	3" w Extrusion

Steps:

- 1) Assemble header by attaching vertical extrusions [14] between curve extrusions [13 and 15] as shown.
- 2) Apply graphic to assembled header, then hook header to top of vertical extrusions [2 and 4].
- 3) Assemble shelf supports as shown in shelf support assembly.
- 4) Attach assembled shelf supports to vertical extrusion [5], then place shelves atop supports.

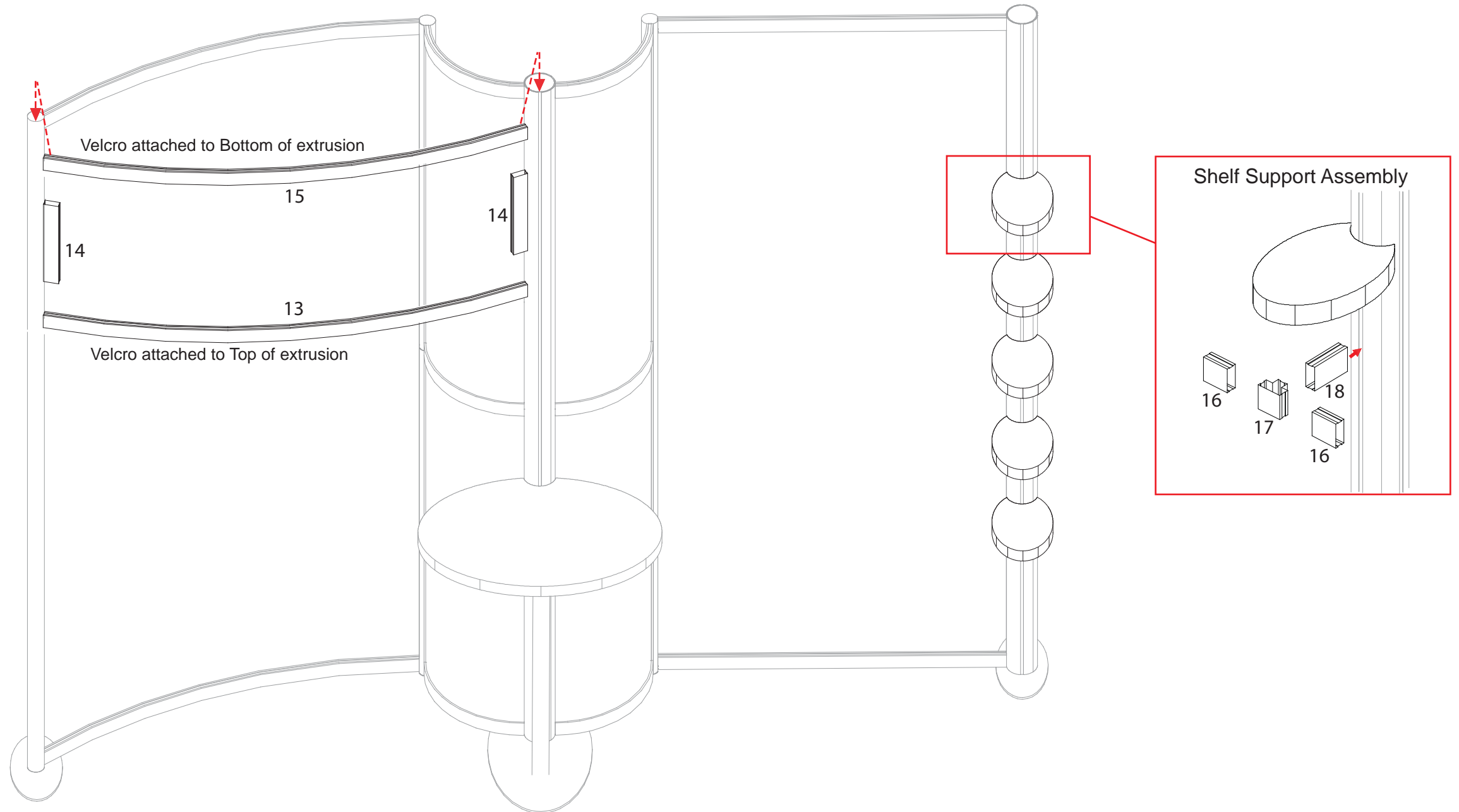

WHEN DISASSEMBLING ALUMINUM EXTRUSION, TIGHTEN ALL SETSCREWS AND LOCKS TO PREVENT LOSS DURING SHIPPING

866.652.2100

Item Number	Description
1	9.5"r x 38"h Quarter Curve Panel
2	9.5"r x 38"h Quarter Curve Panel
3	31.1"r x 38"h Quarter Curve Panel
4	31.1"r x 38"h Quarter Curve Panel
5	9.5"r x 38"h Quarter Curve Panel
6	9.5"r x 38"h Quarter Curve Panel
7	9.5"r x 38"h Quarter Curve Panel w/ Door

- Steps:
- 1) Assemble by starting at panel #1 and continue in numerical order.
 - 2) Velcro internal shelf supports to inside of assembled base.
 - 3) Set internal shelf atop shelf supports.
 - 4) Place counter atop assembled pedestal base.

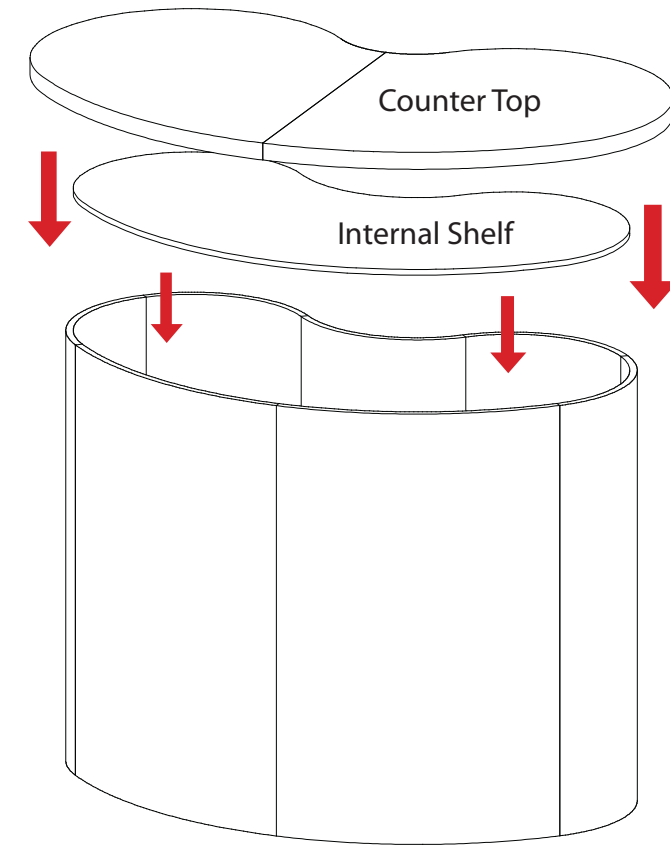
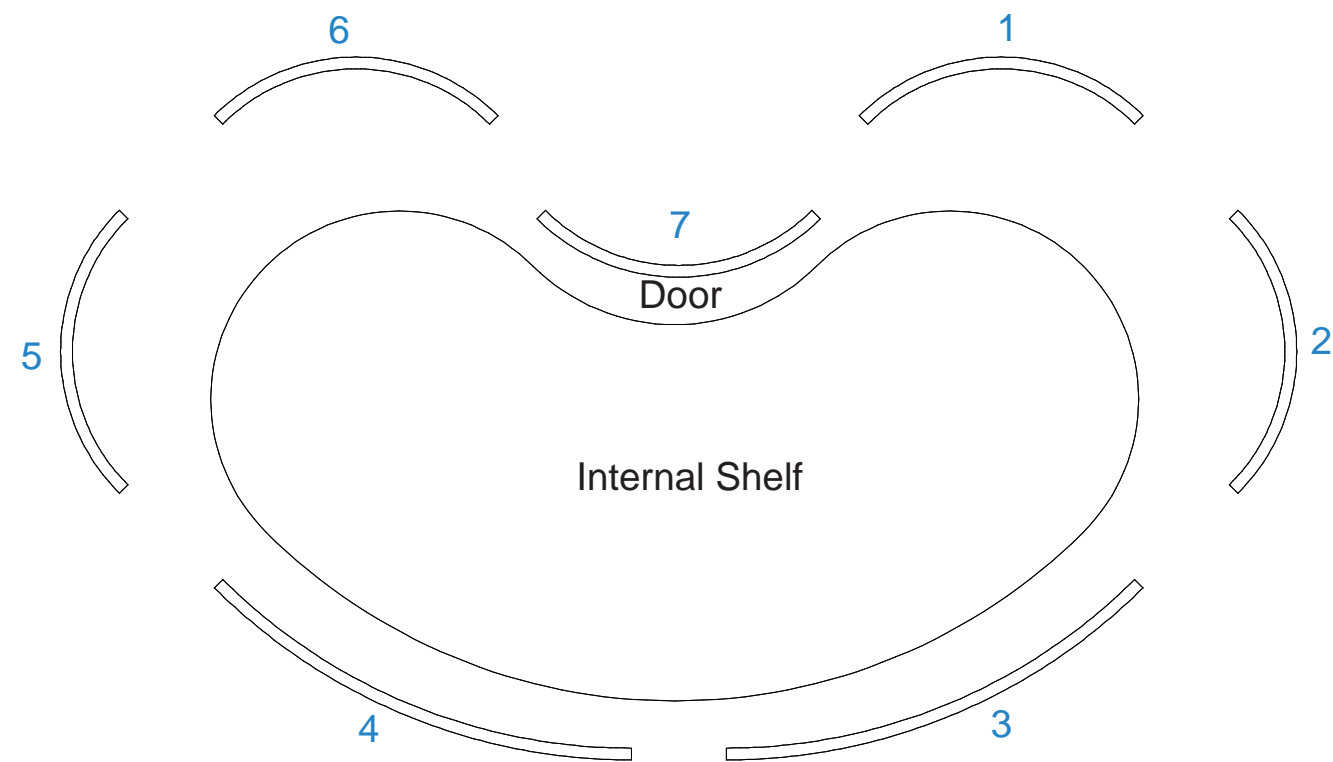
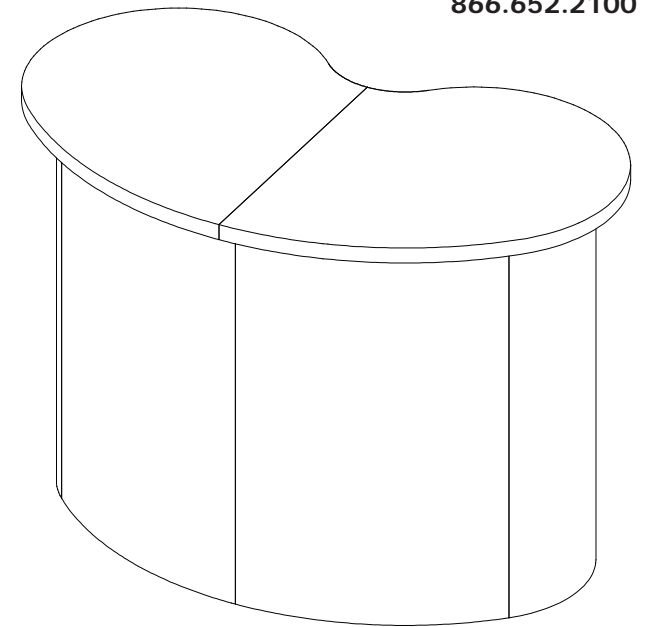

Place counter atop assembled pedestal base.

WHEN DISASSEMBLING ALUMINUM EXTRUSION, TIGHTEN ALL SETSCREWS AND LOCKS TO PREVENT LOSS DURING SHIPPING

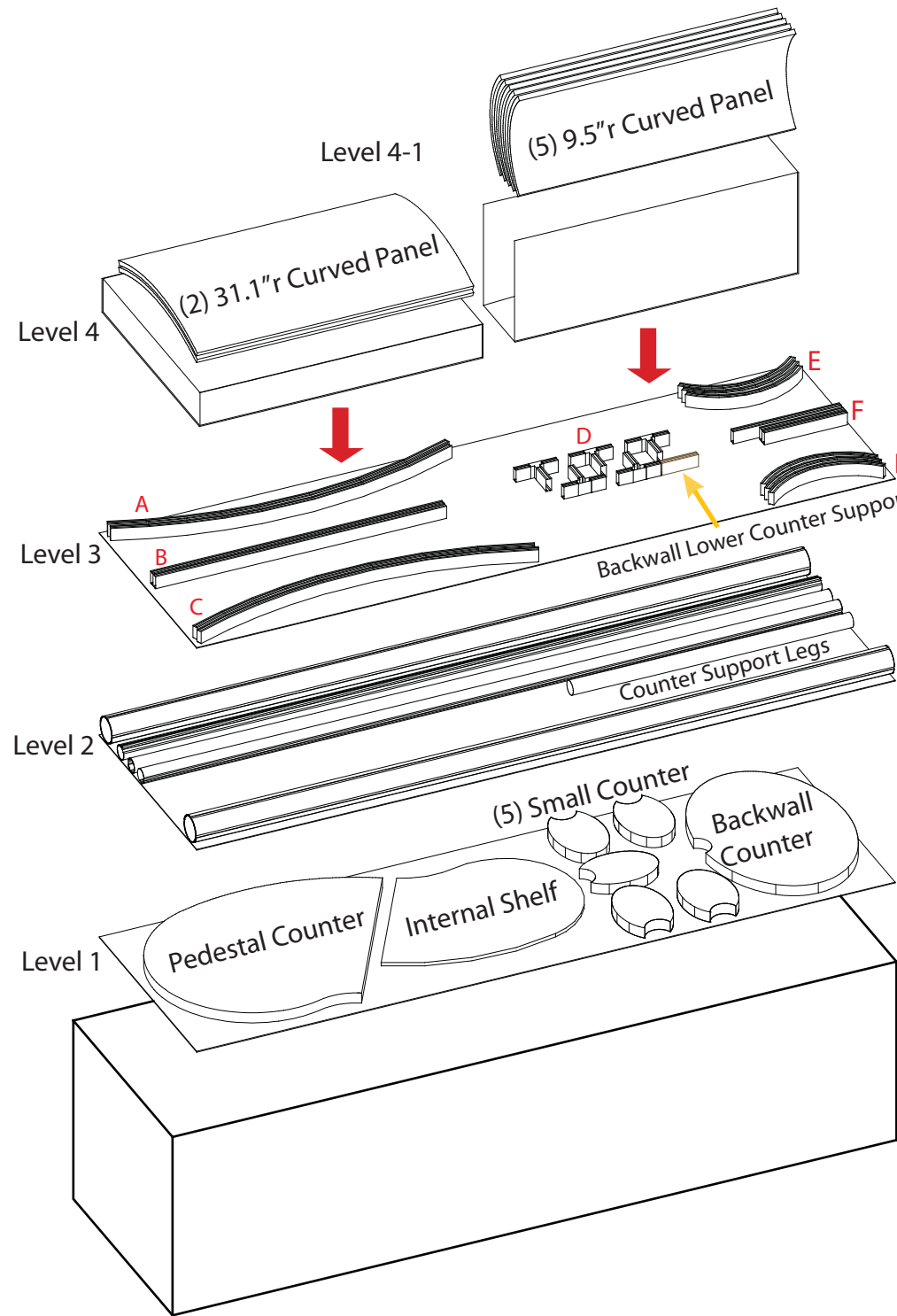

- Level 2: Part List**
- A - (2) 47.9955" Backwall Curved Extrusion
 - B - (2) 40"w Backwall Extrusion
 - C - (2) 57.1897" Header Curved Extrusion
 - D - (5) Assembled Small Shelf Support
 - (1) Backwall Lower Counter Support
 - E - (6) 17.868" Backwall Curved Extrusion
 - F - (1) Backwall Counter Support
 - (2) 11.418" Header Vertical Extrusion

- Level 1: Part List**
- (1) 95.75"h Round Extrusion
 - (3) 96"h Round Extrusion
 - (1) Backwall Counter Support
 - 95.75"h Round Extrusion

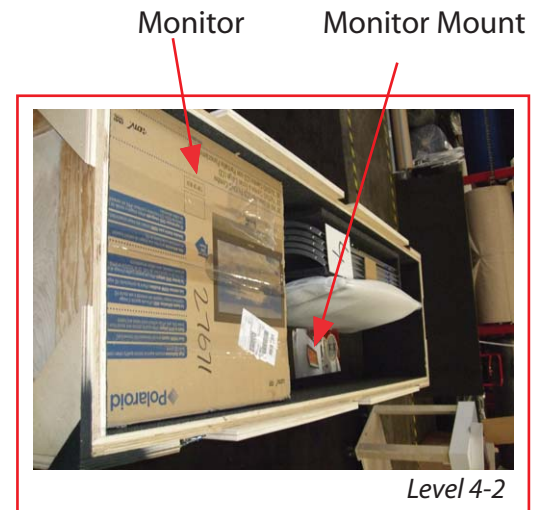
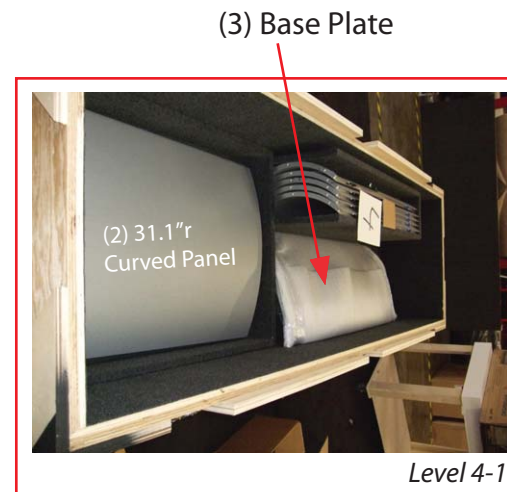
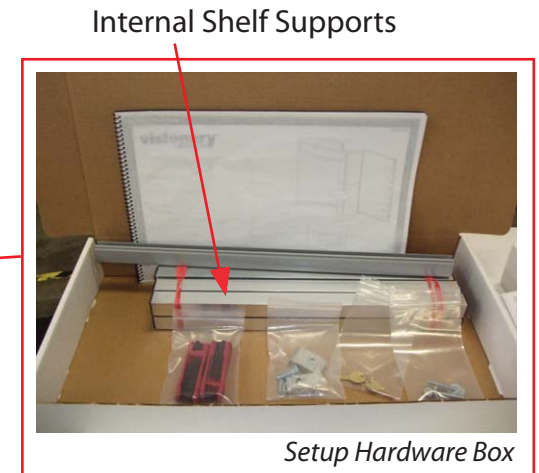

WHEN DISASSEMBLING ALUMINUM EXTRUSION, TIGHTEN ALL SETSCREWS AND LOCKS TO PREVENT LOSS DURING SHIPPING