

WHEN DISASSEMBLING ALUMINUM EXTRUSION, TIGHTEN ALL SETSCREWS AND LOCKS TO PREVENT LOSS DURING SHIPPING

visionary™ DESIGNS

Using Your Setup Instructions

The Visionary Designs Setup Instructions are created specifically for your configuration. They are laid out sequentially, including an exploded view of the entire display, and then a logical series of detailed steps to assemble the main structure and components. We encourage you to study the instructions **before** attempting to assemble your exhibit.

Each page reminds you to tighten the setscrews after disassembling your exhibit to prevent loss of the locks and setscrews (see below in RED). This is **VERY IMPORTANT**.

Cleaning and Packing Your Display

- 1) Use care when cleaning aluminum extrusion or acrylic inserts. Use only non-abrasive cleaners.
- 2) When cleaning laminate inserts or countertops, use mild cleansers and a soft material such as cotton.
- 3) Keep all display components away from extreme heat and long exposure to sunlight to avoid warping and fading.
- 4) Retain all packing material. It will make re-packing much easier and will reduce the likelihood of shipping damage.



The Tool

Most Visionary Designs exhibits can be assembled with the supplied Hex Key Tool. Occasionally, a flat head screwdriver may be required.



Detail A

Typical Connection



Typical Connection (cont'd)

Most horizontal extrusion connections have a patented expandable lock. This lock inserts into the groove of an opposing extrusion. Tightening the lock with the Hex Key Tool expands the lock and creates a strong positive connection.



Detail B

Numbered Label

Each extrusion contains a numbered label which corresponds with setup instructions. The label is located within a groove of the extrusion (when possible). With Visionary Designs the labels contain Black numbers unless otherwise specified.



Detail C

Horizontal Inline Connection (remove only one setscrew)

Remove only (1) setscrew when disassembling. Replace setscrew in extrusion after assembling it. Before packing, replace setscrew in extrusion to avoid losing it.



Detail D

Base Plate Connection

Attach base plate to round or square vertical extrusion using the bolt provided. Be careful not to strip the threads.



Detail E

Vertical Connection
(remove only two setscrews)

When vertical extrusions are packed in portable cases rather than crates or tubs, they must be broken down into smaller sections which then require assembly.

Remove only (2) setscrews when disassembling. Replace setscrews in extrusion after assembling it. Before packing, replace setscrews in extrusion to avoid losing them.

WHEN DISASSEMBLING ALUMINUM EXTRUSION, TIGHTEN ALL SETSCREWS AND LOCKS TO PREVENT LOSS DURING SHIPPING

866.652.2100

Item	Qty.	Description
1	1	Oval Base Plate
2	3	42" h Lower Square Vertical Extrusion
3	1	42" h Upper Square Vertical Extrusion w/ Canopy Attachment
4	2	42" h Upper Square Vertical Extrusion
5	1	41.75" h Lower Round Vertical Extrusion
6	1	42" h Upper Round Vertical Extrusion w/ Canopy Attachment
7	1	12.209" Horizontal Extrusion
8	1	12.209" Horizontal Extrusion
9	1	26" Horizontal w/ Velcro attached to Top of member
10	1	26" Horizontal w/ Velcro attached to Bottom of member

Steps:

- 1) Attach lower vertical extrusions [5] to oval base plate [1].
- 2) Attach upper vertical extrusions [3, 4 and 6] atop lower vertical extrusions [2 and 5]
- 3) Attach horizontal extrusions [7, 8, 9 and 10] between vertical extrusions [2/3, 2/4 and 5/6] as shown.
- 4) Apply graphics to assembled backwall, see Attaching Graphic details.

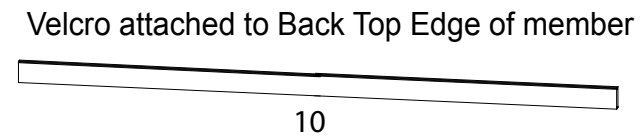
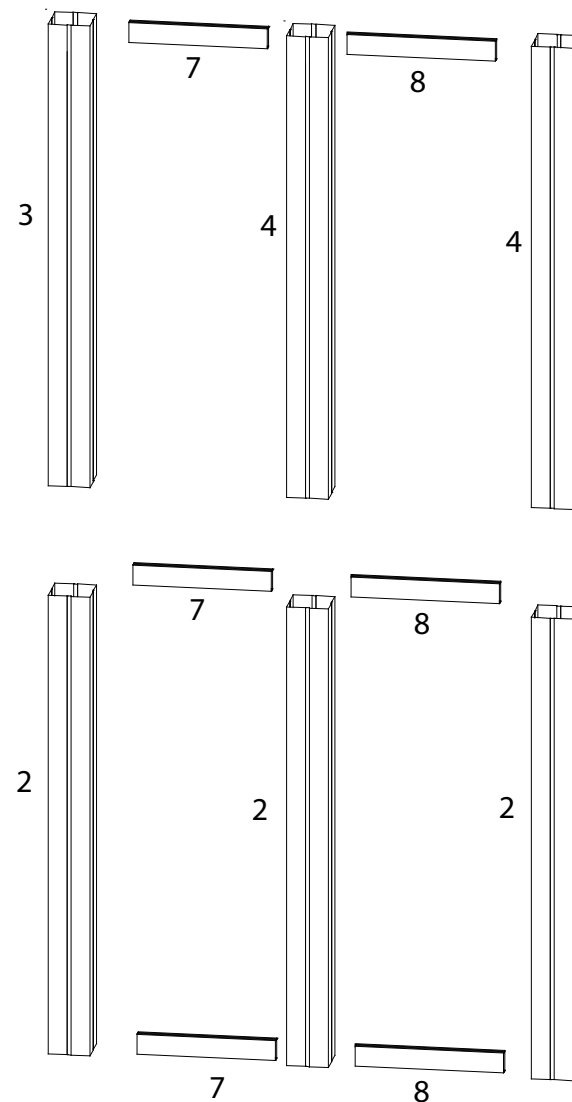
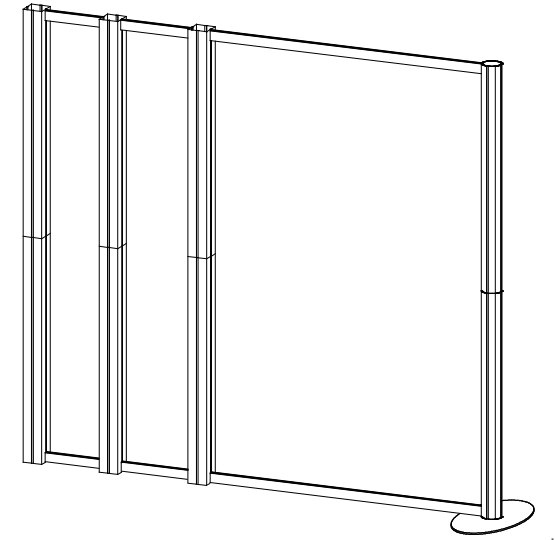

Note: Attaching Graphics
 Attach Backwall Graphics to Velcro on the Top Back Edge of the Upper Horizontals and to the Bottom Back Edge of the Lower Horizontals

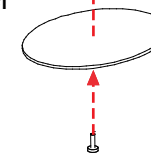
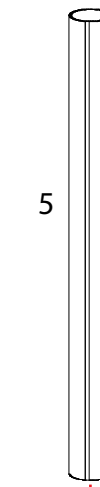
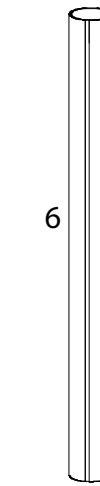
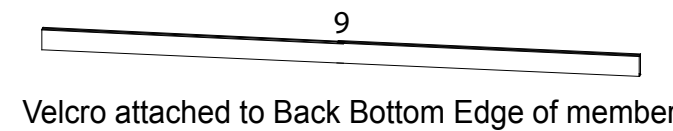

WHEN DISASSEMBLING ALUMINUM EXTRUSION, TIGHTEN ALL SETSCREWS AND LOCKS TO PREVENT LOSS DURING SHIPPING

866.652.2100

Item	Qty	Description
11	2	38" h Round Vertical Extrusion
12	1	38" h 135° Corner Extrusion
13	1	38" h 135° Corner Extrusion w/ Door Hinges
14	4	12.5" w Horizontal Extrusion
15	2	Curved Horizontal Extrusion
16	1	34.418" h Vertical Extrusion w/ Door Stopper
	4	Square Shelf Supports

Steps

- 1) Attach corner extrusions [12 and 13] to vertical extrusions [11] as shown below, see Pressure Screw Attachment detail.
- 2) Attach lower horizontal extrusions [14 and 15] between vertical extrusions [2&11 and 12&13] as shown.
- 3) Attach vertical extrusion [16] to horizontal extrusion [15], leave loose, placing door and insert as shown, then tighten vertical extrusion [16] in place.
- 4) Place remaining inserts where indicated.
- 5) Attach upper horizontal extrusions [14 and 15] between vertical extrusions [2&11 and 12&13] as shown.
- 6) Velcro shelf support to inside of pedestal, then set internal shelf atop support.
- 7) Place counter atop assembled pedestal.

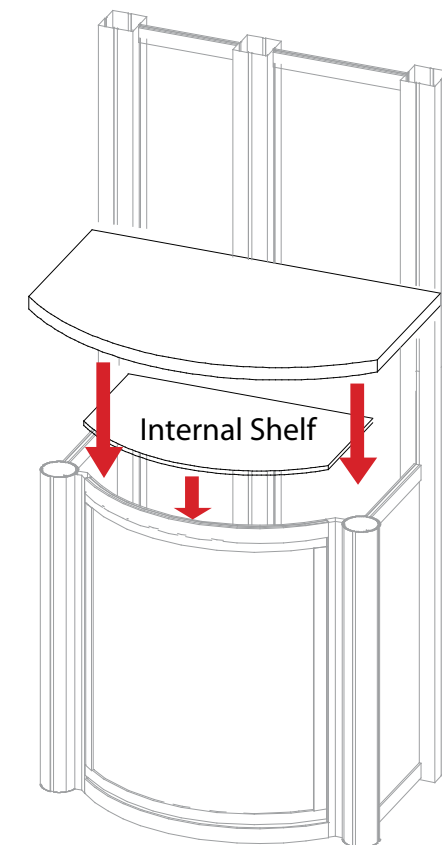
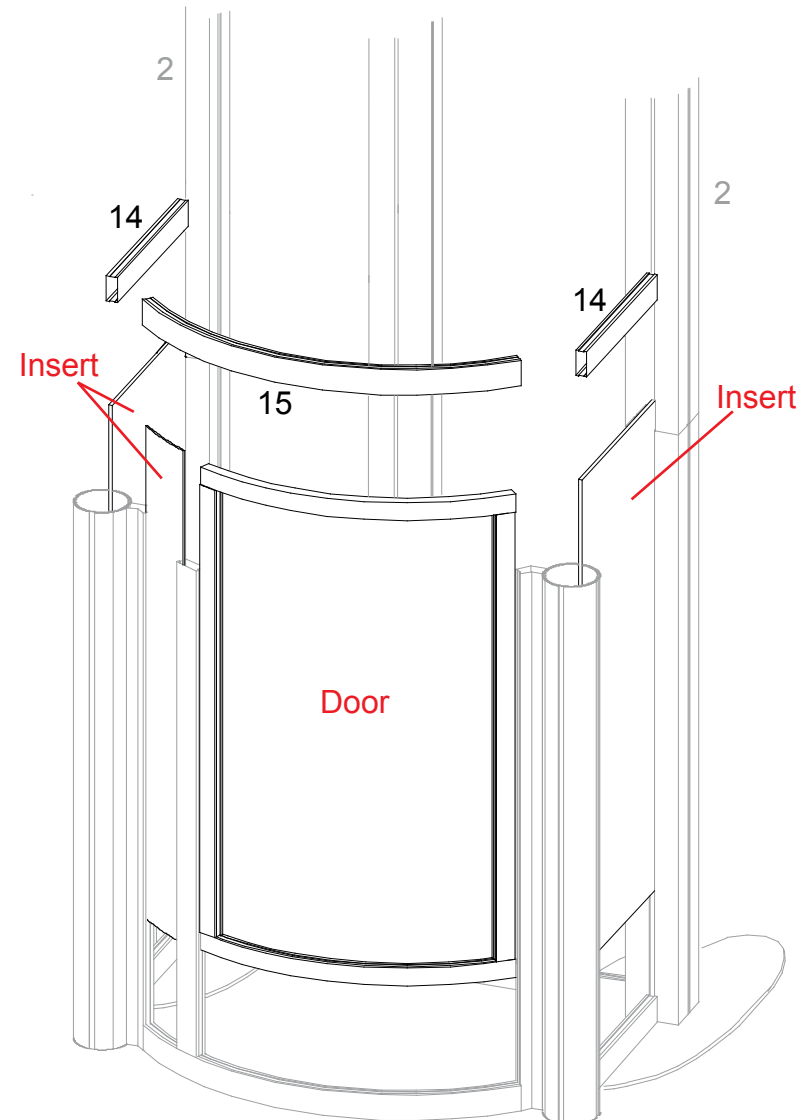
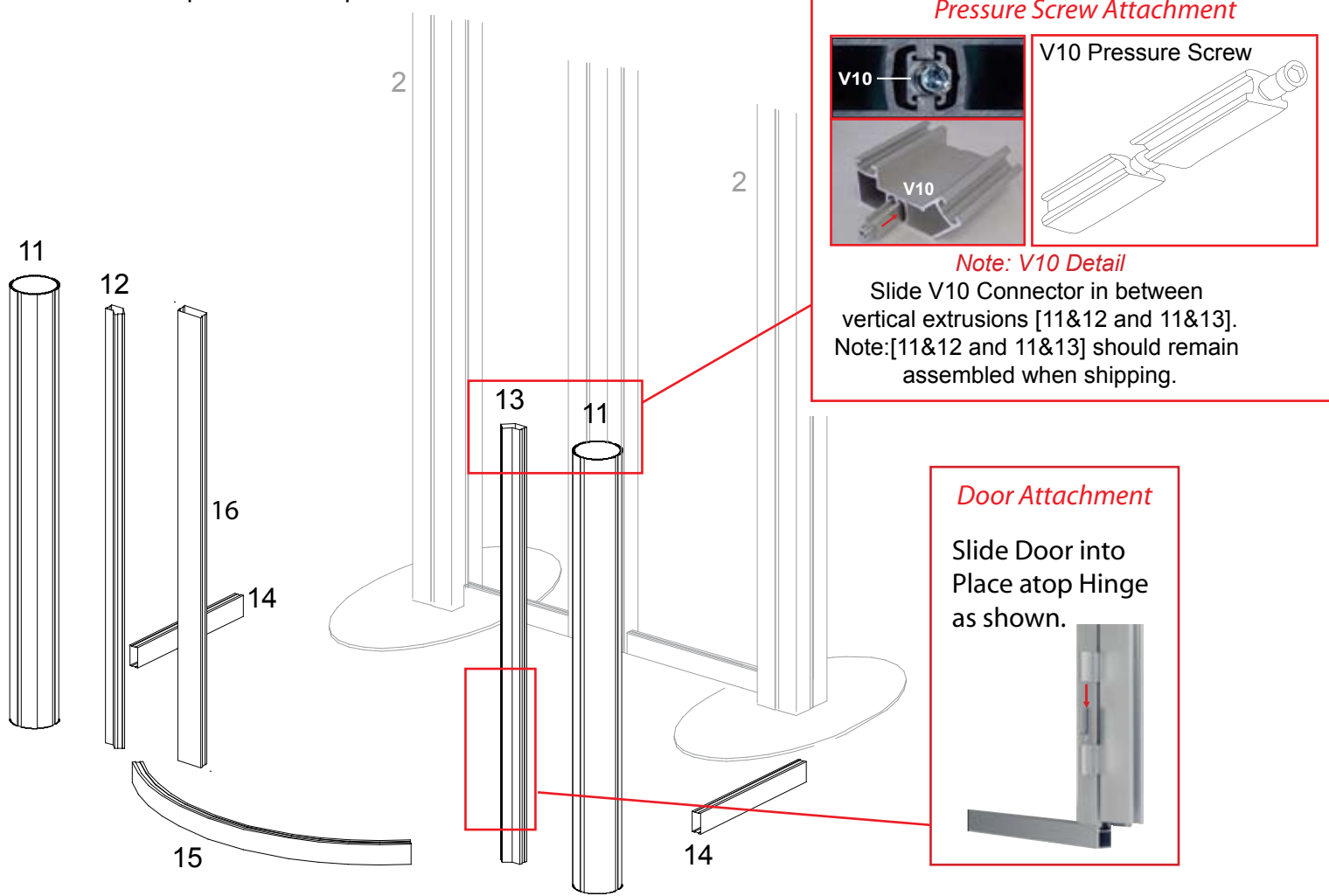
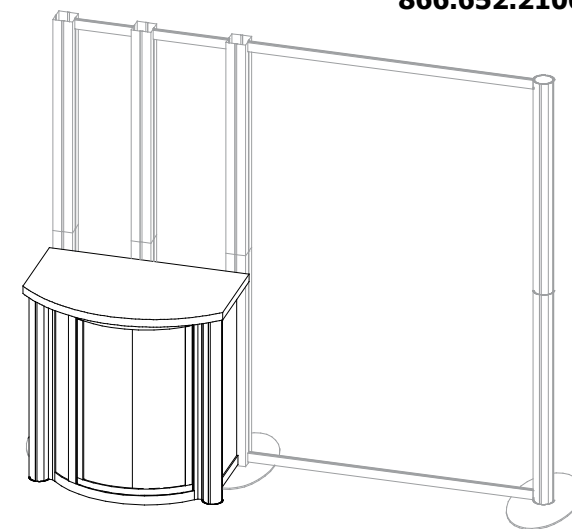

WHEN DISASSEMBLING ALUMINUM EXTRUSION, TIGHTEN ALL SETSCREWS AND LOCKS TO PREVENT LOSS DURING SHIPPING

866.652.2100

Item	Description
17	Custom Shelf Support

Steps

- 1) Slide shelf supports into groove of square vertical from top, slide to desired location and tighten into place using supplied single allen wrench.
- 2) Place shelves atop supports as shown.

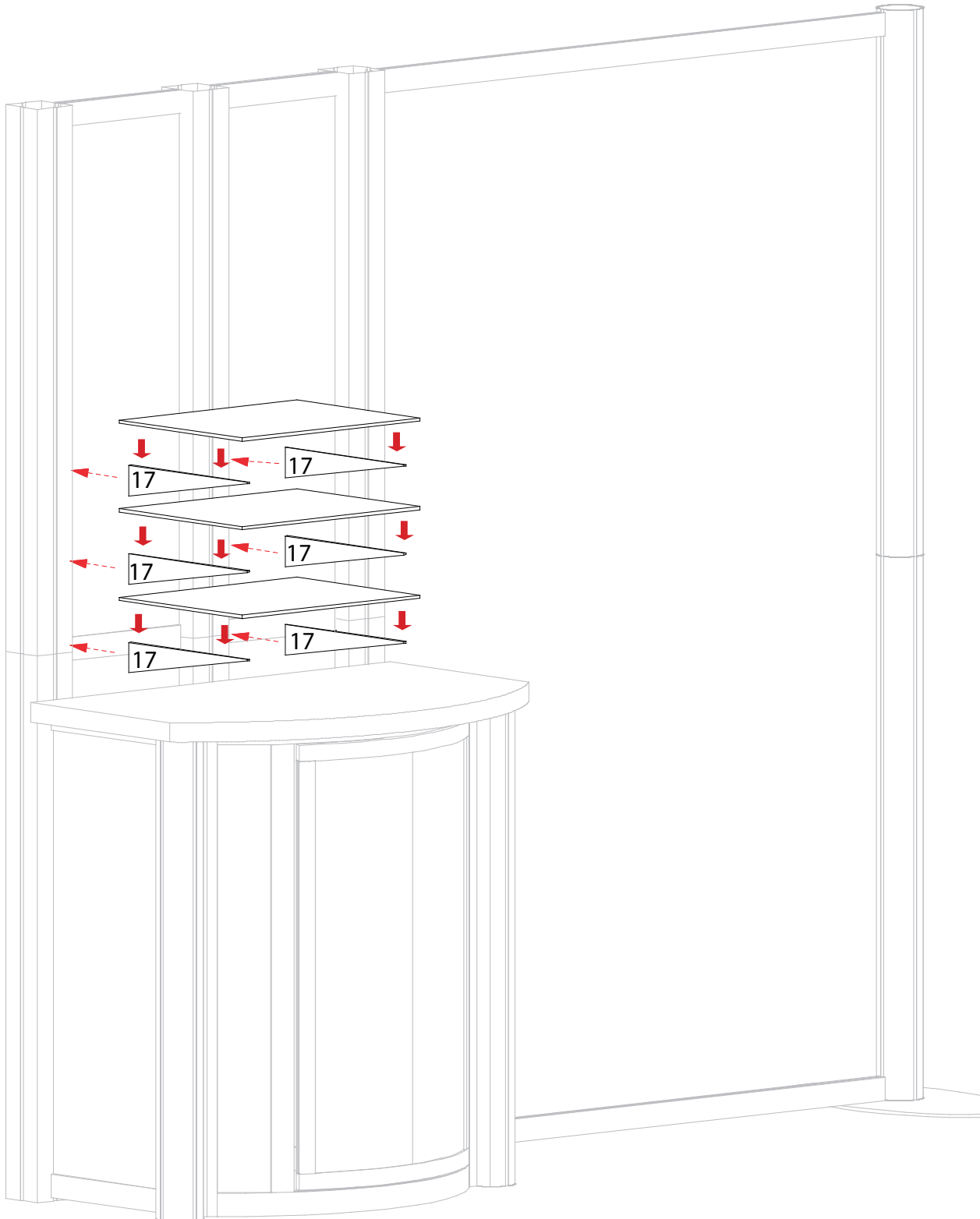

WHEN DISASSEMBLING ALUMINUM EXTRUSION, TIGHTEN ALL SETSCREWS AND LOCKS TO PREVENT LOSS DURING SHIPPING

866.652.2100

Item	Qty.	Description
18	1	37.74" w Horizontal Extrusion w/ Velcro attached to Back of member
19	1	37.74" w Horizontal Extrusion w/ Velcro attached to Back of member
20	1	5.862" w Vertical Extrusion w/ Velcro attached to Back of member
21	1	5.862" w Vertical Extrusion w/ Velcro attached to Back of member
22	1	38.5" w Curved Horizontal Extrusion w/ Velcro attached to Back of member
23	1	38.5" w Curved Horizontal Extrusion w/ Velcro attached to Back of member

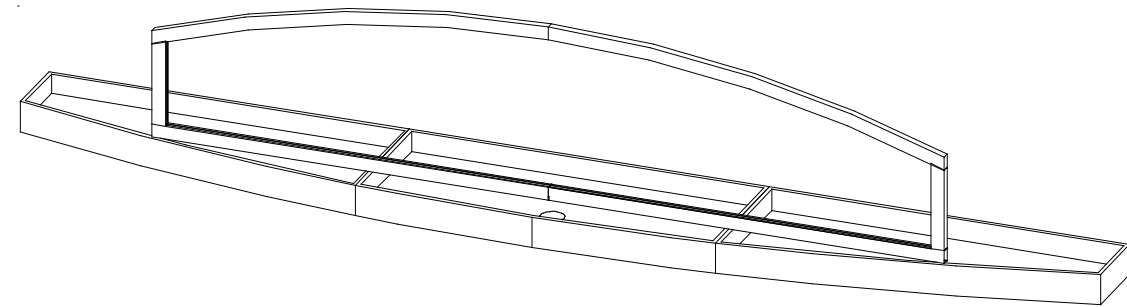

Steps

- 1) Connect canopy pieces together using bolts and wing nuts provided, see Example of Canopy Connection detail.
- 2) Connect horizontal extrusions [18 to 19 and 22 to 23] together.
- 3) Attach assembled horizontal extrusion [18/19] to assembled canopy using bolts as shown.
- 4) Connect vertical extrusions [20 and 21] to left and right side of assembled horizontal extrusion [18/19].
- 5) Attach assembled curved horizontal extrusion [22/23] atop vertical extrusions [20 and 21].

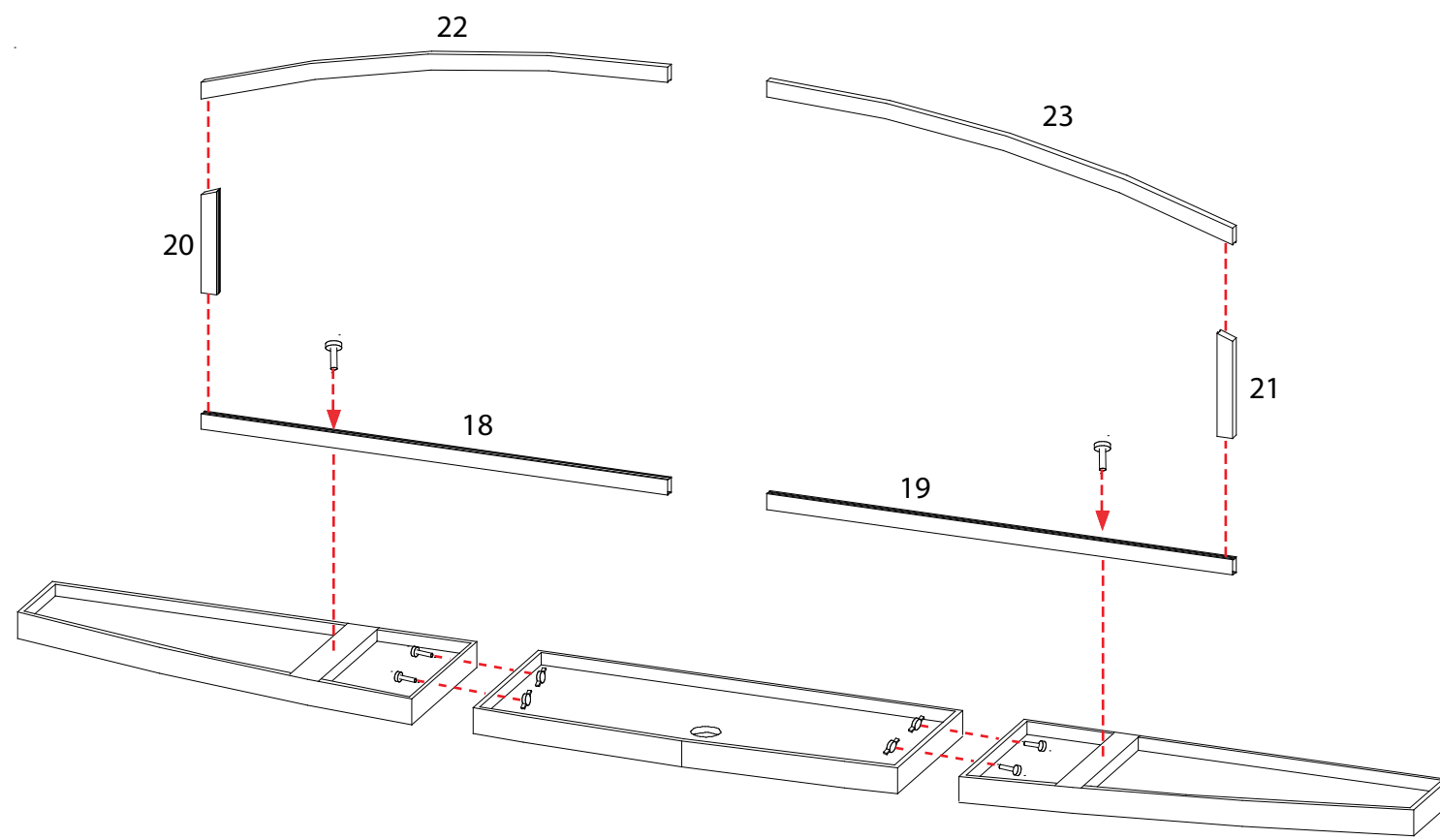
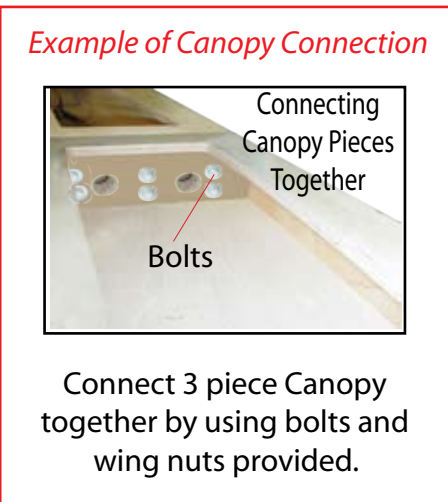

WHEN DISASSEMBLING ALUMINUM EXTRUSION, TIGHTEN ALL SETSCREWS AND LOCKS TO PREVENT LOSS DURING SHIPPING

866.652.2100

Steps

- 1) Attach canopy to assembled backwall as shown.
- 2) Attach wings using A10 clamps as shown.
- 3) Attach literature racks as shown

Note: Attaching Graphics
Attach Header Graphic to Back of assembled header frame.

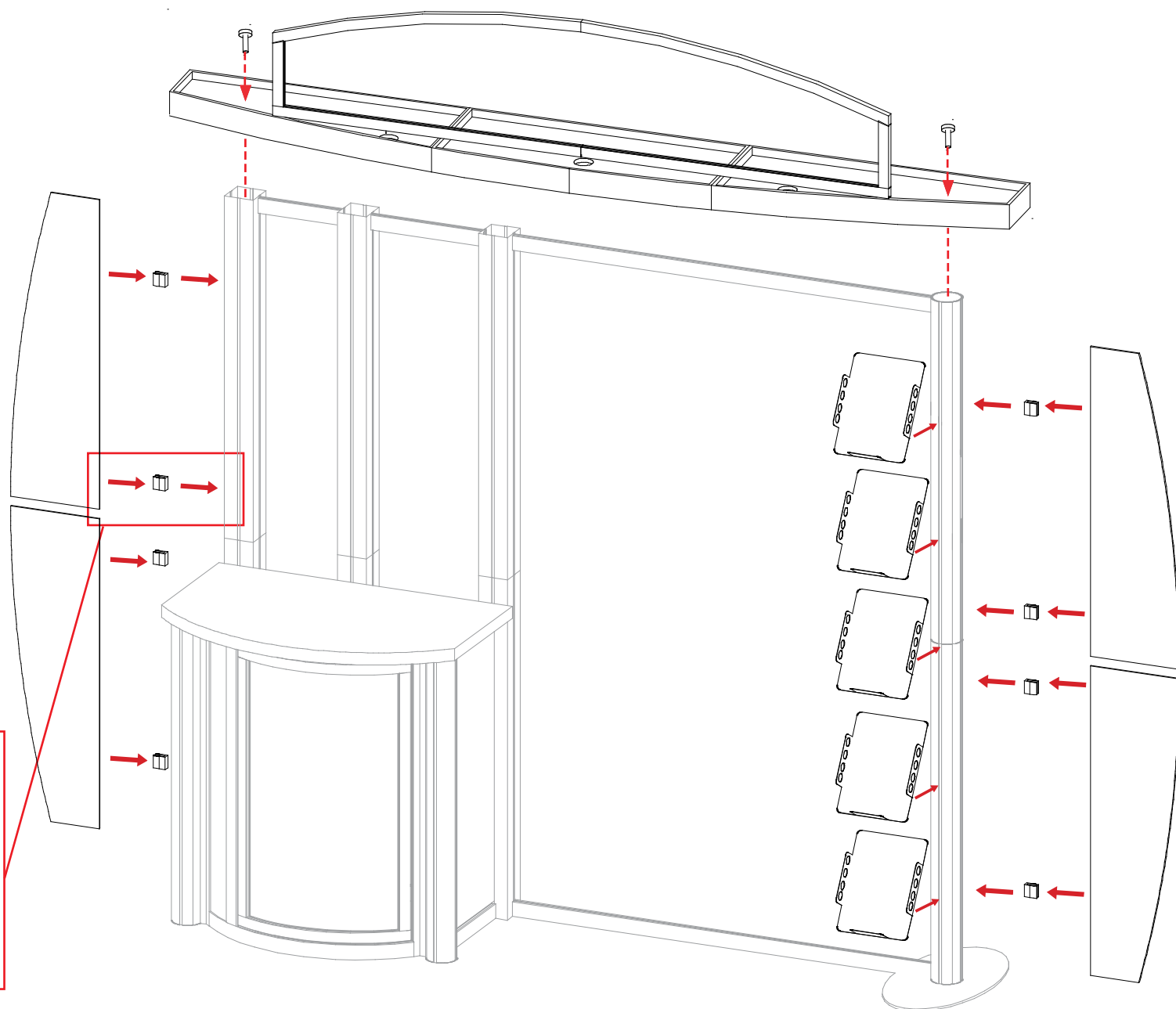
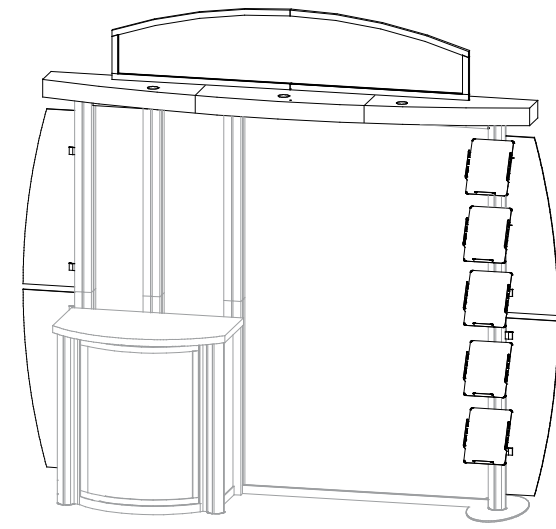

Wing Attachment

Slide A10 Clamp into groove of square extrusion.

A10

When desired location is found, tighten set screw to secure.

Set-Screw

Tighten black plastic set screw to secure Wing in place.

Black Plastic Set-screw

Literature Rack Attachment

Tighten Lock to Secure

Attach connector piece to rack as shown. Then connect assembled literature rack to vertical extrusion.

WHEN DISASSEMBLING ALUMINUM EXTRUSION, TIGHTEN ALL SETSCREWS AND LOCKS TO PREVENT LOSS DURING SHIPPING

866.652.2100

Item Number	Qty	Description
25	2	34.25"w Horizontal Extrusion
26	1	42"h Vertical Extrusion
27	2	5.866"w Horizontal Extrusion
28	1	42"h Vertical Extrusion
29	2	Curved Horizontal Extrusion
30	1	42"h Vertical Extrusion
31	2	21.0358"w Horizontal Extrusion
32	1	42"h Vertical Extrusion
33	2	Curved Horizontal Extrusion
34	1	42"h Vertical Extrusion
35	2	5.856"w Horizontal Extrusion
36	1	42"h Vertical Extrusion
37	1	38.4173"h Vertical Extrusion

Setup:

- 1) Connect horizontal extrusions [25, 27, 29, 31, 33 and 35] between vertical extrusions [26, 28, 30, 32, 34, and 36].
- 2) Connect vertical extrusion [37] to horizontal extrusion 8 as shown.
- 3) Place inserts and doors where indicated.
- 4) Connect upper horizontal extrusions [25, 27, 29, 31, 33 and 35] between vertical extrusions [26, 28, 30, 32, 34, and 36].
- 5) Attach Velcroed counter supports to inside of pedestal.
- 6) Set shelf into assembled pedestal and place counter atop.
- 7) Attach plex shelves to counter top using stand-off barrels and caps.

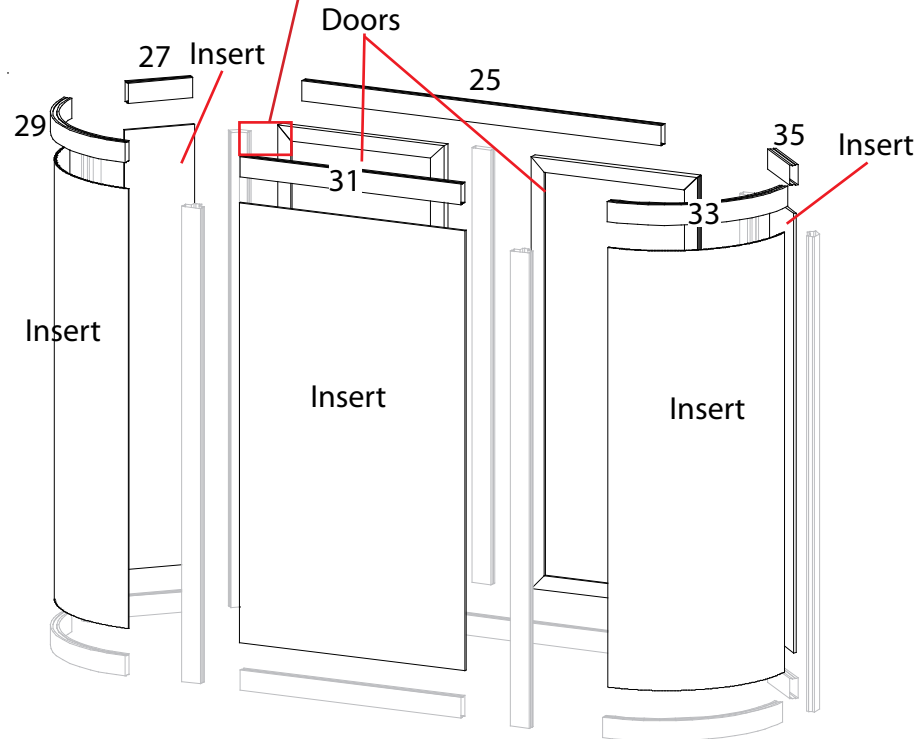
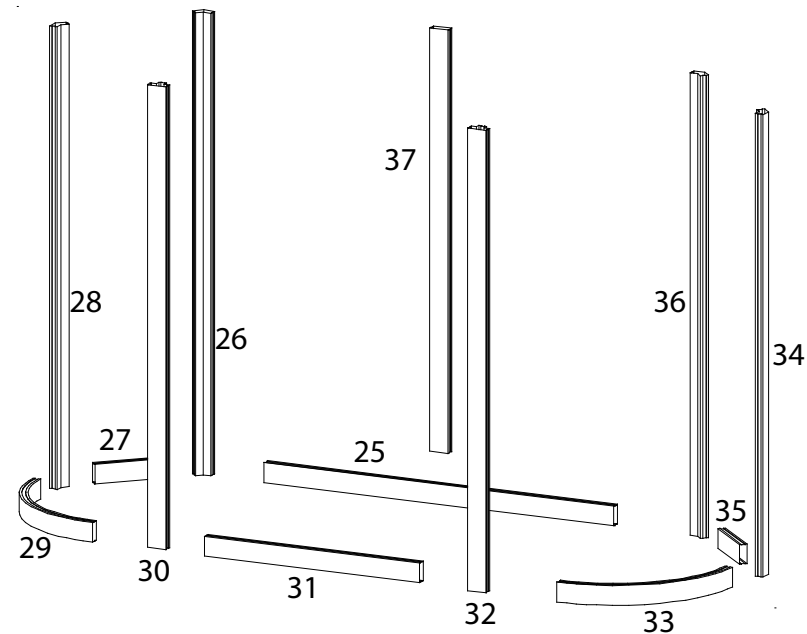

Place Shelf atop Supports inside assembled Pedestal.
Set Counter atop assembled Pedestal.

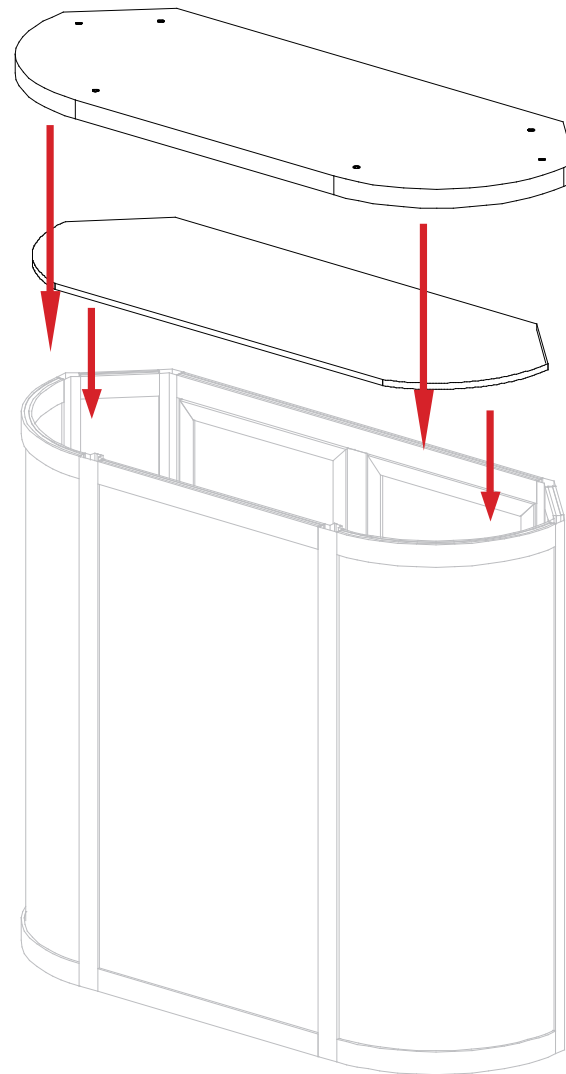

Attach Plex shelves to Counter Top using Stand-off Barrels and Caps.

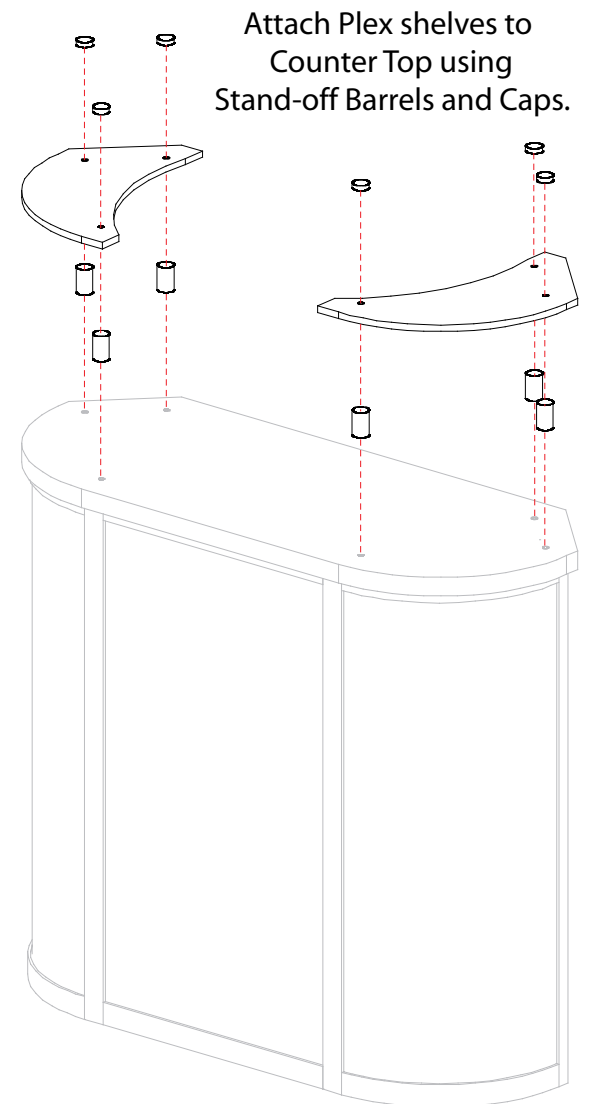

WHEN DISASSEMBLING ALUMINUM EXTRUSION, TIGHTEN ALL SETSCREWS AND LOCKS TO PREVENT LOSS DURING SHIPPING

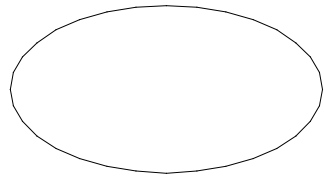

Oval Base Plate

Qty. : 1

Located in Case : _____

42"H Round Extrusion

Qty. : 1

Located in Case : _____

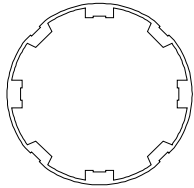

41.75"H Round Extrusion

Qty. : 1

Located in Case : _____

38"H Round Extrusion

Qty. : 2

Located in Case : _____

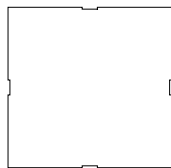

42"H Square Extrusion

Qty. : 6

Located in Case : _____

Shelf Support

Qty. : 4

Located in Case : _____



37.74"W Extrusion

Qty. : 2

Located in Case : _____

34.418"H Extrusion

Qty. : 1

Located in Case : _____

12.09"W Extrusion

Qty. : 6

Located in Case : _____

28.32"W Curved Extrusion

Qty. : 2

Located in Case : _____

18.041"W Curved Extrusion

Qty. : 2

Located in Case : _____

34.25"W Extrusion

Qty. : 2

Located in Case : _____

42"W Extrusion

Qty. : 2

Located in Case : _____

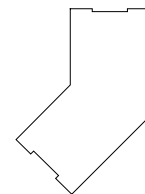

38"H 135° Corner Extrusion

Qty. : 2

Located in Case : _____

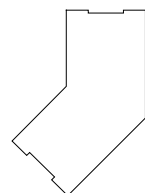

42"H 135° Corner Extrusion

Qty. : 2

Located in Case : _____

38.4173"H Extrusion

Qty. : 2

Located in Case : _____

21.0358"H Extrusion

Qty. : 2

Located in Case : _____

52"W Extrusion

Qty. : 2

Located in Case : _____

12.5"W Extrusion

Qty. : 2

Located in Case : _____

5.862"H Extrusion

Qty. : 2

Located in Case : _____

5.866"H Extrusion

Qty. : 2

Located in Case : _____

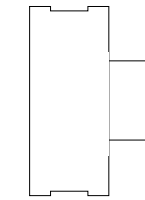

42"W Extrusion

Qty. : 2

Located in Case : _____

Additional Accessories:

Located in Case : _____

Located in Case : _____

Located in Case : _____

WHEN DISASSEMBLING ALUMINUM EXTRUSION, TIGHTEN ALL SETSCREWS AND LOCKS TO PREVENT LOSS DURING SHIPPING

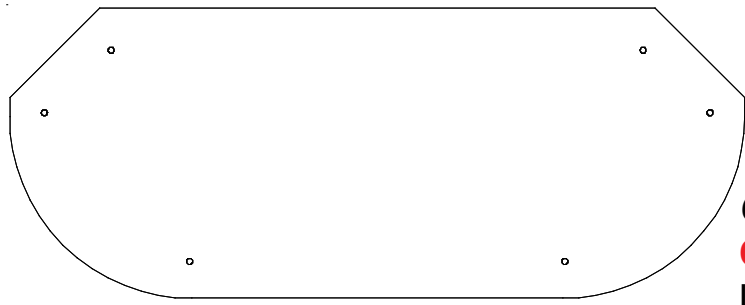

Counter Top
Qty. : 1
Located in Case : _____

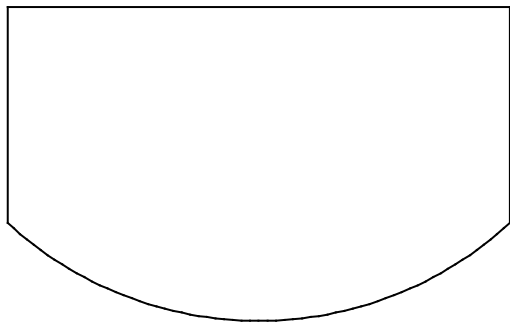

Counter Top
Qty. : 1
Located in Case : _____

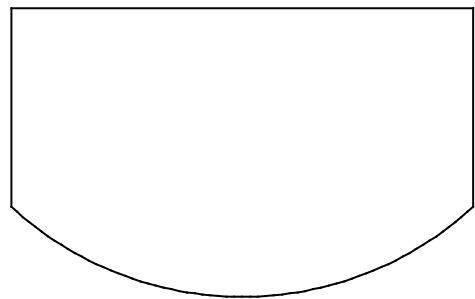

Internal Shelf
Qty. : 1
Located in Case : _____

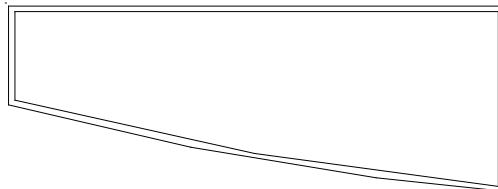

Canopy Header 1
Qty. : 1
Located in Case : _____

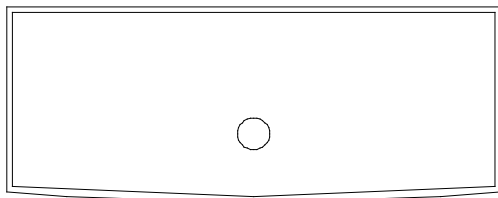

Canopy Header 2
Qty. : 1
Located in Case : _____

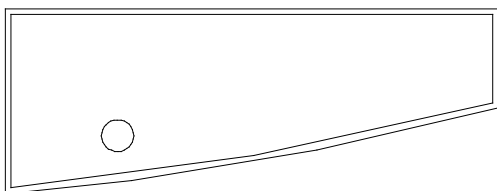

Canopy Header 3
Qty. : 1
Located in Case : _____

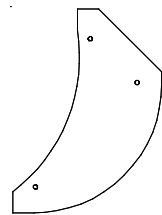

Sintra Wing
Qty. : 2
Located in Case : _____

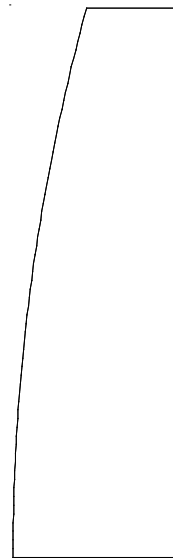

Sintra Wing
Qty. : 4
Located in Case : _____

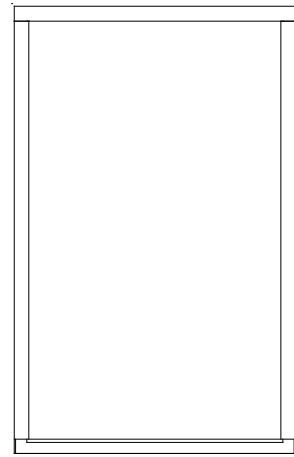

Curved Locking Door
Qty. : 1
Located in Case : _____

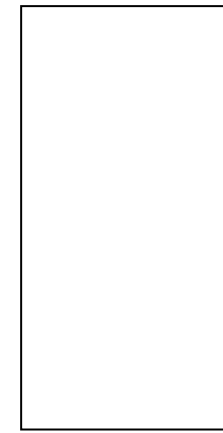

19.438"W x 34.855"H
Laminated Insert
Qty. : 2
Located in Case : _____

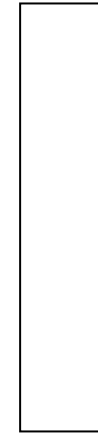

4.437"W x 34.855"H
Laminated Insert
Qty. : 1
Located in Case : _____

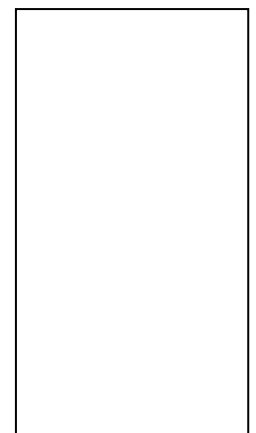

17.739"W x 38.855"H
Laminated Insert
Qty. : 2
Located in Case : _____

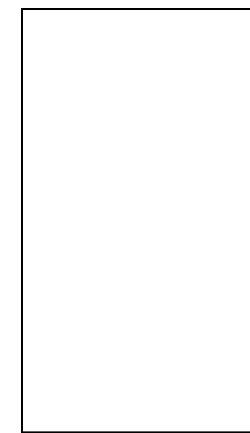

21.473"W x 38.855"H
Laminated Insert
Qty. : 1
Located in Case : _____

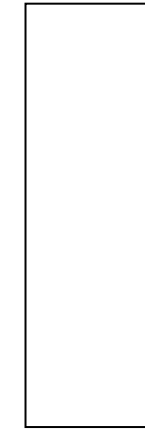

6.03"W x 38.855"H
Laminated Insert
Qty. : 2
Located in Case : _____

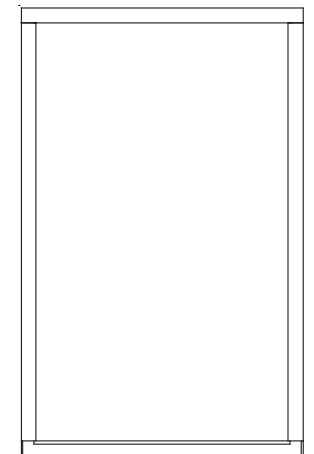

Flat Locking Door
Qty. : 2
Located in Case : _____

WHEN DISASSEMBLING ALUMINUM EXTRUSION, TIGHTEN ALL SETSCREWS AND LOCKS TO PREVENT LOSS DURING SHIPPING