

WHEN DISASSEMBLING ALUMINUM EXTRUSION, TIGHTEN ALL SETSCREWS AND LOCKS TO PREVENT LOSS DURING SHIPPING

visionary™ IDESIGNS

Using Your Setup Instructions

The Visionary Designs Setup Instructions are created specifically for your configuration. They are laid out sequentially, including an exploded view of the entire display, and then a logical series of detailed steps to assemble the main structure and components. We encourage you to study the instructions **before** attempting to assemble your exhibit.

Each page reminds you to tighten the setscrews after disassembling your exhibit to prevent loss of the locks and setscrews (see below in RED). This is **VERY IMPORTANT**.

Cleaning and Packing Your Display

- 1) Use care when cleaning aluminum extrusion or acrylic inserts. Use only non-abrasive cleaners.
- 2) When cleaning laminate inserts or countertops, use mild cleansers and a soft material such as cotton.
- 3) Keep all display components away from extreme heat and long exposure to sunlight to avoid warping and fading.
- 4) Retain all packing material. It will make re-packing much easier and will reduce the likelihood of shipping damage.



The Tool

Most Visionary Designs exhibits can be assembled with the supplied Hex Key Tool. Occasionally, a flat head screwdriver may be required.



Detail A

Typical Connection



Typical Connection (cont'd)

Most horizontal extrusion connections have a patented expandable lock. This lock inserts into the groove of an opposing extrusion. Tightening the lock with the Hex Key Tool expands the lock and creates a strong positive connection.



Detail B

Numbered Label

Each extrusion contains a numbered label which corresponds with setup instructions. The label is located within a groove of the extrusion (when possible). With Visionary Designs the labels contain Black numbers unless otherwise specified.



Detail C

Horizontal Inline Connection (remove only one setscrew)

Remove only (1) setscrew when disassembling. Replace setscrew in extrusion after assembling it. Before packing, replace setscrew in extrusion to avoid losing it.



Detail D

Base Plate Connection

Attach base plate to round or square vertical extrusion using the bolt provided. Be careful not to strip the threads.

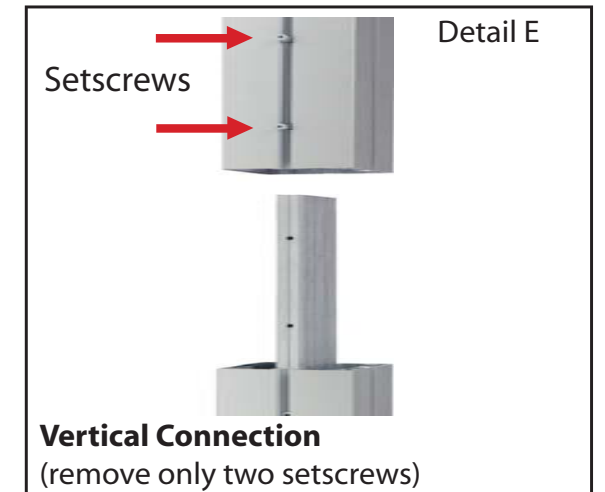

Detail E

Vertical Connection
(remove only two setscrews)

When vertical extrusions are packed in portable cases rather than crates or tubs, they must be broken down into smaller sections which then require assembly.

Remove only (2) setscrews when disassembling. Replace setscrews in extrusion after assembling it. Before packing, replace setscrews in extrusion to avoid losing them.

WHEN DISASSEMBLING ALUMINUM EXTRUSION, TIGHTEN ALL SETSCREWS AND LOCKS TO PREVENT LOSS DURING SHIPPING

866.652.2100

Item	Quantity	Description
1	2	Oval Base Plates
2	1	41.75" Square Vertical Extrusion
3	1	42" Square Vertical Extrusion
4	1	41.75" Square Vertical Extrusion w/ Canopy Connection
5	1	42" Square Vertical Extrusion w/ Canopy Connection
6	1	54.14" Horizontal Extrusion
7	1	54.14" Horizontal Extrusion
7A	1	Vertical Extrusion
7B	1	Vertical Extrusion
8	1	22.34" Tapered Horizontal Extrusion
9	1	22.34" Tapered Horizontal Extrusion
10	1	8.758" Horizontal Extrusion
11	1	8.758" Horizontal Extrusion
12	1	71.3293" Curved Extrusion w/ Attached Velcro to Back of Extrusion
13	1	71.3293" Curved Extrusion w/ Attached Velcro to Back of Extrusion
14	1	71.3293" Curved Extrusion w/ Attached Velcro to Back of Extrusion
15	1	71.3293" Curved Extrusion w/ Attached Velcro to Back of Extrusion
16	1	22.396" Tapered Horizontal Extrusion
17	1	22.396" Tapered Horizontal Extrusion

Steps:

- 1) Connect vertical extrusions [2 to 3 and 4 to 5].
- 2) Attach assembled verticals to oval base plates [1] as shown, refer to detail D on General Info page.
- 3) Connect horizontal extrusion [6 to 7] and attach between vertical assemblies [2/3 and 4/5].
- 4) Attach vertical extrusions [7A and 7B] atop horizontal assembly [6/7] leaving loose.
- 5) Place inserts A, B, and C as shown, tightening [7A and 7B] securely.
- 6) Attach tapered horizontal extrusions [8 and 9] to vertical extrusions [2 and 4] and atop inserts.
- 7) Attach horizontal extrusions [10 and 11] to vertical assemblies [2/3 and 4/5], placing inserts D and E between horizontal extrusions as shown.
- 8) Assemble curved extrusions [12, 13, 14 and 15] together.
- 9) Attach each side of assembled curved extrusions to horizontal extrusions [7A, 7B, 8, 9, 10 and 11].
- 10) Place inserts F and G as shown.
- 11) Attach tapered horizontal extrusion [16] between vertical extrusion [3] and curved extrusion [14].
- 12) Attach tapered horizontal extrusion [17] between vertical extrusion [5] and curved extrusion [15].
- 13) Attach graphic to Velcro on backside.

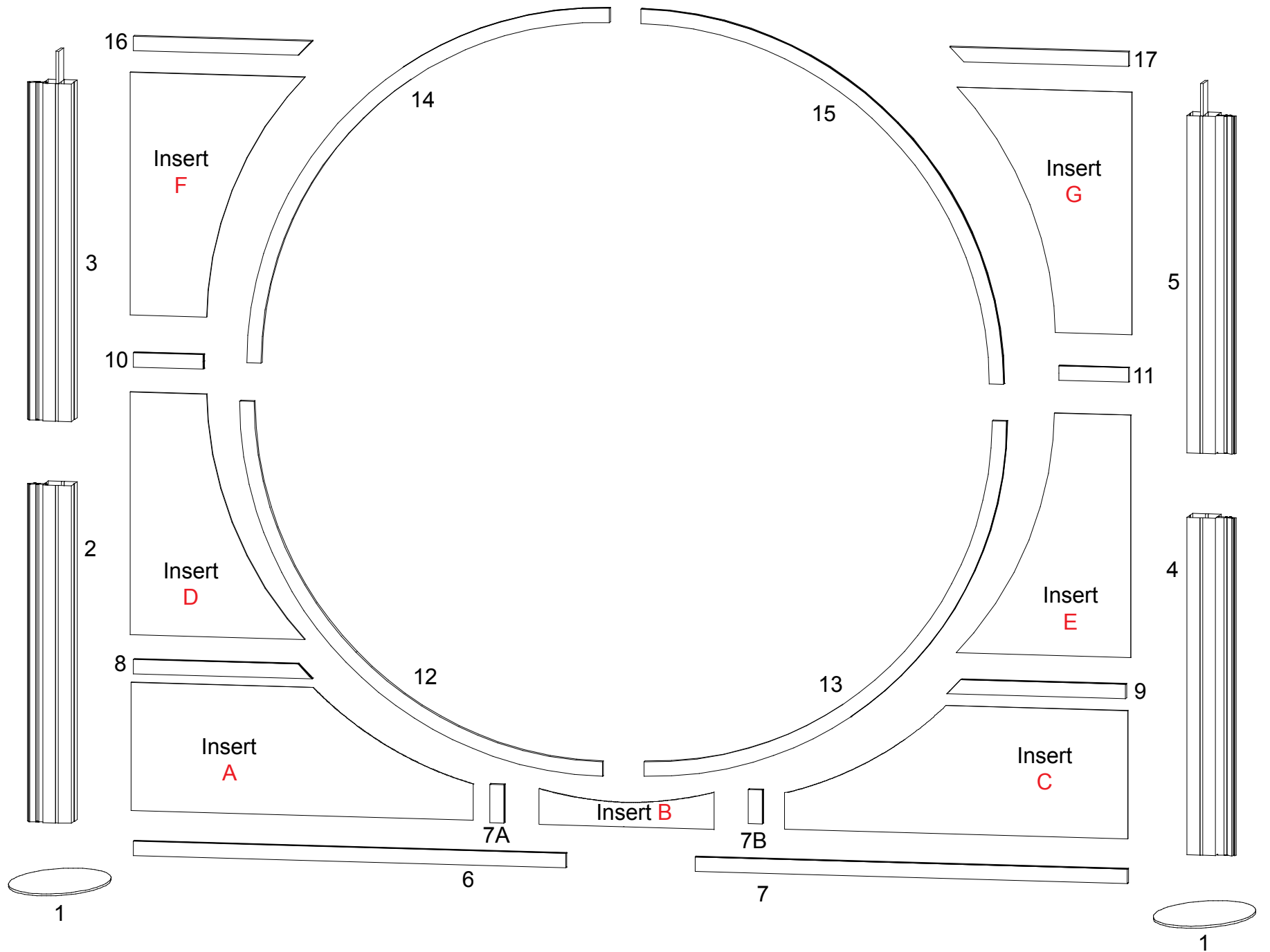

WHEN DISASSEMBLING ALUMINUM EXTRUSION, TIGHTEN ALL SETSCREWS AND LOCKS TO PREVENT LOSS DURING SHIPPING

866.652.2100

Item	Quantity	Description
18	1	48" Square Vertical Extrusion
19	1	36" Square Vertical Extrusion
20	1	48" Square Vertical Extrusion
21	1	36" Square Vertical Extrusion
22	2	30" Horizontal T- Extrusion
23	2	30" Horizontal T- Extrusion
24	2	30" Horizontal T- Extrusion
25	2	30" Horizontal T- Extrusion
26	6	1.75" Horizontal Extrusion

Steps:

- 1) Connect vertical extrusions [18 to 19 and 20 to 21].
- 2) Connect horizontal extrusions [22 to 23 and 24 to 25].
- 3) Attach assembled horizontals between vertical assemblies [18/19, 20/21 and 2/3, 4/5 from previous page].
- 4) Attach vertical extrusions [26] evenly spread out atop horizontal assemblies [24/25].

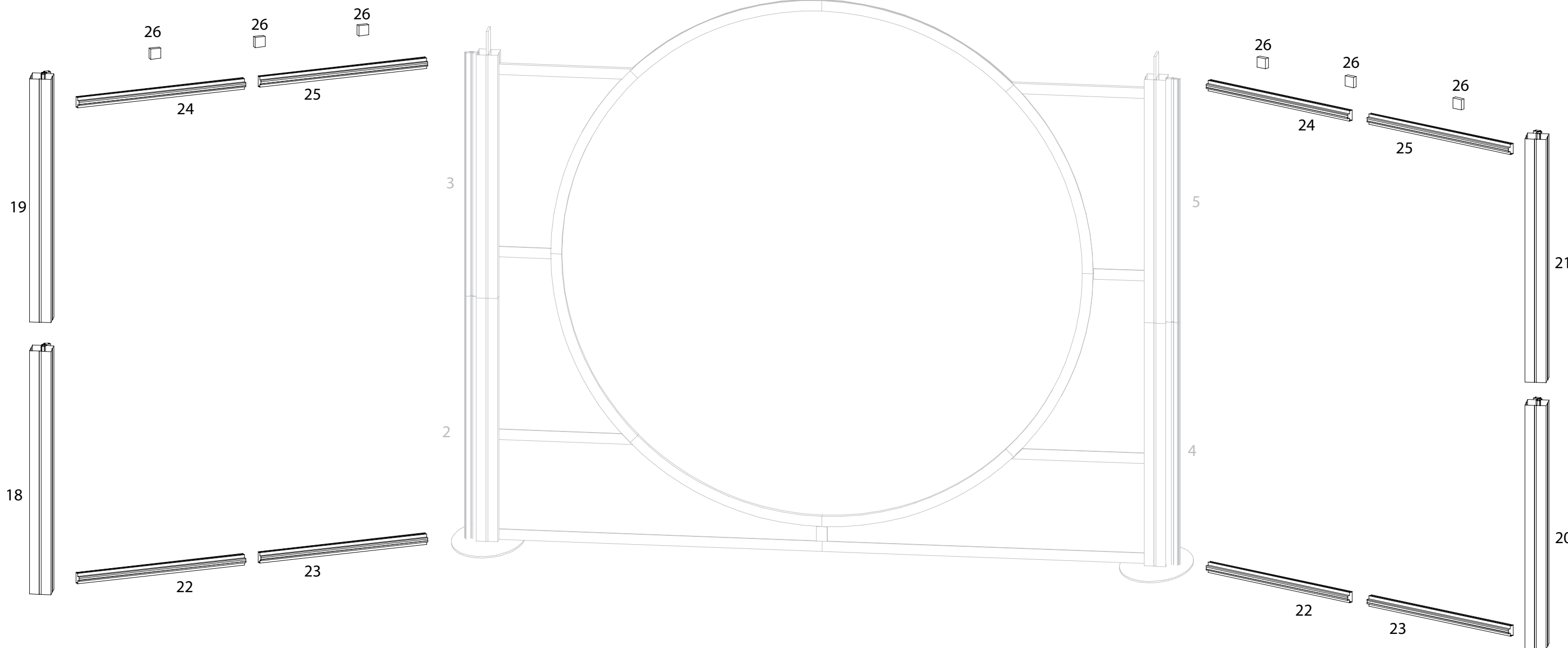

WHEN DISASSEMBLING ALUMINUM EXTRUSION, TIGHTEN ALL SETSCREWS AND LOCKS TO PREVENT LOSS DURING SHIPPING

866.652.2100

Item	Qty.	Description
27	2	30" Horizontal Extrusion
28	2	30" Horizontal Extrusion
29	4	Oval Base Plate
30	4	42" Vertical Extrusion
31	8	24" Horizontal Extrusion
32	4	24" Horizontal Extrusion w/pill slots for shelf supports

Steps:

- 1) Place lights as shown.
- 2) Connect horizontal extrusions [27 to 28].
- 3) Attach horizontal assemblies [27/28] between vertical extrusions [2/3, 18/19, 4/5, and 20/21] from previous pages, and atop vertical pieces [26].
- 4) Connect vertical extrusions [30] to oval base plates [29], refer to Detail D on the General Info page.
- 5) Connect horizontal extrusions [31 and 32] between vertical assemblies [18/19, 20/21, and 30].

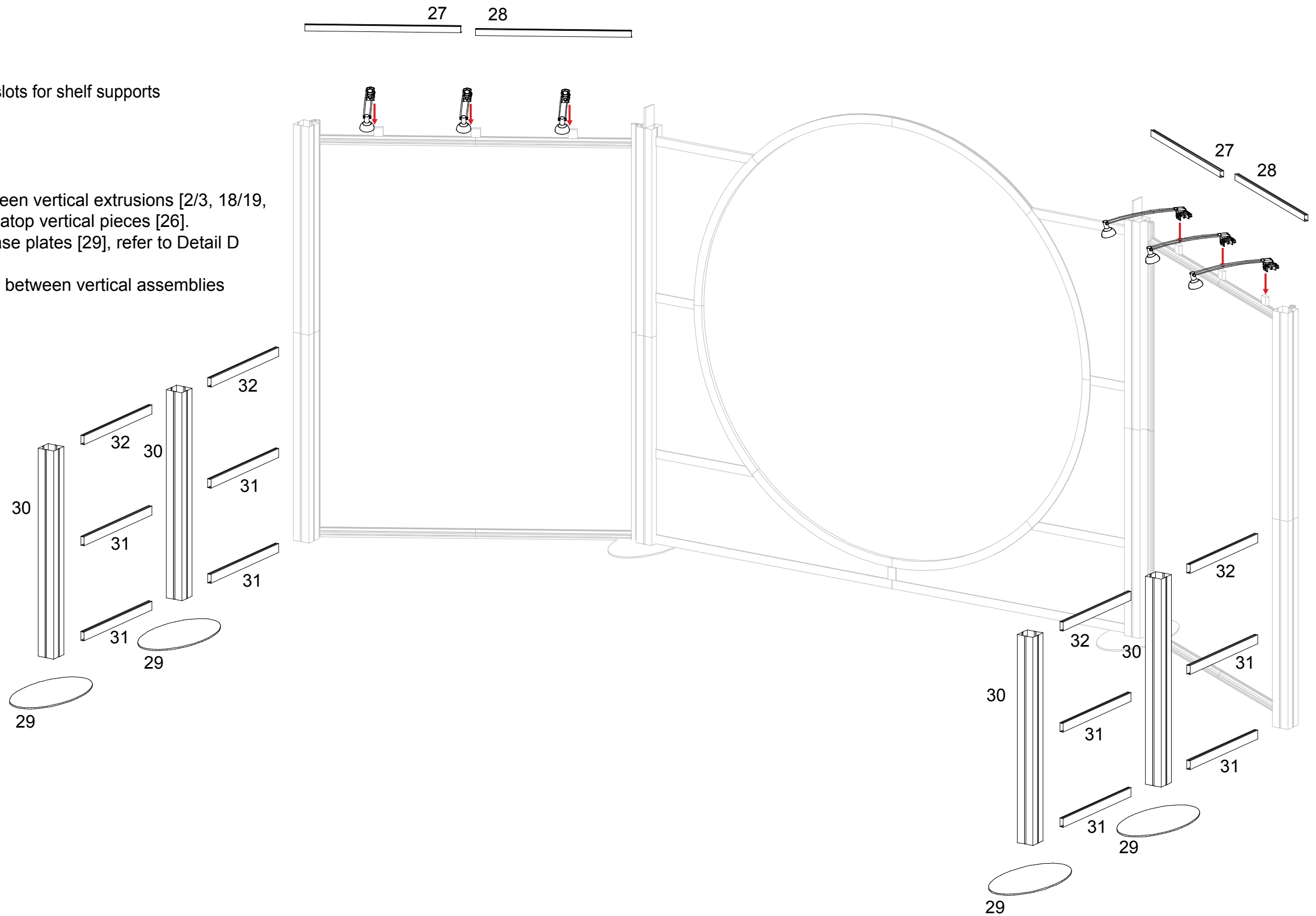

WHEN DISASSEMBLING ALUMINUM EXTRUSION, TIGHTEN ALL SETSCREWS AND LOCKS TO PREVENT LOSS DURING SHIPPING

866.652.2100

Item	Qty.	Description
33	1	40"h Vertical 135° Extrusion
34	1	40"h Vertical 135° Extrusion
35	1	40"h Vertical Assembly
36	2	34.2185" Curved Horizontal Extrusion
37	4	8" Horizontal Extrusion
38	2	40.6152" Curved Horizontal Extrusion
39	1	36.418" Vertical Extrusion
40	1	36.418" Vertical Extrusion

Steps:

- 1) Connect lower horizontal extrusions [36, 37, and 38] between vertical extrusions [33, 34, 35, and 36].
- 2) Connect vertical extrusions [39 and 40] atop curved horizontal [36] leaving loose.
- 3) Place inserts and door as shown, tighten vertical extrusions [39 and 40] to secure.
- 4) Connect upper horizontal extrusions [36, 37, and 38] between vertical extrusions [33, 34, 35, and 36].
- 5) Set assembled pedestal atop lower base and secure using L Brackets and thumbscrews provided.
- 6) Place Velcroed shelf supports into assembled pedestal and set internal shelf atop.
- 7) Place counter atop assembled pedestal base.

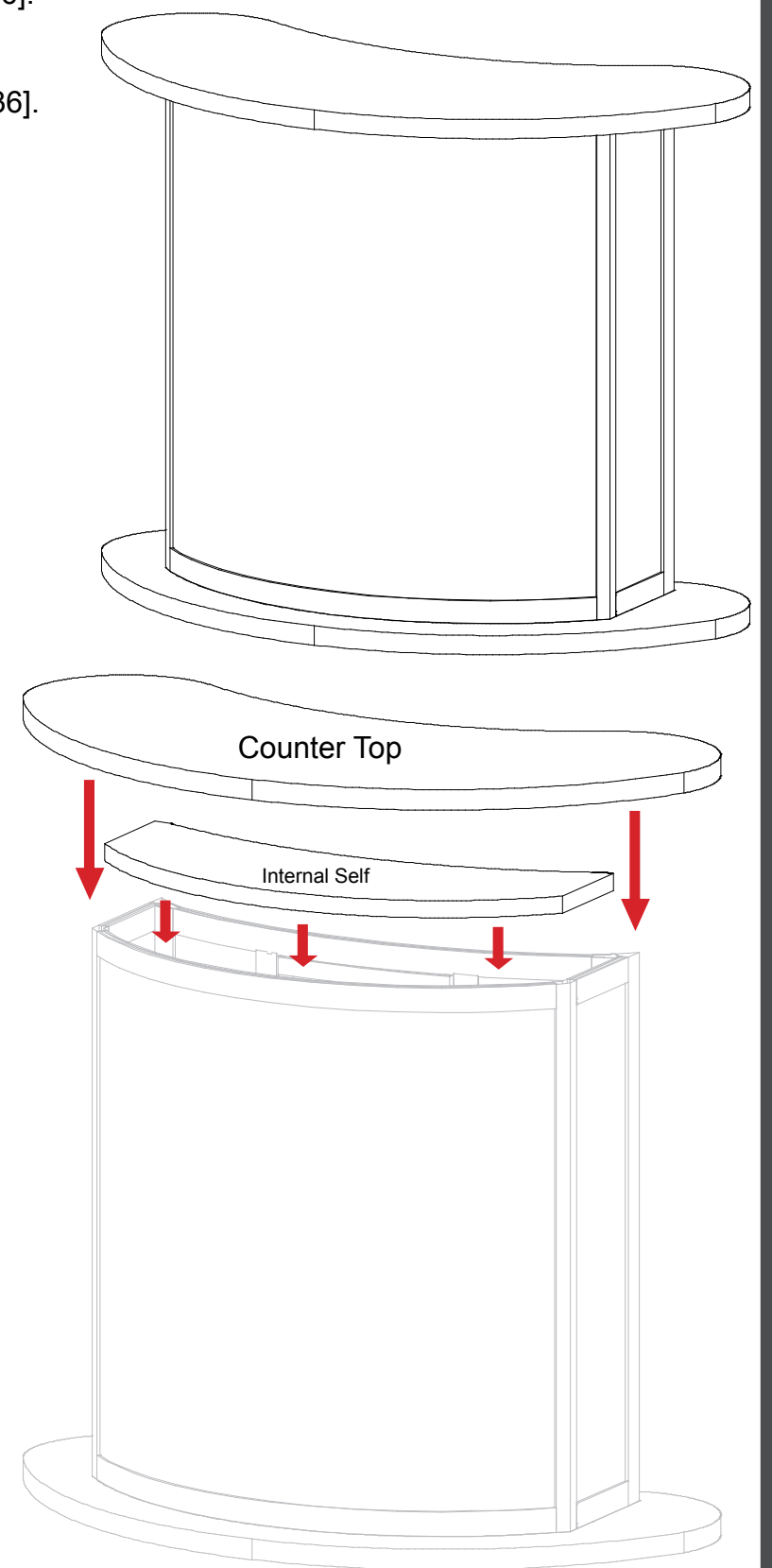
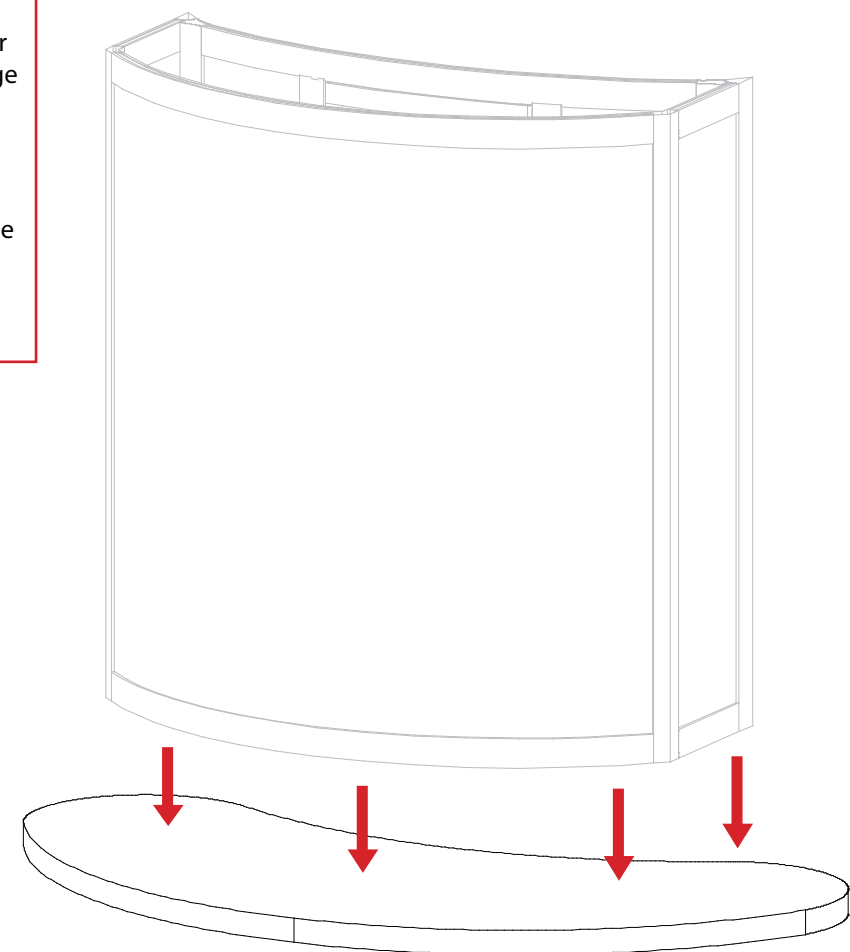
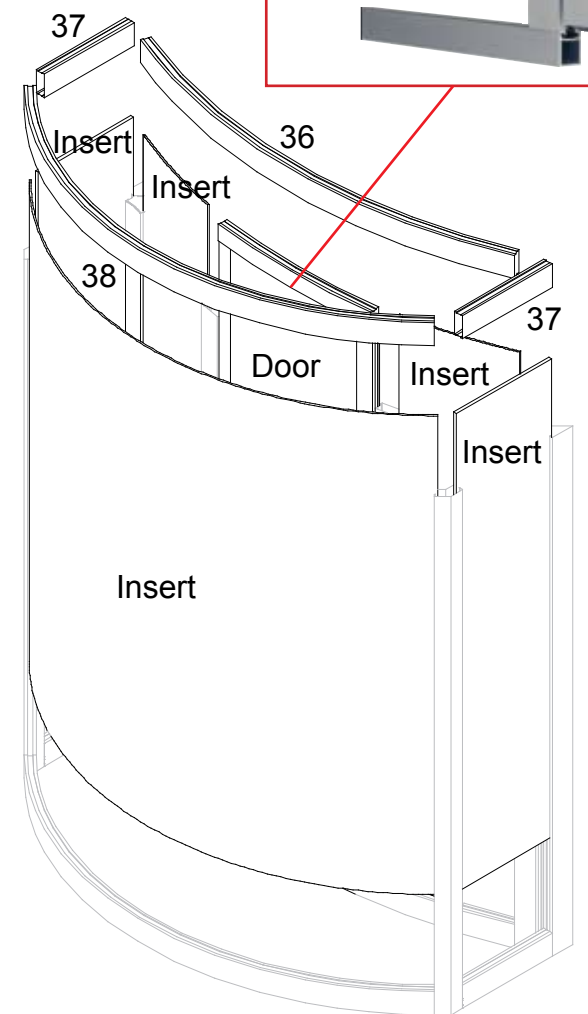
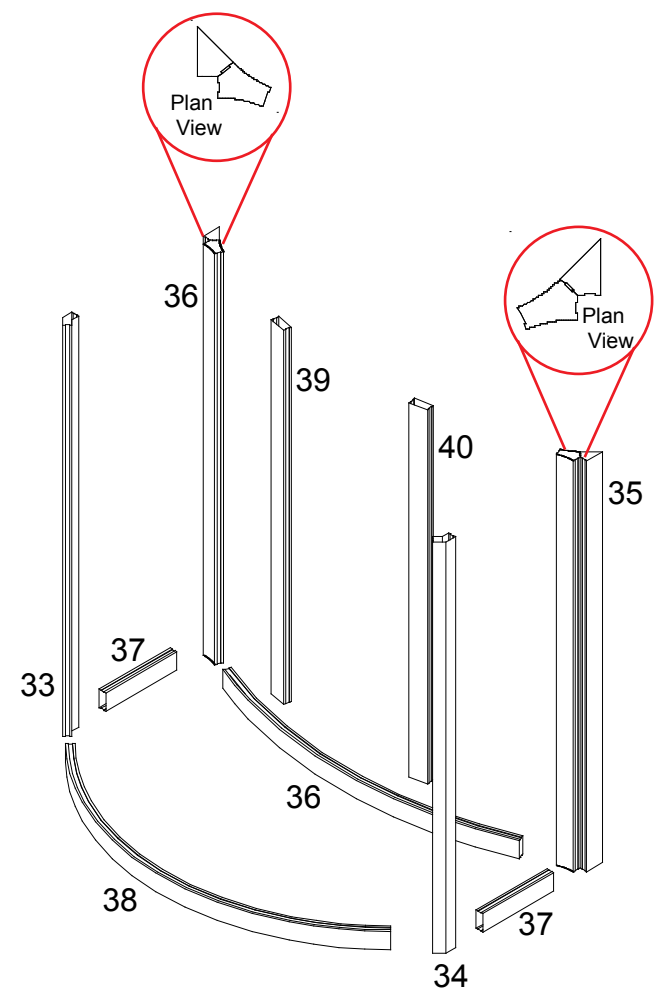
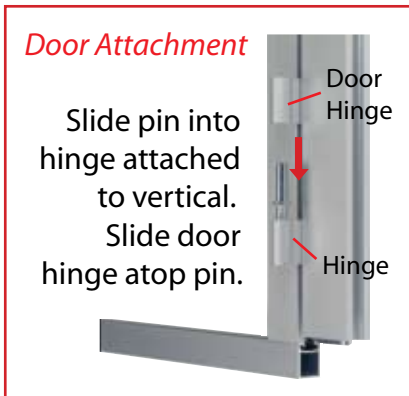

WHEN DISASSEMBLING ALUMINUM EXTRUSION, TIGHTEN ALL SETSCREWS AND LOCKS TO PREVENT LOSS DURING SHIPPING

866.652.2100



- Steps:
 1) Connect canopy pieces together as shown.
 2) Apply pillow case graphic to assembled canopy

Using Your Setup Instructions

The Aero Overhead Sign Setup Instructions are created specifically for your configuration. They include an exploded view of the frame which is sequentially numbered. We encourage you to study the instructions before attempting to assemble your exhibit.

Connections are kept very simple: no tools. Everything assembles with push-button connectors and pre-connected horizontal sections.

Cleaning and Packing Your Display

- 1) Use care when cleaning aluminum extrusion or acrylic inserts. Use only non-abrasive cleaners.
- 2) Retain all packing material. It will make re-packing much easier and will reduce the likelihood of shipping damage.

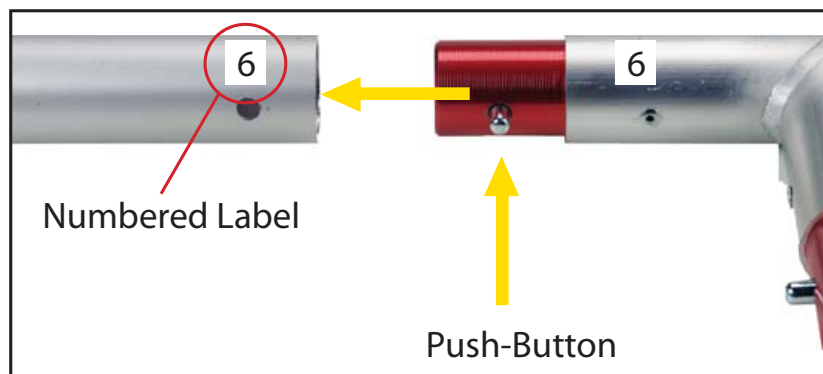
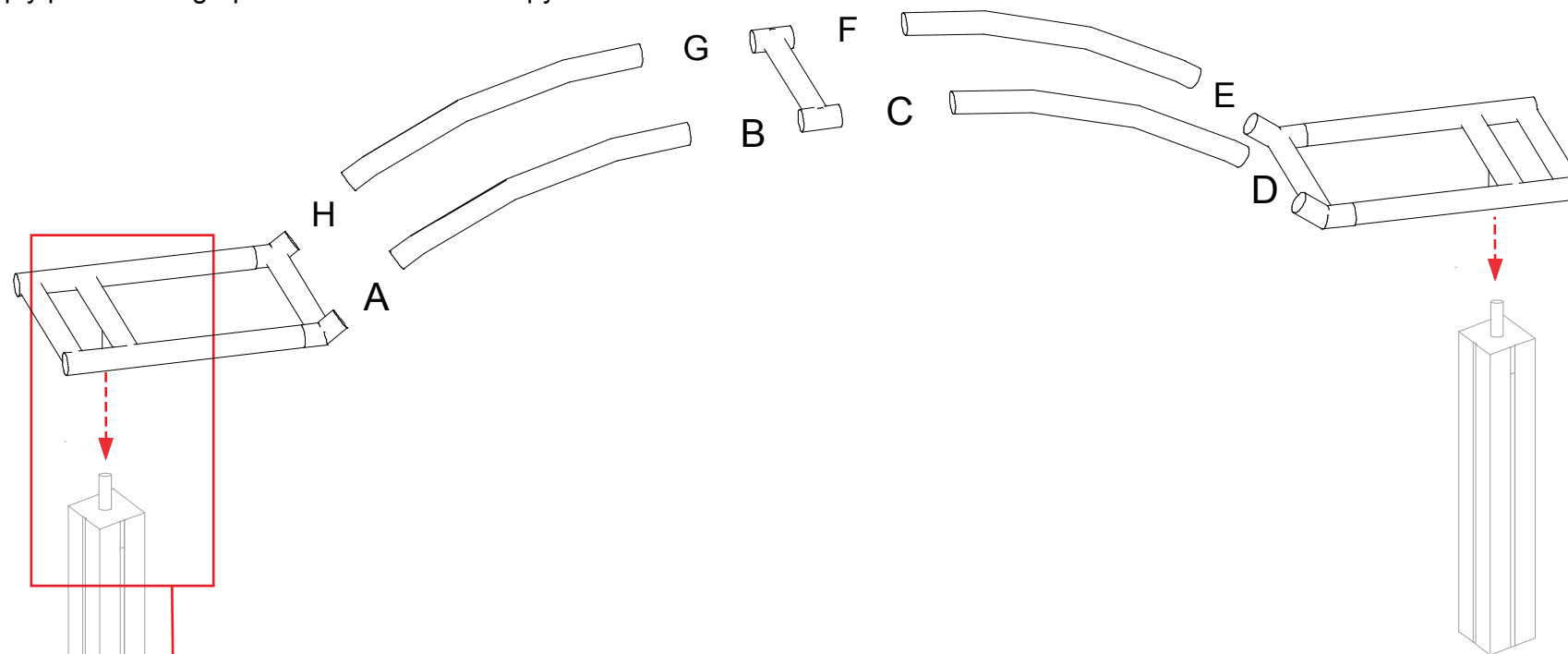

Connections are made by holding the button down and sliding the red tube into opposing tube until the connection is made. To disassemble push button and pull or twist extrusions apart.

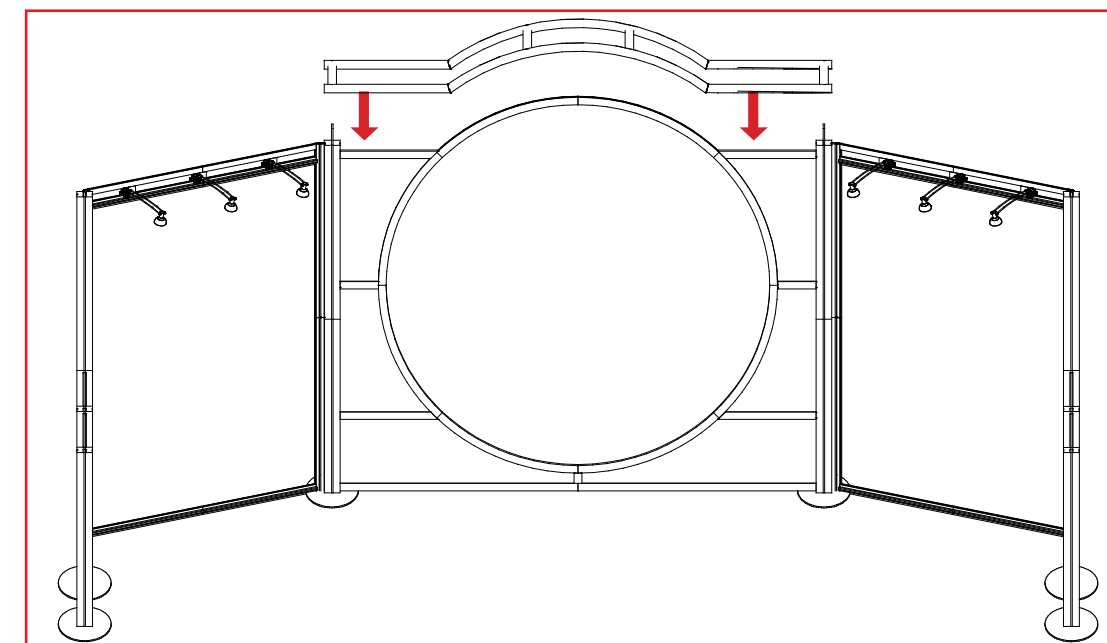
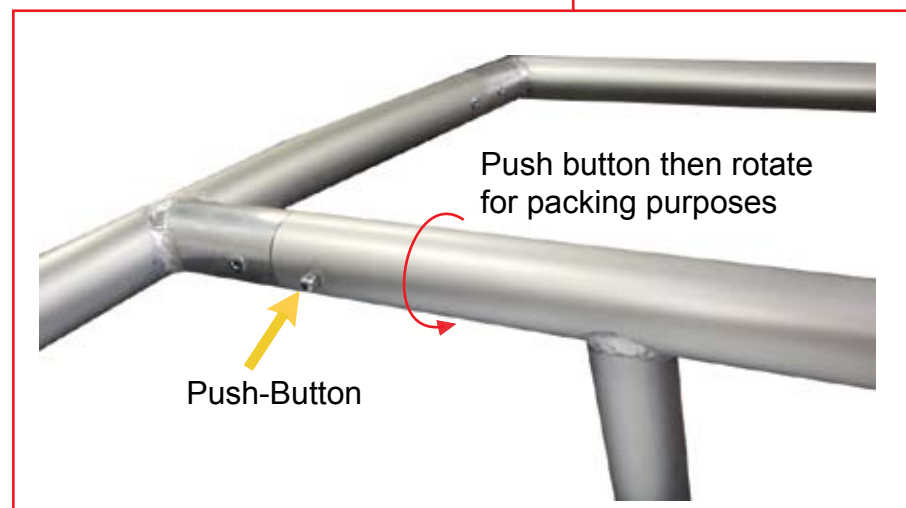
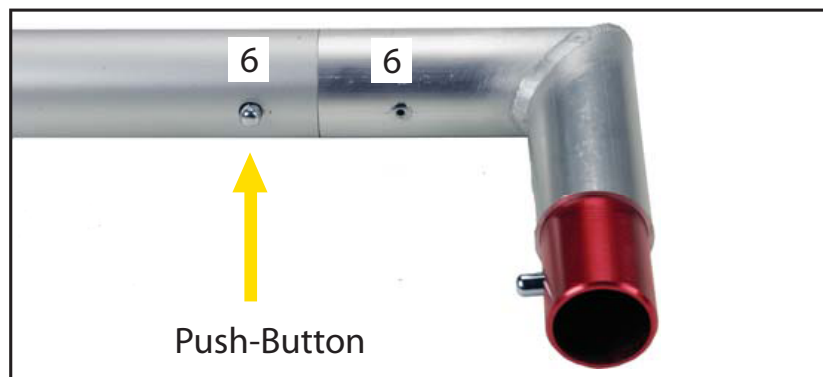

WHEN DISASSEMBLING ALUMINUM EXTRUSION, TIGHTEN ALL SETSCREWS AND LOCKS TO PREVENT LOSS DURING SHIPPING