

euro It | *HYBRIDS*

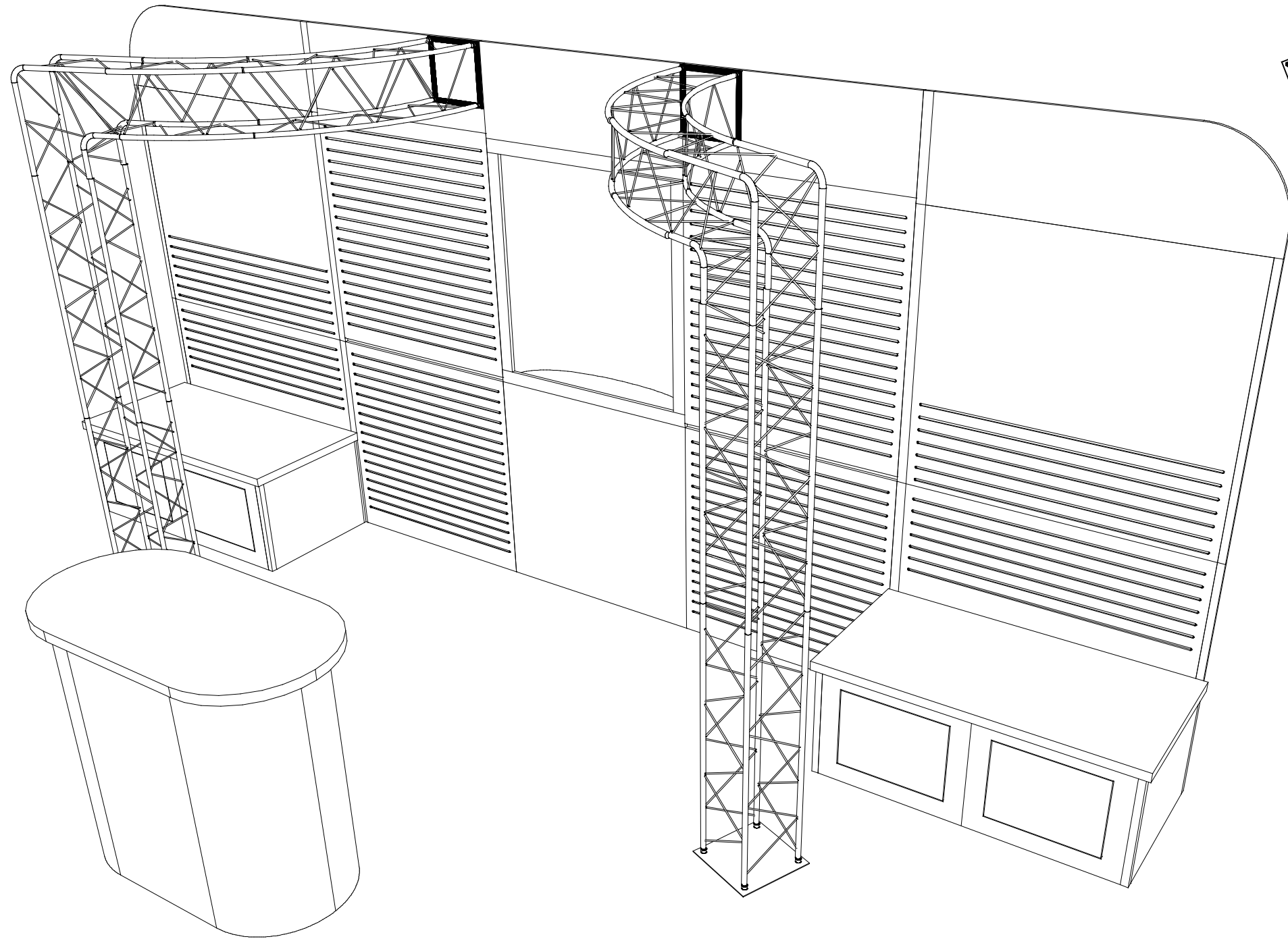

Plan View

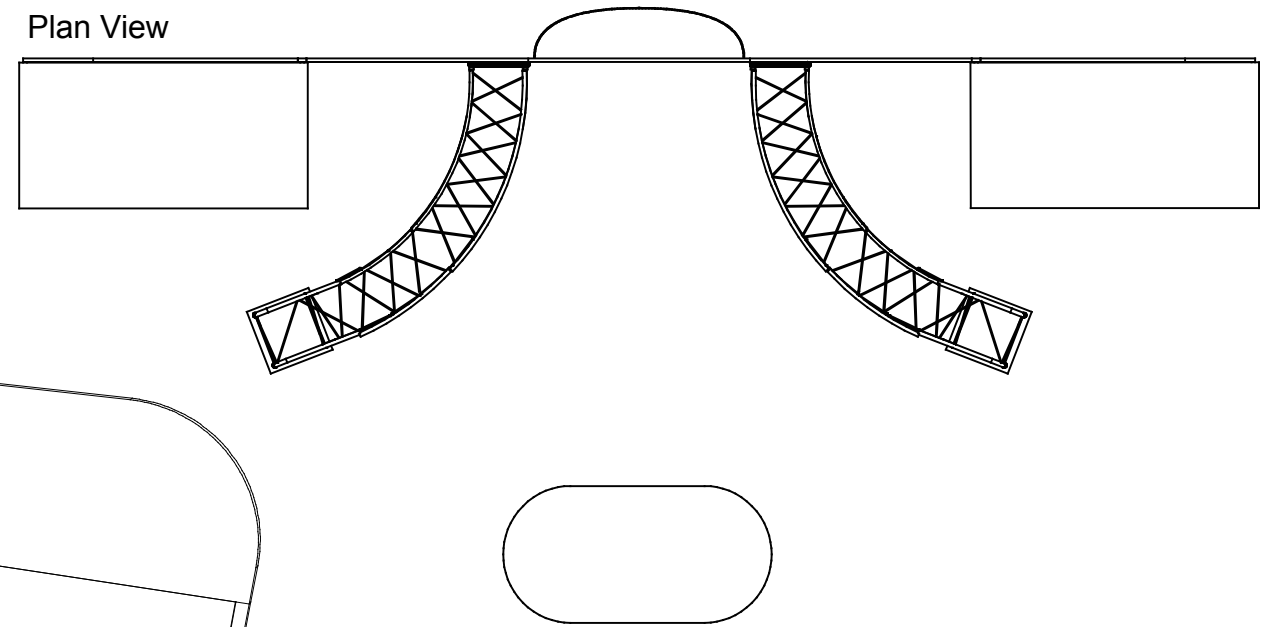

WHEN DISASSEMBLING ALUMINUM EXTRUSION, TIGHTEN ALL SETSCREWS AND LOCKS TO PREVENT LOSS DURING SHIPPING

euro lt | HYBRIDS

Using Your Setup Instructions

The Euro LT Hybrids Setup Instructions are created specifically for your configuration. They are laid out sequentially in levels, including exploded views, and a logical series of detailed steps to assemble the main structure and components. We encourage you to study the instructions **before** attempting to assemble your exhibit.

Each page reminds you to tighten the setscrews after disassembling your exhibit to prevent loss of the locks and setscrews (see below in RED). This is VERY IMPORTANT.

Cleaning and Packing Your Display

- 1) Use care when cleaning aluminum extrusion or acrylic inserts. Use only non-abrasive cleaners.
- 2) When cleaning laminate inserts, countertops, or panels use mild cleansers and a soft material such as cotton.
- 3) Keep all display components away from extreme heat and long exposure to sunlight to avoid warping and fading.
- 4) Retain all packing material. It will make re-packing much easier and will reduce the likelihood of shipping damage.

General Setup Instructions for Extrusion System



The Tool

Most exhibits can be assembled with the supplied Hex Key Tool. Occasionally, a flat head screwdriver may be required.



Typical Connection

Most horizontal extrusion connections have a patented expandable lock. This lock inserts into the groove of an opposing extrusion. Tightening the lock with the Hex Key Tool expands the lock and creates a strong positive connection.



Typical Connection (cont'd)

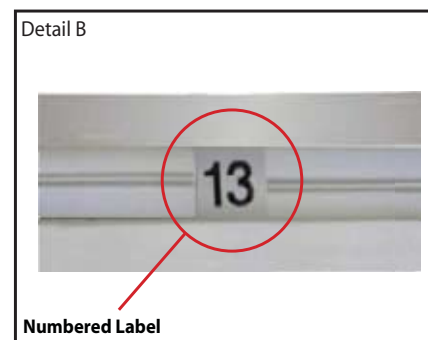

Numbered Label

Each extrusion contains a numbered label which corresponds with setup instructions. The label is located within a groove of the extrusion (when possible). With extrusion components the labels contain Black numbers unless otherwise specified.



Horizontal Inline Connection (remove only one setscrew)

Remove only (1) setscrew when disassembling. Replace setscrew in extrusion after assembling it. Before packing, replace setscrew in extrusion to avoid losing it.

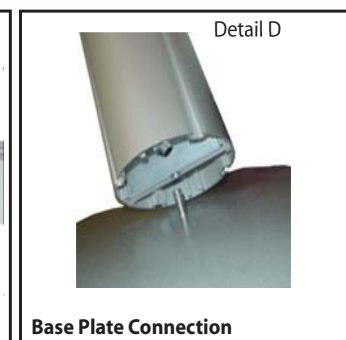

Base Plate Connection

Attach base plate to round or square vertical extrusion using the bolt provided. Be careful not to strip the threads.

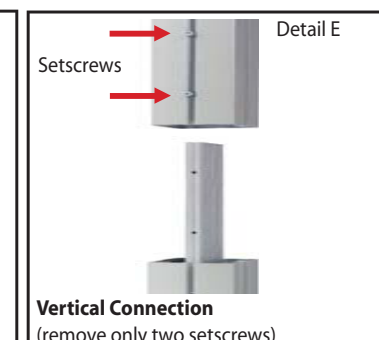

Vertical Connection (remove only two setscrews)

When vertical extrusions are packed in portable cases rather than crates or tubs, they must be broken down into smaller section which then require assembly.

Remove only (2) setscrews when disassembling. Replace setscrews in extrusion after assembling it. Before packing, replace setscrews in extrusion to avoid losing them.

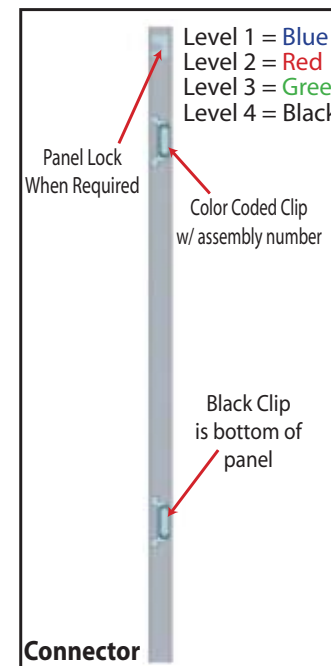

Connector

Each component has 2 clips, the lower clip is ALWAYS black. The top clip is color coded to distinguish which level. The color coded clip also contains the numbered label.

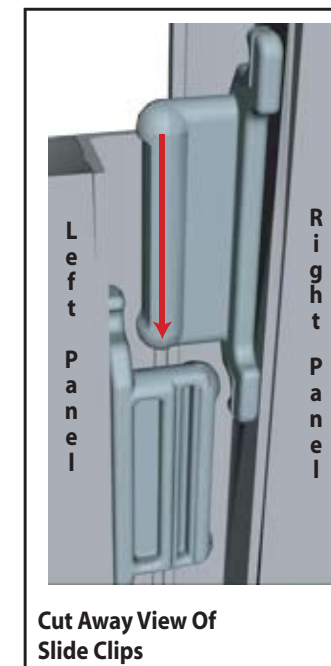

Cut Away View Of Slide Clips

Components connect together by aligning them and sliding downward connecting clips together.

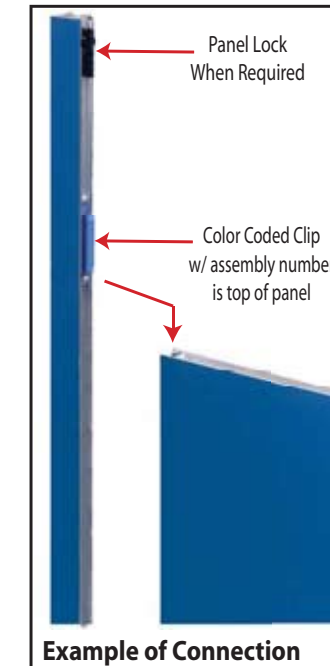

Example of Connection

Configurations are assembled from left to right, usually starting with #1 and following the numbered sequence.

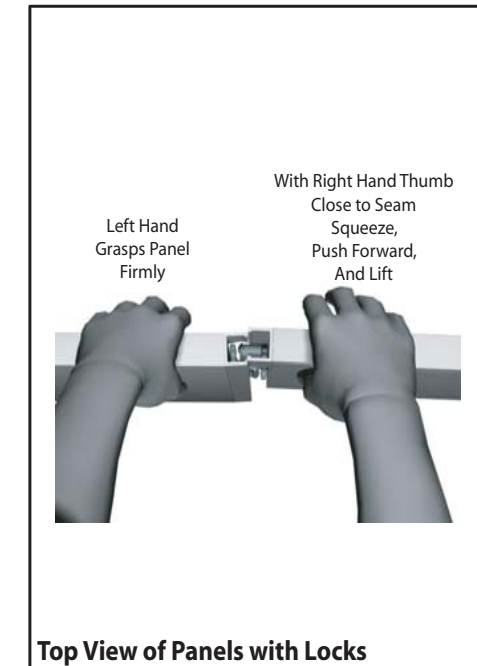

Top View of Panels with Locks

The first level of components contain panel locks that are located at the top of the panel for extra stability and seamless connection. When disassembling panels twist top connection slightly and lift right panel upward.

WHEN DISASSEMBLING ALUMINUM EXTRUSION, TIGHTEN ALL SETSCREWS AND LOCKS TO PREVENT LOSS DURING SHIPPING

866.652.2100

Item Number	Description	Item Number	Description	Item Number	Description	Item Number	Description
1	38" w x 38" h Flat Panel w/ Slatwall	9	23" w x 19" h Flat Panel	18	23" w x 19" h Flat Panel	45	19" w x 38" h Flat Panel w/ Door
3	38" w x 38" h Flat Panel	10	19" h 90° Connector	19	19" h 90° Connector	46	11.5" r x 38" h Curved Panel
5	38" w x 38" h Flat Panel w/ Slatwall	11	23" w x 19" h Flat Panel w/ Door	20	23" w x 19" h Flat Panel w/ Door	47	11.5" r x 38" h Curved Panel
		12	23" w x 19" h Flat Panel w/ Door	21	23" w x 19" h Flat Panel w/ Door	48	19" w x 38" h Flat Panel
		13	19" h 90° Connector	22	19" h 90° Connector	49	11.5" r x 38" h Curved Panel
		14	23" w x 19" h Flat Panel	23	23" w x 19" h Flat Panel	50	11.5" r x 38" h Curved Panel
		15	38" h Custom Milled 90° Connector	24A	38" h Custom Milled T-Connector		
		16	46" w x 38" h Flat Panel w/ Slatwall	25	46" w x 38" h Flat Panel w/ Slatwall		
		17A	38" h Custom Milled T-Connector	26	38" h Custom Milled 90° Connector		

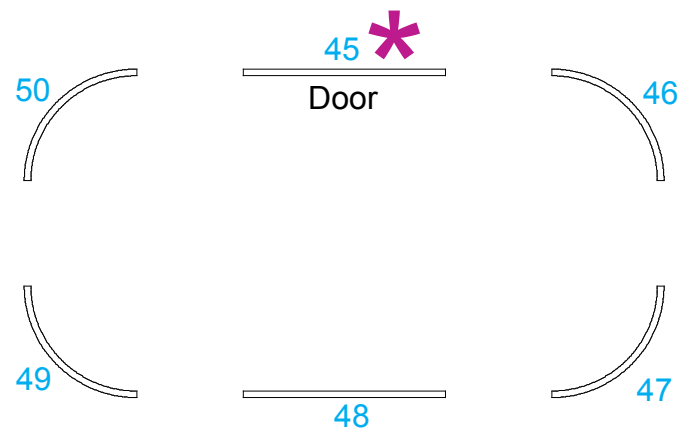
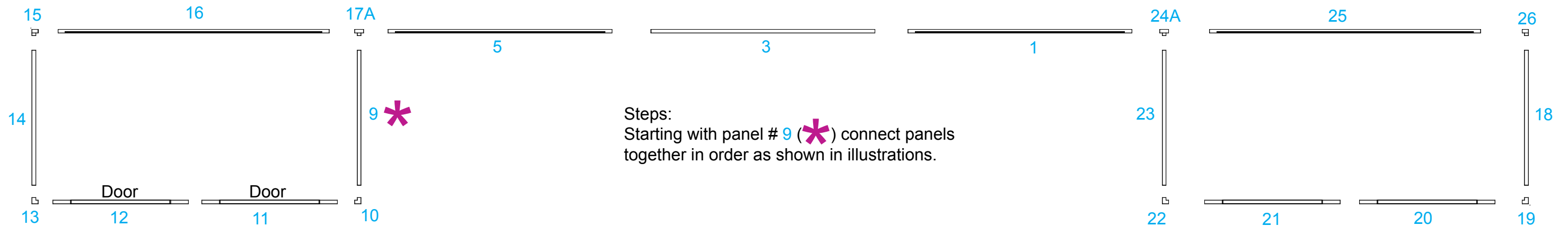

WHEN DISASSEMBLING ALUMINUM EXTRUSION, TIGHTEN ALL SETSCREWS AND LOCKS TO PREVENT LOSS DURING SHIPPING

866.652.2100

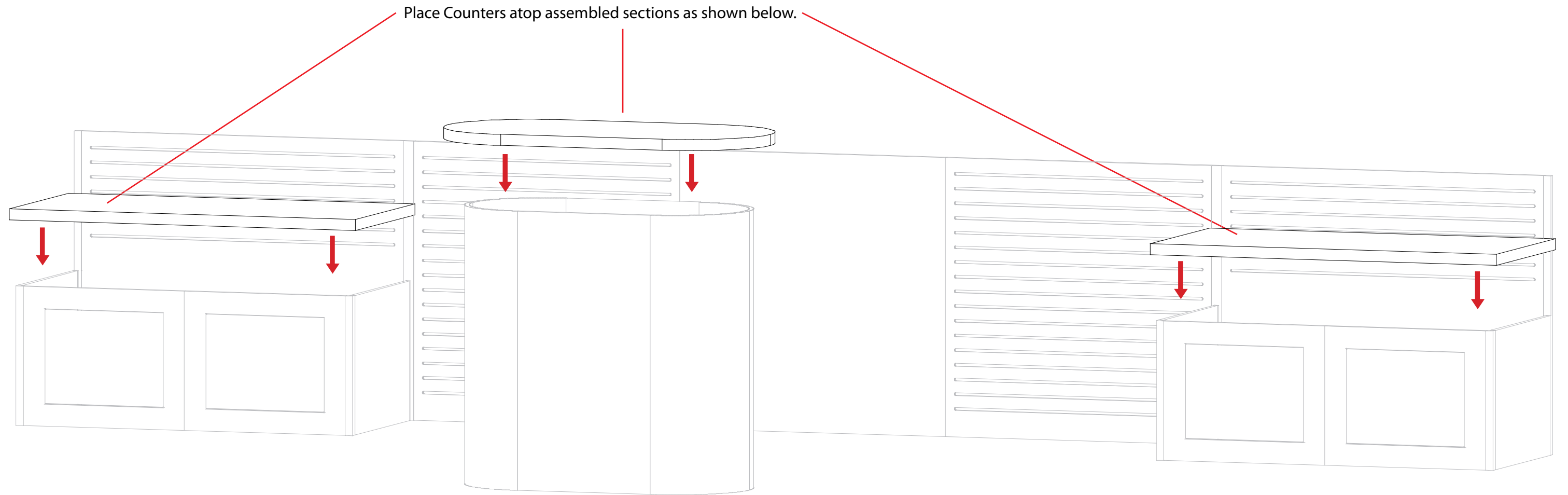

WHEN DISASSEMBLING ALUMINUM EXTRUSION, TIGHTEN ALL SETSCREWS AND LOCKS TO PREVENT LOSS DURING SHIPPING

866.652.2100

Item Number	Description	Item Number	Description	Item Number	Description
1	38" w x 42" h Flat Panel w/ Slatwall	15	42" h Custom Milled 90° Connector	24A	38" h Custom Milled T-Connector
3	38" w x 42" h Flat Panel	16	46" w x 42" h Flat Panel w/ Slatwall	25	46" w x 38" h Flat Panel w/ Slatwall
5	38" w x 42" h Flat Panel w/ Slatwall	17A	42" h Custom Milled 180° Connector	26	38" h Custom Milled 90° Connector

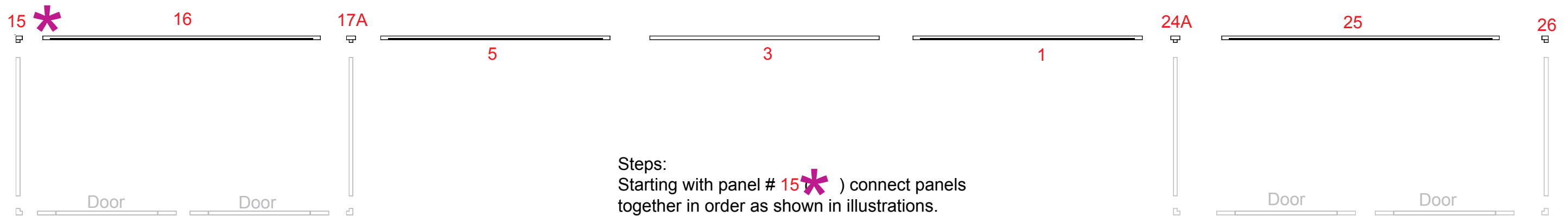
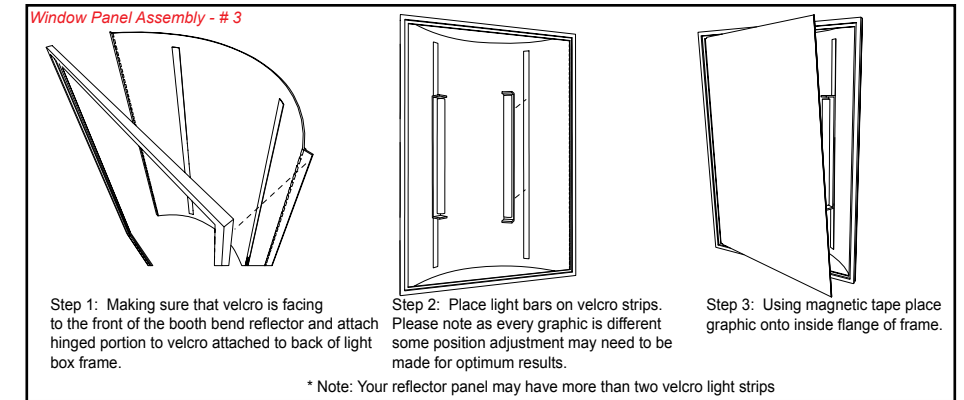

WHEN DISASSEMBLING ALUMINUM EXTRUSION, TIGHTEN ALL SETSCREWS AND LOCKS TO PREVENT LOSS DURING SHIPPING

866.652.2100

Item Number	Description	Item Number	Description	Item Number	Description
1	38" w x 15" h Flat Panel w/ Slatwall	15	15" h End Cap	24A	15" h 180° Connector
3	38" w x 15" h Flat Panel	16	46" w x 15" h Flat Panel w/ Slatwall	25	46" w x 15" h Flat Panel w/ Slatwall
5	38" w x 15" h Flat Panel w/ Slatwall	17A	15" h 180° Connector	26	15" h End Cap

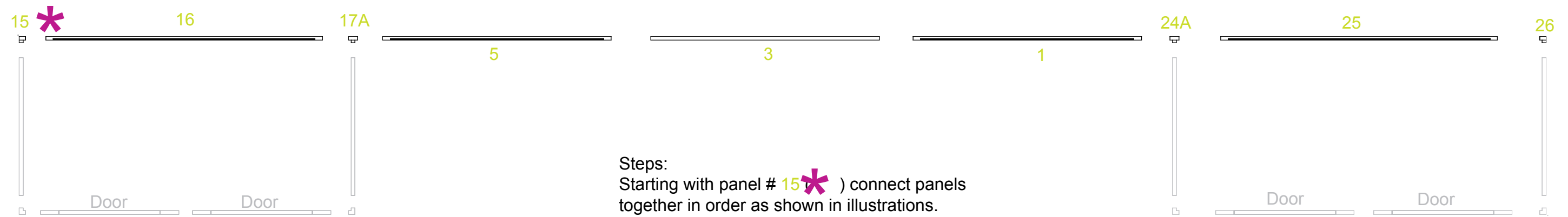

Steps:
 Starting with panel # 15*) connect panels together in order as shown in illustrations.

WHEN DISASSEMBLING ALUMINUM EXTRUSION, TIGHTEN ALL SETSCREWS AND LOCKS TO PREVENT LOSS DURING SHIPPING