

euro It | HYBRIDS

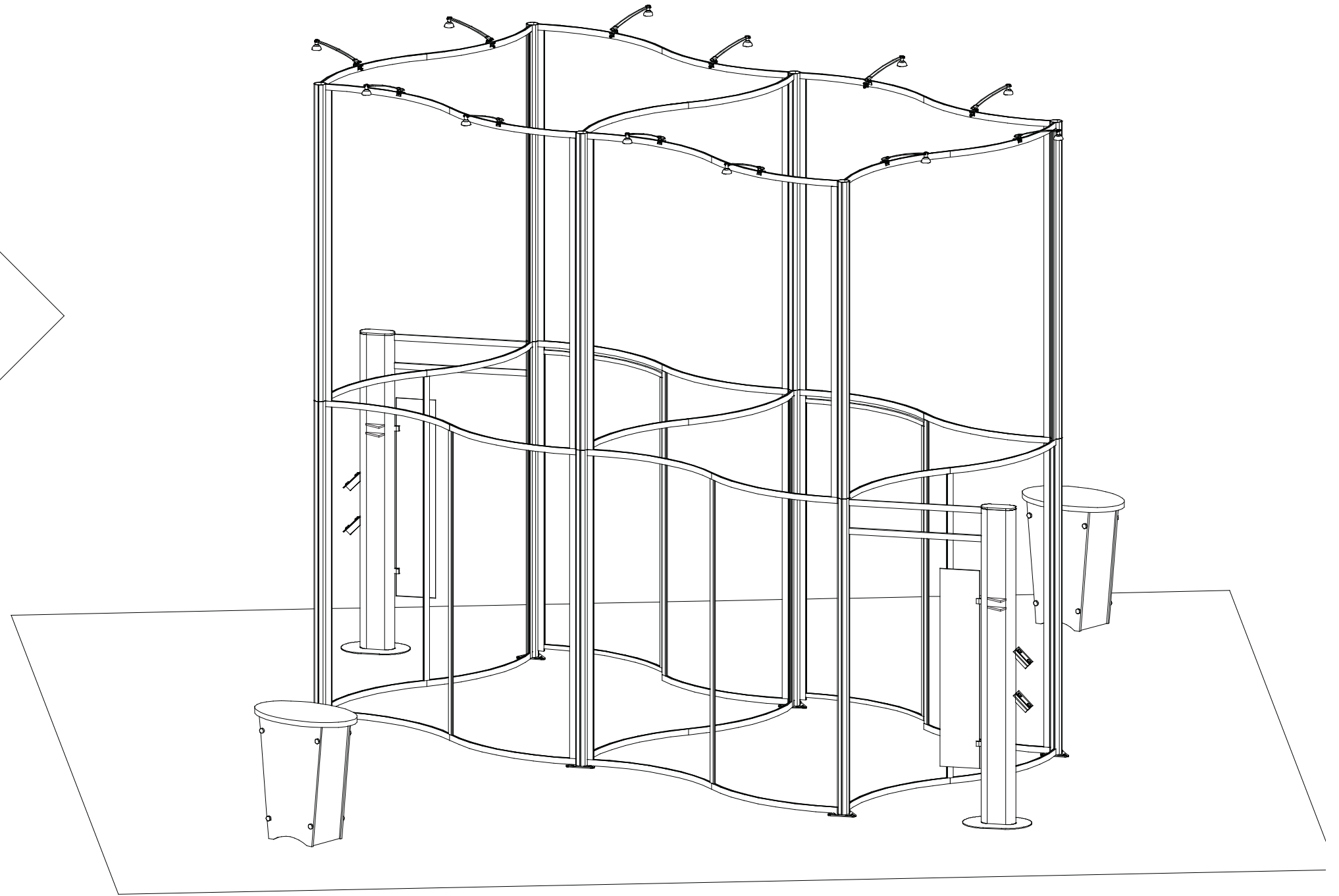
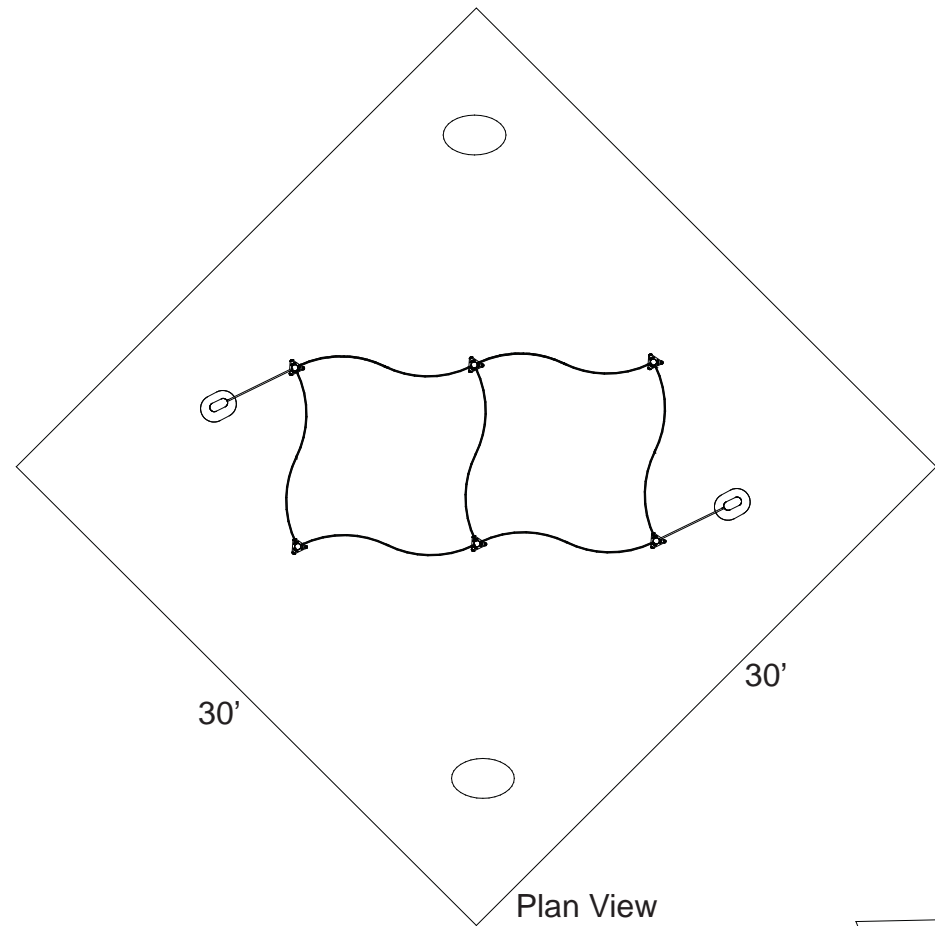

WHEN DISASSEMBLING ALUMINUM EXTRUSION, TIGHTEN ALL SETSCREWS AND LOCKS TO PREVENT LOSS DURING SHIPPING

euro lt | HYBRIDS

Using Your Setup Instructions

The Euro LT Hybrids Setup Instructions are created specifically for your configuration. They are laid out sequentially in levels, including exploded views, and a logical series of detailed steps to assemble the main structure and components. We encourage you to study the instructions **before** attempting to assemble your exhibit.

Each page reminds you to tighten the setscrews after disassembling your exhibit to prevent loss of the locks and setscrews (see below in RED). This is VERY IMPORTANT.

Cleaning and Packing Your Display

- 1) Use care when cleaning aluminum extrusion or acrylic inserts. Use only non-abrasive cleaners.
- 2) When cleaning laminate inserts, countertops, or panels use mild cleansers and a soft material such as cotton.
- 3) Keep all display components away from extreme heat and long exposure to sunlight to avoid warping and fading.
- 4) Retain all packing material. It will make re-packing much easier and will reduce the likelihood of shipping damage.

General Setup Instructions for Extrusion System



The Tool

Most exhibits can be assembled with the supplied Hex Key Tool. Occasionally, a flat head screwdriver may be required.



Typical Connection

Most horizontal extrusion connections have a patented expandable lock. This lock inserts into the groove of an opposing extrusion. Tightening the lock with the Hex Key Tool expands the lock and creates a strong positive connection.



Typical Connection (cont'd)

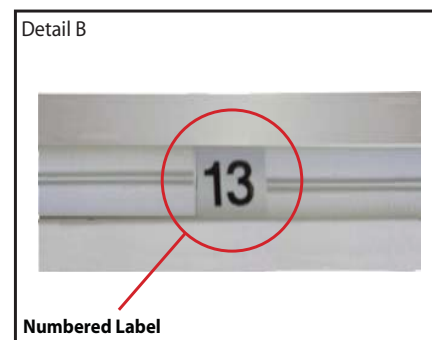

Numbered Label

Each extrusion contains a numbered label which corresponds with setup instructions. The label is located within a groove of the extrusion (when possible). With extrusion components the labels contain Black numbers unless otherwise specified.



Horizontal Inline Connection (remove only one setscrew)

Remove only (1) setscrew when disassembling. Replace setscrew in extrusion after assembling it. Before packing, replace setscrew in extrusion to avoid losing it.

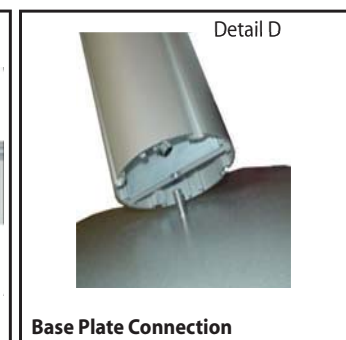

Base Plate Connection

Attach base plate to round or square vertical extrusion using the bolt provided. Be careful not to strip the threads.

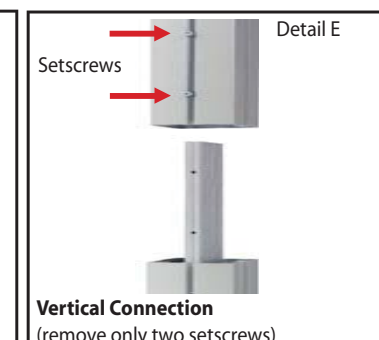

Vertical Connection (remove only two setscrews)

When vertical extrusions are packed in portable cases rather than crates or tubs, they must be broken down into smaller section which then require assembly.

Remove only (2) setscrews when disassembling. Replace setscrews in extrusion after assembling it. Before packing, replace setscrews in extrusion to avoid losing them.

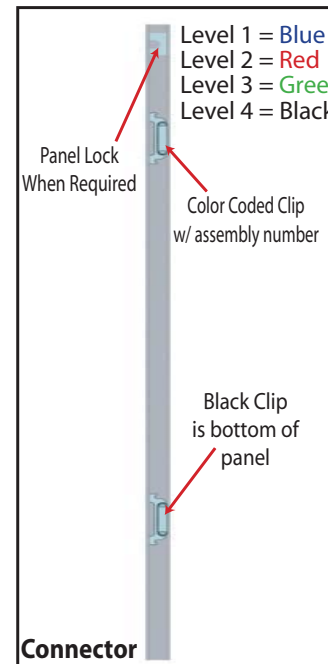

Connector

Each component has 2 clips, the lower clip is ALWAYS black. The top clip is color coded to distinguish which level. The color coded clip also contains the numbered label.

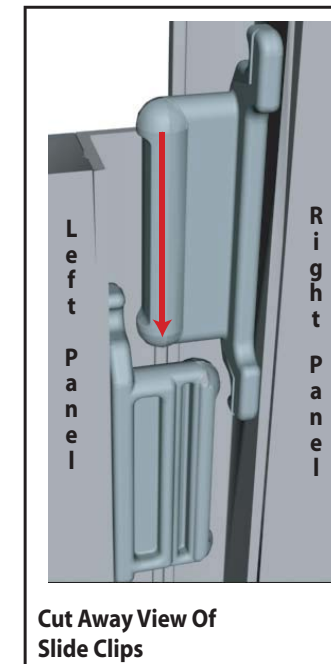

Cut Away View Of Slide Clips

Components connect together by aligning them and sliding downward connecting clips together.

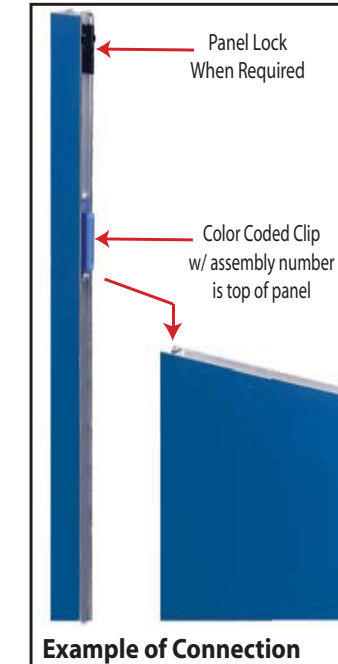

Example of Connection

Configurations are assembled from left to right, usually starting with #1 and following the numbered sequence.

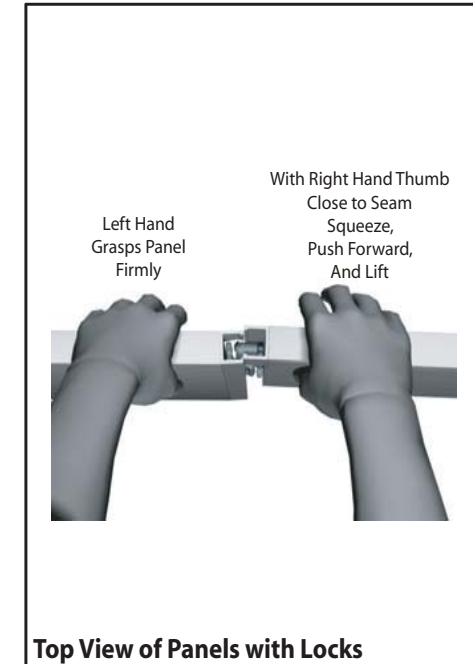

Top View of Panels with Locks

The first level of components contain panel locks that are located at the top of the panel for extra stability and seamless connection. When disassembling panels twist top connection slightly and lift right panel upward.

WHEN DISASSEMBLING ALUMINUM EXTRUSION, TIGHTEN ALL SETSCREWS AND LOCKS TO PREVENT LOSS DURING SHIPPING

866.652.2100

Graphic Frame Extrusions

Item	Qty.	Description
A	2	92.17" Vertical Extrusion
E	2	Curve Horizontal Extrusion
G	4	94.2" Vertical Extrusion
H	2	50.05" Curve Horizontal Extrusion
I	4	50.05" Curve Horizontal Extrusion
J	2	94"h Vertical Extrusion w/ Door Stop
K	2	Curve Horizontal Extrusion
L	2	Door Extrusion w/ Hinges
M	2	Door Extrusion
N	2	Door Extrusion
O	2	Door Extrusion
P	2	Door Extrusion

Item	Qty.	Description
1	3	Base Plate
2	1	95.75"h Vertical Extrusion
2a	2	95.75"h Vertical Extrusion w/ Door Hinges
3	3	96"h Vertical Extrusion
4	2	40"w Horizontal Extrusion
5	1	Base Plate
6	1	95.25"h Vertical Extrusion

Steps:

- 1) Attach door thresholds to vertical extrusions [2a]
- 2) Attach base plates [1] to vertical extrusions [2 and 2a].
- 3) Attach upper vertical extrusions [3] to lower extrusions [2 and 2a].
- 4) Connect one end of extrusions [K] to vertical extrusion [2 and 2a].
- 5) Slide verticals [J] on threshold connectors and tighten setscrews to secure, then lock horizontals [K] to vertical extrusions [J].
- 6) Connect horizontal extrusions together [E to F and I to H].
- 7) Attach horizontal assemblies [E/F and I/H] between verticals [2/3 and 2a/3] as shown, connecting verticals [G] between curve horizontal assemblies, tighten all locks to secure.

Graphic Attachment
Apply graphic to Velcro on assembled frame.
Images must face to BACK

Steps Cont'd:

- 1) Attach vertical [6] to base plate [5].
- 2) Connect horizontals [4] between verticals [2a and 6].

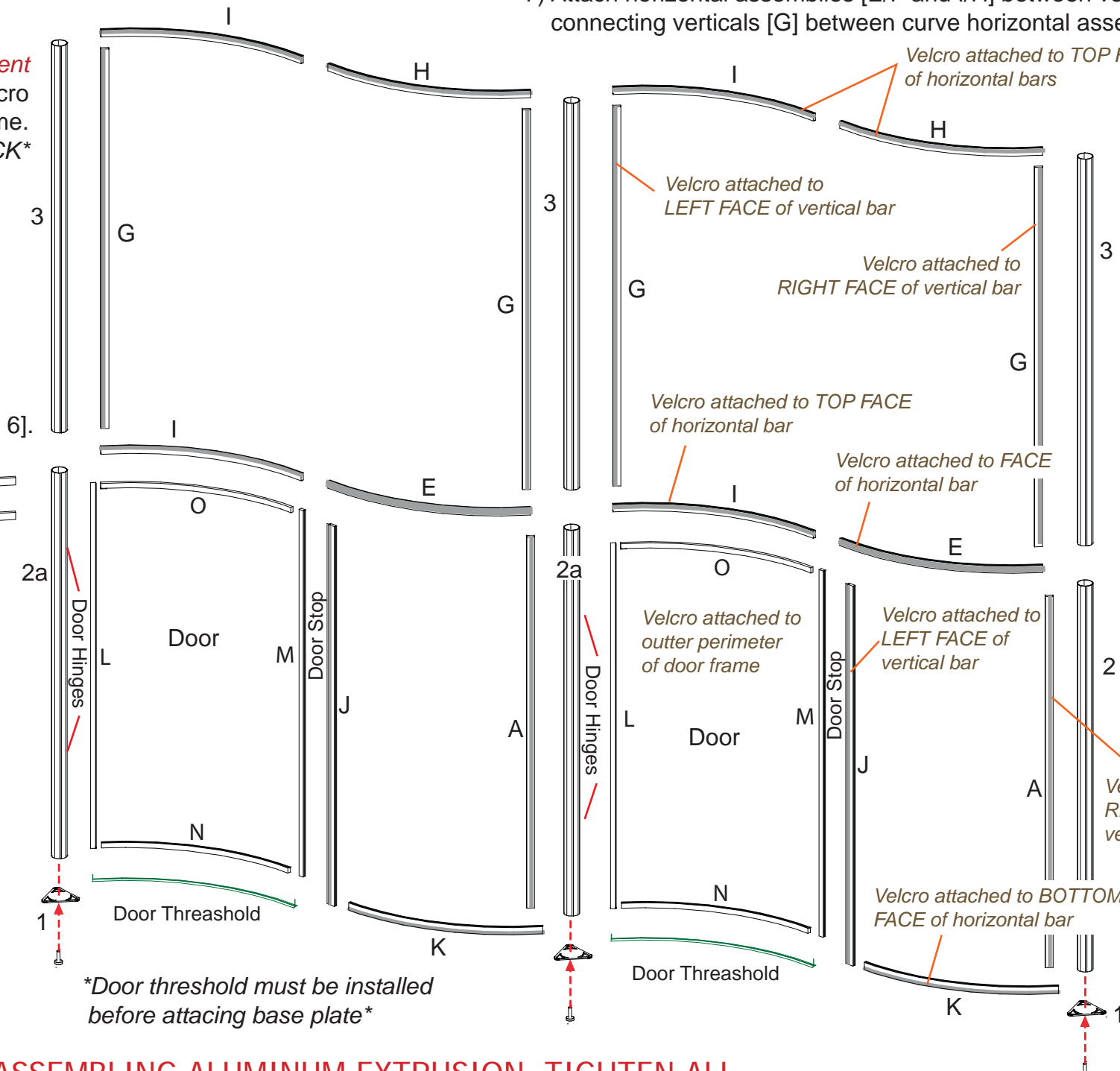
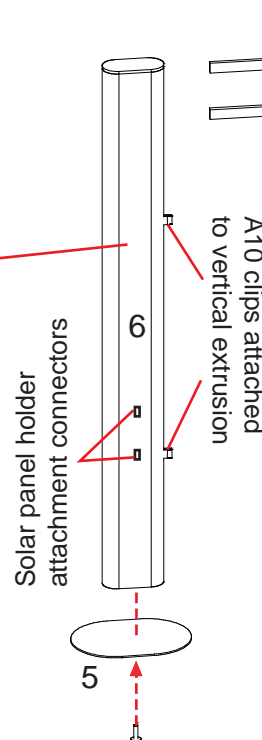

Door threshold must be installed before attaching base plate

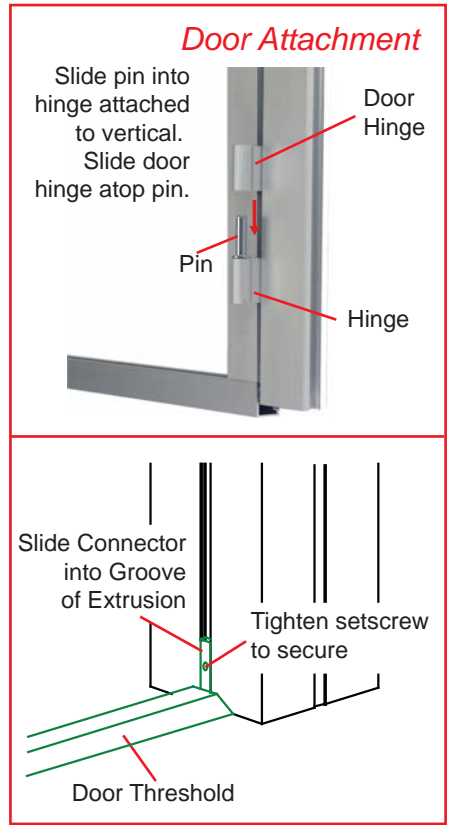

Option #1: If monitor is needed

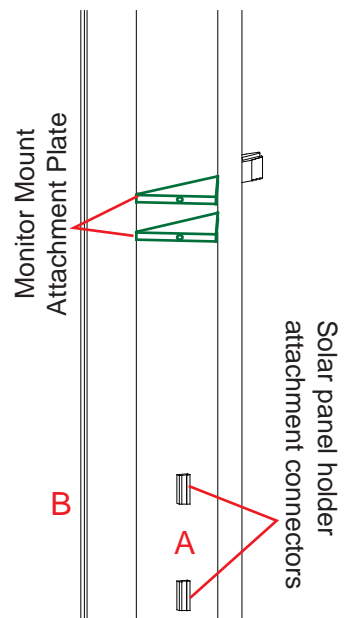

Monitor mount support holders must face forward and A10 clips must be on right side.

Solar panel holders can attach to connectors A OR to side of tower B.

Option #2: If monitor is NOT needed
See the following page

WHEN DISASSEMBLING ALUMINUM EXTRUSION, TIGHTEN ALL SETSCREWS AND LOCKS TO PREVENT LOSS DURING SHIPPING

Option #2: If monitor is *NOT* needed and solar panel holder connectors must be invisible

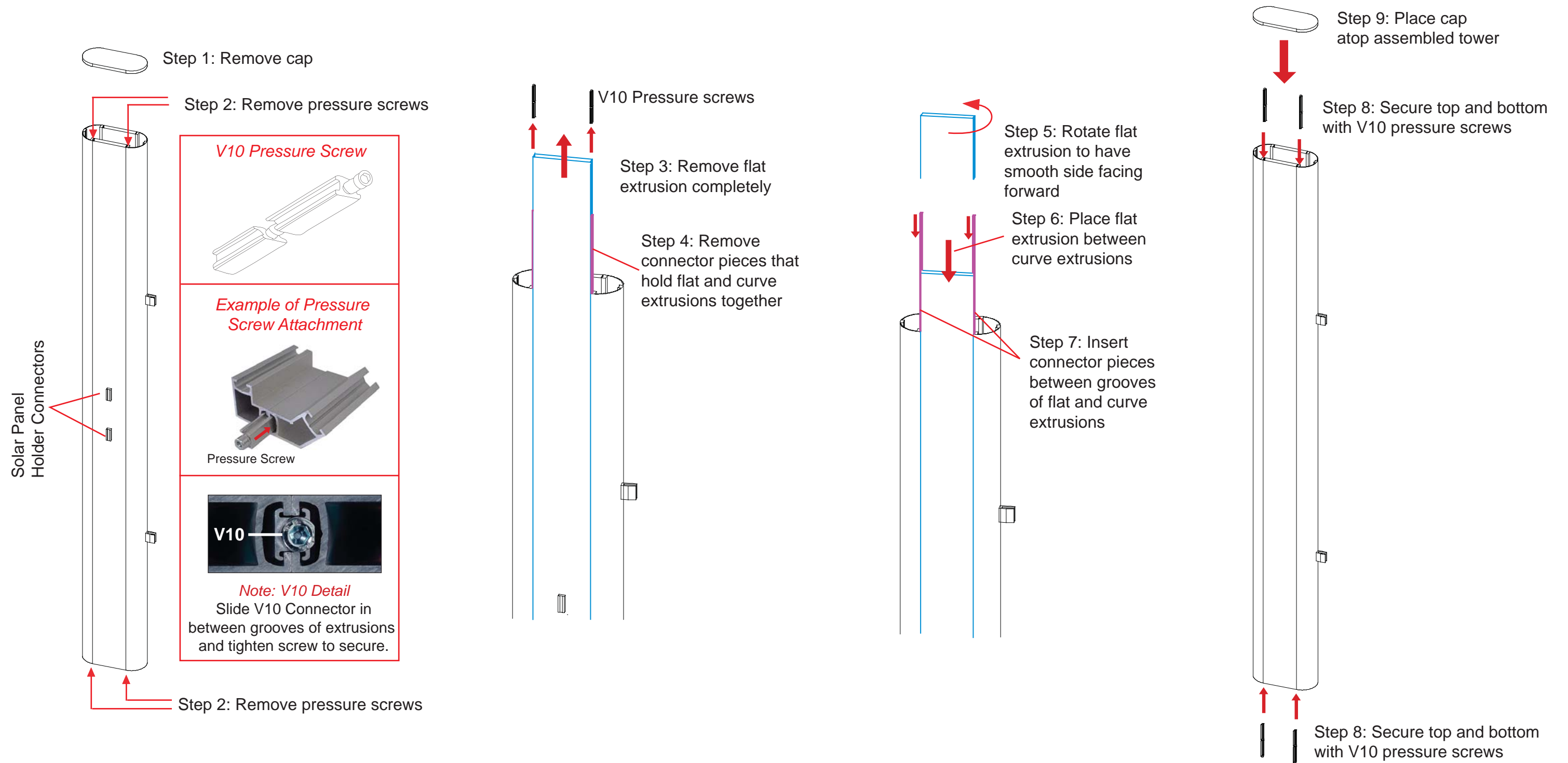

WHEN DISASSEMBLING ALUMINUM EXTRUSION, TIGHTEN ALL SETSCREWS AND LOCKS TO PREVENT LOSS DURING SHIPPING

Graphic Frame Extrusions

Item	Qty.	Description
A	2	92.17" Vertical Extrusion
B	1	92.17" Vertical Extrusion
C	1	Curve Horizontal Extrusion
D	1	Curve Horizontal Extrusion
E	1	Curve Horizontal Extrusion
F	1	Curve Horizontal Extrusion
G	2	94.2" Vertical Extrusion
H	1	50.05" Curve Horizontal Extrusion
I	1	50.05" Curve Horizontal Extrusion

Item	Qty.	Description
1	1	Base Plate
2	1	95.75"h Vertical Extrusion
3	1	96"h Vertical Extrusion

Graphic Attachment
 Apply graphic to Velcro
 on assembled frame
 Images must face to LEFT

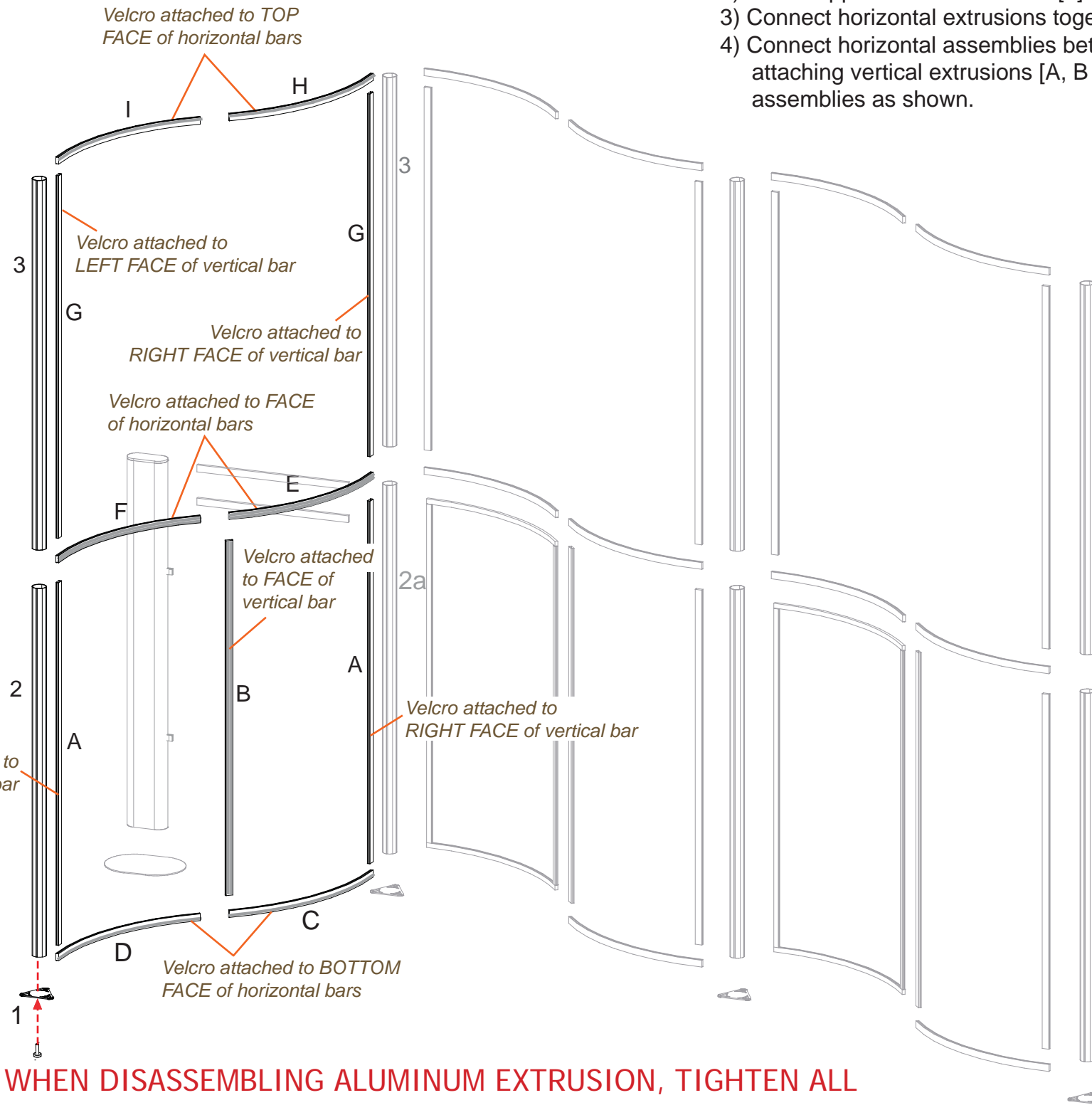

Steps:

- 1) Attach vertical extrusion [2] to base plate [1].
- 2) Attach upper vertical extrusion [3] to lower vertical extrusion [2].
- 3) Connect horizontal extrusions together [C to D, E to F and H to I].
- 4) Connect horizontal assemblies between vertical extrusions [2/3 and 2a/3], attaching vertical extrusions [A, B and G] between horizontal assemblies as shown.

WHEN DISASSEMBLING ALUMINUM EXTRUSION, TIGHTEN ALL SETSCREWS AND LOCKS TO PREVENT LOSS DURING SHIPPING

Graphic Frame Extrusions

Item	Qty.	Description
A	2	92.17" Vertical Extrusion
B	1	92.17" Vertical Extrusion
C	1	Curve Horizontal Extrusion
D	1	Curve Horizontal Extrusion
E	1	Curve Horizontal Extrusion
F	1	Curve Horizontal Extrusion
G	2	94.2" Vertical Extrusion
H	1	50.05" Curve Horizontal Extrusion
I	1	50.05" Curve Horizontal Extrusion

Item	Qty.	Description
1	1	Base Plate
2	1	95.75"h Vertical Extrusion
3	1	96"h Vertical Extrusion

Steps:

- 1) Attach vertical extrusion [2] to base plate [1].
- 2) Attach upper vertical extrusion [3] to lower vertical extrusion [2].
- 3) Connect horizontal extrusions together [C to D, E to F and H to I].
- 4) Connect horizontal assemblies between vertical extrusions [2/3 and 2a/3], attaching vertical extrusions [A, B and G] between horizontal assemblies as shown.

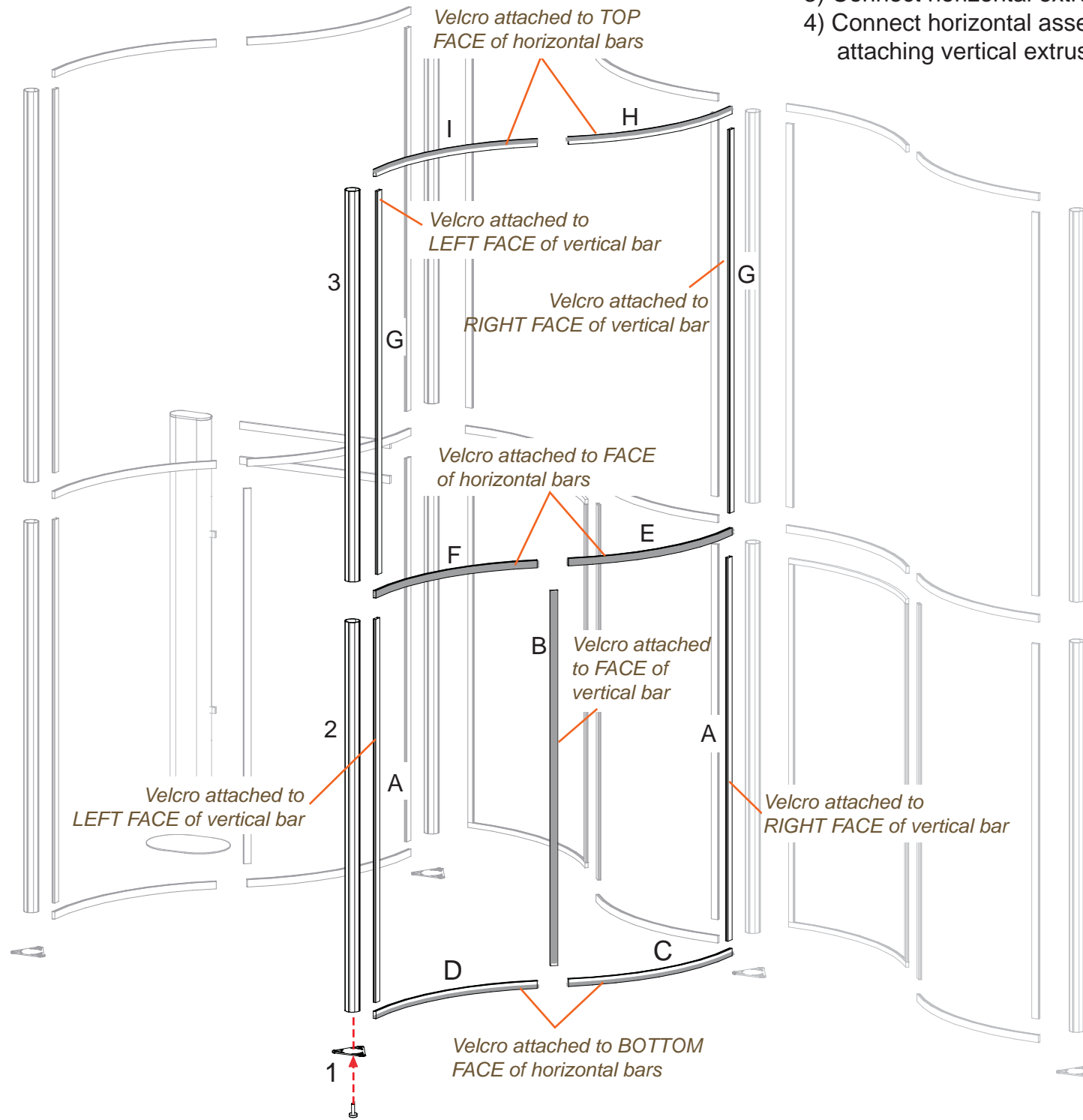

Graphic Attachment
 Apply graphic to Velcro on assembled frame.
Images must face to LEFT

WHEN DISASSEMBLING ALUMINUM EXTRUSION, TIGHTEN ALL SETSCREWS AND LOCKS TO PREVENT LOSS DURING SHIPPING

Graphic Frame Extrusions

Item	Qty.	Description
A	2	92.17" Vertical Extrusion
B	1	92.17" Vertical Extrusion
C	1	Curve Horizontal Extrusion
D	1	Curve Horizontal Extrusion
E	1	Curve Horizontal Extrusion
F	1	Curve Horizontal Extrusion
G	2	94.2" Vertical Extrusion
H	1	50.05" Curve Horizontal Extrusion
I	1	50.05" Curve Horizontal Extrusion

Item	Qty.	Description
1	1	Base Plate
2	1	95.75"h Vertical Extrusion
3	1	96"h Vertical Extrusion

Steps:

- 1) Attach vertical extrusion [2] to base plate [1].
- 2) Attach upper vertical extrusion [3] to lower vertical extrusion [2].
- 3) Connect horizontal extrusions together [C to D, E to F and H to I].
- 4) Connect horizontal assemblies between vertical extrusions [2/3 and 2a/3], attaching vertical extrusions [A, B and G] between horizontal assemblies as shown.

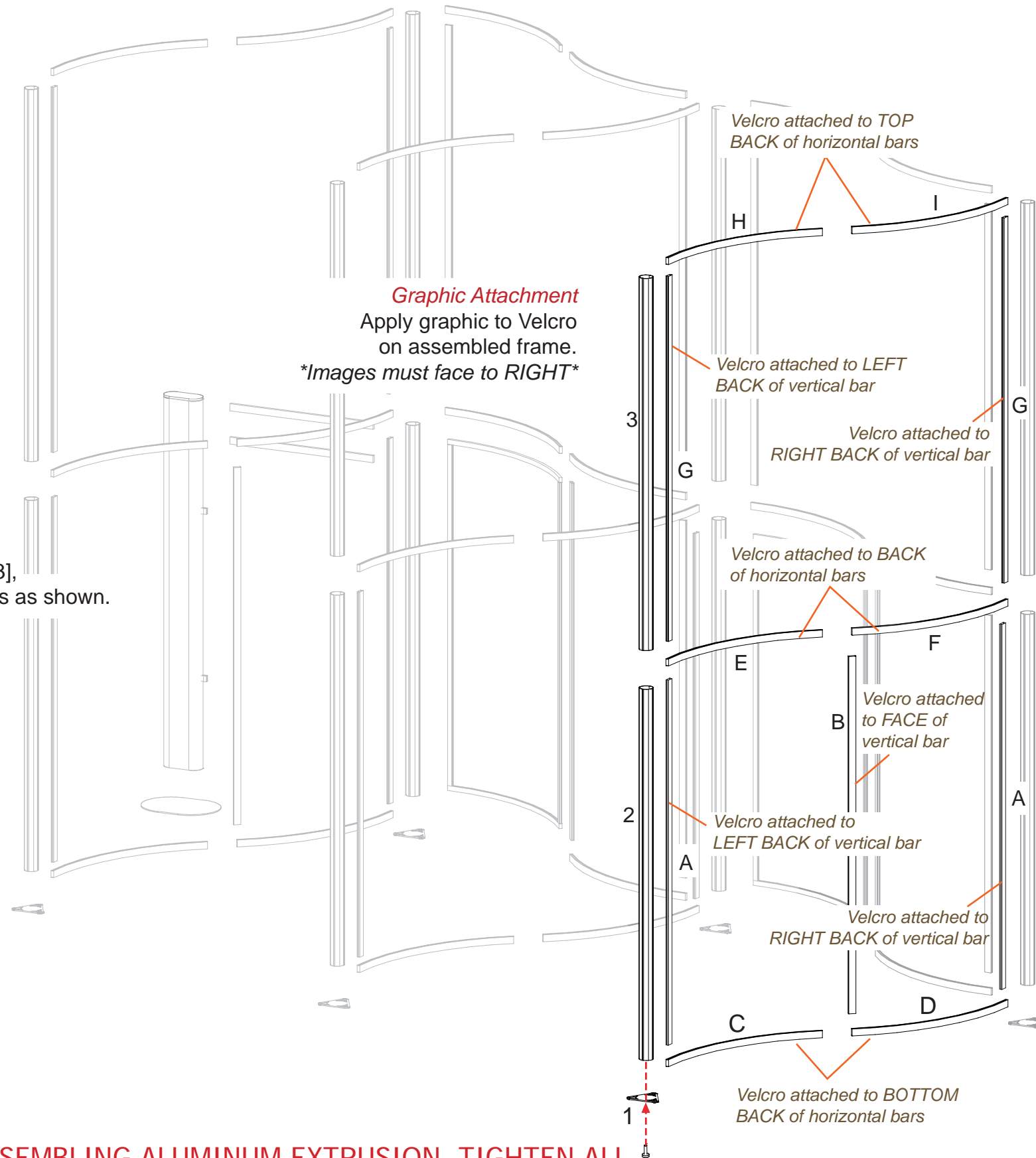

WHEN DISASSEMBLING ALUMINUM EXTRUSION, TIGHTEN ALL SETSCREWS AND LOCKS TO PREVENT LOSS DURING SHIPPING

Graphic Frame Extrusions

Item	Qty.	Description
A	4	92.17" Vertical Extrusion
B	2	92.17" Vertical Extrusion
C	2	Curve Horizontal Extrusion
D	2	Curve Horizontal Extrusion
E	2	Curve Horizontal Extrusion
F	2	Curve Horizontal Extrusion
G	4	94.2" Vertical Extrusion
H	2	50.05" Curve Horizontal Extrusion
I	2	50.05" Curve Horizontal Extrusion

Item	Qty.	Description
4	1	40"w Horizontal Extrusion
5	1	Base Plate
6	1	95.25"h Vertical Extrusion

Graphic Attachment

Apply graphic to Velcro on assembled frame.
Images must face FORWARD

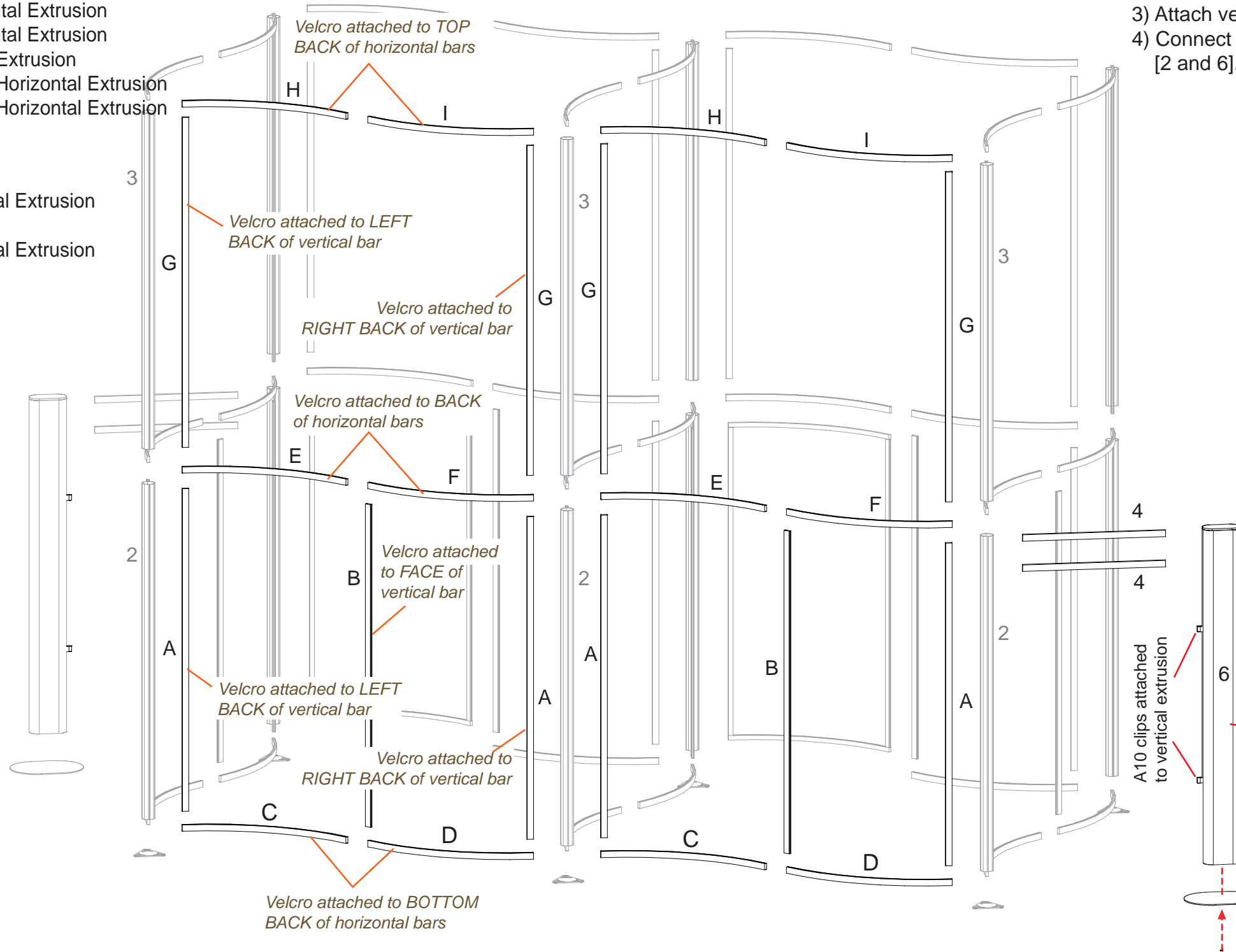

Steps:

- 1) Connect horizontal extrusions together [C to D, E to F and H to I].
- 2) Connect horizontal assemblies between vertical extrusions [2/3], attaching vertical extrusions [A, B and G] between horizontal assemblies as shown.
- 3) Attach vertical extrusion [6] to base plate [5].
- 4) Connect horizontal extrusions [4] between verticals [2 and 6].

Option #1: If monitor is needed

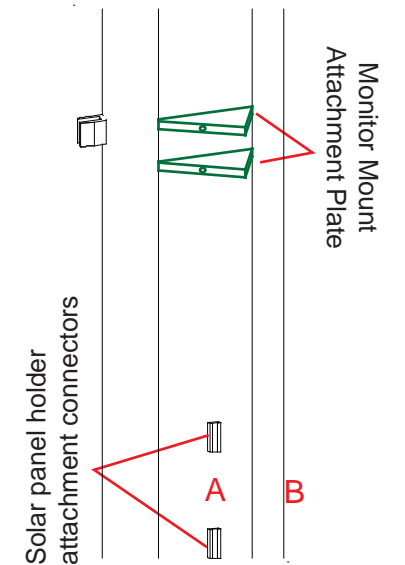

Monitor mount support holders must face forward and A10 clips must be on left side.

Solar panel holders can attach to connectors A OR to side of tower B.

Option #2: If monitor is NOT needed
See Page 2

WHEN DISASSEMBLING ALUMINUM EXTRUSION, TIGHTEN ALL SETSCREWS AND LOCKS TO PREVENT LOSS DURING SHIPPING

Light Connection
 Attach Lights to Backwall where desired and tighten in place.

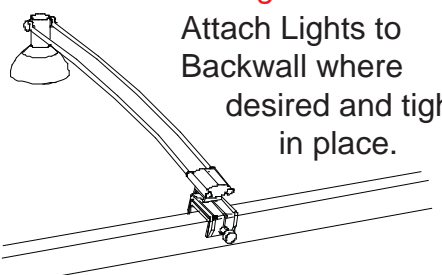

Example of A10 Clamp Attachment

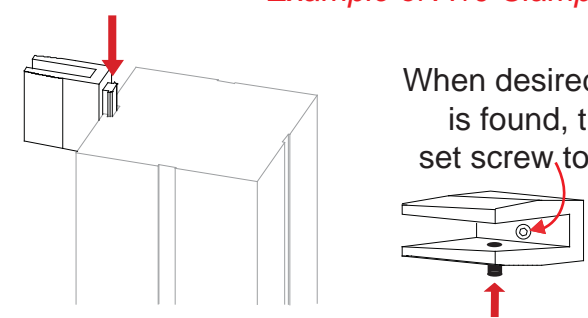

Slide connector on back of A10 clamp into groove of extrusion.

When desired location is found, tighten set screw to secure.

Tighten black plastic set screw to secure panel in place.

Monitor Mount Attachment



Attach back plate of monitor mount to monitor mount attachment plates, secure with screws.

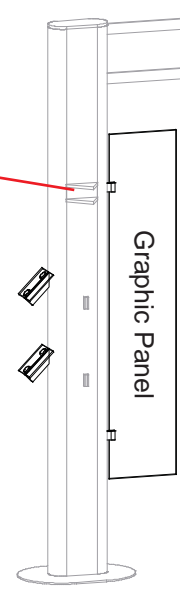

Solar Panel Holder Assembly

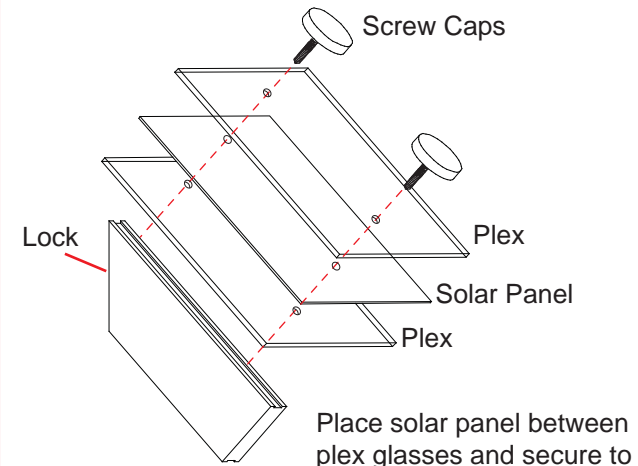

Screw Caps

Lock

Plex

Solar Panel

Plex

Place solar panel between plex glasses and secure to support with screw caps.

WHEN DISASSEMBLING ALUMINUM EXTRUSION, TIGHTEN ALL SETSCREWS AND LOCKS TO PREVENT LOSS DURING SHIPPING

866.652.2100

Setup Instructions:

- A) Use standoff screws to secure the front panel with door and back panel of the pedestal to the side panels.
- B) After assembling front, back, and side panels, slide floor into the bottom of the pedestal. The floor will sit on pins on the inside of the side panels.
- C) After floor is in place, use velcro attachments to install shelf.

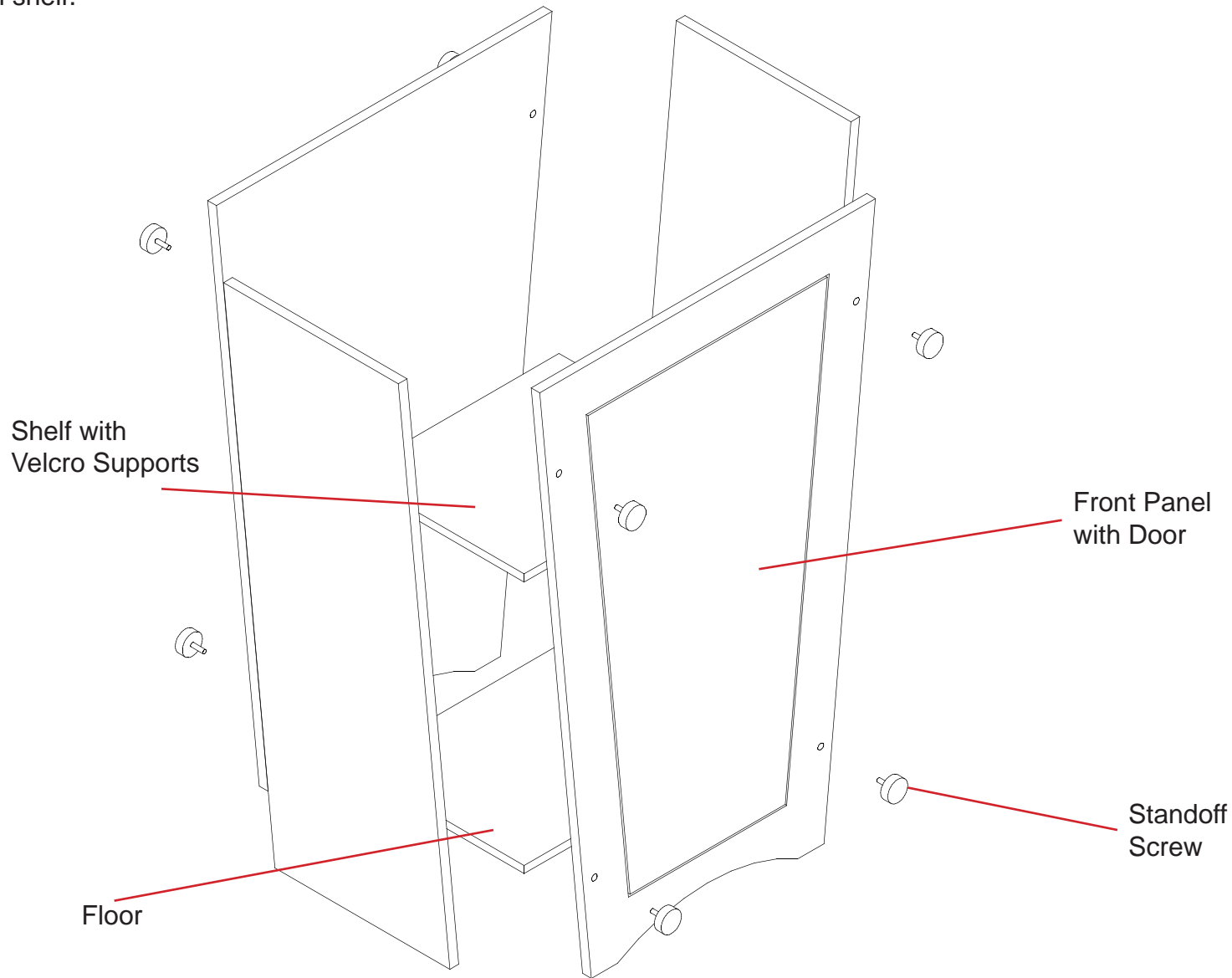
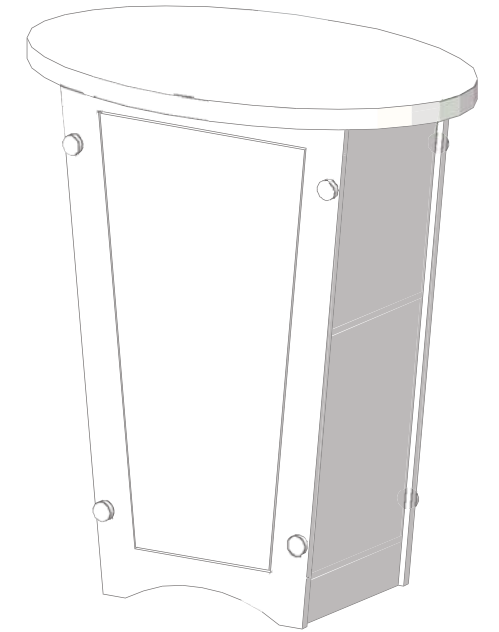

Attach the oval counter top to the pedestal base.

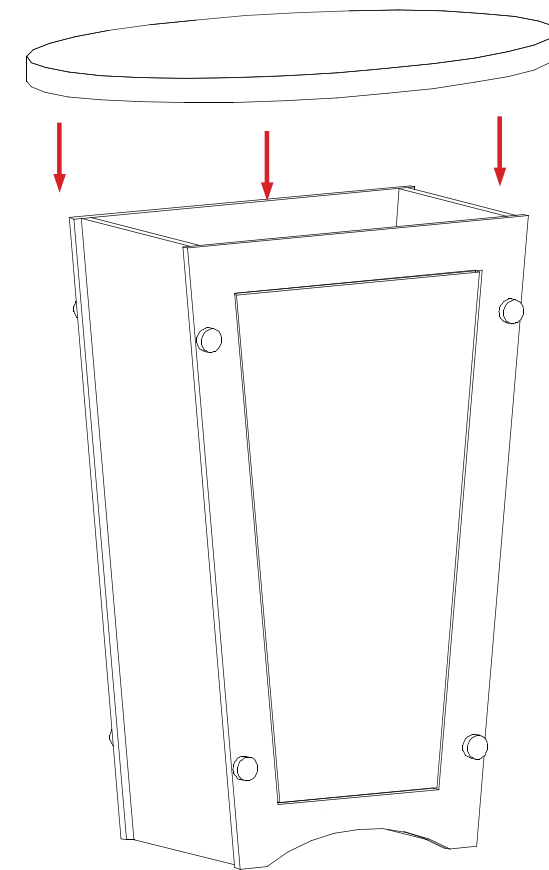

WHEN DISASSEMBLING ALUMINUM EXTRUSION, TIGHTEN ALL SETSCREWS AND LOCKS TO PREVENT LOSS DURING SHIPPING

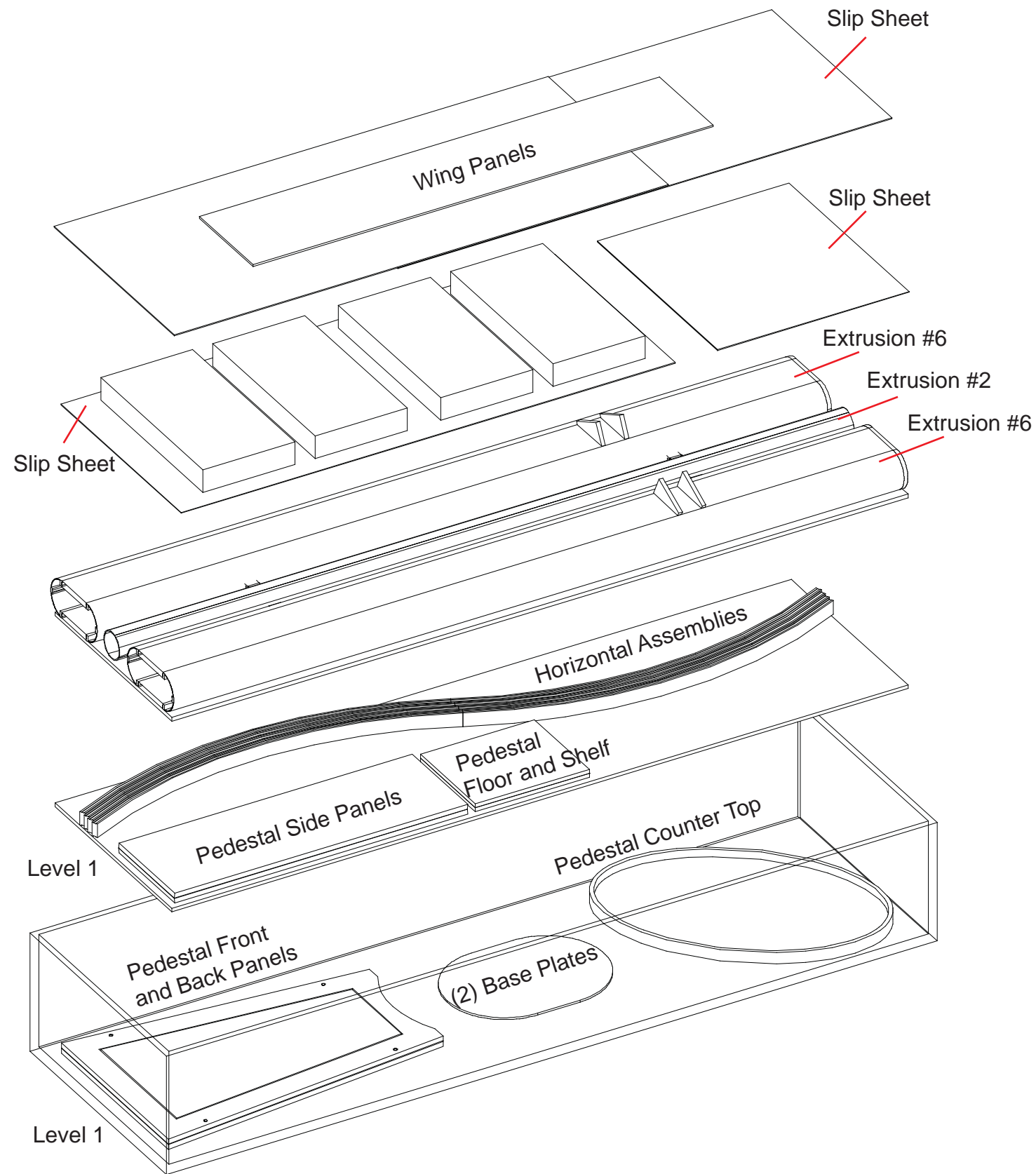

WHEN DISASSEMBLING ALUMINUM EXTRUSION, TIGHTEN ALL SETSCREWS AND LOCKS TO PREVENT LOSS DURING SHIPPING

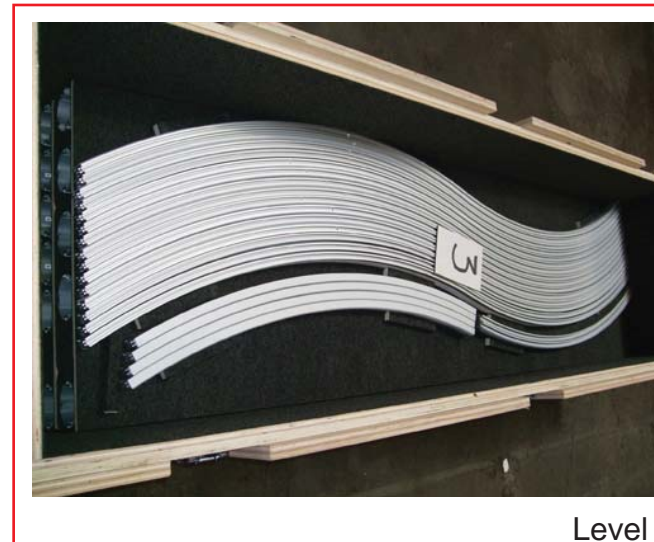
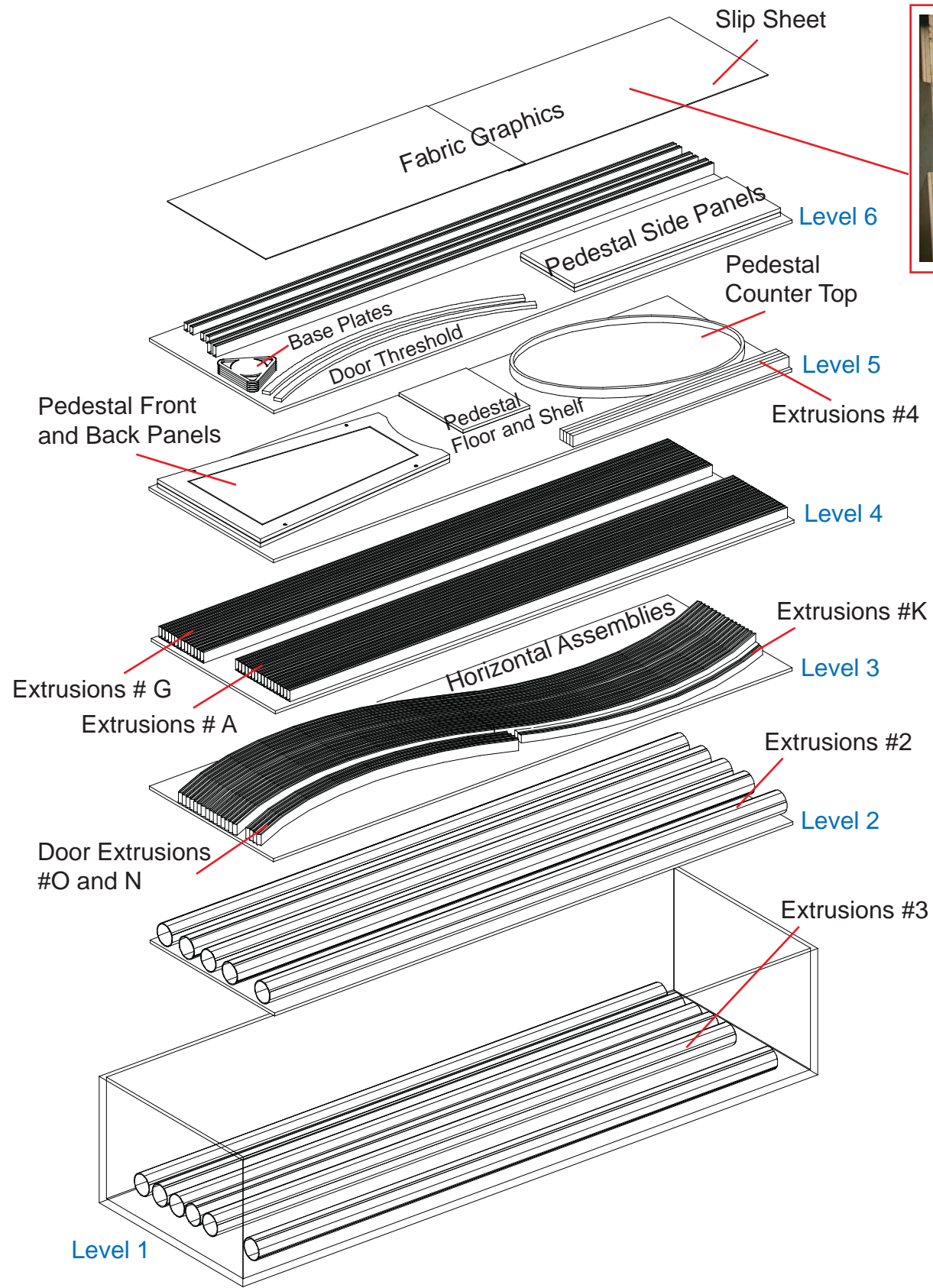

WHEN DISASSEMBLING ALUMINUM EXTRUSION, TIGHTEN ALL SETSCREWS AND LOCKS TO PREVENT LOSS DURING SHIPPING