

Perfect 10 Hybrid Displays

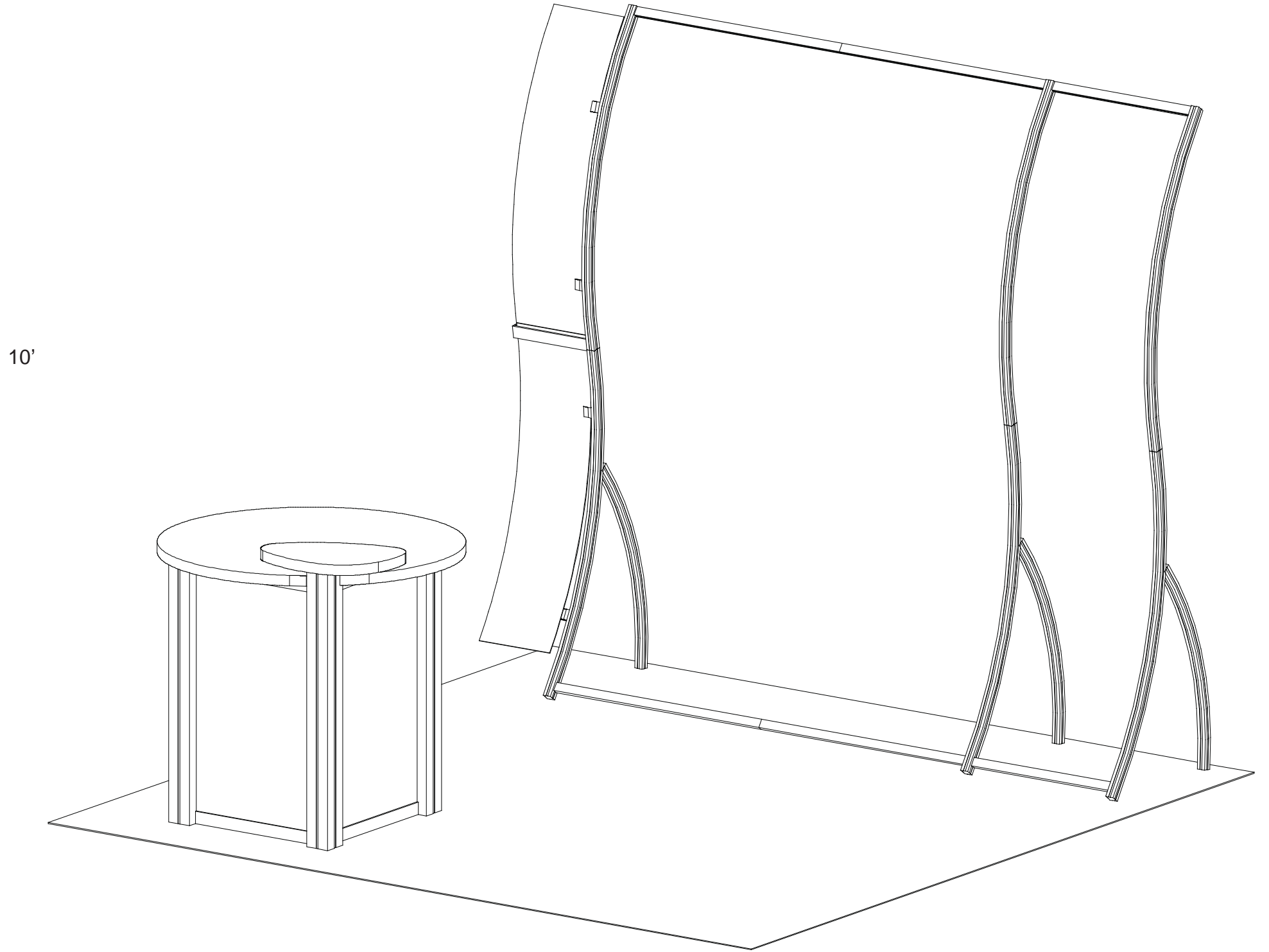
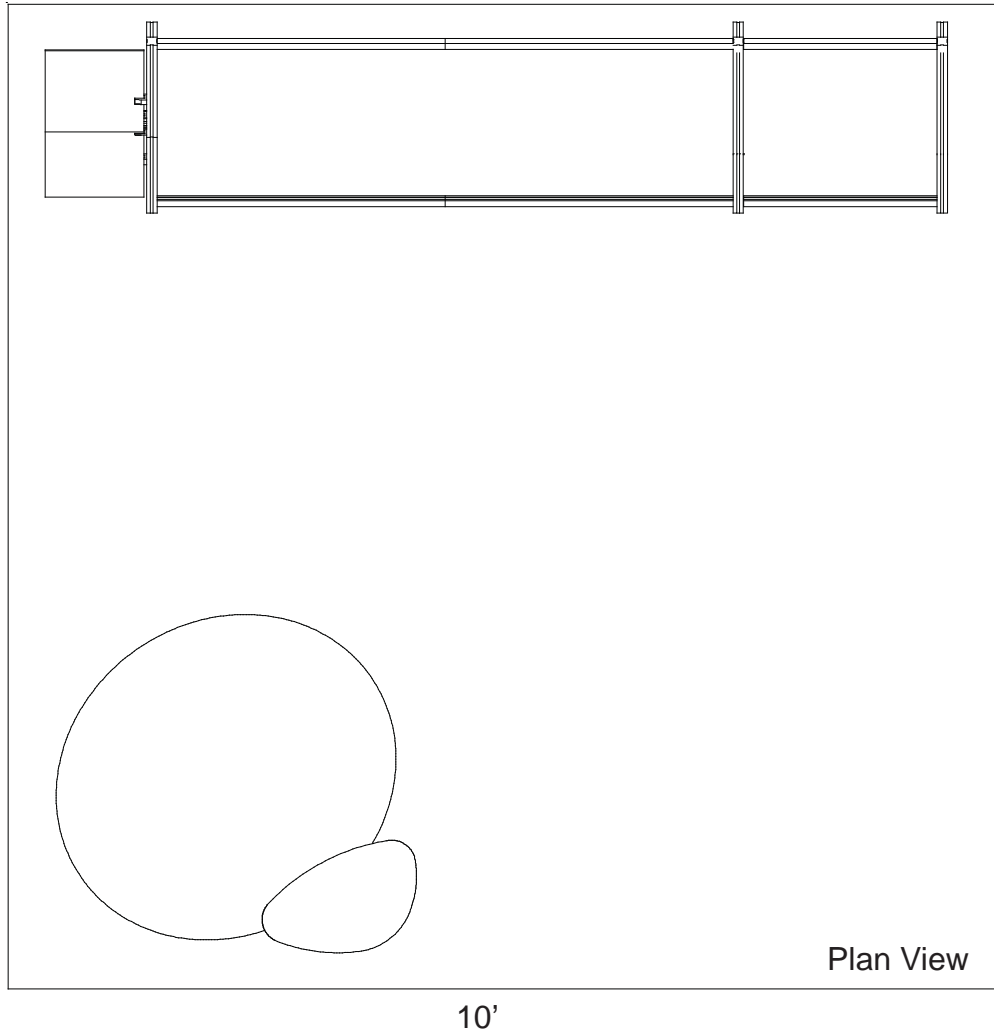

WHEN DISASSEMBLING TIGHTEN ALL KNOBS TO PREVENT LOSS DURING SHIPPING

866.652.2100

Part Number	Description
1	Left Leg Assembly w/ Clamps Attached
2	Middle Leg Assembly
3A	Upper Curved Vertical Clamps Attached
3	Upper Curved Vertical
4	69" w Horizontal

NOTE: When assembling horizontals they should be placed approximately one inch from TOP and BOTTOM.

Step 1

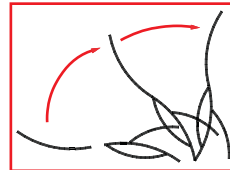
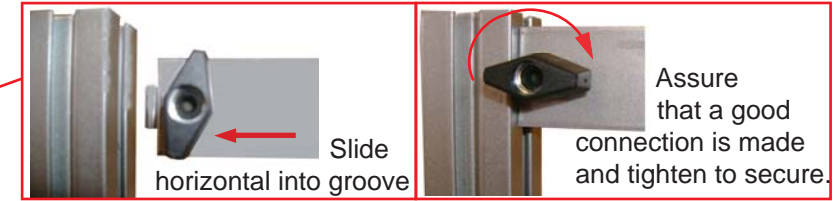

Steps:

NOTE: Can be assembled either face down on floor then lifted upright or upright as shown in drawings.

- A) Connect vertical leg assemblies [1 and 2] together by connecting horizontal extrusions [4] between assemblies tightening BLACK knobs on backside of extrusion making sure Velcro faces toward BACK and placing it about one inch up from bottom and tightening.
- B) Connect vertical extrusions [3 and 3A] to leg assemblies [1 and 2] using vertical connection bar as shown.
- C) Connect upper horizontal extrusion [5] between verticals [3 and 3A] setting bar atop stopper, then attach lower horizontal extrusion [4].

NOTE: Make sure the lock is flush with extrusion before tightening. If lock will not fully engage, gently rock lock and extrusion while turning knob until lock fully opens.

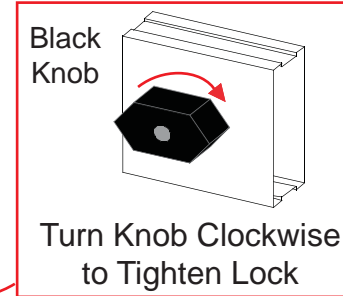
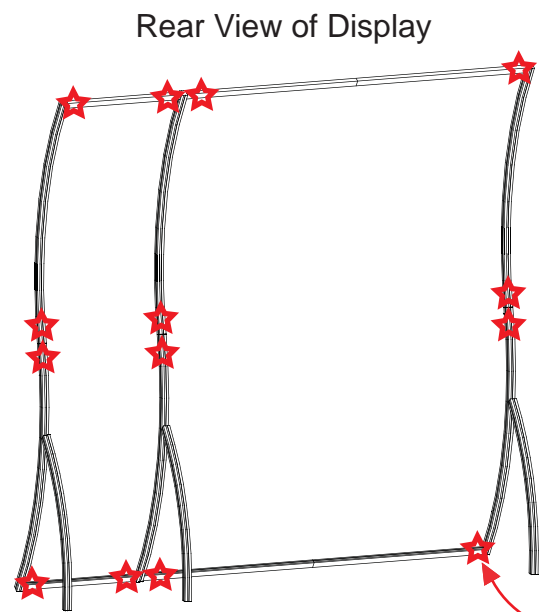
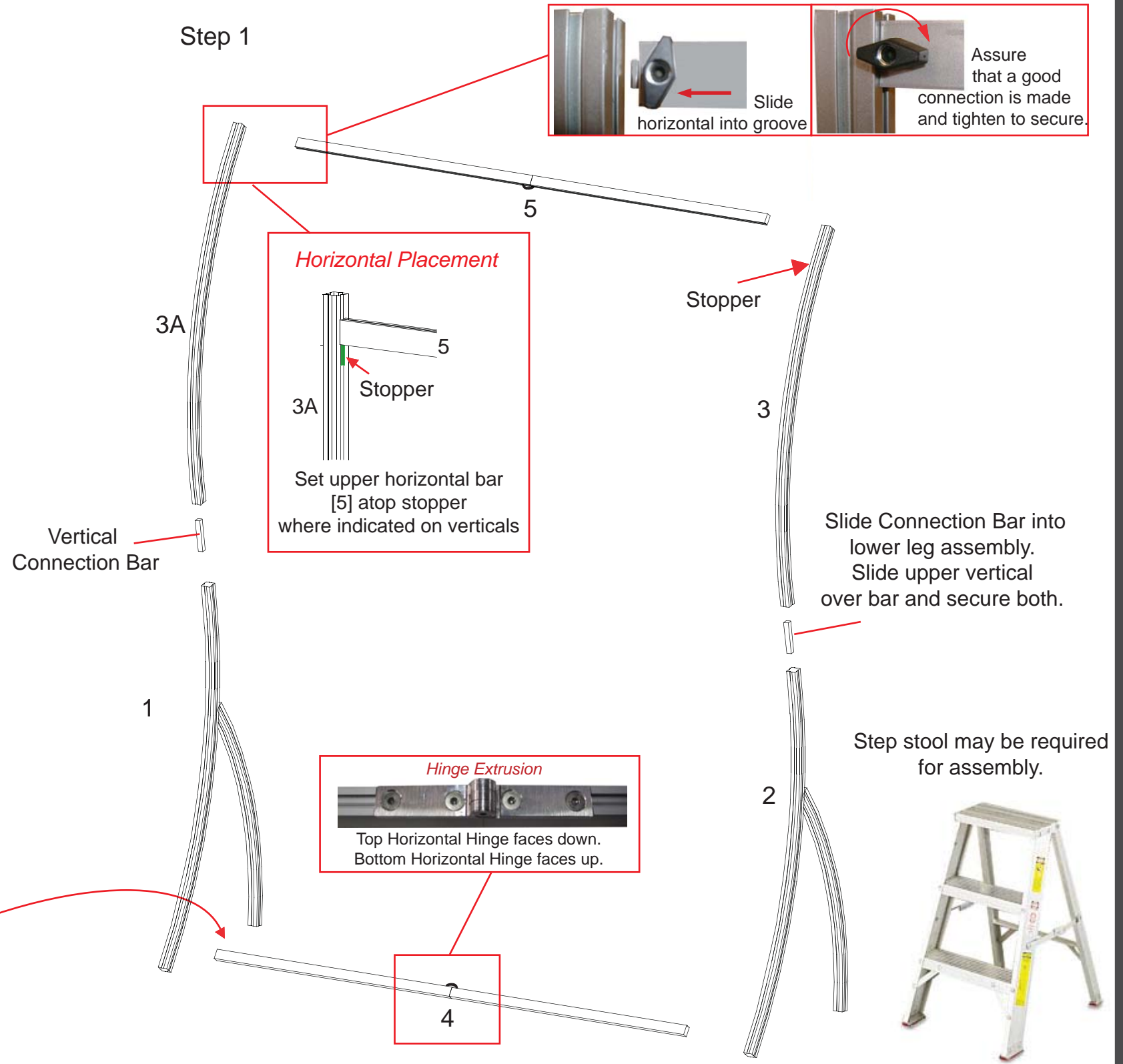

WHEN DISASSEMBLING TIGHTEN ALL KNOBS TO PREVENT LOSS DURING SHIPPING

866.652.2100

Part Number	Description
6	Right Leg Assembly
7	Upper Curved Vertical
8	23" w Horizontal

NOTE: When assembling horizontals they should be placed approximately one inch from TOP and BOTTOM.

Steps:

NOTE: Can be assembled either face down on floor then lifted upright or upright as shown in drawings.

- A) Connect vertical leg assemblies [2 and 6] together by connecting horizontal extrusions [8] between assemblies tightening BLACK knobs on backside of extrusion making sure Velcro faces toward BACK and placing it about one inch up from bottom and tightening.
- B) Connect vertical extrusion [7] to leg assembly [6] using vertical connection bar as shown.
- C) Connect upper horizontal extrusions [8] between verticals [3 and 7] setting bar atop stopper.

NOTE: Make sure the lock is flush with extrusion before tightening. If lock will not fully engage, gently rock lock and extrusion while turning knob until lock fully opens.



Step 1

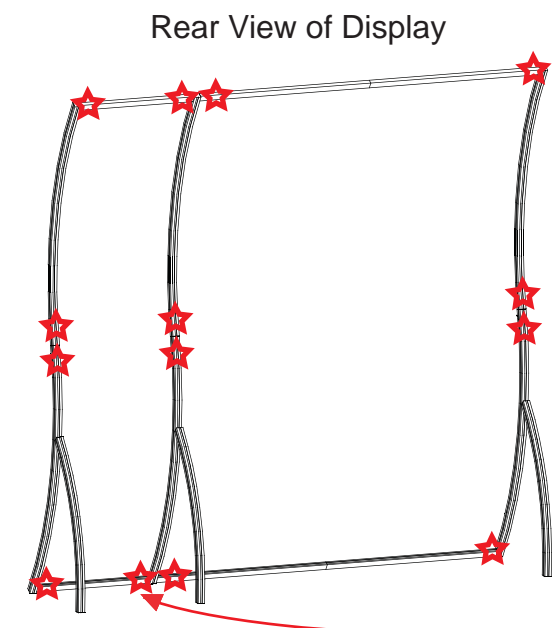
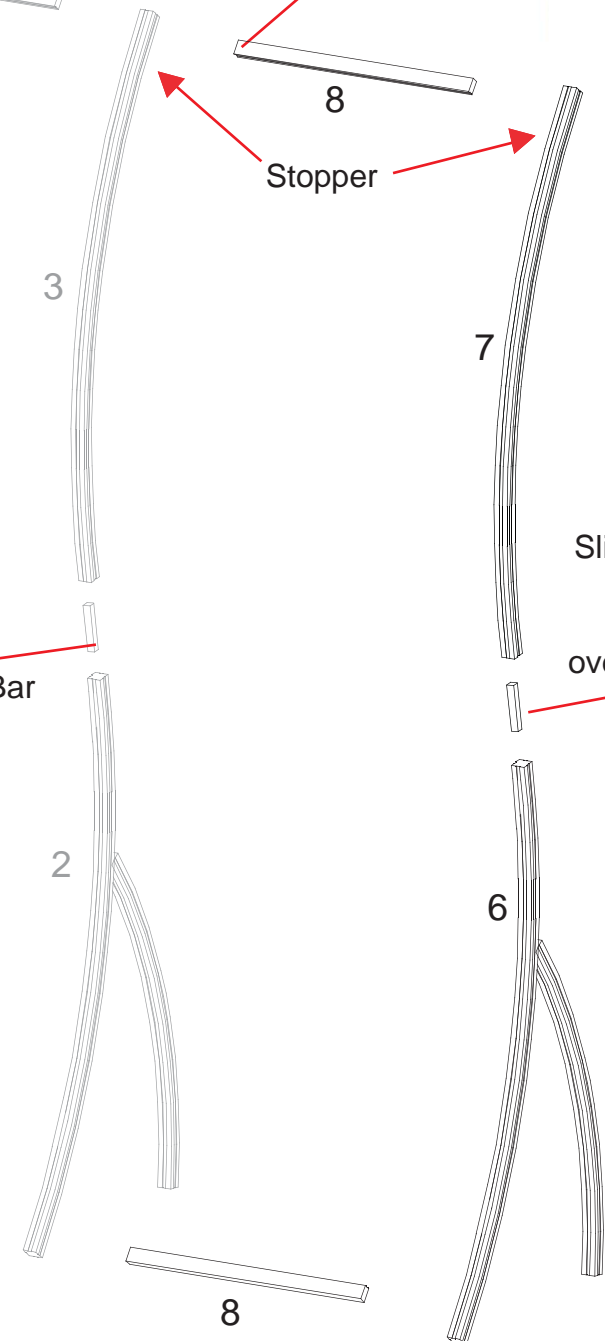
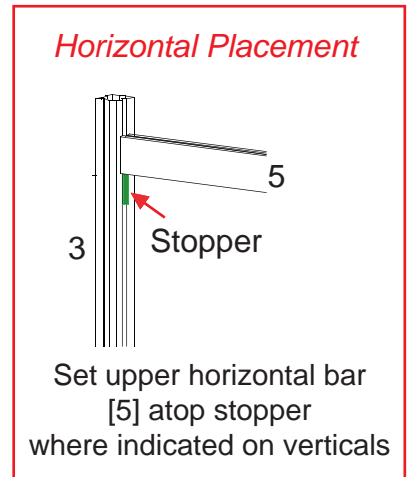
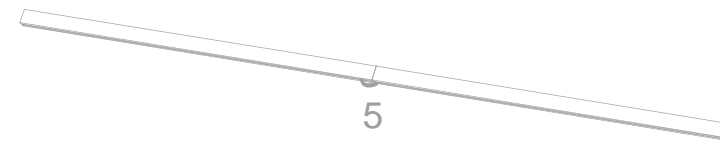

STAR indicates location of knobs on BACKSIDE of unit.

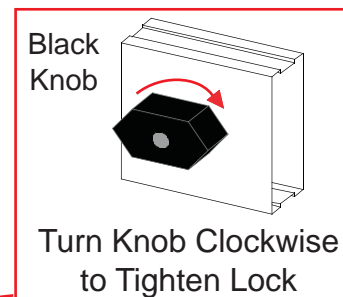

WHEN DISASSEMBLING TIGHTEN ALL KNOBS TO PREVENT LOSS DURING SHIPPING

*Decorative Wing Attachment
(if accidentally removed)*

Slide A10 Clamp into groove
of square extrusion.



A10

When desired location is
found, tighten set screw
to secure.



Setscrew

Tighten black plastic knob
to secure Wing in place.



Black Plastic
knob



WHEN DISASSEMBLING TIGHTEN ALL KNOBS TO PREVENT LOSS DURING SHIPPING

866.652.2100

Item	Quantity	Description
11	1	38" h Vertical Extrusion
12	1	38" h Vertical Extrusion
13	1	38" h Vertical Extrusion
14	1	42" h Vertical Extrusion
14a	1	Plate for Counter Connection
15	2	20" w Horizontal Extrusion
16	2	20" w Horizontal Extrusion
17	2	20" w Horizontal Extrusion
18	2	20" w Horizontal Extrusion
	4	Internal Shelf Support

Steps:

- 1) Connect horizontal extrusions [15 and 16] between vertical extrusions [11, 12, 13 and 14] resting atop stoppers at approximately 4" up from floor to bottom of metal.
- 2) Set floor in place atop lip of horizontal extrusions.
- 3) Place doors and inserts in place as shown.
- 4) Connect horizontal extrusions [17 and 18] between vertical extrusions [11, 12, 13 and 14] and atop inserts and door.
- 5) Velcro shelf supports to inside of pedestal, then set internal shelf atop supports.
- 6) Place counter atop assembled pedestal, attach [14a] to extrusion [3] then connect smaller counter to [14a].

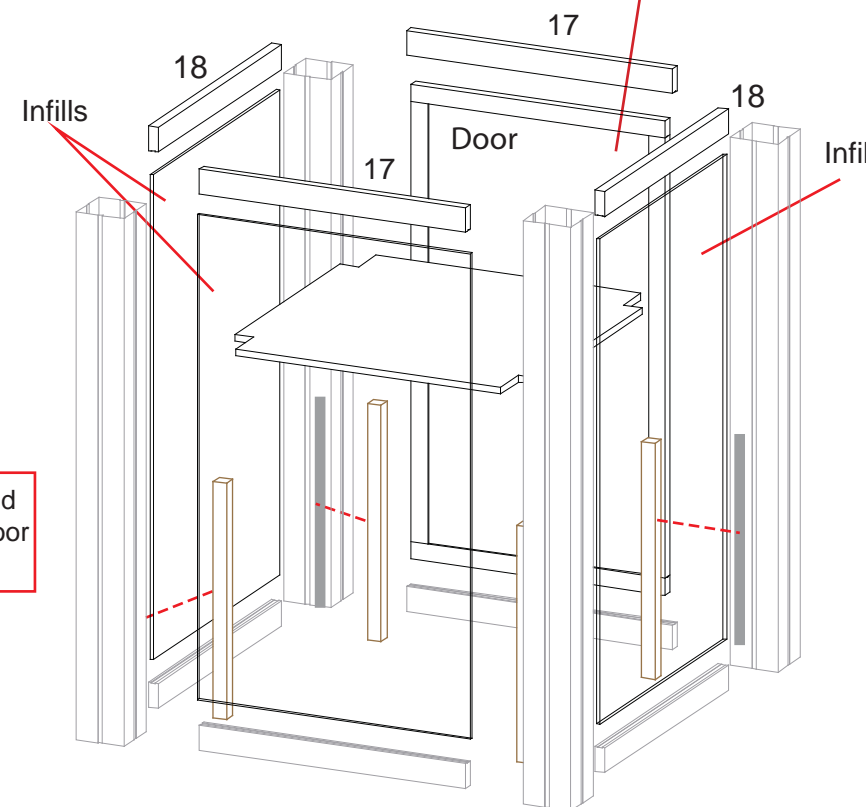
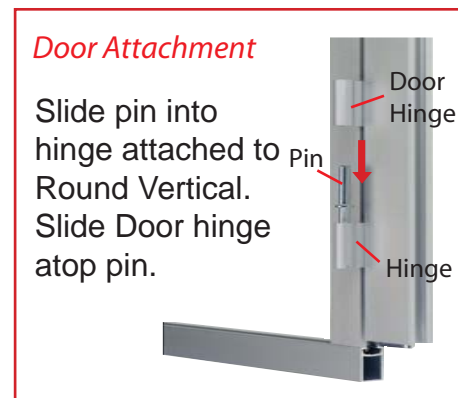
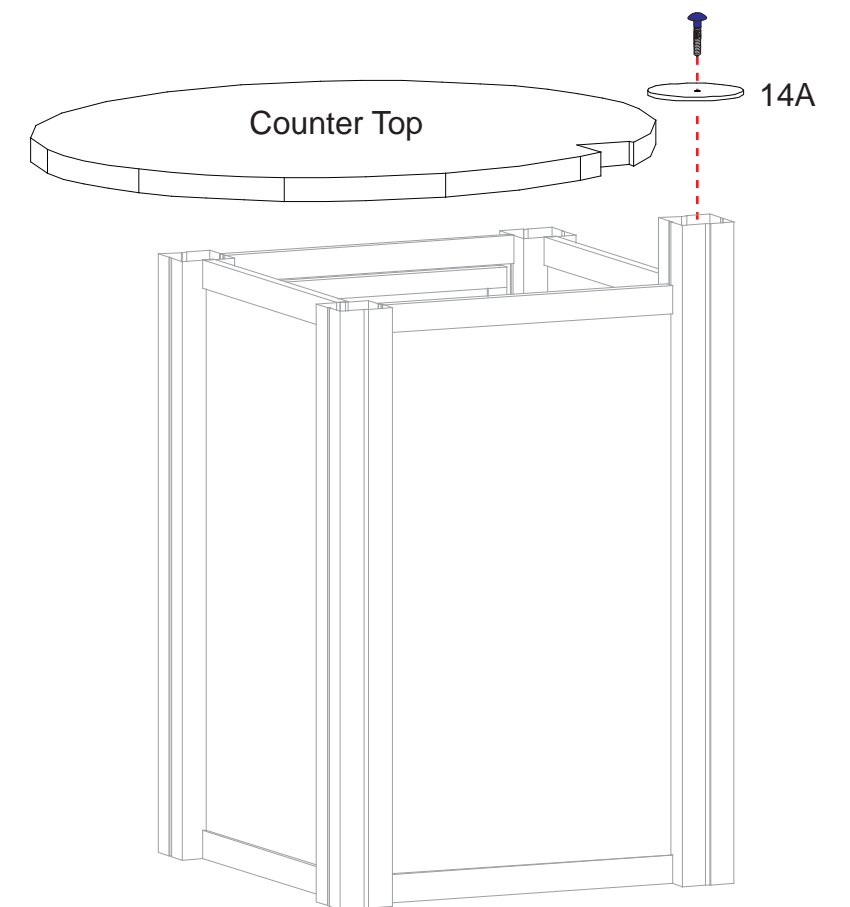
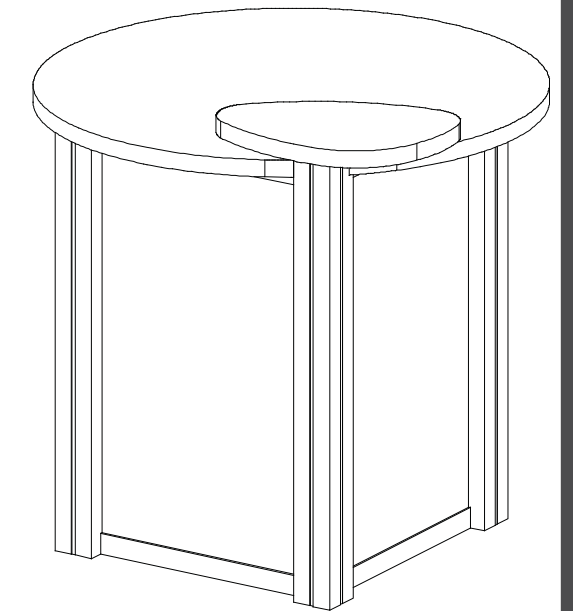

NOTE: TOP SIDE Label needs to be at top of round extrusion.

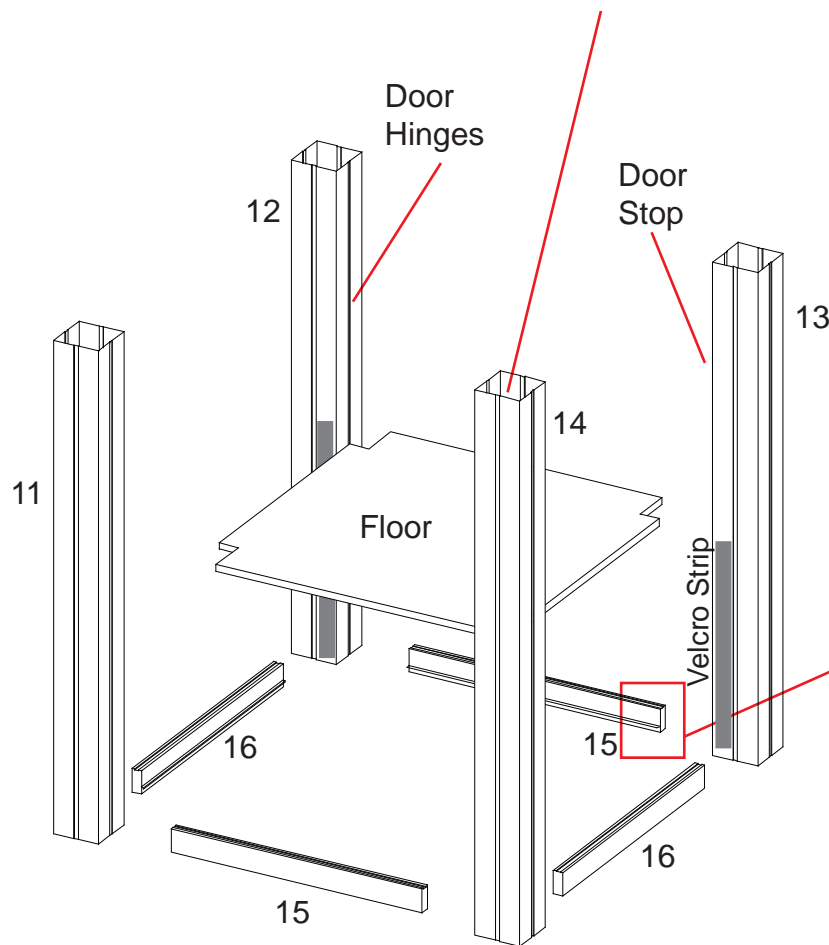

Extrusions 15 and 16 have lip for floor to rest upon.

WHEN DISASSEMBLING TIGHTEN ALL KNOBS TO PREVENT LOSS DURING SHIPPING

Front View of Crate

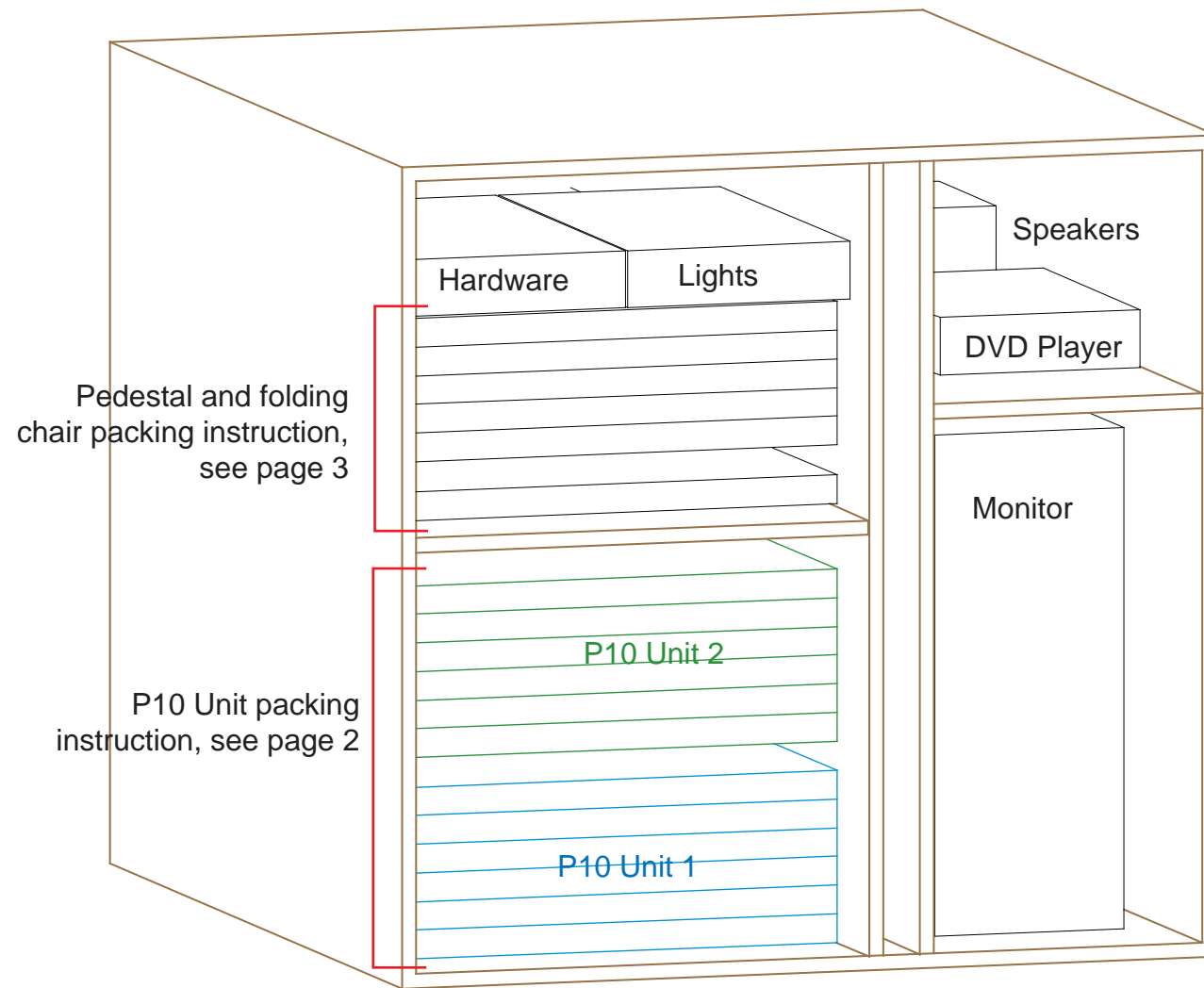

Actual Photo

WHEN DISASSEMBLING TIGHTEN ALL KNOBS TO PREVENT LOSS DURING SHIPPING

P10 unit 2

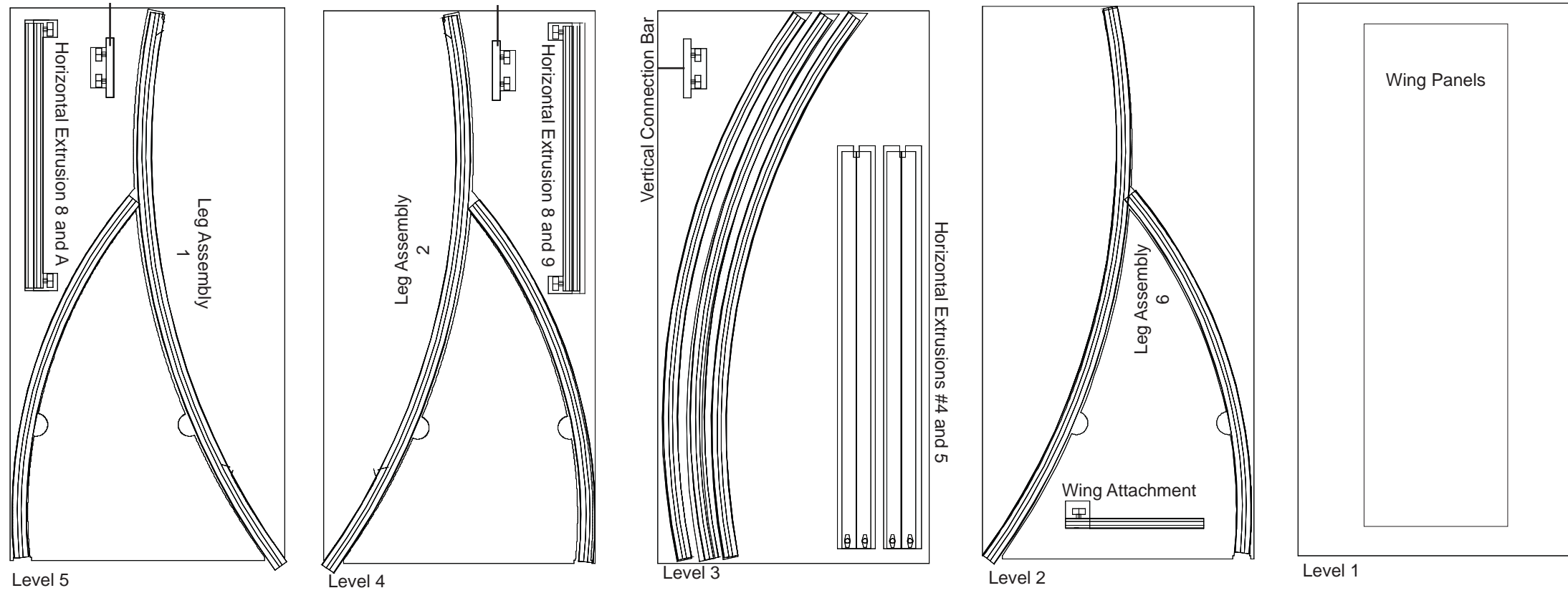

P10 unit 1

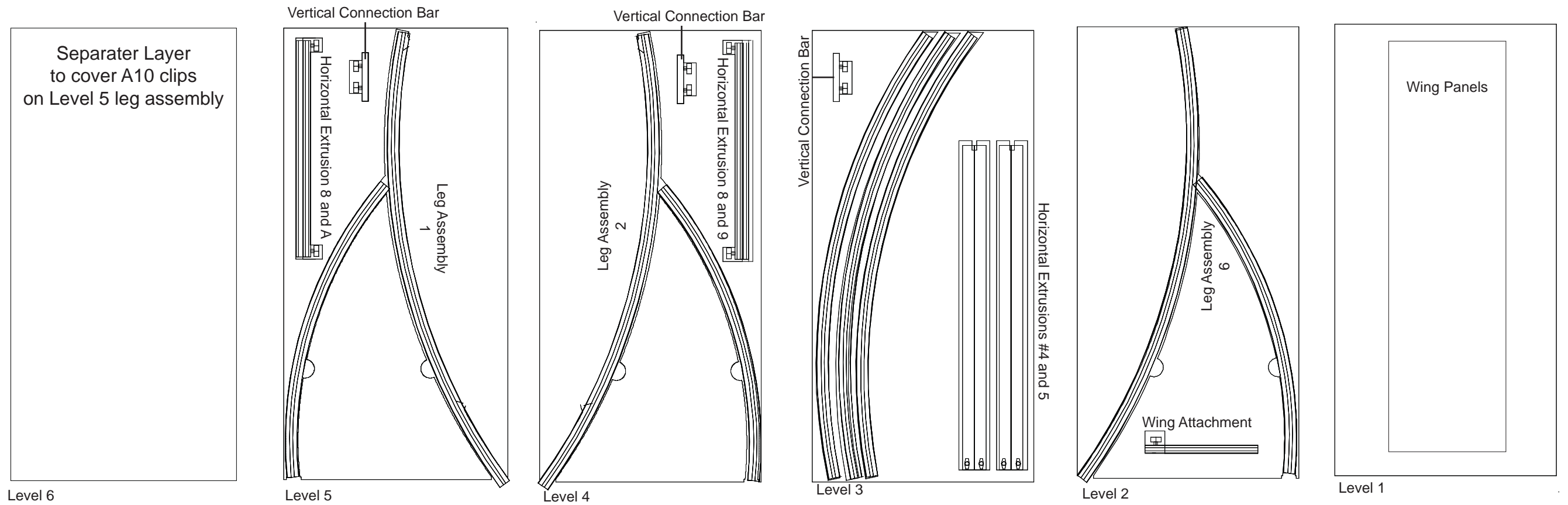

WHEN DISASSEMBLING TIGHTEN ALL KNOBS TO PREVENT LOSS DURING SHIPPING

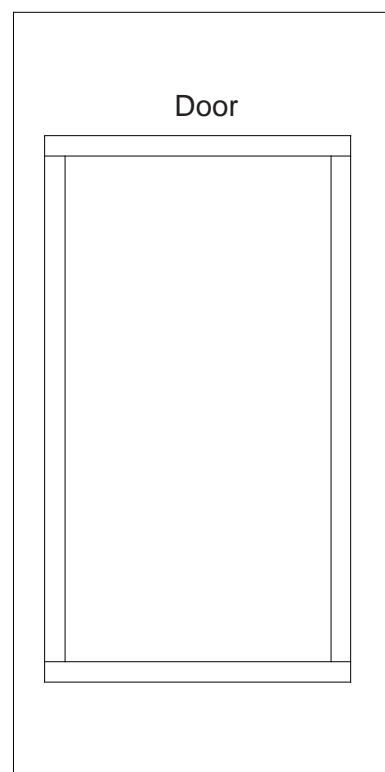

Level 8

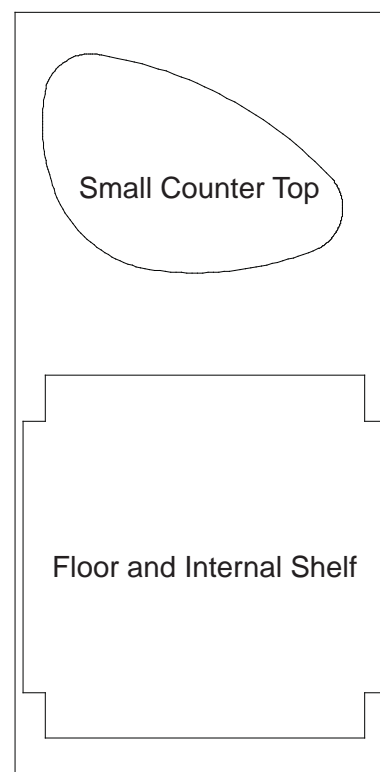

Level 7

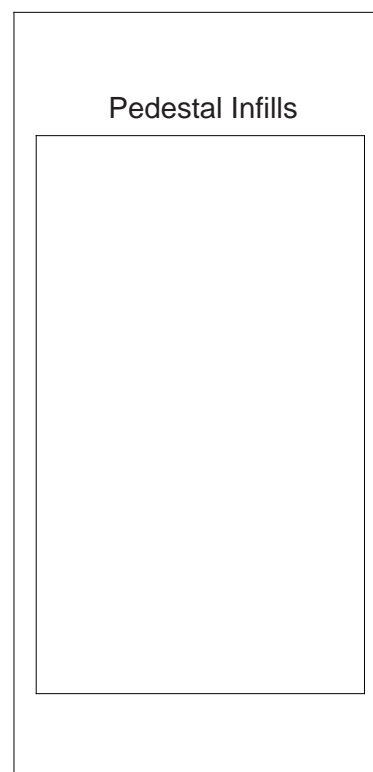

Level 6

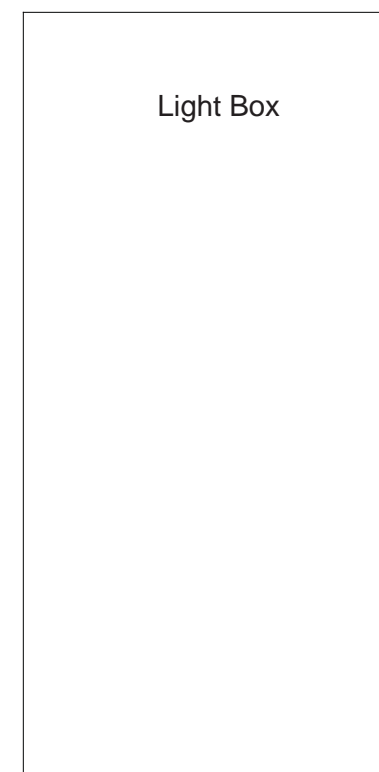

Level 5

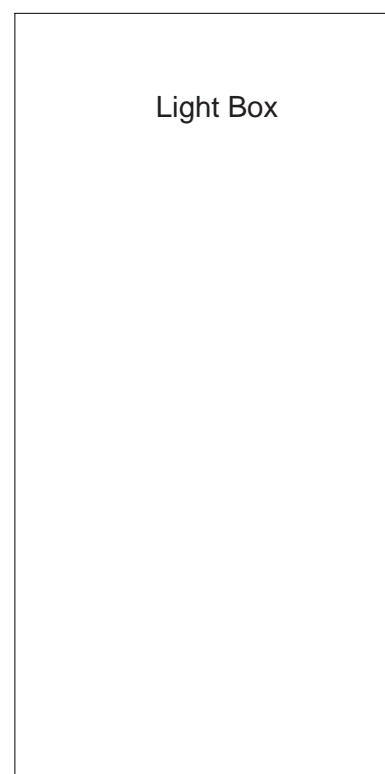

Level 4

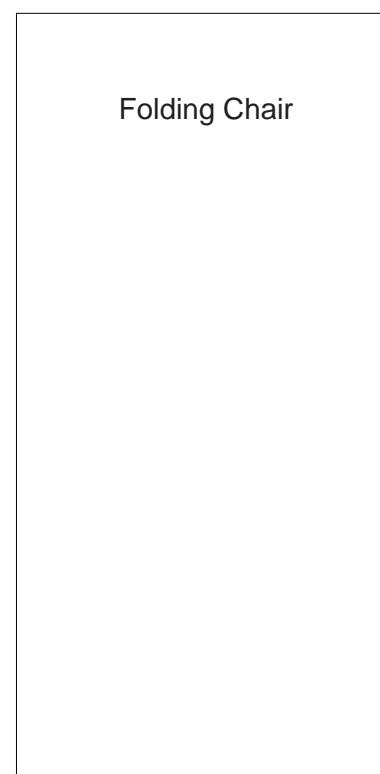

Level 3



Level 2

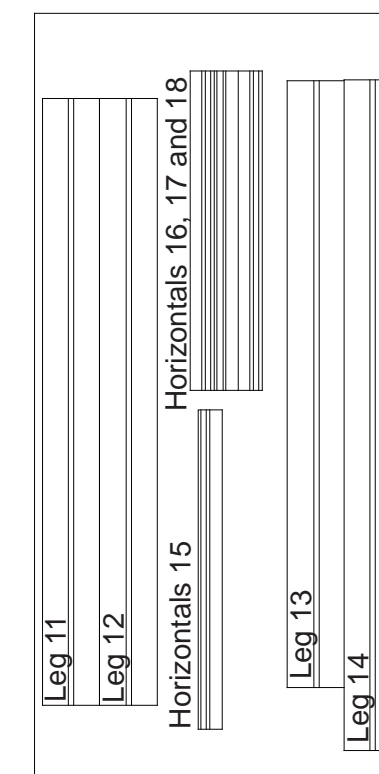

Level 1

WHEN DISASSEMBLING TIGHTEN ALL KNOBS TO PREVENT LOSS DURING SHIPPING