

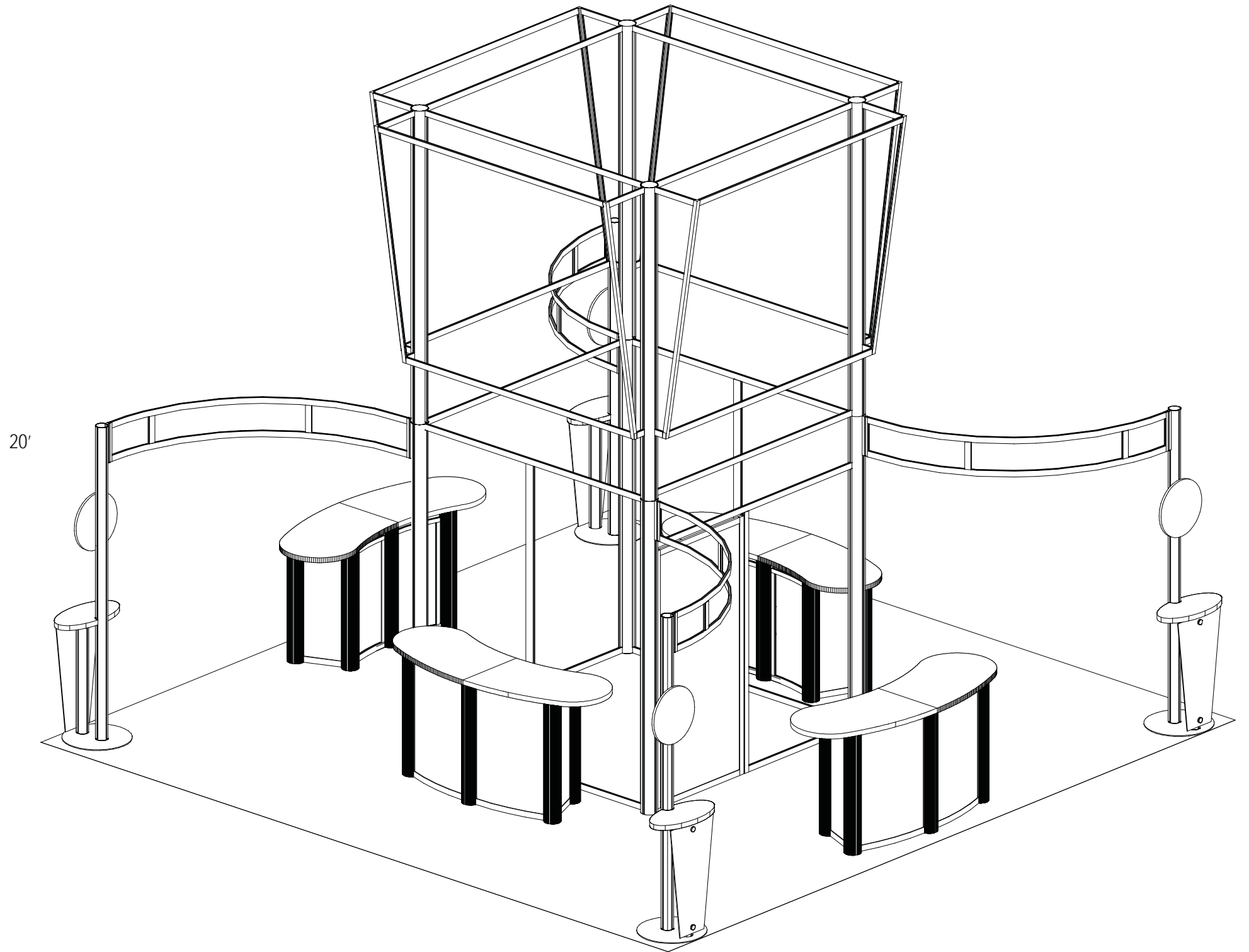

Plan View

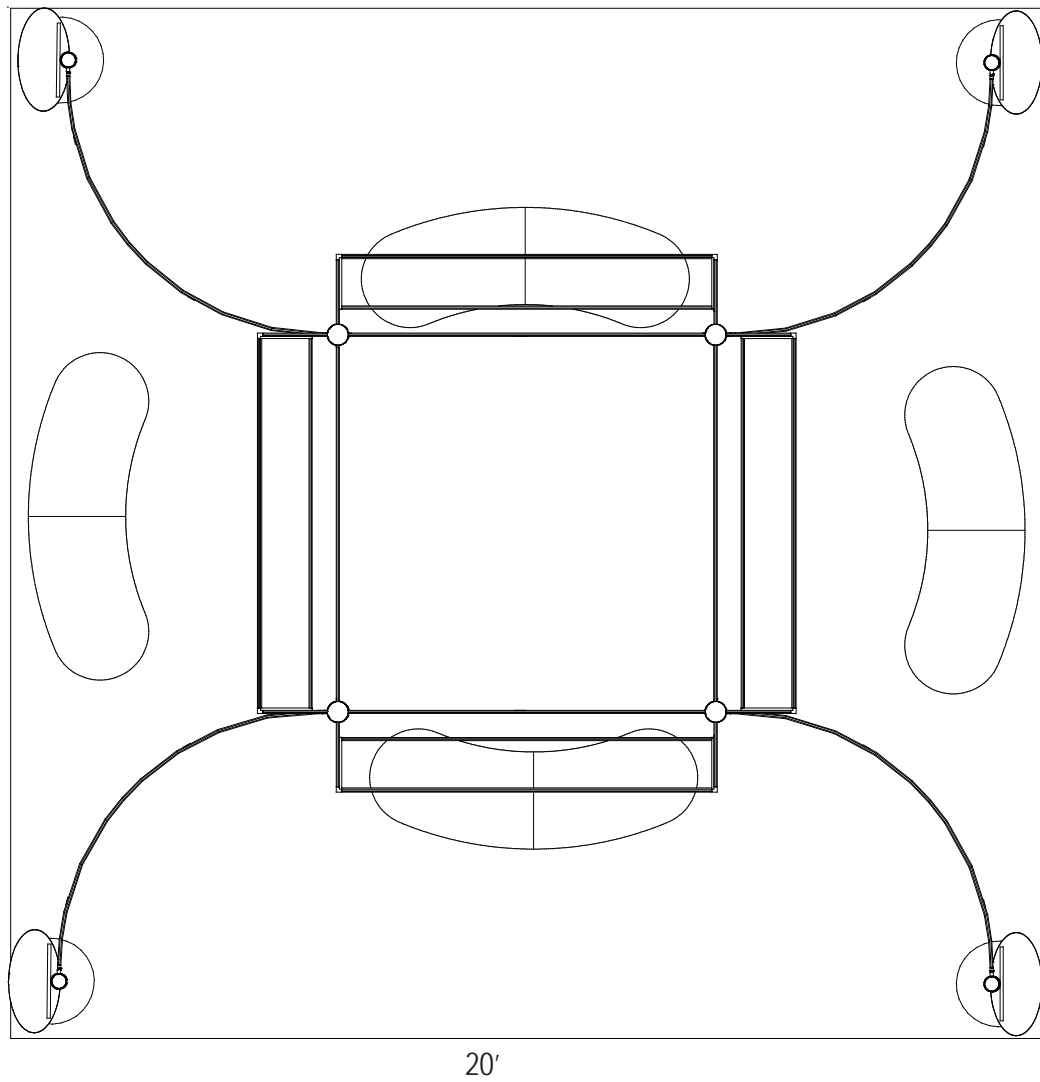

WHEN DISASSEMBLING ALUMINUM EXTRUSION, TIGHTEN ALL SETSCREWS AND LOCKS TO PREVENT LOSS DURING SHIPPING

visionary™ DESIGNS

Using Your Setup Instructions

The Visionary Designs Setup Instructions are created specifically for your configuration. They are laid out sequentially, including an exploded view of the entire display, and then a logical series of detailed steps to assemble the main structure and components. We encourage you to study the instructions **before** attempting to assemble your exhibit.

Each page reminds you to tighten the setscrews after disassembling your exhibit to prevent loss of the locks and setscrews (see below in RED). This is **VERY IMPORTANT**.

Cleaning and Packing Your Display

- 1) Use care when cleaning aluminum extrusion or acrylic inserts. Use only non-abrasive cleaners.
- 2) When cleaning laminate inserts or countertops, use mild cleansers and a soft material such as cotton.
- 3) Keep all display components away from extreme heat and long exposure to sunlight to avoid warping and fading.
- 4) Retain all packing material. It will make re-packing much easier and will reduce the likelihood of shipping damage.



The Tool

Most Visionary Designs exhibits can be assembled with the supplied Hex Key Tool. Occasionally, a flat head screwdriver may be required.



Detail A

Typical Connection



Typical Connection (cont'd)

Most horizontal extrusion connections have a patented expandable lock. This lock inserts into the groove of an opposing extrusion. Tightening the lock with the Hex Key Tool expands the lock and creates a strong positive connection.



Detail B

Numbered Label

Each extrusion contains a numbered label which corresponds with setup instructions. The label is located within a groove of the extrusion (when possible). With Visionary Designs the labels contain Black numbers unless otherwise specified.



Detail C

Horizontal Inline Connection (remove only one setscrew)

Remove only (1) setscrew when disassembling. Replace setscrew in extrusion after assembling it. Before packing, replace setscrew in extrusion to avoid losing it.

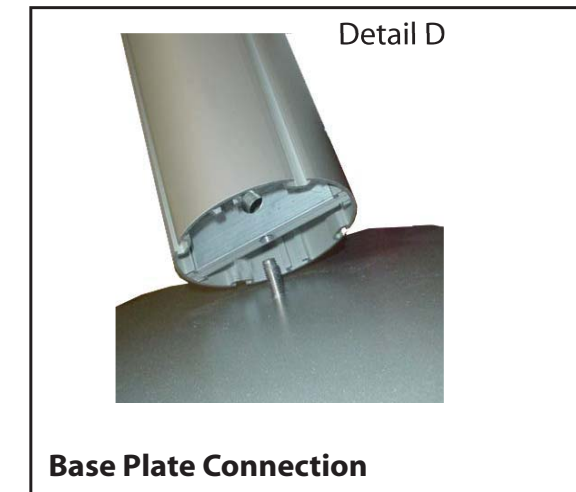

Detail D

Base Plate Connection

Attach base plate to round or square vertical extrusion using the bolt provided. Be careful not to strip the threads.

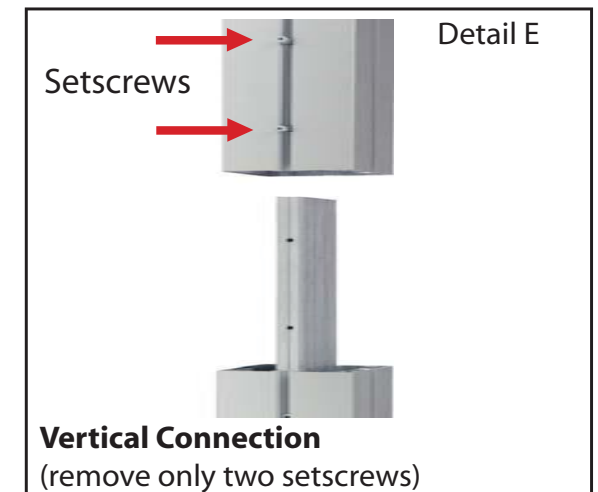

Detail E

Vertical Connection
(remove only two setscrews)

When vertical extrusions are packed in portable cases rather than crates or tubs, they must be broken down into smaller sections which then require assembly.

Remove only (2) setscrews when disassembling. Replace setscrews in extrusion after assembling it. Before packing, replace setscrews in extrusion to avoid losing them.

WHEN DISASSEMBLING ALUMINUM EXTRUSION, TIGHTEN ALL SETSCREWS AND LOCKS TO PREVENT LOSS DURING SHIPPING

866.652.2100

Number	Qty	Description	Number	Qty	Description
1	1	96" h Lower Vertical extrusion	9	7	83" w Horizontal extrusion
2	1	96" h Upper Vertical extrusion	10	4	83" w Horizontal extrusion
3	1	96" h Lower Vertical extrusion	11	1	83" w Horizontal extrusion
4	1	96" h Upper Vertical extrusion	12	1	43.662" w Horizontal extrusion
5	1	96" h Lower Vertical extrusion	13	1	80" h Vertical Extrusion
6	1	96" h Upper Vertical extrusion	14	2	92.418" h Vertical Extrusion
7	1	96" h Lower Vertical extrusion			
8	1	96" h Upper Vertical extrusion			

#9, 11 and 12 have Velcro attached to face for graphic attachment
 ** Velcro must face outward of tower **

Steps:

- 1) Attach door threshold to bottom of verticals [5 and 13] as shown.
- 2) Attach upper verticals [2, 4, 6, and 8] atop lower verticals [1, 3, 5, and 7].
- 3) Connect lower horizontal extrusions [9 and 12] between vertical assemblies [1/2, 3/4, 5/6, and 7/8], see Top View illustration for extrusion orientation.
- 4) Attach door where indicated.
- 5) Slide Lower L-extrusions into groove of extrusions where indicated. (Note: These actually should ship attached to verticals)
- 6) Connect middle horizontals [10 and 11] between vertical assemblies [1/2, 3/4, 5/6, and 7/8] and atop door.
- 7) Slide Upper L-extrusions into groove of extrusions where indicated. (Note: These actually should ship attached to verticals)
- 8) Attach remaining horizontal extrusions [9 and 10] between vertical assemblies [1/2, 3/4, 5/6, and 7/8].

* Attach monitor mount where indicated **AFTER** graphics are installed

** Attach door threshold to verticals as shown first **

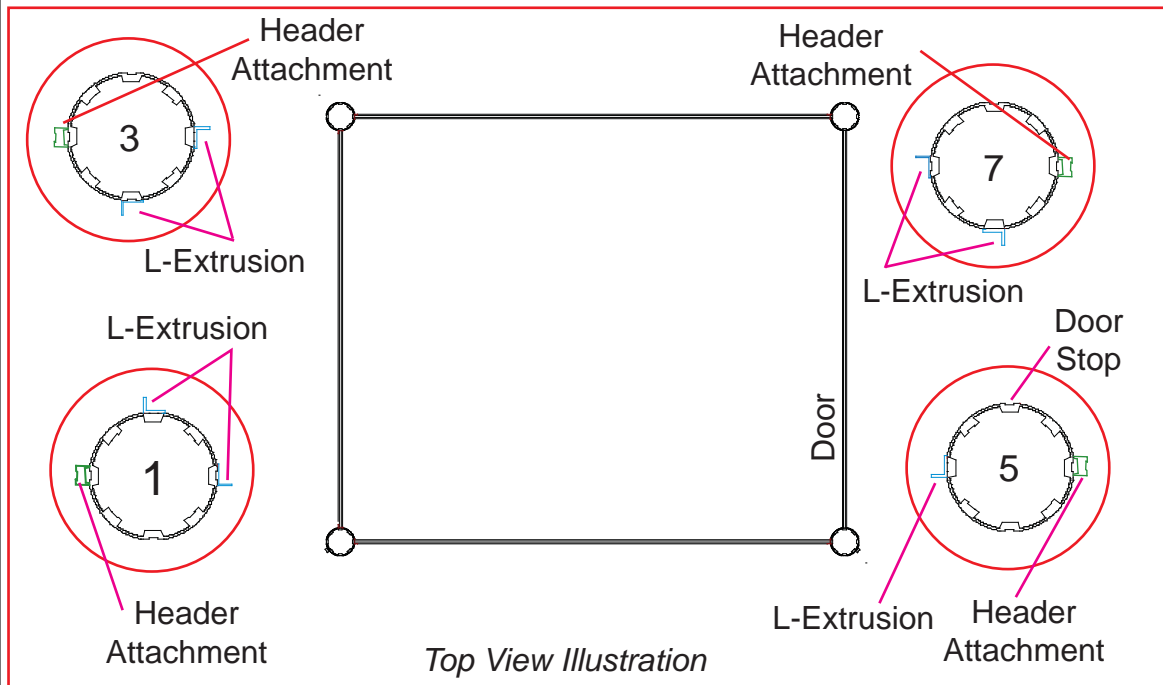

Header Attachment

Header Attachment

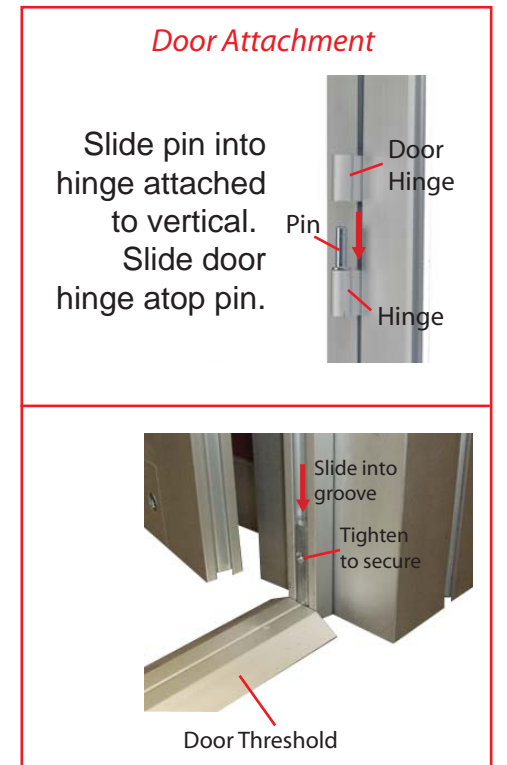
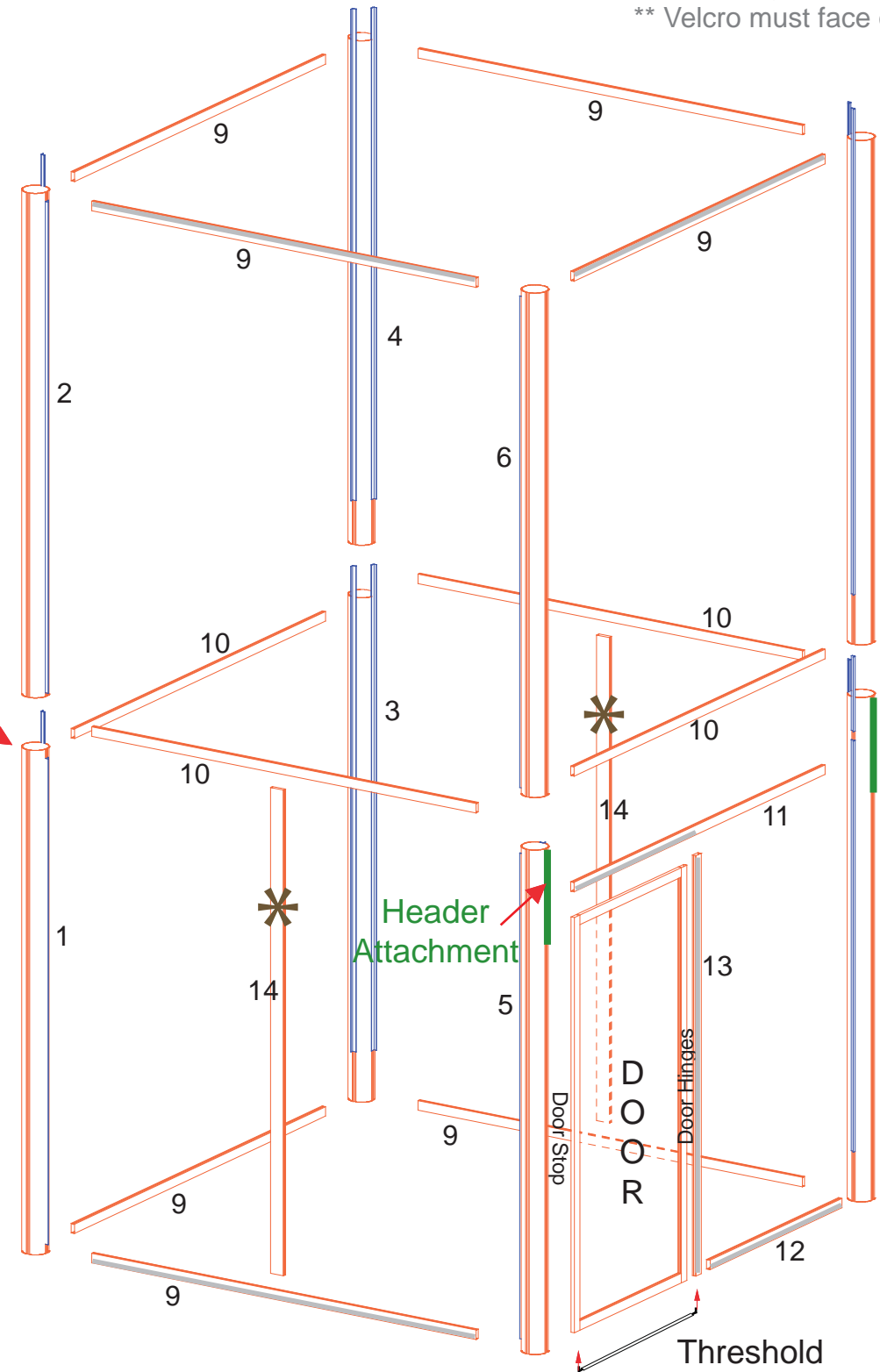

WHEN DISASSEMBLING ALUMINUM EXTRUSION, TIGHTEN ALL SETSCREWS AND LOCKS TO PREVENT LOSS DURING SHIPPING

Note: Attaching Graphics
Attach large graphics to all 4 sides of tower by attaching to face of upper horizontals, sides and lower horizontals and around conference door.

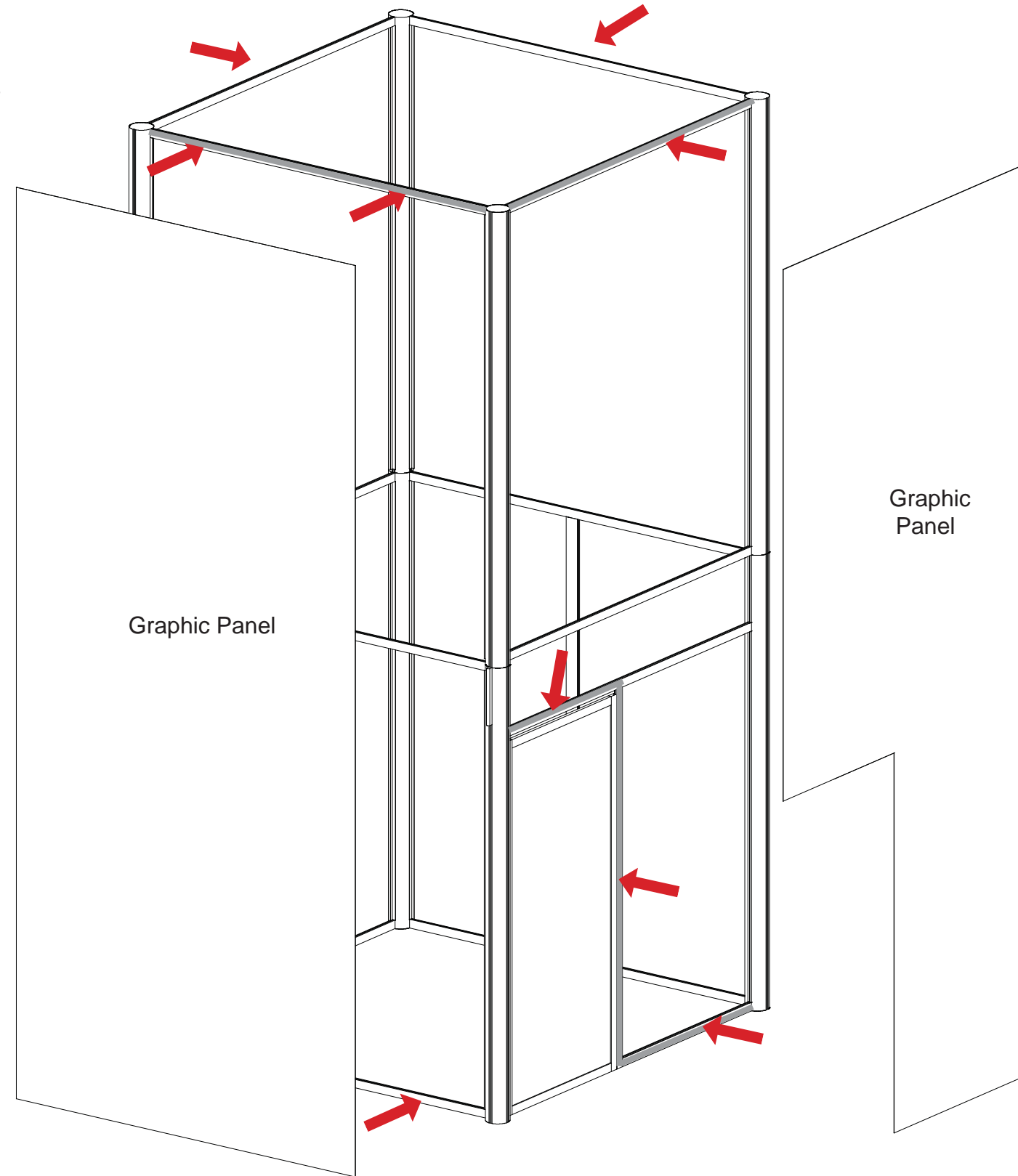

WHEN DISASSEMBLING ALUMINUM EXTRUSION, TIGHTEN ALL SETSCREWS AND LOCKS TO PREVENT LOSS DURING SHIPPING

Part List per Frame

Part Number	Qty	Description
15	2	3.244"w Horizontal Extrusion w/ Mitre Cut One End
15a	2	15"w Horizontal Extrusion w/ Mitre Cut One End
15b	2	86.0727"w Horizontal Extrusion
16a	1	76.948" Left Corner Extrusion
16b	1	76.948" Right Corner Extrusion

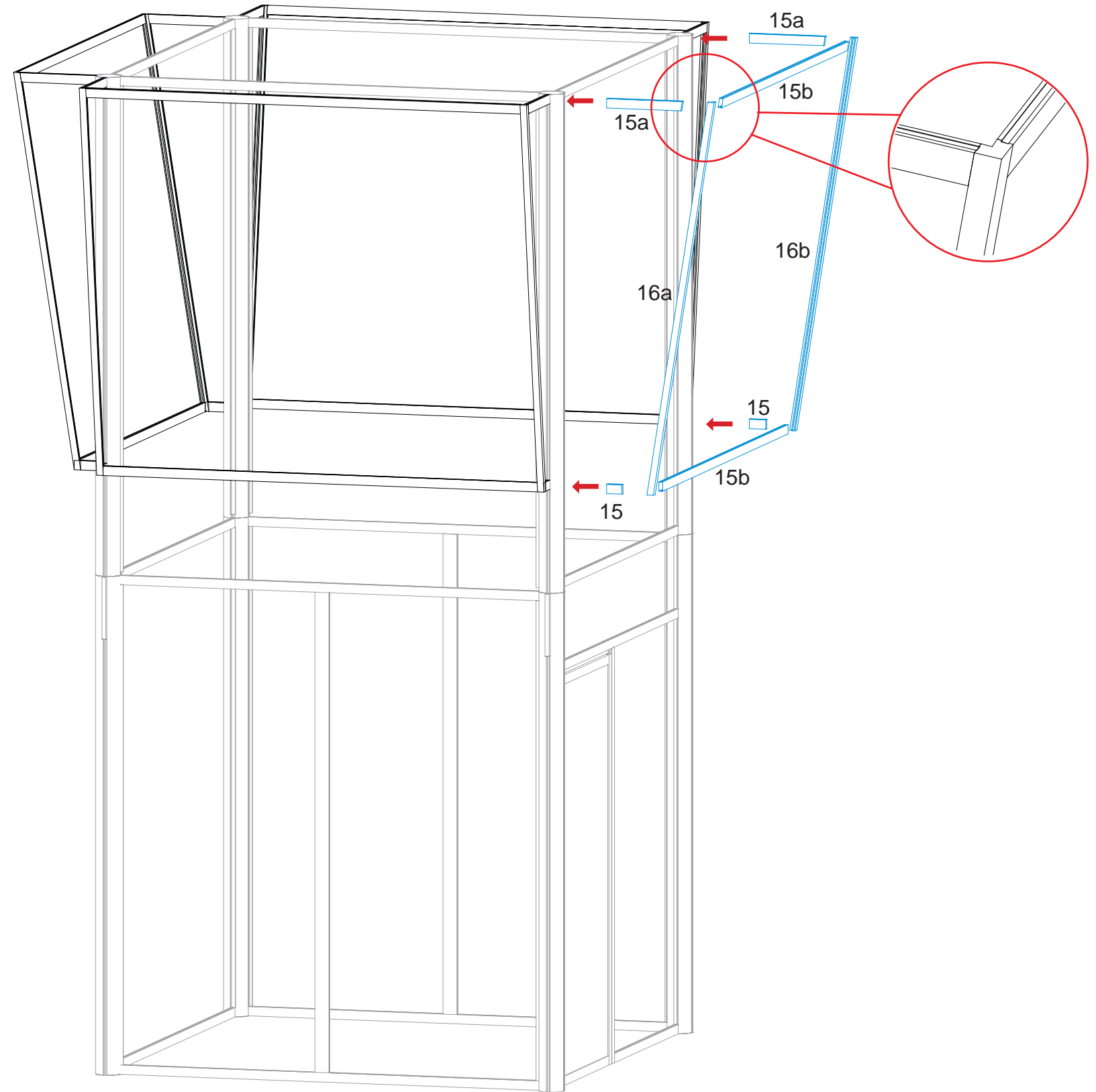
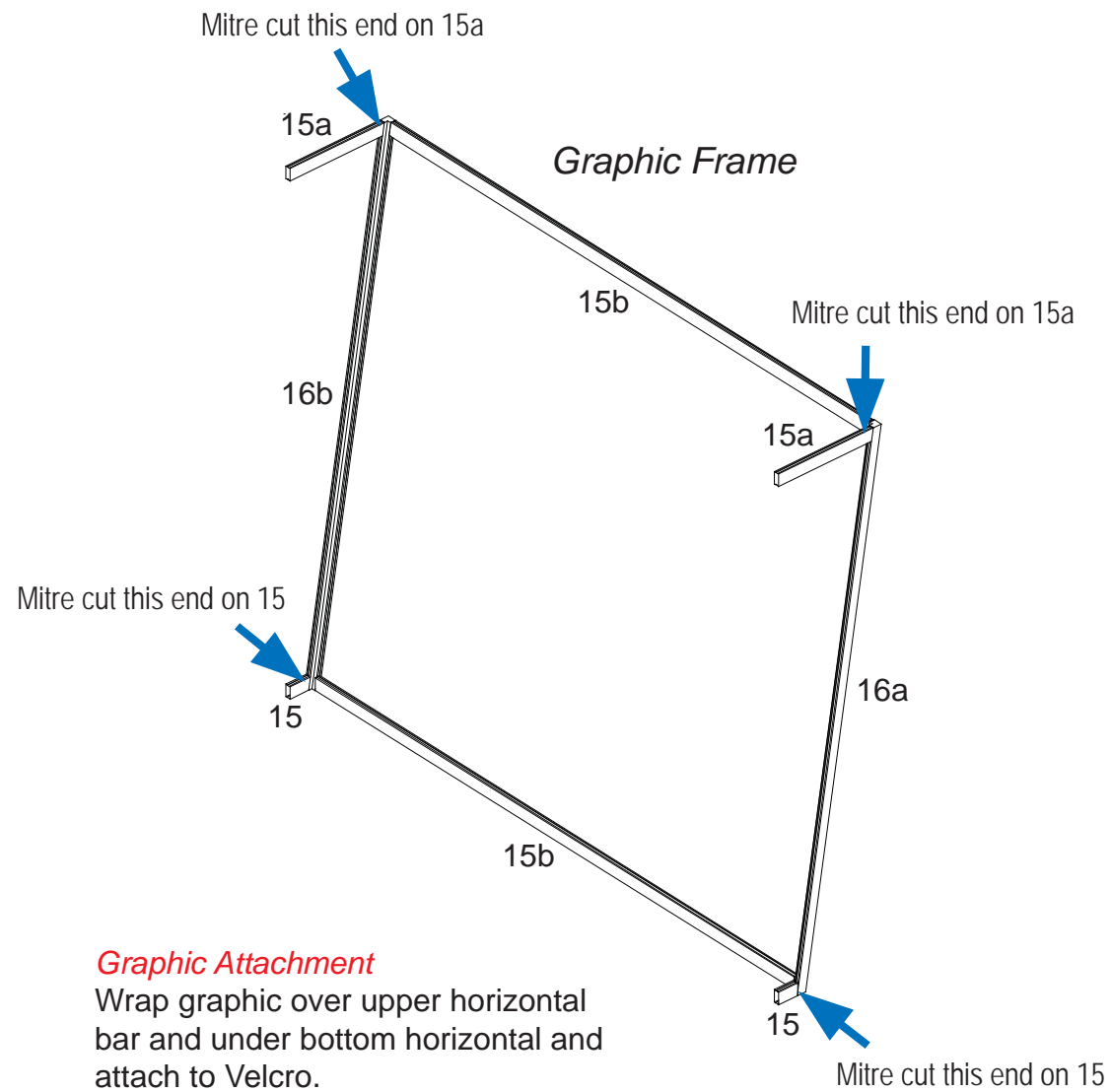

WHEN DISASSEMBLING ALUMINUM EXTRUSION, TIGHTEN ALL SETSCREWS AND LOCKS TO PREVENT LOSS DURING SHIPPING

Part Number	Qty for Step	Description
17	1	18"D Round Base Plate
18	1	95"h Round Vertical Extrusion
19	1	36"h Round Vertical Extrusion

Repeat Steps for All 4 Workstations.
 (Note: Workstations should ship assembled.)

Steps

- 1) Attach vertical extrusions [18 and 19] to base plate [17] as shown.
- 2) Attach tapered plex wings to front of vertical extrusion [19] and round signs to vertical extrusion [18].
- 3) Place and attach counter atop vertical extrusion [19].

*** Monitor Mount Attachment**

Slide mounting connector pieces into groove of extrusion. Tighten setscrew to secure in place.

Attach back plate to connectors on vertical extrusion using screws. Then attach top plate and tighten setscrews to secure.

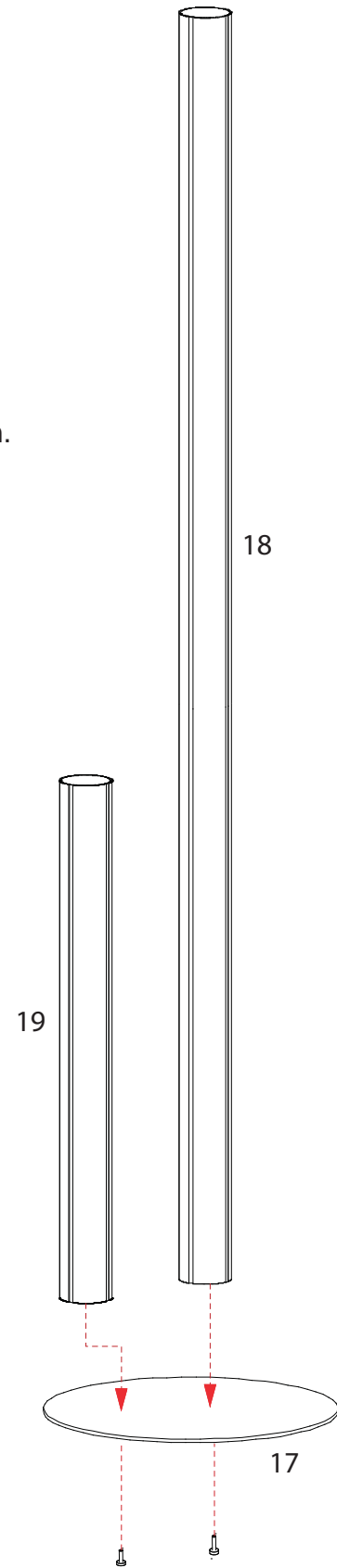

Sign Attachment

Slide stand off barrels to groove of back wall extrusion

Secure Sign to stand off barrel using stand off cap

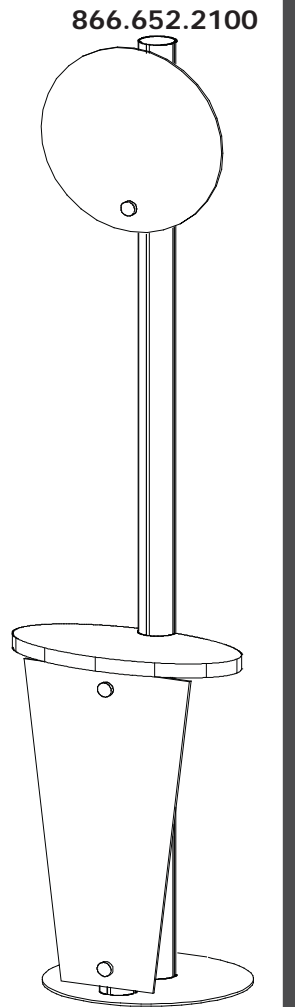
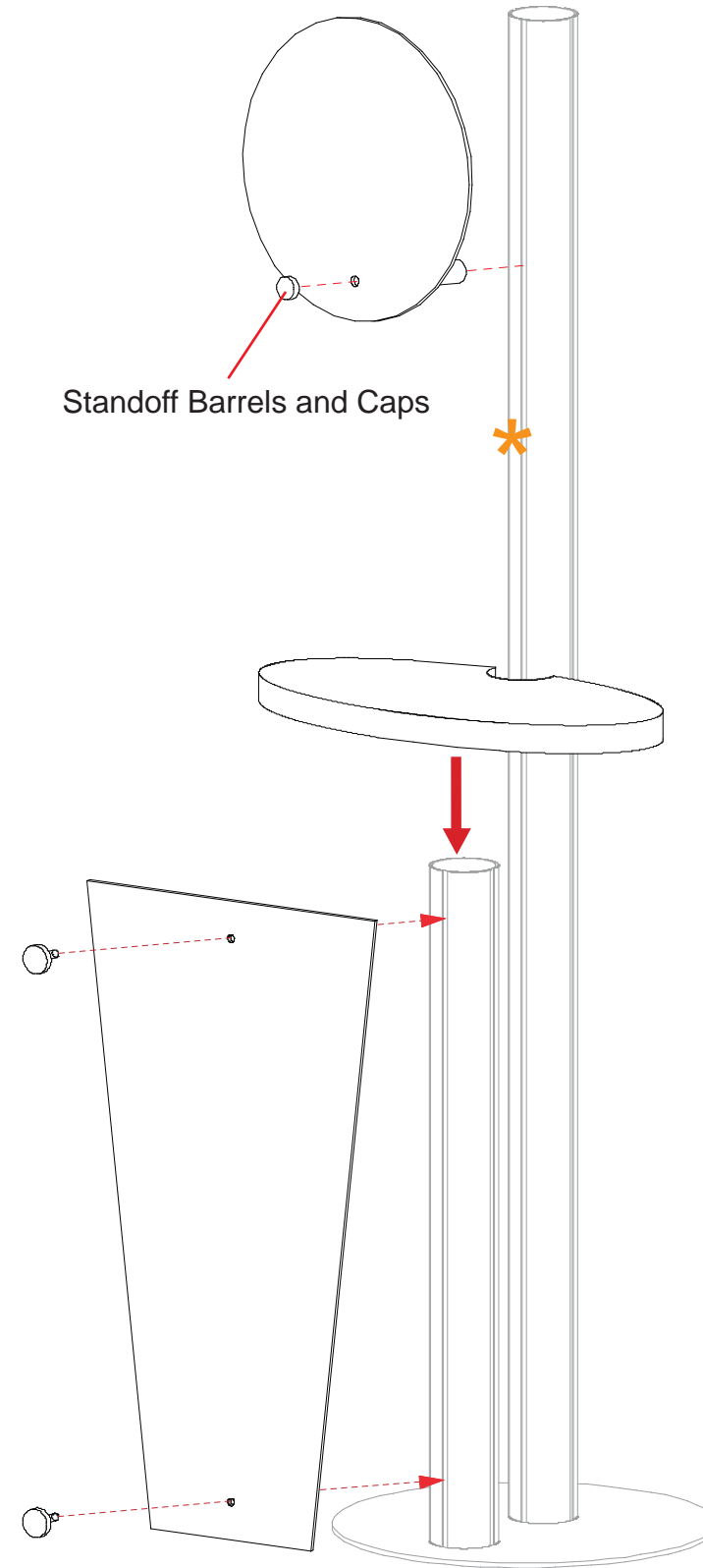

WHEN DISASSEMBLING ALUMINUM EXTRUSION, TIGHTEN ALL SETSCREWS AND LOCKS TO PREVENT LOSS DURING SHIPPING

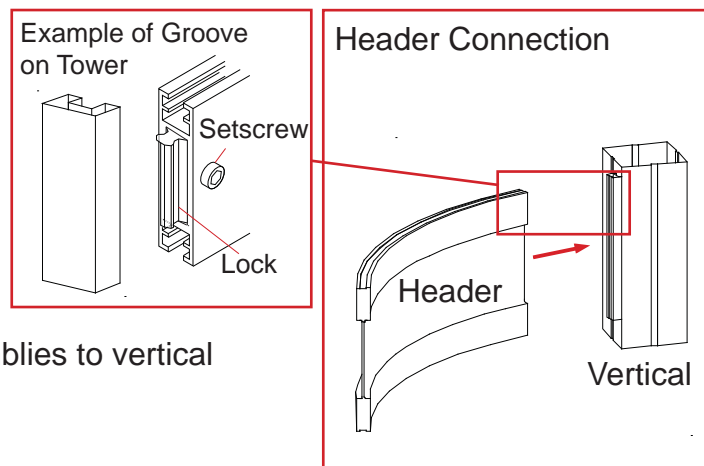

Attach Header Assemblies to vertical extrusions as shown.

Keep Headers Assembled for Shipping

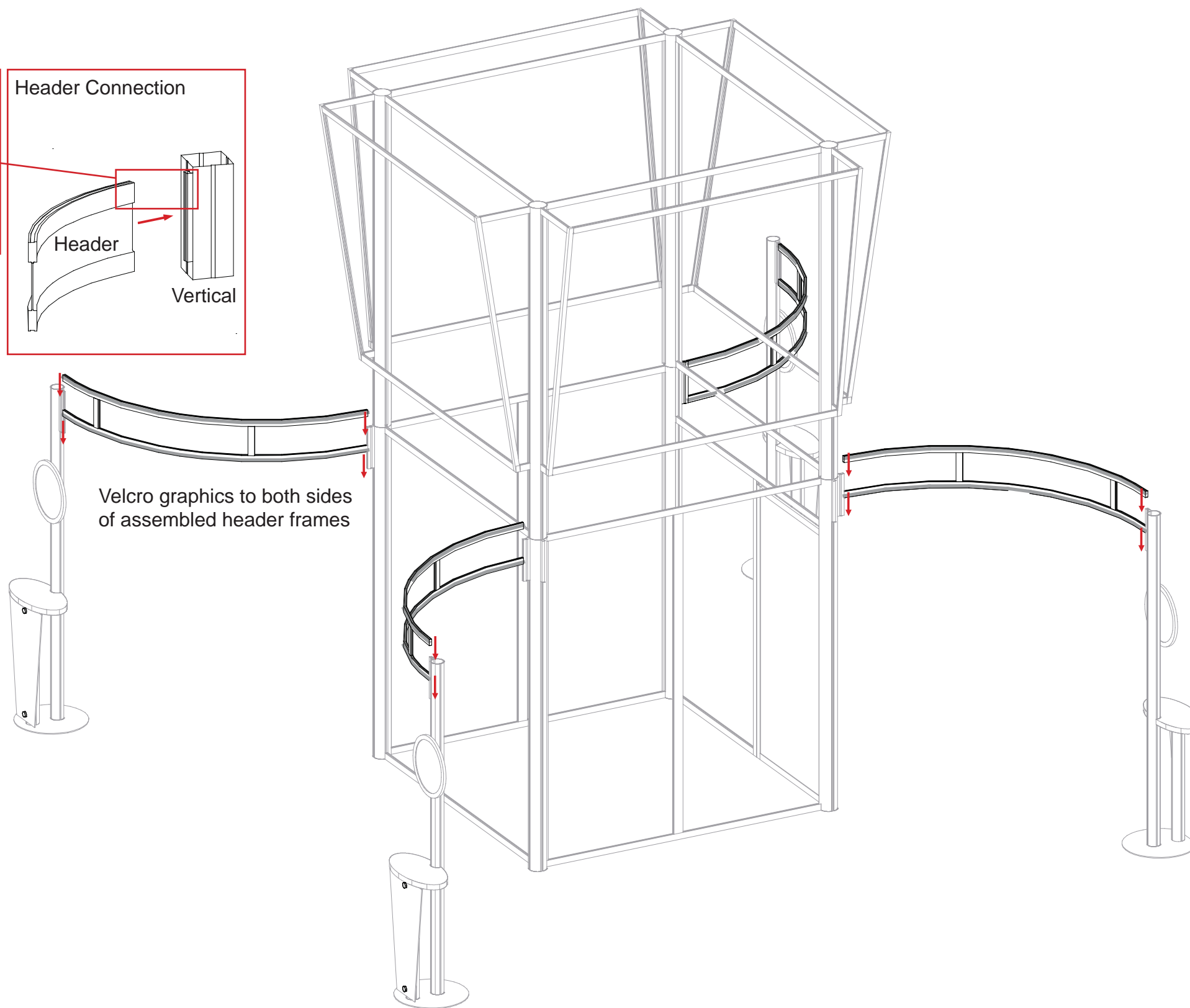

WHEN DISASSEMBLING ALUMINUM EXTRUSION, TIGHTEN ALL SETSCREWS AND LOCKS TO PREVENT LOSS DURING SHIPPING

866.652.2100

Item	Qty.	Description
20	1	38" h Vertical Extrusion
21	1	38" h Vertical Extrusion
22	1	38" h Vertical Extrusion
23	1	38" h Vertical Extrusion w/ Door Hinges
24	1	38" h Vertical Extrusion w/ Door Stop
25	1	38" h Vertical Extrusion w/ Door Hinges
26	4	16.5" Curved Horizontal Extrusion
27	4	11.5" Horizontal Extrusion
28	4	22.95" Curved Horizontal Extrusion

Steps:

- 1) Attach lower horizontal extrusions [26, 27 and 28] between vertical extrusions [20, 21, 22, 23, 24, and 25].
- 2) Place inserts and attach doors where indicated.
- 3) Attach upper horizontal extrusions [26, 27 and 28] between vertical extrusions [20, 21, 22, 23, 24, and 25] and atop doors and inserts.
- 4) Velcro shelf supports to inside of assembled pedestal, then set internal shelves atop supports.
- 5) Place counter top on assembled pedestal.

Note: Keep ALL pieces highlighted in Orange together and ALL pieces highlighted in Light Brown together for shipping.

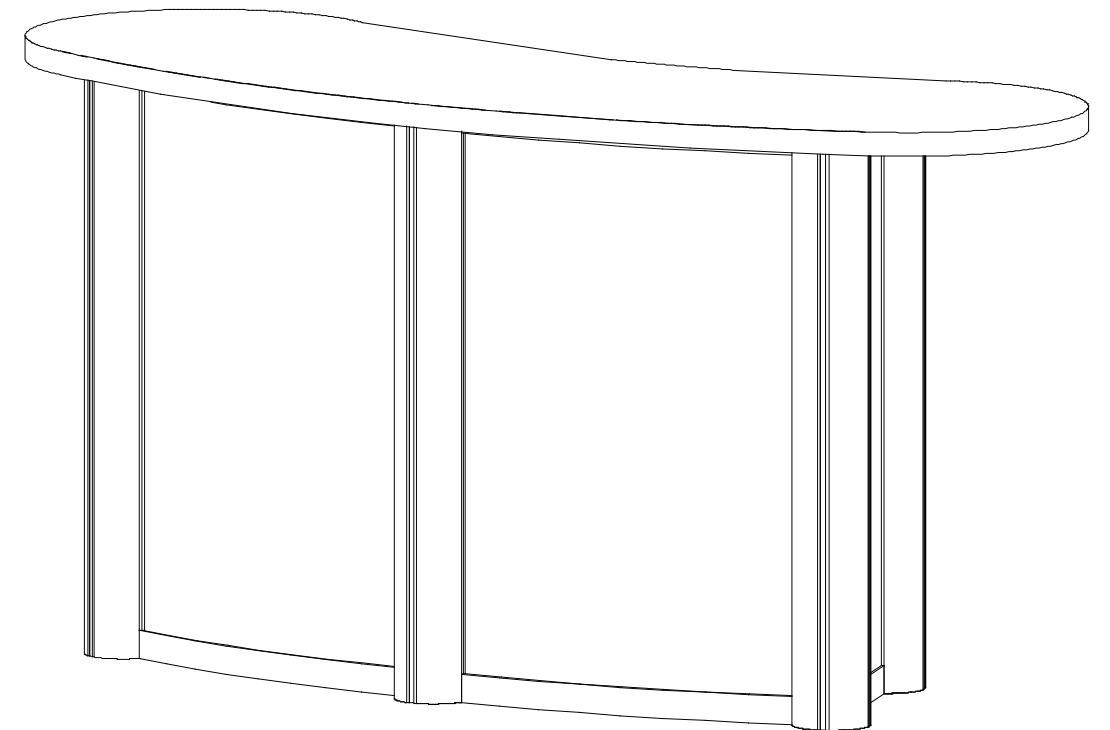
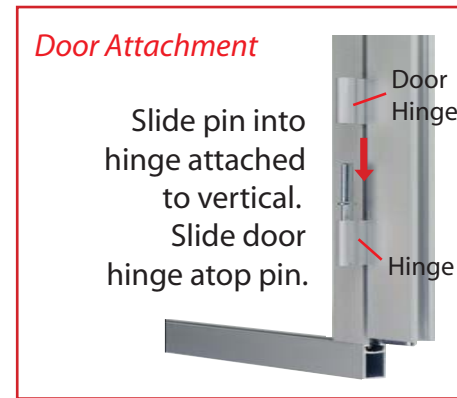
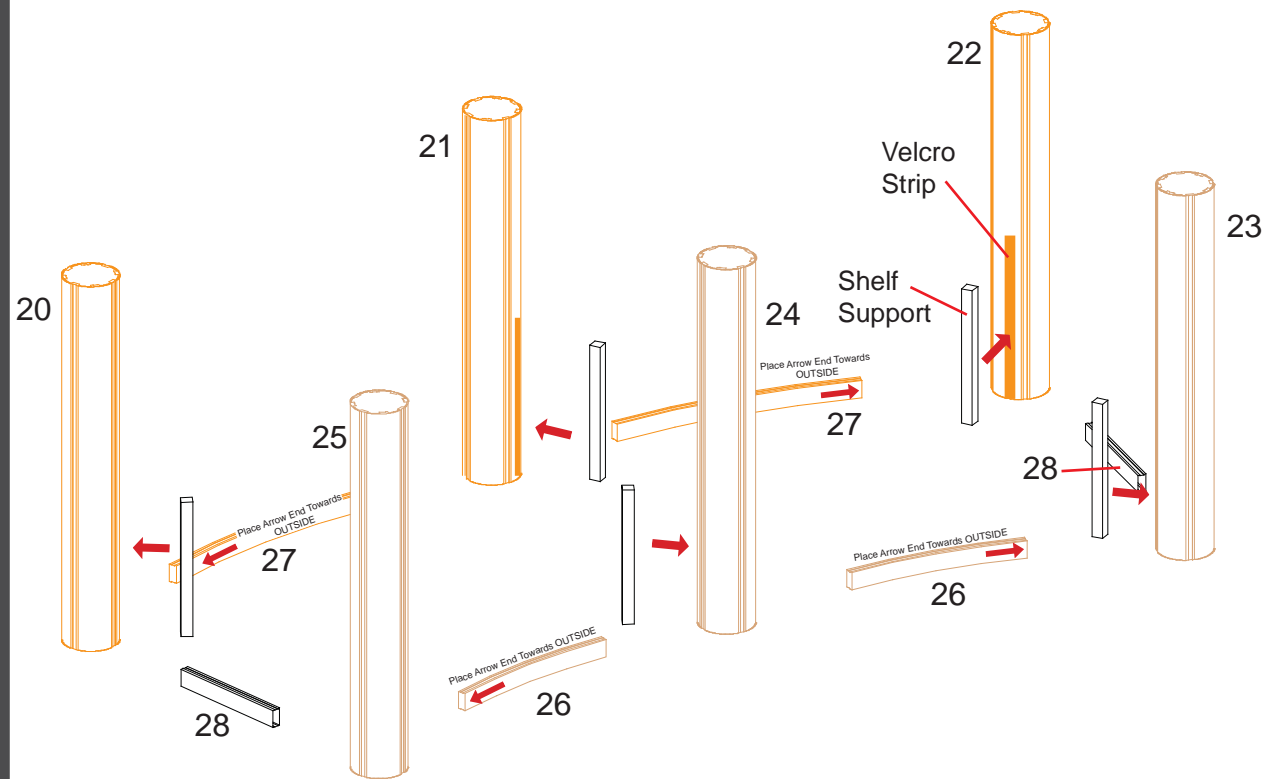

****Note** - Front inserts door inserts have clips used to push panels out

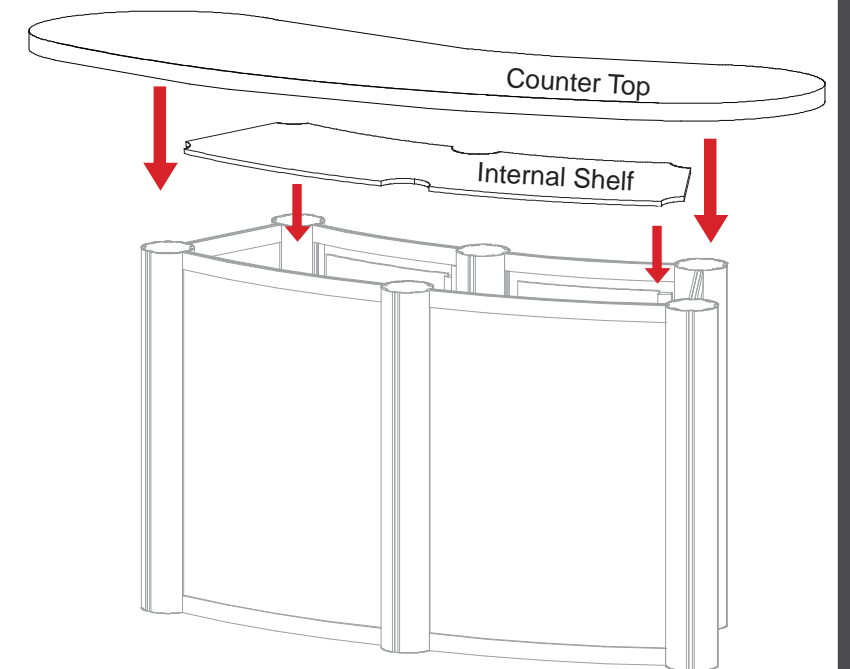
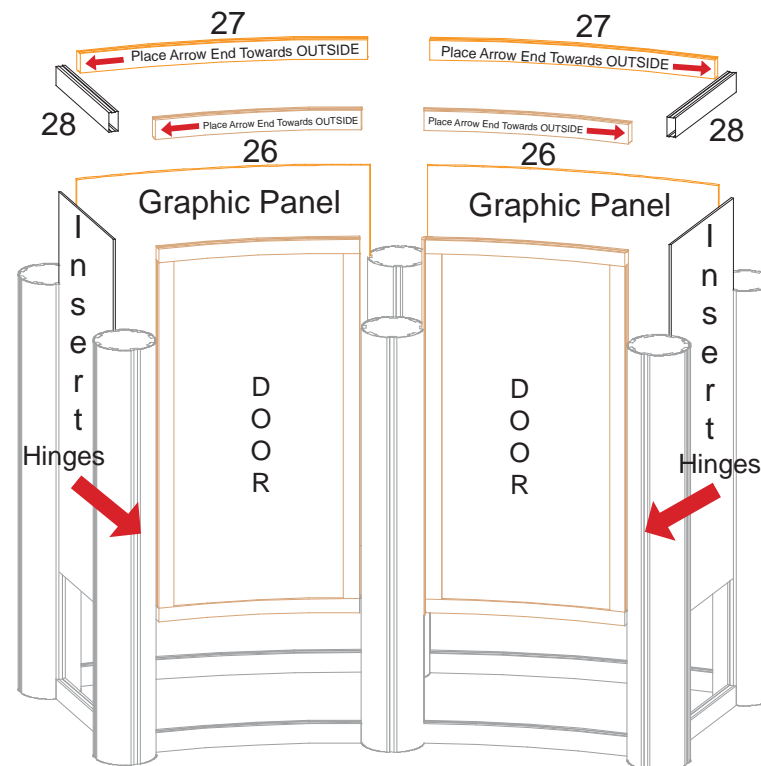

WHEN DISASSEMBLING ALUMINUM EXTRUSION, TIGHTEN ALL SETSCREWS AND LOCKS TO PREVENT LOSS DURING SHIPPING

Crate #1

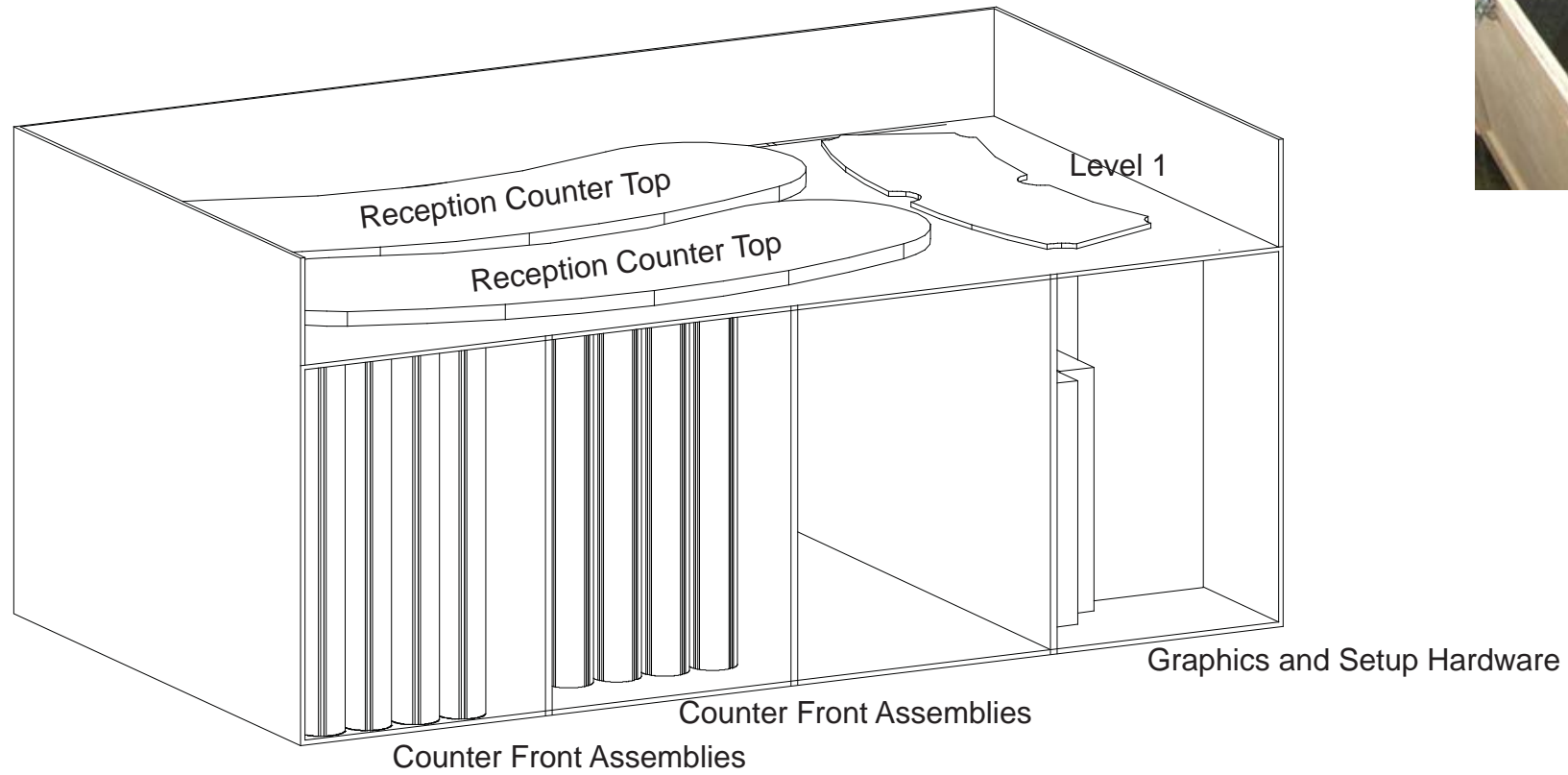
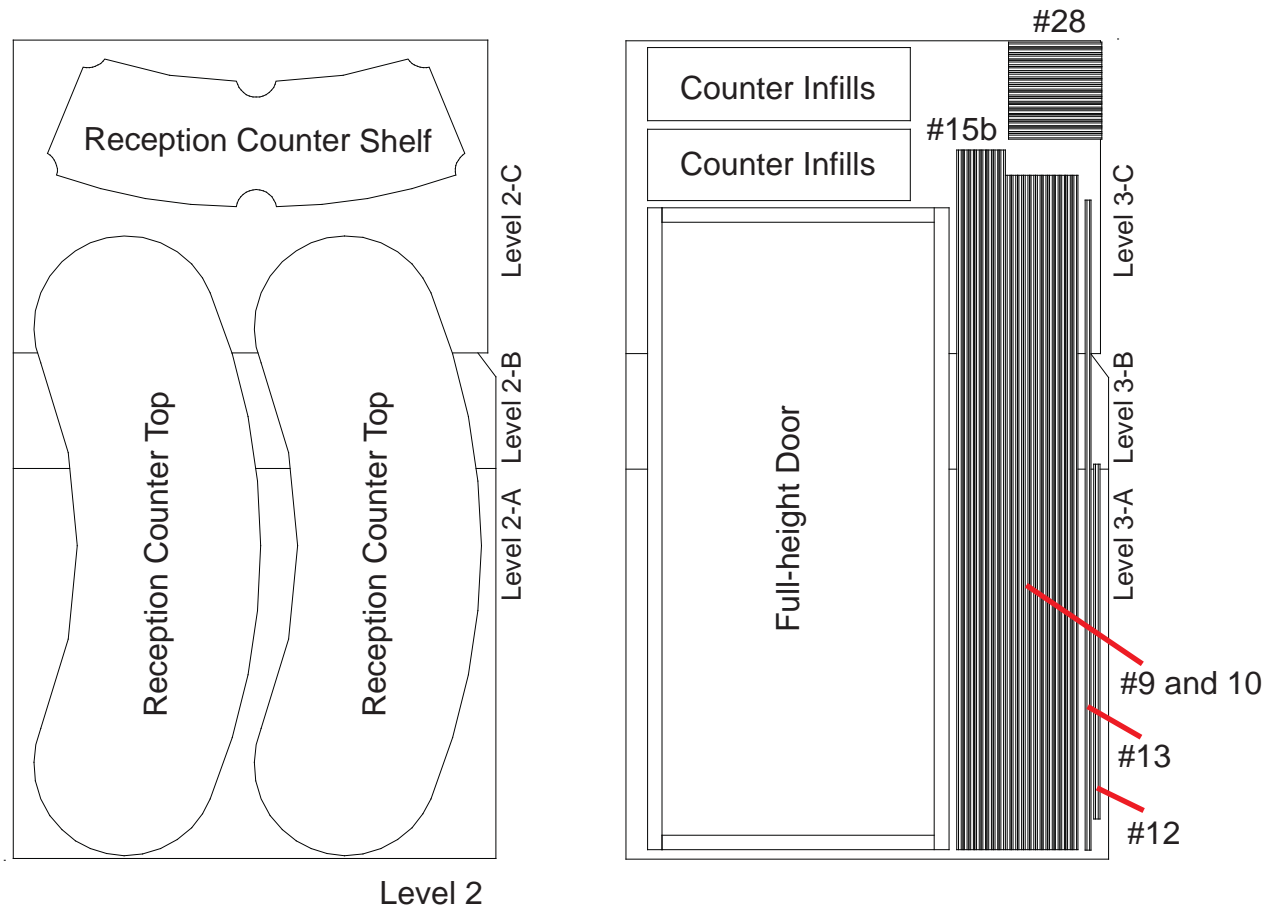

WHEN DISASSEMBLING ALUMINUM EXTRUSION, TIGHTEN ALL SETSCREWS AND LOCKS TO PREVENT LOSS DURING SHIPPING

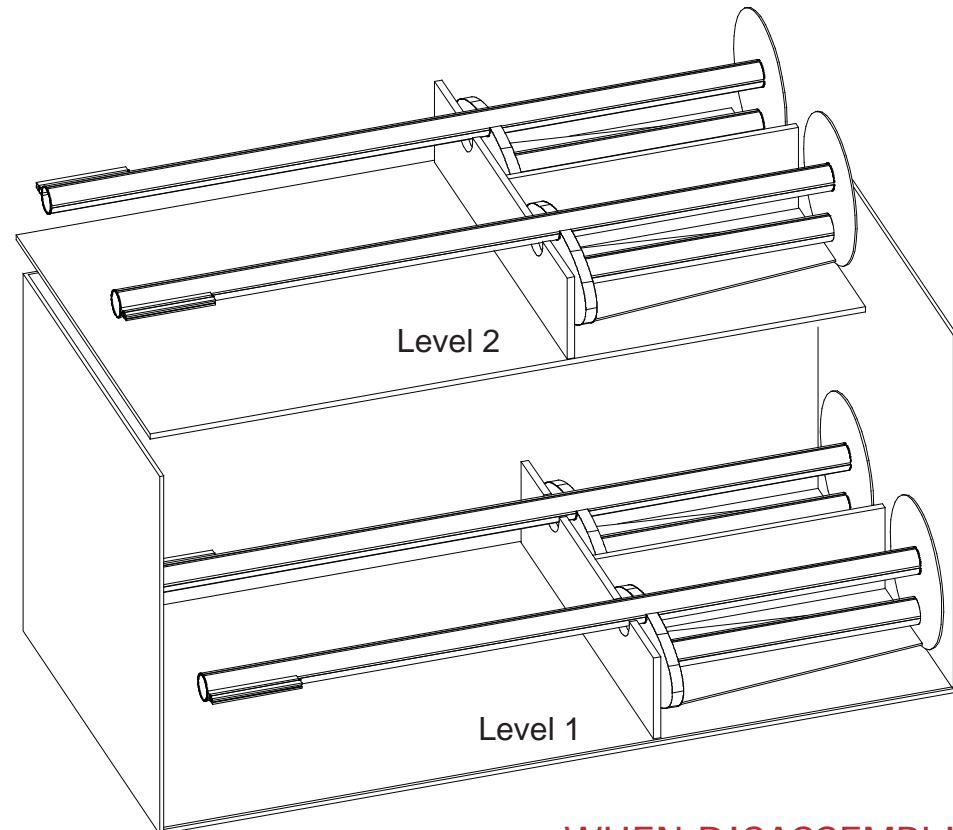
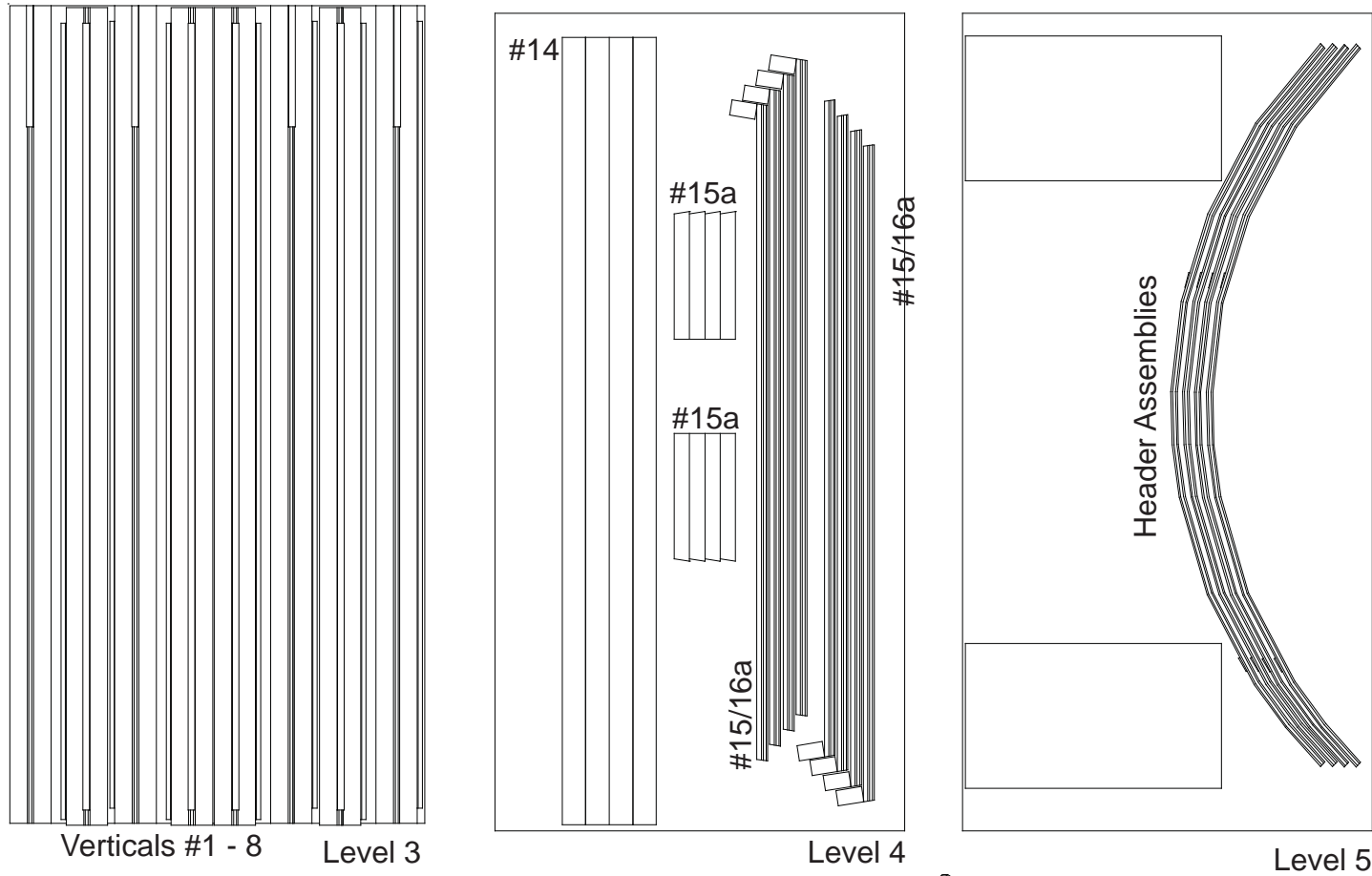

WHEN DISASSEMBLING ALUMINUM EXTRUSION, TIGHTEN ALL SETSCREWS AND LOCKS TO PREVENT LOSS DURING SHIPPING