

visionary[™]
DESIGNS

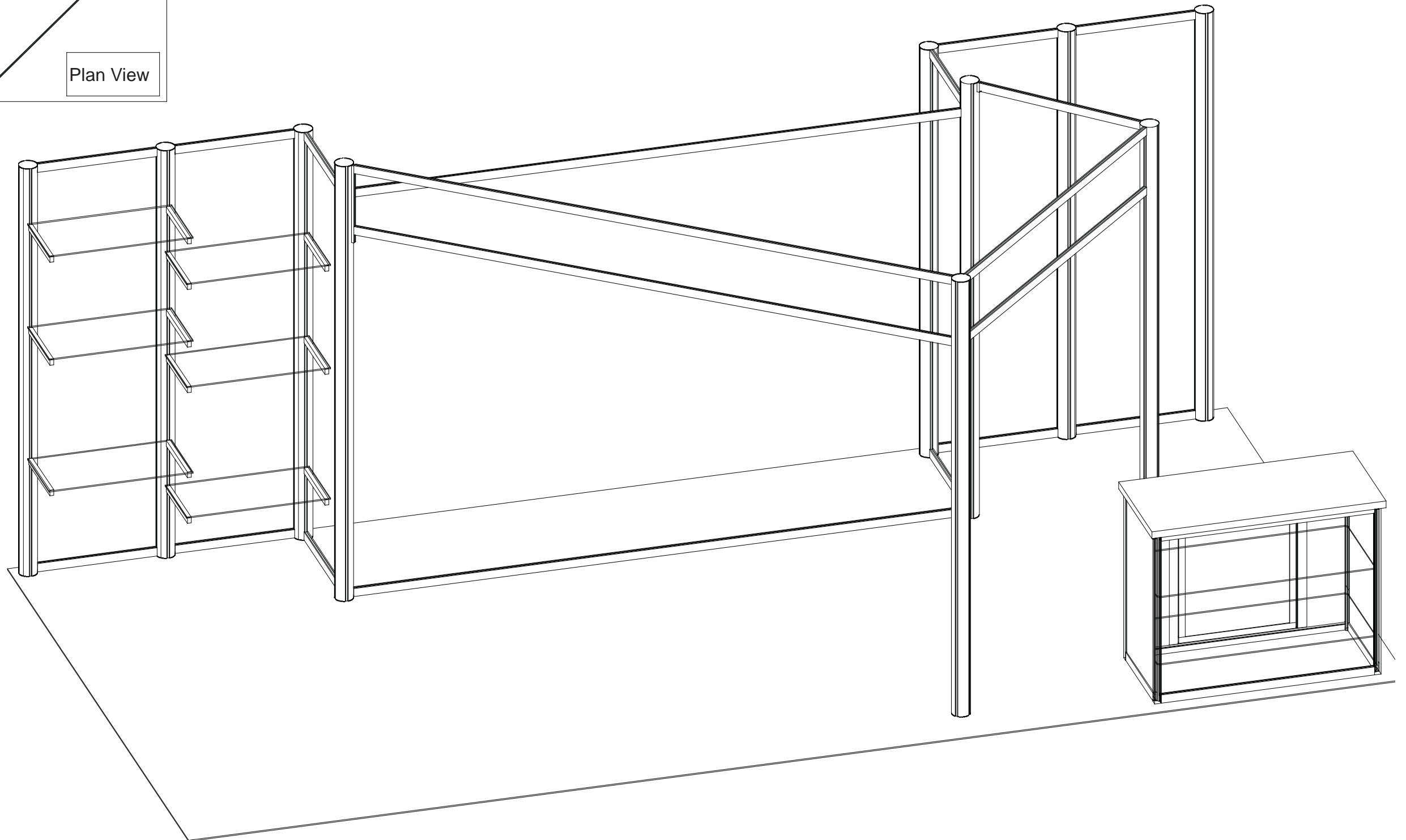
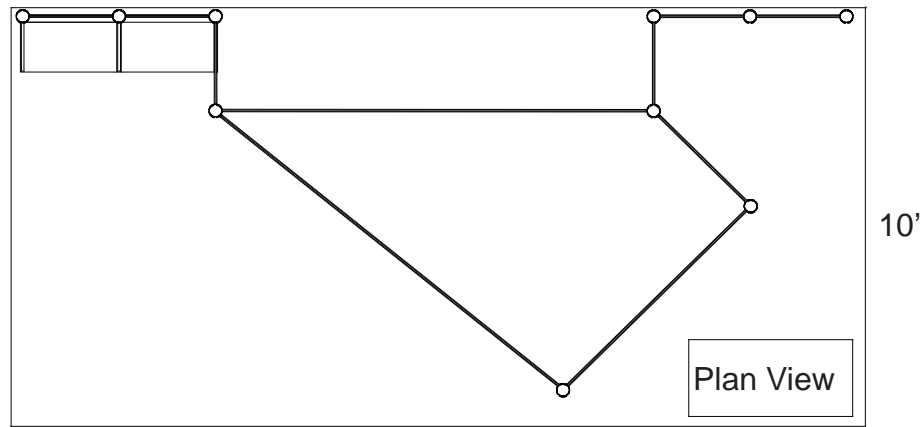

WHEN DISASSEMBLING ALUMINUM EXTRUSION, TIGHTEN ALL SETSCREWS AND LOCKS TO PREVENT LOSS DURING SHIPPING

visionary™ IDESIGNS

Using Your Setup Instructions

The Visionary Designs Setup Instructions are created specifically for your configuration. They are laid out sequentially, including an exploded view of the entire display, and then a logical series of detailed steps to assemble the main structure and components. We encourage you to study the instructions **before** attempting to assemble your exhibit.

Each page reminds you to tighten the setscrews after disassembling your exhibit to prevent loss of the locks and setscrews (see below in RED). This is **VERY IMPORTANT**.

Cleaning and Packing Your Display

- 1) Use care when cleaning aluminum extrusion or acrylic inserts. Use only non-abrasive cleaners.
- 2) When cleaning laminate inserts or countertops, use mild cleansers and a soft material such as cotton.
- 3) Keep all display components away from extreme heat and long exposure to sunlight to avoid warping and fading.
- 4) Retain all packing material. It will make re-packing much easier and will reduce the likelihood of shipping damage.



The Tool

Most Visionary Designs exhibits can be assembled with the supplied Hex Key Tool. Occasionally, a flat head screwdriver may be required.



Typical Connection



Typical Connection (cont'd)

Most horizontal extrusion connections have a patented expandable lock. This lock inserts into the groove of an opposing extrusion. Tightening the lock with the Hex Key Tool expands the lock and creates a strong positive connection.

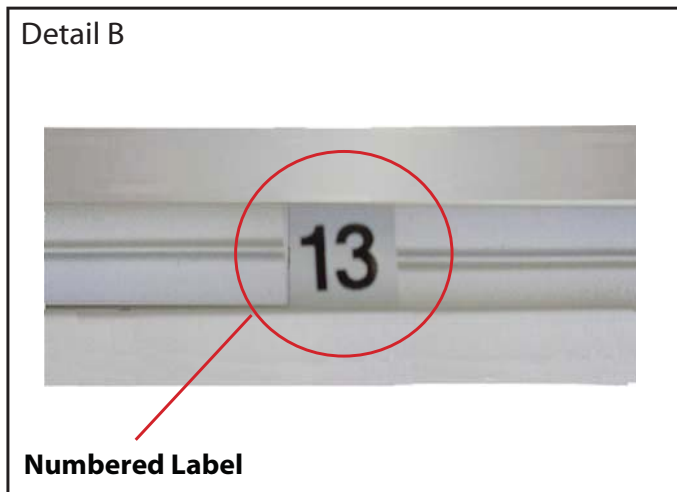

Detail B

Numbered Label

Each extrusion contains a numbered label which corresponds with setup instructions. The label is located within a groove of the extrusion (when possible). With Visionary Designs the labels contain Black numbers unless otherwise specified.



Detail C

Horizontal Inline Connection (remove only one setscrew)

Remove only (1) setscrew when disassembling. Replace setscrew in extrusion after assembling it. Before packing, replace setscrew in extrusion to avoid losing it.

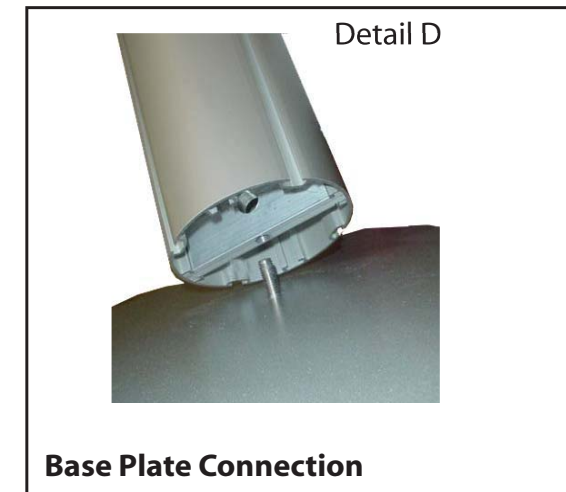

Detail D

Base Plate Connection

Attach base plate to round or square vertical extrusion using the bolt provided. Be careful not to strip the threads.

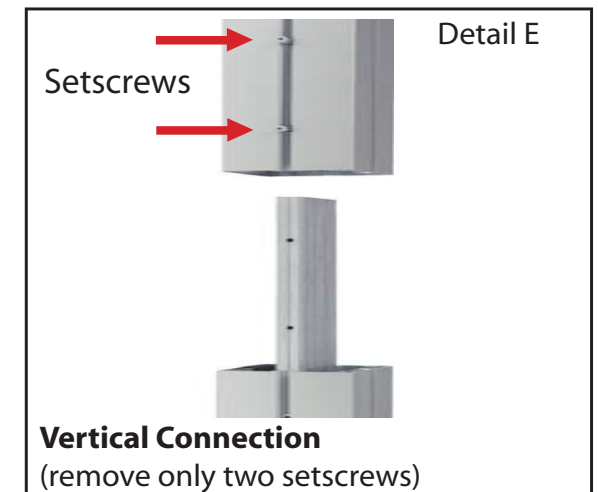

Detail E

Vertical Connection
(remove only two setscrews)

When vertical extrusions are packed in portable cases rather than crates or tubs, they must be broken down into smaller sections which then require assembly.

Remove only (2) setscrews when disassembling. Replace setscrews in extrusion after assembling it. Before packing, replace setscrews in extrusion to avoid losing them.

WHEN DISASSEMBLING ALUMINUM EXTRUSION, TIGHTEN ALL SETSCREWS AND LOCKS TO PREVENT LOSS DURING SHIPPING

866.652.2100

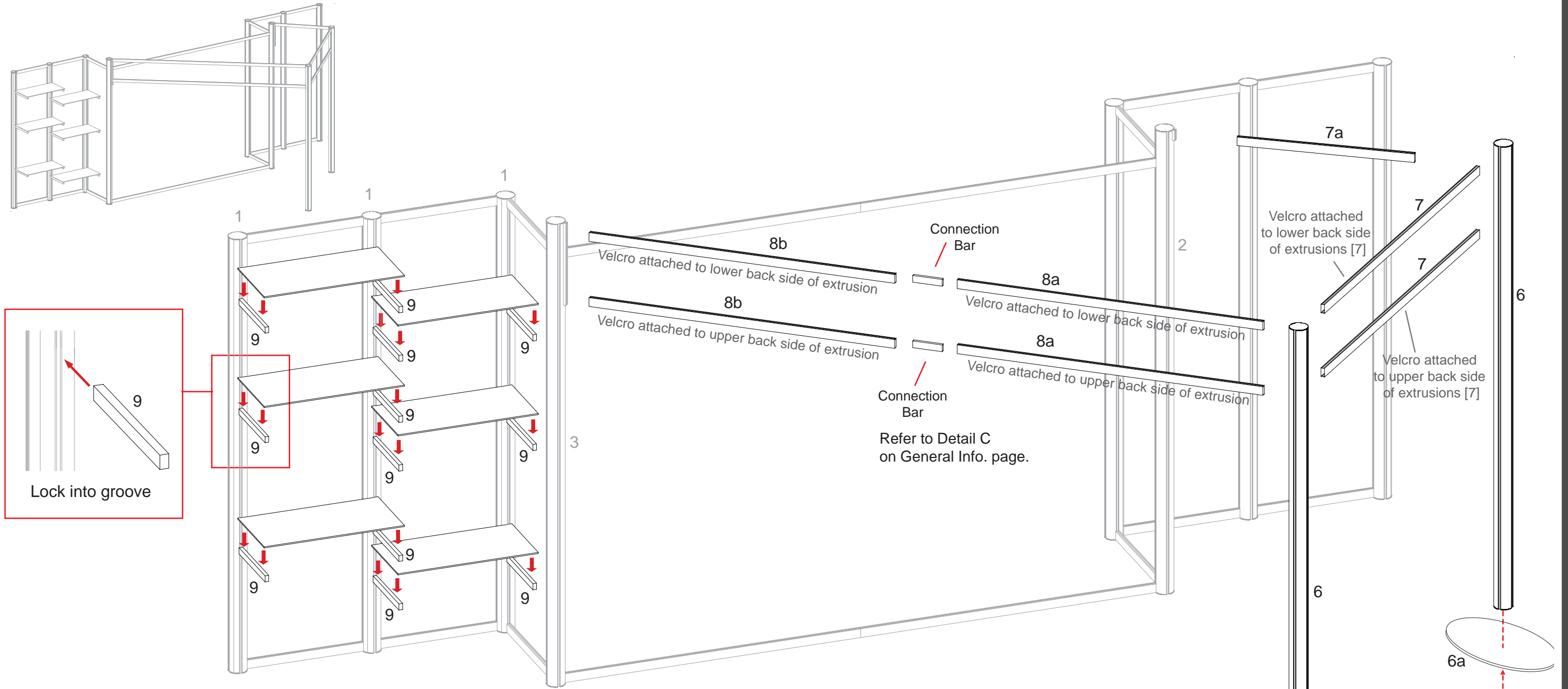

Item	Qty.	Description
6	2	96" Vertical Extrusion
6a	2	Oval Base Plate
7	2	71" Horizontal Extrusion
7a	1	34.5" Vertical Extrusion
8a/8b	2/2	61.135" Horizontal Extrusion
9	12	14" Shelf Support

Steps:

- 1) Attach base plates to vertical extrusions [6a].
- 2) Connect horizontal extrusions [8a and 8b] together using connection bar.
- 3) Attach horizontal assemblies [8a and 8b] between vertical extrusion [6 and 3].
- 4) Attach horizontal extrusions [7] between vertical extrusions [6] as shown below.
- 5) Attach horizontal extrusion [7a] between vertical extrusions [2 and 6].
- 6) Attach shelf supports [9] to vertical extrusions [1] see detail this page.
- 7) Place shelves to top of shelf supports [9].

WHEN DISASSEMBLING ALUMINUM EXTRUSION, TIGHTEN ALL SETSCREWS AND LOCKS TO PREVENT LOSS DURING SHIPPING

866.652.2100

Item	Qty.	Description
10	4	37.5" Vertical Extrusion
11	2	42" Horizontal Extrusion
11a	2	42" Horizontal Extrusion with lip
12	2	18" Horizontal Extrusion
12a	2	18" Horizontal Extrusion with lip
13	1	33.92" Vertical Extrusion with Hinges
14	1	33.92" Vertical Extrusion with Door Stop

- Steps:
- 1) Connect horizontal extrusions [11a and 12a] between vertical extrusions [10].
 - 2) Attach vertical extrusions [13 and 14] to horizontal extrusion [11a] as shown.
 - 3) Set floor to top of lip of horizontal extrusions [11a and 12a].
 - 4) Attach pins to vertical extrusions [10] for shelf support.
 - 5) Place door and slide infills in place as shown.
 - 6) Connect horizontal extrusions [11 and 12] between vertical extrusions [10].
 - 7) Place shelves atop pins and counter top atop assembled pedestal.

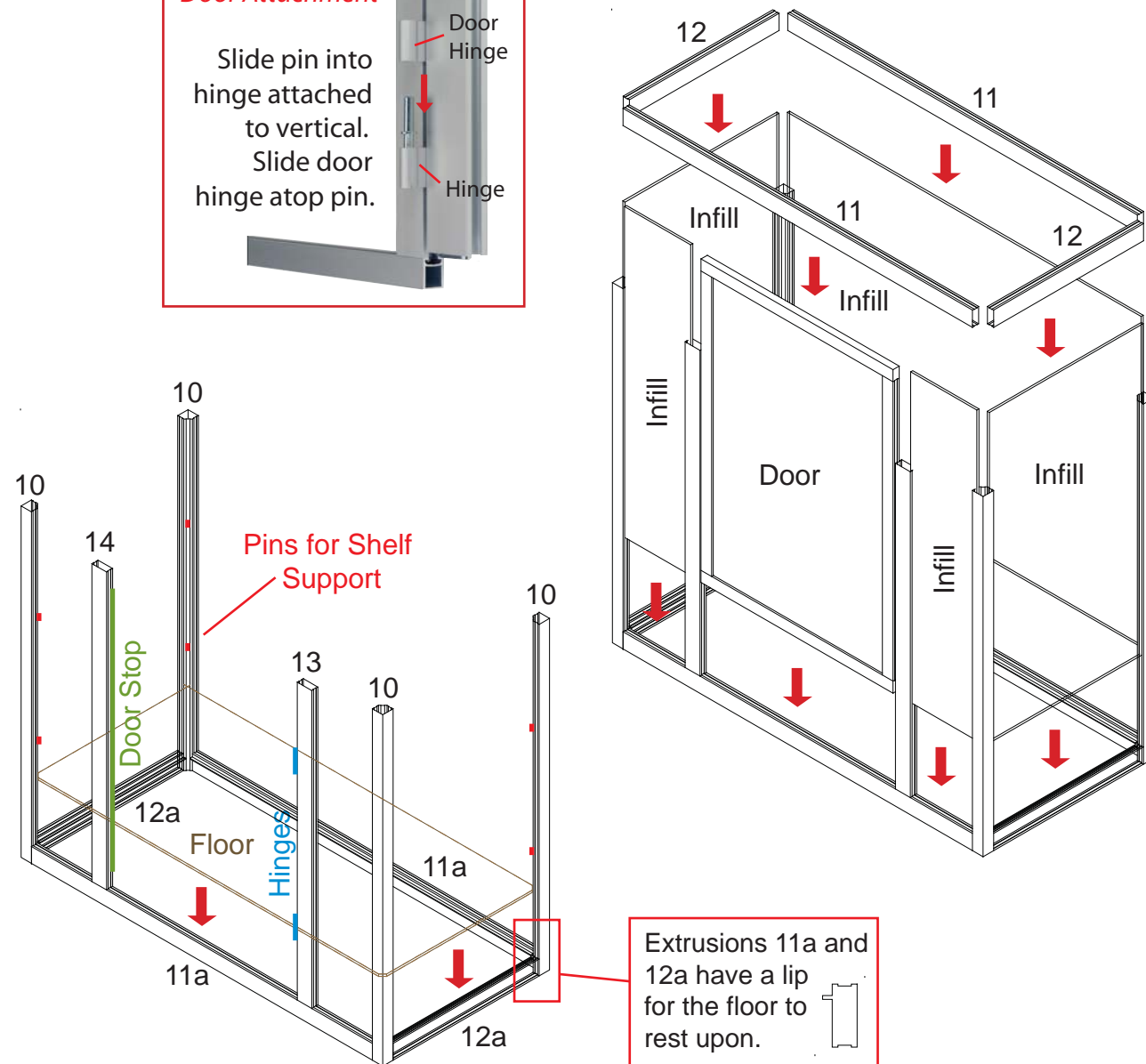
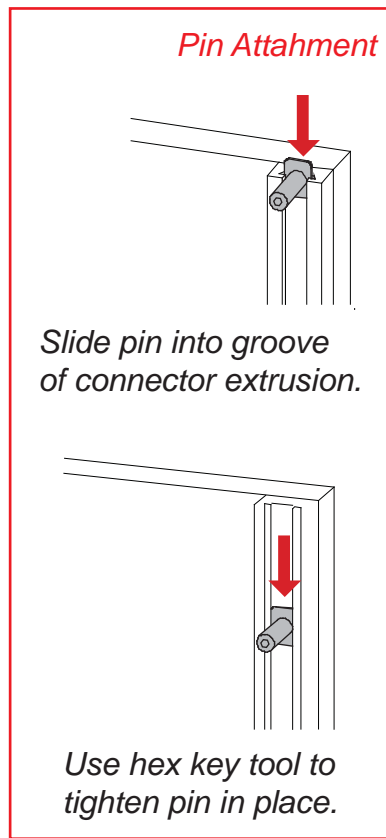
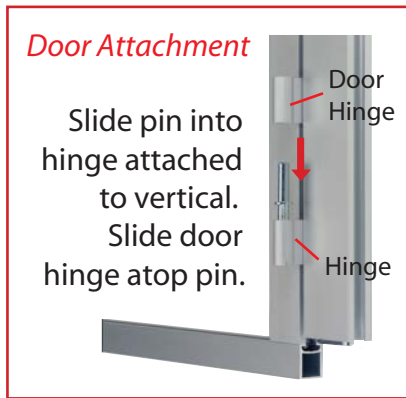
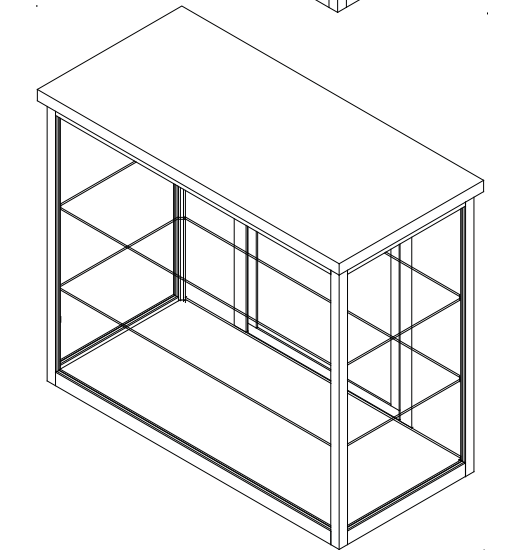
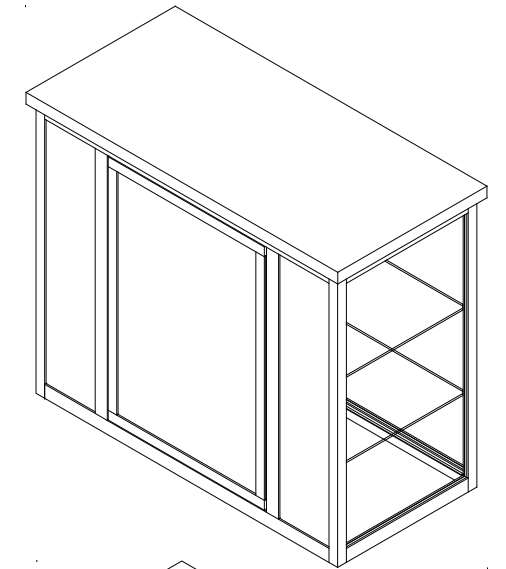

Extrusions 11a and 12a have a lip for the floor to rest upon.

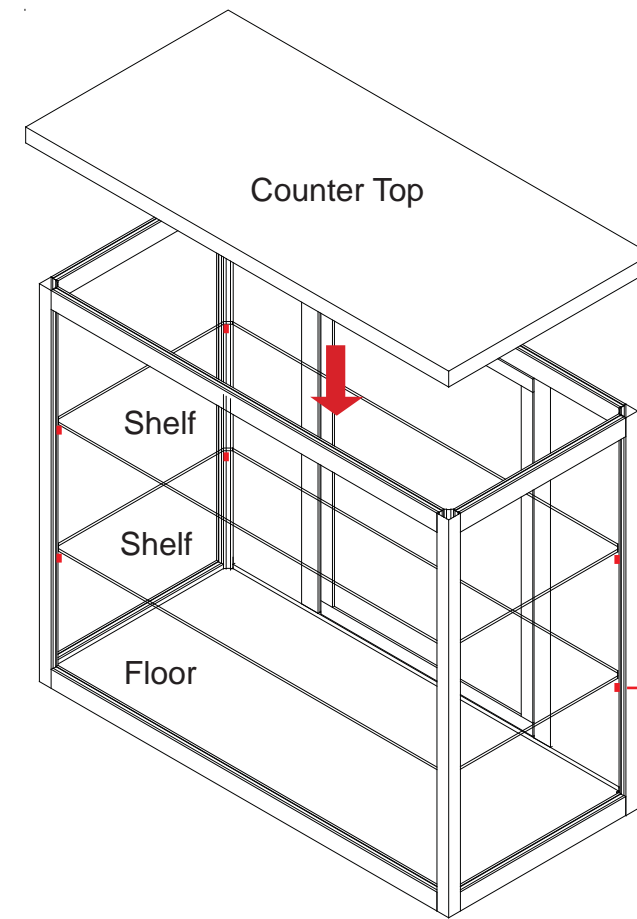

Pins for Shelf Support

WHEN DISASSEMBLING ALUMINUM EXTRUSION, TIGHTEN ALL SETSCREWS AND LOCKS TO PREVENT LOSS DURING SHIPPING

WHEN DISASSEMBLING ALUMINUM EXTRUSION, TIGHTEN ALL
SETSCREWS AND LOCKS TO PREVENT LOSS DURING SHIPPING