

Plan View

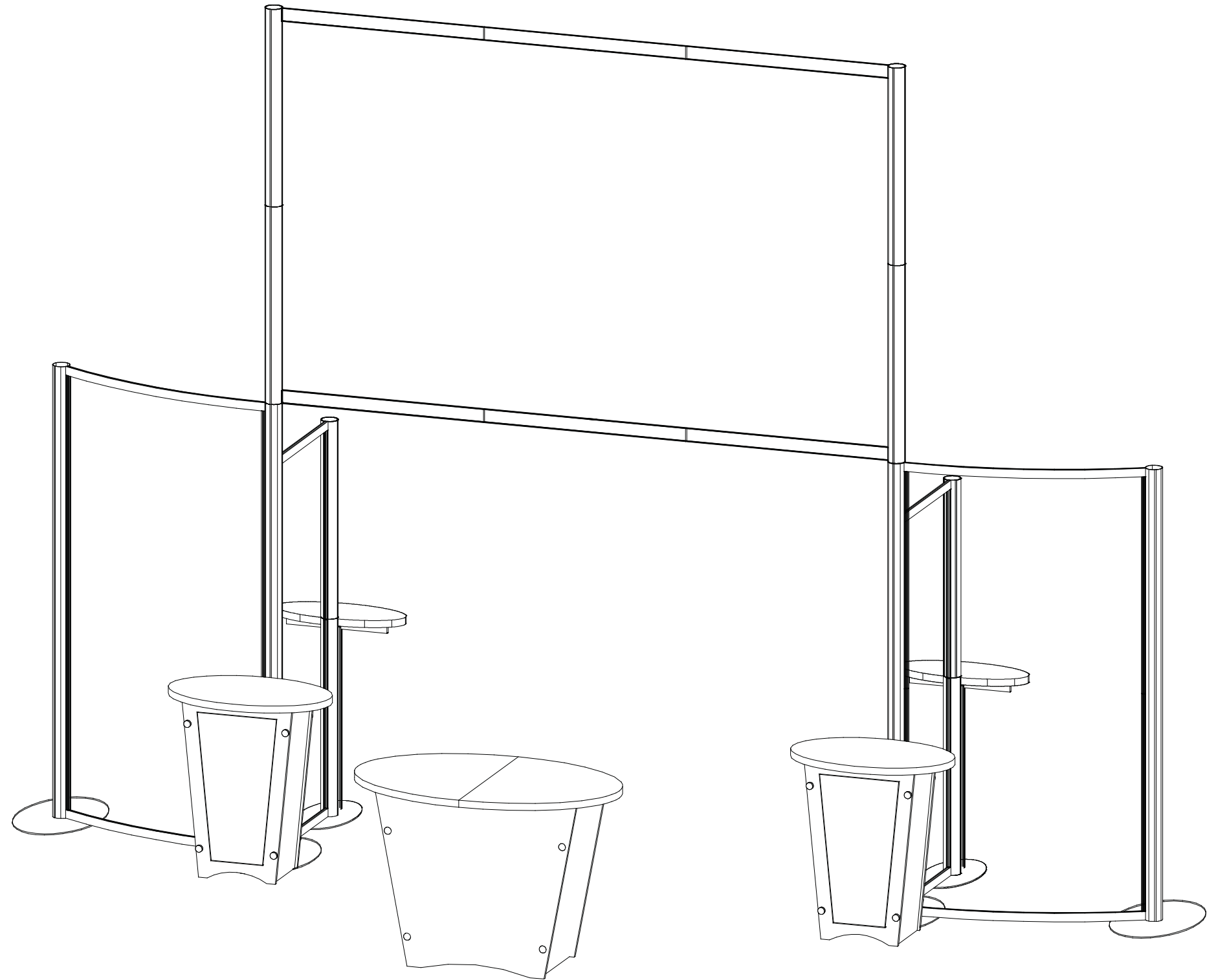

WHEN DISASSEMBLING ALUMINUM EXTRUSION, TIGHTEN ALL SETSCREWS AND LOCKS TO PREVENT LOSS DURING SHIPPING

# visionary™ DESIGNS

## Using Your Setup Instructions

The Visionary Designs Setup Instructions are created specifically for your configuration. They are laid out sequentially, including an exploded view of the entire display, and then a logical series of detailed steps to assemble the main structure and components. We encourage you to study the instructions **before** attempting to assemble your exhibit.

Each page reminds you to tighten the setscrews after disassembling your exhibit to prevent loss of the locks and setscrews (see below in RED). This is **VERY IMPORTANT**.

## Cleaning and Packing Your Display

- 1) Use care when cleaning aluminum extrusion or acrylic inserts. Use only non-abrasive cleaners.
- 2) When cleaning laminate inserts or countertops, use mild cleansers and a soft material such as cotton.
- 3) Keep all display components away from extreme heat and long exposure to sunlight to avoid warping and fading.
- 4) Retain all packing material. It will make re-packing much easier and will reduce the likelihood of shipping damage.



**The Tool**

Most Visionary Designs exhibits can be assembled with the supplied Hex Key Tool. Occasionally, a flat head screwdriver may be required.



**Typical Connection**



**Typical Connection (cont'd)**

Most horizontal extrusion connections have a patented expandable lock. This lock inserts into the groove of an opposing extrusion. Tightening the lock with the Hex Key Tool expands the lock and creates a strong positive connection.

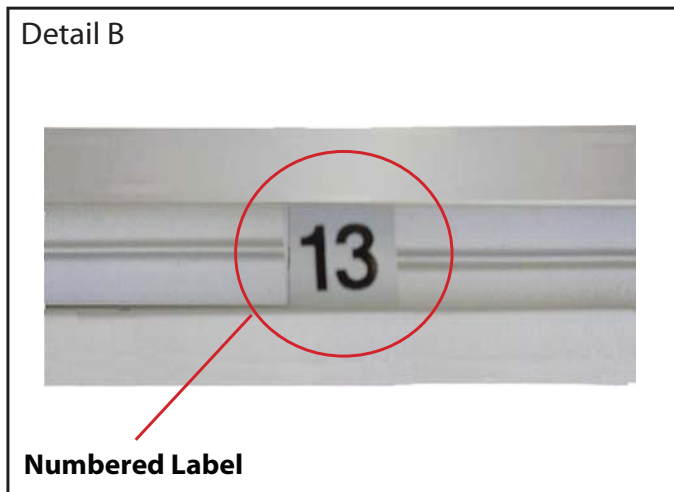

**Detail B**

**Numbered Label**

Each extrusion contains a numbered label which corresponds with setup instructions. The label is located within a groove of the extrusion (when possible). With Visionary Designs the labels contain Black numbers unless otherwise specified.



**Detail C**

**Horizontal Inline Connection** (remove only one setscrew)

Remove only (1) setscrew when disassembling. Replace setscrew in extrusion after assembling it. Before packing, replace setscrew in extrusion to avoid losing it.

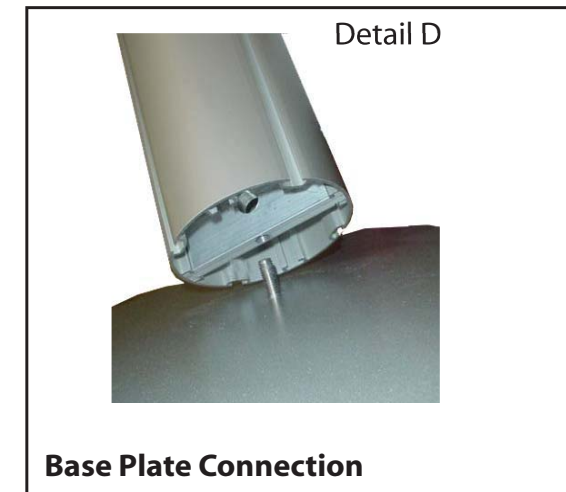

**Detail D**

**Base Plate Connection**

Attach base plate to round or square vertical extrusion using the bolt provided. Be careful not to strip the threads.

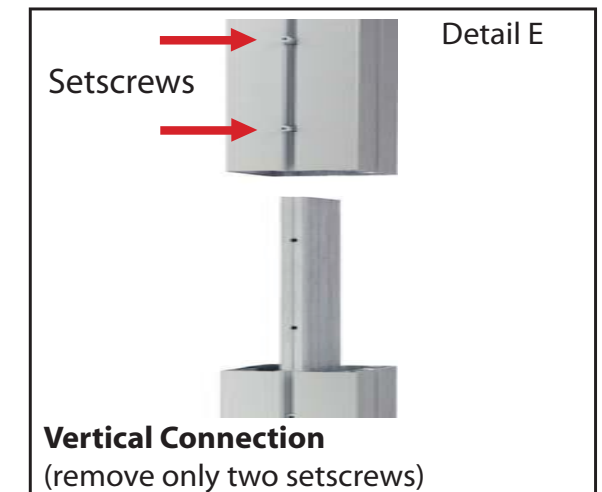

**Detail E**

**Vertical Connection**  
(remove only two setscrews)

When vertical extrusions are packed in portable cases rather than crates or tubs, they must be broken down into smaller sections which then require assembly.

Remove only (2) setscrews when disassembling. Replace setscrews in extrusion after assembling it. Before packing, replace setscrews in extrusion to avoid losing them.



**WHEN DISASSEMBLING ALUMINUM EXTRUSION, TIGHTEN ALL SETSCREWS AND LOCKS TO PREVENT LOSS DURING SHIPPING**

Item	Qty.	Description
1/1b	2/2	Base Plate
2	1	47.875" h Vertical Extrusion
3	1	47.875" h Vertical Extrusion
4	1	47.875" h Vertical Extrusion
5	1	47.875" h Vertical Extrusion
6	1	41.875" w Vertical Extrusion
7	1	41.785" w Vertical Extrusion
8	1	40" w Vertical Extrusion
9	1	41.875" w Vertical Extrusion
10	1	41.875" w Vertical Extrusion
	1	40" w Vertical Extrusion
14	1	47.875" h Vertical Extrusion
16	1	47.875" h Vertical Extrusion
16	1	47.875" h Vertical Extrusion
17	1	47.875" h Vertical Extrusion

Item	Qty.	Description
30a/30b/30c	1/1/1	43.83" w Horizontal Extrusion
31a/31b/31c	1/1/1	43.83" w Horizontal Extrusion

Steps:

- 1) Assemble vertical extrusions together as shown in below illustrator, see detail E on General Info page.
- 2) Attach base plates to bottom of extrusions as shown.  
*NOTE: Base plate connection inserts must be removed from #6 and #9 and installed into bottom of extrusions #27.*
- 3) Connect horizontal extrusions together as shown, see C on General Info page.
- 4) Connect horizontal extrusions between vertical assemblies as shown.

*NOTE: L-brackets highlighted in Pink must be positioned toward graphic for graphic attachment*

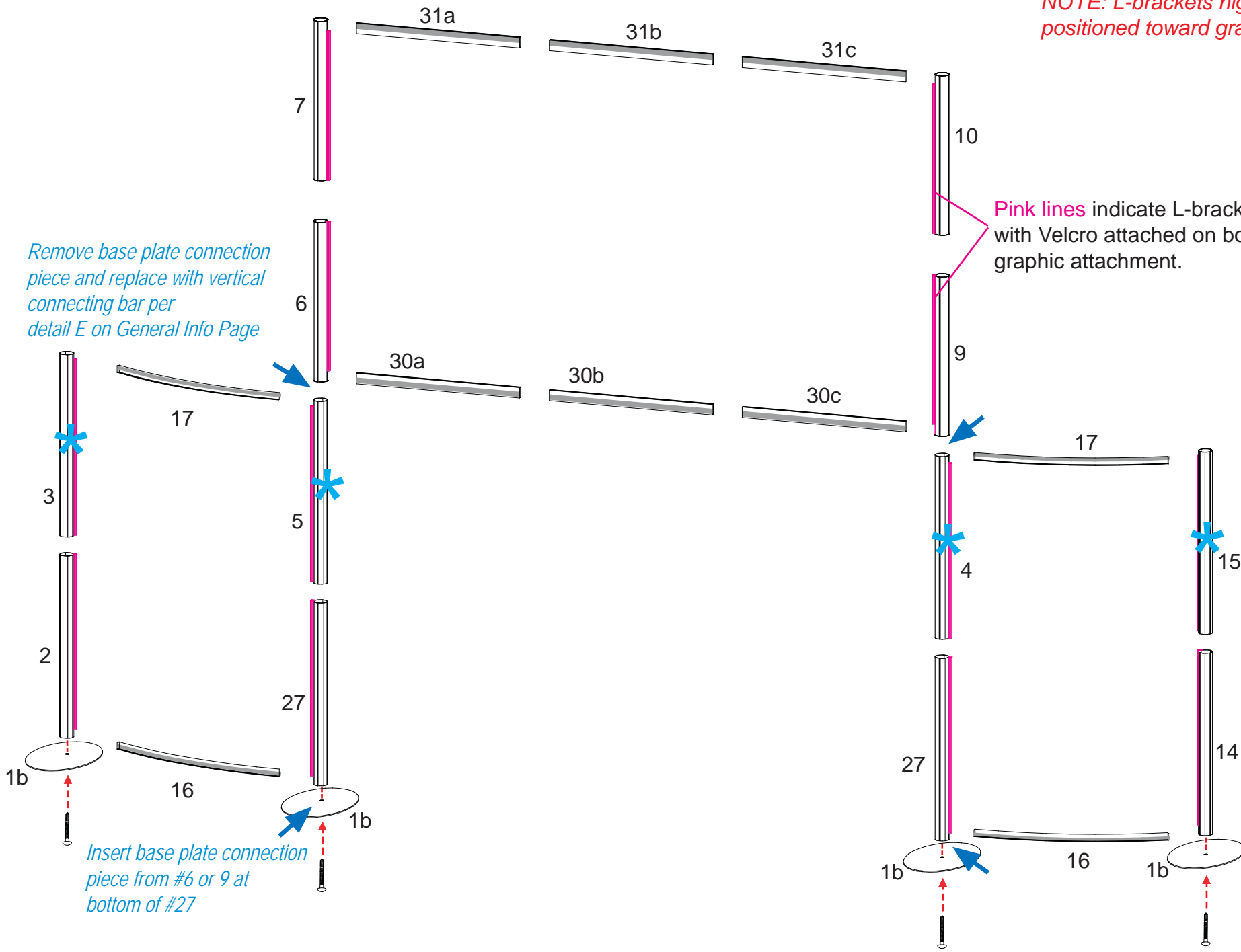

Pink lines indicate L-bracket extrusion with Velcro attached on both sides for graphic attachment.

**\*Example of Monitor Mount Attachment (If connectors removed)**

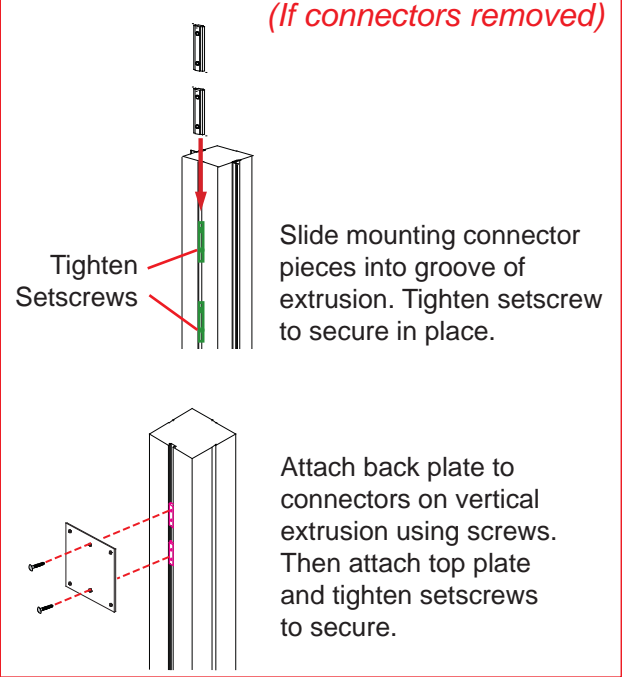

Remove base plate connection piece and replace with vertical connecting bar per detail E on General Info Page

Insert base plate connection piece from #6 or 9 at bottom of #27



**WHEN DISASSEMBLING ALUMINUM EXTRUSION, TIGHTEN ALL SETSCREWS AND LOCKS TO PREVENT LOSS DURING SHIPPING**

Item	Qty.	Description
1a	2	Base Plate w/ 2 Holes
8	1	40" h Vertical Extrusion
11	1	40" h Vertical Extrusion
19	1	30" w Horizontal Extrusion
22	4	10" w Horizontal Extrusion
23	2	6" w Horizontal Extrusion
25	2	47.875" h Vertical Extrusion
26	2	47.875" h Vertical Extrusion

Steps:

- 1) Attach bottom of extrusions [8, 25 and 26] to base plates [1a].
- 2) Attach counter top supports [22 and 23] to verticals [8 and 11].
- 3) Set counter tops atop supports and secure to posts.

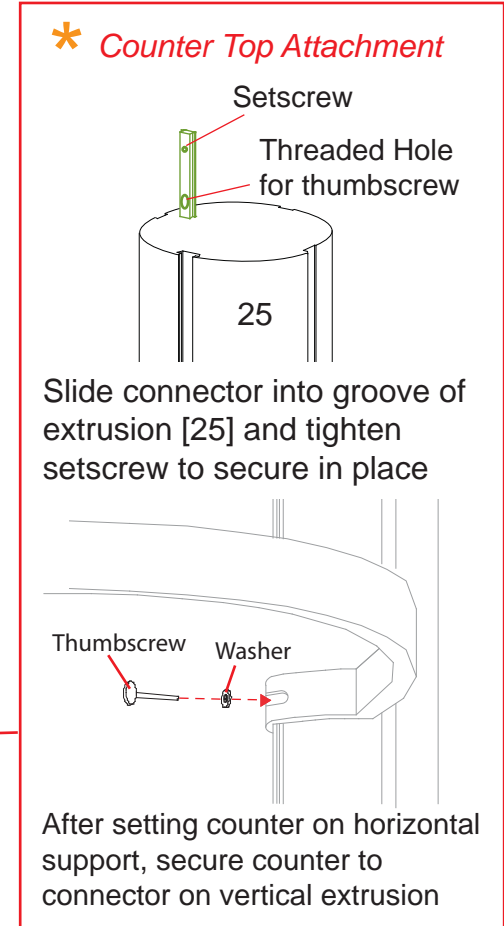
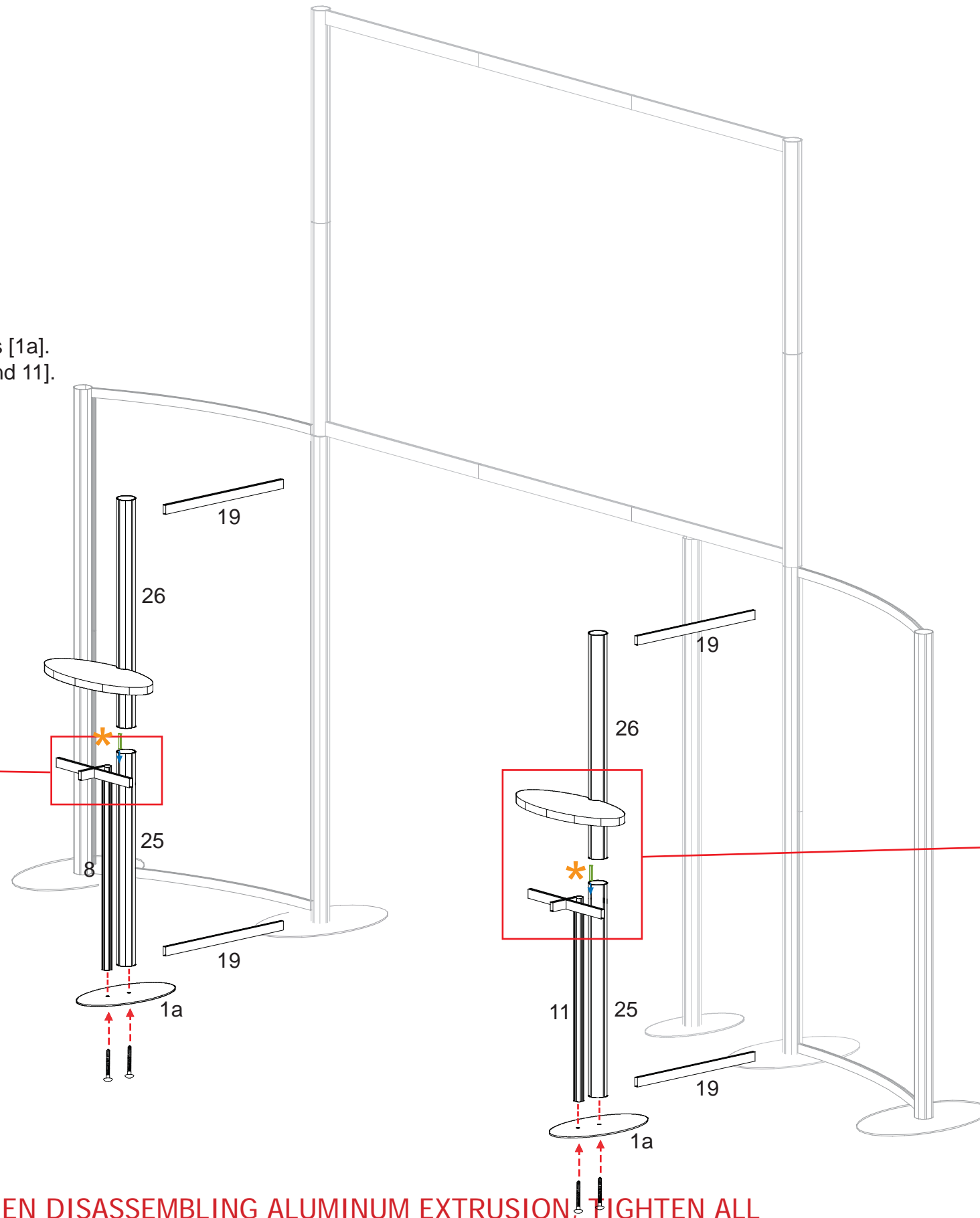
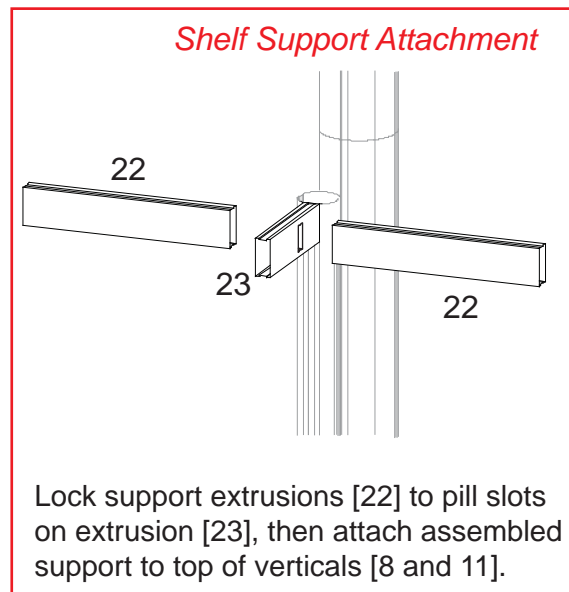

WHEN DISASSEMBLING ALUMINUM EXTRUSION, TIGHTEN ALL SETSCREWS AND LOCKS TO PREVENT LOSS DURING SHIPPING

Item	Qty.	Description
12	1	47.875"h Vertical Extrusion
24	1	Base Plate
33	1	47.875"h Vertical Extrusion

Steps:

- 1) Attach lower vertical extrusion [33] to base plate [24].
- 2) Attach upper vertical extrusion [12 and 13] to extrusion [33].

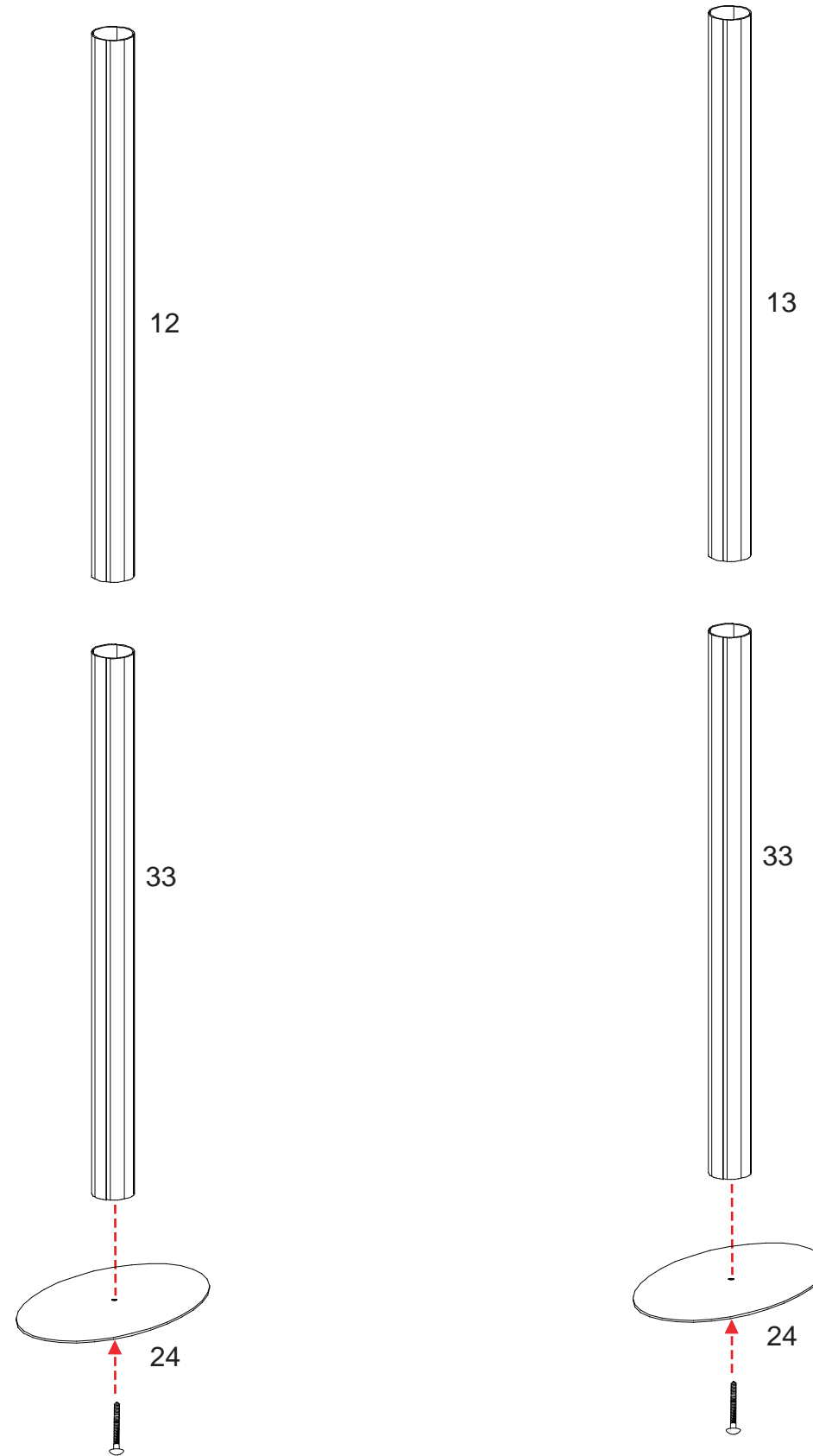

WHEN DISASSEMBLING ALUMINUM EXTRUSION, TIGHTEN ALL SETSCREWS AND LOCKS TO PREVENT LOSS DURING SHIPPING

Setup Instructions:

- A) Use standoff screws to secure the front panels with door and back panels of the pedestal to the side panels.
- B) After assembling front, back, and side panels, slide floor into the bottom of the pedestal. The floor will sit on pins on the inside of the side panels.
- C) After floor is in place, use velcro attachments to install shelf.

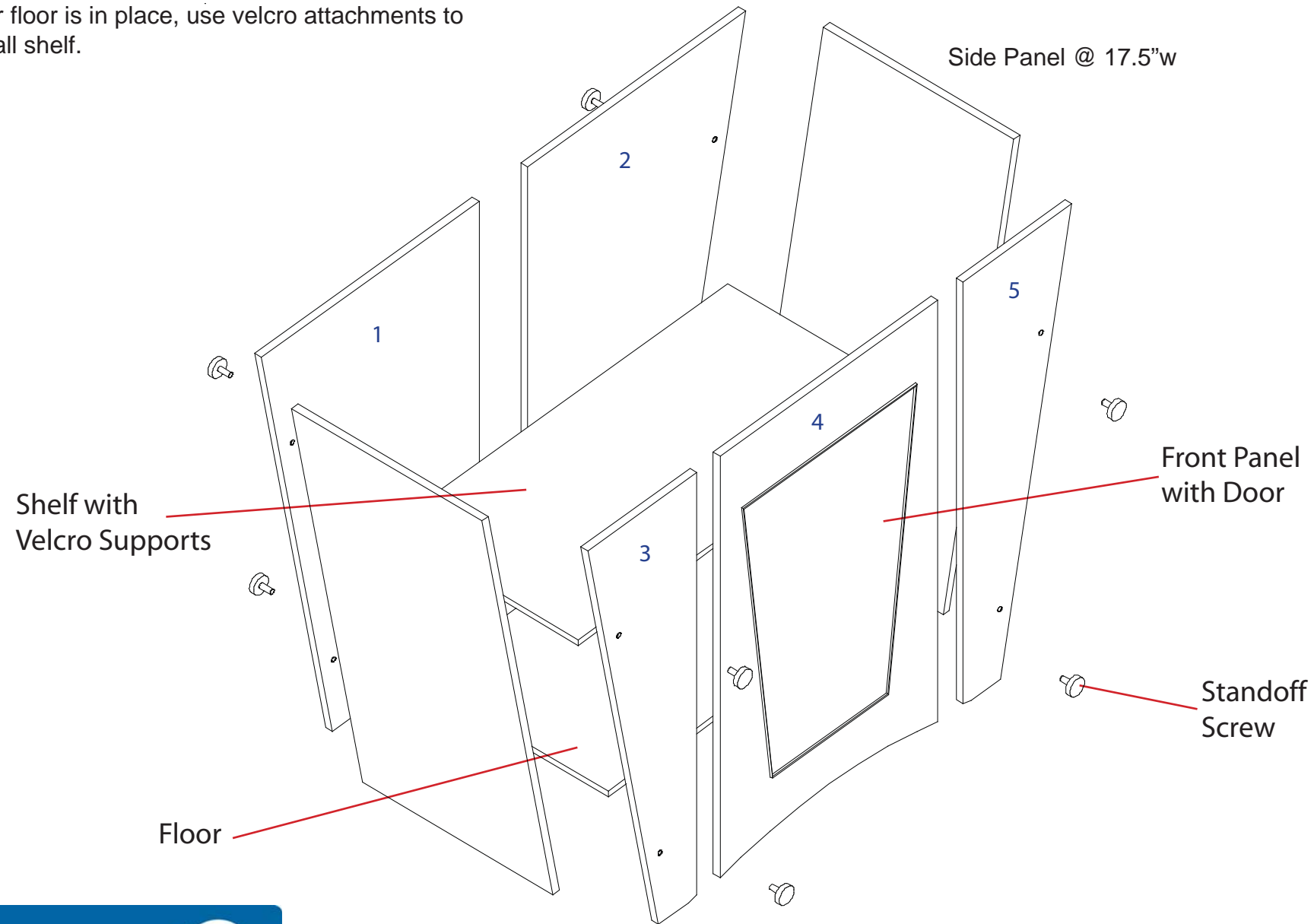
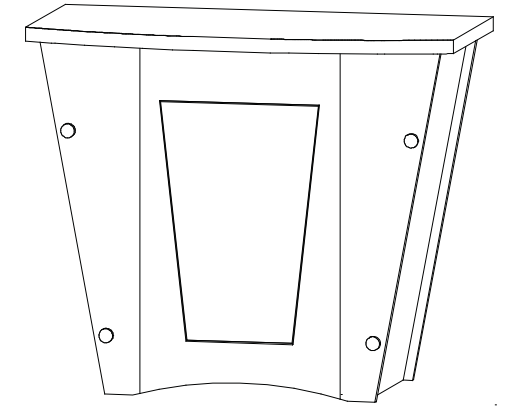

Attach the counter top to the pedestal base.

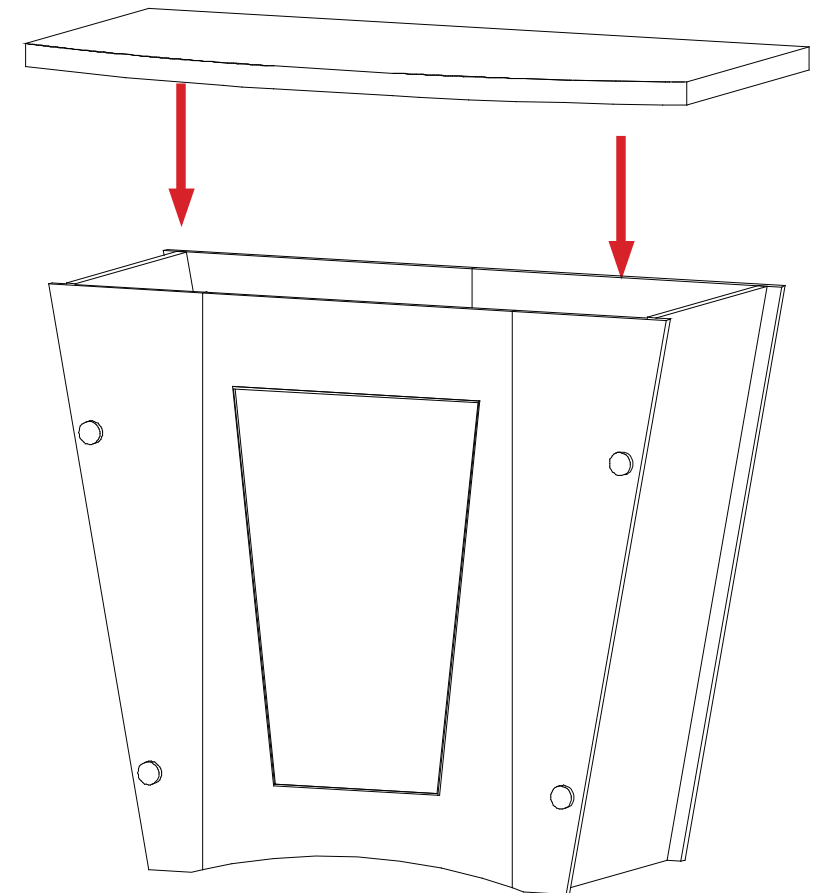

WHEN DISASSEMBLING ALUMINUM EXTRUSION, TIGHTEN ALL SETSCREWS AND LOCKS TO PREVENT LOSS DURING SHIPPING

Setup Instructions:

- A) Use standoff screws to secure the front panel with door and back panel of the pedestal to the side panels.
- B) After assembling front, back, and side panels, slide floor into the bottom of the pedestal. The floor will sit on pins on the inside of the side panels.
- C) After floor is in place, use velcro attachments to install shelf.

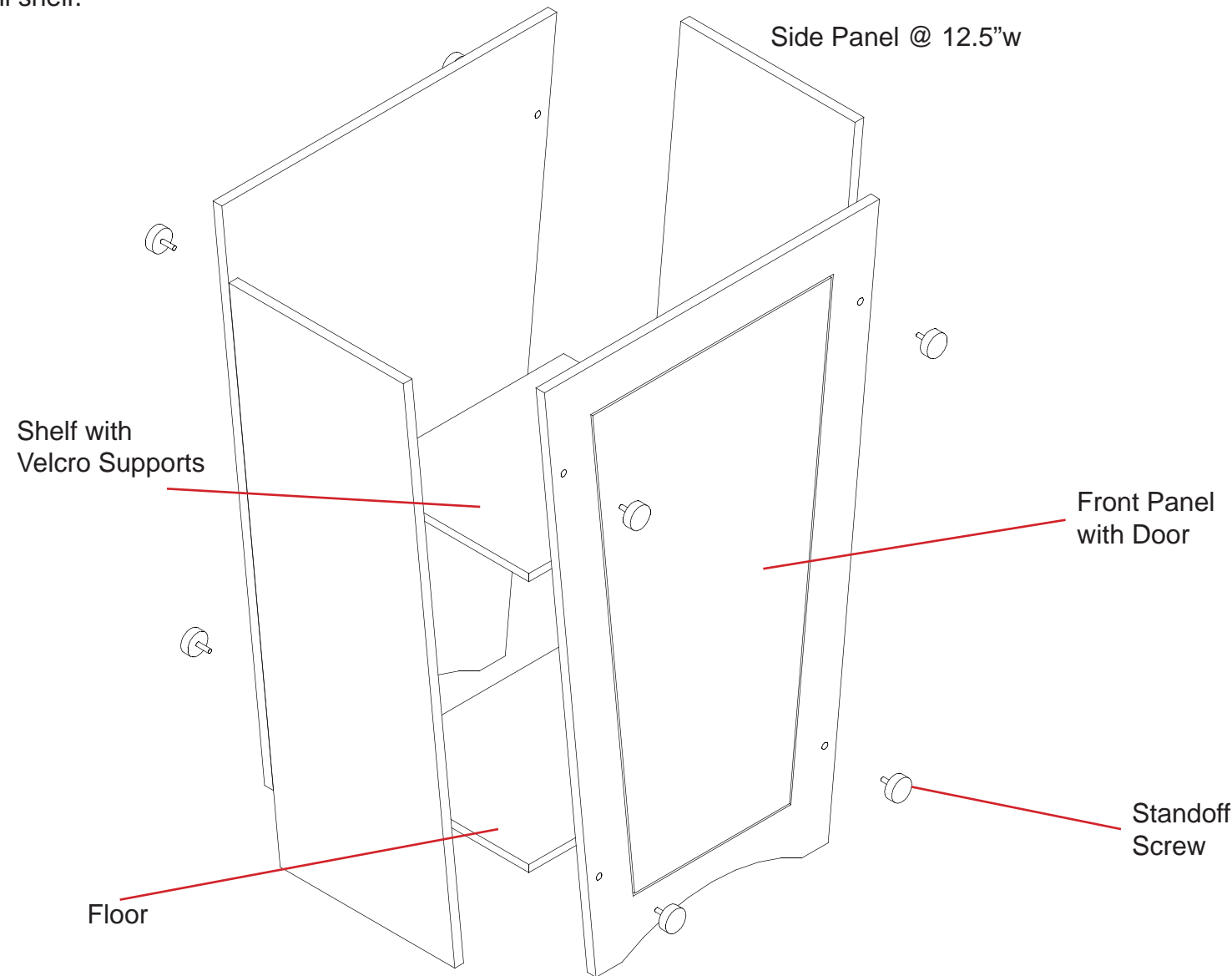
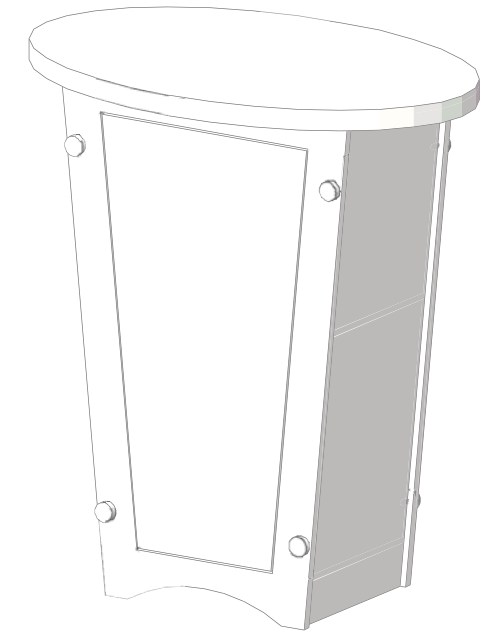

Attach the oval counter top to the pedestal base.

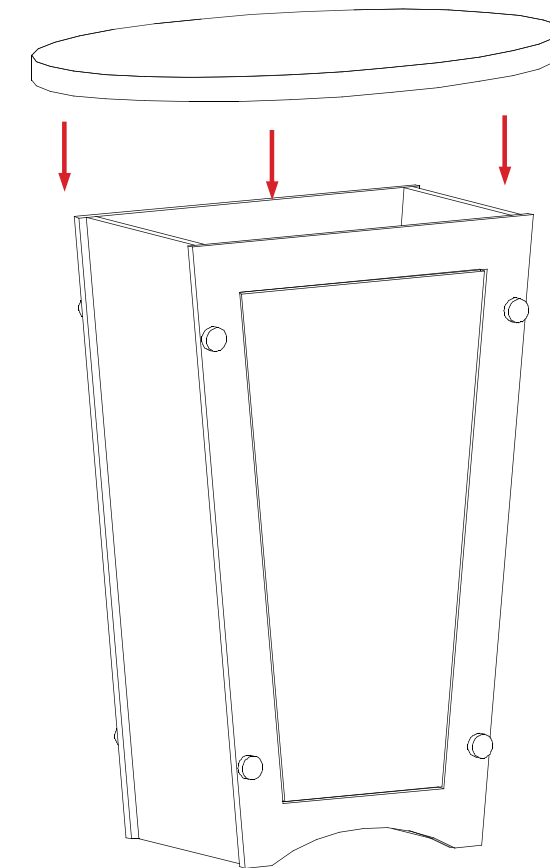

**WHEN DISASSEMBLING ALUMINUM EXTRUSION, TIGHTEN ALL SETSCREWS AND LOCKS TO PREVENT LOSS DURING SHIPPING**