

WHEN DISASSEMBLING ALUMINUM EXTRUSION, TIGHTEN ALL SETSCREWS AND LOCKS TO PREVENT LOSS DURING SHIPPING

visionary™ DESIGNS

Using Your Setup Instructions

The Visionary Designs Setup Instructions are created specifically for your configuration. They are laid out sequentially, including an exploded view of the entire display, and then a logical series of detailed steps to assemble the main structure and components. We encourage you to study the instructions **before** attempting to assemble your exhibit.

Each page reminds you to tighten the setscrews after disassembling your exhibit to prevent loss of the locks and setscrews (see below in RED). This is **VERY IMPORTANT**.

Cleaning and Packing Your Display

- 1) Use care when cleaning aluminum extrusion or acrylic inserts. Use only non-abrasive cleaners.
- 2) When cleaning laminate inserts or countertops, use mild cleansers and a soft material such as cotton.
- 3) Keep all display components away from extreme heat and long exposure to sunlight to avoid warping and fading.
- 4) Retain all packing material. It will make re-packing much easier and will reduce the likelihood of shipping damage.



The Tool

Most Visionary Designs exhibits can be assembled with the supplied Hex Key Tool. Occasionally, a flat head screwdriver may be required.



Detail A

Typical Connection



Typical Connection (cont'd)

Most horizontal extrusion connections have a patented expandable lock. This lock inserts into the groove of an opposing extrusion. Tightening the lock with the Hex Key Tool expands the lock and creates a strong positive connection.



Detail B

Numbered Label

Each extrusion contains a numbered label which corresponds with setup instructions. The label is located within a groove of the extrusion (when possible). With Visionary Designs the labels contain Black numbers unless otherwise specified.



Detail C

Horizontal Inline Connection (remove only one setscrew)

Remove only (1) setscrew when disassembling. Replace setscrew in extrusion after assembling it. Before packing, replace setscrew in extrusion to avoid losing it.



Detail D

Base Plate Connection

Attach base plate to round or square vertical extrusion using the bolt provided. Be careful not to strip the threads.



Detail E

Vertical Connection
(remove only two setscrews)

When vertical extrusions are packed in portable cases rather than crates or tubs, they must be broken down into smaller sections which then require assembly.

Remove only (2) setscrews when disassembling. Replace setscrews in extrusion after assembling it. Before packing, replace setscrews in extrusion to avoid losing them.

WHEN DISASSEMBLING ALUMINUM EXTRUSION, TIGHTEN ALL SETSCREWS AND LOCKS TO PREVENT LOSS DURING SHIPPING

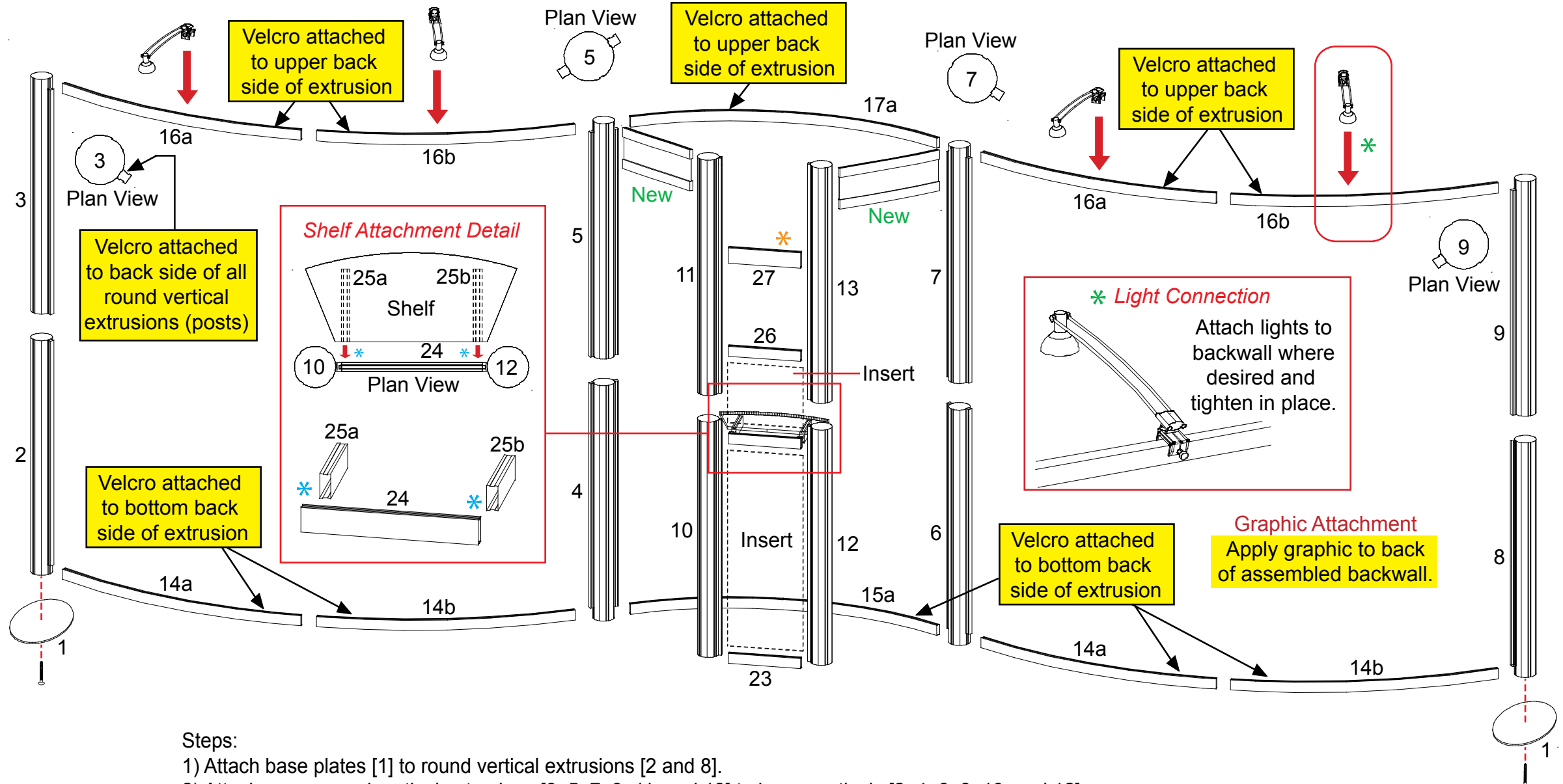
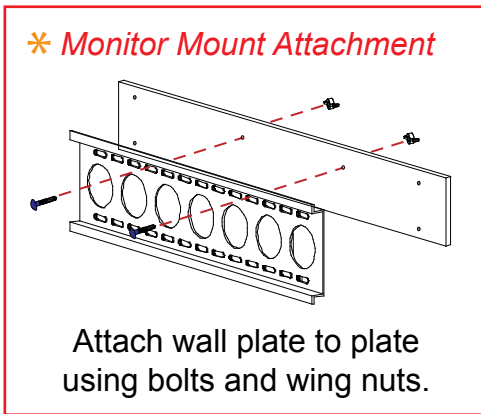
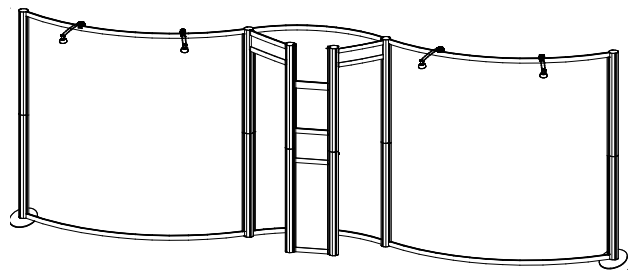

Item	Qty.	Description
1	2	Base Plate
2	1	41.875" Vertical Extrusion
3	1	41.875" Vertical Extrusion
4	1	42" Vertical Extrusion
5	1	42" Vertical Extrusion
6	1	42" Vertical Extrusion
7	1	42" Vertical Extrusion
8	1	41.875" Vertical Extrusion
9	1	41.875" Vertical Extrusion
10	1	42" Vertical Extrusion
11	1	42" Vertical Extrusion
12	1	42" Vertical Extrusion
13	1	42" Vertical Extrusion
14a/14b	2/2	45.0856" Curved Horizontal Extrusion
15a	1	52.1146" Curved Horizontal Extrusion
16a/16b	2/2	45.0856" Curved Horizontal Extrusion
17a	1	52.1146" Curved Horizontal Extrusion
New	2	30.395" Horizontal Header Extrusion

Steps:

- 1) Attach base plates [1] to round vertical extrusions [2 and 8].
- 2) Attach upper round vertical extrusions [3, 5, 7, 9, 11, and 13] to lower verticals [2, 4, 6, 8, 10, and 12].
- 3) Connect curved horizontal extrusions [14a&14b] and [16a&16b] together as shown.
- 4) Attach lower and upper curved horizontal assemblies [14 and 16] between vertical assemblies as shown.
- 5) Attach lower and upper curved horizontal extrusions [15a and 17a] between vertical assemblies as shown.
- 6) Attach horizontal extrusion [23] between round vertical extrusions [10 and 12].
- 7) Slide large insert into groove between vertical assemblies [10/11 and 12/13].
- 8) Attach horizontal extrusion [24] between round vertical extrusions [10 and 12].
- 9) Pill slot attach shelf with shelf supports [25a and 25b] to horizontal extrusion [24]. Refer to detail.
- 10) Slide smaller insert into groove between vertical assemblies [10/11 and 12/13].
- 11) Attach horizontal extrusion [26 and 27] between round vertical extrusions [11 and 13] as shown.
- 12) Attach horizontal header extrusions [New] at top between vertical extrusions [5&11 and 7&13] as shown.
- 13) Attach lights atop assembled backwall as shown. Refer to detail. Attach graphics to back of assembled backwall.
- 14) Attach monitor mount to back side of horizontal extrusion [27]. Refer to detail.

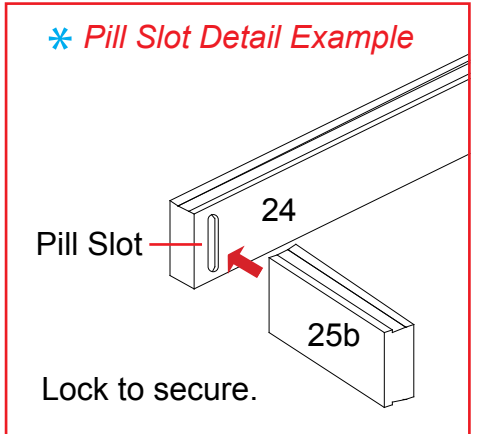

WHEN DISASSEMBLING ALUMINUM EXTRUSION, TIGHTEN ALL SETSCREWS AND LOCKS TO PREVENT LOSS DURING SHIPPING

866.652.2100

Item	Qty.	Description
28a/28b	1/1	41.6261" Curved Horizontal Extrusion
29	2	20.4173" Vertical Extrusion
29a/29b	1/1	20.4173" Vertical Extrusion with Door Stopper/Hinges
30a/30b	1	41.6261" Curved Horizontal Extrusion
31	2	46.4170" Vertical Extrusion
31a/31b	1/1	46.4170" Vertical Extrusion with Door Stopper/Hinges
32a/32b	1/1	41.6261" Curved Horizontal Extrusion
33	2	10"h Vertical Extrusion
34a/34b	1/1	41.6261" Curved Horizontal Extrusion
35	1	12"h Round Vertical Extrusion with Velcro

Steps:

- 1) Connect curved horizontal extrusions [28a and 28b] together.
- 2) Attach vertical extrusions [29, 29a and 29b] to round assembly [28a/28b] as shown.
- 3) Slide black inserts between vertical extrusions [29, 29a and 29b] and attach smaller door between verticals [29a and 29b] as shown. Refer to *Door Attachment* detail.
- 4) Connect curved horizontal extrusions [30a and 30b] together.
- 5) Attach round assembly [30a/30b] atop verticals [29, 29a and 29b] as shown.
- 6) Place round laminated floor atop assembled base as shown.
- 7) Attach vertical extrusions [31, 31a and 31b] to round assembly [30a/30b] as shown.
- 8) Slide clear acrylic inserts between vertical extrusions [31, 31a and 31b] and attach large door between verticals [31a and 31b] as shown. Refer to *Door Attachment* detail.
- 9) Connect curved horizontal extrusions [32a and 32b] together.
- 10) Attach round assembly [32a/32b] atop verticals [31, 31a and 31b] as shown.
- 11) Attach pins to vertical extrusions [31, 31a and 31b] about 9" between floor, shelves, and ceiling for shelf support. Refer to *Pin Attachment Example*.
Note: Attach pins to three vertical extrusions and plastic extrusion for wiring to fourth vertical extrusion.
- 12) Drop shelf above vertical extrusions [31, 31a and 31b] onto pins for shelf support. Note: Notch cutout in shelf must match vertical extrusions when dropping shelf. Large notch in shelf must align with plastic vertical extrusion for wiring. Attach pins to vertical extrusions [31, 31a and 31b] just above shelf to avoid shelf uplift. Repeat steps [11 and 12] for additional shelves.
- 13) Place round laminated ceiling atop assembled showcase as shown.
Note: Laminated ceiling finish must face down. Attach pin to curved horizontal extrusion [32b] to avoid ceiling uplift.
- 14) Attach vertical extrusions [33] to round assembly [32a/32b] as shown.
- 15) Slide graphic inserts between vertical extrusions [33].
- 16) Connect curved horizontal extrusions [34a and 34b] together as shown.
- 17) Attach round assembly [34a/34b] atop verticals [33] as shown.
- 18) Twist threaded vertical extrusion [35] onto ceiling bolt to secure in place.
- 19) Velcro lights to vertical extrusion [35] as shown.

****Puck Lights** - Attach puck lights from bottom of ceiling.
Note: Light facing down.

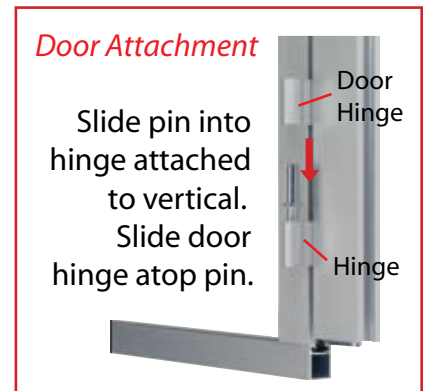
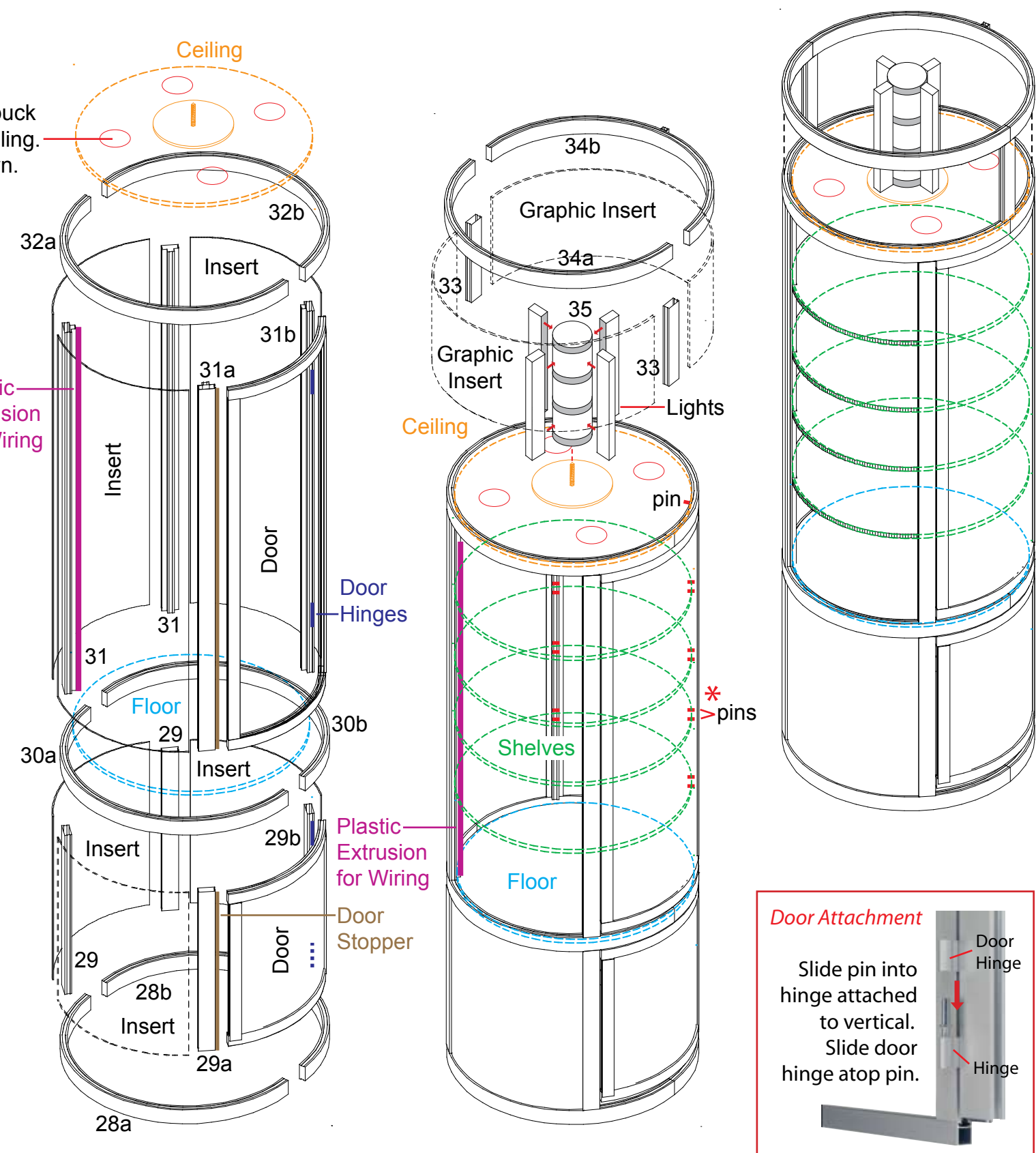
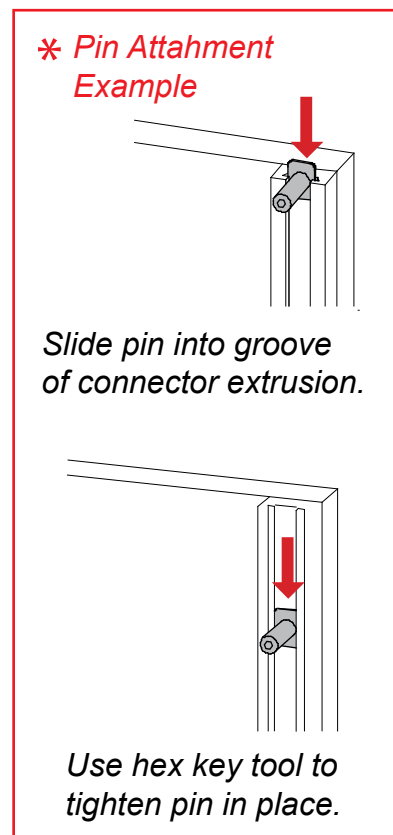

WHEN DISASSEMBLING ALUMINUM EXTRUSION, TIGHTEN ALL SETSCREWS AND LOCKS TO PREVENT LOSS DURING SHIPPING

866.652.2100

Item	Qty.	Description
19	1	51.5281" Curved Horizontal Header Extrusion
20	1	7.9"h "V" Shaped Vertical Extrusion
22	1	7.9"h Angled Vertical Extrusion

Steps:

- 1) Attach vertical extrusion [22] to curved header extrusion [19] as shown. Note: Keep assembled when shipping.
- 2) Attach horizontal header assembly [22 and 19] between curved extrusion [34b - S10 Connector Piece] and vertical extrusion [13] as shown. Note: Position showcase appropriately for header assembly attachment.

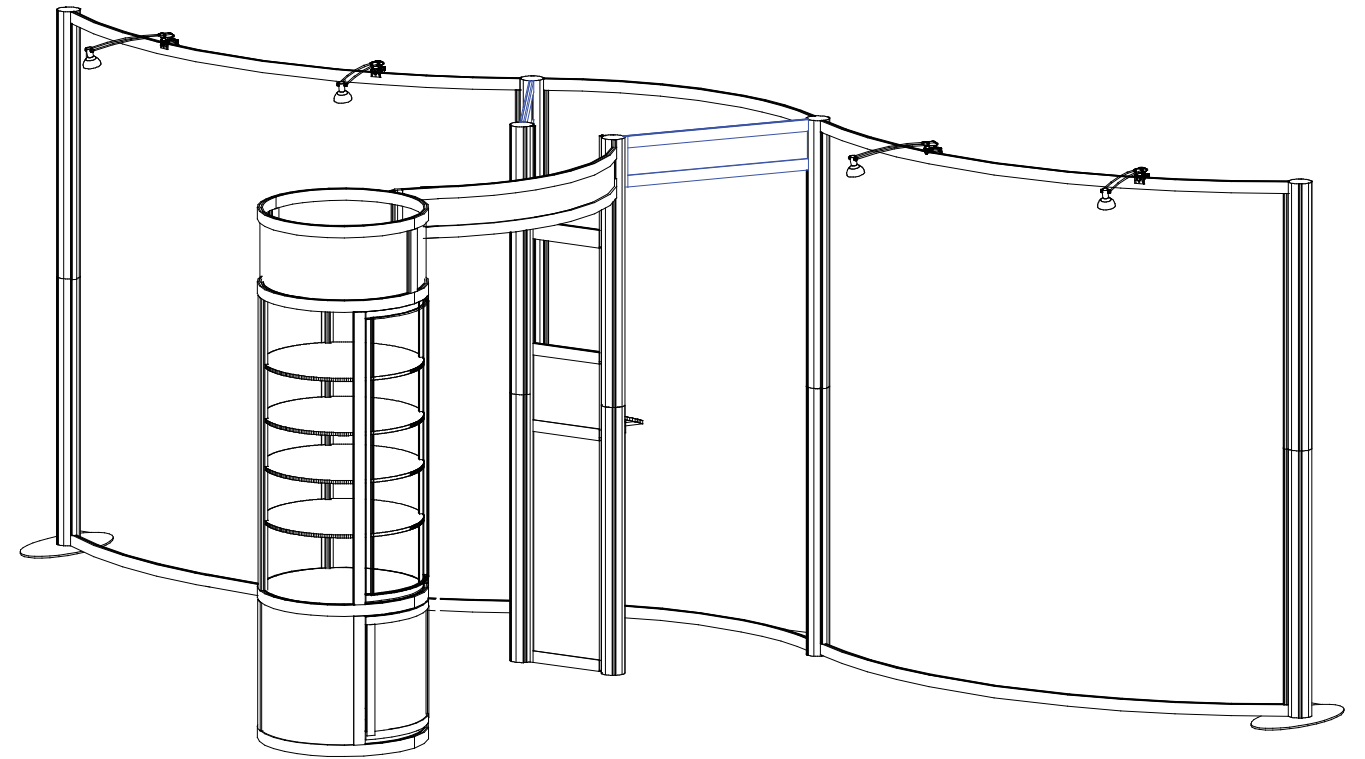

Exploded View

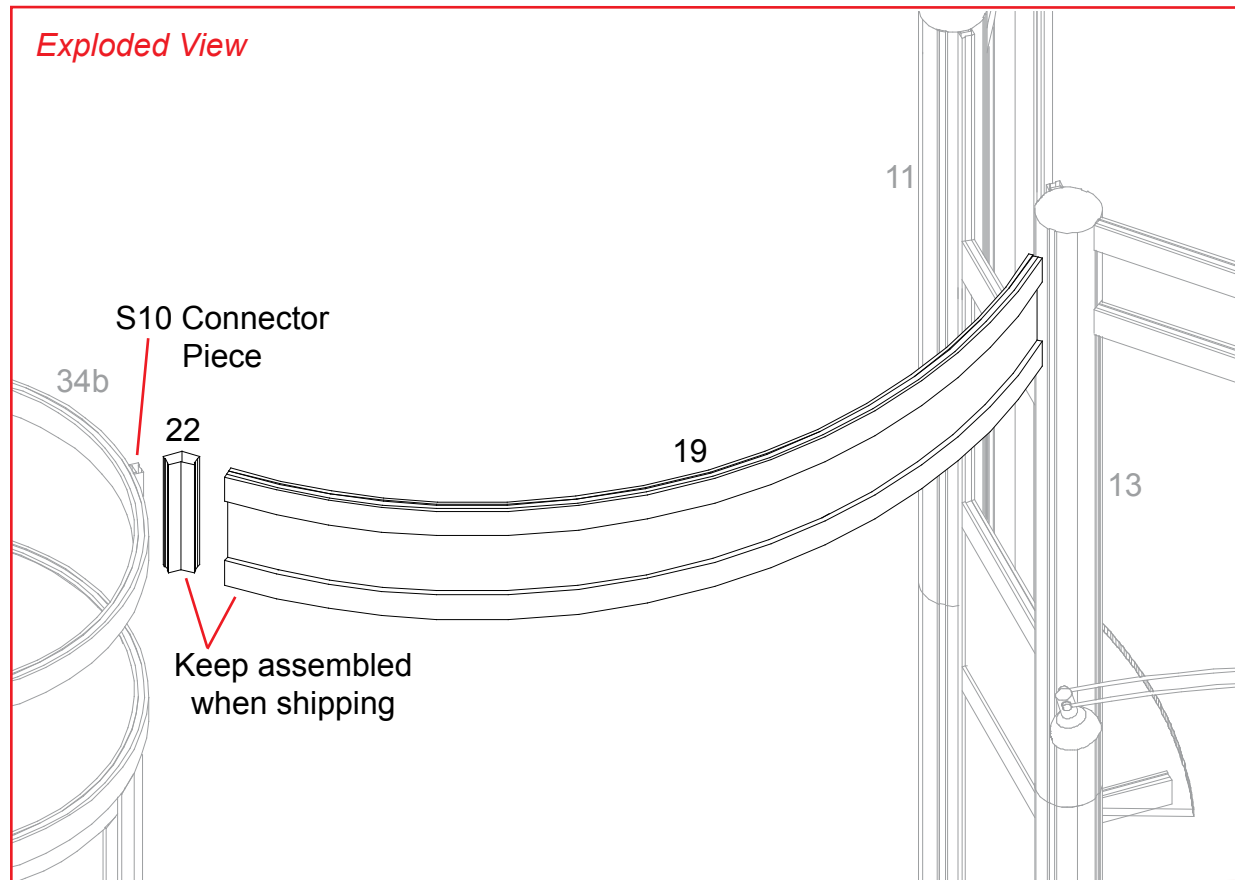

Assembled View

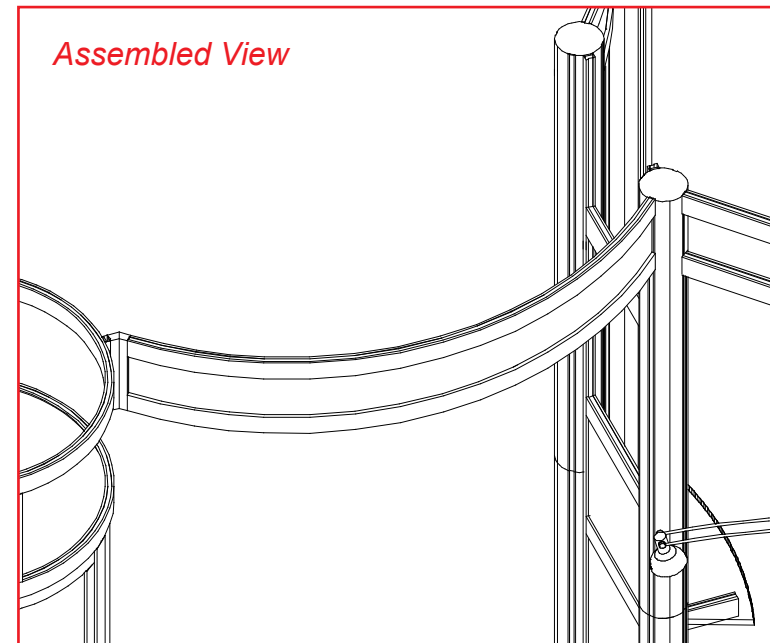

WHEN DISASSEMBLING ALUMINUM EXTRUSION, TIGHTEN ALL SETSCREWS AND LOCKS TO PREVENT LOSS DURING SHIPPING