

**1 Intro Folding Panel System**

**16 Panel Display Backwall Set-up Instructions**

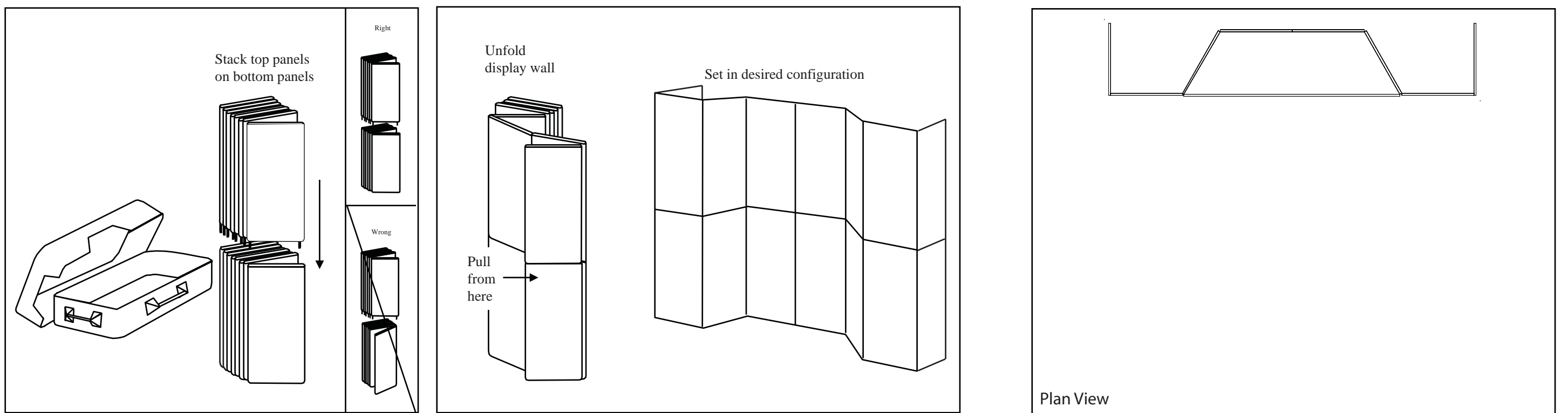

**1.**  
 Remove each folded sections from case or cases. Stand bottom section up (the unit with adjustable feet) with adjustable feet down. Lift top section up (the unit with pegs) pegs down and slide into receiving holes in bottom section. **NOTE:** Make sure panels are folded the same way (see diagrams).

**2.**  
 Slowly unfold unit by pulling on the bottom panels while supporting the top with your other hand while forming into desired configuration.

**WHEN DISASSEMBLING ALUMINUM EXTRUSION, TIGHTEN ALL SETSCREWS AND LOCKS TO PREVENT LOSS DURING SHIPPING**

## 2 Intro Folding Panel System

### 70" Header Set-up Instructions

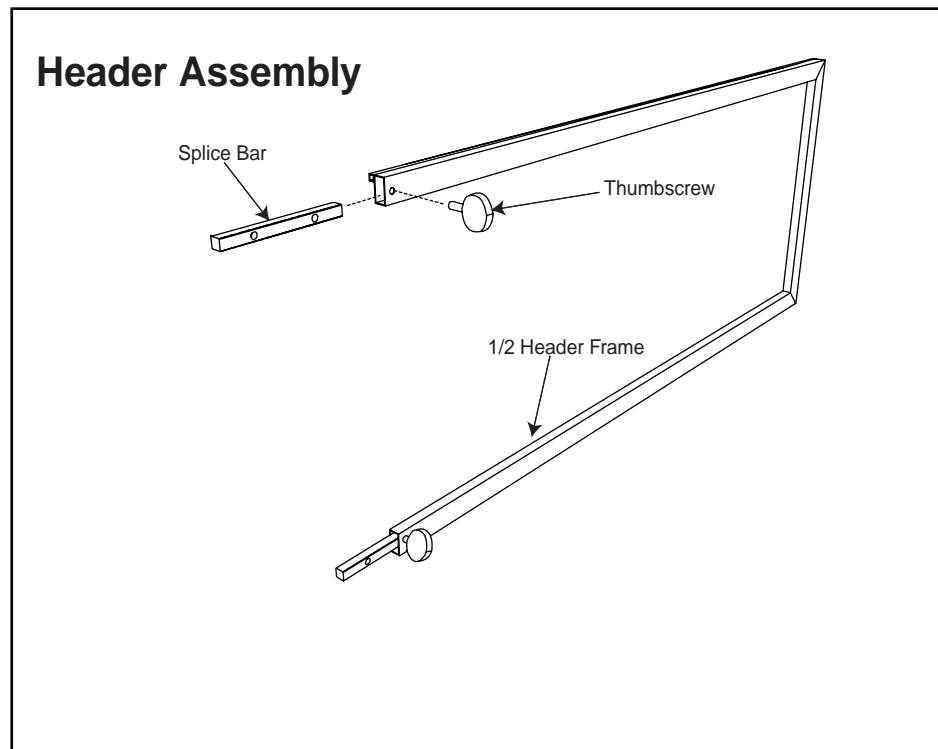

1.

Insert Splice Bars into one half of Header Frame and secure with Thumbscrews as shown.  
Slide second half of Header Frame over Splice Bars and secure with supplied Thumbscrews.  
When attaching Header onto the Backwall make sure Thumbscrews are facing to back of booth.

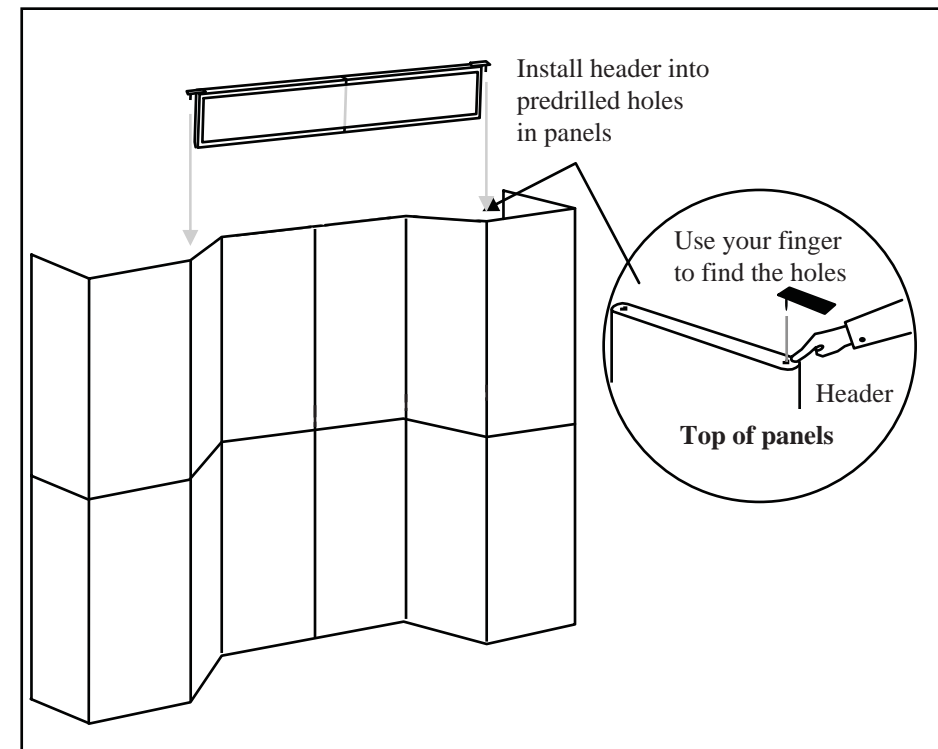

2.

Then install header by inserting header pins into pre-drilled holes in panel tops (Use your finger to find holes). Install ceiling diffuser panels into bottom channels of header and ceiling supports.

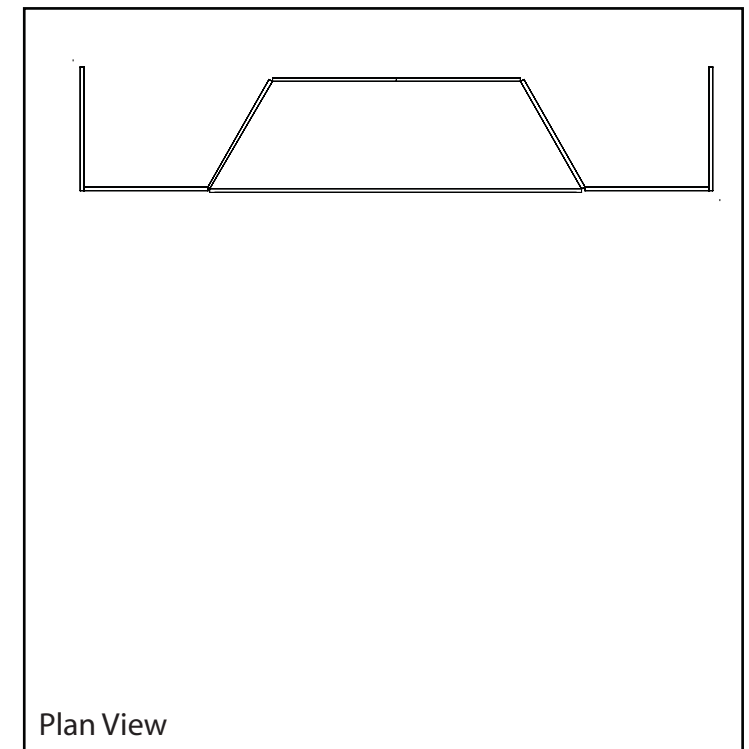

**WHEN DISASSEMBLING ALUMINUM EXTRUSION, TIGHTEN ALL SETSCREWS AND LOCKS TO PREVENT LOSS DURING SHIPPING**