

visionary[™]
DESIGNS

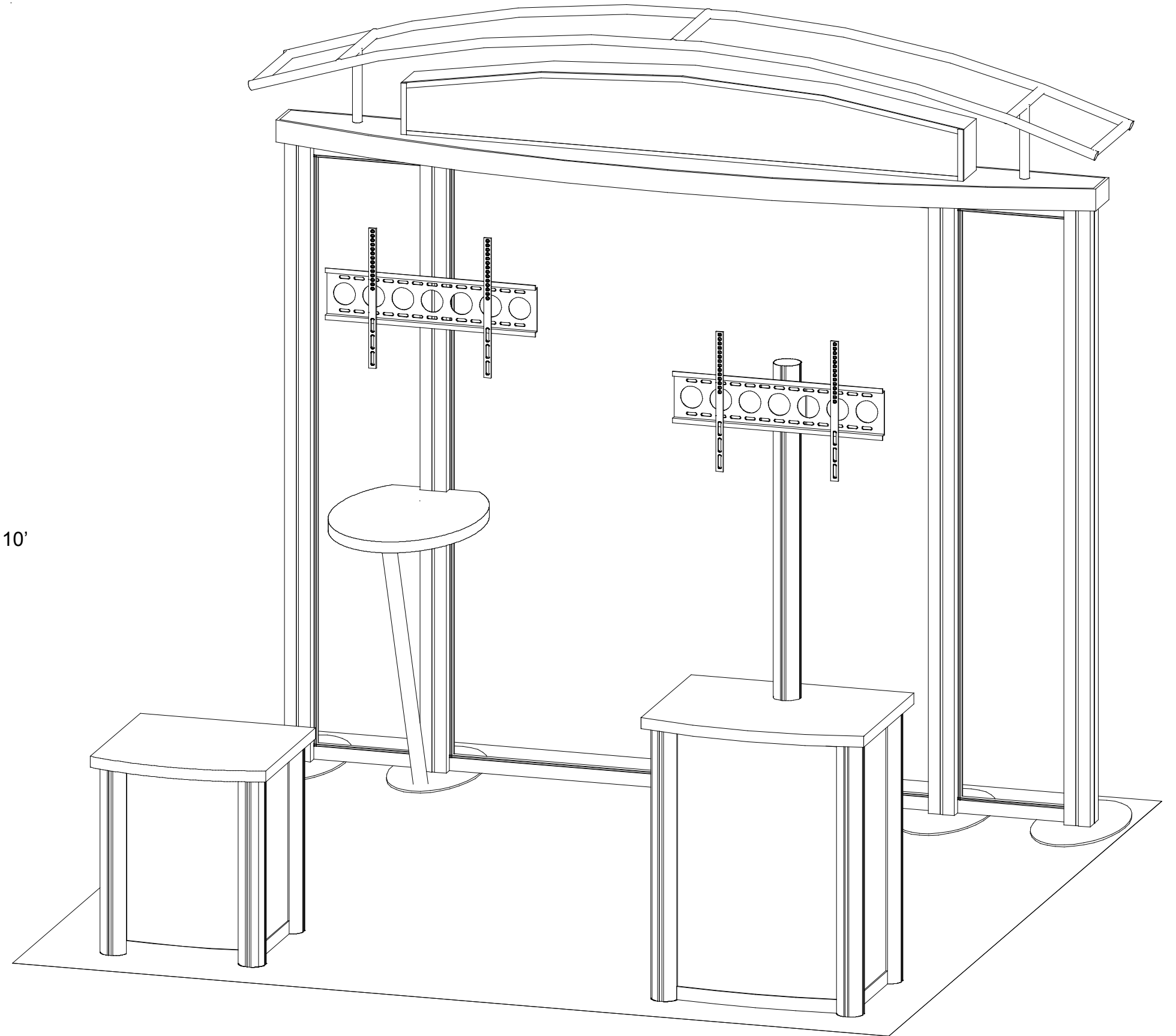
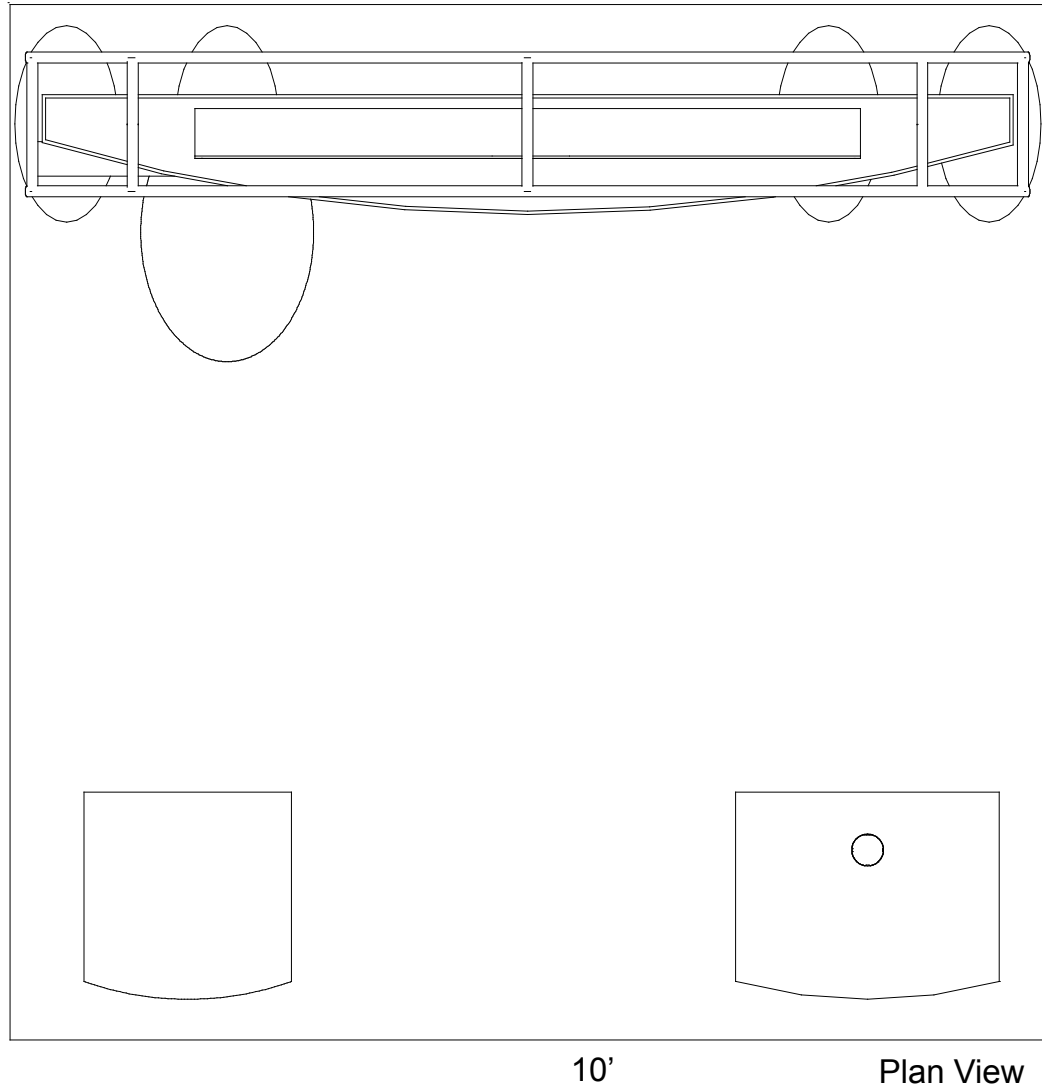

WHEN DISASSEMBLING ALUMINUM EXTRUSION, TIGHTEN ALL SETSCREWS AND LOCKS TO PREVENT LOSS DURING SHIPPING

visionary™ DESIGNS

Using Your Setup Instructions

The Visionary Designs Setup Instructions are created specifically for your configuration. They are laid out sequentially, including an exploded view of the entire display, and then a logical series of detailed steps to assemble the main structure and components. We encourage you to study the instructions **before** attempting to assemble your exhibit.

Each page reminds you to tighten the setscrews after disassembling your exhibit to prevent loss of the locks and setscrews (see below in RED). This is **VERY IMPORTANT**.

Cleaning and Packing Your Display

- 1) Use care when cleaning aluminum extrusion or acrylic inserts. Use only non-abrasive cleaners.
- 2) When cleaning laminate inserts or countertops, use mild cleansers and a soft material such as cotton.
- 3) Keep all display components away from extreme heat and long exposure to sunlight to avoid warping and fading.
- 4) Retain all packing material. It will make re-packing much easier and will reduce the likelihood of shipping damage.



The Tool

Most Visionary Designs exhibits can be assembled with the supplied Hex Key Tool. Occasionally, a flat head screwdriver may be required.



Typical Connection

Most horizontal extrusion connections have a patented expandable lock. This lock inserts into the groove of an opposing extrusion. Tightening the lock with the Hex Key Tool expands the lock and creates a strong positive connection.



Typical Connection (cont'd)

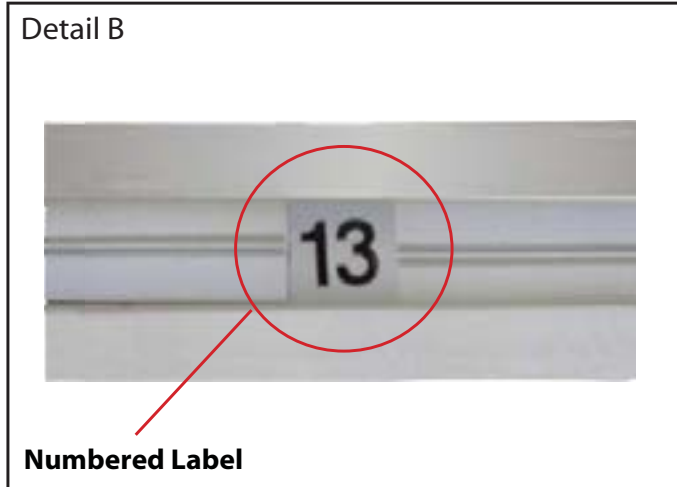

Numbered Label

Each extrusion contains a numbered label which corresponds with setup instructions. The label is located within a groove of the extrusion (when possible). With Visionary Designs the labels contain Black numbers unless otherwise specified.



Horizontal Inline Connection (remove only one setscrew)

Remove only (1) setscrew when disassembling. Replace setscrew in extrusion after assembling it. Before packing, replace setscrew in extrusion to avoid losing it.

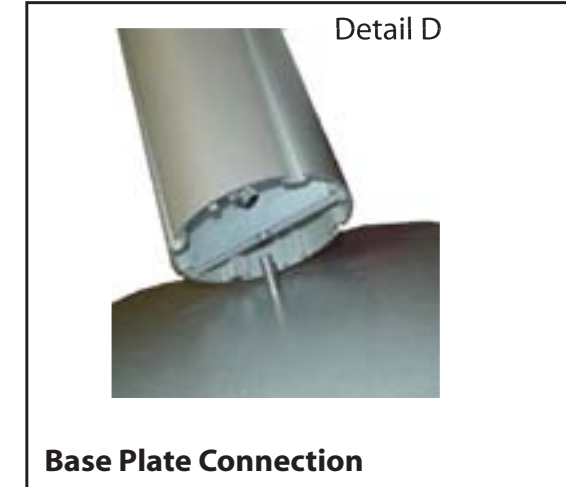

Base Plate Connection

Attach base plate to round or square vertical extrusion using the bolt provided. Be careful not to strip the threads.

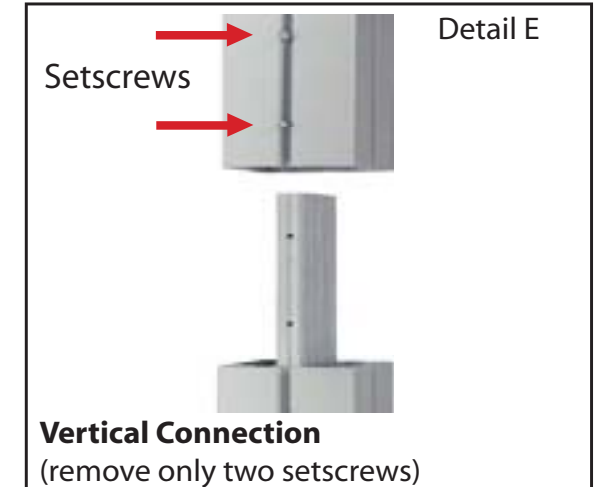

Vertical Connection
(remove only two setscrews)

When vertical extrusions are packed in portable cases rather than crates or tubs, they must be broken down into smaller sections which then require assembly.

Remove only (2) setscrews when disassembling. Replace setscrews in extrusion after assembling it. Before packing, replace setscrews in extrusion to avoid losing them.

WHEN DISASSEMBLING ALUMINUM EXTRUSION, TIGHTEN ALL SETSCREWS AND LOCKS TO PREVENT LOSS DURING SHIPPING

SEG Graphic Installation

Graphic: To Ensure Proper Fit

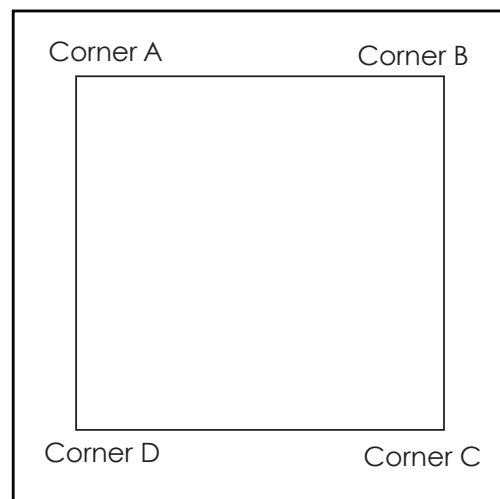

It is important to first insert graphic into each alternater corner then to the sides of the frame.
If this is not done, graphic will not fit into the frame correctly.



Step 1
Insert corner A.
Turn edge of graphic so silicon welt is perpendicular to face of graphic.
Insert narrow side of welt with fabric to outside into the channel.
Repeat for other side of this corner.



Step 2
Repeat Step 1 for opposite corner C, then insert corner B, followed by corner corner D, to complete the installation of the corners.



Step 3
Once all corners are inserted, press one silicon edge into channel from corners and work toward the center. Make sure welt is fully inserted into channel. Continue until all sides are done. Smooth out edges of graphic.

Graphic Removal



To remove the graphic from the frame, locate the fabric pull tab.
Gently pull up on the tab to remove the fabric.

WHEN DISASSEMBLING ALUMINUM EXTRUSION, TIGHTEN ALL SETSCREWS AND LOCKS TO PREVENT LOSS DURING SHIPPING

866.652.2100

Item	Qty.	Description
1/1a	3/1	Base
2	1	84" h Vertical Extrusions
3	2	84" h Vertical Extrusions
4	1	84" h Vertical Extrusions
5	2	15" w Horizontal Extrusion
6	1	66" w Horizontal Extrusion
7	2	15" w Horizontal Extrusion
8	1	66" w Horizontal Extrusion

Steps:

- 1) Attach vertical extrusions [2,3,4] to base plates [1 and 1a] as shown.
- 2) Attach horizontal extrusions [6 and 8] between vertical extrusions [3 and 3].
- 3) Attach horizontal extrusions [5 and 7] between vertical extrusions [2 and 3, 3 and 4].

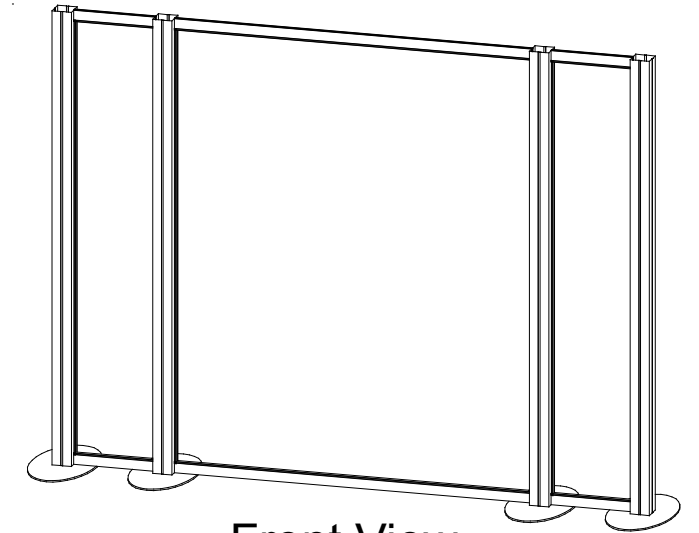

Front View

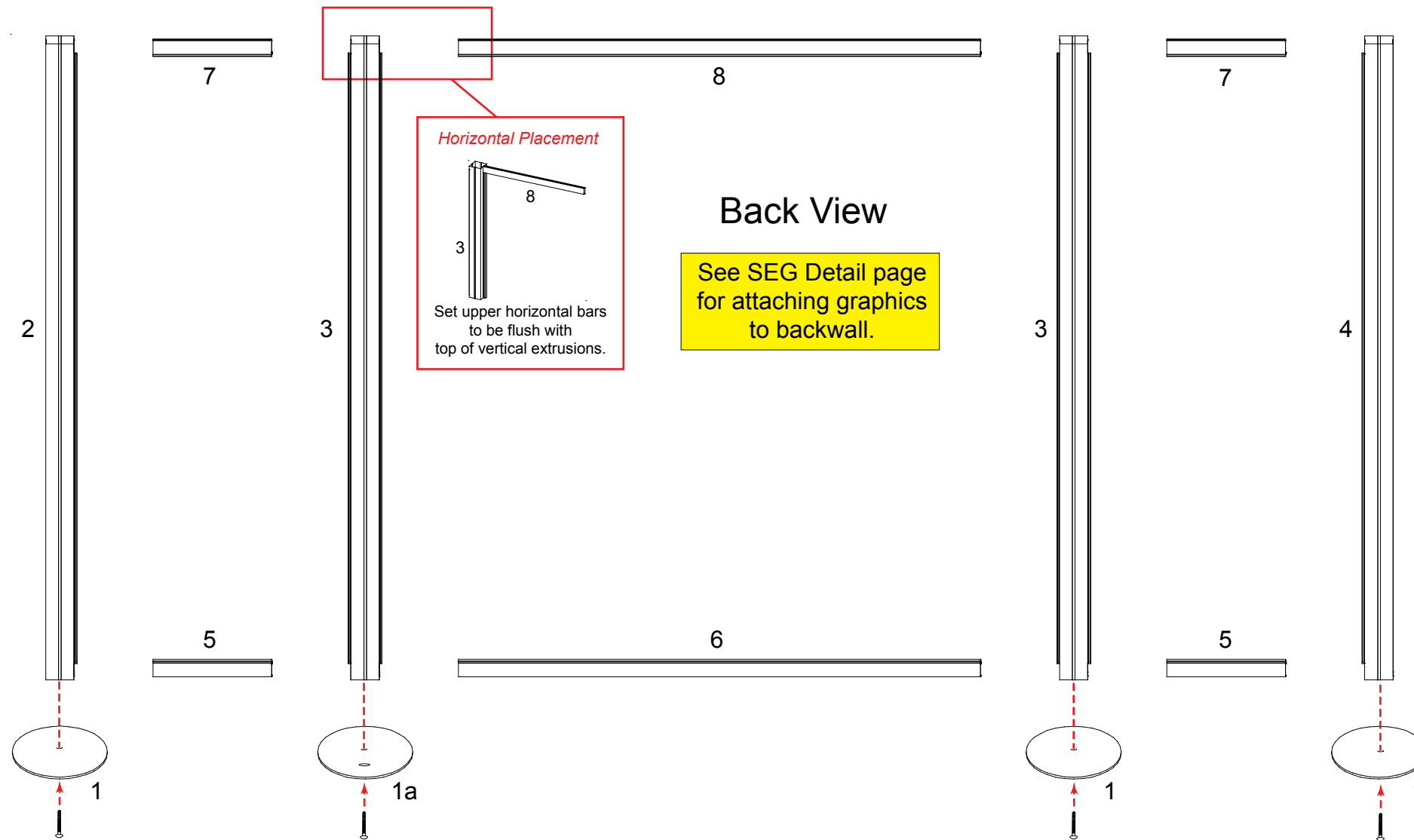

WHEN DISASSEMBLING ALUMINUM EXTRUSION, TIGHTEN ALL SETSCREWS AND LOCKS TO PREVENT LOSS DURING SHIPPING

866.652.2100

Counter Parts

Item	Qty.	Description
9	1	Support Bar
10	1	Leg

Steps:

- 1) Position connectors for monitor mount back plate at the desired height in the second vertical extrusion from the left front of the assembled backwall.
- 2) Attach ceiling to end vertical extrusions of the assembled backwall using screws.
- 3) Attach lights to velcro on ceiling. Feed cord through hole in ceiling.
- 4) Set graphic infill into slot attached to ceiling and place header over infill. Connect header to mounts attached to ceiling.
- 5) Attach header backing to velcro on the back of the header.
- 6) Attach monitor mount back plate to connectors with screws.
- 7) Attach monitor mount to back plate using screws.
- 8) Connect counter support bar [9] to counter leg [10] and then attach to assembled backwall and base [1a].
- 9) Attach counter top as shown in Counter Attachment detail.

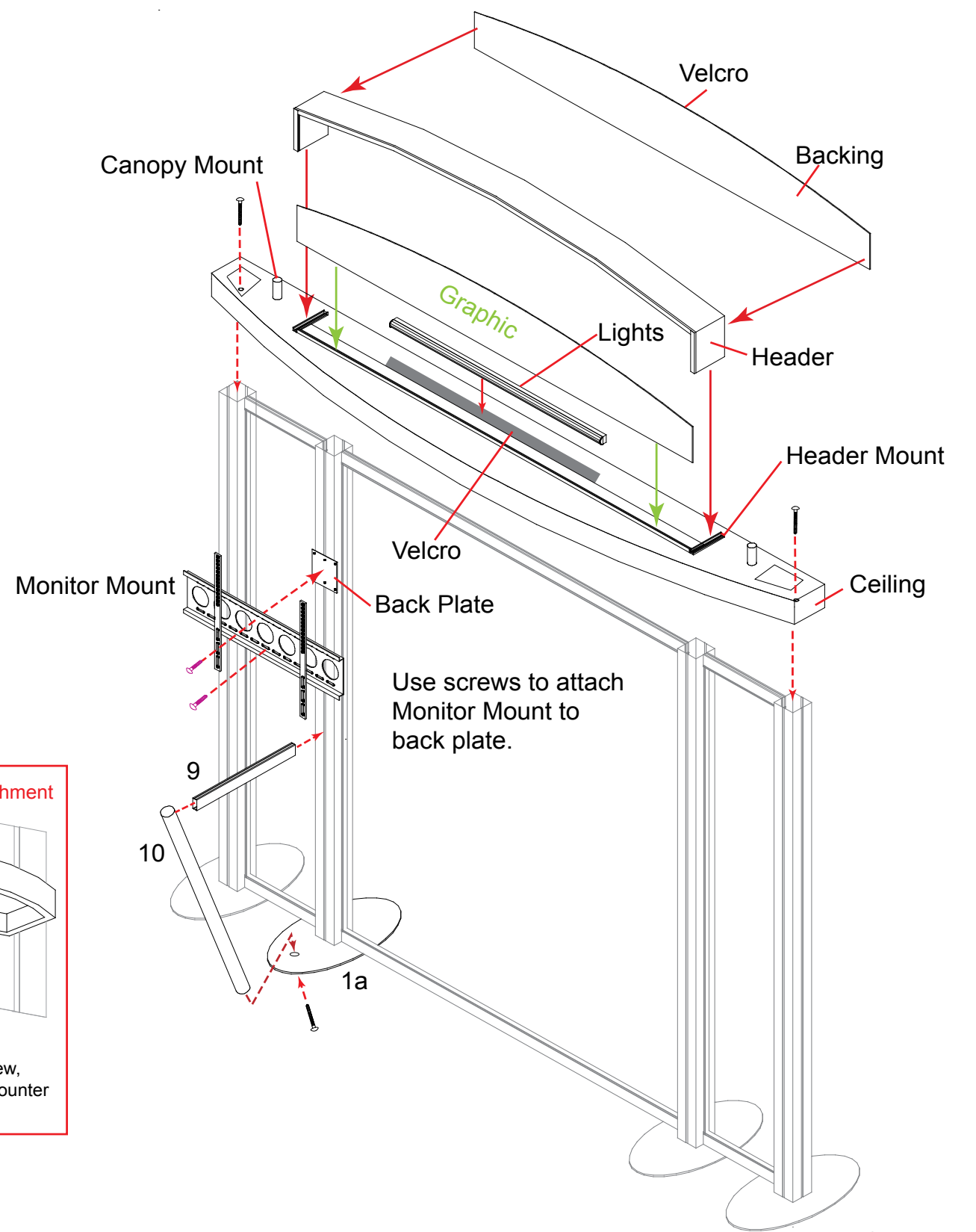
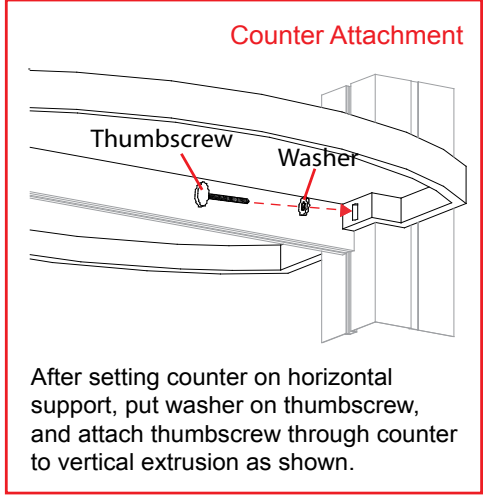
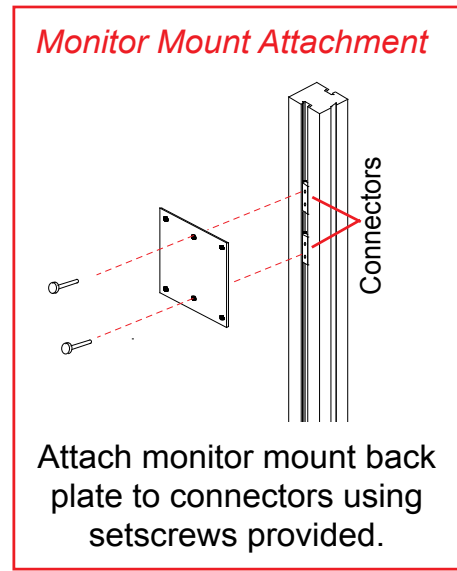

WHEN DISASSEMBLING ALUMINUM EXTRUSION, TIGHTEN ALL SETSCREWS AND LOCKS TO PREVENT LOSS DURING SHIPPING

AERO

Using Your Setup Instructions

The Aero Overhead Sign Setup Instructions are created specifically for your configuration. They include an exploded view of the frame which is sequentially numbered. We encourage you to study the instructions before attempting to assemble your exhibit.

Connections are kept very simple: no tools. Everything assembles with push-button connectors and pre-connected horizontal sections.

Cleaning and Packing Your Display

- 1) Use care when cleaning aluminum extrusion or acrylic inserts. Use only non-abrasive cleaners.
- 2) Retain all packing material. It will make re-packing much easier and will reduce the likelihood of shipping damage.

Steps:

- 1) Connect canopy parts as shown.
- 2) Apply pillowcase covering to assembled canopy.
- 3) Place assembled canopy onto canopy mounts.

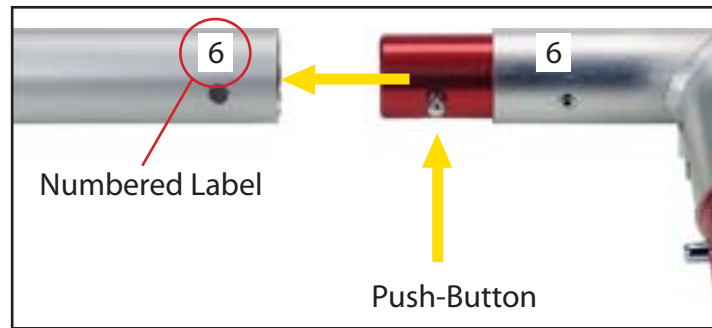

Connections are made by holding the button down and sliding the red tube into opposing tube until the connection is made. To disassemble push button and pull or twist extrusions apart.

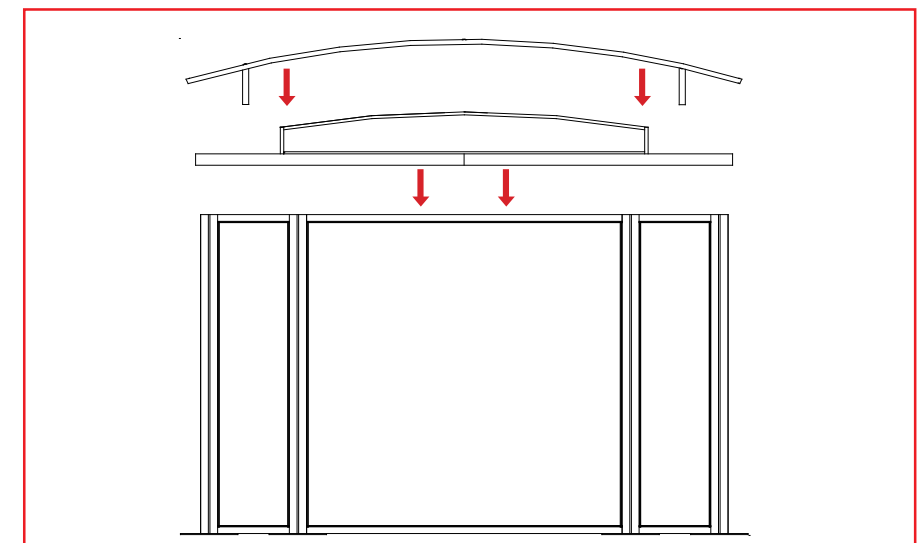
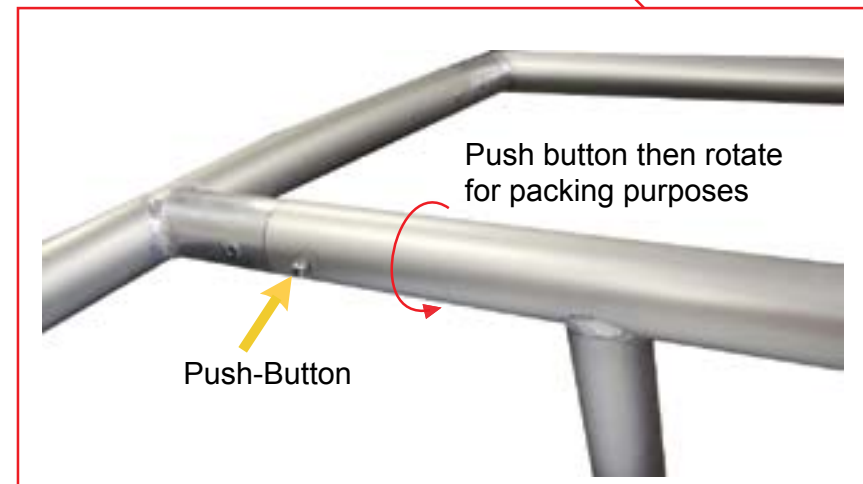
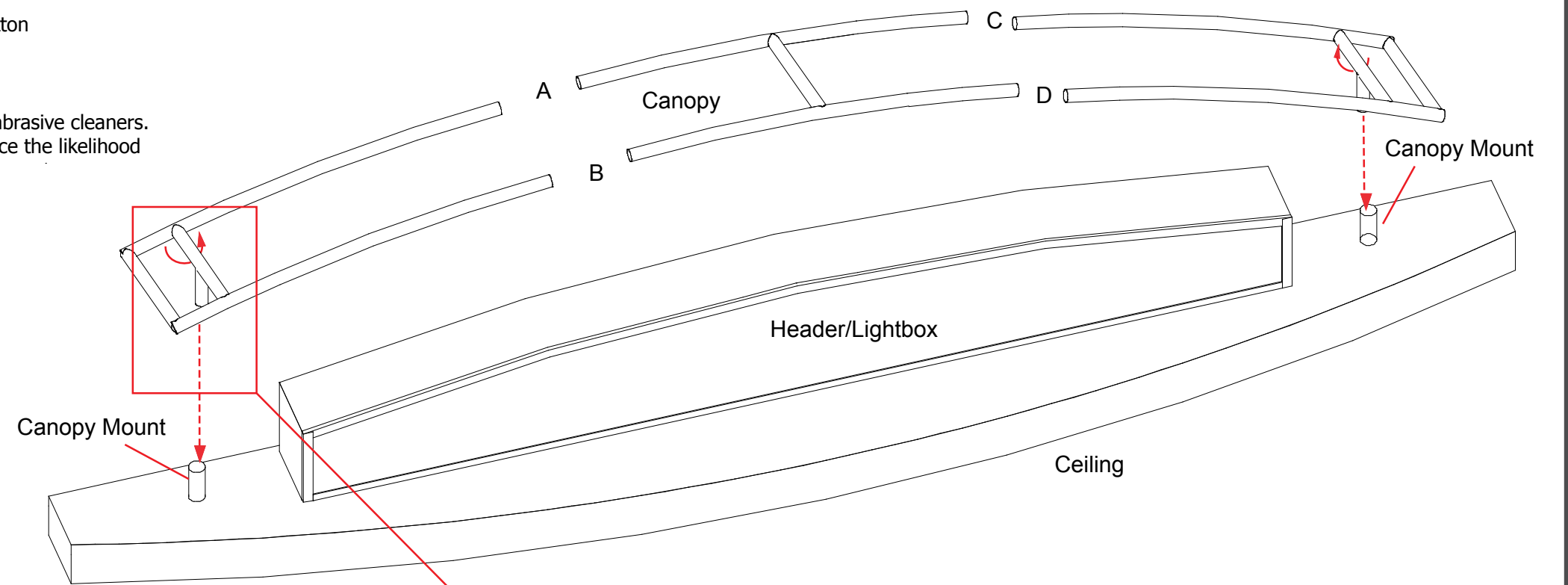
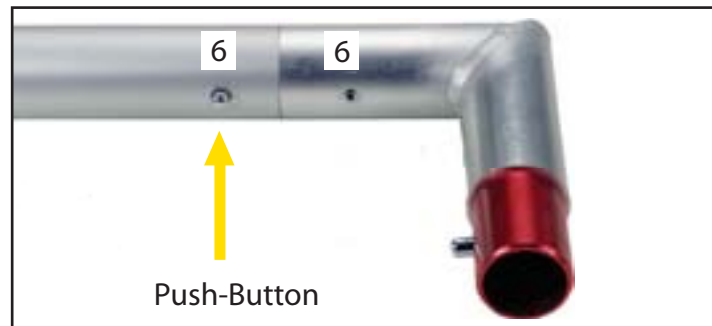

WHEN DISASSEMBLING ALUMINUM EXTRUSION, TIGHTEN ALL SETSCREWS AND LOCKS TO PREVENT LOSS DURING SHIPPING

866.652.2100

Item	Qty.	Description
11	1	38" h Vertical Extrusion
12	1	38" h Vertical Extrusion w/ Hinges
13	1	38" h Vertical Extrusion w/ Door Stop
14	1	38" h Vertical Extrusion
15	4	13.355" w Horizontal Extrusion
16	2	21.835" w Horizontal Extrusion
17	2	21.888" w Curved Horizontal Extrusion
18	1	Post Connector
19	1	Monitor Post

- Steps:
- 1) Attach lower horizontal extrusions [15,16,17] between vertical extrusions [11,12,13,14] as shown.
 - 2) Attach shelf supports to velcro on vertical extrusions as shown.
 - 3) Attach monitor post [19] to lower horizontal extrusion [16] using connector [18].
 - 4) Place internal shelf over monitor post and set atop supports.
 - 5) Insert infills and attach upper horizontal extrusions [15,16,17] to vertical extrusions. Attach door.
 - 6) Place counter top over monitor post and set on assembled pedestal as shown.
 - 7) Set monitor mount at desired height on vertical post.

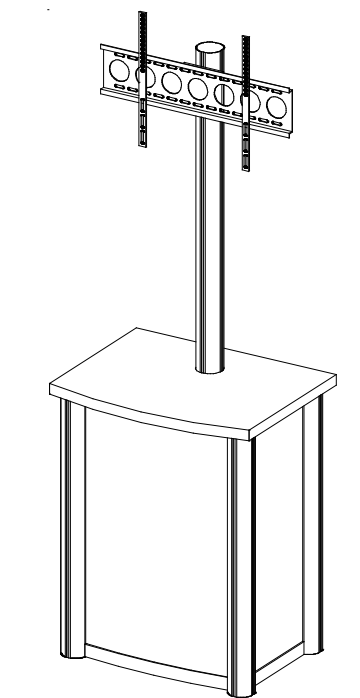
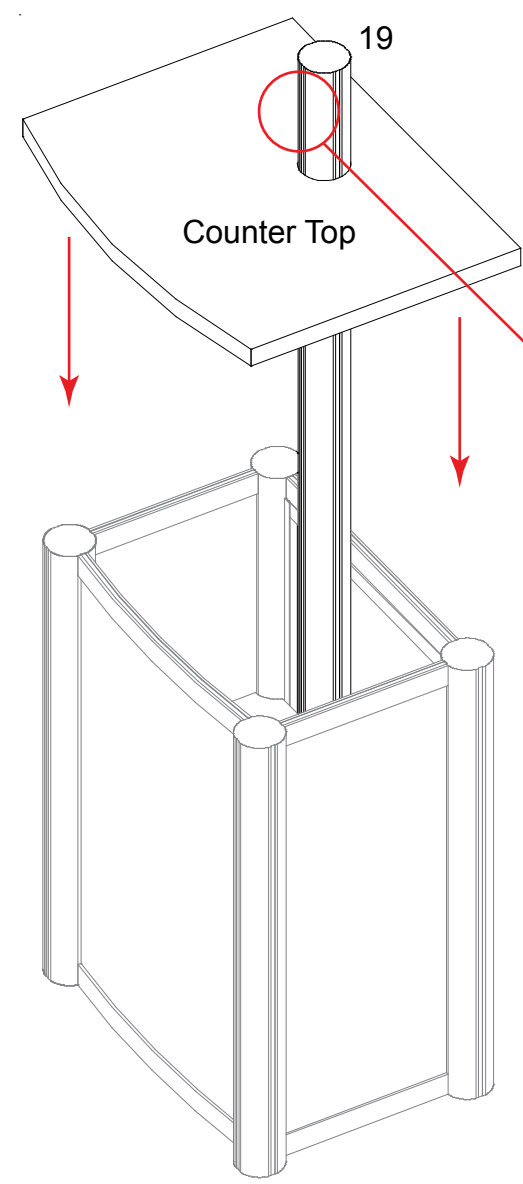
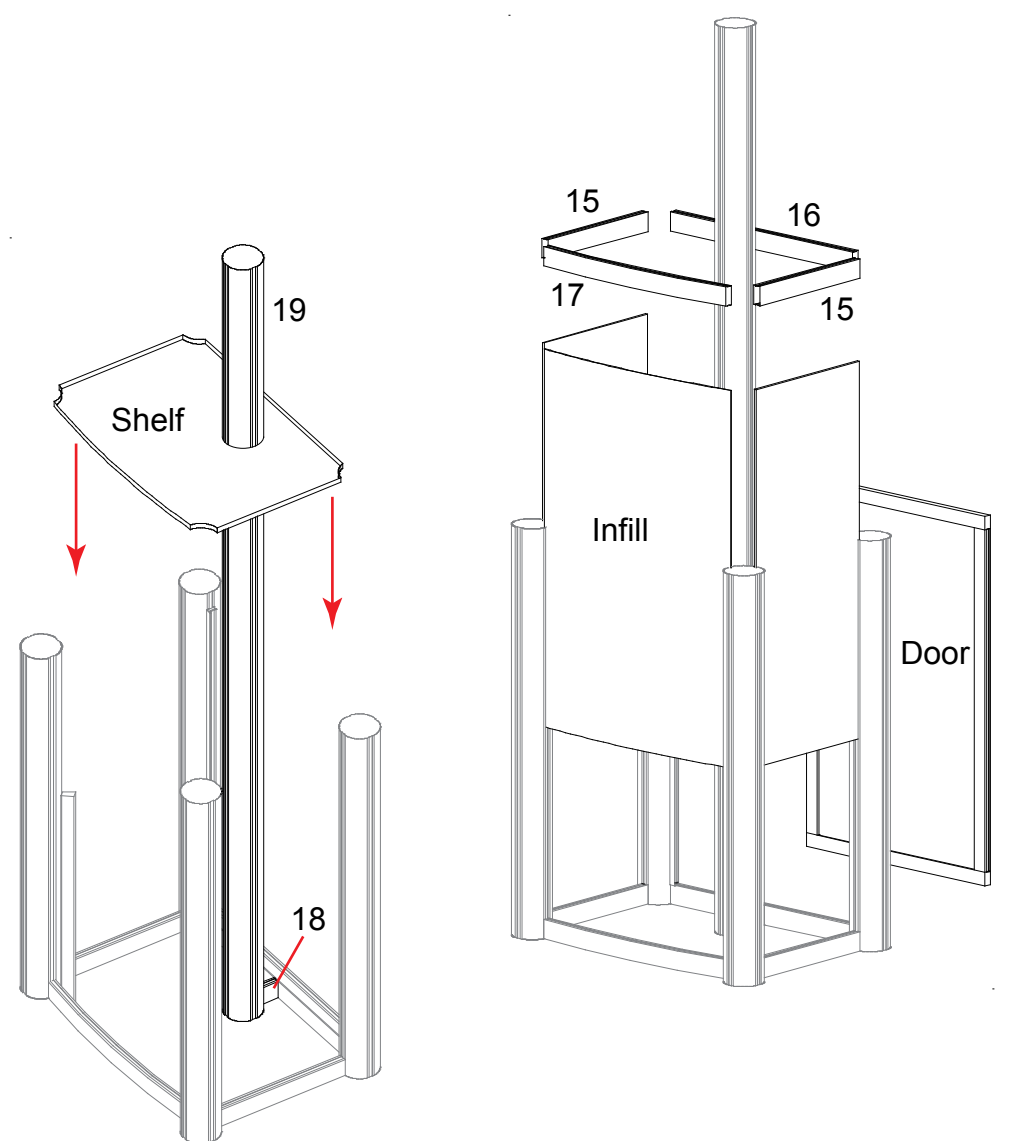
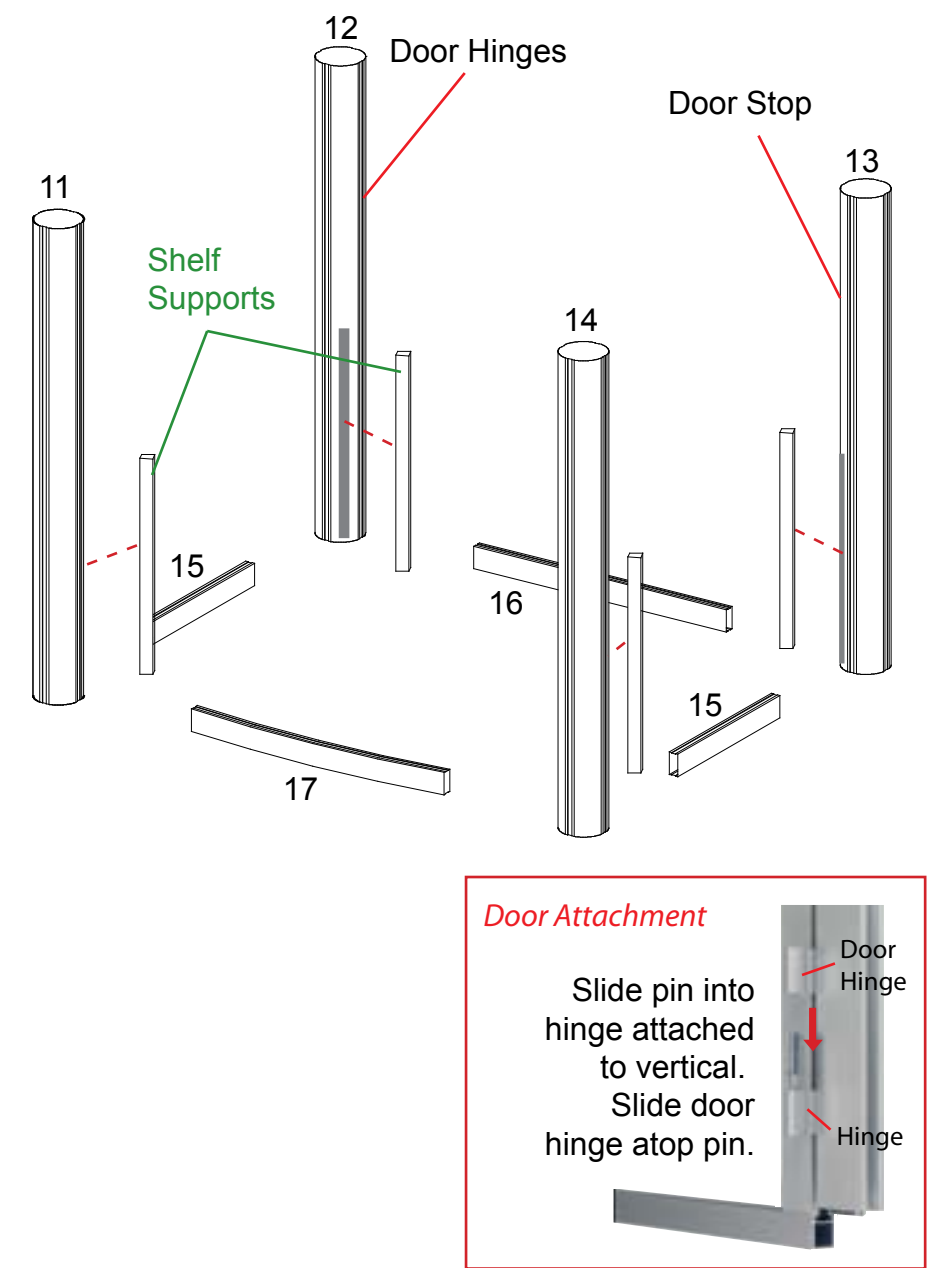

Monitor Mount Attachment

Slide mounting connector pieces into groove of extrusion. Tighten setscrew to secure in place.

Attach back plate to connectors on vertical extrusion using screws. Then attach monitor mount and tighten setscrews to secure.

WHEN DISASSEMBLING ALUMINUM EXTRUSION, TIGHTEN ALL SETSCREWS AND LOCKS TO PREVENT LOSS DURING SHIPPING

866.652.2100

Item	Qty.	Description
20	1	26.5"h Vertical Extrusion
21	1	26.5"h Vertical Extrusion w/ Hinges
22	1	26.5"h Vertical Extrusion w/ Door Stop
23	1	26.5"h Vertical Extrusion
24	4	13.355"w Horizontal Extrusion
25	2	21.835"w Horizontal Extrusion
26	2	21.888"w Curved Horizontal Extrusion

Steps:

- 1) Attach lower horizontal extrusions [24,25,26] between vertical extrusions [20,21,22,23] as shown.
- 2) Attach shelf supports to velcro on vertical extrusions as shown.
- 3) Insert infills and attach upper horizontal extrusions [24,25,26] between vertical extrusions. Attach door.
- 4) Place internal shelf atop supports.
- 5) Set counter top on assembled pedestal as shown.

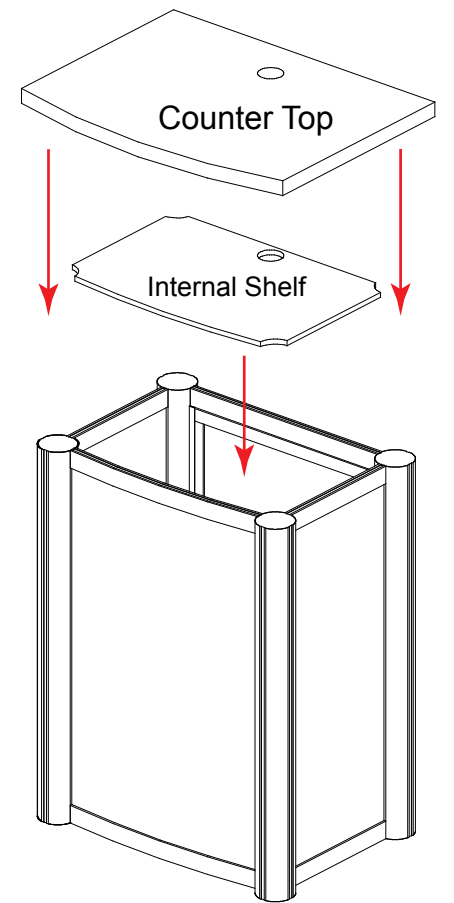
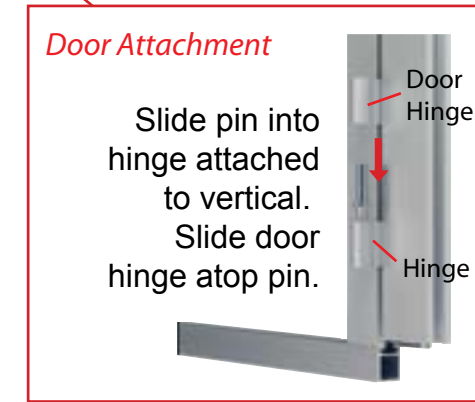
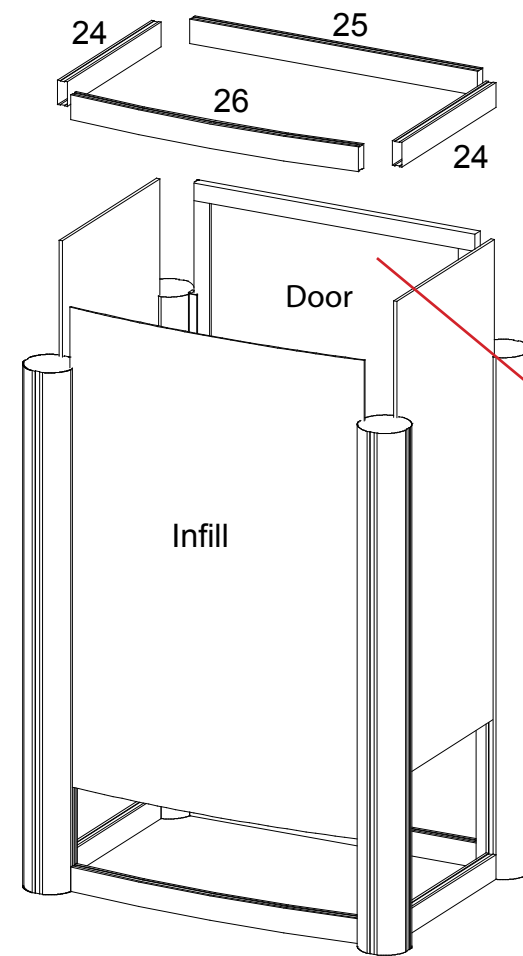
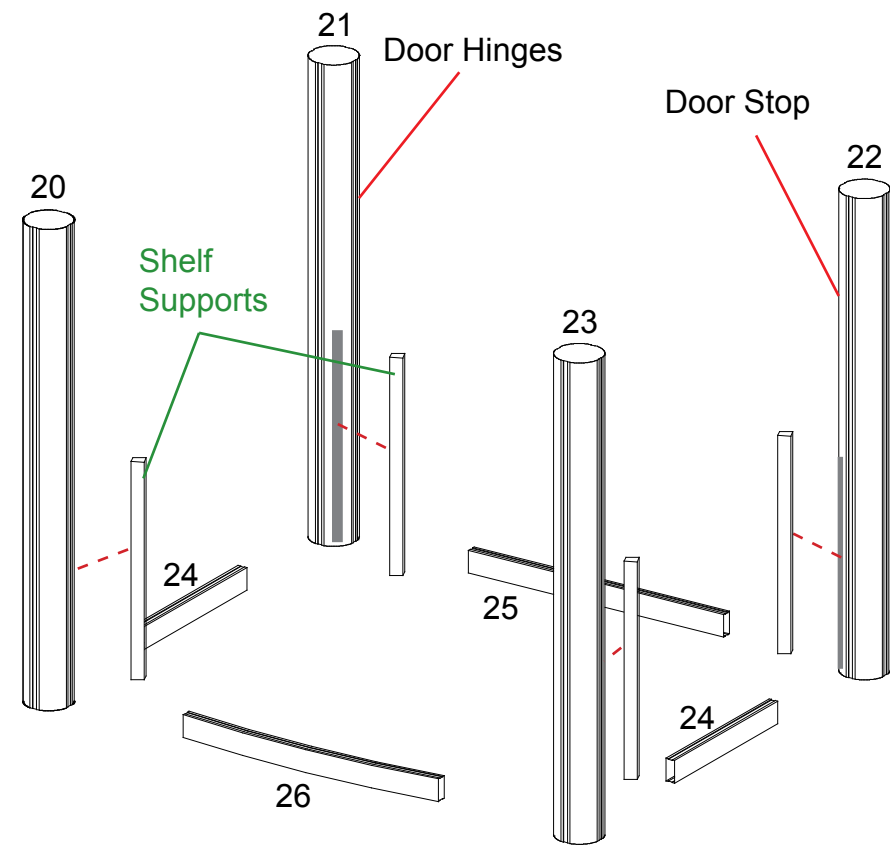
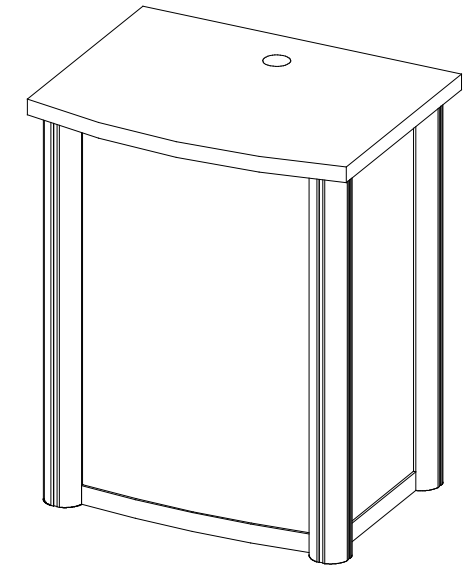

WHEN DISASSEMBLING ALUMINUM EXTRUSION, TIGHTEN ALL SETSCREWS AND LOCKS TO PREVENT LOSS DURING SHIPPING

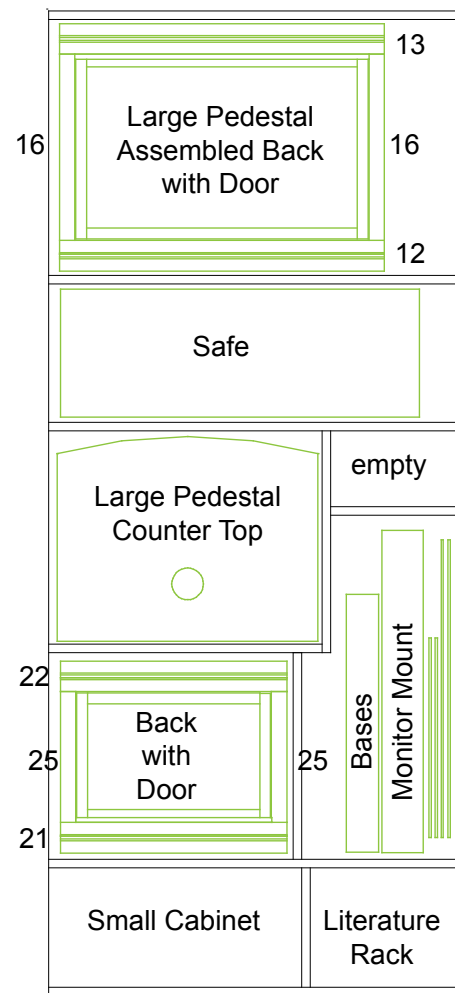

Level 1

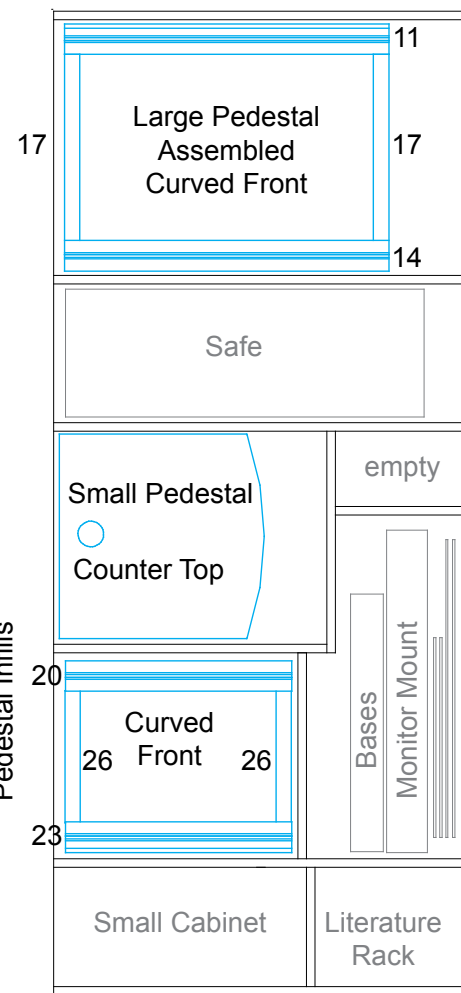

Level 2



Level 3



Level 4

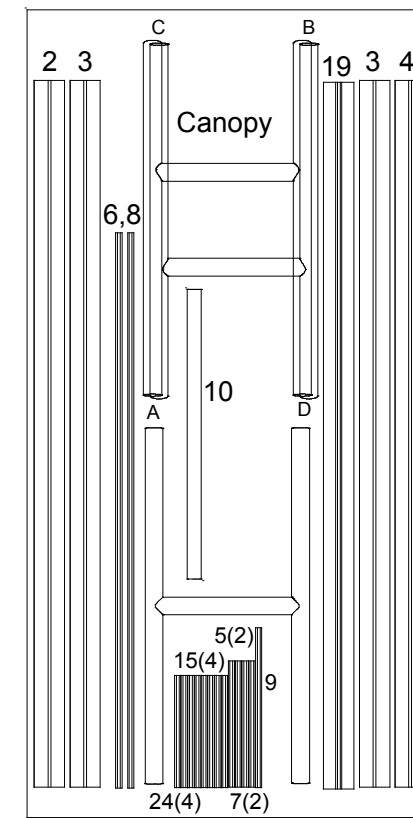

Level 5

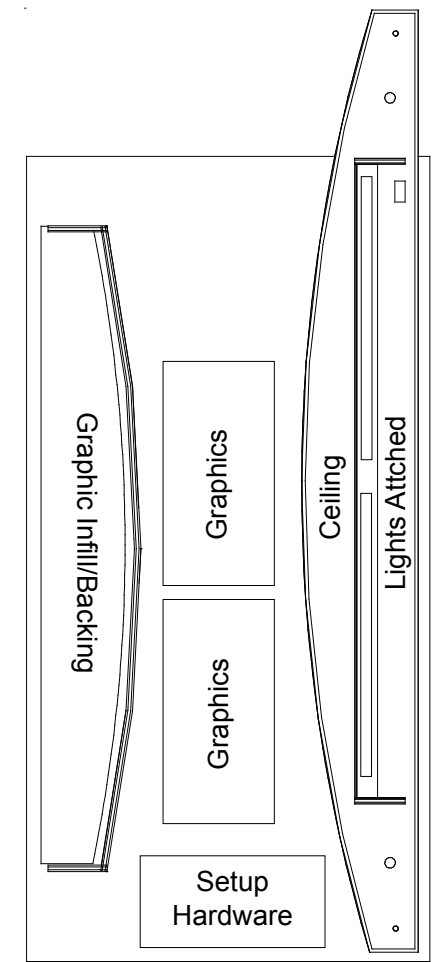

Level 6



WHEN DISASSEMBLING ALUMINUM EXTRUSION, TIGHTEN ALL SETSCREWS AND LOCKS TO PREVENT LOSS DURING SHIPPING

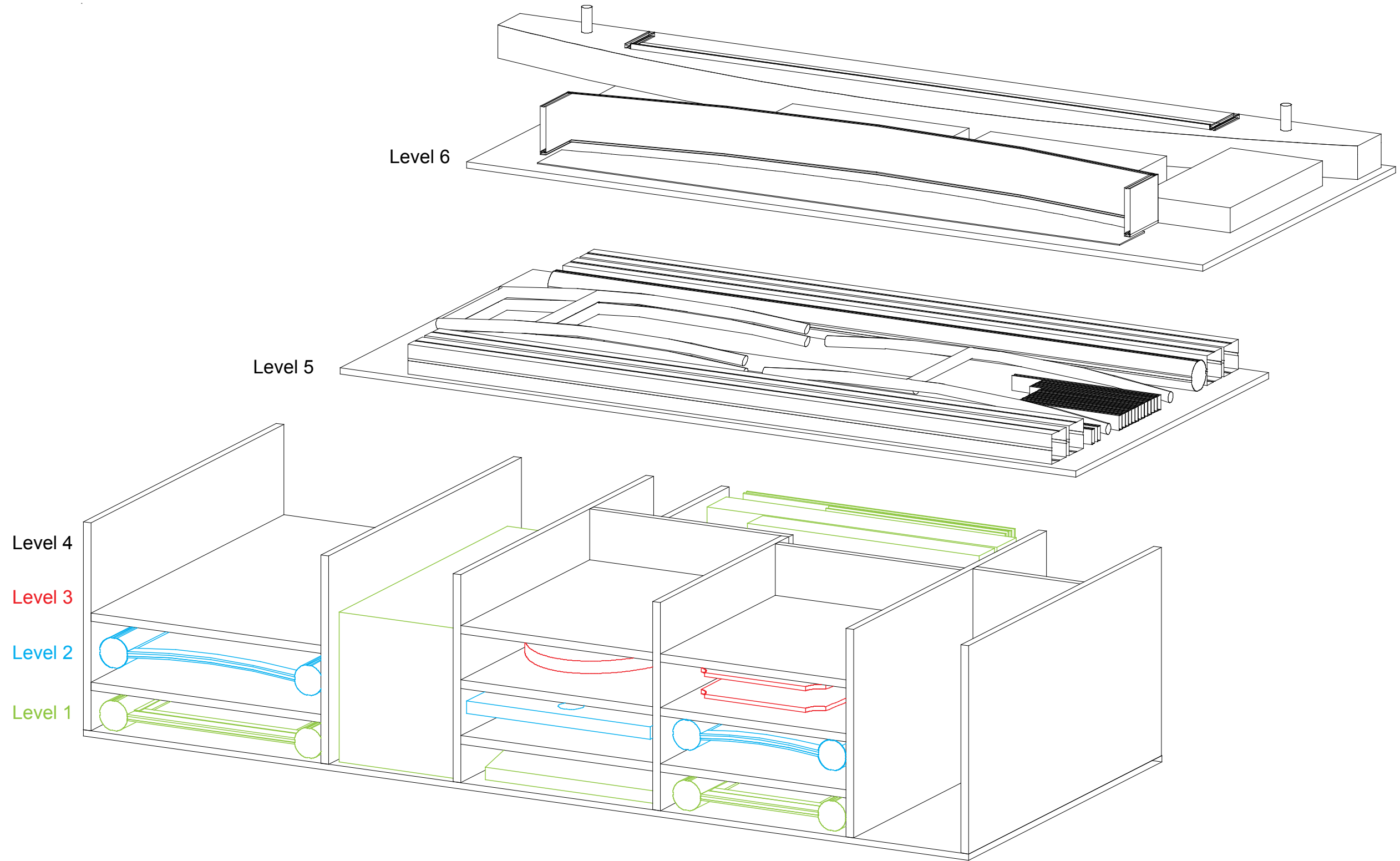

WHEN DISASSEMBLING ALUMINUM EXTRUSION, TIGHTEN ALL SETSCREWS AND LOCKS TO PREVENT LOSS DURING SHIPPING