

WHEN DISASSEMBLING ALUMINUM EXTRUSION, TIGHTEN ALL SETSCREWS AND LOCKS TO PREVENT LOSS DURING SHIPPING

### Using Your Setup Instructions

Setup Instructions are created specifically for your configuration. They are laid out sequentially in levels, including exploded views, and a logical series of detailed steps to assemble the main structure and components. We encourage you to study the instructions **before** attempting to assemble your exhibit.

Each page reminds you to tighten the setscrews after disassembling your exhibit to prevent loss of the locks and setscrews (see below in RED). This is VERY IMPORTANT.

### Cleaning and Packing Your Display

- 1) Use care when cleaning aluminum extrusion or acrylic inserts. Use only non-abrasive cleaners.
- 2) When cleaning laminate inserts, countertops, or panels use mild cleansers and a soft material such as cotton.
- 3) Keep all display components away from extreme heat and long exposure to sunlight to avoid warping and fading.
- 4) Retain all packing material. It will make re-packing much easier and will reduce the likelihood of shipping damage.

### General Setup Instructions for Extrusion System



The Tool

Most exhibits can be assembled with the supplied Hex Key Tool. Occasionally, a flat head screwdriver may be required.



Typical Connection

Most horizontal extrusion connections have a patented expandable lock. This lock inserts into the groove of an opposing extrusion. Tightening the lock with the Hex Key Tool expands the lock and creates a strong positive connection.



Typical Connection (cont'd)

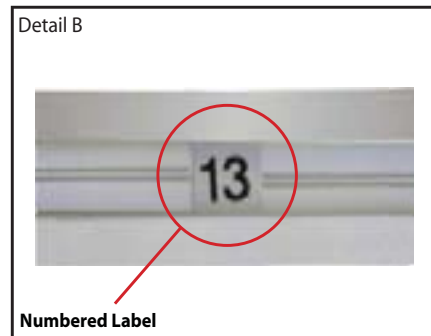

Numbered Label

Each extrusion contains a numbered label which corresponds with setup instructions. The label is located within a groove of the extrusion (when possible). With extrusion components the labels contain Black numbers unless otherwise specified.



Horizontal Inline Connection (remove only one setscrew)

Remove only (1) setscrew when disassembling. Replace setscrew in extrusion after assembling it. Before packing, replace setscrew in extrusion to avoid losing it.

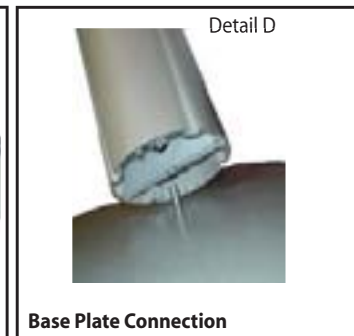

Base Plate Connection

Attach base plate to round or square vertical extrusion using the bolt provided. Be careful not to strip the threads.

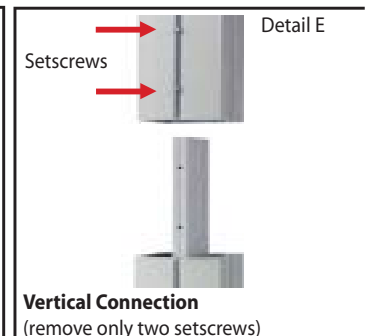

Vertical Connection (remove only two setscrews)

When vertical extrusions are packed in portable cases rather than crates or tubs, they must be broken down into smaller section which then require assembly.

Remove only (2) setscrews when disassembling. Replace setscrews in extrusion after assembling it. Before packing, replace setscrews in extrusion to avoid losing them.

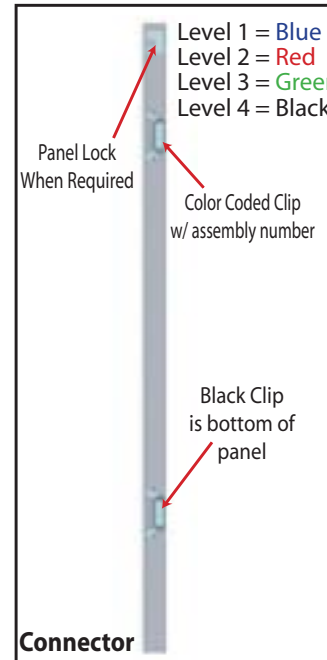

Connector

Each component has 2 clips, the lower clip is ALWAYS black. The top clip is color coded to distinguish which level. The color coded clip also contains the numbered label.

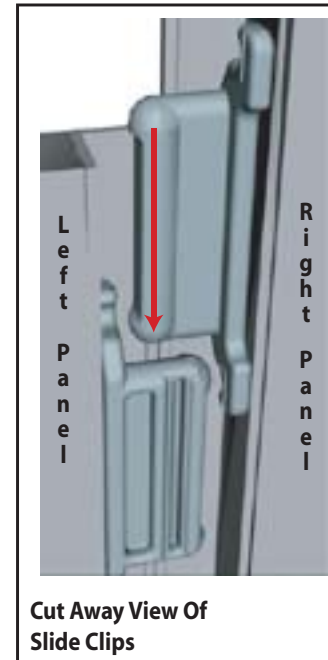

Cut Away View Of Slide Clips

Components connect together by aligning them and sliding downward connecting clips together.

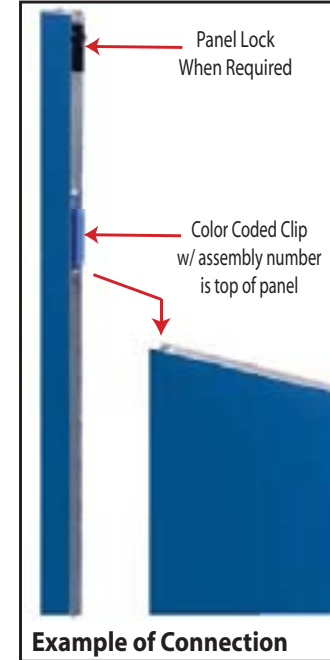

Example of Connection

Configurations are assembled from left to right, usually starting with #1 and following the numbered sequence.

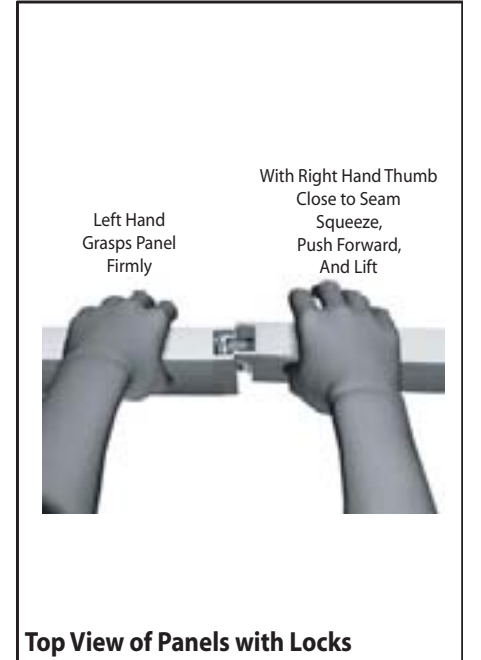

Top View of Panels with Locks

The first level of components contain panel locks that are located at the top of the panel for extra stability and seamless connection. When disassembling panels twist top connection slightly and lift right panel upward.

**WHEN DISASSEMBLING ALUMINUM EXTRUSION, TIGHTEN ALL SETSCREWS AND LOCKS TO PREVENT LOSS DURING SHIPPING**

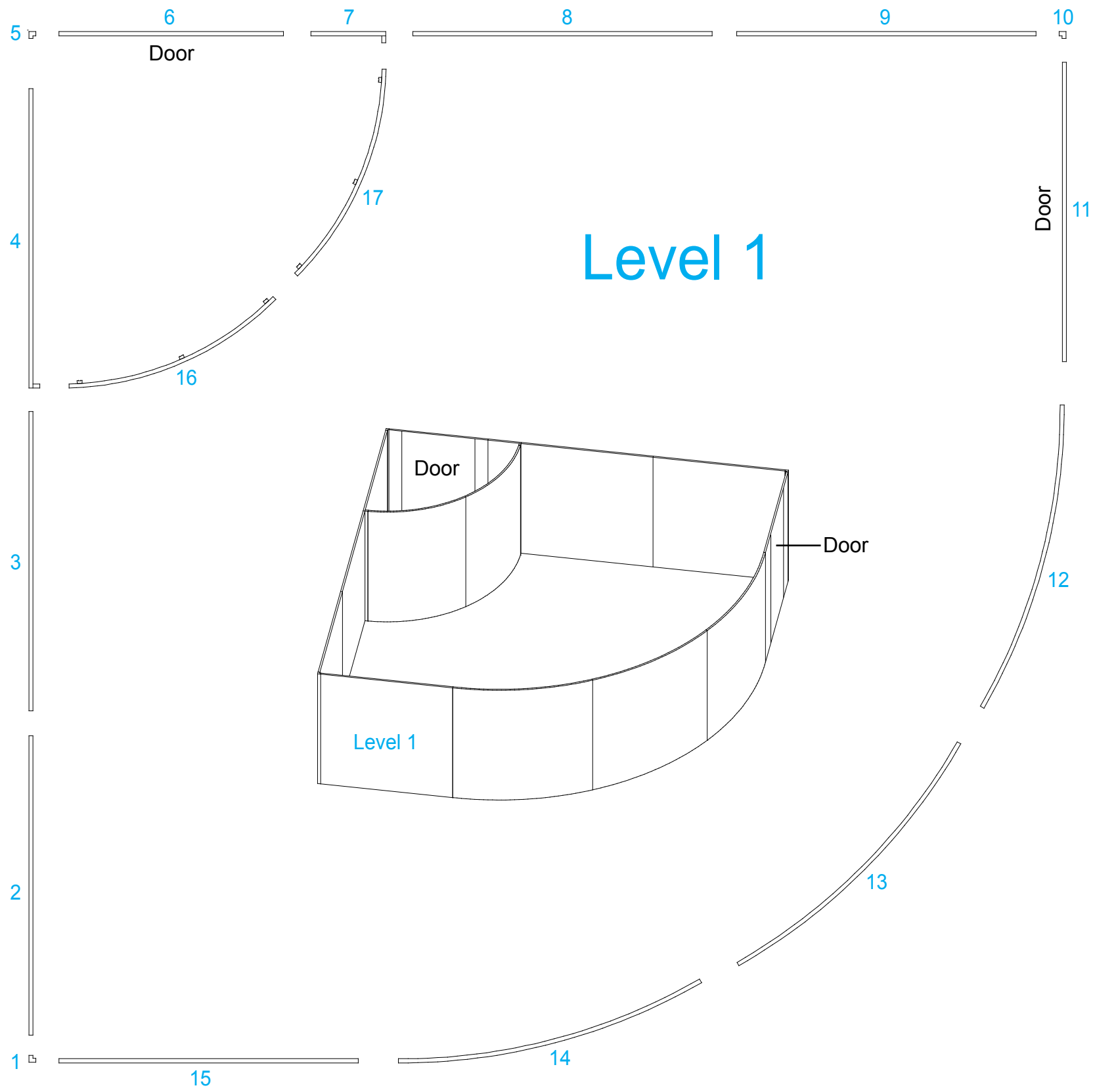

Item	Description
1	47.5”h Corner Connector
2	46”w x 47.5”h Flat Panel
3	46”w x 47.5”h Flat Panel
4	46”w x 47.5”h Flat Panel
5	47.5”h Corner Connector
6	34.5”w x 47.5”h Flat Panel
7	11.5”w x 47.5”h Flat Panel
8	46”w x 47.5”h Flat Panel
9	46”w x 47.5”h Flat Panel
10	47.5”h Corner Connector
11	46”w x 47.5”h Flat Panel
12	92.6141”r x 47.5”h Curved Panel
13	92.6141”r x 47.5”h Curved Panel
14	92.6141”r x 47.5”h Curved Panel
15	46”w x 47.5”h Flat Panel
16	46.5422”r x 47.5”h Curved Panel
17	46.5422”r x 47.5”h Curved Panel

Steps:  
 1) Connect LT panels and connectors together in numerical order.

**WHEN DISASSEMBLING ALUMINUM EXTRUSION, TIGHTEN ALL SETSCREWS AND LOCKS TO PREVENT LOSS DURING SHIPPING**

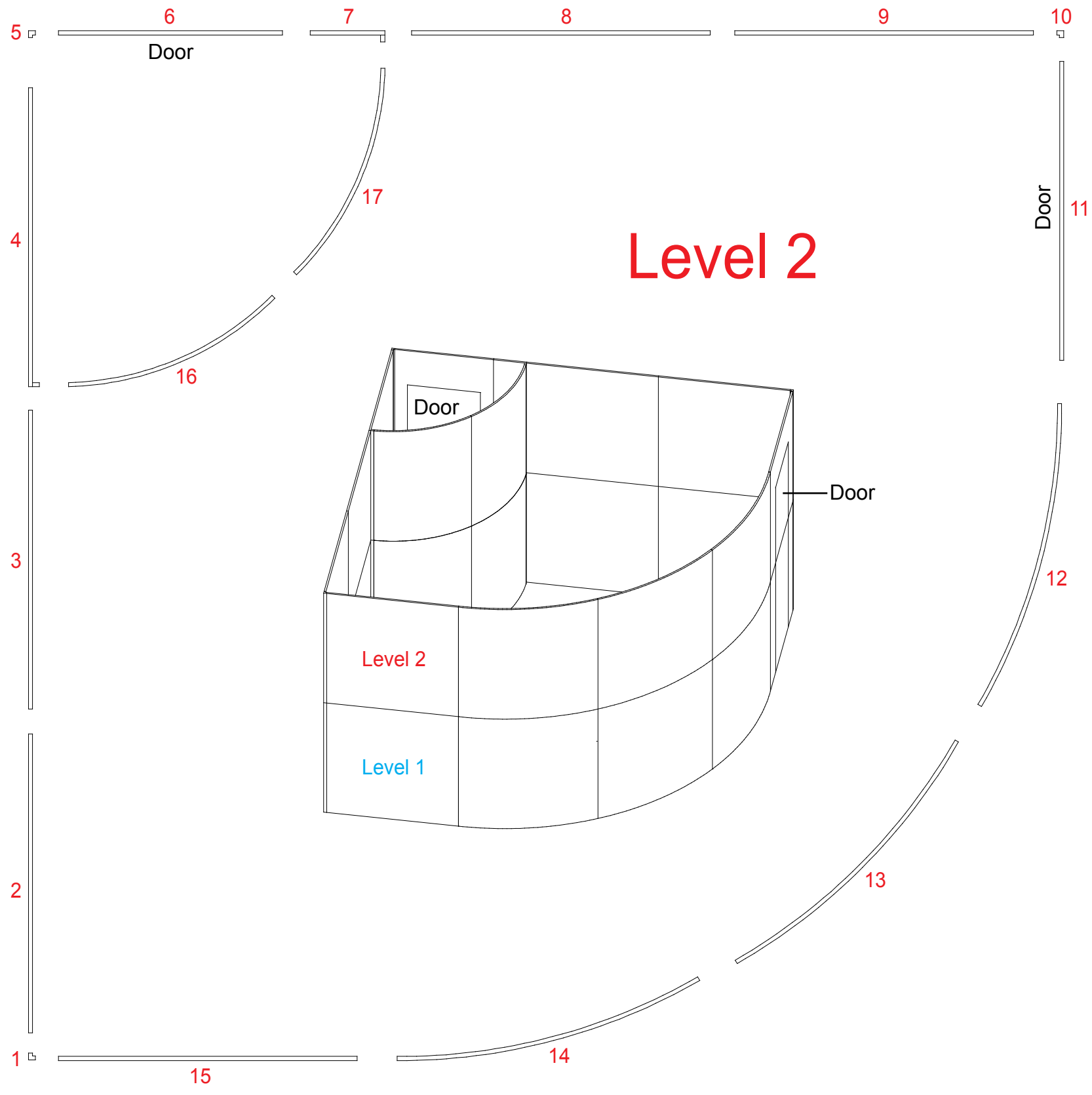

Item	Description
1	47.5”h Corner Connector
2	46”w x 47.5”h Flat Panel
3	46”w x 47.5”h Flat Panel
4	46”w x 47.5”h Flat Panel
5	47.5”h Corner Connector
6	34.5”w x 47.5”h Flat Panel
7	11.5”w x 47.5”h Flat Panel
8	46”w x 47.5”h Flat Panel
9	46”w x 47.5”h Flat Panel
10	47.5”h Corner Connector
11	46”w x 47.5”h Flat Panel
12	92.6141”r x 47.5”h Curved Panel
13	92.6141”r x 47.5”h Curved Panel
14	92.6141”r x 47.5”h Curved Panel
15	46”w x 47.5”h Flat Panel
16	46.5422”r x 47.5”h Curved Panel
17	46.5422”r x 47.5”h Curved Panel

Steps:  
 1) Connect LT panels and connectors together in numerical order.

**WHEN DISASSEMBLING ALUMINUM EXTRUSION, TIGHTEN ALL SETSCREWS AND LOCKS TO PREVENT LOSS DURING SHIPPING**

Item	Qty.	Description
1	4	10" Round Base Plate
2	4	38" Vertical Post
2a	4	Flange Plate
3	6	10" Shelf Support
4	1	55.9378" Round Extrusion
5	1	55.9378" Round Extrusion

- Steps:
- 1) Attach base plates [1] to vertical posts [2].
  - 2) Connect three piece large curved counter top together with connector plate and wing nuts.
  - 3) Place large curved counter top atop vertical posts and secure in place with flange plate [2a] and wing nuts as shown. Refer to detail. Note: Counter to curved wall attachment - use thumb screws.
  - 4) Attach 5" shelf supports to S10 as shown. Refer to detail.
  - 5) Velcro attach shelf atop shelf supports as shown.
  - 6) Attach graphic header atop assembled LT panel structure as shown.
  - 7) Connect round extrusions [4 & 5] together. Attach track lights to extrusions [4 & 5].
  - 8) Attach round extrusion assembly [4/5] atop LT curved panel walls.

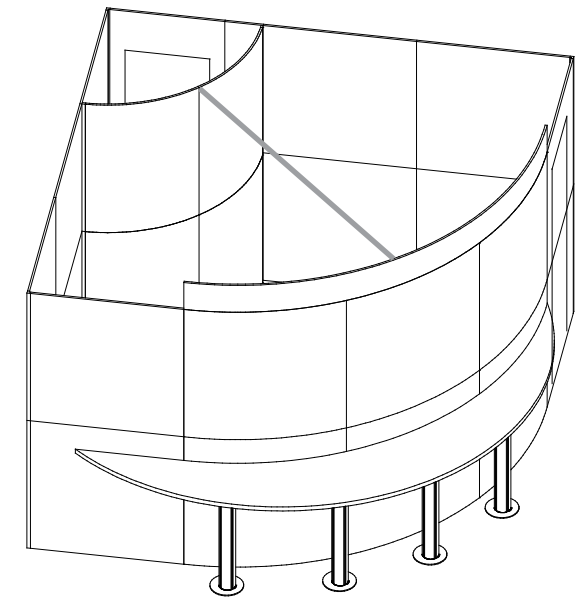

When Assembled

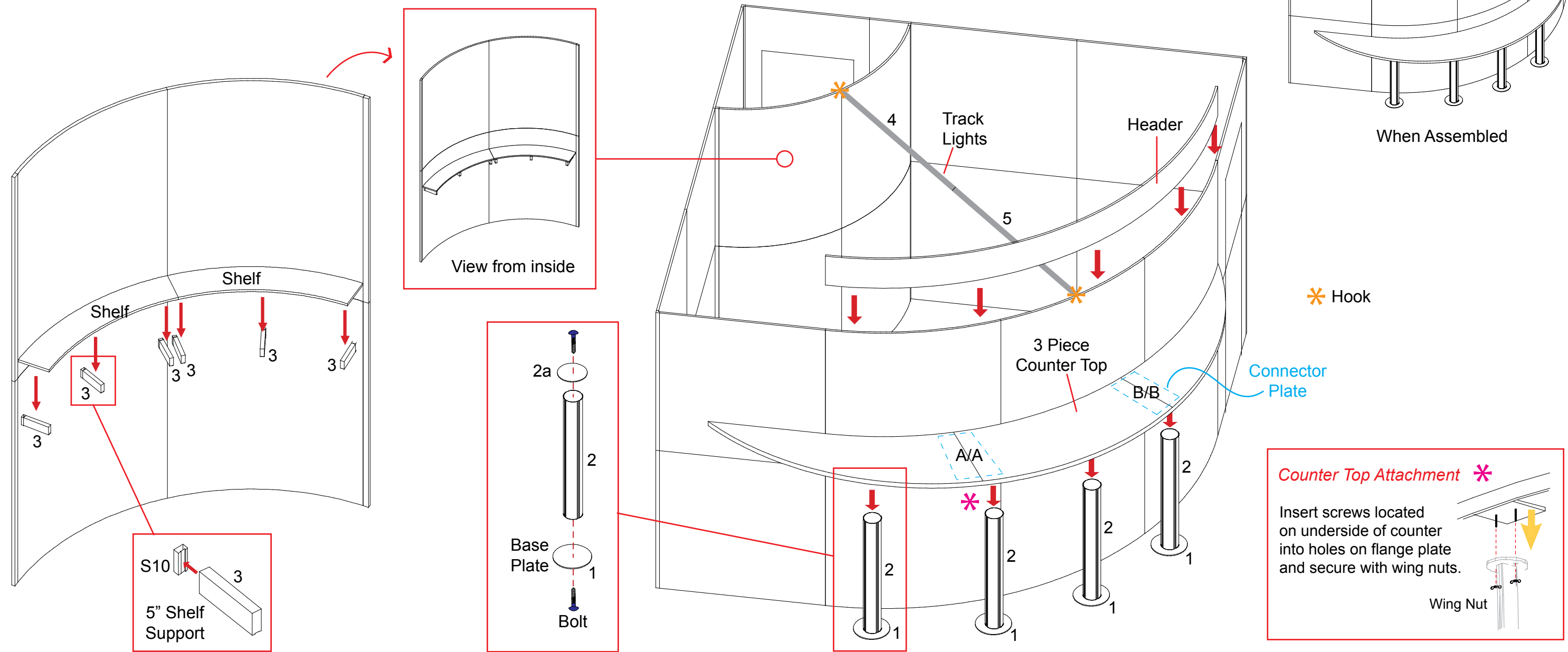

**Counter Top Attachment \***

Insert screws located on underside of counter into holes on flange plate and secure with wing nuts.

Wing Nut

**WHEN DISASSEMBLING ALUMINUM EXTRUSION, TIGHTEN ALL SETSCREWS AND LOCKS TO PREVENT LOSS DURING SHIPPING**

Item	Qty.	Description
15	1	84" Vertical Assembly (Keep Assembled)
16	1	84" Vertical Assembly (Keep Assembled)
17	1	51.0959" Horizontal Curved Extrusion
18	1	51.0959" Horizontal Curved Extrusion
19	1	51.0959" Horizontal Curved Extrusion
20	1	51.0959" Horizontal Curved Extrusion
21	1	51.0959" Horizontal Curved Extrusion
22	1	51.0959" Horizontal Curved Extrusion
23	1	51.0959" Horizontal Curved Extrusion

Steps:

- 1) Attach horizontal curved extrusions [17 & 20] between verticals [15 & 16].
- 2) Attach door to vertical [16]. Refer to **Door Attachment** detail.
- 3) Attach horizontal curved extrusions [18, 19, 21, 22, & 23] between verticals [15 & 16].  
Note: Place infills between verticals and horizontals as shown.
- 4) Place floor, top shelf, and ceiling w/ lights atop pins as shown. Refer to **Pin Attachment** detail.
- 5) Place product cabinet atop floor as shown.

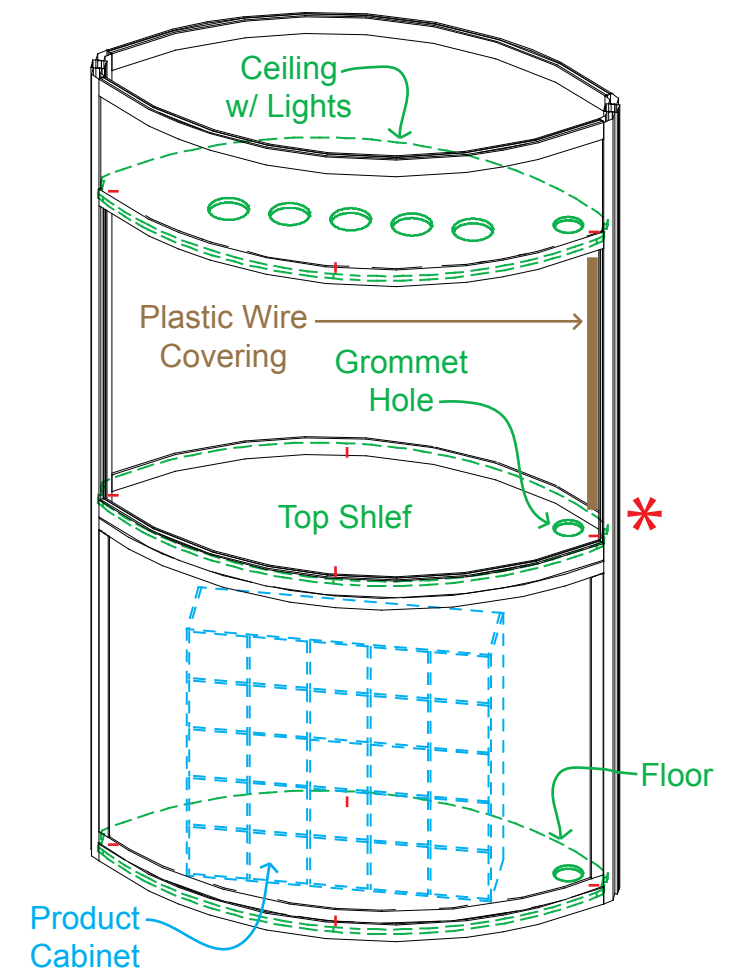
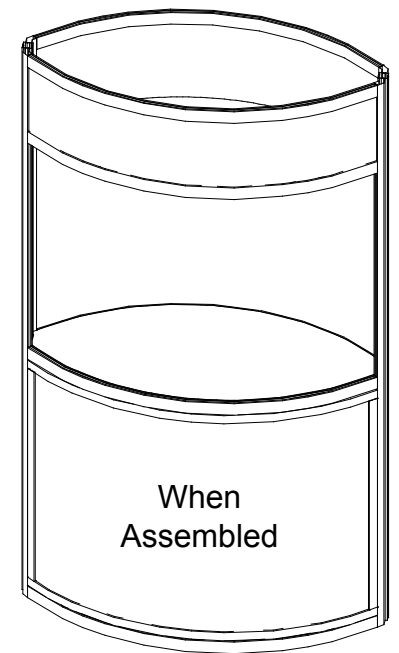
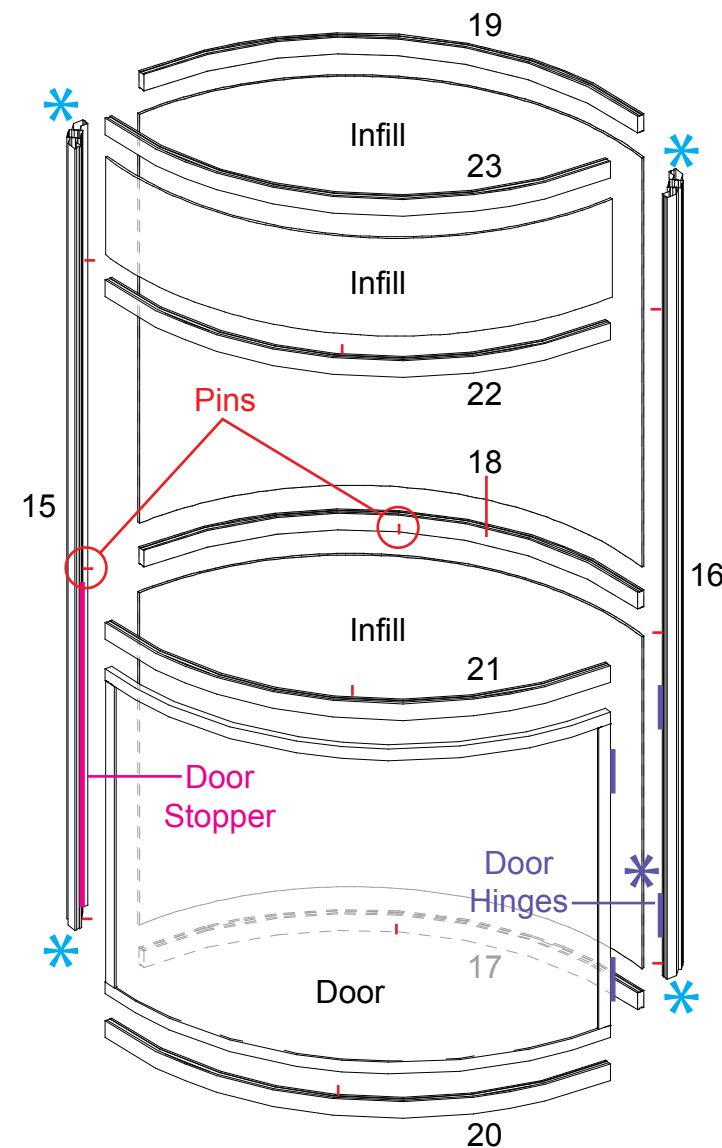
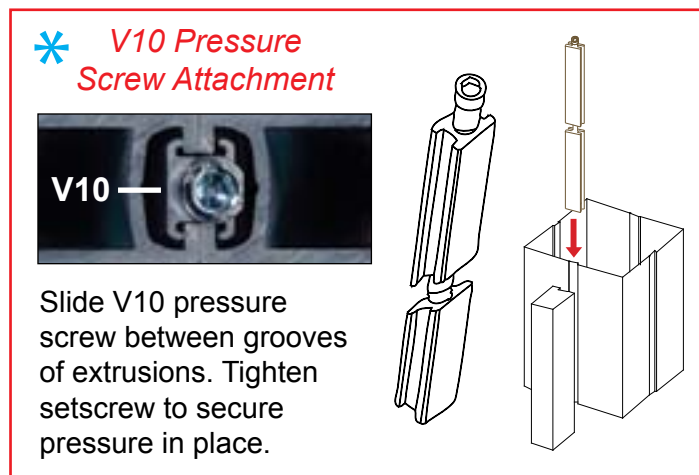
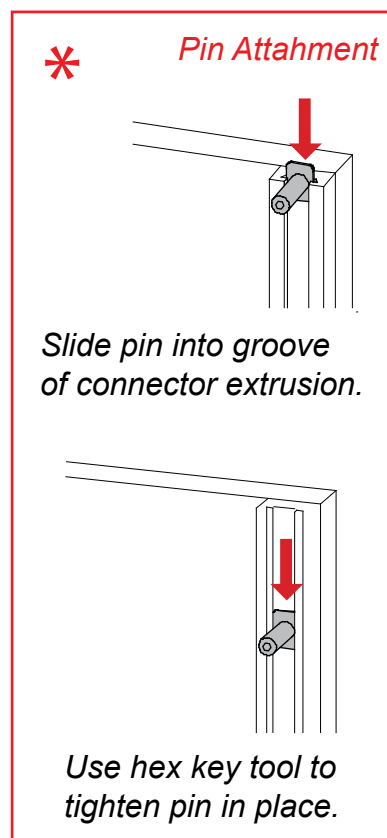
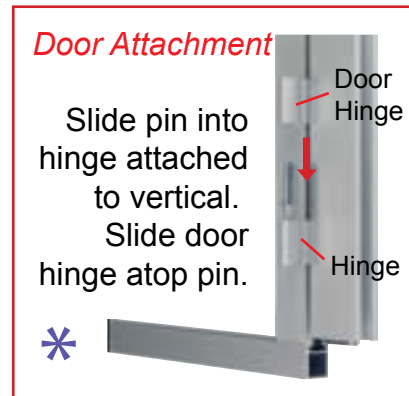

**WHEN DISASSEMBLING ALUMINUM EXTRUSION, TIGHTEN ALL SETSCREWS AND LOCKS TO PREVENT LOSS DURING SHIPPING**

**Counter Top Attachment \***

Insert screws located on underside of counter into holes on flange plate and secure with wing nuts.

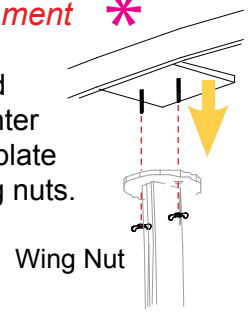

Item	Qty.	Description
1	2	10" Round Base Plate
2a	2	Flange Plate
2x	2	Vertical Counter Top Support
7	4	51.0959" Horizontal Curved Extrusion
8	4	51.0959" Horizontal Curved Extrusion
9	4	51.0959" Horizontal Curved Extrusion
10	4	51.0959" Horizontal Curved Extrusion
11	2	47.5" Vertical Assembly (Keep Assembled)
12	2	47.5" Vertical Assembly (Keep Assembled)
13	2	47.5" Vertical Assembly (Keep Assembled)
14	2	47.5" Vertical Assembly (Keep Assembled)

**Steps:**

- 1) Attach horizontal curved extrusions [7 & 8] between verticals [11 & 13].  
Note: Place infills between verticals and horizontals as shown.
- 2) Attach upper verticals [12 & 14] atop lower verticals [11 & 13].
- 3) Attach horizontal curved extrusions [9 & 10] between verticals [12 & 14].  
Note: Place infills between verticals and horizontals as shown.
- 4) Place top shelf, ceiling w/ lights, and ceiling atop pins as shown.
- 5) Place header atop assembled kiosk and secure in place as shown.
- 6) Attach base plate [1] to vertical post [2x].
- 7) Attach counter top atop vertical extrusion [2x] and secure in place with flange plate [2a] and wing nuts as shown. Refer to **Counter Top Attachment** detail. Note: Counter to curved wall attachment - use thumb screws.

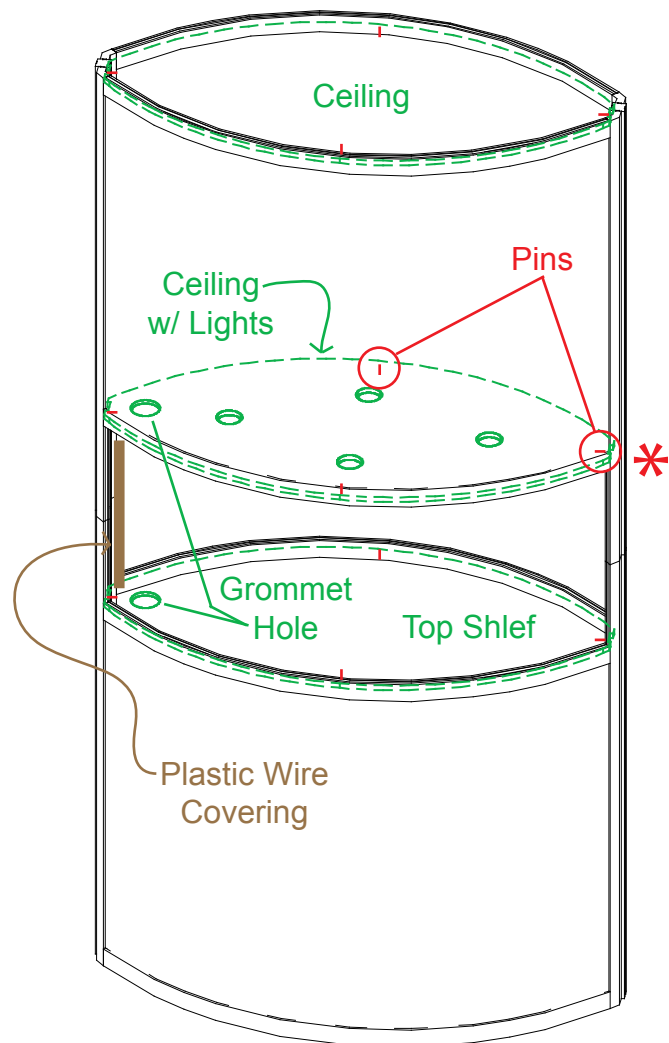
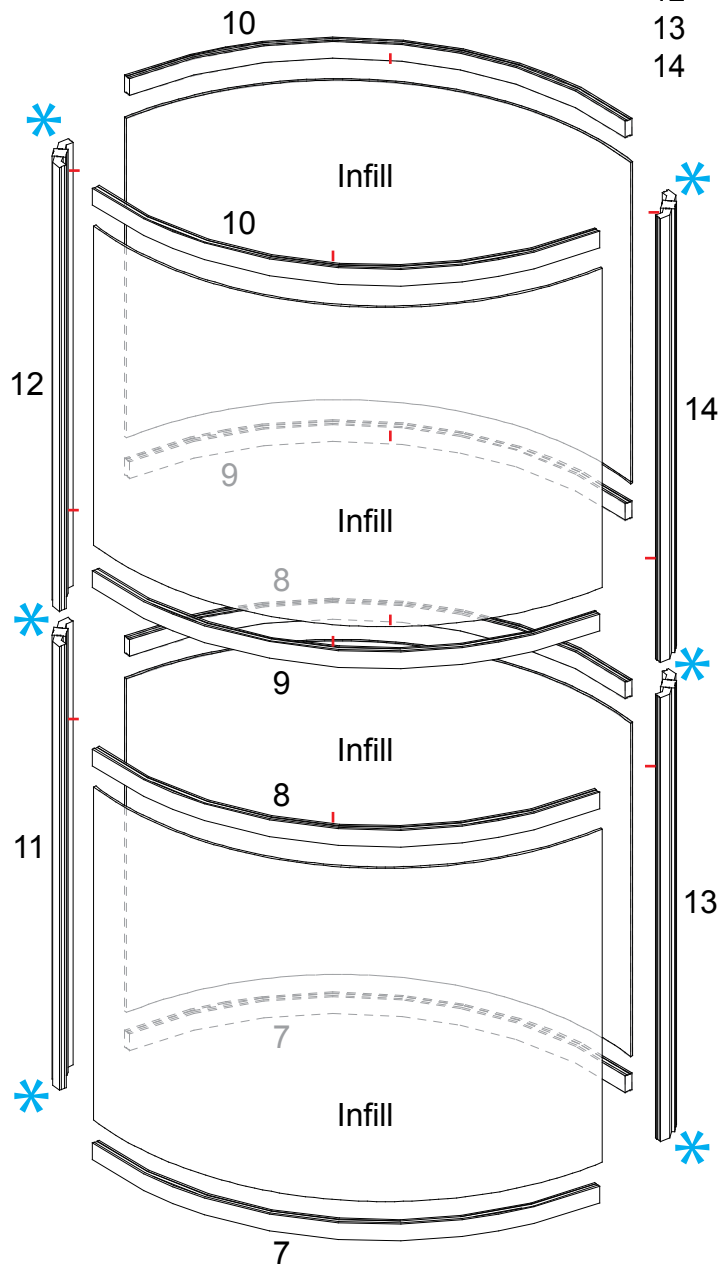
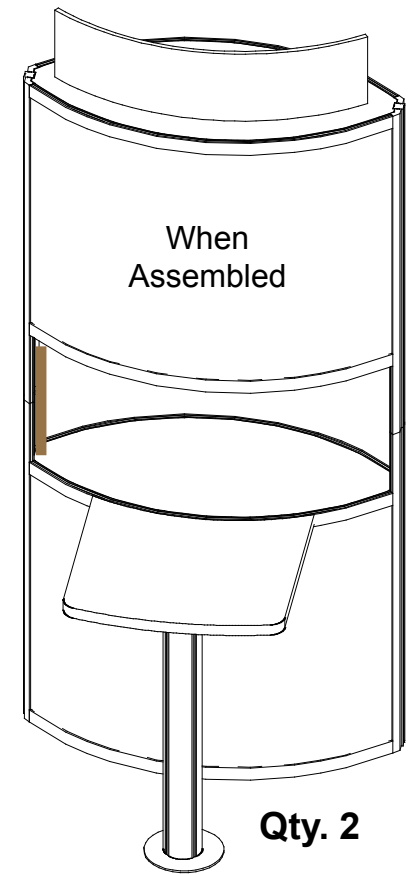

**\* V10 Pressure Screw Attachment**



Slide V10 pressure screw between grooves of extrusions. Tighten setscrew to secure pressure in place.

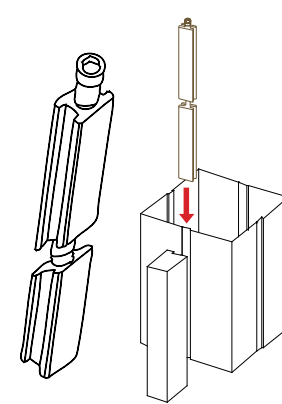

**\* Pin Attachment**

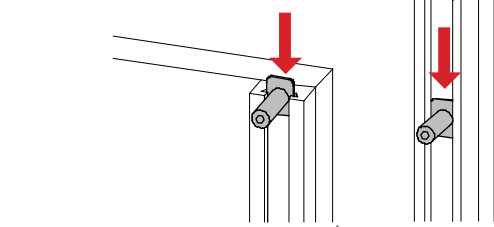

Slide pin into groove of connector extrusion.

Use hex key tool to tighten pin in place.

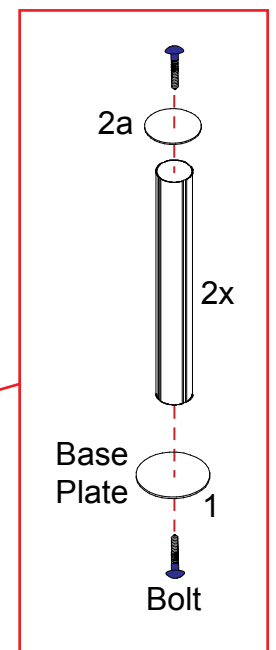
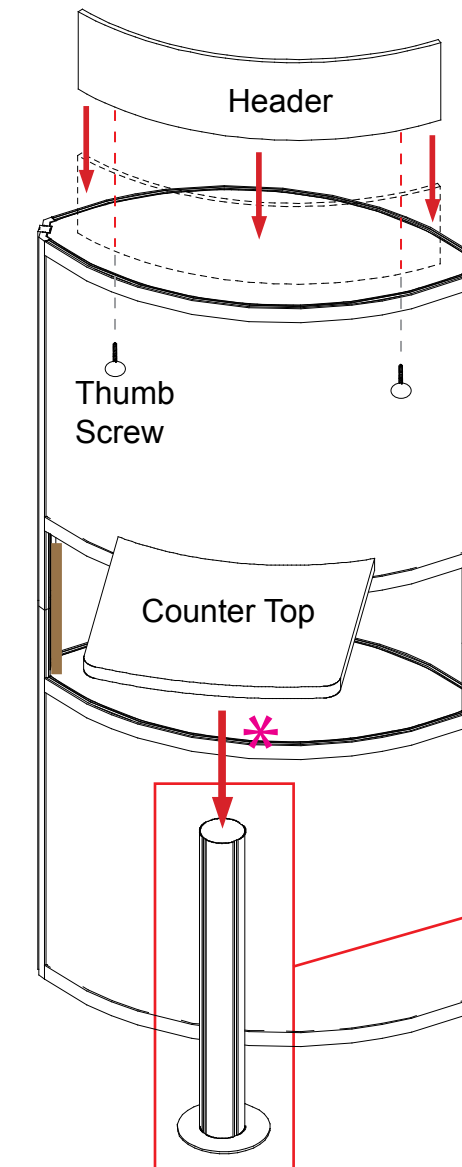

**WHEN DISASSEMBLING ALUMINUM EXTRUSION, TIGHTEN ALL SETSCREWS AND LOCKS TO PREVENT LOSS DURING SHIPPING**

Item	Qty.	Description
1	4	10" Round Base Plate
6	4	29.25" Vertical Post
6a	4	Flange Plate

Steps:

- 1) Attach base plates [1] to vertical posts [6].
- 2) Attach table top atop vertical extrusions [6] and secure in place with flange plate [6a] and wing nuts as shown. Refer to *Counter Top Attachment* detail.

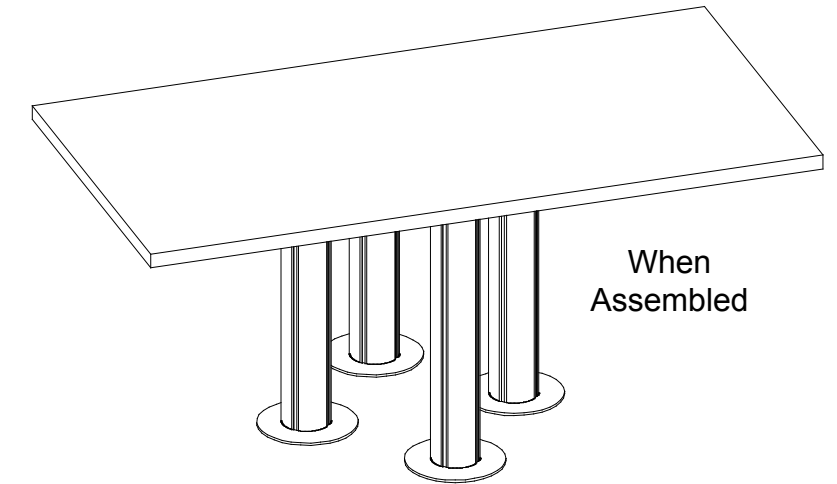

*Counter Top Attachment* \*

Insert screws located on underside of counter into holes on flange plate and secure with wing nuts.

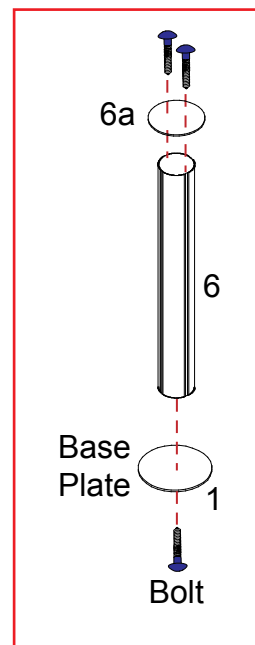
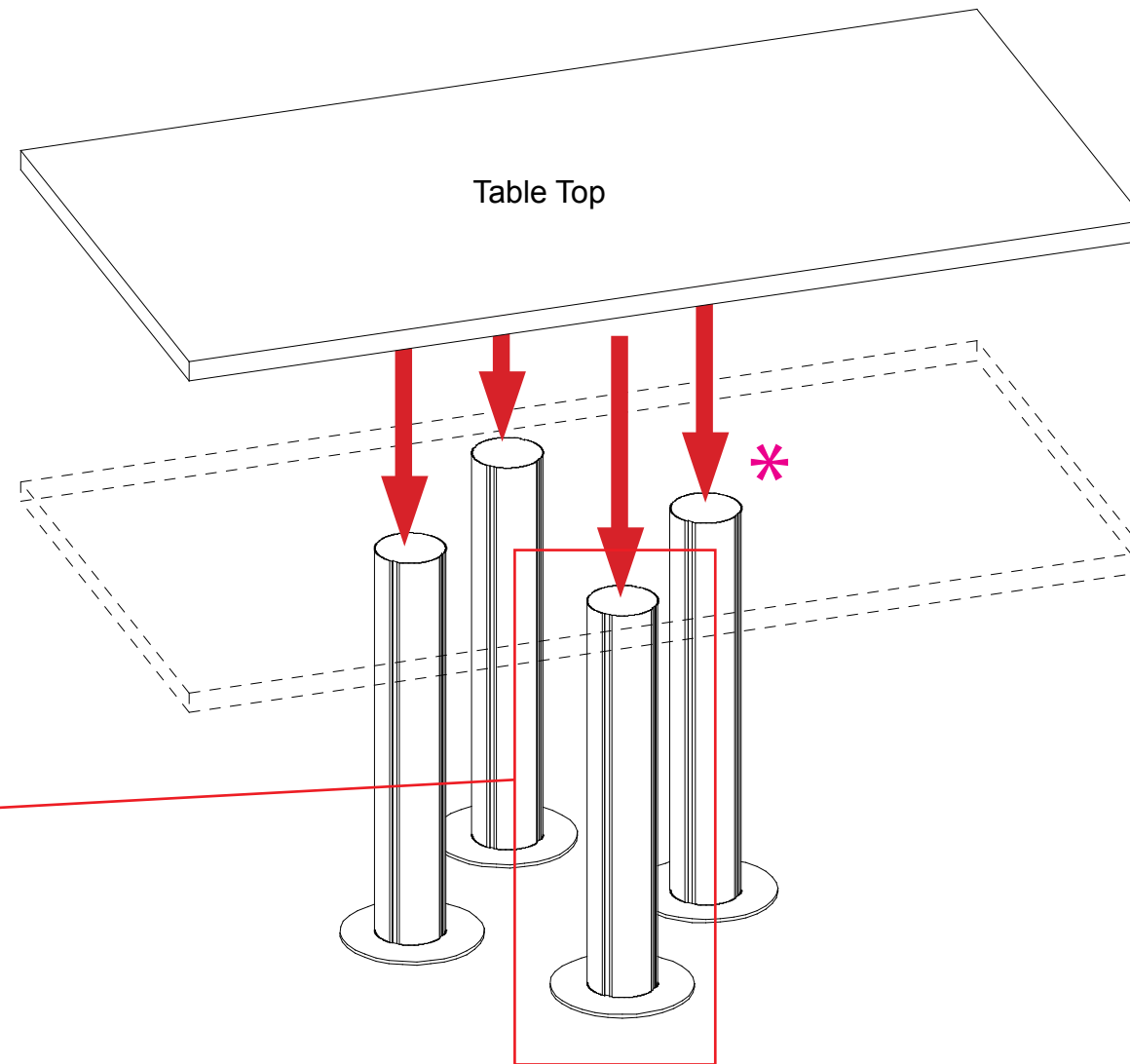
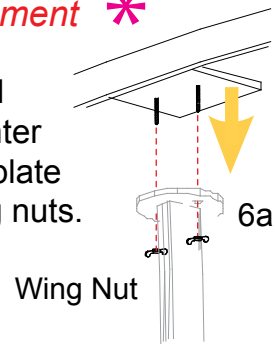

WHEN DISASSEMBLING ALUMINUM EXTRUSION, TIGHTEN ALL SETSCREWS AND LOCKS TO PREVENT LOSS DURING SHIPPING

# Crate 1 Packing Instruction



Crate #1

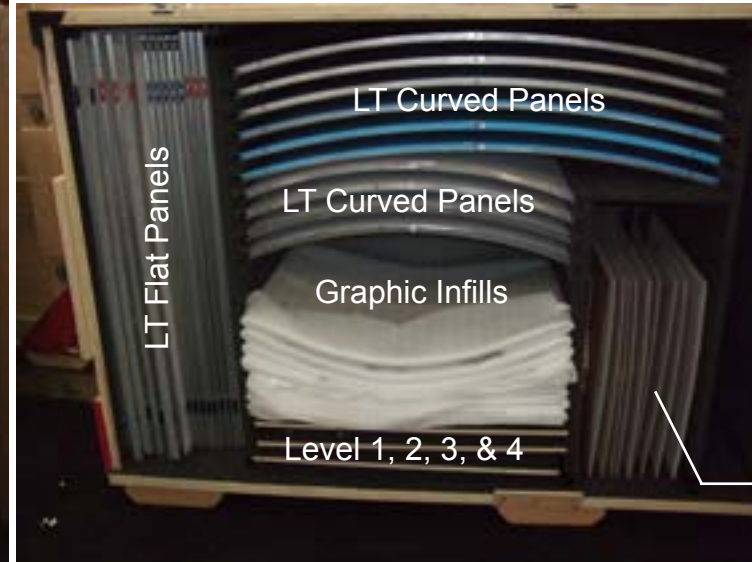

Crate #1

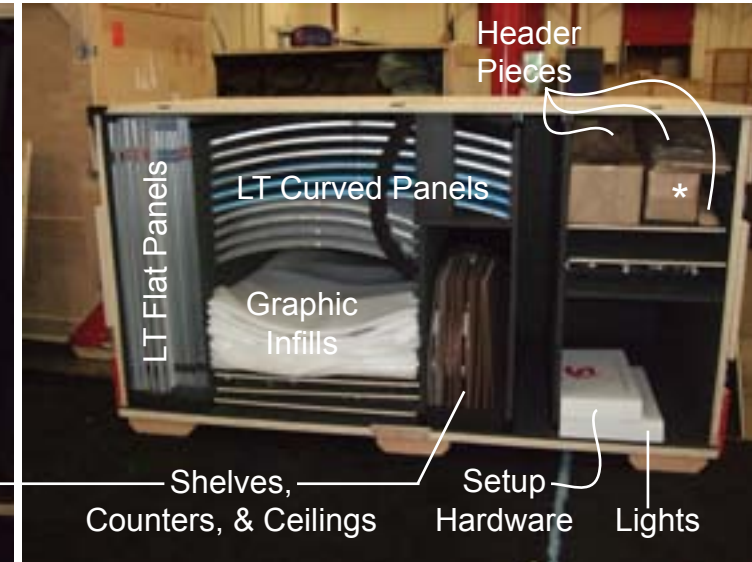

Crate #1



LT Flat Panels



Level 1



Level 2



Level 3



Level 4

**WHEN DISASSEMBLING ALUMINUM EXTRUSION, TIGHTEN ALL SETSCREWS AND LOCKS TO PREVENT LOSS DURING SHIPPING**



Crate #2

WHEN DISASSEMBLING ALUMINUM EXTRUSION, TIGHTEN ALL SETSCREWS AND LOCKS TO PREVENT LOSS DURING SHIPPING