

Plan View

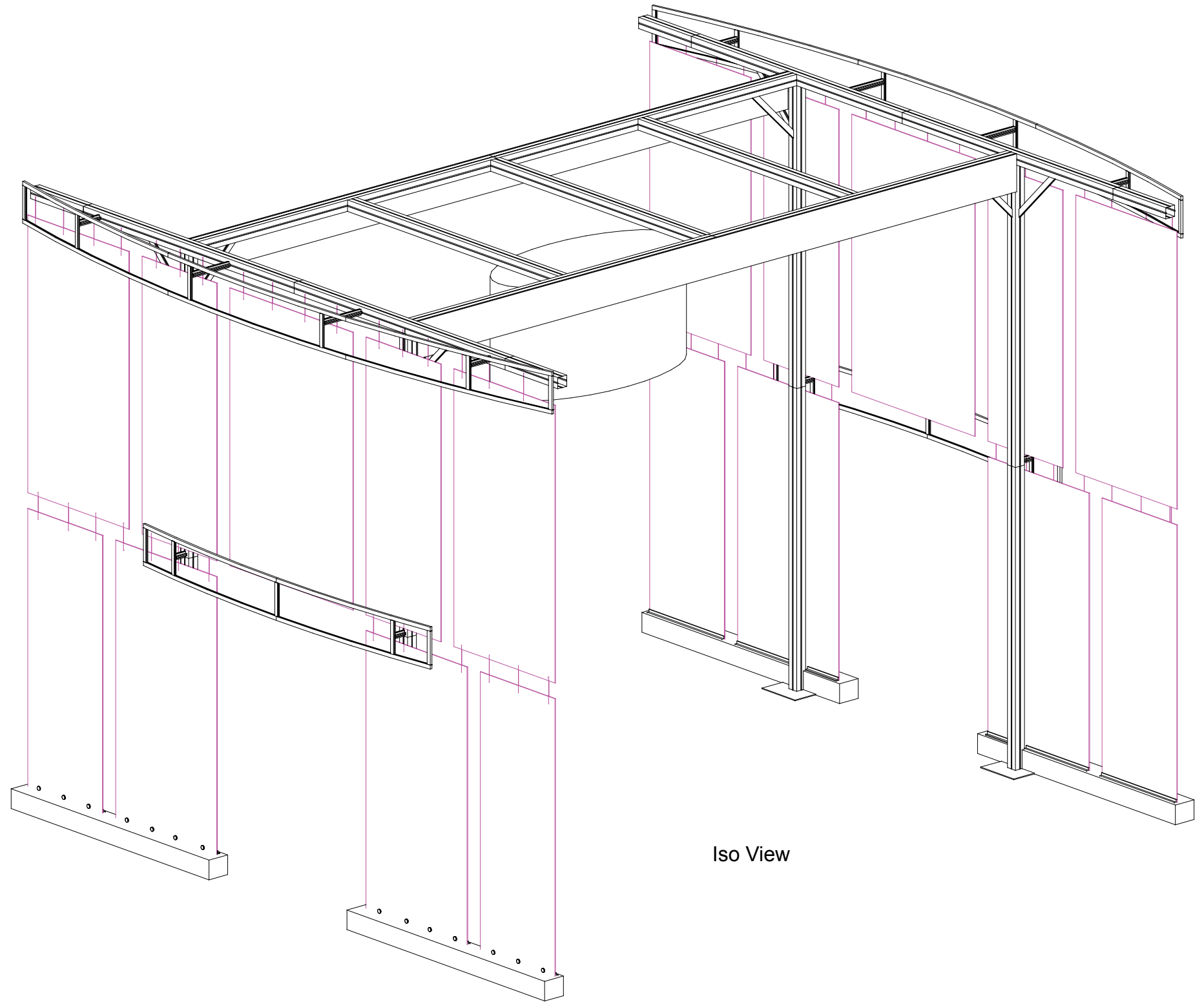

Iso View

WHEN DISASSEMBLING ALUMINUM EXTRUSION, TIGHTEN ALL SETSCREWS AND LOCKS TO PREVENT LOSS DURING SHIPPING

visionary™ IDESIGNS

Using Your Setup Instructions

The Visionary Designs Setup Instructions are created specifically for your configuration. They are laid out sequentially, including an exploded view of the entire display, and then a logical series of detailed steps to assemble the main structure and components. We encourage you to study the instructions **before** attempting to assemble your exhibit.

Each page reminds you to tighten the setscrews after disassembling your exhibit to prevent loss of the locks and setscrews (see below in RED). This is **VERY IMPORTANT**.

Cleaning and Packing Your Display

- 1) Use care when cleaning aluminum extrusion or acrylic inserts. Use only non-abrasive cleaners.
- 2) When cleaning laminate inserts or countertops, use mild cleansers and a soft material such as cotton.
- 3) Keep all display components away from extreme heat and long exposure to sunlight to avoid warping and fading.
- 4) Retain all packing material. It will make re-packing much easier and will reduce the likelihood of shipping damage.



The Tool

Most Visionary Designs exhibits can be assembled with the supplied Hex Key Tool. Occasionally, a flat head screwdriver may be required.



Detail A

Typical Connection



Typical Connection (cont'd)

Most horizontal extrusion connections have a patented expandable lock. This lock inserts into the groove of an opposing extrusion. Tightening the lock with the Hex Key Tool expands the lock and creates a strong positive connection.

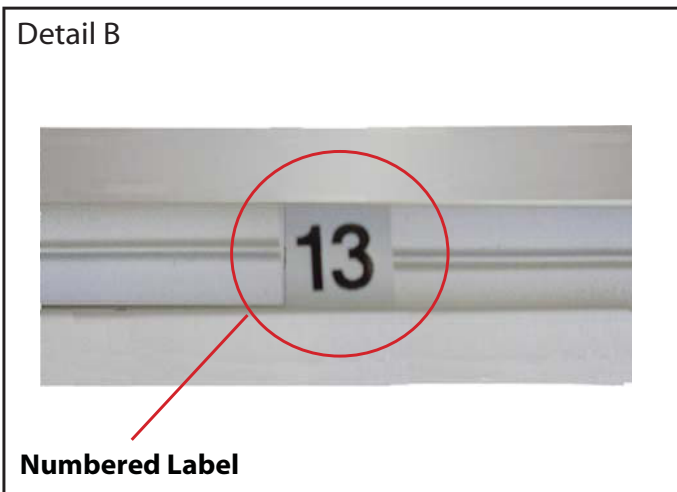

Detail B

Numbered Label

Each extrusion contains a numbered label which corresponds with setup instructions. The label is located within a groove of the extrusion (when possible). With Visionary Designs the labels contain Black numbers unless otherwise specified.



Detail C

Horizontal Inline Connection (remove only one setscrew)

Remove only (1) setscrew when disassembling. Replace setscrew in extrusion after assembling it. Before packing, replace setscrew in extrusion to avoid losing it.

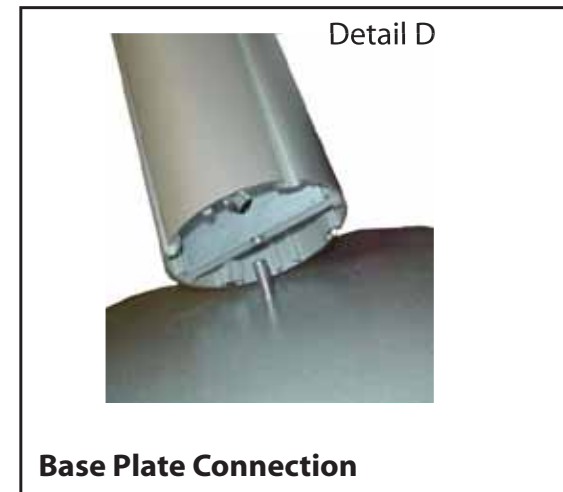

Detail D

Base Plate Connection

Attach base plate to round or square vertical extrusion using the bolt provided. Be careful not to strip the threads.

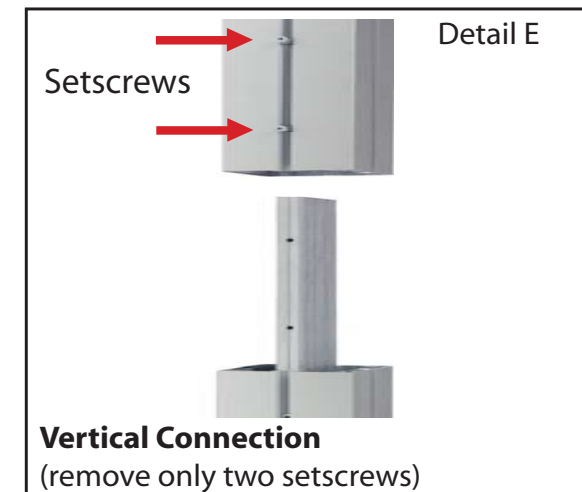

Detail E

Vertical Connection
(remove only two setscrews)

When vertical extrusions are packed in portable cases rather than crates or tubs, they must be broken down into smaller sections which then require assembly.

Remove only (2) setscrews when disassembling. Replace setscrews in extrusion after assembling it. Before packing, replace setscrews in extrusion to avoid losing them.

WHEN DISASSEMBLING ALUMINUM EXTRUSION, TIGHTEN ALL SETSCREWS AND LOCKS TO PREVENT LOSS DURING SHIPPING

866.652.2100

Item	Qty.	Description
1	4	Square Base Plate
2	4	96" h Vertical Extrusion
3	4	96" h Vertical Extrusion
4	4	Diagonal Brace
5	2	24" w Horizontal Extrusion
6	2	96" w Horizontal Extrusion
7	2	96" w Horizontal Extrusion
8	2	24" w Horizontal Extrusion

- Steps:
- 1) Attach base plates [1] to verticals [2].
 - 2) Attach upper verticals [3] to lower verticals [2] as shown.
 - 3) Connect horizontal extrusions [5 thru 8] together.
 - 4) Place horizontal assembly atop verticals [3] as shown and secure in place.
 - 5) Attach a diagonal brace between verticals and horizontals as shown.

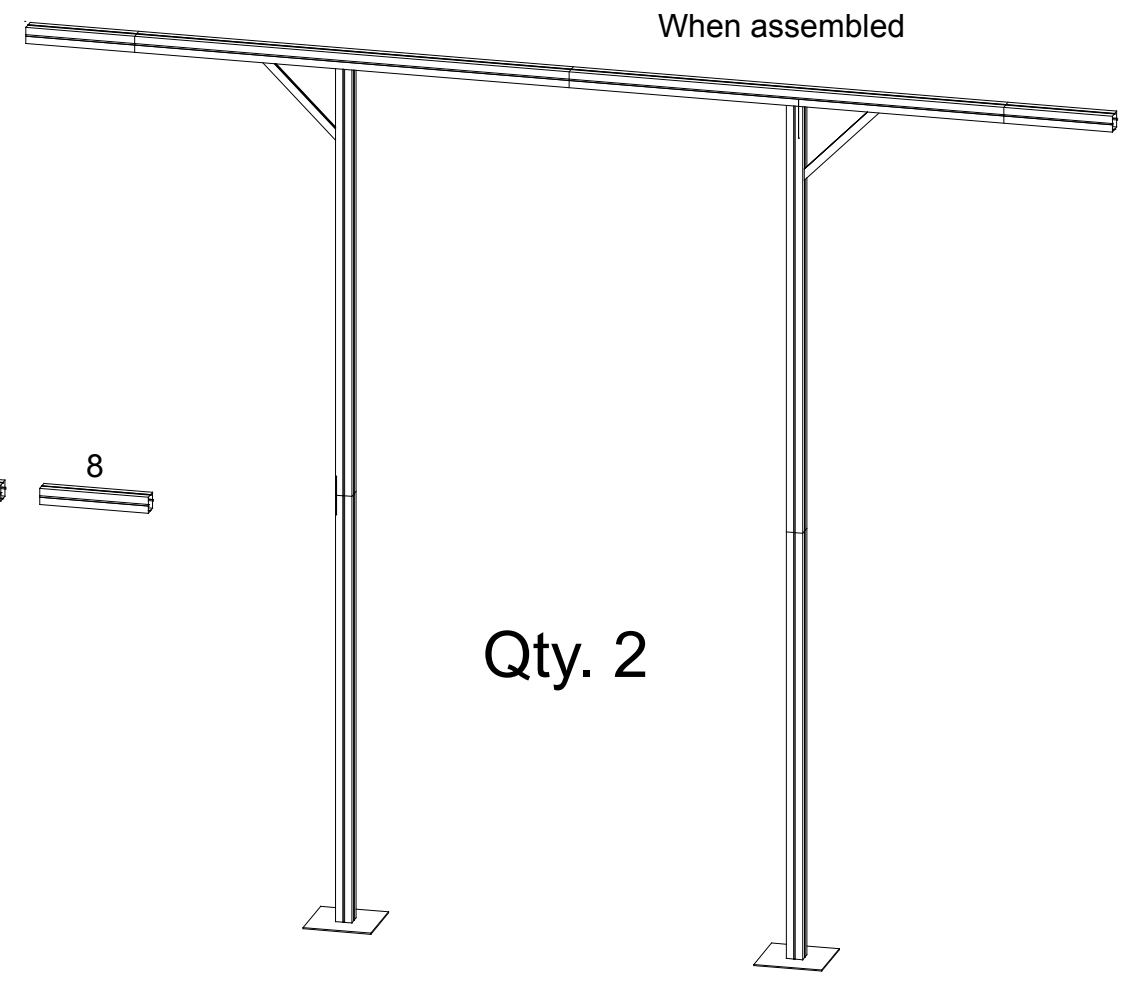
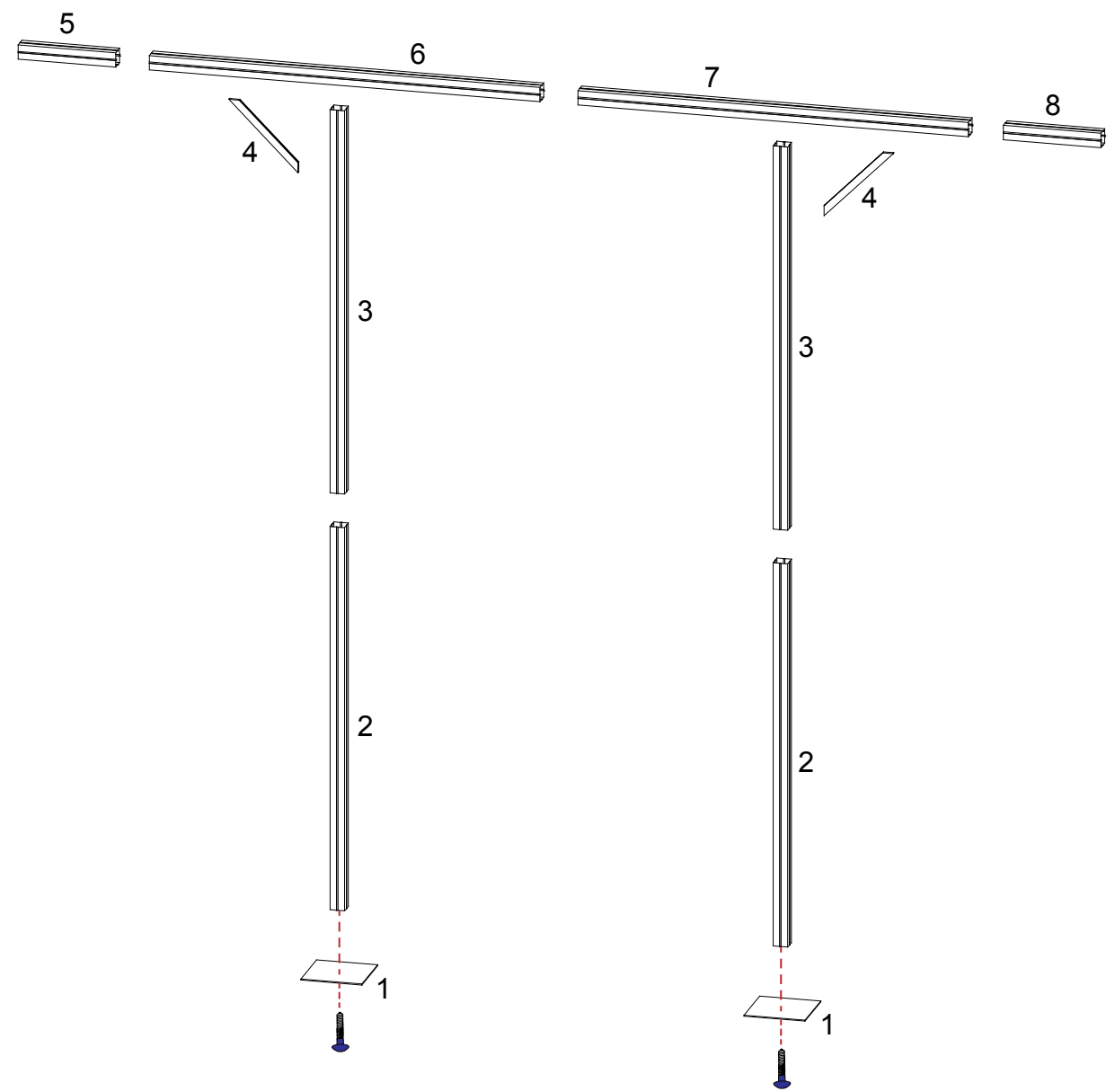

WHEN DISASSEMBLING ALUMINUM EXTRUSION, TIGHTEN ALL SETSCREWS AND LOCKS TO PREVENT LOSS DURING SHIPPING

866.652.2100

Item	Qty.	Description
32	4	120" w Horizontal Extrusion
33	3	96" w Horizontal Extrusion
34	4	Diagonal Brace

Steps:

- 1) Assemble ceiling extrusions [32 and 33] together as shown.
- 2) Attach assembled ceiling section between assembled side sections as shown.
- 3) Attach diagonal braces [34] between assembled ceiling section and assembled side sections.

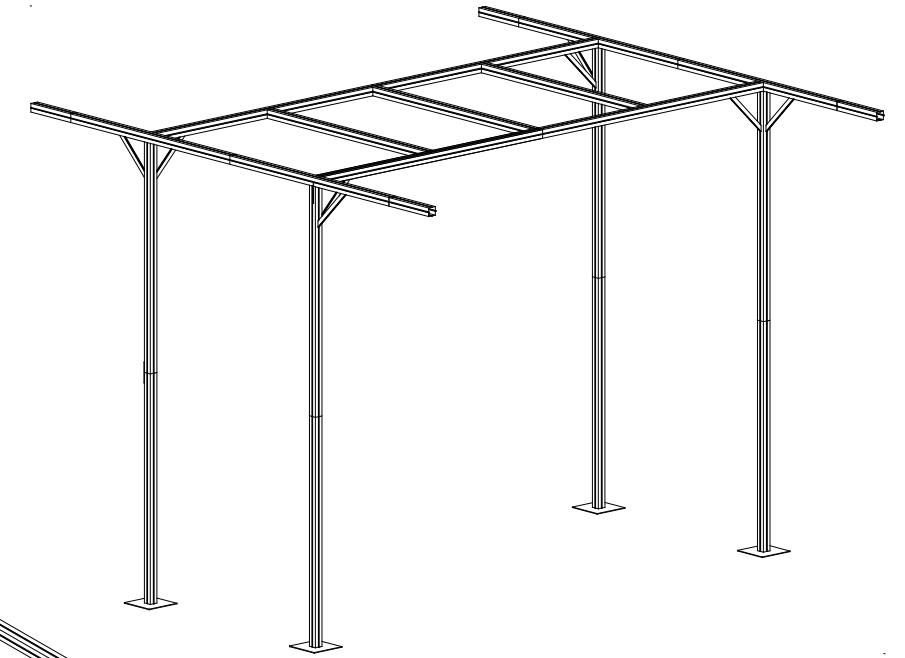
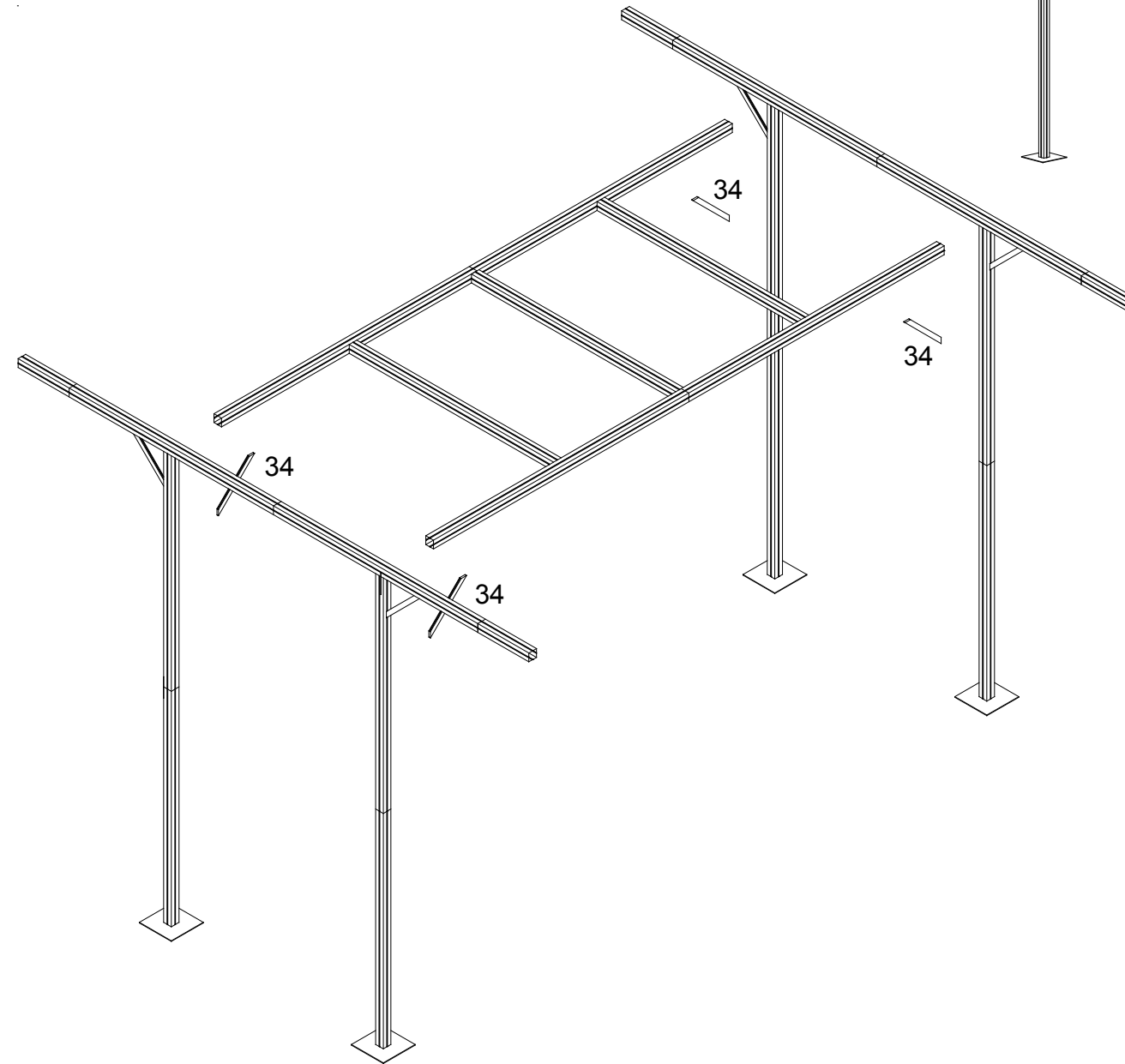
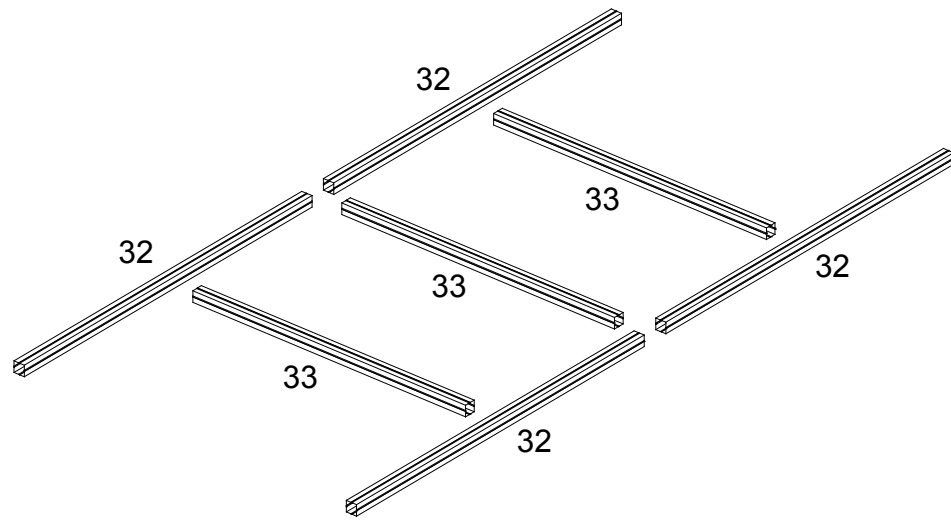

WHEN DISASSEMBLING ALUMINUM EXTRUSION, TIGHTEN ALL SETSCREWS AND LOCKS TO PREVENT LOSS DURING SHIPPING

866.652.2100

Item	Qty.	Description
11	2	10.74"h Vertical Extrusion
12	2	10.74"h Vertical Extrusion
13	2	10.74"h Vertical Extrusion
14	2	10.74"h Vertical Extrusion
15	2	10.74"h Vertical Extrusion
16	2	65.5" Curved Extrusion
17	2	65.5" Curved Extrusion
18	2	65.5" Curved Extrusion
19	2	65.5" Curved Extrusion
20	2	10.74"h Vertical Extrusion
21	2	10.74"h Vertical Extrusion
22	2	10.74"h Vertical Extrusion
23	2	10.74"h Vertical Extrusion
24	2	10.74"h Vertical Extrusion
25	2	10.74"h Vertical Extrusion
26	2	81" Curved Extrusion
27	2	81" Curved Extrusion
28	2	81" Curved Extrusion
29	2	81" Curved Extrusion
30	2	81" Curved Extrusion
31	2	81" Curved Extrusion

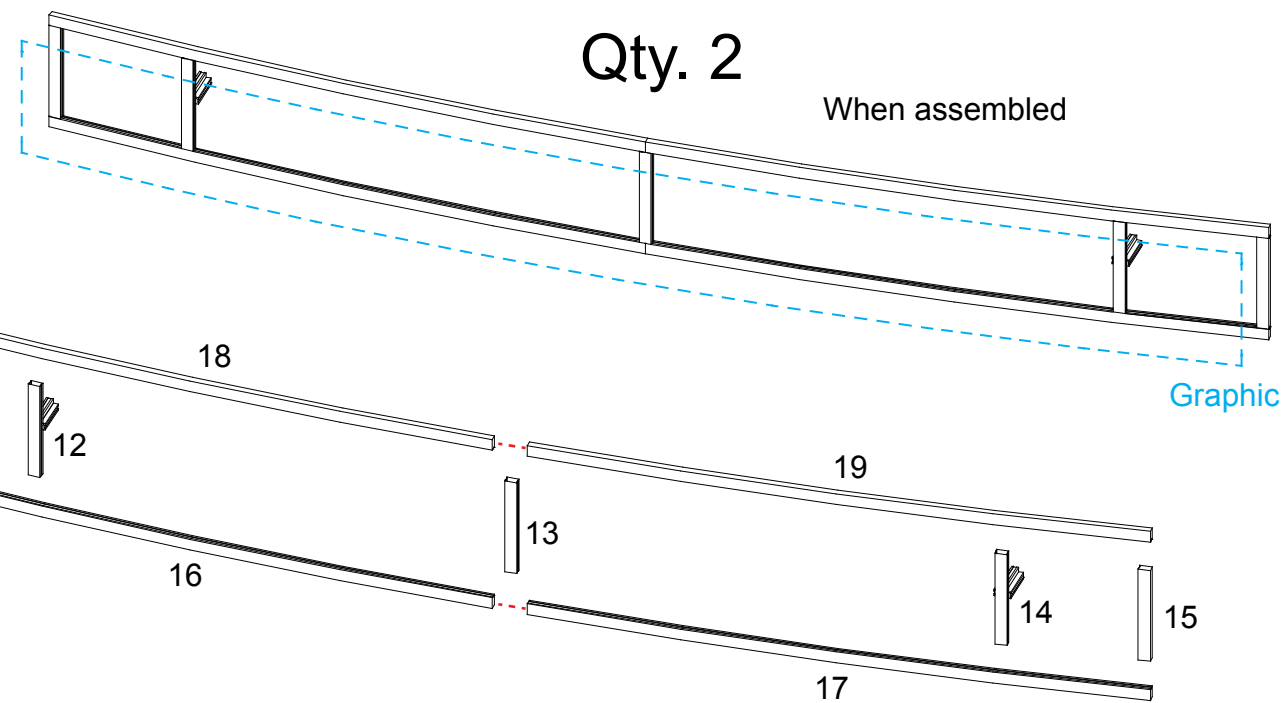
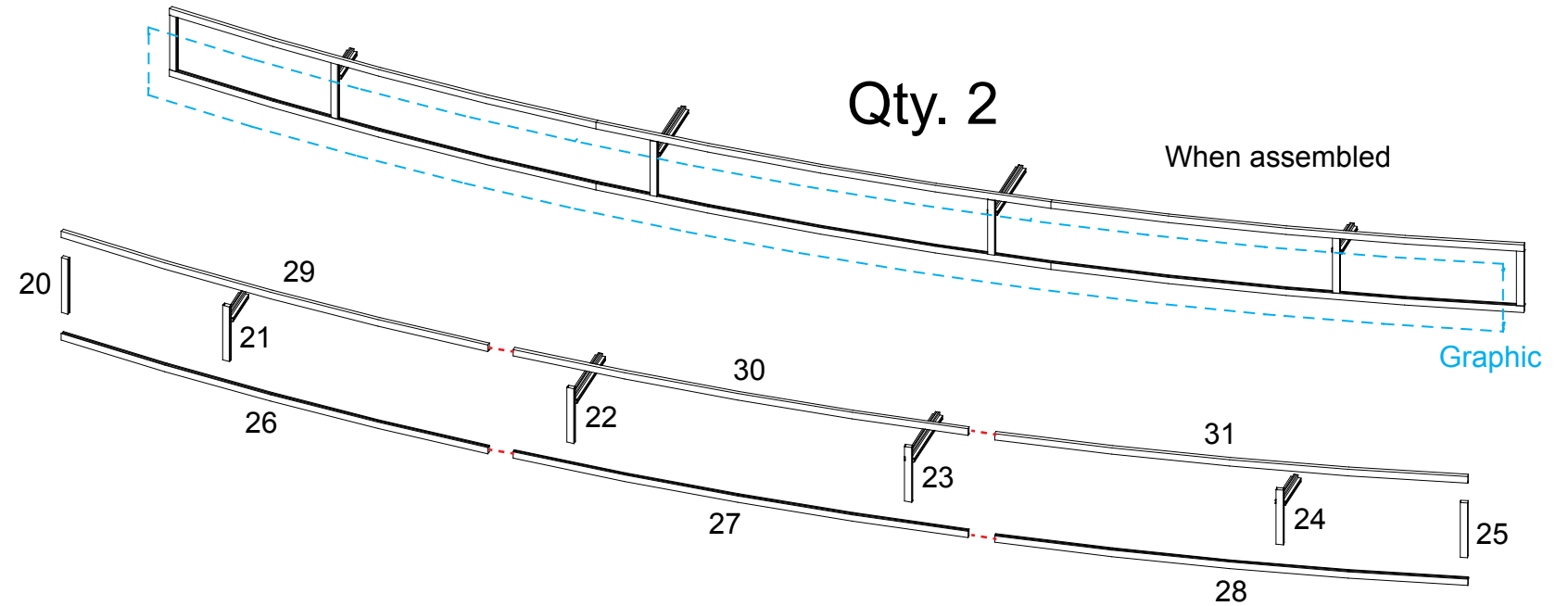

Steps:

- 1) Connect horizontal extrusions together.
- 2) Attach vertical extrusions between horizontal assemblies as shown.

** Magnet attach graphic to header frame **

WHEN DISASSEMBLING ALUMINUM EXTRUSION, TIGHTEN ALL SETSCREWS AND LOCKS TO PREVENT LOSS DURING SHIPPING

866.652.2100

BS32RSET

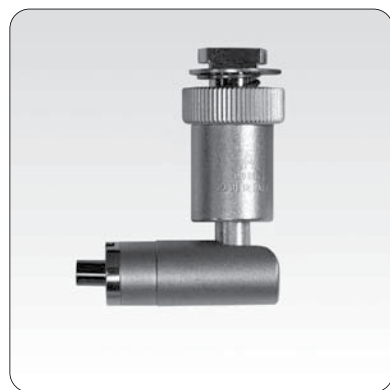

°BS32RSET

BS32RSET is Arakawa's gripper-type, top connector rail clip for hanging angled cable from the CRB/CRC Rail system.

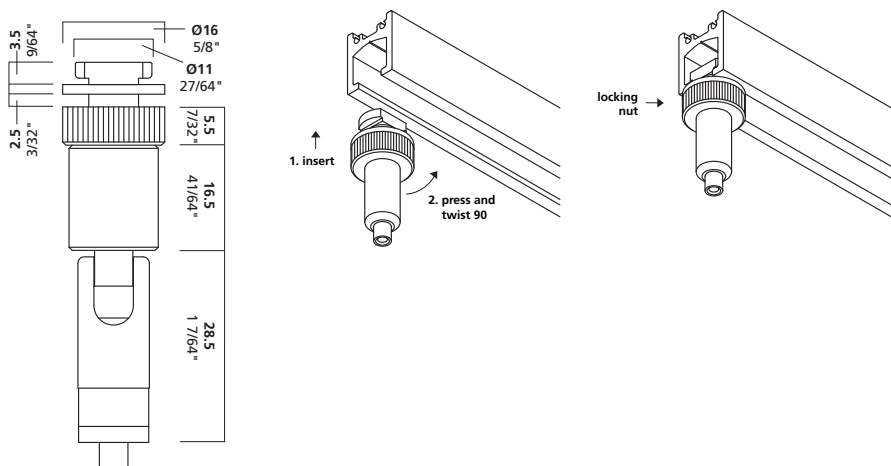

◦ Product Information

cable size 3/64" 1.2 mm 1/16" 1.5 mm	1-2
maximum weight 3/64": 40 lbs. 18 kg 1/16": 65 lbs. 30 kg	
function rail clip for CRB / CRC Rail	
installation To install the BS32RSET rail clips, align properly, insert into the rail, twist 90°, then tighten the locking nut. Cable must be inserted 1/2" - 3/4". Make sure all rail clips are completely tightened. Failure to do so will weaken the system	

SF31SLSET



°SF31SLSET

SF31SLSET was designed to use with up to 1/2" thick glass panels. The extended throat length allows the hole to be drilled farther from the edge, as suggested by revisions to ASTM C-1048. SF31SLSET includes a 33/64"Ø plastic sleeve that covers the M4 screw and prevents glass edge to metal contact.

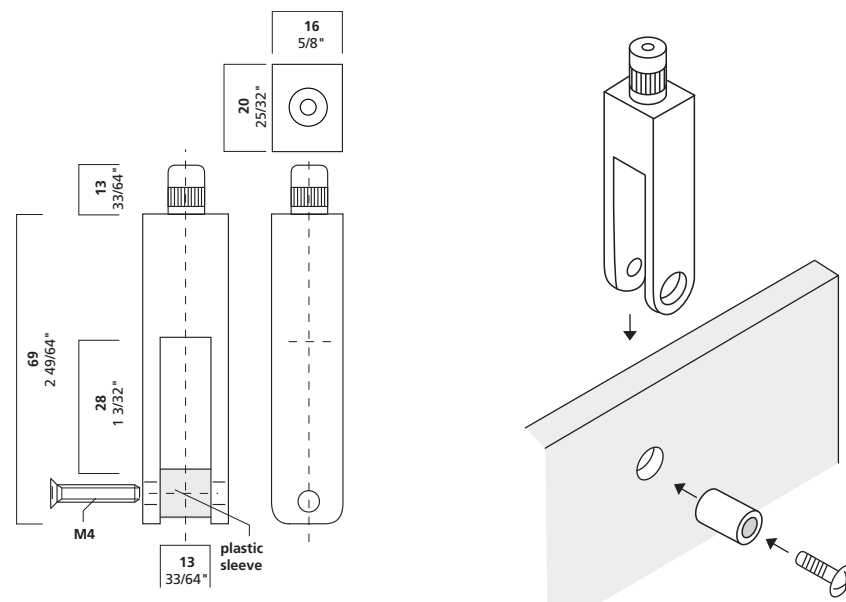

◦ Product Information

cable size 1/16" 1.5 mm 3/32" 2.5 mm	2-3
maximum weight 1/16": 65 lbs. 30 kg 3/32": 155 lbs. 70 kg	
function midway: glass, plexiglass, metal, wood, signs, panels, etc.	
installation instructions A hole (9/16" Ø) is drilled into the glass panel. Align SF31SL with hole, and fix with M4 screw. Note: hole should be drilled 1 1/4" away from edge of glass.	

WHEN DISASSEMBLING ALUMINUM EXTRUSION, TIGHTEN ALL SETSCREWS AND LOCKS TO PREVENT LOSS DURING SHIPPING

Item	Qty.	Description
9	2	Wooden Base
10	2	Wooden Base

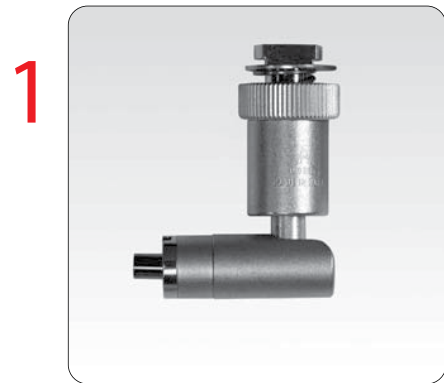

See details next page.



See details next page.

Steps:

- 1) Attach wooden bases [9 and 10] to lower verticals as shown.
- 2) Attach 90° connectors [1] to upper horizontal extrusion according to the spacing provided.
- 3) Attach panel connectors [2] to tops of upper panels.
- 4) Connect panel connectors [2] to 90° connectors [1] with wire to hang upper panels.
- 5) Attach panel connectors [2] to bottoms of upper panels and tops of lower panels.
- 6) Connect panel connectors [2] with wire to hang lower panels.

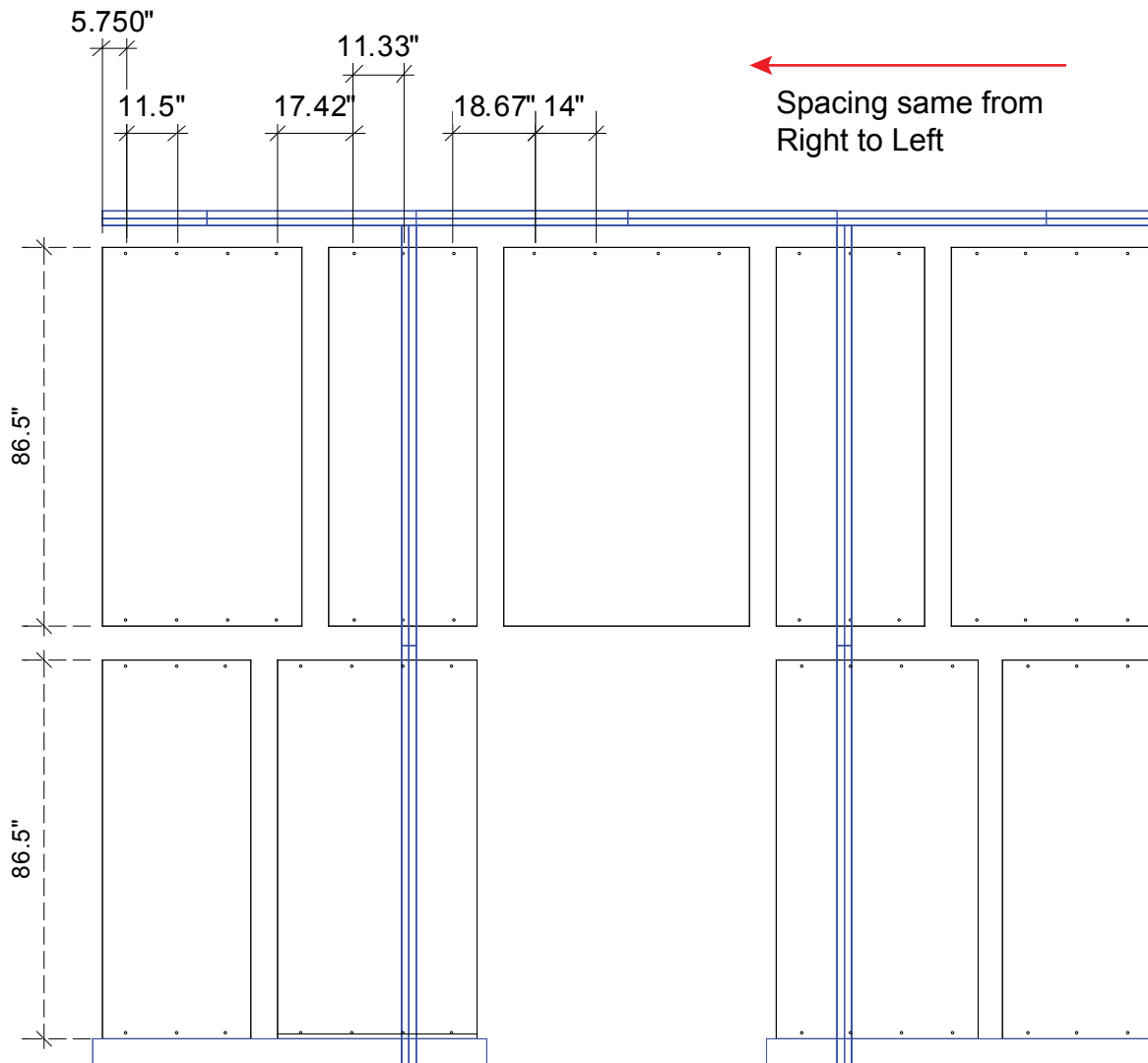

← Spacing same from Right to Left

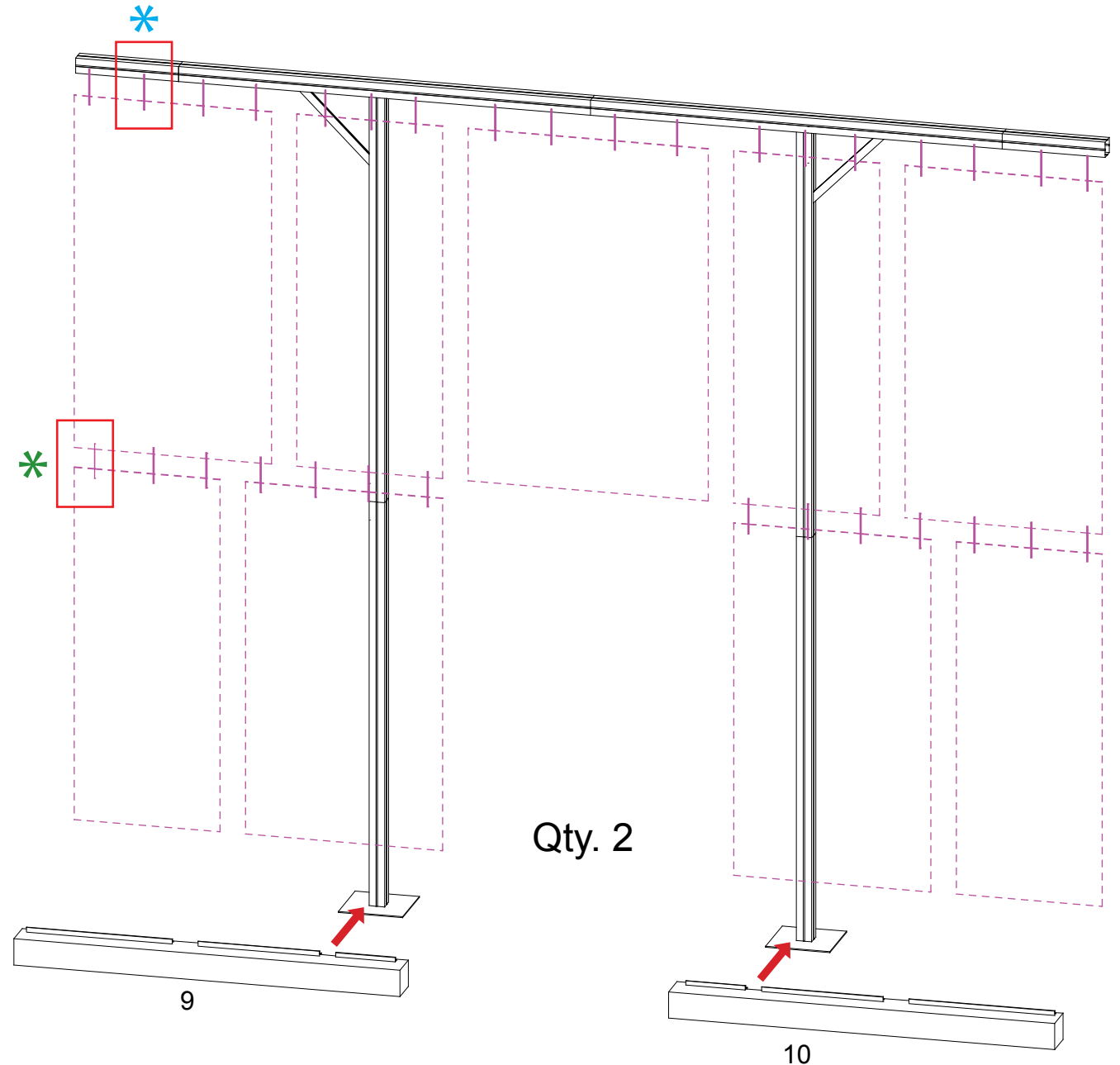

WHEN DISASSEMBLING ALUMINUM EXTRUSION, TIGHTEN ALL SETSCREWS AND LOCKS TO PREVENT LOSS DURING SHIPPING

866.652.2100

Steps:

- 1) Attach lower panels to bases with screws provided.
- 2) Attach assembled headers to extrusions as indicted.

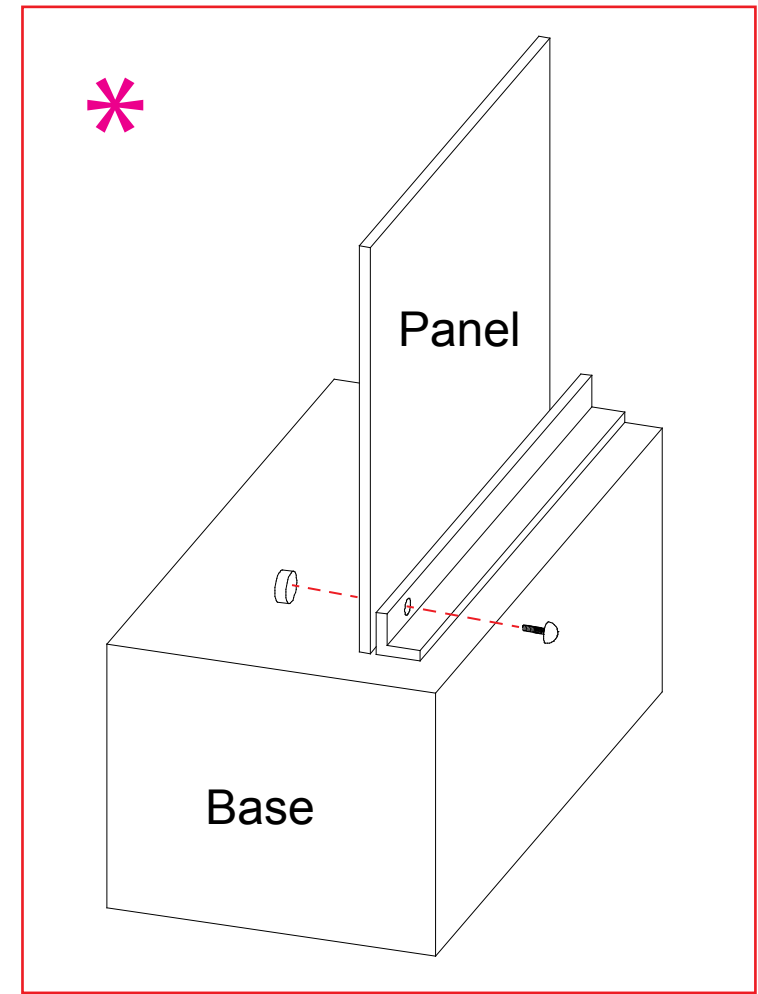
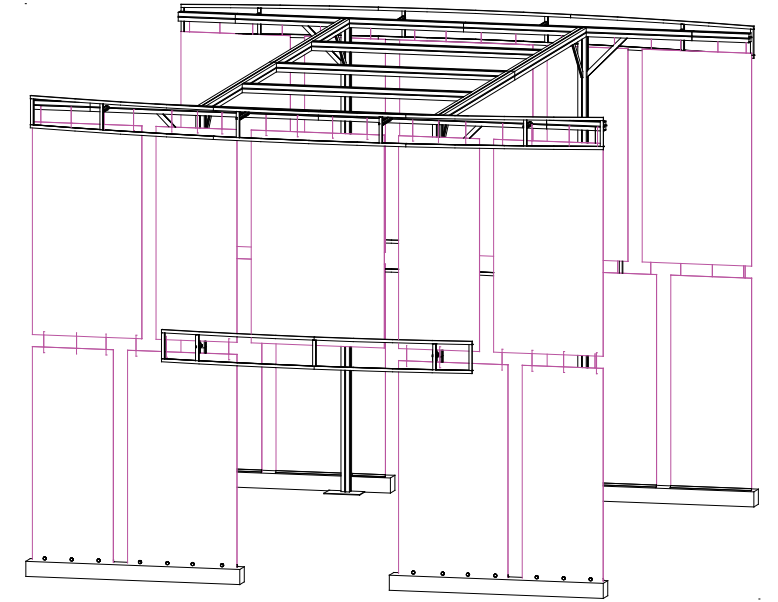
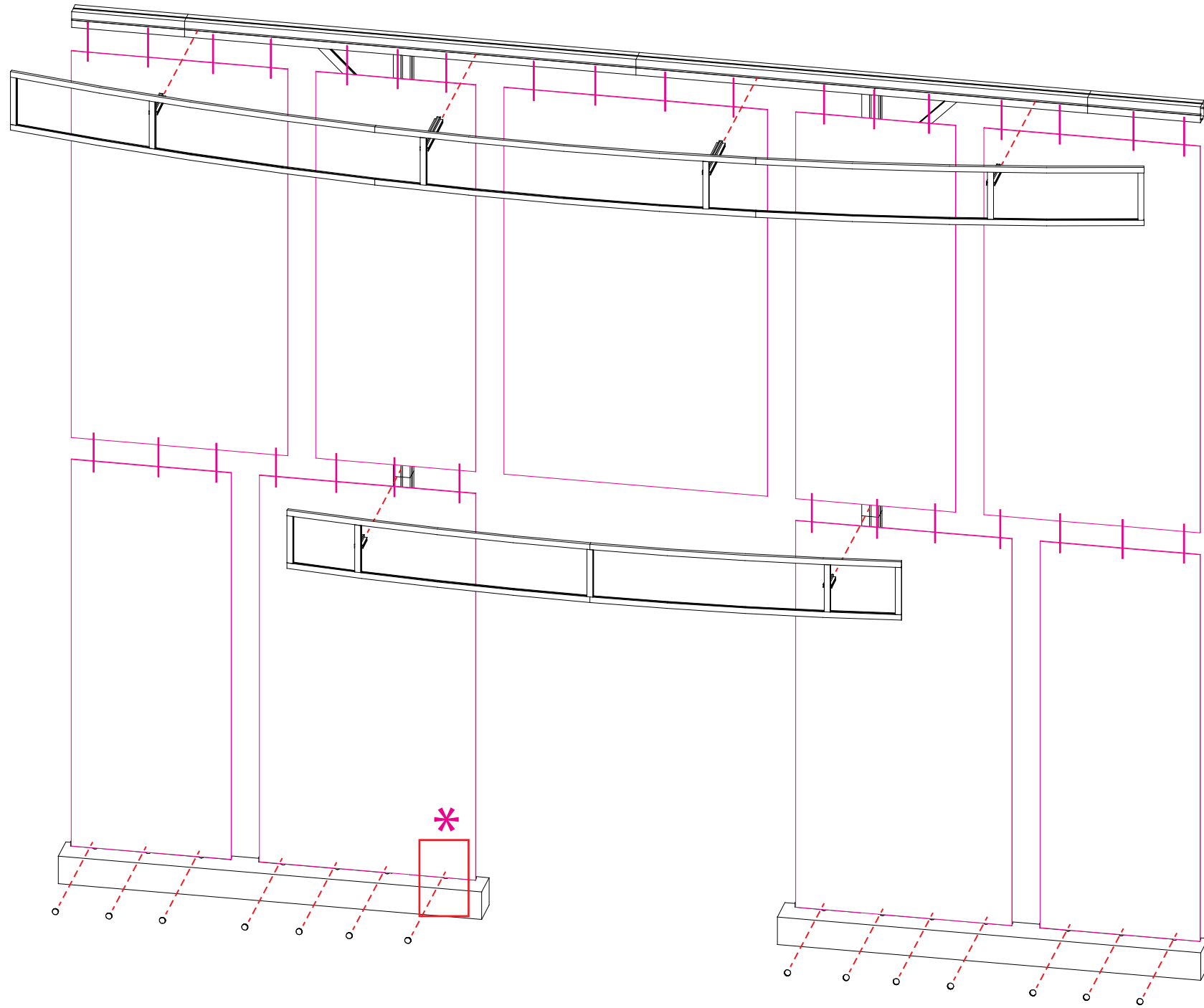

WHEN DISASSEMBLING ALUMINUM EXTRUSION, TIGHTEN ALL SETSCREWS AND LOCKS TO PREVENT LOSS DURING SHIPPING

866.652.2100

** Magnet attach graphic to ceiling as shown **

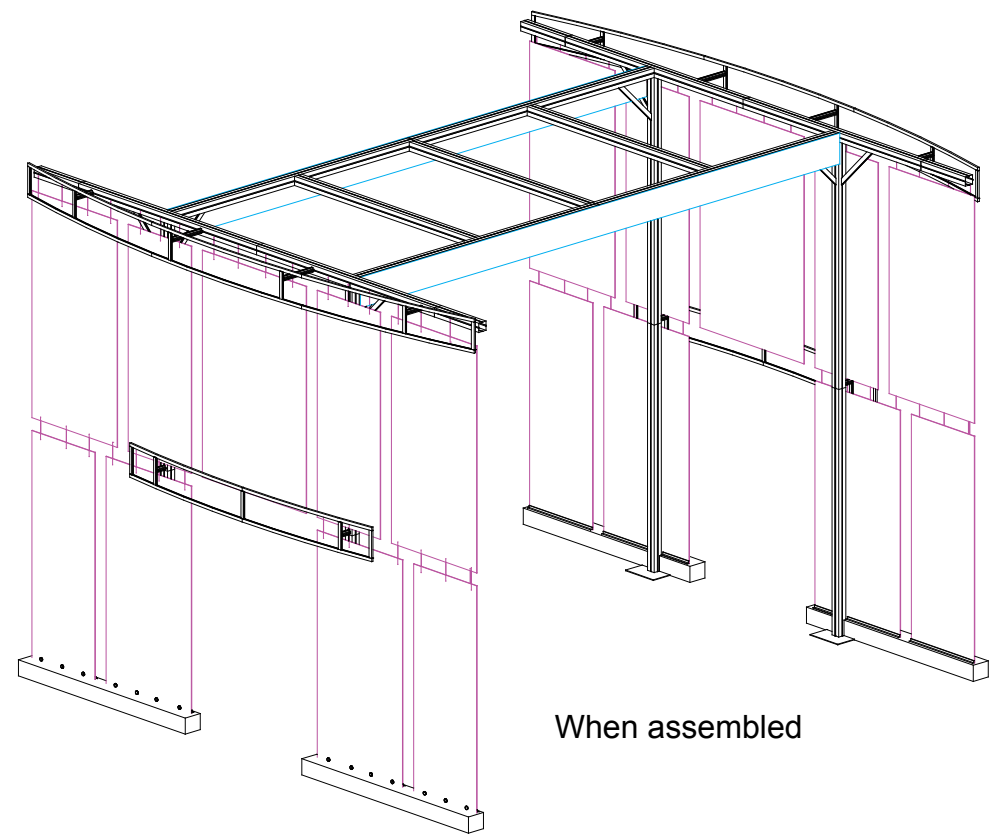
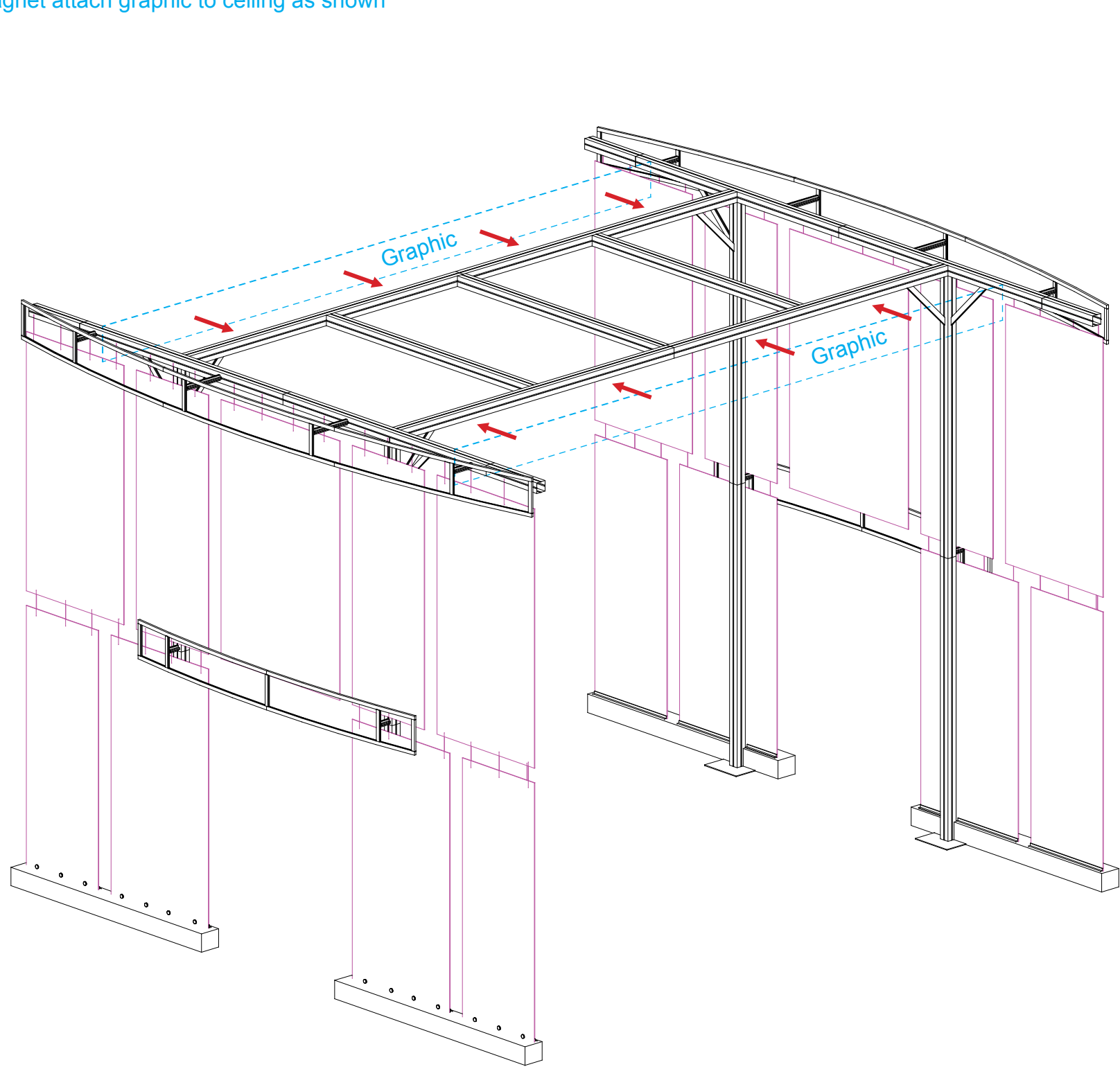

When assembled

WHEN DISASSEMBLING ALUMINUM EXTRUSION, TIGHTEN ALL SETSCREWS AND LOCKS TO PREVENT LOSS DURING SHIPPING

AERO

Using Your Setup Instructions

The Aero Overhead Sign Setup Instructions are created specifically for your configuration. They include an exploded view of the frame which is sequentially numbered. We encourage you to study the instructions before attempting to assemble your exhibit.

Connections are kept very simple: no tools. Everything assembles with push-button connectors and pre-connected horizontal sections.

Cleaning and Packing Your Display

- 1) Use care when cleaning aluminum extrusion or acrylic inserts. Use only non-abrasive cleaners.
- 2) Retain all packing material. It will make re-packing much easier and will reduce the likelihood of shipping damage.

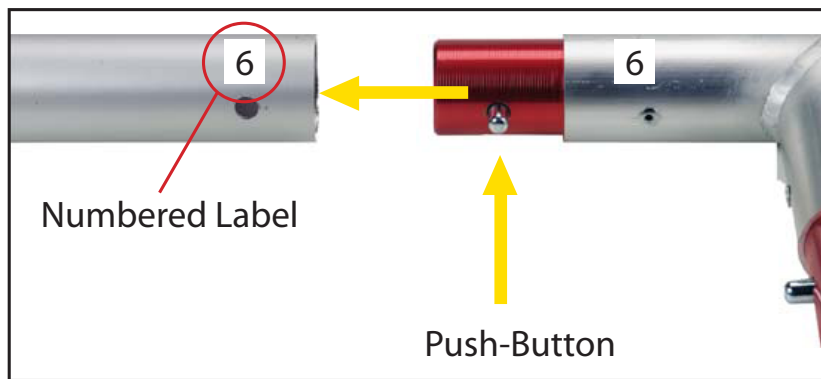

Connections are made by holding the button down and sliding the red tube into opposing tube until the connection is made. To disassemble push button and pull or twist extrusions apart.

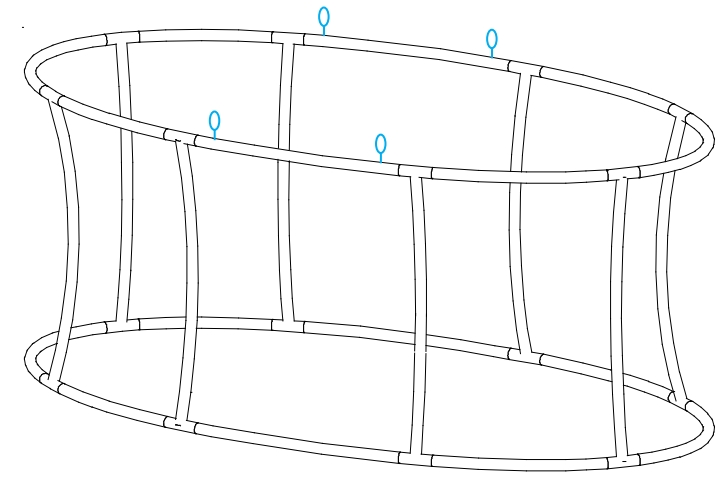
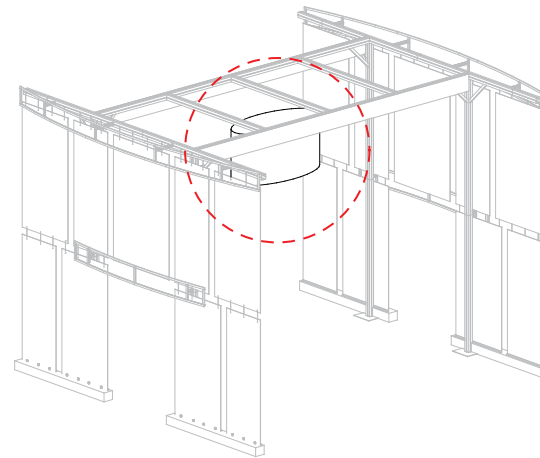
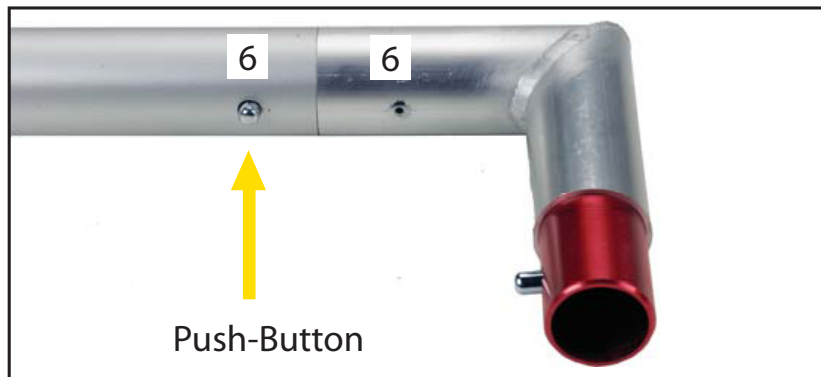

When assembled

- 1) Connect all upper and lower pieces together in numerical order.
- 2) Connect upper section and lower section together using (8) verticals.
- 3) Attach aero frame to ceiling. Refer to detail next page.

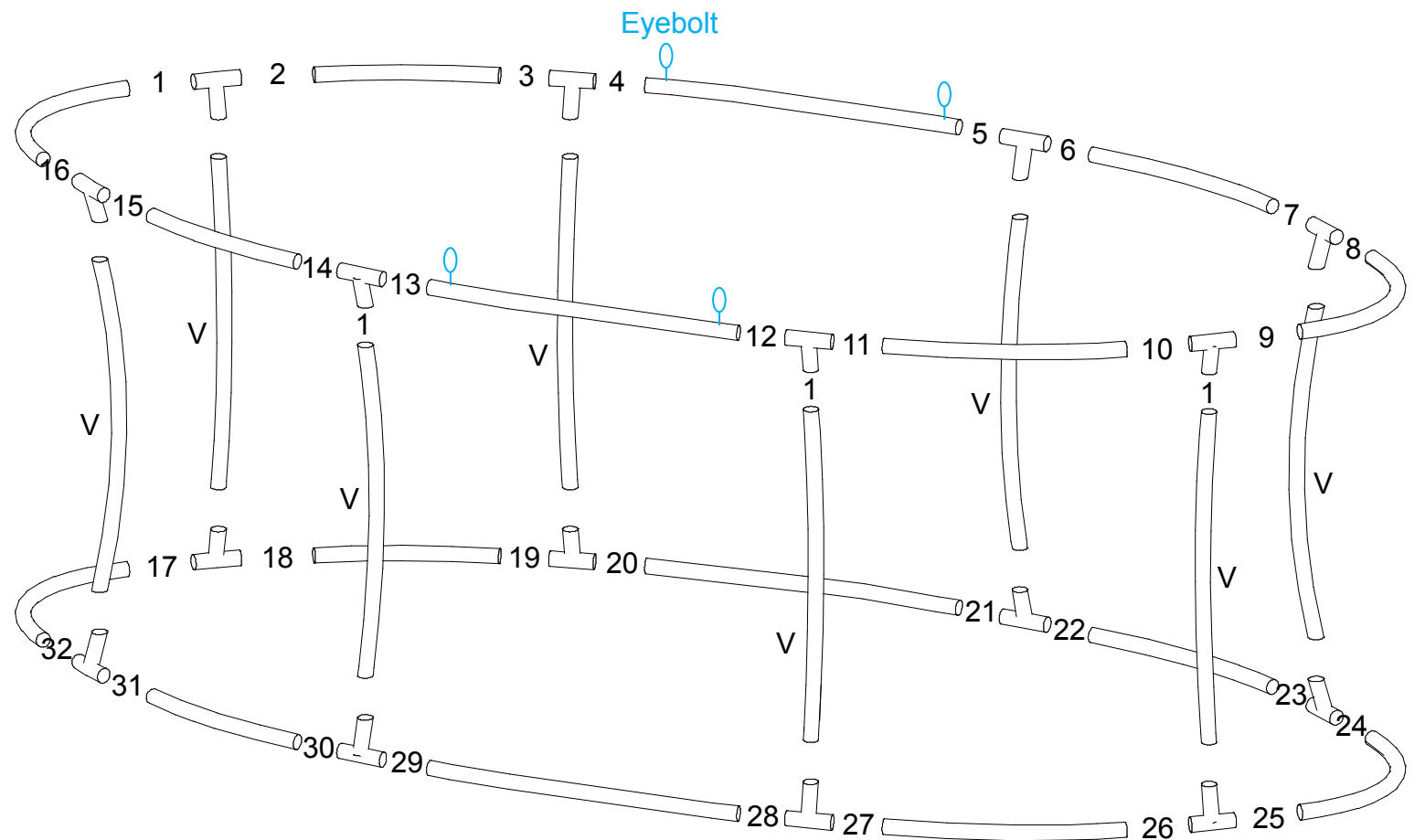

WHEN DISASSEMBLING ALUMINUM EXTRUSION, TIGHTEN ALL SETSCREWS AND LOCKS TO PREVENT LOSS DURING SHIPPING

Engineering Specifications

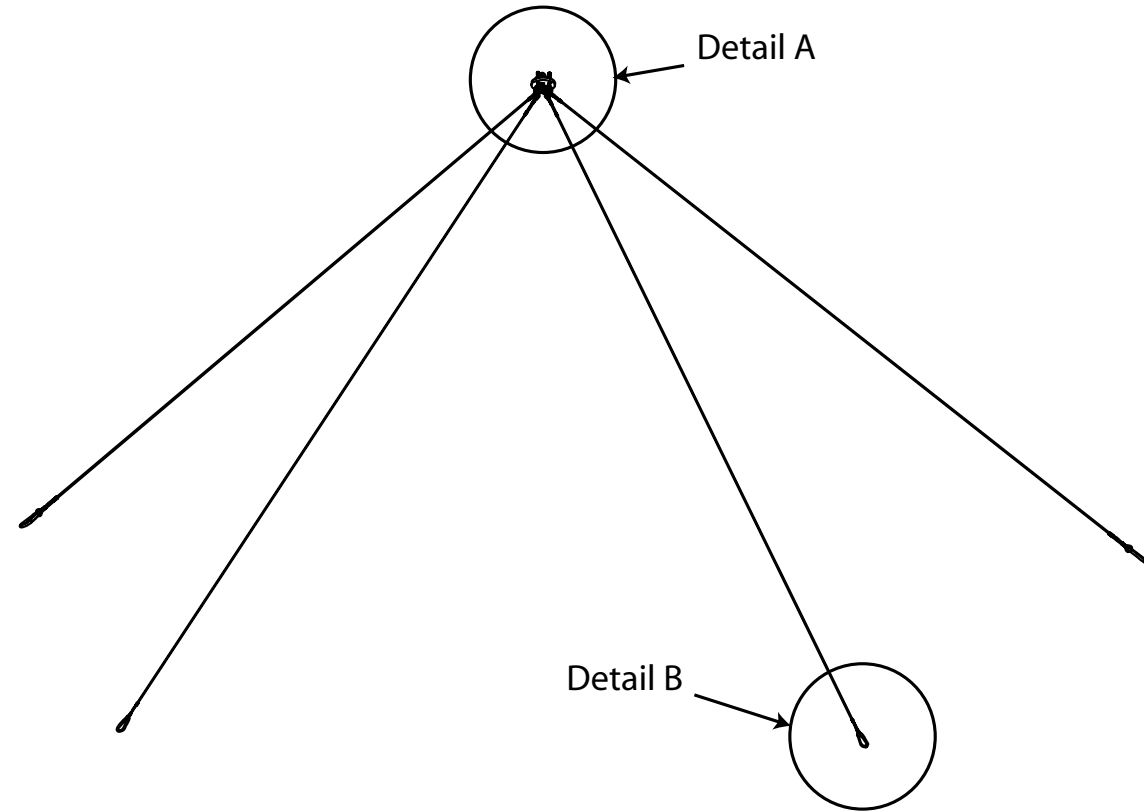

Construction consists of the following materials:

1. 302/304 (1/8") Stainless Steel Cable (Rated at 1760 lbs break strength)
2. Plated Spring-loaded Interlocking Snaps (Rated at 280 lbs working load)
3. Nicoperss Oval Sleeves (Holding strength rated at 900 lbs)
4. 0.25" x 4" Diameter T6061 Aluminum Plate
5. Eye Bolts (Rated 900 lbs on vertical lift and 450 lbs on 45 degree lift)

Harness Strength Calculation

Hanging sign weight is calculated based on weight of the structure and the weight of the fabric:

1. The weight of the structure material is 0.29 lbs per linear feet
2. The weight of the fabric is 0.04 lbs per sq. feet

Based on information above, one string of the harness at a standard 45 degree sling angle will accommodate 163 sq. feet surface measured sign. The vertical string will hold 233 sq. feet surface measured sign.

NOTE: If motor used for rotation, see motor specification.

Detail A

Harness Head Assembly

Classic Rotating Motor Specifications
**Optional

MODEL IG-4 HANGING ROTATOR
(NO SPINNING POWER CORD)
PART # 150001 021HANG

HANGING WEIGHT CAPACITY: 200 LBS.
AVAILABLE RPM SPEEDS: 1, 2(STD), 3, 4, 6
MOTOR DRAW: 0.1A (12w)
SAFETY CLUTCH: YES

MK	Qty	Desc
10e	1	.313 Nylok Hex Nut
10c	2	.125 Copper Stop 520-20040
10f	1	.313 Kidney Snap 434-24905
		Typical 4 Places

****Complete Engineering Certifications are available at www.classicexhibits.com.**

Use the "Search for Setup Instructions Tool" on the Classic Home Page

(lower left-hand corner).

Search for Setup Instructions

Enter this 5 digit #

WHEN DISASSEMBLING ALUMINUM EXTRUSION, TIGHTEN ALL SETSCREWS AND LOCKS TO PREVENT LOSS DURING SHIPPING



Level 1

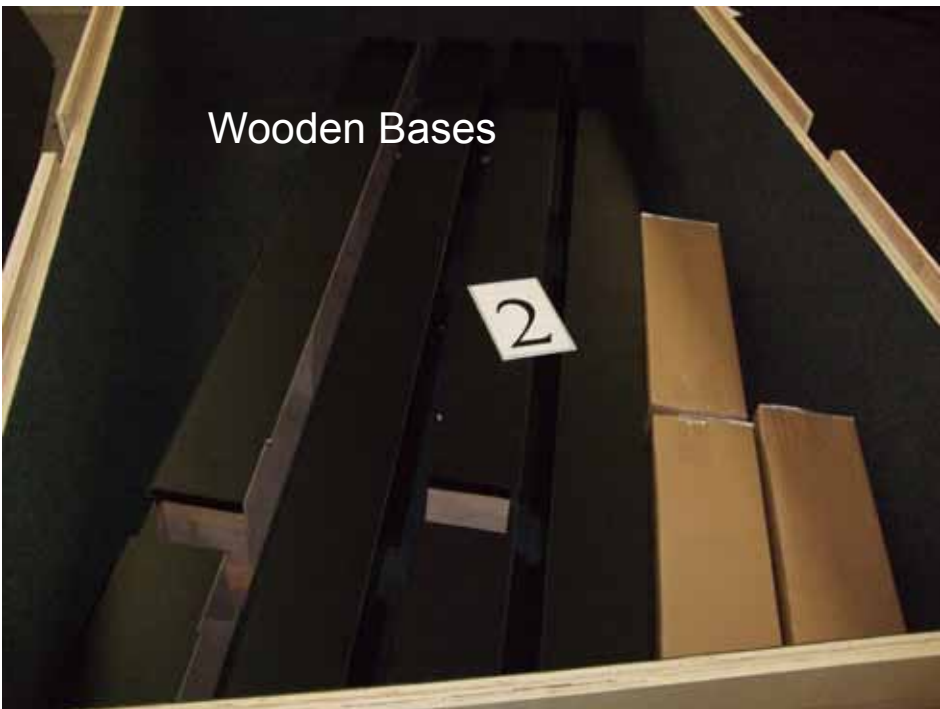

Level 2



Level 3

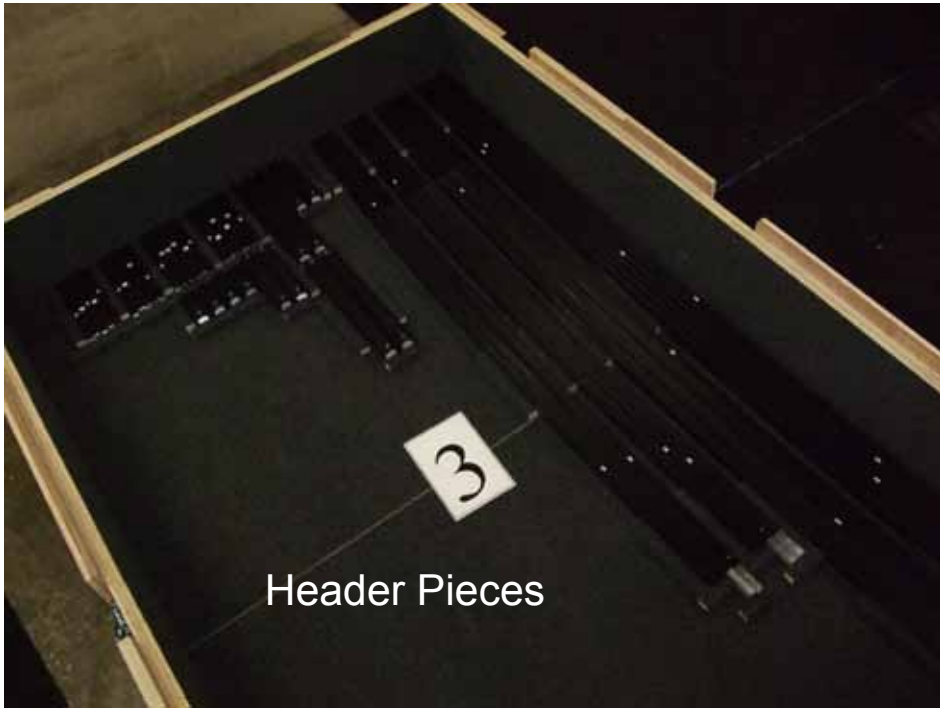

Level 3

WHEN DISASSEMBLING ALUMINUM EXTRUSION, TIGHTEN ALL SETSCREWS AND LOCKS TO PREVENT LOSS DURING SHIPPING