

General Setup Instructions

- Read entire setup instruction manual prior to unpacking parts and pieces.
- The setup instructions are created specifically for this configuration.
- Setup instructions are laid out sequentially in steps, including exploded views with detailed explanation for assembly.

Cleaning & Packing

- For Cleaning Metal, Plex, & Laminate Parts: Use a **MILD NON-ABRASIVE** cleanser and soft cloth/paper towel to clean all surfaces.
- Keep exhibit components away from heat and prolonged sun exposure.
Heat and UV exposure will warp and fade components.
- Retain all provided Packing Materials. All provided packing materials are for ease of repacking & component protection.

Disassembly

- For loss prevention, tighten all setscrews and locks during disassembly

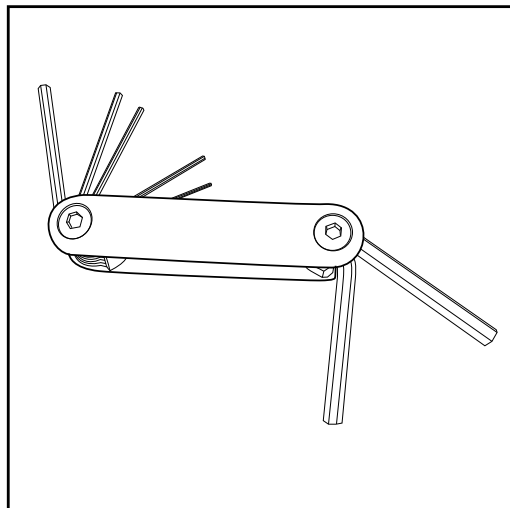

Hex Tool - Essential for Assembly

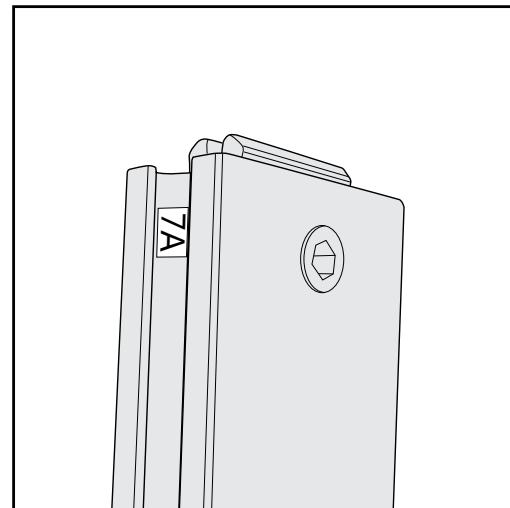

Part Identification - Numbering

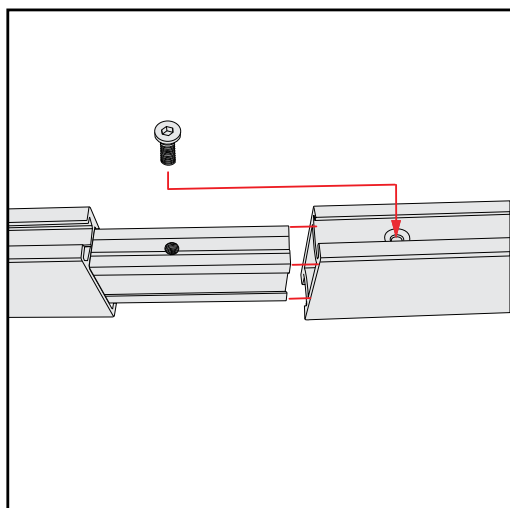

Spline Connection

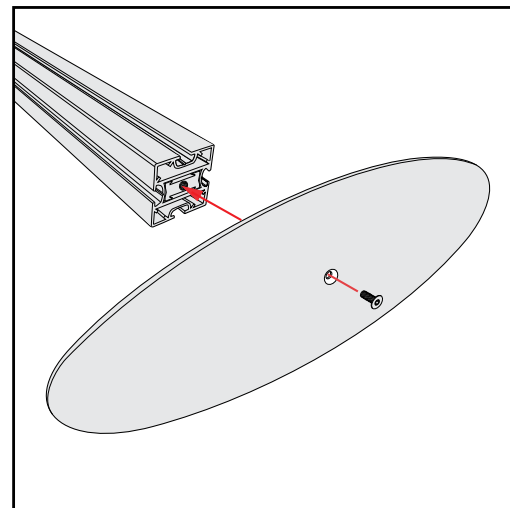

Base Plate & Extrusion Connection

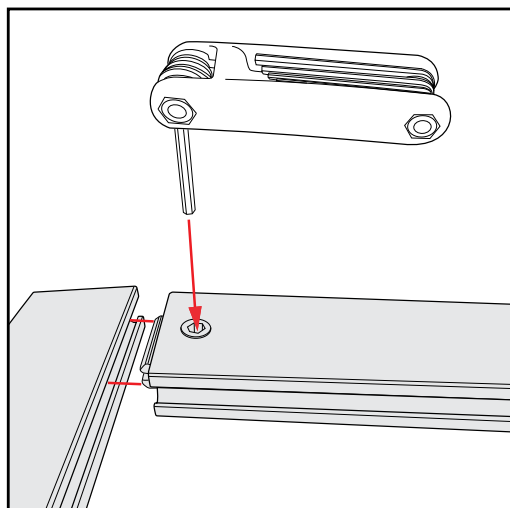

Extrusion & Lock Connection

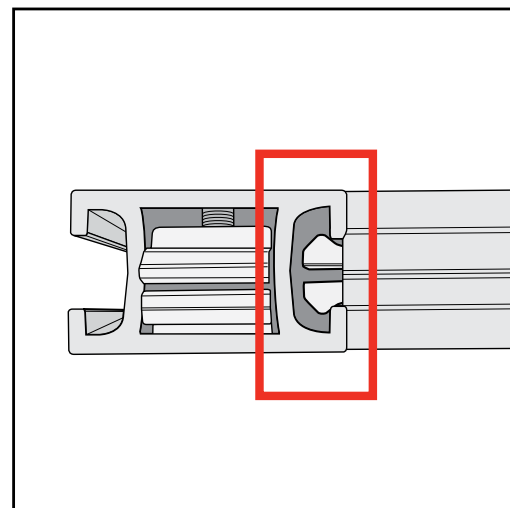

Engaged Lock



WARNING

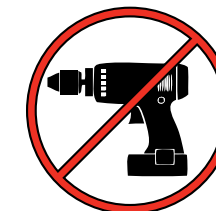

DO NOT USE POWER TOOLS

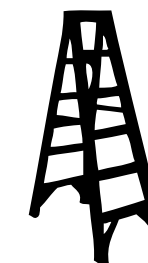

LADDERS OR LIFTS
MAY BE REQUIRED



ALL CONNECTIONS MUST
BE TIGHTLY SECURED

SEG Graphic Installation

- 1) Locate channels along the edges of extrusions
- 2) Insert graphic corners first into channels then center point of graphic into channels. Allows for proportional fit around the perimeter of the extrusion.
- 3) Working from center to corner, slide silicon edge on graphic into channel.
- 4) After all edges of graphic have been inserted into channels, step back and assess graphic fit, make adjustments where needed.

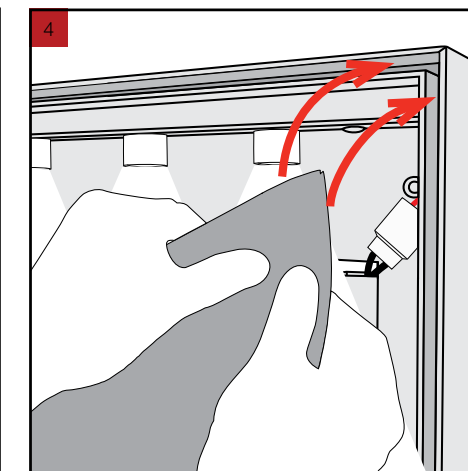
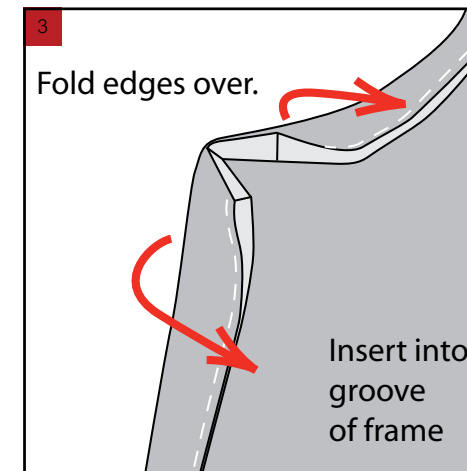
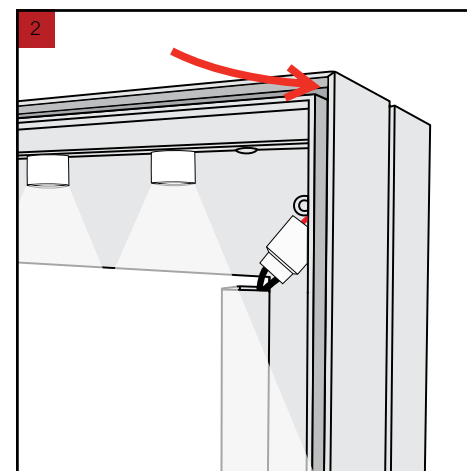
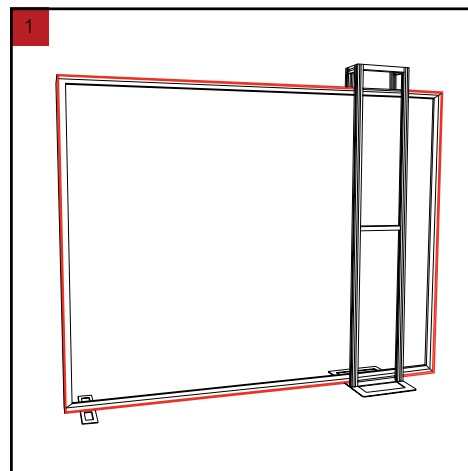

LT Panel Assembly

- 1) With a vertical offset, place LT-Panels side-by-side; slide vertically offset panel down to lock panels together and in place.
- 2) Corner Connectors (90°, T-Connector, Straight Connector) connect just as panels connect together. Repeat Step 1 for installing corner connectors to panels.

LT Panel Disassembly

- 1) To disassemble push panel with upper locks horizontally to disengage top lock clip.
- 2) Slide panels or connectors vertically in opposing directions to release latches and disconnect parts.

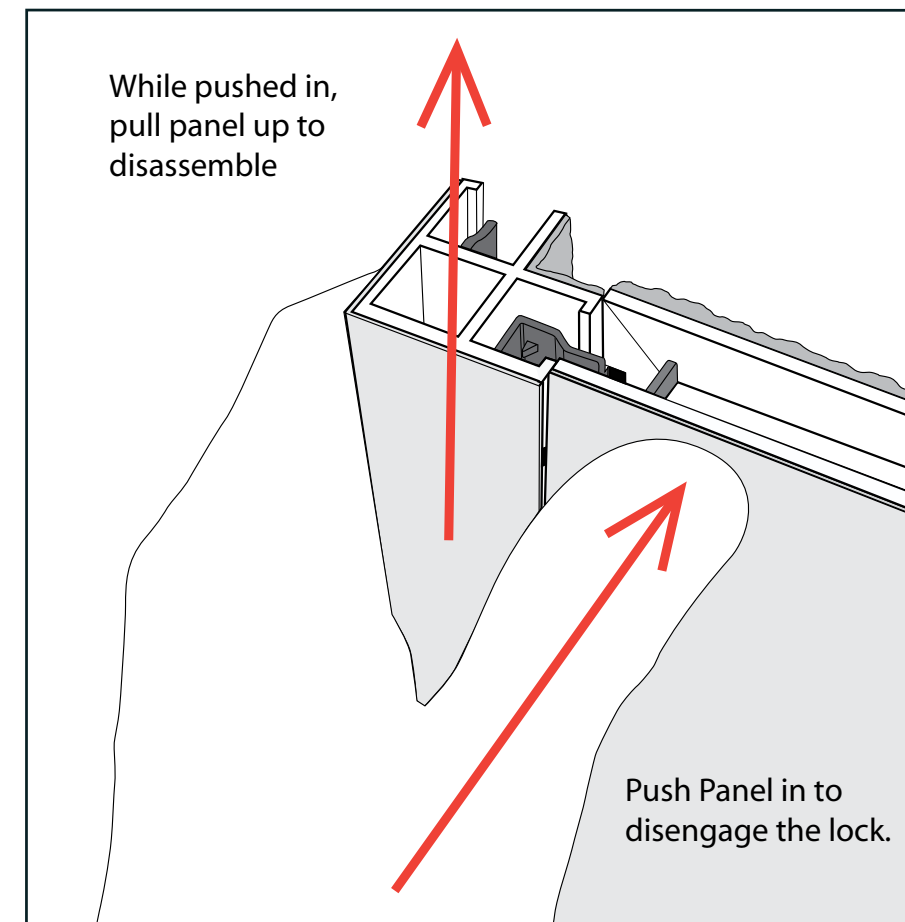
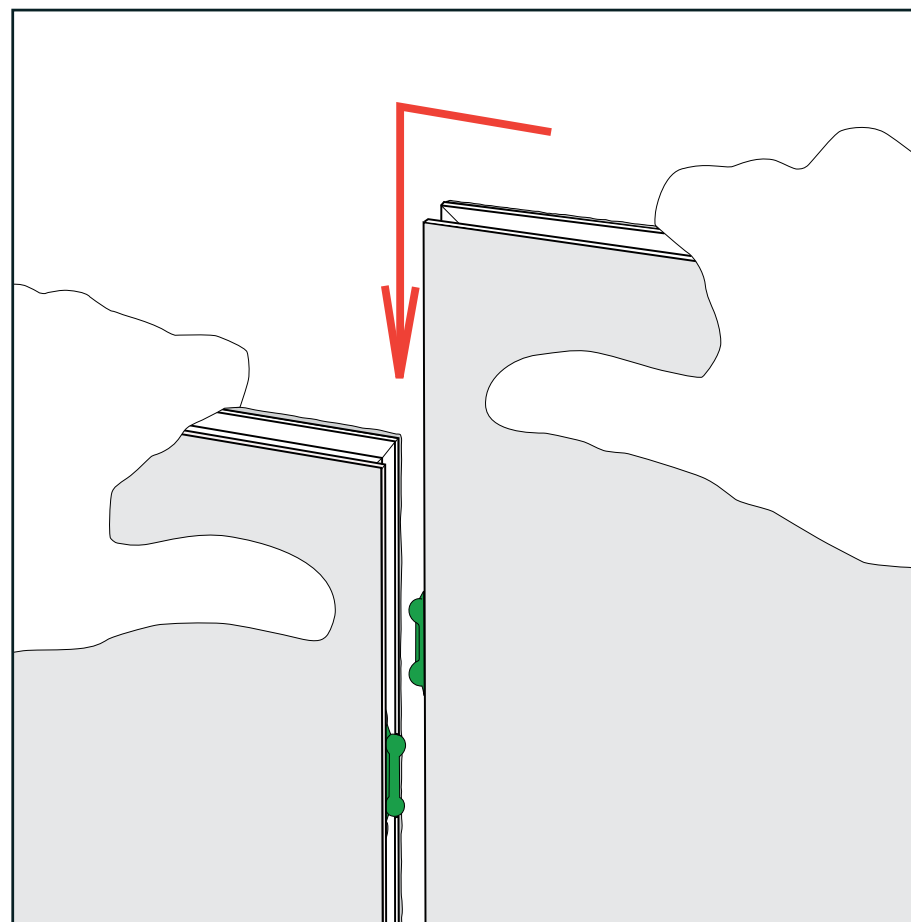



Level 1



Level 2

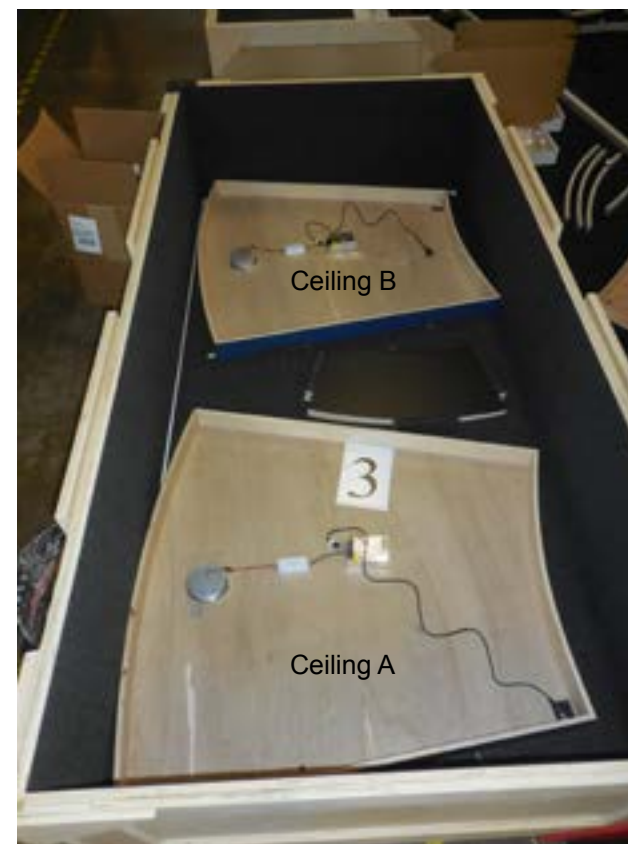

Level 3



Level 4



Level 5



Level 6

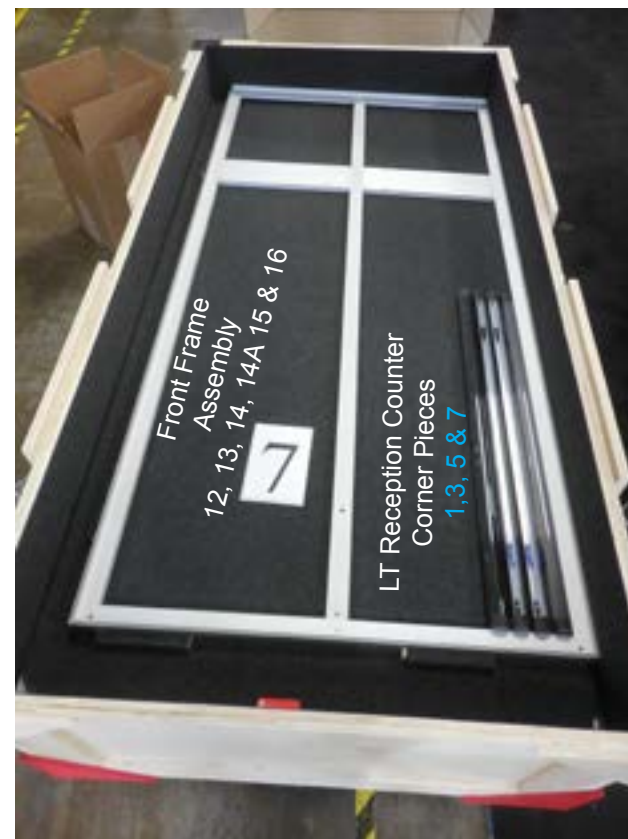

Level 7

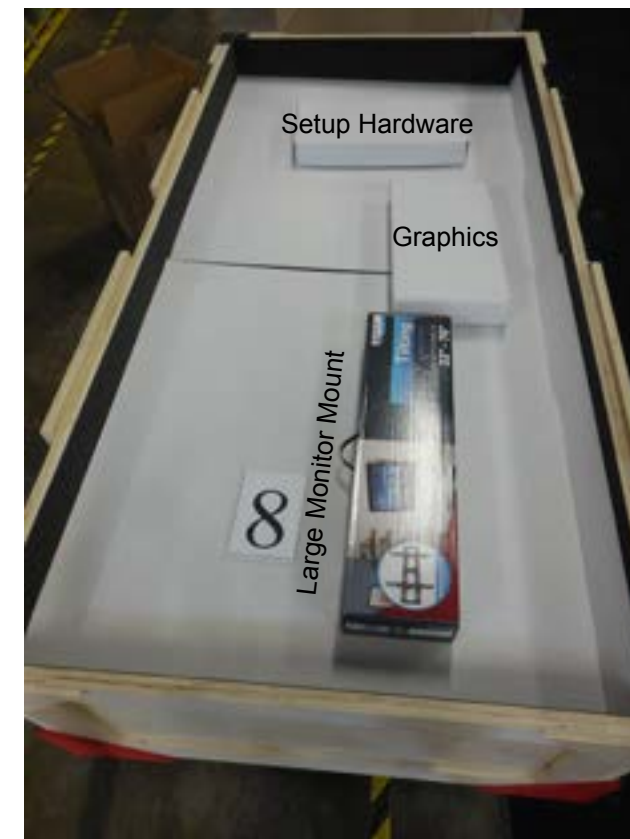

Level 8

Item	Qty.	Description
1	1	95.5”h S44 Vertical Extrusion
2	1	95.5”h S44 Vertical Extrusion
3	1	95.5”h S44 Vertical Extrusion
4	1	95.5”h S44 Vertical Extrusion
5	1	95.5”h S44 Vertical Extrusion
6	1	95.5”h S44 Vertical Extrusion
7	1	22.25”w Z45 Horizontal Extrusion
8	2	45.2297”w Z45 Curved Horizontal Extrusion
9	2	31.5927”w Z45 Curved Horizontal Extrusion
10	1	Door Threshold

Steps:

- 1) Connect horizontal [7] between verticals [1] & [2].
- 2) Attach horizontal [8] between verticals [2] & [3].
- 3) Attach other horizontal [8] between verticals [3] & [4].
- 4) Install door threshold between verticals [4] & [5].
See Door Threshold detail.
- 5) Connect horizontal [9] between verticals [5] & [6].
- 6) Attach other horizontal [9] between verticals [1] & [6].

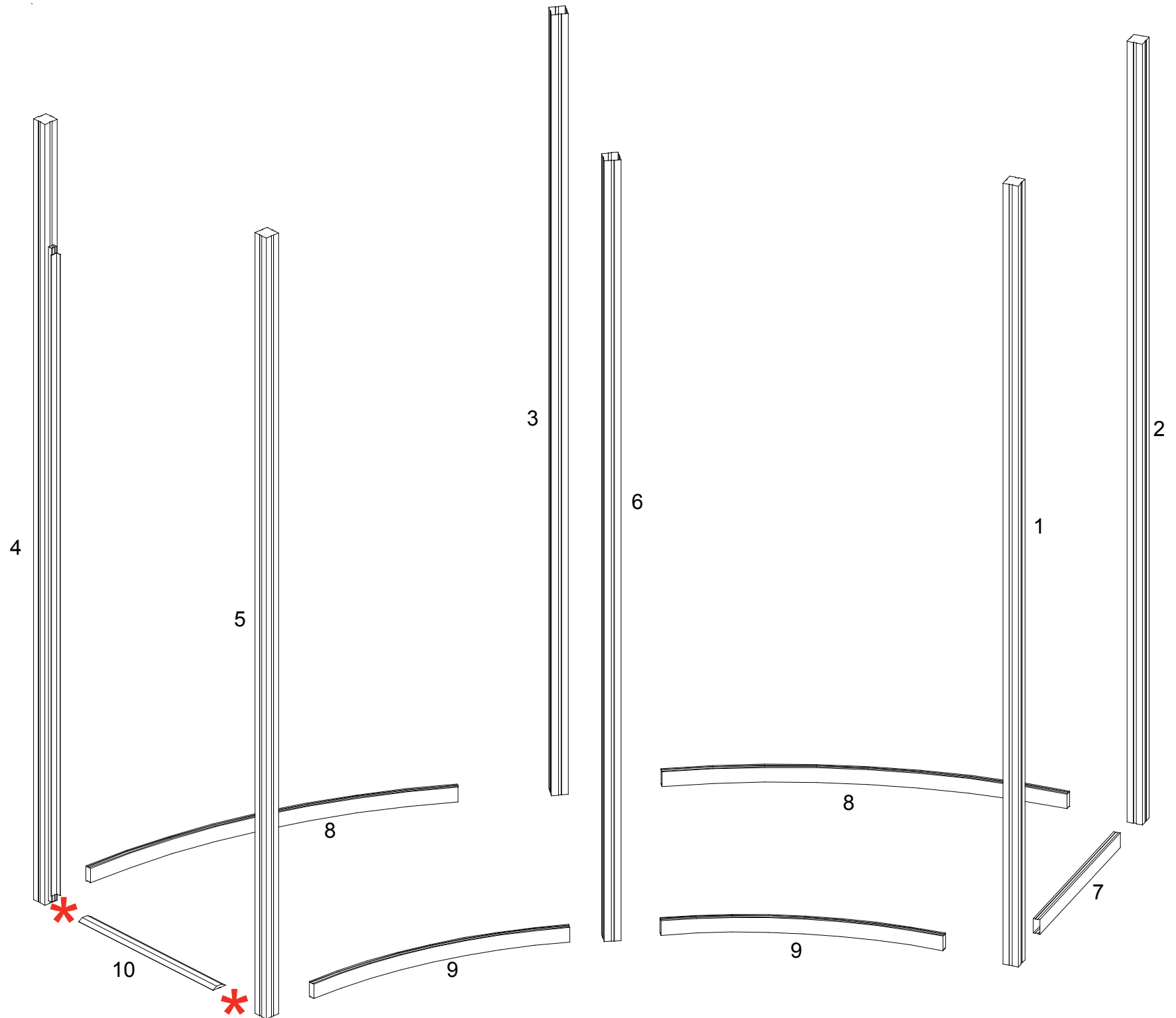
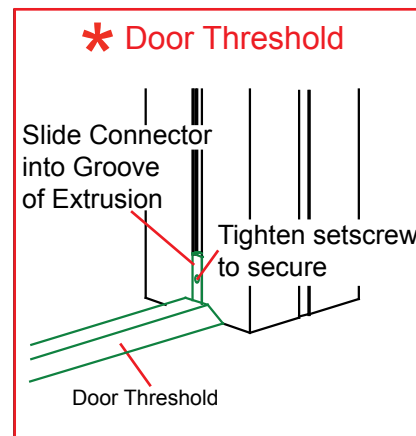

BACK SIDE

Item	Qty.	Description
7A	1	22.25"w Z45 Horizontal Extrusion
8A	2	45.2297"w Z45 Curved Horizontal Extrusion
9A	2	31.5927"w Z45 Curved Horizontal Extrusion
11/11A	1/1	22.25"w Z45 Horizontal Extrusion

Steps:

- 1) Insert infill between verticals [1] & [2] and secure in place using horizontal [7A].
- 2) Repeat Step 1. to insert infills between verticals [2], [3] & [4] and securing in place with horizontals [8A].
- 3) Attach horizontal [11] between verticals [4] & [5].
- 4) Insert infill between verticals [4] & [5] and secure in place using horizontal [11A].
- 5) Install door to assembled frame where indicated.
See **Door Installation** detail.

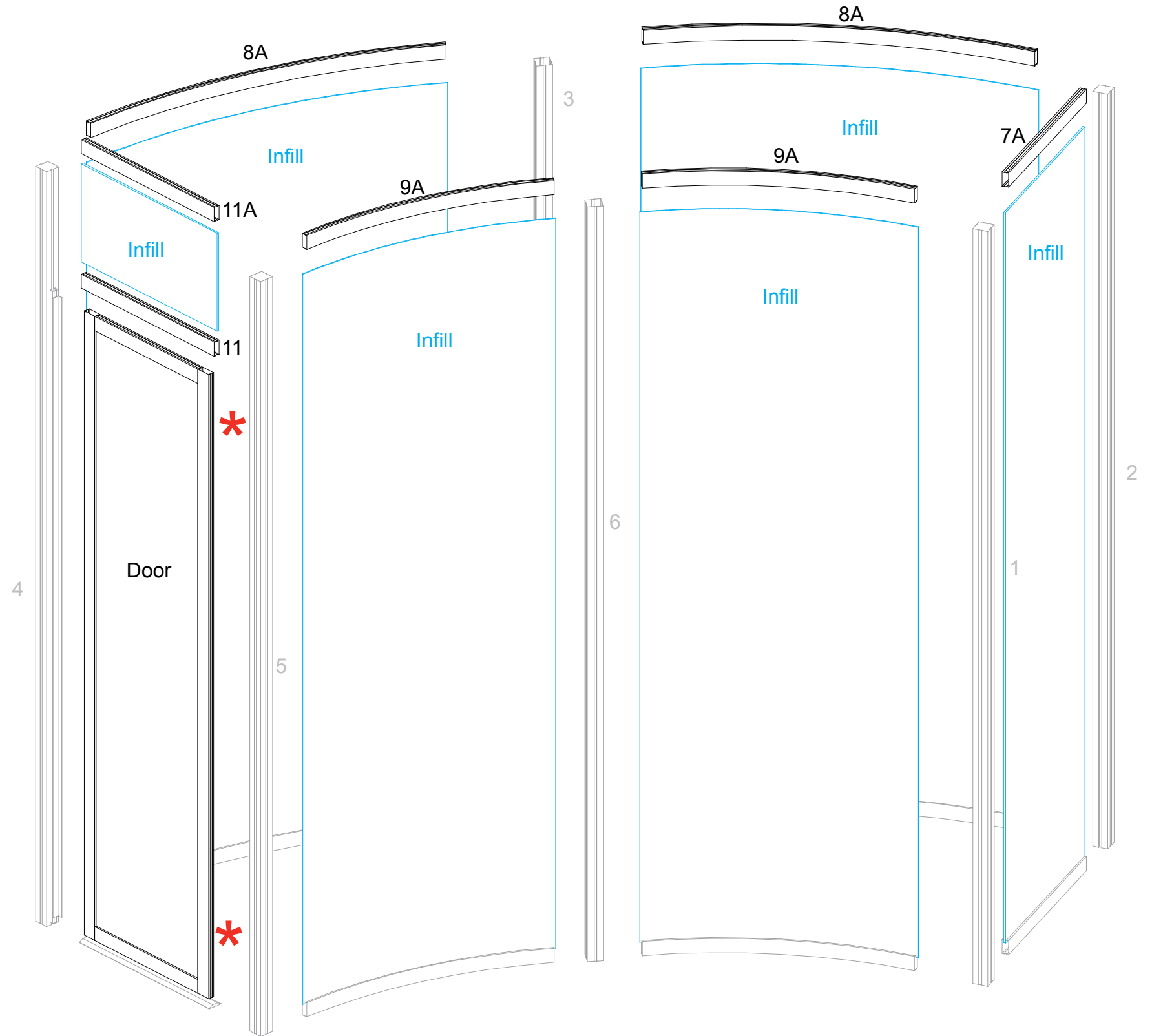
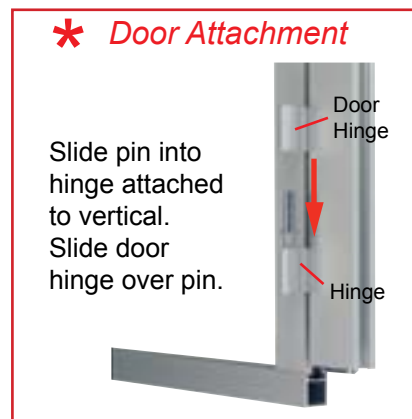

BACK SIDE

Item	Qty.	Description
12	1	90"h TSP46 Vertical Extrusion
13	1	90"h TSP46 Vertical Extrusion
14/14A	1/1	42"w TSP46 Horizontal Extrusion
15	1	86.417"h Z45 Vertical Extrusion
16	2	18.3128"w Z140 Horizontal Extrusion

Steps:

- 1) Attach horizontal [14] between verticals [12] & [13].
See [TSP 46 Corner Connection](#) detail.
- 2) Connect horizontal [14A] between verticals [12] & [13].
See [TSP 46 Corner Connection](#) detail.
- 3) Attach vertical [15] between horizontals [14] & [14A]
- 4) Attach horizontal [16] between verticals [12] & [15].
- 5) Repeat Step 4. for attaching other horizontal [16] between [13] & [15].
- 6) Install standoff barrels on horizontals [16] for monitor mount.
See [Stand-off Barrel & Bolt](#) detail.

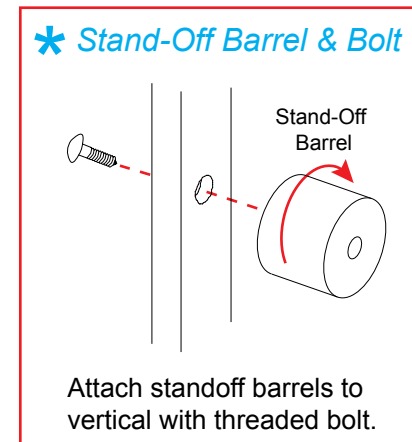
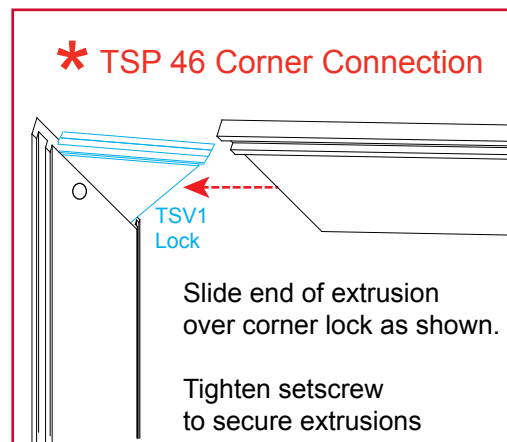
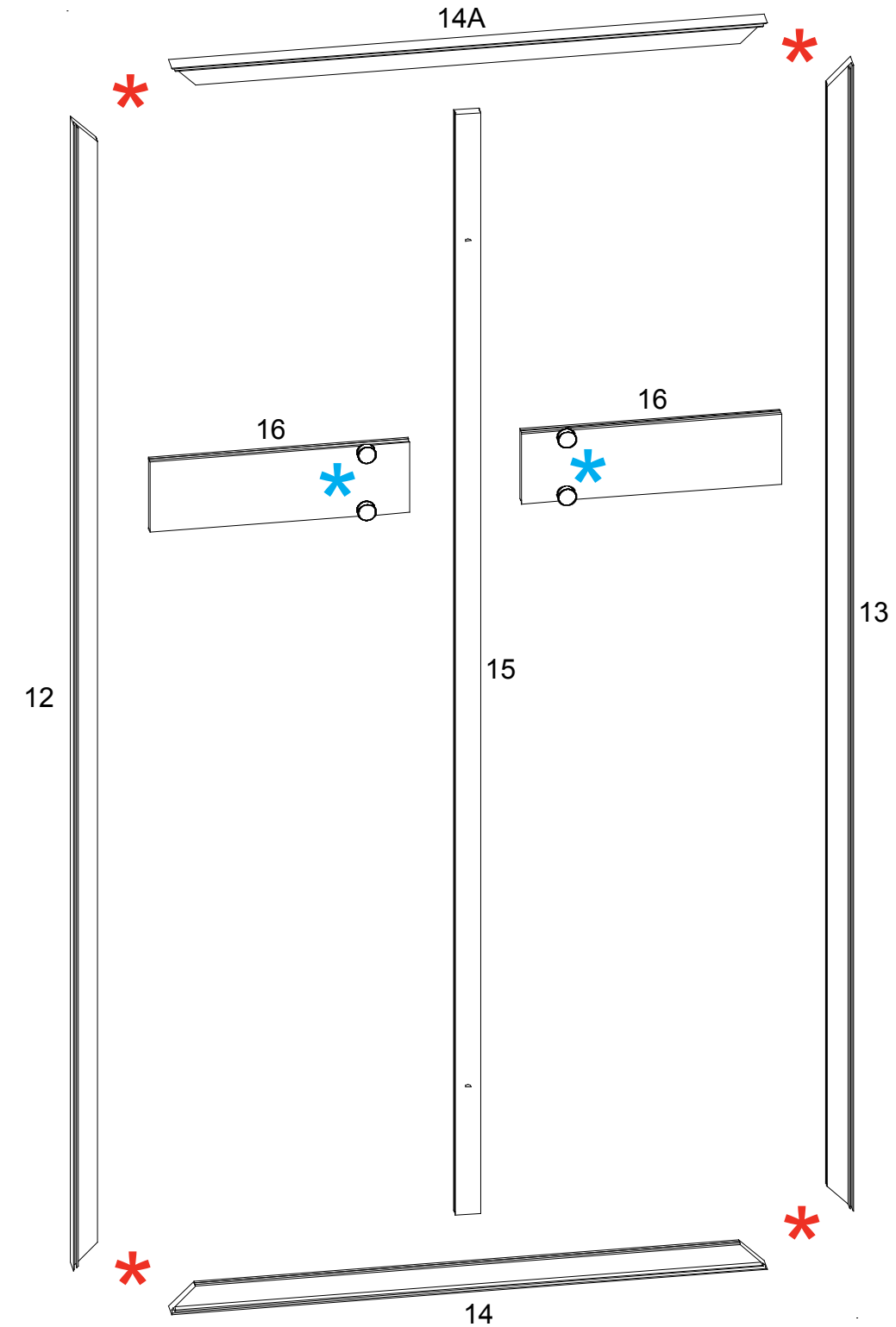

Steps:

- 1) Attach Ceilings to top of assembled frame using bolts from the top side.
- 2) Attach assembled front frame to assembled frame using standoff barrels.
See [Vertical Extrusion to Post Attachment](#) detail.
- 3) Apply SEG Graphic to front of frame.
See [General Information Page](#) for details.
- 3) Install Large Monitor Mount to front frame using standoff barrels.
See [Large Monitor Mount Attachment](#) detail.

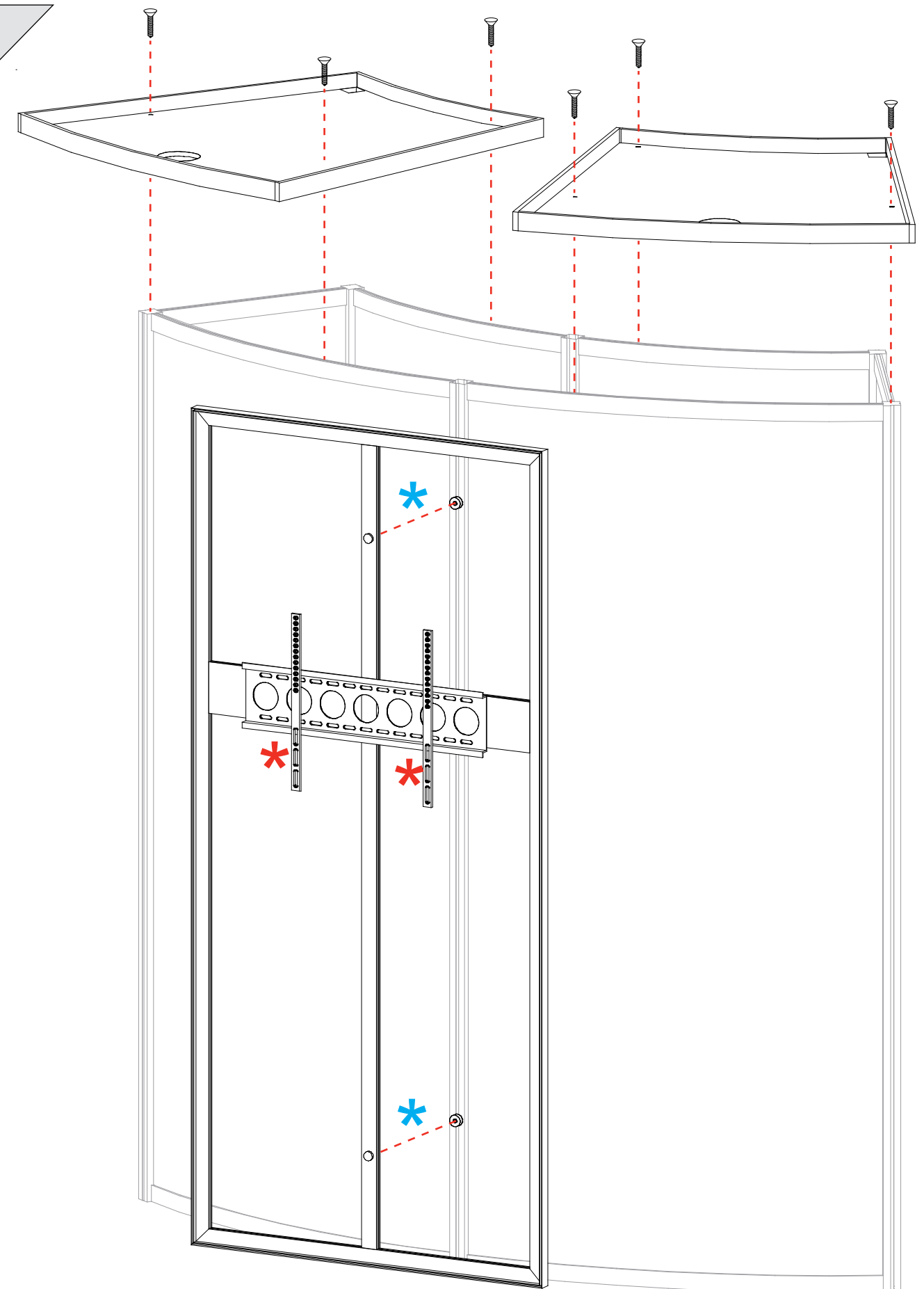
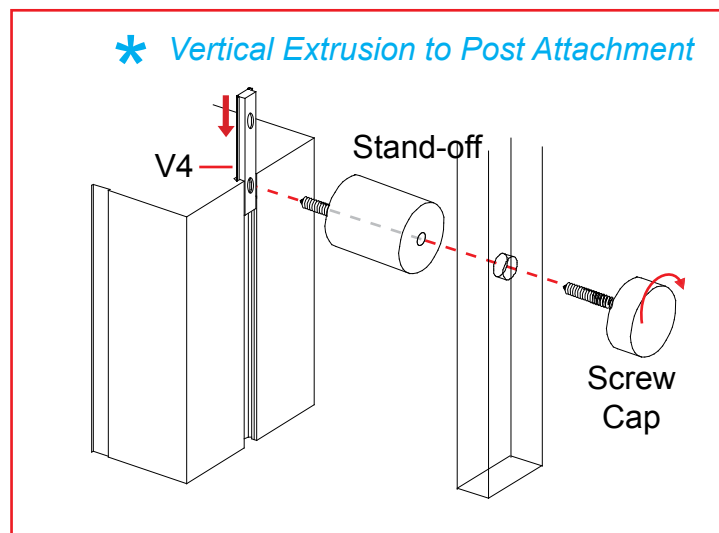
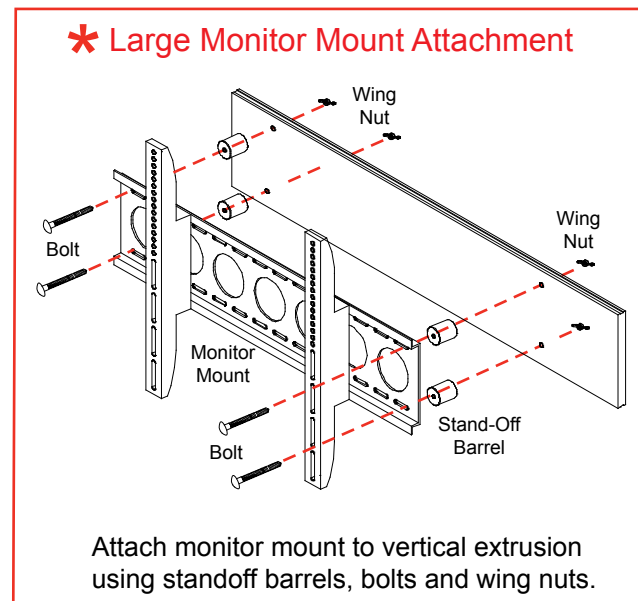

Item	Qty	Description
1	1	37.5"h Vertical Extrusion
2	1	37.5"h Corner Extrusion
3	1	37.5"h Corner Extrusion
4	1	37.5"h Vertical Extrusion
5/5a	4/2	11"w Horizontal Extrusion
6	2	24.875"w Horizontal Extrusion

- Steps**
- 1) Connect side assemblies together using curved extrusions [6], placing graphic infills between horizontals as shown.
 - 2) Place shelf atop lip of extrusions.
 - 3) Set counter top atop assembled base.

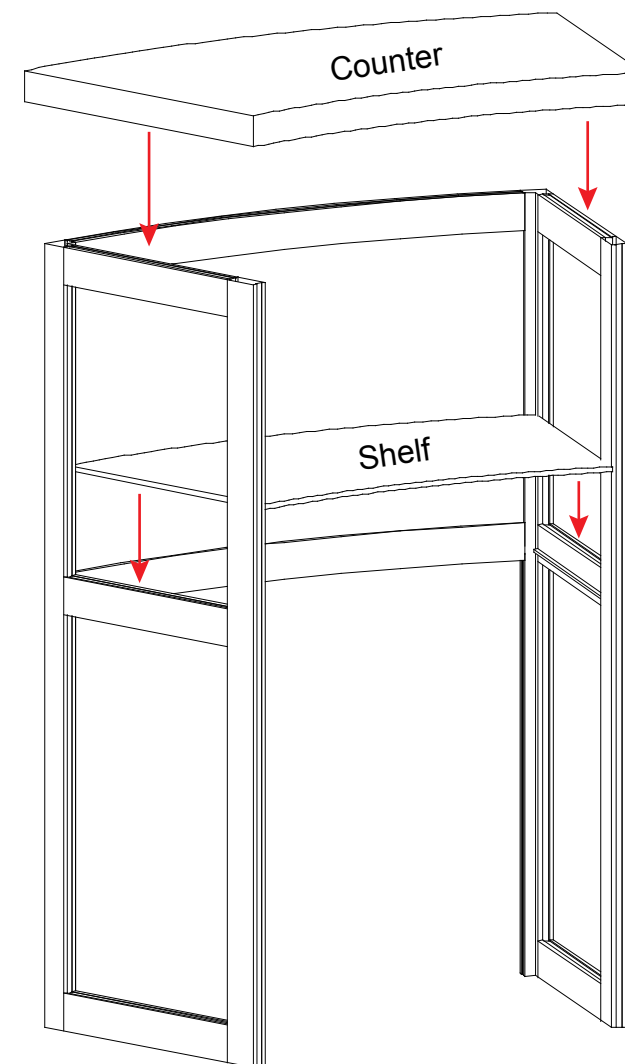
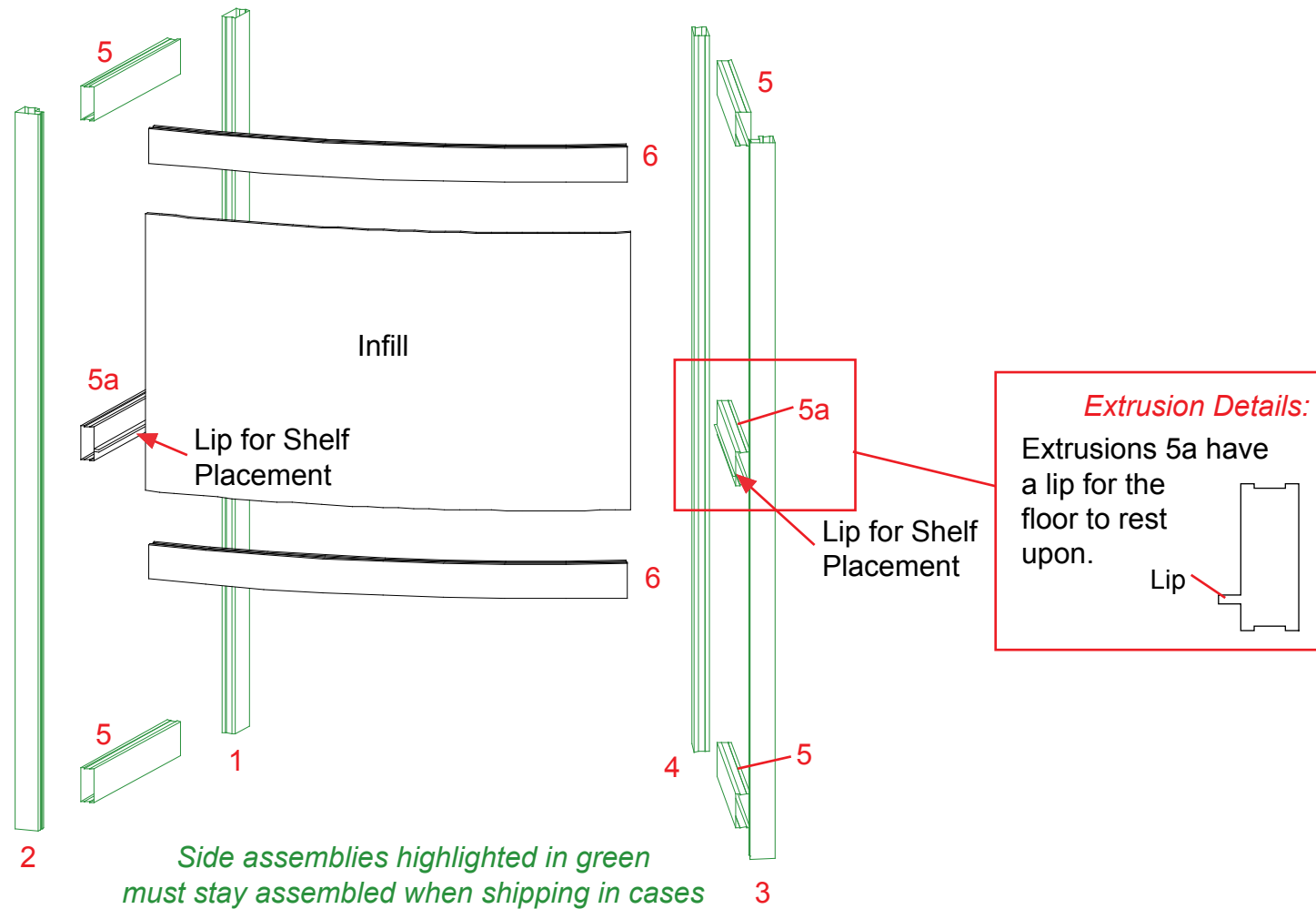
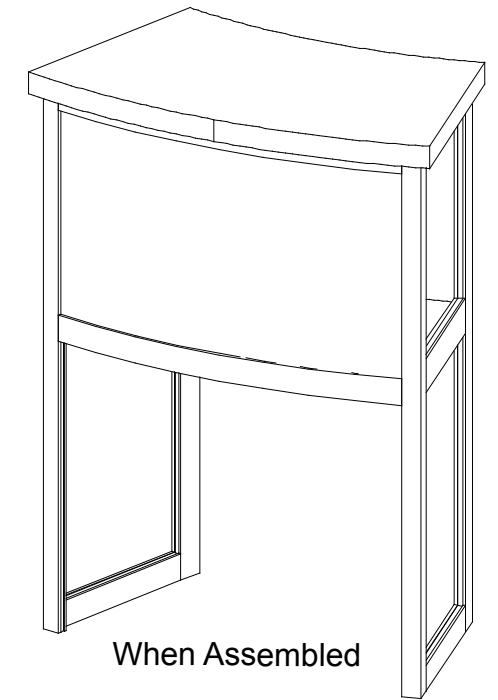

Item	Description
1	38" 90° Connector
2	36.9738" x 38" Curved Panel w/Door
3	38" 90° Connector
4	19"w x 38"h Side Panel
5	38" 90° Connector
6	44.13"w x 38" Side Panel
7	38" 90° Connector
8	19"w x 38"h Side Panel

Steps:

- 1) Assemble LT Panels in numerical order as shown.
- 2) Place Shelf into assembled counter.
- 3) Place Countertop onto assembled counter.

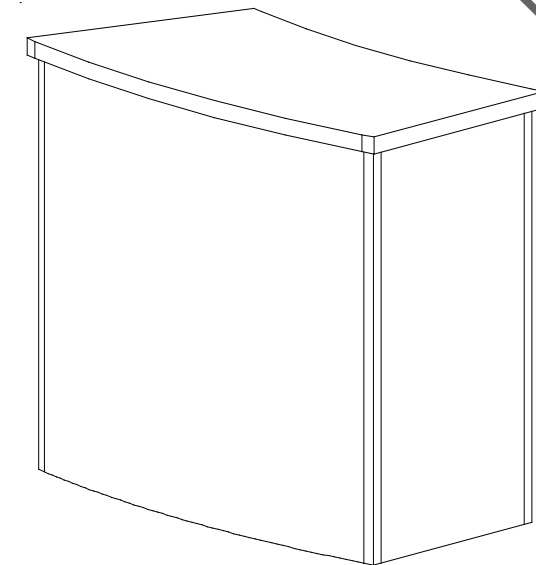
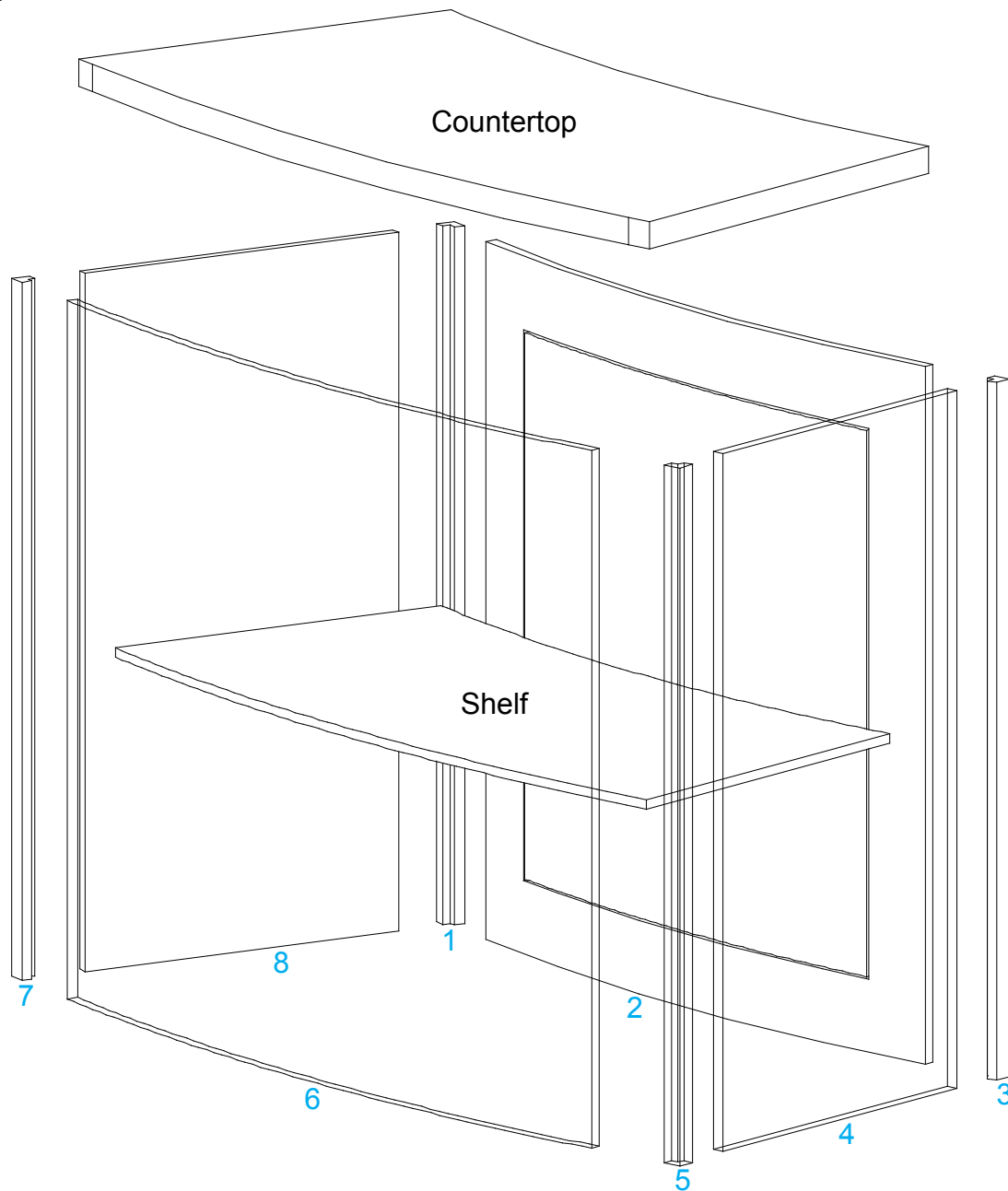
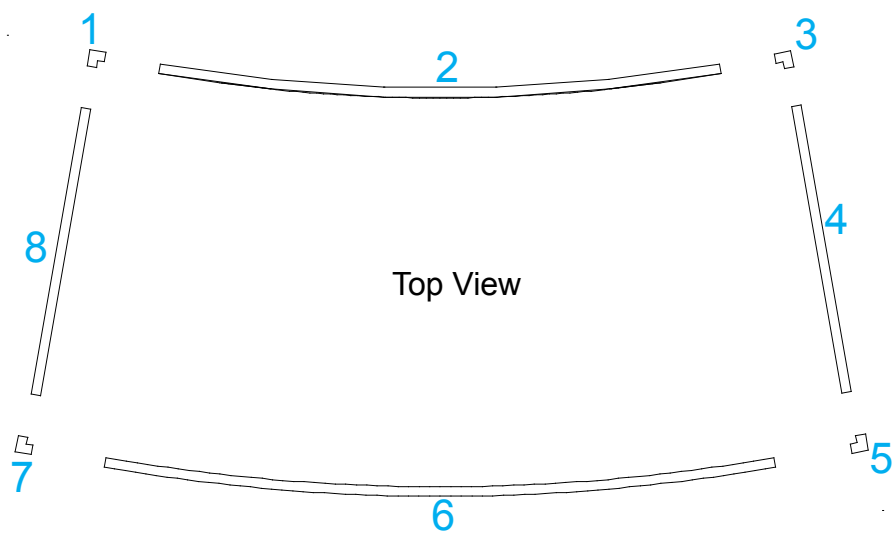

When assembled

